

ELITE, GRAND TOURING AND EXPRESS TRAVEL TRAILERS

# Passport

ULTRA-LITE  
*by Keystone*



GO ANYWHERE



★ ★ ★ ★ ★

# EXPRESS SUPER LITE



What looks small but packs a big punch when it comes to living space? The Passport Express Super Lite! Whether it's the feel of sleeping in the open air with our expandable models or the need for a trailer that can be towed by most small SUV's, the Passport Express Super Lite is the Passport way of making camping easy.



199ML SHOWN IN RATTAN DECOR

**Passport**  
ULTRA LITE  
*by Keystone*

EXPRESS SUPER LITE



195RB SHOWN IN BAYSIDE DECOR



238ML SHOWN IN RATTAN DECOR







LIGHTED PASS-THRU STORAGE (N/A ON EXPANDABLES)



FOOT FLUSH TOILET



EASY OPEN LP TANK COVER



HEAVY DUTY DRAWER GUIDES

# MURPHY BED

STANDARD IN 195RB & 238ML

The passport murphy bed is an innovative way to have both a bed and sofa in a space saving design. *Now available in the passport express 195RB and 238ML.*



STEP 1



STEP 2



STEP 3



STEP 4



DEEP SINK WITH HIGH-RISE FAUCET AND SINK COVERS



EXTERIOR SHOWER



ADJUSTABLE AWNING



BLACK TANK FLUSH

# ALL NEW EXPANDABLES NOW AVAILABLE!



Passport expandables compact design comes with travel-friendly lengths and lightweight floorplans that make this travel trailer towable by many smaller vehicles\*.

\*CHECK WITH YOUR VEHICLE MANUFACTURER FOR TOWING SPECIFICATIONS

The Passport Express Expandable Series has been specifically engineered to maximize sleeping capacity while keeping both weight and overall length of the trailer in mind. Without sacrificing the look, comfort and amenities found in the regular Passport Express, the expandables also offer the latest in hybrid technology.



**ROTO-VISE SYSTEM** clamps tighter than the competition for a better seal with less effort.



Our tent system makes setting up and tearing down your hybrid a breeze. You no longer have to worry about awkward support bars or the tent canvas not being properly sealed to the tent door.

**AVAILABLE IN 145EXP, 171EXP, 177EXP AND 217EXP FLOOR PLANS**



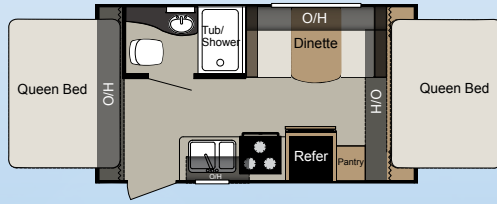

145EXP

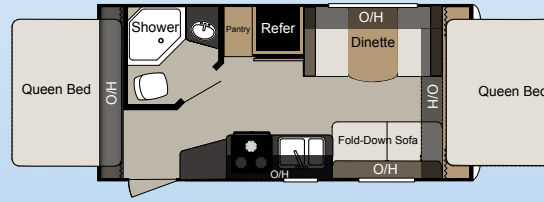

171EXP

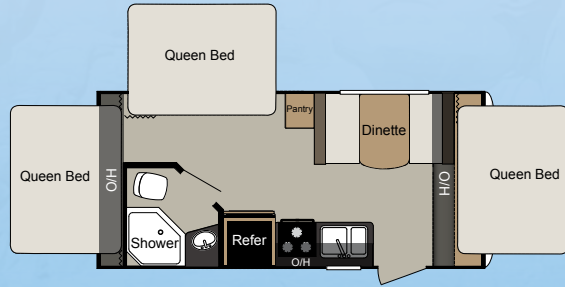

177EXP

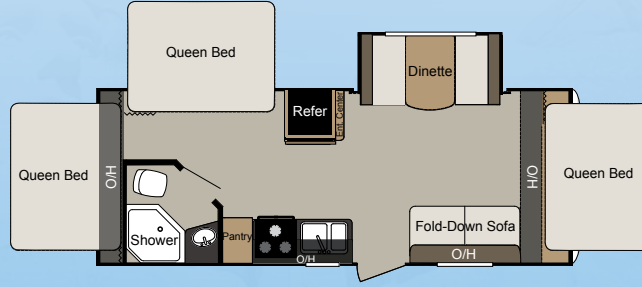

217EXP

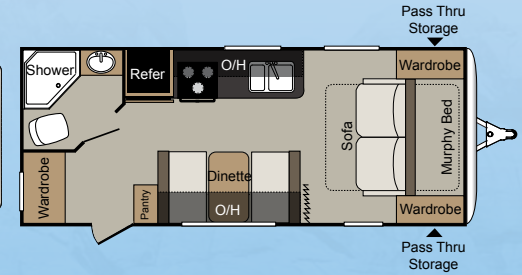

195RB

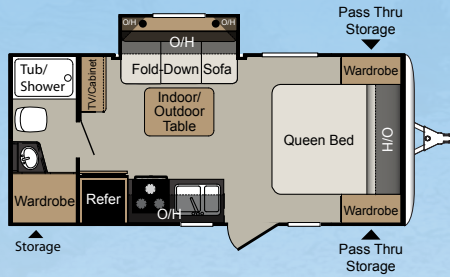

199ML

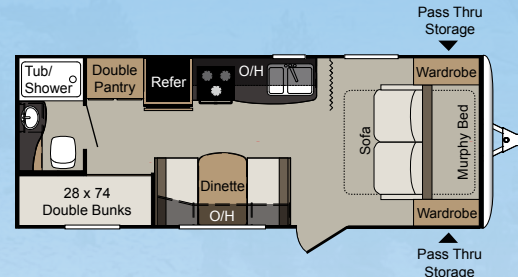

238ML

# EXPRESS FLOOR PLANS

MODEL	SHIPPING WEIGHT	CARRYING CAPACITY	HITCH	LENGTH	HEIGHT	FRESH WATER	WASTE WATER	GRAY WATER	LPG	AWNING
145EXP	3120	850	470	17' 7"	10' 1"	43	38	38	40	10'
171EXP	3612	1588	410	20' 2"	10' 1"	43	38	38	40	10'
177EXP	TBD	TBD	TBD	20' 8"	10' 1"	43	38	38	40	12'
217EXP	TBD	TBD	TBD	TBD	TBD	TBD	TBD	TBD	TBD	TBD
195RB	3677	1523	350	23' 4"	10' 1"	30	30	30	40	15'
199ML	3571	1629	335	21' 9"	10' 1"	30	30	30	40	10'
238ML	3753	1647	495	24' 11"	10' 2"	30	30	30	40	15'

★ ★ ★ ★ ★

# GRAND TOURING



One word describes the Passport Grand Touring. Amazing! The Passport Grand Touring didn't get the memo that it was suppose to act like the other lite weights. With size and features of a full size camper, this Passport is still made for today's SUV's and half ton vehicles. So go ahead and live large, go lite, and get more with a Passport Grand Touring.



3320BH SHOWN IN BAYSIDE DECOR

GRAND TOURING



LOAD EQUALIZATION AXLES (GT AND ELITE)



FOLDING ENTRY ASSIST HANDLE (GT AND ELITE)



ENTERTAINMENT CENTER WITH LED TV AND POCKET DOORS



BUMPER MOUNT GRILL (ON SELECT FLOOR PLANS)





**ENTERTAINMENT CENTER WITH DVD PLAYER,  
AM/FM RADIO, MP3, AUX PORT AND BLUETOOTH**



**GAS/ELECTRIC DSI WATER  
HEATER FOR LONGER  
HOT SHOWERS**



**EXTERIOR LIGHTS ALLOW EASY ACCESS  
TO THE TERMINATION VALVE**



**OUTSIDE KITCHEN  
(AVAILABLE ON 2400BH, 2250RB\*, 2770RB\*, 2920BH, 3220BH, 3320BH)**

*\*GRILL INCLUDED IN PLACE OF 2 BURNER RANGE*

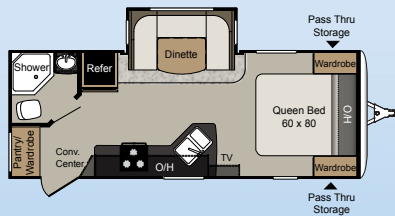

2200RB

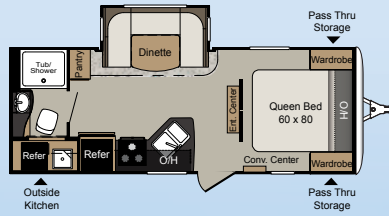

2250RB

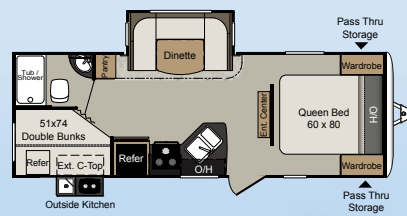

2400BH

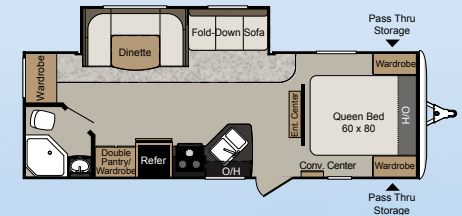

2510RB



2650BH

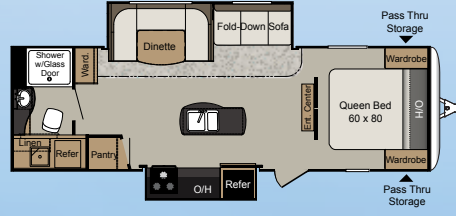

2770RB

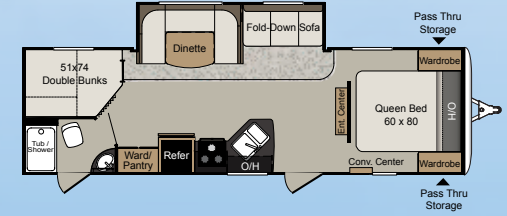

2810BH

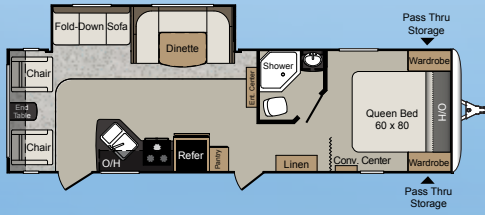

2890RL



2920BH

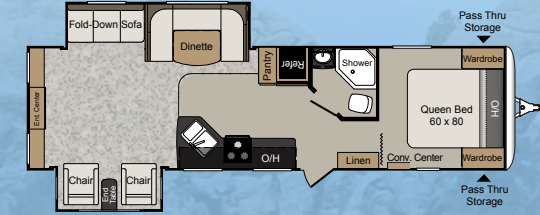

3180RE



3220BH



3290BH

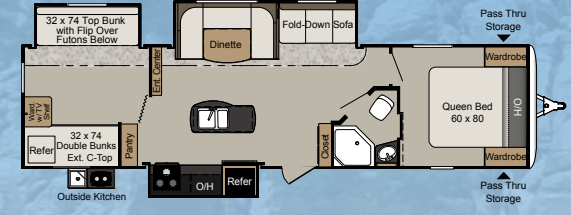

3320BH

# GRAND TOURING FLOOR PLANS

MODEL	SHIPPING WEIGHT	CARRYING CAPACITY	HITCH	LENGTH	HEIGHT	FRESH WATER	WASTE WATER	GRAY WATER	LP6	AWNING
2200RB	4303	2197	420	25' 10"	10' 7"	30	30	30	40	15'
2250RB	4578	1922	490	26' 4"	10' 7"	30	30	30	40	15'
2400BH	4730	2070	515	27' 10"	10' 7"	30	30	30	40	19'
2510RB	4812	2188	495	28' 10"	10' 7"	30	30	30	40	19'
2650BH	4828	2372	540	29' 4"	10' 7"	30	30	30	40	19'
2770RB	5525	1875	645	30' 9"	10' 9"	30	30	60	40	20'
2810BH	5145	2055	565	31' 10"	10' 9"	30	30	30	40	19'
2890RL	5470	1730	615	32' 9"	10' 9"	30	30	60	40	19'
2920BH	5384	1816	625	32' 10"	10' 9"	30	30	30	40	15'
3180RE	5827	1673	720	34' 11"	10' 9"	30	30	30	40	15'
3220BH	5959	1541	600	35' 5"	10' 9"	30	30	30	40	15' & 10'
3290BH	6308	1692	825	36' 8"	10' 11"	30	30	30	40	15'
3320BH	6562	1438	690	36' 10"	10' 11"	30	30	60	40	19'



★ ★ ★ ★ ★

# ELITE



Taking camping to the next level, Passport has created the ultimate in lightweight luxury! Once inside, you will see why the wide open spaces, all the amenities and high end finishes make this ultra-lite travel trailer Elite indeed.



**Passport**  
ULTRA LITE  
*by Keystone*

31RE SHOWN IN RATTAN DECOR

ELITE



**ENTERTAINMENT CENTER TO ENJOY WITH THE WHOLE FAMILY**



**DEEP BASIN STAINLESS STEEL SINK WITH PULL OUT SPRAYER**



**60" X 80" TRI-FOLD QUEEN SIZE HIDE-A-BED**





# Passport

ULTRA LITE  
by Keystone



**OPTIONAL** FREE-STANDING DINETTE (N/A 23RB)



**23RB** SHOWN IN BAYSIDE DECOR

ELITE



**ADJUSTABLE PANTRY SHELVING**  
(SELECT FLOOR PLANS)

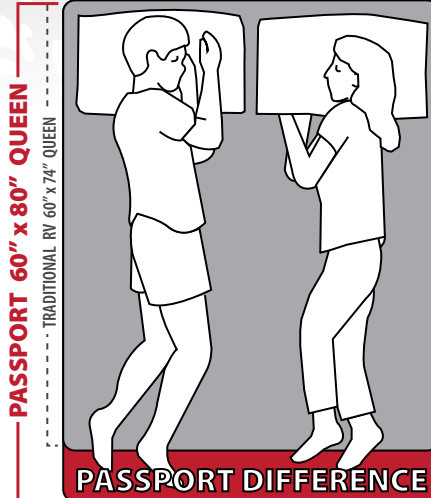

**60" X 80" QUEEN SIZE BED**  
(ALL GT AND ELITE EXCEPT 23RB & 32FB)



**RESIDENTIAL STYLE FAUX WOOD BLINDS**



**FRAMELESS TINTED WINDOWS**



**HEAVY DUTY DRAWER GUIDES**



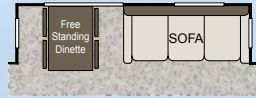

**OPTIONAL  
FREE-STANDING  
DINETTE AND CHAIRS  
(N/A 23RB)**

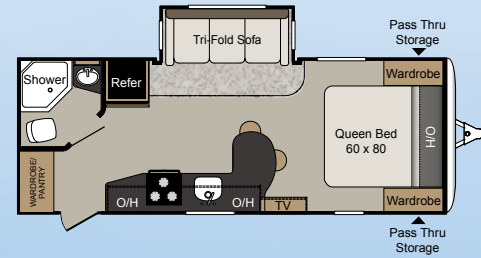

**23RB**



**29BH**

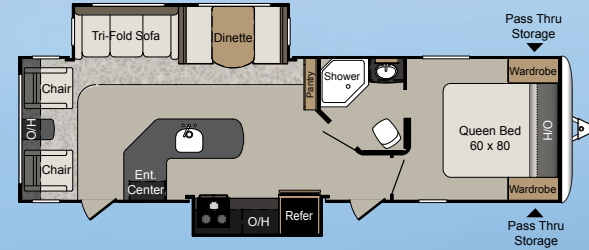

**30RL**

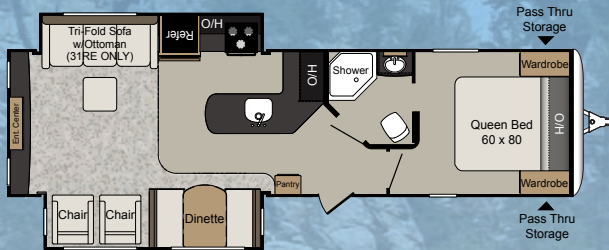

**31RE**

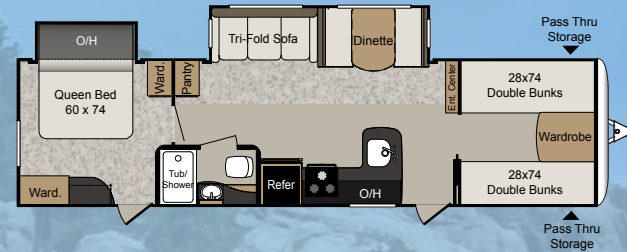

**32FB**

## ELITE FLOOR PLANS

MODEL	SHIPPING WEIGHT	CARRYING CAPACITY	HITCH	LENGTH	HEIGHT	FRESH WATER	WASTE WATER	GRAY WATER	LPG	AWNING
<b>23RB</b>	4608	2192	530	25' 11"	10' 9"	30	30	30	40	15'
<b>29BH</b>	5955	1845	745	33' 8"	10' 8"	30	30	60	40	19'
<b>30RL</b>	6119	1681	665	33' 8"	10' 8"	30	30	60	40	19'
<b>31RE</b>	6216	1784	690	34' 8"	10' 9"	30	30	30	40	12'
<b>32FB</b>	6320	1880	885	35' 4"	10' 9"	30	30	30	40	19'

# SPECIFICALLY BUILT FOR THE WEST

EXPRESS AND GT WESTERN EDITION MODELS ARE AVAILABLE



Oregon production gives West Coast buyers an extreme price advantage over products produced in Indiana due to decreased freight costs. The Pendleton, OR plant also enables the Passport team to offer a trailer that is “specifically built for the West”

What do we mean by “specifically built for the West”? The Western Edition Passport is geared to the specific needs of the West, where camping is done year round and primarily without the luxury of full hook ups to sewer, water, and electricity regularly found in campgrounds in the Midwest and the East.

The Western Edition Passport models are generally, smaller, lighter, and carry more robust features such as added insulation, larger holding tank capacities, larger propane capacity, more interior and exterior storage. We hope that you enjoy our affordable west coast floor plans, added features, and ease of towability with the Western Edition Passport.



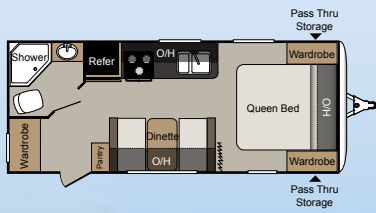

195RBWE

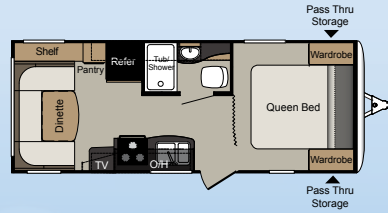

234QBWE

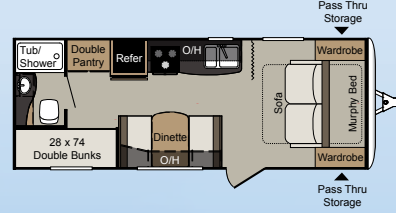

238MLWE

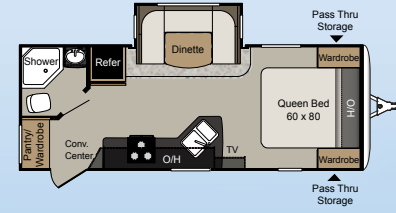

220ORBWE

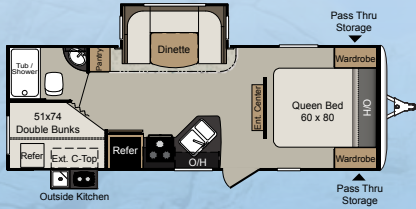

240ORBWE



2450RLWE

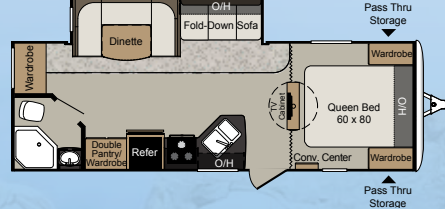

2510RBWE

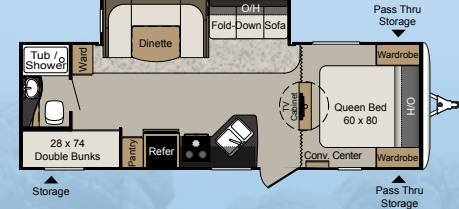

2650BHW



2770RBWE

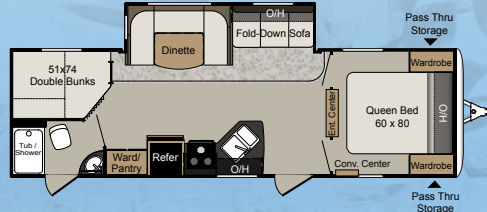

2810BHW

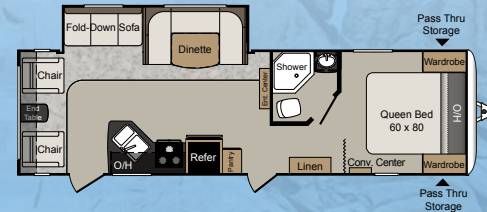

2890RLWE

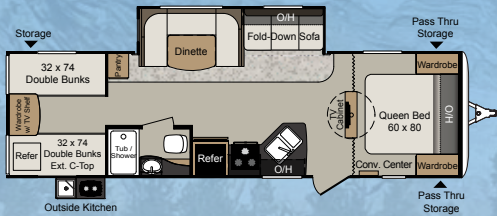

2920BHW



3220BHW



3320BHW

# WESTERN EDITION FLOOR PLANS

MODEL	SHIPPING WEIGHT	CARRYING CAPACITY	HITCH	LENGTH	HEIGHT	FRESH WATER	WASTE WATER	GRAY WATER	LPG	AWNING
195RBWE	3846	2084	260	24' 5"	10' 1"	43	30	30	40	14'
234QBWE	3922	2478	420	25' 4"	10' 1"	43	30	30	40	15'
238MLWE	3923	1477	410	25' 6"	10' 2"	43	30	30	40	15'
220ORBWE	4430	2070	520	25' 10'	10' 7"	43	30	30	40	15'
2400BHW	4740	2260	500	27' 10"	10' 7"	43	30	60	40	19'
2450RLWE	4780	2220	550	28' 7"	10' 7"	43	30	30	40	15'
2510RBWE	4904	2096	510	28' 10"	10' 7"	43	30	30	40	19'
2650BHW	5005	2195	470	29' 4"	10' 7"	43	30	30	40	19'
2770RBWE	5525	1875	645	30' 9"	10' 9"	43	38	76	40	20'
2810BHW	5280	1920	550	31' 10"	10' 7"	43	30	30	40	19'
2890RLWE	5581	1619	610	32' 9"	10' 7"	43	30	60	40	19'
2920BHW	5646	1554	670	32' 10"	10' 9"	43	30	30	40	15'
3220BHW	6243	1257	580	35' 5"	10' 9"	43	30	30	40	15' & 10'
3320BHW	6850	2150	740	36' 10"	10' 11"	30	30	60	40	19'



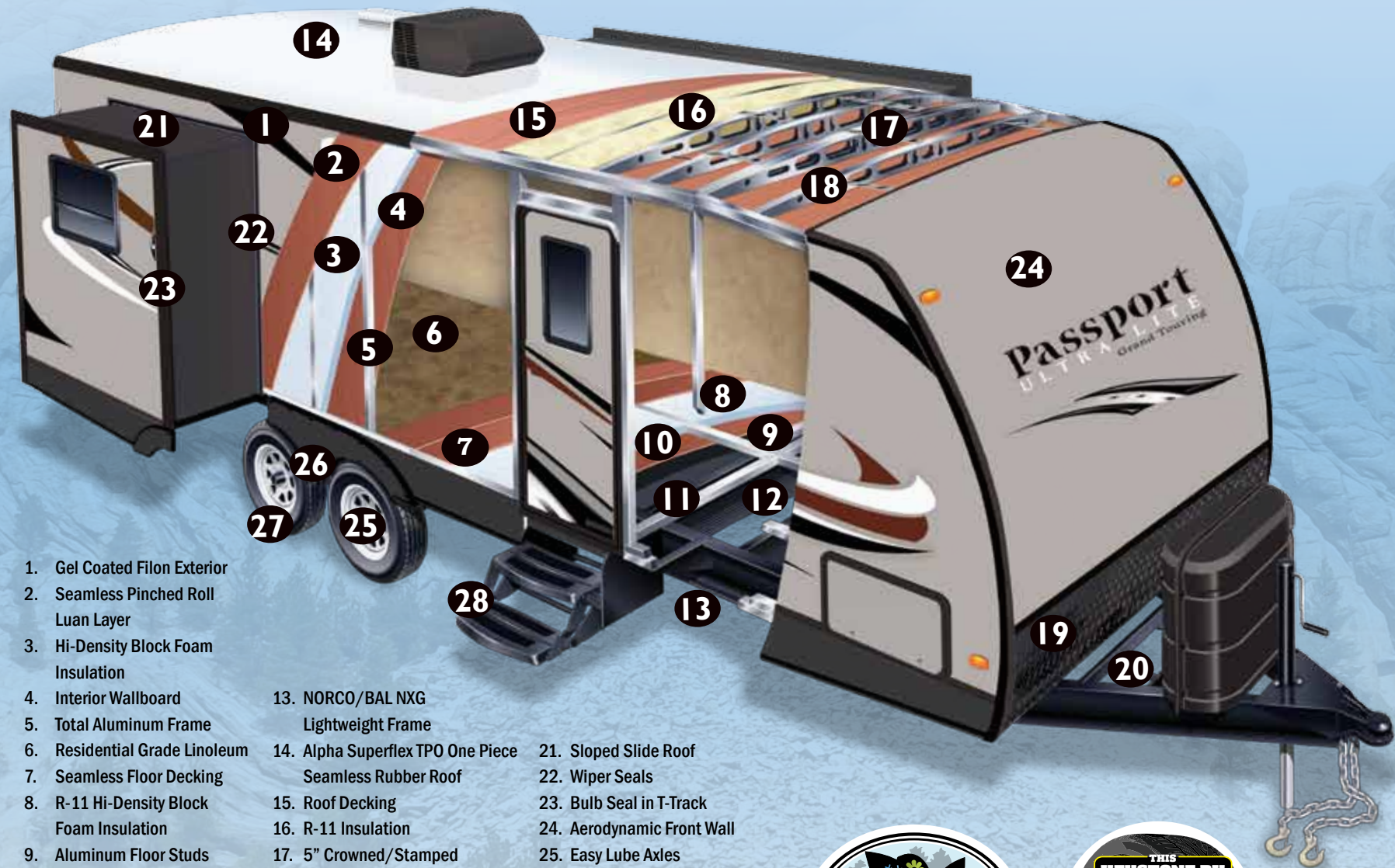

- |  |  |   |
|--|--|---|
| 1. Gel Coated Filon Exterior             | 14. Alpha Superflex TPO One Piece Seamless Rubber Roof | 21. Sloped Slide Roof                           |
| 2. Seamless Pinched Roll Luan Layer      | 15. Roof Decking                                       | 22. Wiper Seals                                 |
| 3. Hi-Density Block Foam Insulation      | 16. R-11 Insulation                                    | 23. Bulb Seal in T-Track                        |
| 4. Interior Wallboard                    | 17. 5" Crowned/Stamped Roof Trusses                    | 24. Aerodynamic Front Wall                      |
| 5. Total Aluminum Frame                  | 18. Hurricane Straps                                   | 25. Easy Lube Axles                             |
| 6. Residential Grade Linoleum            | 19. Diamond Plate                                      | 26. Load Equalization Axles (GT and Elite only) |
| 7. Seamless Floor Decking                | 20. Dual Battery Tray                                  | 27. Radial Tires                                |
| 8. R-11 Hi-Density Block Foam Insulation |  | 28. Radius Entry Steps                          |
| 9. Aluminum Floor Studs                  |  |   |
| 10. Bottom layer floor decking           |  |   |
| 11. Moisture Barrier Wrap                |  |   |
| 12. Enclosed Underbelly (GT & Elite)     |  |   |
| 13. NORCO/BAL NXG Lightweight Frame      |  |   |





	EXPRESS	GT	ELITE
<b>CHASSIS</b>			
Engineered specifically for each floor plan	●	●	●
Tube style bumper w/ sewer hose storage		●	●
Fully welded outriggers	●	●	●
Cambered for added structural support	●	●	●
Extra support cross members	●	●	●
Electric slide out system	●	●	●
Enclosed and sealed heated underbelly		●	●
<b>CONSTRUCTION</b>			
Welded aluminum framed sidewalls	●	●	●
Seamless laminated gel-coated filon exterior walls	●	●	●
High density block foam insulation in sidewalls (R-7 insulation)	●	●	●
Laminated aluminum framed floor 2" thick	●	●	●
One piece breathable Darco protective wrap	●	●	●
R-11 high density block floor insulation	●	●	●
Stamped galvanized 5" thick crowned rafters	●	●	●
One piece seamless Alpha Superflex TPO roof	●	●	●
R-11 ceiling rolled fiberglass insulation	●	●	●
<b>EXTERIOR FEATURES</b>			
Insulated lockable radius baggage doors with hold backs	●	●	●
Insulated radius entrance door with screen door	●	●	●
Double entry steps at main door	●		
Triple entry steps at main door		●	●
Heavy duty front mechanical jack	●	●	●
4 scissor style stabilizer jacks	●	●	●
2-20lb. Propane bottles with flip top cover	●	●	●
Dual battery rack over A-frame	●	●	●
Rain gutters with extended downspouts	●	●	●
Electric adjustable awning	●	●	●
Lighted exterior pass thru storage compartment	●	●	●
Portable outside grill (Select models. Not all outdoor kitchen models)		●	●
Patio entrance light	●	●	●
Exterior shower w/ hot & cold	●	●	●
Front diamond plate	●	●	●
Fold away exterior grab handle (main door)		●	●
Load Equalization (spread axle design)		●	●
EZ lube axles	●	●	●
Exterior speakers	●	●	●
Exterior light at dump valves	●	●	●
15" aluminum wheels			●
15" radial tires			●
Frameless windows			●
Upgraded graphics package			●

	EXPRESS	GT	ELITE
<b>INTERIOR FEATURES</b>			
Residential style furniture with high grade fabric	●	●	●
Convenience center with slide, lights, awning, water system controls, and 110V receptacle		●	●
13,500 BTU A/C	●	●	●
Forced air furnace	●	●	●
Ducted in floor heating		●	●
6 gallon gas/electric DSI water heater (17.8 gal/hr)	●	●	●
Water system winterization ready	●	●	●
Residential durable Beauflor® linoleum	●	●	●
Digital TV system	●	●	●
12 volt DVD/CD/AM/FM stereo, AUX input, bluetooth and quality sound speakers	●	●	●
LED flat screen HD TV	●	●	●
Residential light fixtures in slide room	●	●	●
Radius walls			●
Upgraded residential window treatments and valences		●	●
High-end window treatments with crown molding (wood valence leather accent)			●
Residential style entertainment center with integrated pocket doors		●	●
Residential interior doors	●	●	●
Upgraded furniture (hide-a-bed)			●
Wood mini blinds			●
Vaulted ceiling			●
<b>KITCHEN</b>			
Extra large double door domestic refrigerator	●	●	
Oversized 60/40 residential sink with sink covers	●	●	
Metal high-rise faucet	●	●	●
Microwave with carousel	●	●	●
3-burner high output range	●	●	●
Range hood	●	●	●
Residential raised panel hardwood cabinet doors	●	●	●
Coordinated wall paper border	●	●	●
Gas Oven	●	●	●
Solid surface countertop			●
Stainless steel sink			●
Pendant lighting above kitchen countertops			●

	EXPRESS	GT	ELITE
<b>BEDROOM (MAIN)</b>			
60"x80" Queen size mattress with quilted bedspread		●	●
60"x74" Queen size bed	●		
Oversized wardrobes	●	●	●
Nighttime reading lights	●	●	●
Under bed storage	●	●	●
Power outlet at bed side	●	●	●
Throw pillows			●
<b>BATHROOM</b>			
Solid wood custom built medicine cabinet with mirror	●	●	●
Tub surround with built-in shelves	●	●	●
Radius shower curtain	●	●	●
Pedestal foot flush toilet	●	●	●
Skylight over tub (most floorplans)		●	●
12 volt power exhaust fan	●	●	●
<b>SAFETY PACKAGE</b>			
4 wheel electric brakes	●	●	●
Break-away switch	●	●	●
Heavy duty safety chains with clasp	●	●	●
Tinted safety glass windows	●	●	●
Multiple emergency egress windows	●	●	●
GFI receptacles	●	●	●
Carbon monoxide detector	●	●	●
Smoke alarm	●	●	●
Fire extinguisher	●	●	●
Propane gas leak detector	●	●	●
Dead-bolt lock on entrance doors	●	●	●
Manual override on slide system	●	●	●
Spare tire kit	●	●	●
<b>OPTIONS</b>			
15,000 BTU A/C	●	●	●
Aluminum Wheels	●	●	●
Free-standing dinette and chairs (N/A 23RB)			●

# STANDARDS AND OPTIONS



GRANITE DECOR



BAYSIDE DECOR

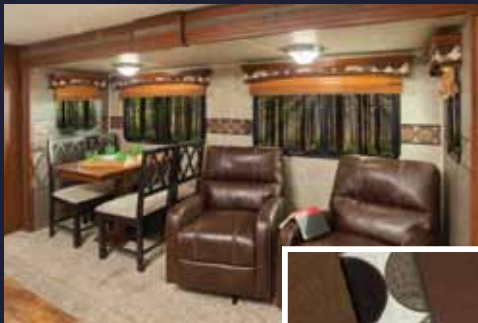

RATTAN DECOR



# STAY IN TOUCH



Passport is always just a touch away. You'll find 360 virtual tours, location of your nearest dealer, photos, videos and all of the latest information about Passport on our easy to navigate website. Everything you need can be accessed anytime, day or night, from home or on the road. You can also find us on the Keystone RV facebook.

[www.keystonerv.com/Passport](http://www.keystonerv.com/Passport)



## KEYSTONE RV RECOMMENDS BUYING LOCALLY

It's up to you where you purchase your new Passport, but may we suggest your local dealer? Not only does it help your local economy and provide jobs, but it will also give you an opportunity to develop a service relationship with someone that will come to know you and your coach. Congratulations on finding the best built, best equipped, best value in the industry, and happy travels!

### YOUR LOCAL DEALER:

JANUARY 2015

Product information is as accurate as possible at the date of publication of this brochure. Features, floor plans, and specifications are subject to change without notice. Please also consult Keystone's web site at [keystonerv.com](http://keystonerv.com) for more current product information and specifications. **Tow Vehicle Disclaimer.** CAUTION: Owners of Keystone recreational vehicles are solely responsible for the selection and proper use of tow vehicles. All customers should consult with a motor vehicle manufacturer or their dealer concerning the purchase and use of suitable tow vehicles for Keystone products. Keystone disclaims any liability or damages suffered as a result of the selection, operation, use or misuse of a tow vehicle. **KEYSTONE'S LIMITED WARRANTY DOES NOT COVER DAMAGE TO THE RECREATIONAL VEHICLE OR THE TOW VEHICLE AS A RESULT OF THE SELECTION, OPERATION, USE OR MISUSE OF THE TOW VEHICLE.**

Go RVing  
Life's A Trip™



2642 Hackberry Drive | PO Box 2000  
Goshen, IN 46527-2000  
(574) 535-2100



Passport  
ULTRA LITE  
by Keystone

