



TRAVELER

HOLIDAY RAMBLER



HALF-TON ULTRA-LITE TRAVEL TRAILER

The Traveler by Holiday Rambler is lightweight, durable and built for family fun and easy towing. Several spacious floor plans are available from 22–32 feet. This aluminum welded frame trailer provides comfort and is built to last for the long haul.

22RD

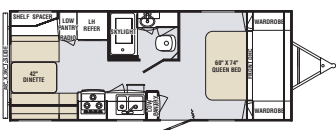

23RBS

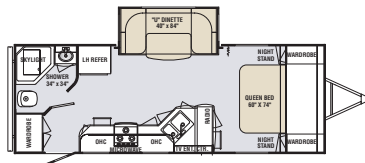

24BH

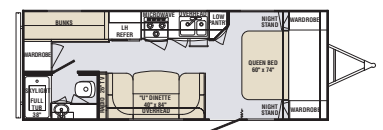

25BHS

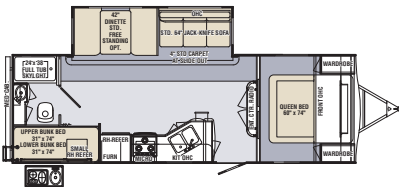

25RKS

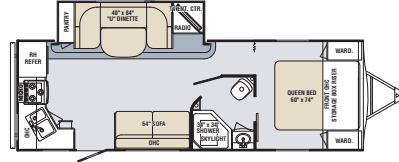

27BHS

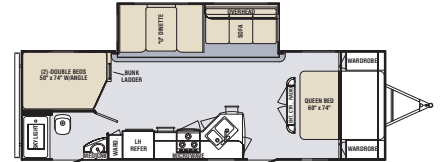

28RLS

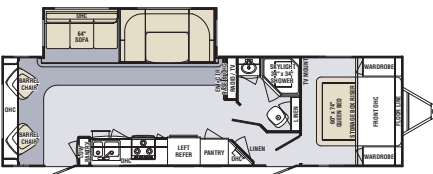

32BHD

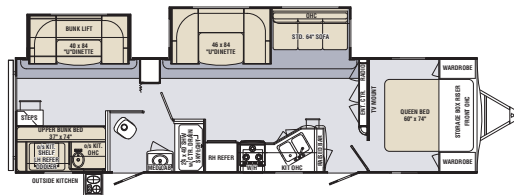

STANDARD FEATURES

BODY CONSTRUCTION

- > I-Beam Chassis w/Steel Outriggers
- > 96" Width Construction
- > 15" Tires w/Steel Rims (N/A 32BHD)
- > Frame Mounted Entry Steps
- > Front Hitch Manual Crank Jack
- > 2-5/16" Ball Coupler
- > Tandem Axles
- > Gel Coat Fiberglass Exterior
- > Aluminum Welded Construction (Sidewalls, Floors, Rear)
- > Laminated Sidewalls, Floor & Rear Walls
- > Wood Rafter Roof 16" O.C.
- > EPDM Roofing Membrane
- > Rain Gutters w/Downspouts
- > Steel Bumper
- > A-Frame Battery Rack
- > Pass Through Front Storage
- > Entry Assist Entry Door Handle
- > Tinted Windows
- > Vinyl Graphics

SLIDE-OUT CONSTRUCTION

- (Where Applicable)
- > Aluminum Welded Frame (Excluding Floor)
 - > Laminated Roof and End Walls
 - > Decorative Slide-out Fascia

APPLIANCES & ACCESSORIES

- > Powered Range-Hood w/Light
- > 6 Gallon Gas Water Heater
- > Water Heater Bypass On-Demand High Flow Water Pump
- > Systems Monitor Panel
- > 18M BTU Electronic Ignition Furnace or 20M BTU Electronic Ignition Furnace w/Ducted Heat

INTERIOR

- > Solid Hard Wood Stained Cabinet Doors and Drawers
- > Accent Wall Board (Slide-outs & Front Wall)
- > Galley Border
- > Linoleum

- > Mini-Blinds
- > Window Valances
- > Lambrequin Legs
- > Bed Storage w/Prop Rod
- > Medicine Cabinet
- > Booth U-Shaped Dinette (By Floorplan)
- > Curtains at Bunk Windows
- > Hard Valance w/Drapes at Bedroom Windows
- > Jackknife Sofa
- > Queen Bed
- > Bunk Mats (By Floorplan)
- > 12V Vent in Bathroom
- > Manual Vent - Living Room
- > HPL Countertops w/Bullnose
- > Hi-Rise Goose Neck Faucet
- > Tub w/Curtain
- > Shower w/Glass Door (23RBS, 25RKS & 28RLS)

ELECTRICAL & PLUMBING SYSTEMS

- > 30 AMP Power Cord
- > 55 AMP Converter w/Charger
- > 120 Volt Breaker Panel
- > Porch Light
- > 120V Exterior Recept
- > 120V GFI Outlets
- > Pex Plumbing System
- > Rotocast Holding & Fresh Tanks
- > Hand Flush Toilet
- > Centralized and Extended Dump Valves
- > Gravity Fill
- > Black Tank Flush

SAFETY STANDARD FEATURES

- > Fire Extinguisher
- > 120V GFI Outlets (Kitchen, Bath, Exterior)
- > Breakaway Switch
- > Safety Chains
- > LP Gas Detector
- > Smoke Detector
- > CO Detector
- > Egress Window(s)

GENERAL OPTIONS

CONVENIENCE PACKAGE

(Mandatory Option)

- > Radial Tires
- > EZ-Lube Hubs
- > Dual 20lb. LP Bottles
- > X-Wide Luggage Doors (Front)
- > Safety Glass Windows
- > Oversized Dinette Window
- > Radius Dark Tinted Windows
- > Ball Bearing Stainless Steel Drawer Glides
- > 7-PLY Cabinet Grade Drawer Boxes
- > Skylight in Bathroom
- > 60/40 Kitchen Sink
- > Tub Surround Bath Accessories
- > Double Door 6 Cu. Ft. Refrigerator
- > Microwave
- > Ducted Heat (where applicable)
- > Manual Patio Awning
- > 13.5K BTU AC w/Direct Feed/Dump
- > Rear Stabilizer Jacks (2)
- > AM/FM/CD/DVD/iPod MP3 Stereo
- > Interior Speakers (2)
- > TV Antenna w/Cable

VALUE PACKAGE

(Mandatory Option)

- > Black Exterior Trims [Awning Hardware, LP Bottle Cover, Fenders (where applicable), Black Framed Entrance Door w/Window, Black Framed Baggage Doors]
- > Front Stabilizer Jacks (2)
- > Hitch Light

- > Outside Shower
- > Oven w/3 Burner Range
- > (2) Exterior Black Speakers
- > Enclosed Underbelly
- > Gel Coat Front Cap
- > Ceiling AC Duct
- > Front Diamond Plate
- > 6 Gal. G/E DSI 110 Water Heater

BODY CONSTRUCTION

- > Aluminum Wheels
- > Spare Tire w/Cover
- > Electric Power Awning

FURNITURE

- > Murphy Bed w/Sofa (232RBS & 242BH)

APPLIANCE & ACCESSORIES

- > Sink Cover
- > Stove Cover (Bi-Fold)
- > LED TV

PLUMBING & LP

- > 30# Propane Tanks w/Cover

CANADIAN RV SHIPMENTS

- > Transport Canada MSVR
- > Canadian RV Certification

WARRANTY:

12 month basic limited warranty. 5 year limited structural warranty.*

*Please review your RV's limited warranty in full for complete terms and conditions.

WEIGHTS*	22RD	23RBS	24BH	25BHS	25RKS	27BHS	28RLS	32BHD
Gross Vehicle Weight Rating (lbs.)	6,160	6,160	6,160	7,700	6,160	7,700	7,700	11,440
Dry Hitch Weight (Approx.)	470	460	360	615	445	675	775	930
Dry Axle Weight (Approx.)	3,260	3,880	3,510	5,950	4,480	4,695	5,275	7,295
Net Carrying Capacity (NCC)	2,430	1,820	2,290	1,135	1,235	2,2330	1,650	3,215
Axle Ratings	2,800 (x2)	2,800 (x2)	2,800 (x2)	3,500 (x2)	2,800 (x2)	3,500 (x2)	3,500 (x2)	5,200 (x2)
Tire Size (ST205/75R14C)	14"	14"	14"	14"	14"	14"	14"	15"
Tire Load Range	C	C	C	C	C	C	C	D
MEASUREMENTS								
Overall Length	23' 11"	26' 7"	26' 2"	28' 11"	28' 6"	30' 5"	32' 11"	35' 9"
Overall Height (A/C Included)	10' 5"	10' 5"	10' 5"	10' 7"	10' 7"	10' 7"	10' 7"	10' 8"
Interior Width	92 3/4"	92 3/4"	92 3/4"	92 3/4"	92 3/4"	92 3/4"	92 3/4"	92 3/4"
Exterior Width (w/o Awning)	96"	96"	96"	96"	96"	96"	96"	96"
TANK CAPACITIES**								
Grey Tank (gal.)	30	30	30	30	30	30	30	30
Black Tank (gal.)	30	30	30	30	30	30	30	30
Fresh Water Capacity (gal.)	30	30	30	30	30	30	30	49
LP Tank (Two 20 lb. Tanks)	S	S	S	S	S	S	S	S

* Weights may vary by options.

** Tank manufacturer's listed water capacity (WC). Actual filled LP capacity is 80% of listing due to safety shut off required on tank.

The actual overall length of the recreational vehicle may differ from that indicated in the brochure due to variances in the manufacturing process and/or installed components. The actual length may be greater or less than that indicated. Due to the large variety of options and floorplan arrangements available to our customers, actual weights for each unit can differ significantly. Holiday Rambler provides a weight sticker on each unit we produce which includes that unit's tank capacities and approximate weight. Consult your local Holiday Rambler dealer for unit availability and further information. The information printed in this brochure reflects product design, fabrication, and component parts at the date of printing. The manufacturer reserves the right, at any time, to make changes in product design or material or component specifications as its sole option, without notice. This includes the substitution of components of a different brand or trade name which will result in comparable performance. All information printed in this brochure is subject to change after the date of printing. Some features shown or mentioned in this brochure are optional and may only be available in selected floorplans. Photographs may show props or decorations that are not standard equipment. Holiday Rambler, the Holiday Rambler logo and its design, are registered trademarks. Other products and company names are trademarks and/or registered trademarks of their respective holders. While the interior fabrics depicted in this sales brochure are fair and reasonable depictions, the colors depicted may not be an exact match of the actual colors because of the variances in photo-processing and printing. Due to product improvements, changes during the model year and/or transcription errors that may occur, information represented within this brochure may not be accurate at the time of your purchase. If certain information is significant to your purchasing decision, please confirm the information with your dealer. Component part and appliance manufacturers issue limited warranties covering portions of the recreational vehicle not covered under the Limited Warranties issued by Holiday Rambler. To learn specific details regarding warranty coverage, please contact your selling dealership or review the warranty packet inside the recreational vehicle.

