

JAY FEATHER ULTRA LITE

EXPAND YOUR EXPECTATIONS OF FAMILY FUN



JAY FEATHER SLX



JAY FEATHER



Jayco[®]

Generations of family fun.

BUILT FOR THE

ultimate

experience camping

TENTS

Jay Feather's tent system packs the traditional camping experience without all the hardships of tent camping. Part travel trailer, part Swiss Army knife, it delivers everything you need in the ultimate expandable design.



closes easily



travel-friendly length

space-making design

experience comfort

WALL-TO-WALL FEATURES

Thanks to innovative floorplans, expandable sleeping areas and hardwall slideouts, Jay Feather maximizes space so you won't have to sacrifice amenities. Equipped with wall-to-wall features, this leading lightweight is big on comfort.

LEARN MORE ABOUT OUR 2-YEAR LIMITED WARRANTY ON THE BACK COVER.



CAMPING EXPERIENCE

2

MAGNUM
ROOF SYSTEM

experience craftsmanship

Say hello to the industry's strongest roof — the Magnum Truss Roof System. In a side-by-side comparison test, our exclusive roof system withstood 4,500 lbs. — 50 percent more than other roofs. See page 8 to learn more about the top-quality materials we use in Jay Feather's roof.

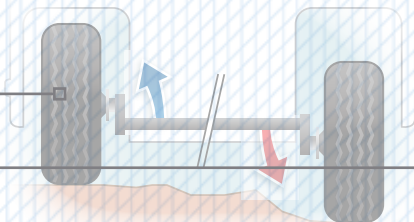

4

experience towability

THE INDUSTRY'S LEADING LIGHTWEIGHT

Boasting travel-friendly lengths, Jay Feather is towable by most SUVs, minivans and crossovers.* Complete with independent rubberized suspension and E-Z Lube axles, this legendary lightweight is a breeze to tow.

* Consult with your authorized automobile manufacturer or vehicle owner's manual; some models require a tow package.



JAY FEATHER SLX 18FDB | HARVEST



JAY FEATHER SLX 18FDB | HARVEST



JAY FEATHER SLX 18FDB | HARVEST



light AS A FEATHER

THE ALL-NEW 2014 JAY FEATHER SLX isn't just lightweight. It's our lightest Jay Feather yet. Weighing in under 3,275 pounds, Jay Feather SLX loads up on must-have features in a space-saving design that is towable by most minivans and crossovers.*

* Consult with your authorized automobile manufacturer or vehicle owner's manual; some models require a tow package.



JAY FEATHER SLX 18FDB | HARVEST



MINIVANS*

MAKE	MODEL	ENGINE
Honda	Odyssey	3.5L V-6
Toyota	Sienna**	3.5L V-6
Nissan	Quest	3.5L V-6
Kia	Sedona	3.5L V-6
Dodge	Grand Caravan**	3.6L V-6
Chrysler	Town & Country**	3.6L V-6



CROSSOVERS

MAKE	MODEL	ENGINE
Ford	Flex	3.5L V-6
Chevrolet	Traverse FWD/AWD**	3.6L V-6
GMC	Acadia**	3.6L V-6
Toyota	4Runner	4.0L V-6

* Tow rating matches the GVWR of the 16XRB and 18FDB models only
 ** Towing package required



JAY FEATHER X23B | TRUFFLE



JAY FEATHER X213 | BRICK



JAY FEATHER X23B | TRUFFLE



expand ON COMFORT

THE 2014 JAY FEATHER is brimming with high-end features — so many, in fact, most of the 2014 Jay Feather lineup is now expandable. Effortless tent setup, room-making slideouts and select model bunk beds create the space your family needs in a legendary, lightweight design.

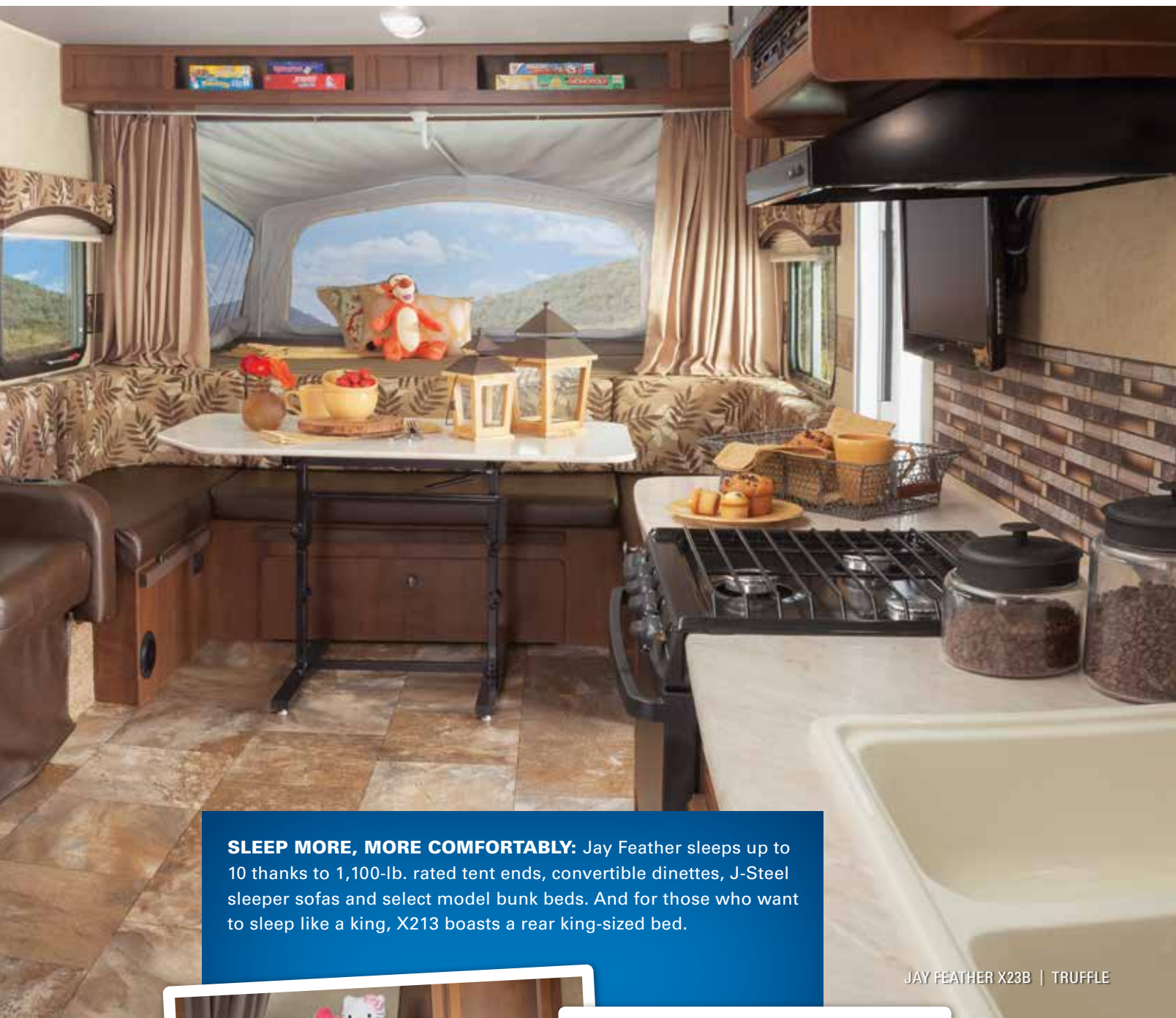

SLEEP MORE, MORE COMFORTABLY: Jay Feather sleeps up to 10 thanks to 1,100-lb. rated tent ends, convertible dinettes, J-Steel sleeper sofas and select model bunk beds. And for those who want to sleep like a king, X213 boasts a rear king-sized bed.

JAY FEATHER X23B | TRUFFLE



JAY FEATHER X213 | BRICK



JAY FEATHER X213 | BRICK

Superior craftsmanship starts at the top at Jayco

We've built a reputation for superior construction and quality craftsmanship.

We pride ourselves on always using top-quality materials and innovative manufacturing techniques. That commitment has led to one of our latest construction advancements, the exclusive Magnum Truss Roof System. Fifty percent stronger than other roofs in the industry, this Jayco roof is built to weather Mother Nature.

OUR ROOF FEATURES ...

- 1 4 1/2" crowned wood trusses: Uses 2"x 2" vertical studs to maximize load capacity, while oversized nail plates provide a tighter design
- 2 3/8" roof decking, screwed down at every seam: More durable than typical stapled construction, provides a fully walkable roof
- 3 Residential attic-style insulation: Helps maintain interior temperatures
- 4 One-piece, sidewall-wrapped Alpha Ply material: Provides leak protection



50% STRONGER

TO LEARN MORE ABOUT OUR MAGNUM TRUSS ROOF SYSTEM, SCAN HERE ►



WALL CONSTRUCTION

- 5 Vacuum-bonded layers: Involves 15-18 minutes of 144 tons of pressure to ensure a strong bond
- 6 Welded aluminum frames with metal backers: Lighter than wood, increases towability
- 7 Extra-wide corner seals: Prevents leaks on corner molds, baggage/entrance doors and window seals
- 8 Innovative, aerodynamic front profile: Eliminates angle, increasing towability

FLOOR CONSTRUCTION

- 9 Vacuum-bonded layers: Backed by computer monitoring and constant quality control checks, Jayco prides itself on building a solid foundation
- 10 Bead-foam insulation (R-9): Maintains interior temperatures
- 11 Norco NextGen frame: Features industry's strongest strength-to-weight ratio thanks to high-strength, low-alloy sheet steel, huck bolts and interlocking design
- 12 Innovative A-frame: Fully integrated, and not welded, prevents buckling

TENT DESIGN

- 13 Reversed cambered-support: Creates durable structure rated to hold 1,100 lbs.
- 14 Hook tent frame: Creates more headroom than competing tents
- 15 5" bed mats: Provide comfort
- 16 DuraTek water-repellent vinyl tent material: Resists mildew, mold, scratches and cracks; double-stitched design adds strength
- 17 Permanent tent-to-bunk attachment system with channel locks: Eliminates misplaced poles, using Velcro system

JAYCO'S ROOF



OTHER ROOFS

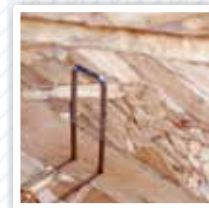

SCREWED CONSTRUCTION VS. STAPLED



OVERSIZED NAIL PLATES VS. SMALLER PLATES



2" X 2" VERTICAL WOOD STUDS VS. 1" ALUMINUM

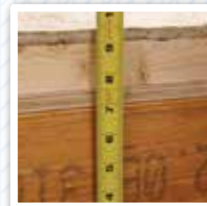

7" HEADER BEAM VS. 2" X 6" LUMBER



4,500 LBS. ON A JAYCO ROOF VS. OTHER ROOFS

STANDARDS AND OPTIONS

JAY FEATHER SLX

STANDARD EXTERIOR EQUIPMENT

TuffShell vacuum-bonded laminated sidewalls, front and end walls
Vacuum-bonded laminated tent ends with reverse-cambered support (expandables)
Deluxe graphics package with Slate Gray exterior fiberglass color
Magnum Truss Roof System
One-piece seamless Alpha Ply roof material
Box tube style frames with integrated A-Frame
Amber patio light with interior switch
Patio awning (select models)
Heavy-duty entrance step with no-slip treads
G20 dark-tinted windows
E-Z Lube axles
Radial tires
Galvanized-steel, impact-resistant wheel wells
Front diamond plate
Double-wide corner mold extrusions
Radius-cornered entrance and baggage doors
DuraTek water-repellent, scratch-resistant vinyl tent material with zipper windows (expandables)
Painted shepherd's hook tent frame (expandables)
Permanently attached tent-to-bed base design (expandables)
Self-supporting, lockable tent ends with 1,100-lb. capacity (expandables)
30-amp service

STANDARD INTERIOR EQUIPMENT

Screwed-and-glued cabinetry
Ball bearing drawer guides, 75-lb. capacity with full extension
2-burner cooktop range with range hood
High-definition laminate countertop with rounded bull-nosed edging
Acrylic sinks with metal plumbing fittings
Plywood dinette, bunk and bed bases
4" high-density, reversible dinette cushions
Diamondflor vinyl flooring
8,000-BTU side-mounted A/C
5" tent bunk mats (expandables)
Bathroom roof vent
Bath skylight

CUSTOMER VALUE PACKAGE (MANDATORY)

4 cu. ft. Norcold refrigerator
6-gal. gas Atwood water heater
Patio awning
Microwave oven
Pleated shades
Range hood
Spare tire and carrier
AM/FM stereo with MP3 and iPod input
Water heater bypass

OPTIONS

13,500-BTU roof-mounted A/C

JAY FEATHER

STANDARD EXTERIOR EQUIPMENT

TuffShell vacuum-bonded laminated sidewalls, floors, front and end walls
Vacuum-bonded laminated tent ends with reverse-cambered support (expandables)
Deluxe Graphics Package with Slate Gray front and rear walls, slideout endwalls and 12" sidewall color band
.030 bottom radius metal skirting
Magnum Truss Roof System
One-piece seamless Alpha Ply roof material
Norco NextGen frame with integrated A-frame
Amber patio lights with interior switch
Entrance step and hitch light
Heavy-duty entrance step with no-slip treads
Patio awning (select models)
Marine-grade exterior speakers (2)
G20 dark-tinted windows
Aluminum rims
E-Z Lube axles
Radial tires
Galvanized-steel, impact-resistant wheel wells
Black ABS fenders
TorFlex independent torsion-axle suspension
Aerodynamic, rounded front profile
Front diamond plate
Double-wide corner mold extrusions
Radius-cornered entrance and baggage doors
Knuckle-hinge baggage doors
Electric-powered Schwintek slide systems (slide models only)
DuraTek water-repellent, scratch-resistant vinyl tent material with zipper windows (expandables)
Painted shepherd's hook tent frame (expandables)
Permanently-attached tent-to-bed base design (expandables)
Self-supporting, lockable tent ends with 1,100-lb. capacity (expandables)
Outside grill quick-connect port
Outside shower
Sewer hose storage compartment
Rubberized flexible propane lines
Stabilizer jacks with sand pads (4)
30-amp service

STANDARD INTERIOR EQUIPMENT

Wood-grain accent wall panels (select walls)
Screwed-and-glued cabinetry
Bead-board inserts (select overhead cabinets)
Ball bearing drawer guides, 75-lb. capacity with full extension
5 cu. ft. flush-mounted Norcold refrigerator (select models)
6.3 cu. ft. Norcold double-door refrigerator (select models)
3-burner range with 9,000-BTU SuperBurner and piezo igniter
Oven

High-definition laminate countertop with rounded bull-nosed edging
Deep single-bowl acrylic sink with high-rise faucet (select models)
Large 60/40 acrylic sink with high-rise faucet (select models)
Metal alloy faucet fittings
6-gal. gas/electric DSI Atwood water heater
Plywood dinette, bunk and bed bases
4" high-density, reversible dinette cushions
Diamondflor vinyl flooring
Pleated shades throughout with box valances
Cable/satellite hookups
AM/FM/DVD with MP3 and iPod hookups
6" high-density foam mattress with radius-corner bed bases (select models)
Pillowtop Denver Mattress with radius corners (221 and 228)
5" soft-quilt tent bunk mats (select models)
12V power port in tent ends
Full-height shirt wardrobes in front walk-around queen bedroom models
Bathroom roof vent
Bath skylight
Shower curtain with curved track (select models)

CUSTOMER VALUE PACKAGE

Aluminum rims
ABS bottle cover
Dual 20-lb. propane bottles with regulator
Spare tire with carrier
13,500-BTU air conditioner
Microwave
Water heater bypass

OPTIONS

Enclosed underbelly (n/a X17A, X17Z, 16V)
Suspension lift kit (2") (standard on 197)
Power Package: Electric awning with LED light and electric tongue jack (n/a X17A, X17Z, 16V)
Outside grill
Customer Value Package with 15,000-BTU A/C
Folding table with bench seat (X18D)
22" HDTV (select models)
Queen bed with bunk (197)
Tent end bed mat heaters (expandable models)

JAY FEATHER SLX INTERIOR DÉCOR

HARVEST



- 1 Sofa
- 2 Bedspread
- 3 Accent
- 4 Carpet

JAY FEATHER INTERIOR DÉCOR CHOICES

CHOCOLATE



TRUFFLE



BRICK



- 1 Sofa
- 2 Bedspread
- 3 Accent
- 4 Flooring

JAY FEATHER SLX FLOORPLANS

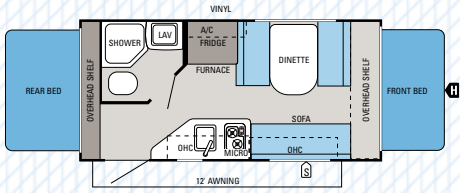

JAY FEATHER SLX | 16XRB

Ext. Length: 18' 4" Ext. Height: 117" Unloaded Wt. (lbs.): 2,575 Sleeps: 6-7

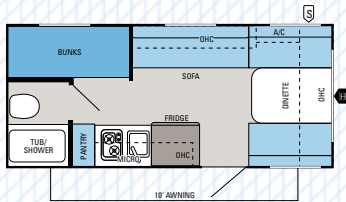

JAY FEATHER SLX | 18FDB

Ext. Length: 20' 6" Ext. Height: 117" Unloaded Wt. (lbs.): 2,625 Sleeps: 4-5

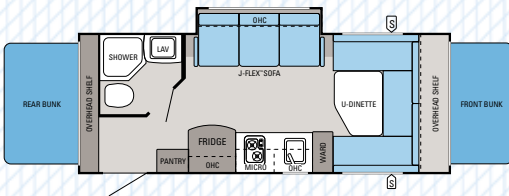

JAY FEATHER SLX | 19XUD

Ext. Length: 21' 10" Ext. Height: 117" Unloaded Wt. (lbs.): 3,275 Sleeps: 6-8

JAY FEATHER ULTRA LITE FLOORPLANS

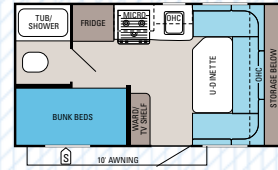

JAY FEATHER ULTRA LITE | 16V

Ext. Length: 18' 6" Ext. Height: 119" Unloaded Wt. (lbs.): 2,575 Sleeps: 3-4

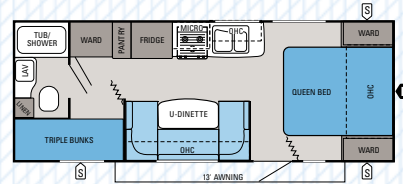

JAY FEATHER ULTRA LITE | 228

Ext. Length: 25' 11" Ext. Height: 120" Unloaded Wt. (lbs.): 3,785 Sleeps: 6-7

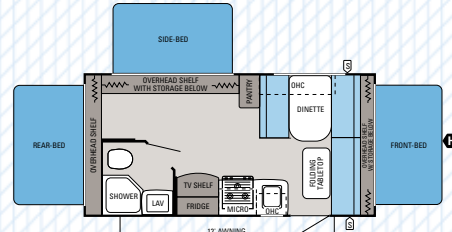

JAY FEATHER ULTRA LITE | X18D

Ext. Length: 20' 6" Ext. Height: 120" Unloaded Wt. (lbs.): 3,380 Sleeps: 7-8

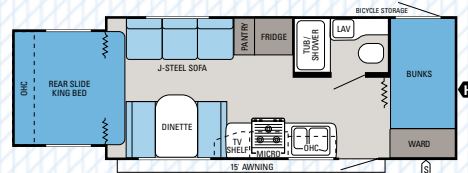

JAY FEATHER ULTRA LITE | X213

Ext. Length: 24' Ext. Height: 120" Unloaded Wt. (lbs.): 3,955 Sleeps: 6-8

JAY FEATHER SLX SPECIFICATIONS

FLOORPLAN	EXT. LENGTH	EXT. WIDTH	EXT. HEIGHT (WITH A/C)	INT. HEIGHT	UNLOADED VEHICLE WEIGHT (LBS.)	DRY HITCH WEIGHT (LBS.)	GROSS VEHICLE WEIGHT RATING (LBS.)	CARGO CARRYING CAPACITY (LBS.)	FRESH WATER CAPACITY (GAL.) (WITH WATER HEATER)	GRAY WASTEWATER CAPACITY (GAL.)	TOILET/BLACK WASTEWATER CAPACITY (GAL.)
16XRB	18' 4"	85"	117"	78"	2,575	315	3,500	925	26	15	9
18FDB	20' 6"	85"	117"	78"	2,625	385	3,500	875	26	15	9
19XUD	21' 10"	85"	117"	78"	3,275	373	4,250	975	26	15	9

The weights of certain options and/or option packages are not included in the UWW listed in the specification charts.

Unloaded Vehicle Weight (UWW): Sometimes referred to as "Dry Weight," UWW means the typical weight of this trailer as built at the factory. The UWW, as used in product literature and other promotional materials, does not include cargo, fresh water, propane, options or dealer-installed accessories.

Gross Vehicle Weight Rating (GVWR): GVWR means the maximum permissible weight of the trailer, including the UWW plus passengers, personal items, all cargo, fluids, options, and dealer-installed accessories. The GVWR is equal to or greater than the sum of the UWW and the CCC.

Cargo Carrying Capacity (CCC): CCC means the maximum weight of all passengers, personal items, food, fresh water, propane, tools, other cargo and dealer-installed accessories that can be carried by the trailer. CCC is equal to or less than GVWR minus UWW. The addition of options will decrease the CCC.

Hitch Weight (HW): The hitch weight, as used in product literature and other promotional materials, does not include cargo, fresh water, propane gas, options or dealer-installed accessories. The addition of these types of items will either add to or subtract from the stated hitch weight.

It is important for your safety and enjoyment that your tow vehicle be adequately sized and equipped to tow and handle the GVWR of the RV you select. Review weights and rating of your tow vehicle and consult a competent advisor for questions or advice. Whether you are new to RVing or a veteran, get a feel for the performance of your tow vehicle before heading out on the roadways. When you tow an RV, you must drive differently than when you drive a single vehicle. Practice hooking up, driving, backing up and braking in a safe environment or seek out professional instruction. Jayco affixes a weight label to each RV which lists weight information for that vehicle. See the specification chart above and to the right.

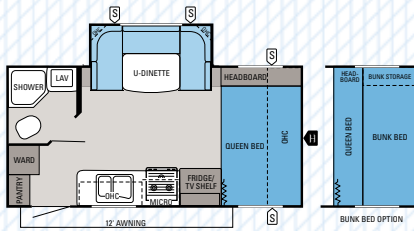

JAY FEATHER ULTRA LITE | 197

Ext. Length: 21' 2" Ext. Height: 123" Unloaded Wt. (lbs.): 3,610 Sleeps: 3-5

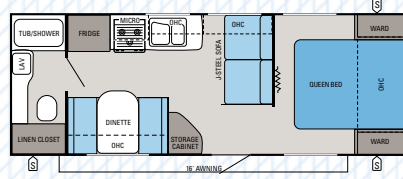

JAY FEATHER ULTRA LITE | 221

Ext. Length: 26' 3" Ext. Height: 120" Unloaded Wt. (lbs.): 3,775 Sleeps: 4-6

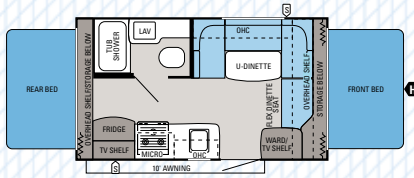

JAY FEATHER ULTRA LITE | X17A

Ext. Length: 18' 6" Ext. Height: 116" Unloaded Wt. (lbs.): 2,815 Sleeps: 5-6

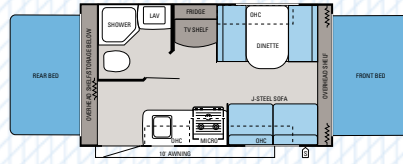

JAY FEATHER ULTRA LITE | X17Z

Ext. Length: 18' 6" Ext. Height: 117" Unloaded Wt. (lbs.): 2,810 Sleeps: 6-8

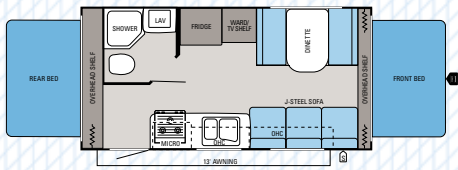

JAY FEATHER ULTRA LITE | X19H

Ext. Length: 20' 8" Ext. Height: 119" Unloaded Wt. (lbs.): 3,350 Sleeps: 6-8

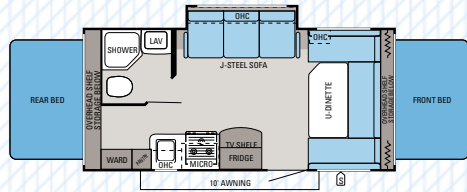

JAY FEATHER ULTRA LITE | X20E

Ext. Length: 21' 11" Ext. Height: 121" Unloaded Wt. (lbs.): 3,660 Sleeps: 7-8

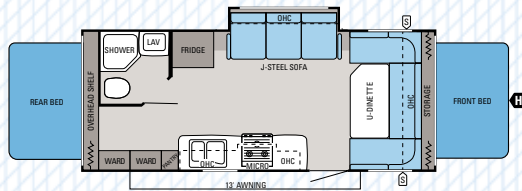

JAY FEATHER ULTRA LITE | X23B

Ext. Length: 24' 5" Ext. Height: 120" Unloaded Wt. (lbs.): 3,995 Sleeps: 7-8

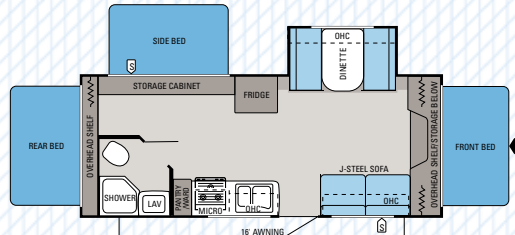

JAY FEATHER ULTRA LITE | X23F

Ext. Length: 24' 5" Ext. Height: 120" Unloaded Wt. (lbs.): 4,175 Sleeps: 8-10

JAY FEATHER SPECIFICATIONS

FLOORPLAN	EXT. LENGTH	EXT. WIDTH	EXT. HEIGHT (WITH A/C)	INT. HEIGHT	UNLOADED VEHICLE WEIGHT (LBS.)	DRY HITCH WEIGHT (LBS.)	GROSS VEHICLE WEIGHT RATING (LBS.)	CARGO CARRYING CAPACITY (LBS.)	FRESH WATER CAPACITY (GAL.) (WITH WATER HEATER)	GRAY WASTEWATER CAPACITY (GAL.)	TOILET/BLACK WASTEWATER CAPACITY (GAL.)
16V	18' 6"	96"	119"	78"	2,575	275	3,500	925	28.5	30.5	22.5
197	21' 2"	96"	123"	78"	3,610	620	4,750	1,140	28.5	30.5	22.5
221	26' 3"	96"	120"	78"	3,775	480	4,950	1,175	28.5	30.5	30.5
228	25' 11"	96"	120"	78"	3,785	350	4,950	1,165	28.5	30.5	22.5
X17A	18' 6"	96"	116"	78"	2,815	285	3,500	685	28.5	30.5	22.5
X17Z	18' 6"	96"	117"	78"	2,810	342	3,500	690	28.5	30.5	22.5
X18D	20' 6"	96"	120"	78"	3,380	400	4,600	1,220	48.0	30.5	22.5
X19H	20' 8"	96"	119"	78"	3,350	305	4,950	1,600	48.0	30.5	22.5
X20E	21' 11"	96"	121"	78"	3,660	370	4,750	1,090	48.0	30.5	22.5
X213	24'	96"	120"	78"	3,955	330	5,500	1,545	48.0	30.5	22.5
X23B	24' 5"	96"	120"	78"	3,995	395	4,950	955	48.0	22.5	22.5
X23F	24' 5"	96"	120"	78"	4,175	440	5,995	1,820	48.0	30.5	22.5

2-YEAR WARRANTY*

Peace of mind comes standard



Nobody offers a better warranty than Jayco. With our exclusive 2-year Co-Pilot Limited Warranty, the only strings we attach are those that deliver the ultimate in reliability. At Jayco, your peace of mind is our priority, and that's the Jayco difference.

*For a copy of our 2-year limited warranty with full terms and conditions, please contact your local Jayco dealer or visit Jayco.com.

300 JAYCO DEALERS

A four-decade strong network

From the sales experience to service after the sale, we consider our dealers to be an important part of the Jayco family. Establishing a solid relationship with your local Jayco dealer is a key component in the enjoyment of your new Jayco. By purchasing from a local dealer, you will have a convenient location for sales, parts and service support. We hope you consider them a part of your camping family.

Your local dealer

1-YEAR FREE

Roadside Assistance

Travel worry-free with Jayco's Customer First Roadside Assistance program, yours at no cost during your first year of ownership. This program is offered through Coach-Net, the country's largest RV emergency road service, and gives you immediate access to assistance.

Coach-Net
RV Technical & Roadside Assistance



Generations of family fun.

THE JAYCO STORY BEGAN IN 1968 WITH OUR FAMILY—THE BONTRAGERS. Lloyd Bontrager created an innovative, easy-to-use lifter system that led to a better fold-down camper. Loaded with more conveniences, he believed his camper would bring families closer together.

Since then, Jayco has helped generation after generation create family stories — good, old-fashioned family fun built around campfires with a Jayco RV nearby. At Jayco, we strive to build family-friendly products that will outlast just about everything but your memories. We'd love nothing more than to be a part of your family story. Join us in our generations of family fun.

eco advantage™

Jayco's long-term commitment to protecting the environment



Scan this QR code with your smartphone to watch a video about our efforts and the impact we're making on our planet.
jayco.com/ecoadvantage

Follow us on



Jayco, Inc., P.O. Box 460, Middlebury, IN 46540, www.jayco.com 

See dealer for further information and prices. All information in this brochure is the latest available at the time of publication approval. Jayco reserves the right to make changes and to discontinue models without notice or obligation. Photos in this brochure may show optional equipment and props for photography purposes. RVs built for sale in Canada may differ to conform to Canadian codes. ©2013 Jayco, Inc. 14-JFTR-PL 1013-100K. Printed in U.S.A.