

# Tango



Pacific  
Coachworks®



# Ultra Lite

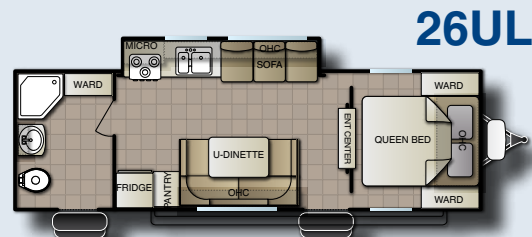
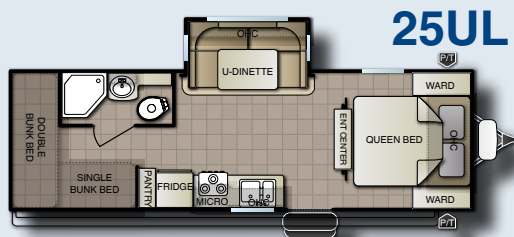
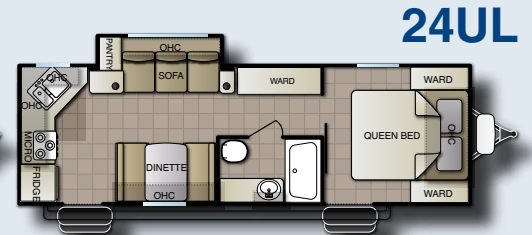
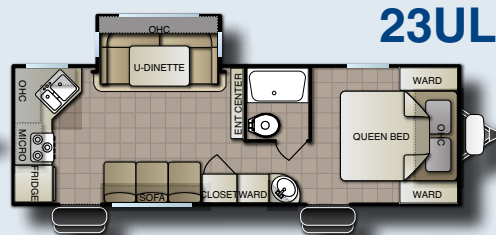
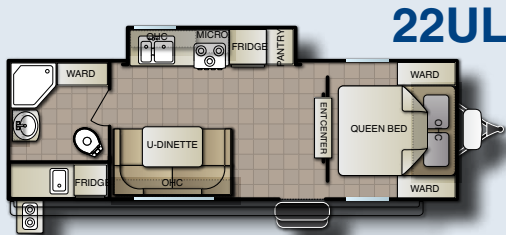
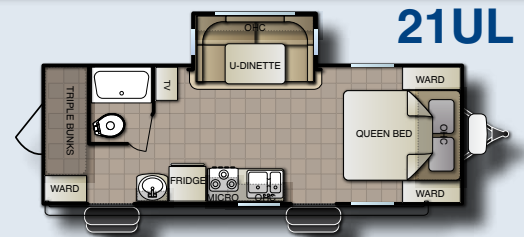
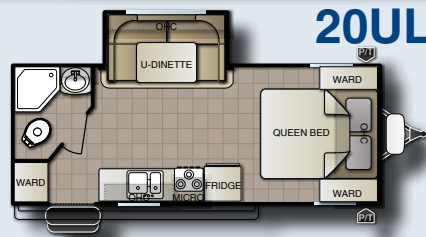
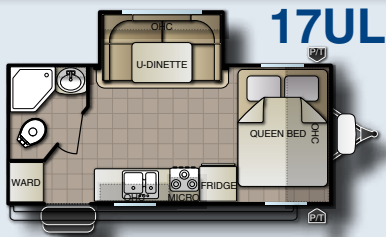

## Ultra Lite Specifications

MODEL	17UL	20UL	21UL	22UL	23UL	24UL	25UL	26UL
EXT LENGTH	21'-4"	24'-1"	25'-7"	23'-5"	27'-2"	28'-3"	27'-11"	27'-9"
EXT WIDTH	90"	90"	90"	90"	90"	90"	90"	90"
INT HEIGHT	78"	78"	78"	78"	78"	78"	78"	78"
GVWR	7,500	7,500	7,500	7,500	7,500	7,500	7,500	7,500
AXLE WEIGHT	3,580	3,880	4,000	3,900	4,190	4,400	TBD	TBD
HITCH WEIGHT	380	500	480	380	430	480	TBD	TBD
UVW	3,960	4,380	4,520	3,820	4,660	4,880	TBD	TBD
PAYLOAD	3,000	2,615	2,980	3,160	2,840	2,560	TBD	TBD
FRESH WATER	50 GAL	50 GAL	50 GAL	50 GAL	50 GAL	50 GAL	50 GAL	50 GAL
GRAY WATER	30 GAL	30 GAL	30 GAL	30 GAL	30 GAL	30 GAL	30 GAL	30 GAL
BLACK WATER	30 GAL	30 GAL	30 GAL	30 GAL	30 GAL	30 GAL	30 GAL	30 GAL

NOTES: Exterior Heights Do Not Include Air Conditioner. PCW reserves the right to change or discontinue at any time, without notice, prices, colors, materials, equipment, accessories, specifications, models, and packages, without incurring any obligations to make the same or similar changes to Tangos previously sold. Colors shown may vary due to reproduction and printing processes.

# Tow Lite



**21FBS**

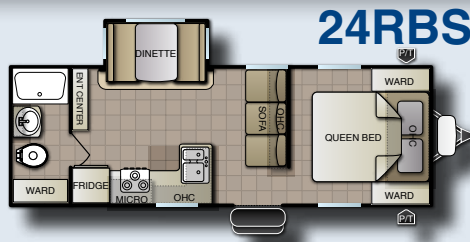

**24RBS**

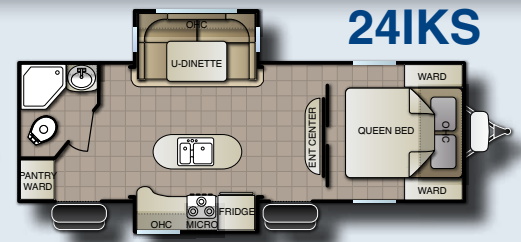

**24IKS**

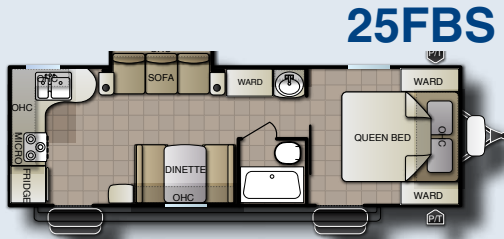

**25FBS**

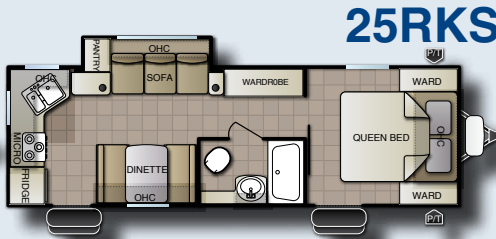

**25RKS**

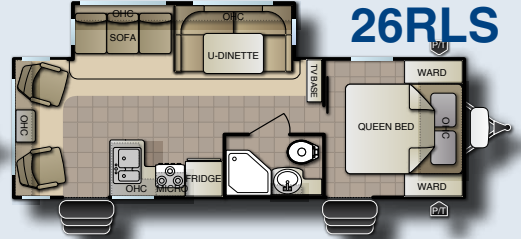

**26RLS**

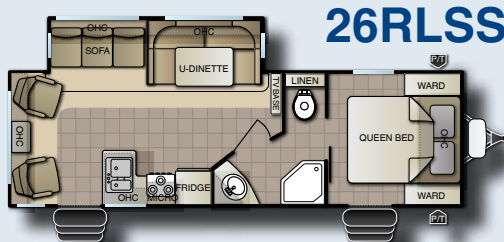

**26RLSS**

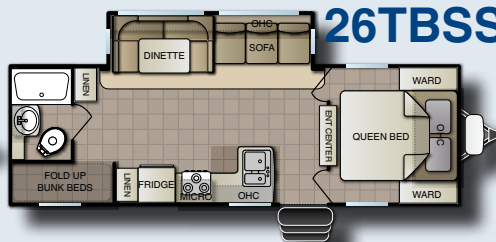

**26TBSS**

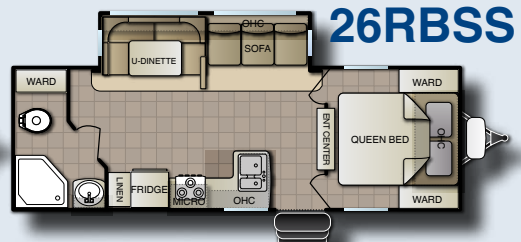

**26RBSS**

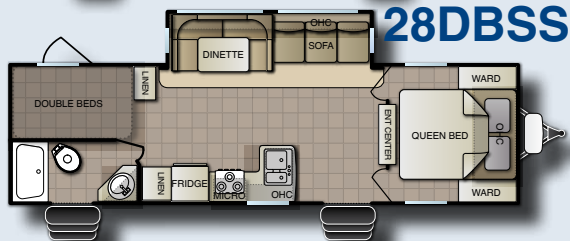

**28DBSS**



## Tow Lite Specifications

MODEL	21FBS	24RBS	24IKS	25FBS	25RKS	26RLS	26RLSS	26TBSS	26RBSS	28DBSS
EXT LENGTH	25'-9"	27'-6"	29'	29'-1"	28'-3"	29'-5"	29'-5"	28'-8"	29'-11"	31'-11"
EXT WIDTH	96"	96"	96"	96"	96"	96"	96"	96"	96"	96"
INT HEIGHT	78"	78"	78"	78"	78"	78"	78"	78"	78"	78"
GVWR	7,500	7,500	7,500	7,500	7,500	9,000	9,000	9,000	9,000	9,000
AXLE WEIGHT	4,380	4,900	5,090	4,980	5,000	5,390	5,350	5,350	TBD	TBD
HITCH WEIGHT	600	600	700	500	600	690	690	690	TBD	TBD
UVW	5,040	5,500	5,790	5,540	5,600	6,080	6,040	7,000	TBD	TBD
PAYLOAD	2,460	2,000	1,710	1,960	1,900	2,920	2,960	2,900	TBD	TBD
FRESH WATER	50 GAL	50 GAL	50 GAL	50 GAL	50 GAL	50 GAL	50 GAL	50 GAL	50 GAL	50 GAL
GRAY WATER	50 GAL	50 GAL	50 GAL	50 GAL	50 GAL	50 GAL	50 GAL	50 GAL	50 GAL	50 GAL
BLACK WATER	50 GAL	50 GAL	50 GAL	50 GAL	50 GAL	50 GAL	50 GAL	50 GAL	50 GAL	50 GAL

NOTES: Exterior Heights Do Not Include Air Conditioner. PCW reserves the right to change or discontinue at any time, without notice, prices, colors, materials, equipment, accessories, specifications, models, and packages, without incurring any obligations to make the same or similar changes to Tangos previously sold. Colors shown may vary due to reproduction and printing processes.



## TANGO ULTRA LITE FEATURES

### STANDARD FEATURES - EXTERIOR\*

- 6gal Gas DSI Water Heater
- Aluminum Frame Construction
- Awning - Manual
- Block Foam Insulation
- Custom Built I-Beam Chassis
- Electric Brakes on All Wheels
- Full Weld Outriggers and Entry Step
- Holding Tanks 50/30/30
- Laminated Fiberglass Exterior Walls
- Large Capacity Holding Tanks
- Outside Shower
- Seamless One Piece Rubber Roof
- Spare Tire & Carrier
- Stab Jacks (2) Rear
- TV Antenna with Cable Hook-Up

### STANDARD FEATURES - INTERIOR\*

- 78" Ceiling Height
- Air Conditioner 13.5 BTU
- Large Double Door Refrigerator
- Microwave Oven
- Power Bath Vent
- Skylight Bath
- Stereo AM/FM/CD/DVD
- Three (3) Burner Cooktop w/ Oven
- Tub Surround
- Upgraded Appliances
- Upgraded Floor Covering

## TANGO TOW LITE FEATURES

### STANDARD FEATURES - EXTERIOR\*

- Aluminum Frame Construction
- Awning - Electric
- Custom Built I Beam Chassis
- Dual LPG Bottles w/ Cover
- DSI Water Heater
- Electric Brakes on All Wheels
- Full Weld Outriggers and Entry Step
- Furnace - 30,000 BTU
- Holding Tanks 50/50/50
- Outside Shower
- Radius Entry Door w/ Assist Handle
- Spare Tire & Carrier
- Stab Jacks (4)
- TV Antenna w/ Cable Hook-Up

### STANDARD FEATURES - INTERIOR\*

- A/C 13.5 BTU - Ducted
- Front Diamond Plate Metal
- Furnace - 30,000 BTU
- Glass Tub/Shower Door
- Laminated Counter Tops w/ Edge
- Large Double Door Refrigerator
- Large Oven w/ Cook Top
- Microwave Oven
- Power Bath Vent
- Skylight Bath
- Stereo AM/FM/CD/DVD
- Tub Surround Upgraded Floor Covering

## OPTIONS

### POPULAR OPTIONS\*

- A/C 15.0 BTU Upgrade
- Awning - Power
- Aluminum Wheels (4)
- Chrome Wheels (4)
- Exterior Ladder
- Exterior Swing Out Handle
- Front Window w/ Rockguard
- Shades IPO Blinds Galley & LR
- Sani-Flush Black Tank
- Sink Covers - Galley
- TV LCD 24"
- TV LCD 32"
- Thermal Dual Pane Windows

### MAPLE LEAF PACKAGE\*

- Upgraded Floor Covering
- Heated & Enclosed Tanks
- Winterizing Kit

\*Some Features, Packages and Options are not available on all models. Please consult your local sales representative for more information. NOTE: All Pacific Coachworks recreational vehicles are sealed with Sealtech



**Pacific Coachworks**  
549 Rivera St.  
Riverside, CA 92501  
[www.pacificcoachworks.com](http://www.pacificcoachworks.com)  
(951) 686-7294

contact your local dealer

We are committed to providing the highest quality travel trailers, fifth wheel units, and toy haulers at an unsurpassed value. We are dedicated to establishing lasting partnerships with trusted RV dealers, vendors, and suppliers, all of which are equally committed to conducting business with your best interests in mind. The Pacific Coachworks team is focused on exceeding customer expectations by providing the highest level of customer support and service.

All information included in this brochure is the latest at the time of publication. Pacific Coachworks reserves the right to make changes and to discontinue models without notice or obligation. Photos in this brochure may show optional equipment or props used for photography purposes only. All recreational vehicles built by Pacific Coachworks, Inc. include a one year factory warranty. Roadside Assistance via Coach-Net is also included.