

CAMP WITH THE BEST.

# SIERRA SELECT



20<sup>th</sup> Annual RVDA DEALER  
SATISFACTION INDEX  
AWARD WINNER



SIERRA  
SELECT

TRAVEL TRAILERS AND FIFTH WHEELS







329RE

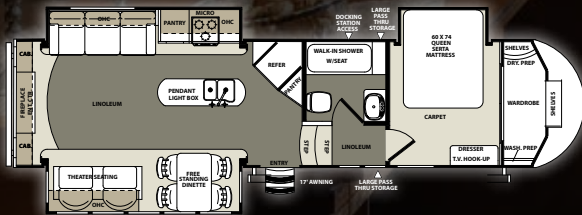

MOCHA INTERIOR



***SIERRA Select by Forest River.***  
*All the great features you*  
*desire in an RV, including an*  
*affordable price.*

With the **SIERRA** series you will experience the pride of ownership. And who wouldn't be proud to own the **SIERRA 329RE**, this fifth wheel floorplan will provide you with effortless living on the road. From the ground up this **SIERRA** floorplan is the finest in spacious, luxurious living. It has been engineered and decorated for residential style and comfort. Take a look, the room layouts, the rich fabrics, the quality furniture and carpeting, and all of the built-ins are coordinated to create a symphony of elegance. This is custom crafted quality at the peak of perfection. The kitchen is well designed with plenty of storage. The living area is large, bright and comfortable. This floorplan, like all floorplans in the **SIERRA** series, provide you with a great value without a sacrifice in quality, comfort, or amenities. **SIERRA** is the only name you need to know in Recreational Vehicles.







*Camping has never been so easy or comfortable as it is with the SIERRA series. Our attention to detail has left nothing to chance.*

Welcome to the **SIERRA 30IOK**, this is truly a great fifth wheel design. No detail has been overlooked in bringing you the comfort and convenience of home in this beautiful RV. The rooms are open and airy with large panoramic views that shower you in an abundance of natural light. The kitchen is a model of modern efficiency with residential quality and styling. Elegant touches like residential countertops, high rise faucet and raised panel cabinet doors will add to the ambiance of your culinary experience. High end convenience at affordable prices, the **30IOK** as with all **SIERRA** products is built with the quality and attention to detail you deserve.







CASHEW INTERIOR

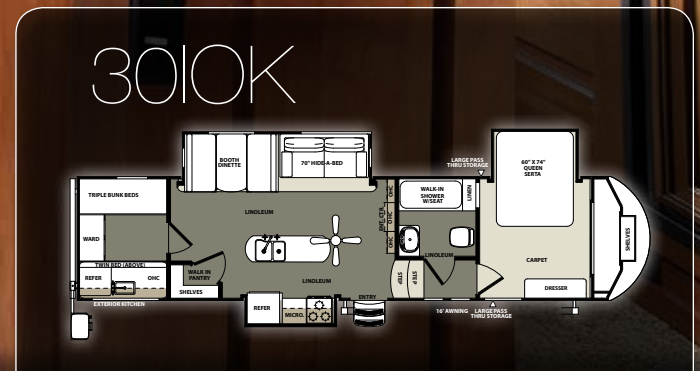



# SIERRA SELECT CONSTRUCTION

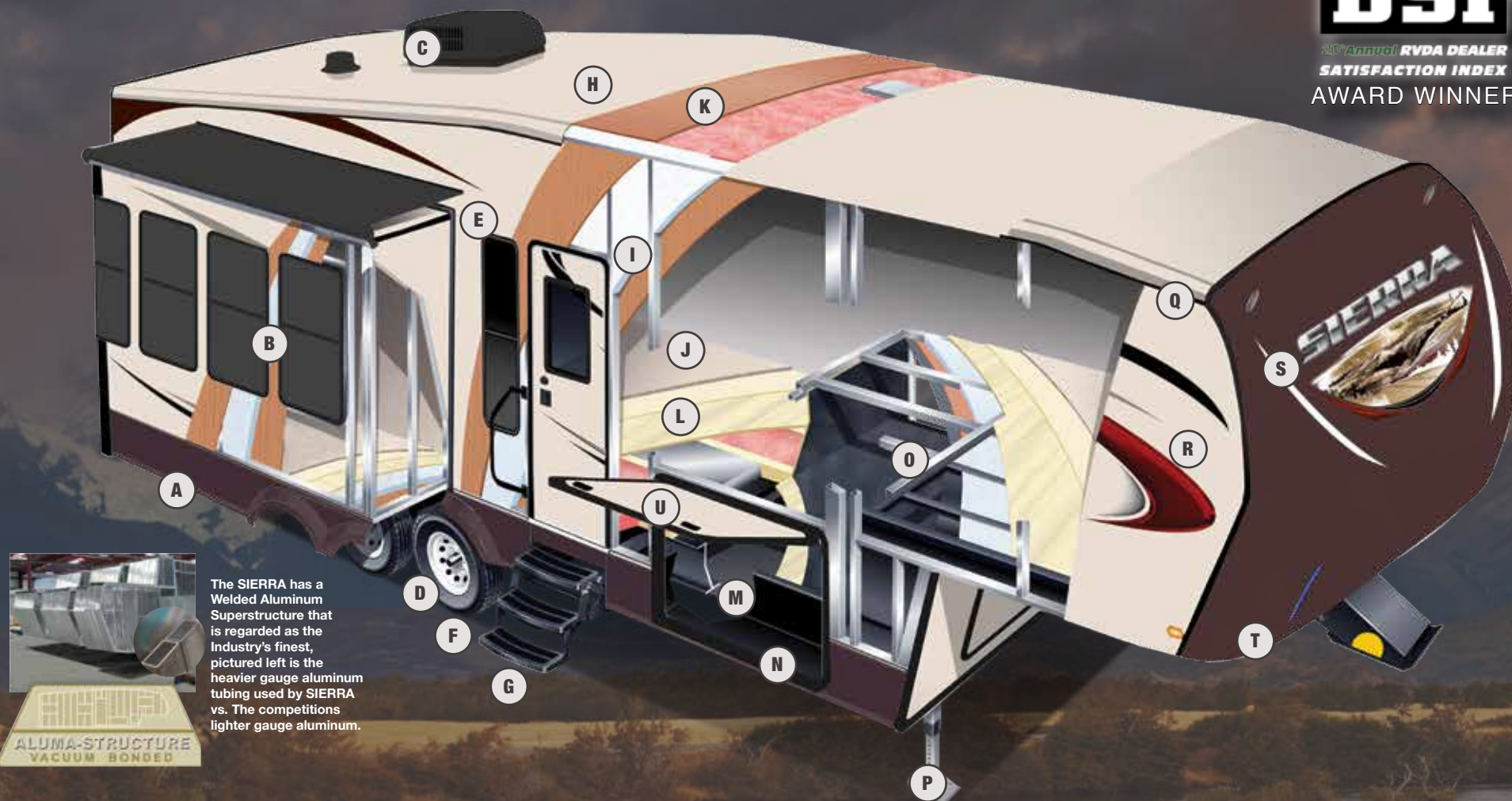

The SIERRA has a Welded Aluminum Superstructure that is regarded as the Industry's finest, pictured left is the heavier gauge aluminum tubing used by SIERRA vs. The competitions lighter gauge aluminum.

- A. ROLLED ALUMINUM SIDED SKIRTING
- B. SAFETY GLASS TINTED WINDOWS (80%)
- C. DUAL ZONE DUCTED 15K BTU AIR CONDITIONING
- D. DEXTER AXLES WITH SELF ADJUSTING BRAKES
- E. LAMINATED VACUUM BONDED ALUMINUM SIDEWALLS
- F. E RATED RADIAL TIRES
- G. HICKORY SPRINGS™ RADIUS ENTRY STEPS
- H. COLOR MATCHED SEAMLESS RUBBER ROOF (12 YR. WARRANTY)

- I. BLOCK FOAM INSULATION
- J. SHAW R2X STAIN RESISTANT CARPET W/ PADDING
- K. 3/8" ROOF DECKING (FULL WALK-ON ROOF)
- L. 5/8" TONGUE AND GROOVE PLYWOOD FLOORING
- M. ENCLOSED HEATED UNDERBELLY
- N. I-BEAM POWDER-COATED FRAME W/ RUST INHIBITOR
- O. ALUMINUM LAMINATED INSULATED BATH DECK
- P. POWER FRONT JACKS WITH QUICK

- RELEASE SNAP PINS (HYDRAULIC JACKS OPTIONAL)
- Q. SLEEK RADIUS ROOF
- R. COLOR MATCH FIBERGLASS EXTERIOR
- S. PAINTED GEL-COAT FIBERGLASS FRONT CAP (STANDARD)
- T. IMPROVED FRONT CAP FOR SHARPER TURNING RADIUS
- U. INSULATED SLAM LOCK BAGGAGE DOORS



# STANDARDS/OPTIONS/DECORS

## EXTERIOR FEATURES

- Painted Aerodynamic fiberglass front cap with LED light strips (5<sup>th</sup>'s)
- Colored exterior fiberglass
- Enclosed and heated dump valves
- Docking station: easy winterization, hot and cold spray port, black tank flush, pull valves for tanks
- Large tinted windows with 80/20 UV prohibitor
- Dexter axles with self adjusting brakes
- Hickory Springs™ radius triple steps with 9" riser (no pinched fingers)
- Dometic™ "One-Touch" electric awning with adjustable arms and LED strip light
- Power front jacks with spring loaded snap pins (fifth wheels)
- 15" Radial tires (TT), 16" (5<sup>th</sup>'s)
- Automotive-style fender skirts
- Hitch light - Travel Trailers
- Dual LED lights (5<sup>th</sup>'s)
- Porch light with interior switch
- 30 lb. double LP tanks with auto change over
- Black tank flush
- 2 exterior speakers
- Rain gutters with extra long drip spouts (prevents black streaking)
- Insulated heavy duty slam lock baggage doors
- Exterior folding grab handle
- Unobstructed pass-through Storage area with cable jacks and 110V outlet (5<sup>th</sup>'s)
- 2 spray ports with 25' hose (one on each side)
- Outside kitchen with swing arm grill standard on 30Z, 30IOK, 30ZIP, 32QBBS

## INTERIOR FEATURES

- 84" interior height with 6'4" slide heights (5<sup>th</sup>'s)
- Solid surface kitchen countertops
- Four color coordinated interiors
- Raised panel refrigerator insert
- Full extension ball bearing drawer glides
- Serta® memory foam mattress
- Stone cast under mounted kitchen sink
- Handmade cabinetry with screwed Lumber core stile construction and brass hardware

- Designer slideout fascia
- Extra large picture windows Throughout
- Vented side windows in slideouts
- Digital TV antenna with booster
- 32" Flatscreen LED/HD TV
- Premium sound system
- Solid wood drawer fronts with pine sides
- Raised panel cabinet doors
- Bedroom slideout fascia
- Shower with glass door (where available)
- Designer window treatment accented per decor
- Overhead cabinet in slideout
- Ceiling fan (5<sup>th</sup>'s)
- Upgraded decorative lighting throughout (Recessed LED's 5<sup>th</sup>'s)
- Shaw R2x stain resistant carpeting
- Center mounted A/C unit for even cooling
- Quilted bedspread
- Shower surround with etched tile pattern
- Tile pattern Beauflor linoleum

## APPLIANCES/SYSTEMS

- Ducted Dometic® 15K A/C with quick cool
- SIERRA command center for switches
- Floor ducted 35,000 BTU furnace
- Three burner High output range w/ 22" oven
- Double door refrigerator
- Interior monitor panel for holding tanks
- Interior digital thermostat for heating and cooling
- Flush floor slideouts (per floorplan)
- Satellite and cable hookup with RG-6 cable for high quality picture
- Porcelain foot flush toilets
- Water heater with quick recovery

## CONSTRUCTION

- Welded aluminum-framed, vacuum Bonded laminated superstructure
- 3/8" roof decking (full walk-on roof)
- Cambered powder coated frame with rust prohibitor
- Fully enclosed, heated underbelly
- 5" truss roof rafters
- R-10 sidewall insulation

## FOR YOUR SAFETY

- Smoke alarm
- Fire extinguisher
- Breakaway switch (battery hook-up required)
- Dead-bolt lock on entry door
- Liquid propane (LP) gas detector
- Fire escape windows

## POPULAR OPTIONS

- Free-standing dinette with 4 chairs
- Roof ladder
- 50 Amp service (travel trailers)
- Spare tire kit
- Plank wood pattern Beauflor linoleum

## SIERRA SELECT SIGNATURE PACKAGE (Mandatory option)

- 50 Amp service w/2nd AC prep (5<sup>th</sup>'s)
- Serta memory foam mattress
- 15K BTU air conditioner
- Porcelain foot flush toilet
- Safety glass windows - 80% tint (5<sup>th</sup>'s)
- High rise faucet
- Designer window shades
- Premium surround sound system "One Touch" Dometic electric awning w/LED lights
- 8 cu. ft. refer with oak insert
- Full walk on roof
- 32" Flat screen television
- Undermount sink
- Jensen AM/FM CD/DVD player w/ bluetooth
- Aerodynamic front cap (5<sup>th</sup>'s)
- Fantastic fan in bathroom
- Designer tile Beauflor™
- Tri-fold hide-a-bed
- Aluminum wheels



## DESIGNER DECORS

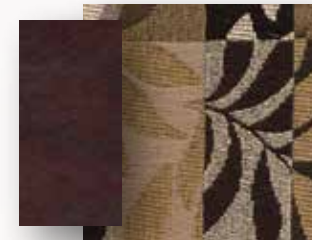

MOCHA INTERIOR



CASHEW INTERIOR



JAVA INTERIOR



CHOCOLATE INTERIOR



# GREAT CAMPING DESERVES GREAT FEATURES

## INTERIOR FEATURES



High rise faucet with undermount stonecast sink.



Relax in comfort in a La-Z-Boy rocker recliner. (Optional)



Optional theater seats.



Full extension ball bearing drawer guides.



The fireplace warms and is a great focal point for the living area.



SIERRA's command center allows you to monitor tanks and other systems quickly and easily.



Jensen AM/FM/CD/DVD stereo comes standard in the SIERRA.



Contemporary ceiling fan.



Your guests will sleep in total comfort on our Trifold hide-a-bed couch. When it's not being used for sleeping it's a perfect place to sit back and relax.



Serta™ Memory Foam mattress is a Forest River exclusive feature.



Contemporary light fixtures in bathroom.



## EXTERIOR FEATURES



The color matched fiberglass front cap features high definition graphics and LED safety lights. (FW only)



Drip rail displaces water to eliminate black streaking.



Large pass-thru storage area with Slam Lock baggage doors allows for extra storage underneath.



SIERRA's convenient outside lighted docking station.



2 quick connect spray ports (one on each side) are perfect for easy clean up.



Optional under mount exterior storage bin keeps commonly used items close at hand.



Contemporary aluminum rims with E-rated radial tires. All SIERRA's feature 6000 Lb. axles. (5th's)



Heated and enclosed underbelly protects your coach and improved airflow allows for a sturdier ride.



The outdoor kitchen is a great feature that allows you to cook a great meal or grab a cold drink while enjoying the great outdoors. (Select models)



Wide stance power front jacks. (Optional hydraulic jacks shown, 14 times faster than electric jacks.)



SIERRA's "ICEBOX" is a quick and easy way to grab a snack and cold beverage without entering your unit.



# SIERRA SELECT

All units are professionally crafted to give you true camping comfort and an incredible value.

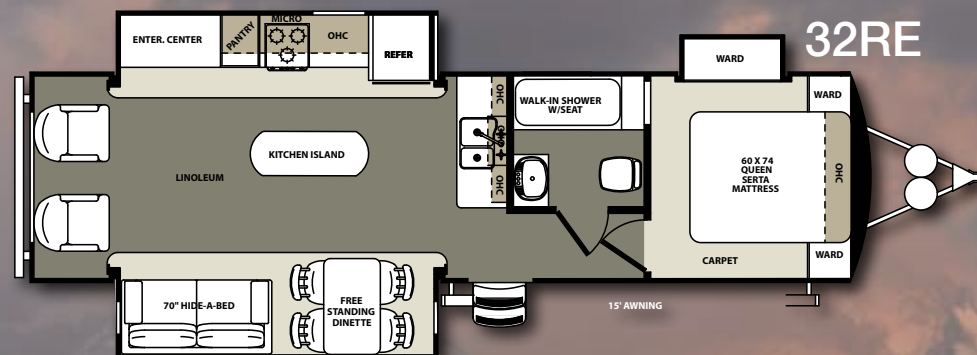
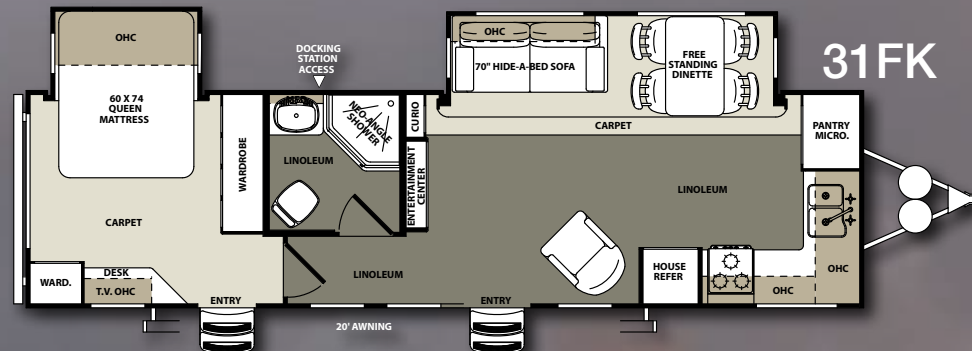
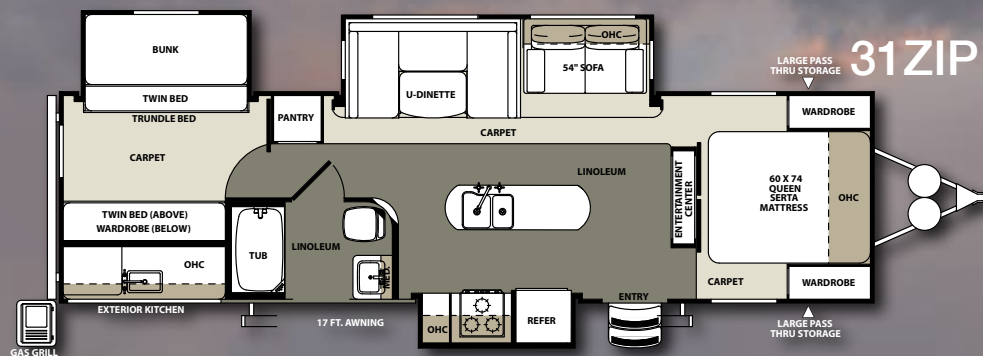

## TRAVEL TRAILER SPECIFICATIONS

Model	31FK	31ZIP	32RE
Hitch Weight	1,213	871	1,055
Ship Weight	7,745	8,887	9,100
GVWR	11,373	12,871	11,215
Cargo	3,628	3,984	2,056
Length	34'6"	34'5"	35'10"
Height	11'9"	11'9"	11'9"
Awning Size	20'	21'	15'
Gray Tank (cap)	62	86	108
Black Tank (cap)	31	54	54
Fresh Tank (cap)	43	60	43



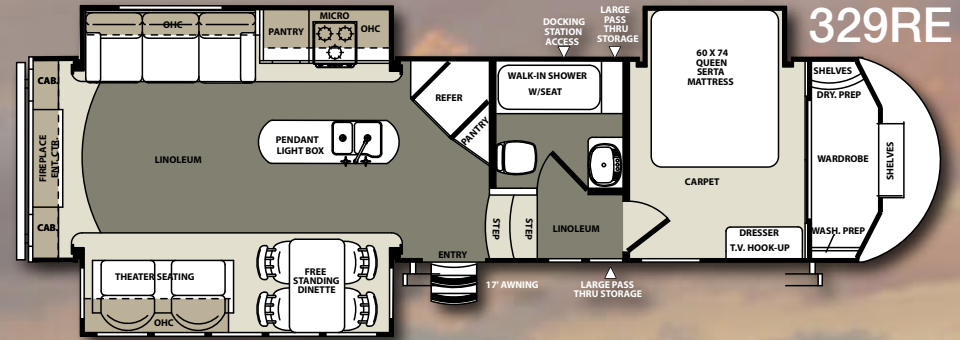
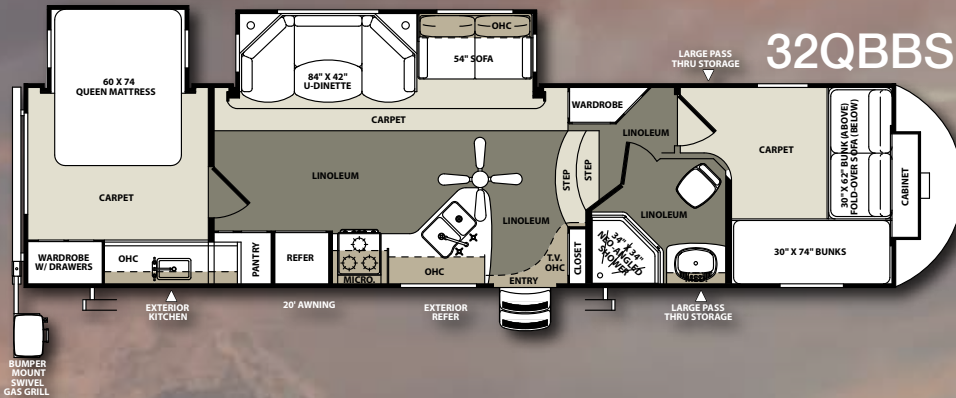
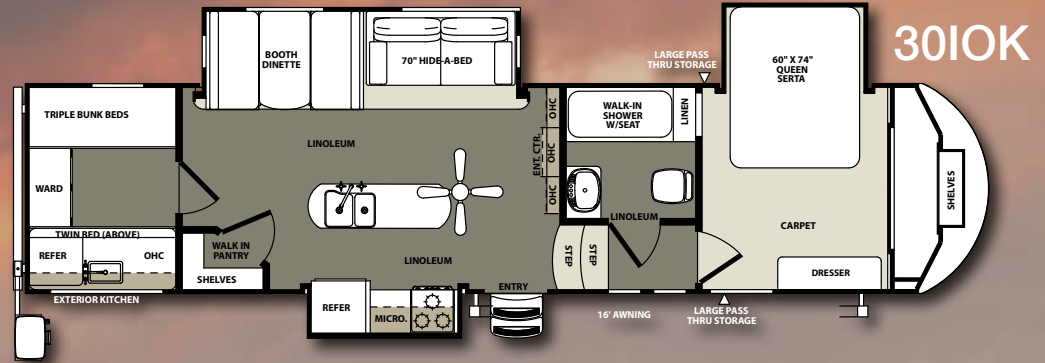
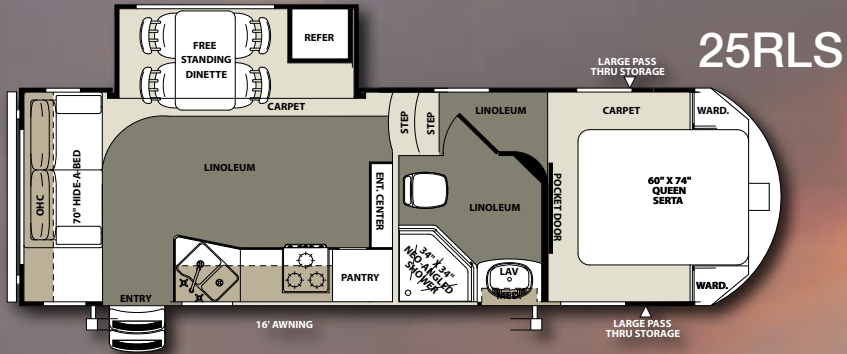

## FIFTH WHEEL SPECIFICATIONS

Model	25RLS	30IOK	32QBSS	329RE
Hitch Weight	1,472	1,930	1,896	1,899
Ship Weight	7,526	10,472	9,000	9,996
GVWR	13,472	13,930	13,896	13,899
Cargo	5,946	3,503	4,896	3,844
Length	29'0"	37'11"	36'11"	36'3"
Height	12'6"	12'6"	13'0"	13'0"
Awning Size	18'	16'	20'	17'
Gray Tank (cap)	32	81	62	89
Black Tank (cap)	32	54	31	54
Fresh Tank (cap)	43	43	43	43





# SIERRA SELECT



## PRE-DELIVERY INSPECTION FACILITY

20,000 square feet of quality assurance. The bare essentials for a premium product. This state-of-the-art facility gives immediate daily feedback to production for quality assurance in every unit built.



Forest River, Inc. encourages our customers to purchase their Forest River products from a local dealership whenever possible for the following reasons:

It is the goal of Forest River, Inc. that all of our RV owners fully enjoy the RV experience and that customer satisfaction meets or exceeds their expectations!

- 1) Forest River, Inc. dealers are independently owned and operated businesses so priority service and scheduling is at their discretion and is often provided to customers that purchased their unit at that dealership.
- 2) Purchasing locally allows customers to establish meaningful relationships with a dealer, enhancing the RV experience through assistance with product questions, user tips or RV regulations for your state or country, and much more!
- 3) Canadian customers must meet requirements to bring an RV purchased out of the country to their home. These requirements may involve additional inspections and certifications, taxes and fees. Your local Canadian Dealer is a professional at meeting these requirements.
- 4) Scheduling timely warranty repairs and adjustments through a local dealership provides far greater flexibility and convenience to you, the customer!

**FREE MEMBERSHIP**  
to Forest River Owners' Group

[www.forestriverfrog.com](http://www.forestriverfrog.com)



## 24/7 EMERGENCY ROADSIDE ASSISTANCE

For a worry-free ownership experience

Forest River includes one year of Coach-Net RV Technical & Roadside Assistance with each RV purchase. Whether new to the RV lifestyle or an experienced RV enthusiast, Forest River owners have 24/7 access to technical, operational and emergency road service coverage throughout the US & Canada. Coach-Net's fast, dependable service is just a phone call away.

**Coach-Net®**

YOUR SIERRA DEALER



## Learn More

Scan this barcode using a QR Reader on your smart phone to learn more about Forest River.



A Berkshire Hathaway company.

Forest River, Inc.  
2012 Century Dr.  
Goshen, IN 46528  
(574) 389-4600  
[www.forestriverinc.com/Sierra](http://www.forestriverinc.com/Sierra)  
[www.forestriveraccessories.com](http://www.forestriveraccessories.com)



All specifications herein are based on the latest product information at the time of printing. Forest River reserves the right to make changes in colors, materials, equipment and specifications at any time without notice and assumes no responsibility for any errors in this brochure. The photos in this brochure may show props and/or optional equipment. PLD418

© 2014- Sierra- a division of Forest River Inc.  
A Berkshire Hathaway company