



SIESTA
& SIESTA SPRINTER



SIESTA & SIESTA SPRINTER

SIESTA EQUALS MORE FIESTA.

MORE SPACE. MORE FEATURES. MORE
CONVENIENCE. MAKE THIS YOUR YEAR
WITH THE SIESTA.

DOOR CHOICES



VINTAGE MAPLE
SPRINTER ONLY



OLYMPIC CHERRY



VINTAGE MAPLE

INTERIOR CHOICES



CASHMERE LEAF



LUXURY RESORT



MILANO BROWN



24SA / LUXURY RESORT DECOR / OPTIONAL U-SHAPE DINETTE SHOWN



29TB / MILANO BROWN DECOR / OLYMPIC CHERRY WOOD

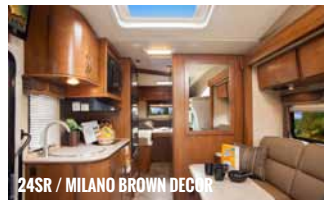

24SR / MILANO BROWN DECOR



29TB FORD DASH



SANDSCAPE



SANDSCAPE



SHADY CANYON



SHADY CANYON



BRONZE ALLOY HD-MAX™



BRONZE ALLOY HD-MAX™



MINERAL HD-MAX™



MINERAL HD-MAX™

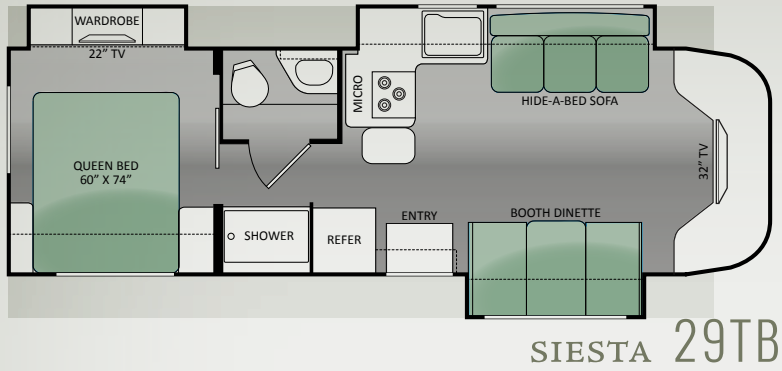

SIESTA 29TB

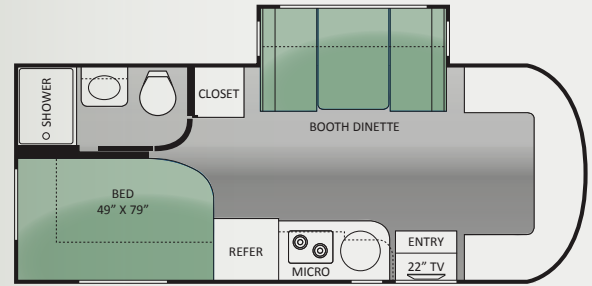

SIESTA SPRINTER 24SA

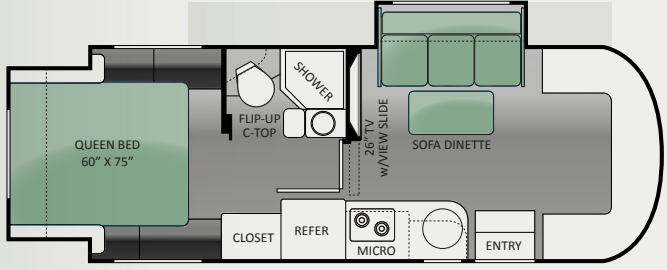

SIESTA SPRINTER 24SR

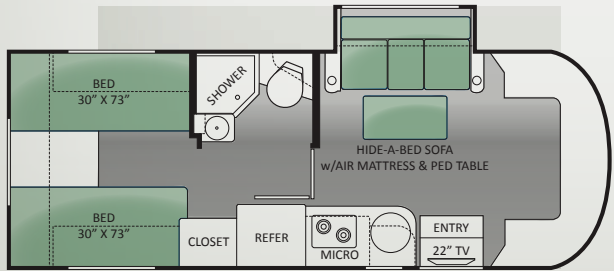

SIESTA SPRINTER 24ST

SPECIFICATIONS

SIESTA / SPRINTER	29TB	24SA	24SR	24ST
Chassis	FORD	SPRINTER	SPRINTER	SPRINTER
Gross Vehicle Weight Rating (GVWR)	14,500	11,030	11,030	11,030
Gross Combined Weight Rating (GCWR)	22,000	15,250	15,250	15,250
Wheel Base	220"	170.3"	170.3"	170.3"
Exterior Length (w/o ladder)	31'-7"	24'-6"	24'-10"	25'-9"
Exterior Height (w/ AC)	10' 7"	10' 10"	10' 10"	10' 10"
Exterior Width (w/o mirrors)	94"	90"	90"	90"
Interior Height	80"	80"	80"	80"
Awning Size (manual/electric)	22' / 15'	14' 6"	11'	11'
Fuel (gallons)	55	26.4	26.4	26.4
LPG (pounds)	40.9	68.2	68.2	68.2
Fresh / Grey / Waste Water (gal)	40 / 23 / 25	40 / 38 / 38	40 / 38 / 38	42 / 23 / 25
Water Heater (gallons)	6	6	6	6
Furnace (BTUs)	25,000	25,000	25,000	25,000
Exterior Storage Capacity (cu. ft.)	56.3	49.6	39	62.9



IMPORTANT-PLEASE READ: Information published within this brochure reflects product design, fabrication, material, components and specifications at the date of printing. If your vehicle was manufactured before this brochure was published this information may not be accurate because vehicles assembled before the brochure was published may not have the same design, fabrication, materials, components and specification as represented in the brochure. If your vehicle was manufactured after this sales brochure was published the representations may not be accurate because, for product improvement reasons, we reserve the unilateral right, at any time, without prior notice, to make changes in product design, material, components and specifications. The date the brochure was published (i.e. "Julian date") is set forth on the last page of the brochure. IF CERTAIN INFORMATION PUBLISHED WITHIN THIS BROCHURE IS SIGNIFICANT TO YOUR PURCHASING DECISION, PLEASE CONSULT WITH YOUR SELLING DEALERSHIP TO CONFIRM THAT THE INFORMATION IS ACCURATE WITH RESPECT TO THE VEHICLE YOU ARE CONSIDERING PURCHASING. Photographs in the brochure may depict optional equipment or may only be available in certain floor plans. We reserve the right to make changes in prices and models and to discontinue models without notice or obligation. Components, appliances and the chassis may have been manufactured in a calendar year before the vehicle's designated model year. All capacities are approximate. The actual length of the vehicle may differ from that indicated in the brochure due to variances in the manufacturing processes and/or installed components. All dry weights are based on standard model features and do not include optional features or equipment. Components, appliances and features may differ to conform to local codes. Due to EPA environmental restrictions, engine power and torque ratings may change during any model year. The Thor Motor Coach logo and its design are registered trademarks. Other products and company names are trademarks and/or registered trademarks of their respective manufacturer. While the color of the motorhome's exterior and the interior fabrics depicted in this brochure are fair and reasonable depictions, the colors depicted may not be exact match of the actual colors because of variances in photo processing and printing. Component part and appliance manufacturers issue limited warranties covering portions of the vehicle not covered under the limited warranty we issue. To learn specific details regarding warranty coverage please consult your selling dealership or review the warranty packet inside the vehicle.

STANDARD FEATURES & OPTIONS

SIESTA

CONSTRUCTION & EXTERIOR

- One-Piece Fiberglass Front & Rear Caps
- HD-Max™ Exterior with Graphics Package
- Mega-Storage Compartment
- Roto-Cast Storage Compartments
- Electric Patio Awning
- Roof Ladder
- Outside Shower

CONSTRUCTION & EXTERIOR OPTIONS

- Fully Automatic Hydraulic Leveling Jacks
- Full-Body Paint Package with Gel-Coat Sidewalls

AUTOMOTIVE & COCKPIT

- Touchscreen Dash Radio with CD Player & Back-up Monitor
- Heated/Remote Exterior Mirrors with Integrated Side View Cameras
- Leatherette Captain's Chairs
- Fiberglass Running Boards
- Valve Stem Extenders
- 5,000 lb Trailer Hitch with 7-pin Round Connector

AUTOMOTIVE & COCKPIT OPTIONS

- Spare Tire Kit
- Power Driver's Seat
- Wood Dash Applique

INTERIOR

- Residential Linoleum Throughout
- Olympic Cherry or Vintage Maple Cabinetry
- Vinyl Wrapped Booth Dinette with Dream Dinette Table Mechanism
- Leatherette Hide-a-Bed Sofa
- Night Shades

INTERIOR OPTIONS

- Child Safety Seat Tether Anchor in Dinette

KITCHEN

- Double Door Refrigerator
- 3-Burner High-Output Gas Cooktop with Cover
- 30" Over-the-Range Microwave
- Solid Surface Kitchen & Dinette Countertops
- Flip-up Countertop Extension
- Ball Bearing Drawer Guides

ENTERTAINMENT

- Front Entertainment Center with 32" Television and DVD Player
- 22" Television in Bedroom
- Coach Radio System with Exterior Speakers
- Satellite & Cable Television Prep

ENTERTAINMENT OPTIONS

- Exterior 22" Television

BEDROOM & BATHROOM

- Queen Size Denver Mattress Weekender
- Bedspread and Pillow Shams
- Shower with Glass Door

BEDROOM & BATHROOM OPTIONS

- 12-volt Attic Fan in Bedroom

ELECTRICAL & PLUMBING

- Onan RV QG 4000 Gas Generator
- Automatic Generator Transfer Switch
- 30 amp Service with Shore Line Power Cord
- 13,500 BTU Lo-Profile Air Conditioner
- Emergency Start Switch
- Auxiliary House Battery
- 6-gallon Gas/Electric Water Heater
- Black Tank Flush System

ELECTRICAL & PLUMBING OPTIONS

- Holding Tanks with Heat Pads
- Second Auxiliary Battery
- 15,000 BTU Lo-Profile Air Conditioner

SIESTA SPRINTER

CONSTRUCTION & EXTERIOR

- HD-Max™ Exterior with Graphics Package
- Side Hinged Slab Luggage Doors
- Roto-Cast Storage Compartments
- Electric Patio Awning
- Roof Ladder (N/A 24SR)
- Outside Shower

CONSTRUCTION & EXTERIOR OPTIONS

- Full Body Paint Package with Gel-Coat Sidewalls

AUTOMOTIVE & COCKPIT

- Touchscreen Dash Radio with CD Player & Back-up Monitor
- Deluxe Remote Exterior Mirrors
- Leatherette Captain's Chairs
- 5,000 lb Trailer Hitch
- Stainless Steel Wheel Liners
- Spare Tire

AUTOMOTIVE & COCKPIT OPTIONS

- Wood Dash Applique

INTERIOR

- Residential Linoleum Throughout
- Vintage Maple Cabinetry
- Electric Euro-Skylight
- Leatherette U-Shape Dinette (24SA Only)
- Night Shades

INTERIOR OPTIONS

- Leatherette Hide-a-Bed Sofa with Air Mattress and Pedestal Table (STD 24SR & 24ST)
- Child Safety Tether (24SA Only)

KITCHEN

- Double Door Refrigerator with Stainless Steel Door Inserts
- European 2-Burner High-Output Gas Range Top with Glass Cover
- Convection Microwave
- Solid Surface Kitchen Countertop (24SA)
- Solid Surface Kitchen Countertop & Sofa Table (24SR & 24ST)
- Ball Bearing Drawer Guides

ENTERTAINMENT

- 22" Television Over the Door with DVD Entertainment System (24SA & 24ST)
- 26" Television (Mid-ship) on Always-in-View™ Slide System with DVD Entertainment System (24SR)

ENTERTAINMENT OPTIONS

- Front Entertainment Center with 26" Television in Cab-Over (N/A 24SR)
- Front Cab-Over Cabinet (24SR Only)
- 22" Television in Bedroom
- 32" Exterior Television (24ST)

BEDROOM & BATHROOM

- Denver Mattress Weekender (24SA & 24ST)
- Queen Size Mattress (24SR)
- Bedspread & Pillow Shams
- Foot Flush Porcelain Toilet

BEDROOM & BATHROOM OPTIONS

- 12-volt Attic Fan in Bedroom (N/A 24SA)

ELECTRICAL & PLUMBING

- Onan RV QG 3600 LP Generator
- 30 amp Service with Shore Line Power Cord
- Automatic Shoreline-to-Generator Transfer Switch
- 6-gallon Gas/Electric Water Heater
- Water Heater Bypass System

ELECTRICAL & PLUMBING OPTIONS

- 3,000-watt Diesel Generator
- Second Auxiliary Battery
- Holding Tanks with Heat Pads (N/A 24ST)



SIESTA

SIESTA SPRINTER



P.O. BOX 1486 • ELKHART, IN 46515 • CUSTOMER SERVICE: 800-860-3812 • SALES DEPARTMENT: 800-860-5658 • SIESTA-RV.COM

COPYRIGHT THOR MOTOR COACH, INC. © 2013

