

IN REALITY, THE FUN WILL FIND YOU

# FUN FINDER





# THE MOST UPSCALE LOOK AND LIVING SPACE IN A LIGHTWEIGHT TRAVEL TRAILER



⌄ ABOVE: Model 233RBS has all the upscale features of a much larger camper, smartly engineered into a lightweight package. The spacious Island kitchen affords style, convenience and best use of space.

⌄ BELOW: The Fun Finder 233RBS combines three outstanding features not found on other lightweights: An Island kitchen, private bedroom with hard doors and a spacious bathroom with corner shower.





**SHOWER:** A luxurious radiused-glass corner shower door with skylight comes standard.

**SOFA:** The large U-dinette provides comfortable seating by day and spacious sleeping space at night. And notice the convenient, portable pull-out bin.



**GALLEY:** Solid surface countertops and an amazing amount of storage space in kitchens.



**BEDROOM:** Designed for your convenience including individual decorative reading lights.

**TV CABINET:** Swivel stand, DVD-CD-FM radio with bluetooth are all standard features. The TV shown is optional.

VISIT OUR WEBSITE FOR MORE **CRV**   
FIND A DEALER STARTING MSRP MORE DETAILS **CRUISERRV.COM**



**Tuscan Spice**



**Mystic Quartz**



**Rustic Cashmere**

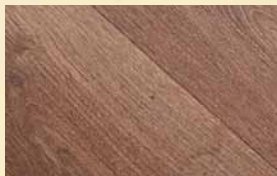

**Wood flooring**





189FBS



215WSK



266KIRB



189FDS



233RBS



267RES

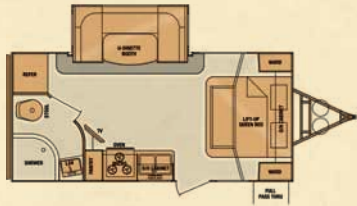

210UDS



242BDS

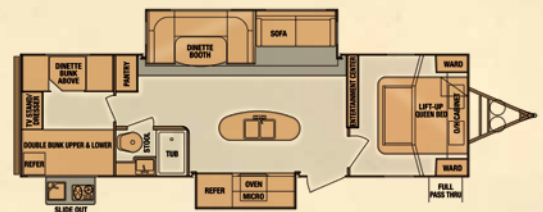

299KIQB



214WSD



265RBSS



301KIBH

| FUN FINDER            | F-189FDS  | F-189FBS  | F-210UDS  | F-214WSD  | F-215WSK  | F-233RBS  | F-242BDS                     | F-265RBSS | F-266KIRB | F-267RES  | F-299KIQB                                 | F-301KIBH  |
|-----------------------|-----------|-----------|-----------|-----------|-----------|-----------|------------------------------|-----------|-----------|-----------|---|--|
| Exterior Length       | 18'-9"    | 18'-9"    | 21'-8"    | 24'-11"   | 25'-1"    | 24'-10"   | 27'-7"                       | 28'-6"    | 29'-10"   | 33'-2"    | 34'                                       | 36'-3"   |
| Exterior Width        | 7'        | 7'        | 8'        | 8'        | 8'        | 8'        | 8'                           | 8'        | 8'        | 8'        | 8'  | 8'   |
| Exterior Height w/A/C | 10'-2"    | 10'-2"    | 10'-7"    | 10'-7"    | 10'-7"    | 10'-7"    | 10'-7"                       | 10'-7"    | 10'-9"    | 10'-9"    | 10'-9"                                    | 10'-9"   |
| Interior Height       | 6'-4"     | 6'-4"     | 6'-9"     | 6'-9"     | 6'-9"     | 6'-9"     | 6'-9"                        | 6'-9"     | 6'-9"     | 6'-9"     | 6'-9"                                     | 6'-9"  |
| Bed Size              | 60" x 80" | 60" x 80" | 60" x 74" | 60" x 80" | 60" x 80" | 60" x 80" | (1)60" x 80"<br>(2)50" x 74" | 60" x 80" | 60" x 80" | 60" x 80" | (1)60" x 80" (1)28" x 72"<br>(2)36" x 72" | (1)60" x 80" (1)28" x 74"<br>(1)38" x 74" (1)48" x 74" |
| Dinette Bed Size      | 32" x 70" | N/A       | 41" x 81" | 41" x 81" | N/A       | 41" x 81" | 41" x 81"                    | 42" x 68" | 41" x 81" | N/A       | (1)41" x 81"<br>(1)28" x 72"              | (1)42" x 68"<br>(1)31" x 74"                           |
| Sofa Size             | N/A       | 68"       | N/A       | N/A       | 68"       | N/A       | N/A                          | 62"       | 62"       | 68"       | 62"                                       | 62"  |
| Axle Weight (lbs.)    | 2,710     | 2,865     | 3,490     | 3,630     | 3,995     | 4,080     | 4,135                        | 4,400     | 4,750     | 5,565     | 5,325                                     | 6,255  |
| Hitch Weight (lbs.)   | 425       | 290       | 395       | 575       | 360       | 490       | 590                          | 485       | 490       | 505       | 780                                       | 735  |
| Dry Weight (lbs.)     | 3,135     | 3,155     | 3,885     | 4,205     | 4,355     | 4,570     | 4,725                        | 4,885     | 5,240     | 6,070     | 6,105                                     | 6,990  |
| GVWR (lbs.)           | 6,025     | 5,890     | 5,995     | 6,175     | 5,960     | 7,490     | 7,590                        | 7,485     | 7,490     | 9,305     | 9,580                                     | 9,535  |
| Cargo Capacity (lbs.) | 2,890     | 2,735     | 2,110     | 1,970     | 1,605     | 2,920     | 2,865                        | 2,600     | 2,250     | 3,235     | 3,475                                     | 2,545  |
| Fresh Tank (gal.)     | 30        | 30        | 36        | 36        | 36        | 36        | 36                           | 36        | 36        | 36        | 36  | 36   |
| Gray Tank (gal.)      | 25        | 25        | 38        | 38        | 38        | 38        | 38                           | 38        | (2) 38    | 38        | (2) 38                                    | (2) 38   |
| Black Tank (gal.)     | 25        | 25        | 38        | 38        | 38        | 38        | 38                           | 38        | 38        | 38        | 38  | 38   |
| LP Bottle (lbs.)      | 40        | 40        | 60        | 60        | 60        | 60        | 60                           | 60        | 60        | 60        | 60  | 60   |
| Power Conv. (amps)    | 55        | 55        | 55        | 55        | 55        | 55        | 55                           | 55        | 55        | 55        | 55  | 55   |
| Elec. Ign. Furn (BTU) | 20K       | 20K       | 20K       | 20K       | 20K       | 30K       | 30K                          | 30K       | 30K       | 30K       | 30K                                       | 30K  |

\* All weights are "non-equipped"



866-277-5630 - CRUISERRV.COM

Cruiser RV, LLC reserves the right to make changes without notice or obligation. Some photography shows optional items available at additional cost. Weights do not include options. All standard features, options and specifications are subject to change. Please contact your authorized dealer for details.

YOUR LOCAL DEALER:

