

# Spree<sup>®</sup>



Luxury Lightweight Travel Trailers



Spree is sure to exceed your expectations with its many standards and popular options. Plenty of space to enjoy, whether watching TV on the free standing sofa, curling up with a book on one of the recliners or playing games in the dinette. Abundant storage in overhead cabinetry and slide out entertainment center.

**3281K**  
Nutmeg Décor with  
Cognac Maple



**3281K** Kitchen island offers additional counter space and storage.



48" Residential size shower (VBF)



**3281K** Slide out entertainment center with fireplace.

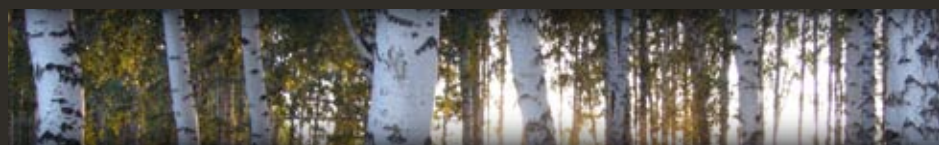



**321RKS**  
Nutmeg Décor with Smart Cherry

321RKS features a rear kitchen full of standing features including glazed cabinetry, pull down faucet, sink cover, oven, microwave with turntable, 8 cubic foot refrigerator, side pantry and optional solid surface countertops.



**321RKS** Extra large windows in slide out provide panoramic views.



**321RKS** Padded headboard and night stands.

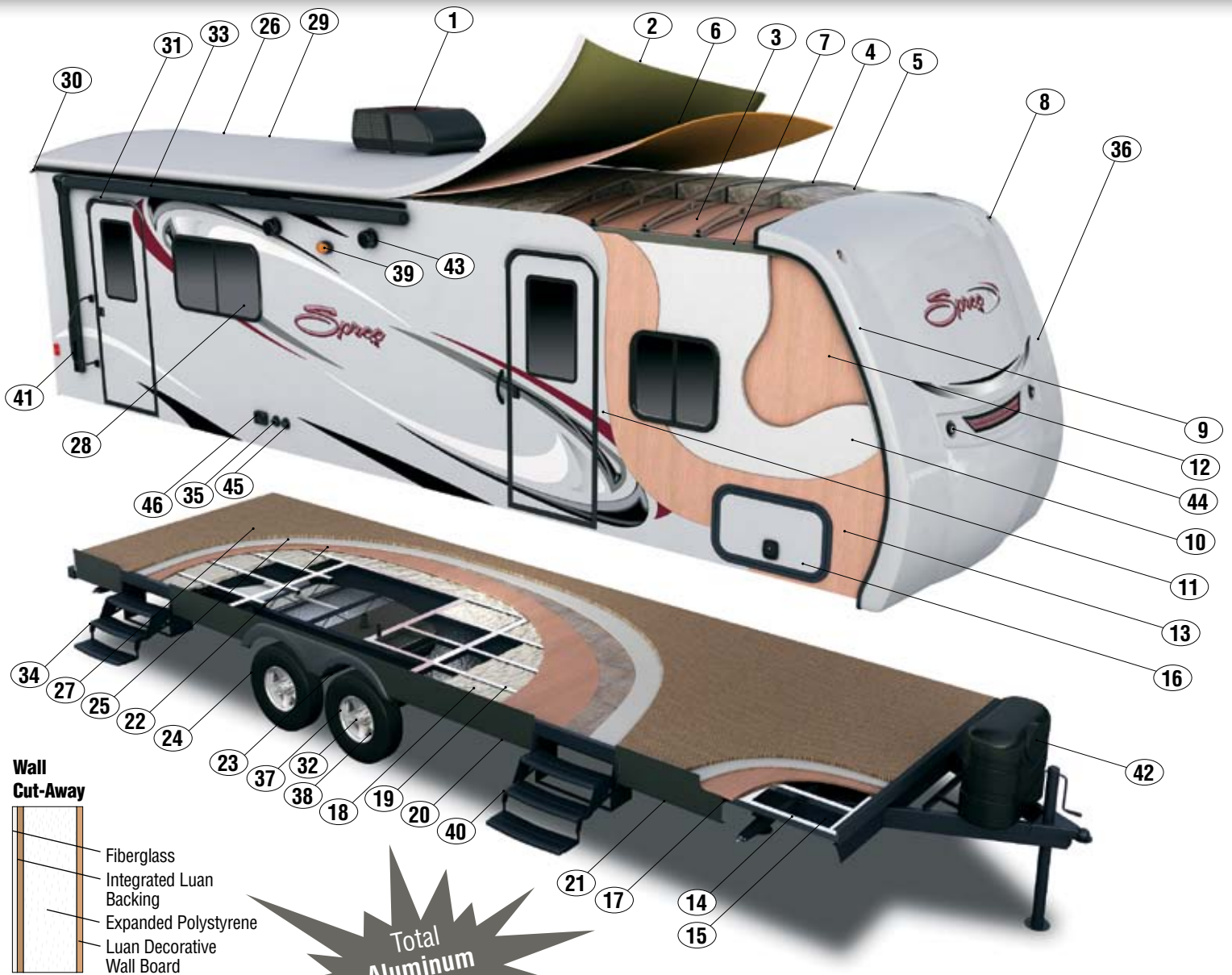

- |   |   |   |
|---|---|---|
| <ul style="list-style-type: none"> <li>1 13,500 BTU A/C</li> <li>2 Seamless 1-Piece Roofing Material</li> <li>3 Vinyl Interior Ceiling Panel</li> <li>4 4 1/2" Arched Aluminum Truss Rafters, 16" O.C.</li> <li>5 R-7 Batten Insulation</li> <li>6 3/8" WalkableRoof Decking</li> <li>7 Heavy Duty Aluminum Headers</li> <li>8 Exterior Clearance and Brake Lights</li> <li>9 Aluminum Frame Front and End Walls</li> <li>10 Expanded Polystyrene R-7</li> <li>11 High Gloss Titanium Gray Exterior Fiberglass</li> <li>12 1/8" Luan Decorative Wall Board</li> <li>13 1/8" Luan</li> <li>14 3" Aluminum Stringer</li> <li>15 Darco® Corrugated Moisture Barrier</li> <li>16 Extra-Large Slam Latch Radius Baggage Doors</li> </ul> | <p style="text-align: center;"><b>Total Aluminum Frame</b></p> <ul style="list-style-type: none"> <li>17 Heavy Duty I-beam Frame Construction</li> <li>18 R-7 Batten Insulation</li> <li>19 2x2 Double Welded Aluminum Floor Joists, 16" O.C.</li> <li>20 Heated &amp; Enclosed Underbelly</li> <li>21 Fully Welded Outriggers</li> <li>22 5/8" Tongue and Groove Plywood Decking</li> <li>23 Heavy Duty Leaf Springs</li> <li>24 15" Radial Tires</li> <li>25 Residential Style Carpet Pad</li> <li>26 Rack and Pinion Electric Slide with Manual Override with Box Tube Slide Out Ram</li> <li>27 Residential Carpet or Linoleum</li> <li>28 Tinted Safety Glass Windows</li> <li>29 Triple Sealed Slide Outs</li> <li>30 Extra Long Drip Spouts</li> </ul> | <ul style="list-style-type: none"> <li>31 Radius Entrance Door</li> <li>32 AL-KO UltraLube® Axles</li> <li>33 Standard Awning</li> <li>34 Triple Steps</li> <li>35 Cable Hook-Up</li> <li>36 Aerodynamic Fiberglass Front Cap</li> <li>37 AL-KO Auto Adjusting Brakes</li> <li>38 Aluminum Rim (Option)</li> <li>39 Porch Light</li> <li>40 Triple Entry Step</li> <li>41 Large Assist Grab Handle</li> <li>42 (2) 30# LP Tanks with Flip-Up Access Lid</li> <li>43 2 Exterior Speakers</li> <li>44 LED Lights</li> <li>45 Satellite Hookup</li> <li>46 110 Outlet</li> </ul> |
|---|---|---|

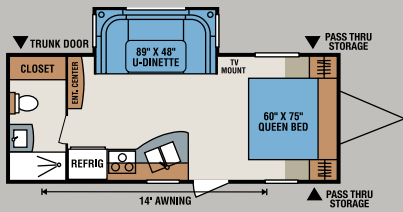

230RBS

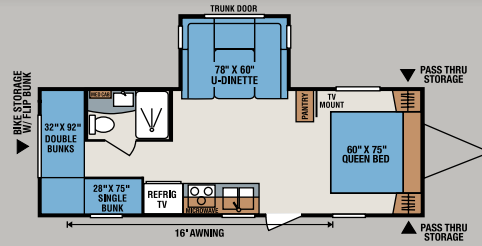

240BHS

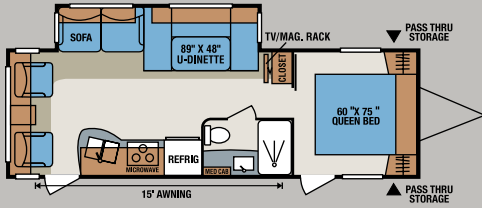

280RLS

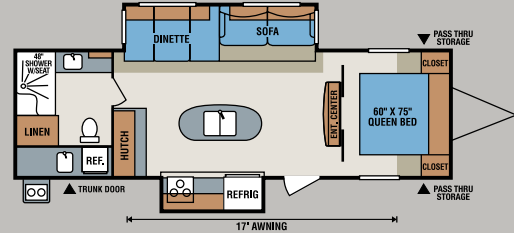

301RIK

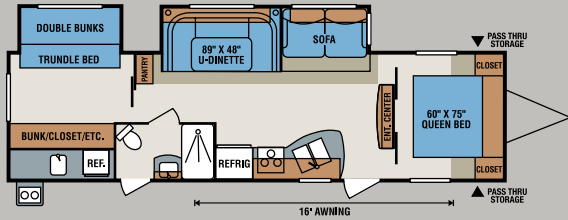

322BHS

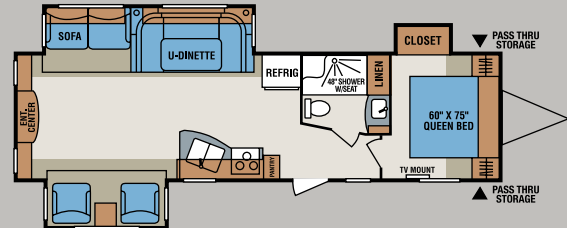

322RES

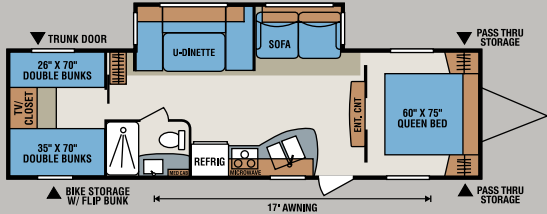

324BHS • Outside Kitchen and Dinette with Flip Up Bunk Option available

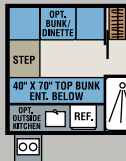

324BHS  
Outside Kitchen and Dinette with Flip Up Bunk Option

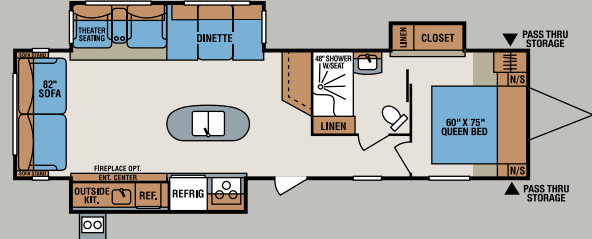

328IK

Travel Trailers	230RBS	240BHS	262RKS	280RLS	301RIK	321RKS	322BHS
UVW (Unloaded Vehicle Weight)*	4840	5160	5590	5590	7010	6680	7150
Dry Hitch Weight*	590	570	600	652	580	760	720
Dry Axle Weight*	4250	4590	4990	4938	6430	5920	6430
NCC (Net Carrying Capacity)	1160	1340	1210	1410	890	1620	1150
GVWR	6000	6500	6800	7000	7900	8300	8300
Interior Height	82"	82"	82"	78"	82"	82"	82"
Exterior Height w/ A/C	11'2"	11'2"	11'1"	10'9"	11'2"	11'2"	11'2"
Exterior Width	96"	96"	96"	96"	96"	96"	96"
Exterior Length	24'9"	28'3"	28'8"	30'3"	31'5"	34'6"	35'8"
Refrigerator (cu. feet)	8	6	8	8	8	8	8
Water Heater Cap. (gal. G/E w/DSI)	6	6	6	6	6	6	6
Fresh Water Cap. (gal.)	40	40	40	40	40	40	40
Waste Water Cap. (gal.)	32	32	32	32	32	32	32
Gray Water Cap. (gal.)	32	32	64	32	32	64	32
LP Gas Cap. (lbs.)	60	60	60	60	60	60	60
Furnace BTUs (1,000s)	20	20	20	25	30	30	30
Tire Size	15"	15"	15"	15"	15"	15"	15"
Awning	14'	17'	15'	15'	17'	17'	16'

\*This weight reflects the rolling average unit weight for each model. Your trailer weight will vary according to optional equipment.

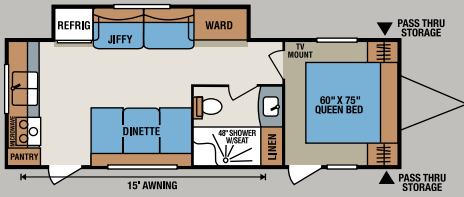

262RKS

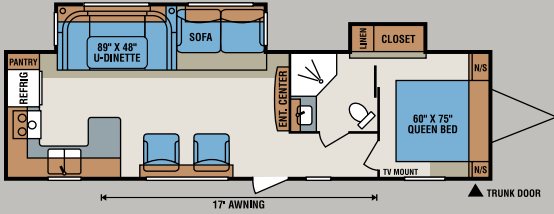

321RKS

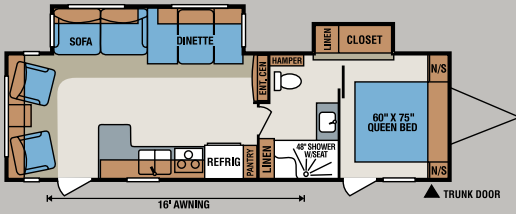

323CSB

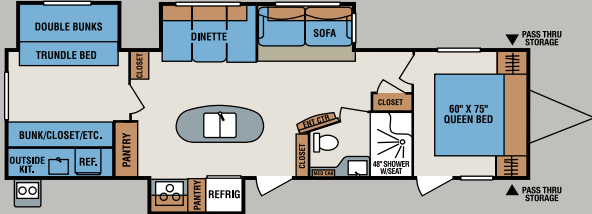

329IK

322RES	323CSB	324BHS	328IK	329IK
7320	6970	6246	8160	8130
900	760	740	740	860
6420	6210	5506	7420	7270
1480	1330	1704	1340	1370
8800	8300	7950	9500	9500
82"	82"	82"	82"	82"
11'2"	11'3"	11'2"	11'6"	11'6"
96"	96"	96"	96"	96"
34'8"	32'4"	34'1/2"	36'2"	36'6"
8	8	8	8	8
6	6	6	6	6
40	40	40	40	40
32	32	32	32	32
64	32	32	32	56
60	60	60	60	60
30	30	30	30	30
15"	15"	15"	15"	15"
13'	16'	17'	20'	17'



82" Radius Ceiling on All Models



Full Extension Ball Bearing Drawer Glides on all Kitchen Cabinetry and Under Dinette Drawers (where available)



Outdoor Kitchen with Range Top, Microwave, Sink, Refrigerator and Storage (301RIK, 322BHS, 328IK, 329IK)



Aluminum Wheels (option) Standard on LX Package



Cap Standard on All Models with Titanium Gray High Gloss Sidewalls



Fawn Décor

Nutmeg Décor

Zorro Décor

Cognac Maple

Smart Cherry

### Standards

- 1 Piece Seamless Roof with SuperFlex Roofing Material
- 15" Tires
- 13,500 BTU A/C
- 30 Amp Service
- 30 lb. LP Bottles and Cover with Flip-Up Access Lid
- 3/8" Roof Decking
- 4 Stabilizer Jacks
- 6 Sided Aluminum Frame
- 6 Gallon Gas/Electric DSI Water Heater
- 8 Cubic Foot Refrigerator (N/A 240BHS)
- Custom Wall Border
- AL-KO Auto-Adjust Brakes
- AM/FM/CD/DVD Player with USB Port
- Assist Grab Handle
- Awning with Drip Rail and Spouts
- Black Tank Flush
- Cable Hook Up
- Decorative Bedspread
- Decorative Designer Backsplash at Kitchen
- Drawers Under Refrigerator and Ovens (Where Available)
- Exterior Shower
- Filon 4,000 Titanium Gray Color Infused Gel Fiberglass Sidewalls

- Free Standing Residential Sofa
- Gas Struts on Bed Base
- Hard Lambrequins and Valances
- Headboard
- Heated and Enclosed Underbelly
- Innerspring Mattress
- Large Overhead Cabinets
- Led Lighting Inside and Out
- Microwave with Turntable
- Monitor Panel
- New Gel Coat Smooth Streamline Titanium Gray Front Cap
- Night Shades
- Outside Speakers
- Oven
- Patio Door Light
- Pendant Lights Over Islands
- Power Vent in Bathroom
- Radius Ceiling
- Radius Entry Door
- Rear Bumper with Sewer Hose Storage
- Residential Pull Down Style Faucet
- Roller Ball Bearing Drawer Guides
- Satellite Preparation
- Sink Cover
- Skylight Over Tub
- Slam Latch Baggage Doors
- Solid Wood Framed Mortise and Tenon Glazed Cabinet Doors

- Tinted Windows
- Triple Step
- TV Antenna with Booster
- UltraLube® Axles
- Wood Framed Decorative Refrigerator Front Panel

### Options

- 15" Aluminum Wheels
- 15,000 BTU A/C
- 2nd A/C (Includes 50 Amp)
- Bunk Ladder and Railing (322BHS, 324BHS, and 329IK) (N/A with Jiffy in Bunk)
- Bunks and Dinette (324BHS Only)
- Deluxe Sleeper Sofa (N/A on 262RKS)
- Fan-Tastic Vent® (Bedroom and Bathroom)
- Fireplace (N/A on 262RKS, 280RLS, and 329IK)
- Flip-Up Bike Rack/Storage Tray (Adds 8" to Length)
- Frameless Windows
- Goodyear® Tires (5)
- Jiffy Sofa with Flip-Up Bunk (322BHS and 329IK)
- Ladder (Adds 5" to Length)
- LED TV (29" or 32") (LX Package)
- Lighted Power Awning (Forced on 301RIK, 328IK, and 329IK) (LX Package)

- Outside Grill
- Outside Kitchen (324BHS Only)
- Paint Package (Gray Exterior Only)
- Power Front/Rear Stabilizer Jacks and Tongue Jack
- Radiant Technology Insulation
- Recliner (1 or 2) (280RLS, 321RKS, 322RES, and 323CSS)
- Solid Surface Countertops
- Spare Tire, Carrier, and Cover
- Table and 4 Chairs with Leaf (N/A on 262RKS, 230RBS, and 240BHS)
- Theater Seating (Forced 328IK)
- White Sidewall (Filon 4,000 with Gray Front and Rear)
- Wire for A/C with 50 Amp Service
- Wood Coice of Cognac Maple or Smart Cherry

### LX Package

- 15" Aluminum Wheels
- Equa-Flex™ Suspension
- Katching ZZs Mattress Upgrade
- Lighted Power Awning
- Porcelain Toilet
- Spare Tire/Carrier/Cover
- LED TV (29" or 32")



**Dealer Satisfaction Index:**  
Ratings of manufacturers, by dealers, have consistently awarded KZ top honors for excellence of design, reliability, overall quality and value, communications and dealer support.



Dealer:



Join our Family Forum at  
[www.kzfamilyforum.com](http://www.kzfamilyforum.com)

**ASK ABOUT OUR 2-YEAR LIMITED WARRANTY!**

For more product details and in-depth information, visit us at [www.kz-rv.com](http://www.kz-rv.com)



0985 N 900 W • Shipshewana, IN 46565  
E-mail [kz@kz-rv.com](mailto:kz@kz-rv.com) • [www.kz-rv.com](http://www.kz-rv.com)



Due to continual research and advances, manufacturer reserves the right to change specifications, design, price and equipment without notice, and assumes no responsibility for any error in this literature. Some items shown are not included as standard or optional equipment. ©2013KZ | 11/15/13 | 30M