



GREYHAWK

2014 MOTORHOMES BY JAYCO

COMFORT ON A **GRAND SCALE.**



Read more about our industry-leading **2-YEAR WARRANTY** on the back cover!

2014 GREYHAWK | MOTORHOMES BY JAYCO

GREYHAWK

WE PACKED EVERY COMFORT,
SO YOU WON'T HAVE TO.



The 2014 Jayco Greyhawk is ahead of its class. Loaded with more high-end features, like an industry-first JRide Ride and Handling Package,* solid-surface countertops and a Denver Mattress, Greyhawk delivers the best Class C value so you can ride *coach* in *first-class* style.

* Optional



DESIGNED FOR YOUR JOURNEY

305 HP TRITON ENGINE



ENGINE

Greyhawk combines a robust 6.8L EFI V-10 305 HP Triton engine with a Ford E-450 chassis for precise handling.

THIRD BRAKE LIGHT



SAFETY

Great design starts with great priorities — like your safety. Greyhawk comes equipped with side-view cameras* and a third brake light for added safety.



Maneuver the roads in comfort thanks to 6-way power in the driver seat.

LAP BELTS



LAP BELTS

Jayco's focus on safety doesn't stop with an extra brake light. We build lap belts into every seating position to protect your family.

IN-DASH INFOTAINMENT



TECHNOLOGY

A 6.5" touch-screen display* features back-up views, built-in GPS and entertainment for the road.

* Customer Value Package

INTERIOR DÉCOR CHOICES

MIDNIGHT

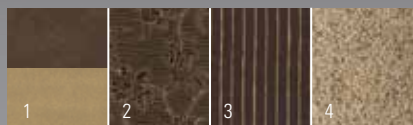

- 1 Sofa and Driver/ Passenger Seats
- 2 Accent
- 3 Bedroom
- 4 Carpet

CAPPUCCINO

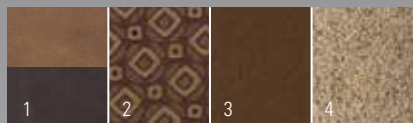

FRENCH VANILLA

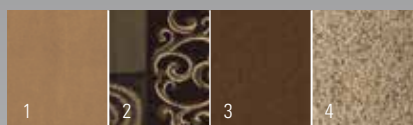

EXTERIOR COLOR CHOICES



POLAR WHITE
FIBERGLASS
(STANDARD)



CHAMPAGNE
FIBERGLASS
(OPTIONAL)



BLACK CRIMSON
PAINT (OPTIONAL)



AMBER STONE
PAINT (OPTIONAL)



High-end kitchen with one-piece, solid-surface countertops

Queen-sized bed with Denver Mattress and bedspread



GREYHAWK 31FK | MIDNIGHT



GREYHAWK 31FK | MIDNIGHT



GREYHAWK 31FK | MIDNIGHT

Bunk beds in the 31FS for a 9-person sleeping capacity

Mega pass-thru storage with slam latches and light



GREYHAWK 31FS | VANILLA



SELECT GREYHAWK MODELS

Superior construction meets a superior ride.



* See warranty policy for front cap details.

** The JRide package is optional on Greyhawk.

WALL CONSTRUCTION

- 1 Vacuum bonded:** Features laminated layers of high-gloss fiberglass, lauan, aluminum framing, R-7 bead-foam insulation and vinyl paneling
- 2 Fiberglass front and rear cap:** Boasts an industry-best 30-month warranty (covers repair or replacement of any defective cap 30 months after manufacture date)*
- 3 Frameless windows:** An industry-first on Class C motorhomes

FLOOR CONSTRUCTION

- 4 Vacuum bonded:** Features laminated layers of Darco underbelly lauan, a welded aluminum frame, R-9 bead-foam insulation and 5/8" Structurwood
- 5 Welded aluminum frame:** Lighter and more corrosion-resistant than competing steel frames, provides more cargo capacity

ROOF CONSTRUCTION

- 6 Vacuum-bonded layers:** Features laminated layers of 5" arched aluminum trusses, moisture-resistant 1/4" plywood decking, R-23 bead-foam insulation and hardboard ceiling
- 7 Seamless one-piece rubber roof:** Features one-piece construction for better leak protection

JRIDE**

RIDE AND HANDLING. DEFINED.

JAYCO.COM/JRIDE

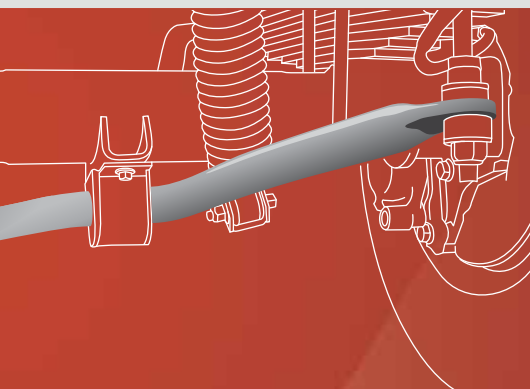

STABILIZER BAR

- 8** Greyhawk's rear stabilizer bar raises and lowers each side of the unit to similar heights, reducing roll when cornering. No other Class C is equipped with this.

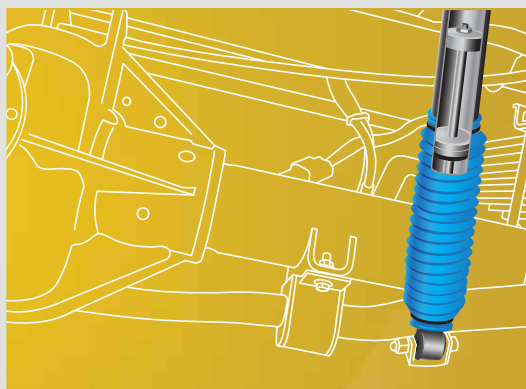

BILSTEIN SHOCKS

- 9** Bilstein shock absorbers, not found on other Class Cs, reduce bounce and eliminate excessive sway. A unique monotube design doesn't trap heat, reducing shock failure.

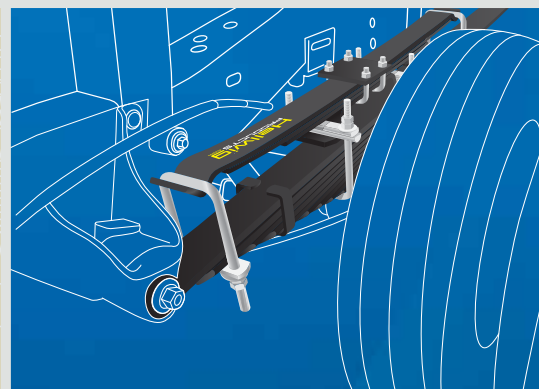

HELLWIG HELPER SPRINGS

- 10** Fluctuating loads impact alignment, reduce traction and diminish handling. Hellwig helper springs correct this, compressing under loads to level out your RV.

STANDARDS AND OPTIONS

CUSTOMER VALUE PACKAGE

- Portable, outside gas grill
- Remote-control, heated, side-view mirrors
- Back-up and side-view cameras/monitor
- Infotainment system with in-dash, touch-screen radio with 6.5" LCD color display, DVD/USB, Sirius satellite prep, Bluetooth and built-in GPS
- 22" LED TV in bedroom
- 400-watt inverter
- Tankless water heater
- 12V electric awning with LED lights

STANDARD EXTERIOR EQUIPMENT

- TuffShell vacuum-bonded laminated floor, sidewalls and roof
- Front molded seamless fiberglass cap
- Fiberglass running boards
- 80" tall fiberglass, radius-cornered entrance
- Keyless entry door, touch-pad lock system
- Electric-powered, double-entrance step
- High-output, marine-grade exterior speakers (2)
- Wheel liners
- Onan 4,000-watt MicroQuiet generator with auto-changeover

- Pass-through storage compartment with slam latches and light (select models)
- Slideout battery tray
- 56-lb. propane tank
- 12V electrical system with 120V, 60-amp power converter
- 30-amp power cord
- Outside shower
- 12V demand water pump
- Heated holding tanks, 12V pads
- Roof ladder

STANDARD INTERIOR EQUIPMENT

- 84" ceiling height with padded vinyl ceiling
- Washington Glazed cabinetry with raised-panel doors and deluxe hidden hinges
- Ball bearing drawer guides, 75-lb. capacity, full-drawer extension
- 3-burner range with 9,000-BTU SuperBurner and piezo igniter
- 8 cu. ft. flush-mount refrigerator with double doors
- Microwave oven
- Oven
- One-piece, solid-surface, high-gloss countertop with integrated deep bowl sinks and covers (2)

- Water purification system
- Dream Dinette mechanism, raises/lowers tabletop
- High-intensity recessed LED lights
- 26" digital LED HDTV (31SS, 31FK)
- 32" digital LED HDTV (29KS, 29MV, 31DS, 31FS)
- Vinyl flooring throughout
- Lap safety belts on all living area seats
- Interior Command Center
- 31,000-BTU auto-ignition furnace with wall thermostat
- Satellite dish prep
- Toilet with foot flush
- ABS shower with one-piece surround
- Queen-sized bed with Denver Mattress
- Under-bed storage (select models)

STANDARD DRIVING EQUIPMENT

- Remote keyless entry
- Auxiliary start switch
- 6-way power driver seat
- Driver and passenger air bags
- Ford E-450 chassis
- Triton 6.8L EFI V-10 305 HP engine with 420 lbs./ft. torque

- 5-speed automatic TorqShift series transmission with overdrive
- 55-gal. fuel tank
- 120-amp alternator
- 5,000-lb. hitch with 7-pin plug
- Power anti-lock brakes with power steering
- A/C and cruise control
- Rubber isolation body mounts

OPTIONS

- JRide package
- Champagne fiberglass exterior with vinyl graphics
- Amber Stone exterior paint
- Black Crimson exterior paint
- Aluminum rims
- Hydraulic auto leveling jacks
- 15,000-BTU air conditioner with heat pump
- Front entertainment center with 32" LED HDTV
- Bunk CD/DVD players (2) (31FS)
- Outside kitchen (29KS)

FLOORPLANS

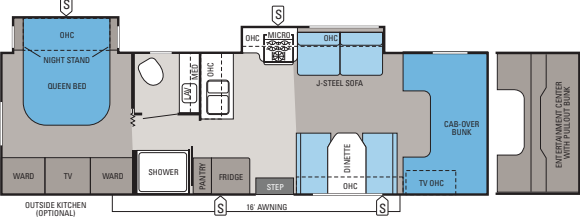

GREYHAWK | 29KS

Ext. Length: 31' 6" Exterior Height: 139" Sleeps: 4-5

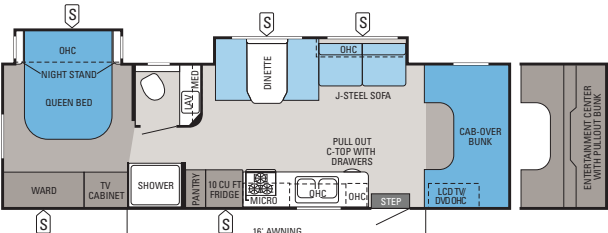

GREYHAWK | 29MV

Ext. Length: 32' 5" Exterior Height: 138" Sleeps: 4-5

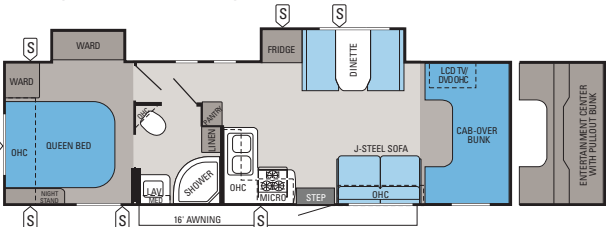

GREYHAWK | 31DS

Ext. Length: 32' 5" Exterior Height: 138" Sleeps: 5-7

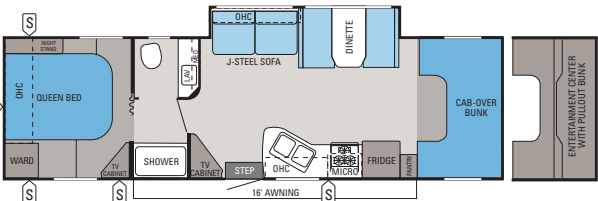

GREYHAWK | 31FK

Ext. Length: 32' 5" Exterior Height: 138" Sleeps: 5-7

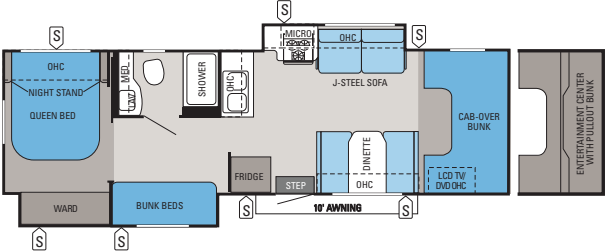

GREYHAWK | 31FS

Ext. Length: 32' 5" Exterior Height: 138" Sleeps: 7-9

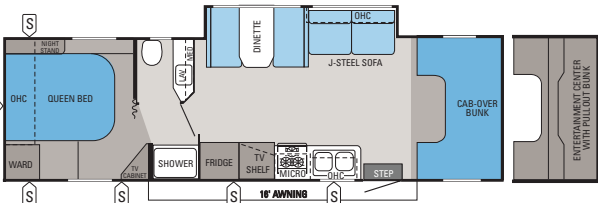

GREYHAWK | 31SS

Ext. Length: 31' 11" Exterior Height: 138" Sleeps: 5-7

SPECIFICATIONS

FLOORPLAN	EXT. LENGTH	EXT. WIDTH	EXT. HEIGHT (WITH A/C)	INT. HEIGHT	GROSS VEHICLE WEIGHT RATING (LBS.)	GROSS COMBINED WEIGHT RATING (LBS.)	ENGINE/SIZE	WHEEL BASE	FURNACE AUTO-IGNITION (BTUS)	FRESH WATER CAPACITY (INCLUDES WATER HEATER) (GALS.)	GRAY WASTE WATER CAPACITY (GALS.)	BLACK WASTE WATER CAPACITY (GALS.)
29KS	31' 6"	100"	139"	84"	14,500	19,500	6.8L TRITON EFI V-10	212"	31M	32.75	40	32
29MV	32' 5"	100"	138"	84"	14,500	19,500	6.8L TRITON EFI V-10	213"	31M	32.75	40	33
31DS	32' 5"	100"	138"	84"	14,500	19,500	6.8L TRITON EFI V-10	223"	31M	32.75	40	31
31FK	32' 5"	100"	138"	84"	14,500	19,500	6.8L TRITON EFI V-10	223"	31M	32.75	40	32
31FS	32' 5"	100"	138"	84"	14,500	19,500	6.8L TRITON EFI V-10	223"	31M	32.75	40	32
31SS	31' 11"	100"	138"	84"	14,500	19,500	6.8L TRITON EFI V-10	218"	31M	32.75	40	32

Gross Vehicle Weight Rating (GVWR): The maximum permissible weight of the motorhome, including the Unloaded Vehicle Weight (UVW) plus passengers, personal items, all cargo, fluids, options and dealer-installed accessories. The GVWR is equal to or greater than the sum of the UVW and the Cargo Carrying Capacity.

Gross Combined Weight Rating (GCWR): The maximum allowable combined weight of the motorhome used as a tow vehicle and the attached towed vehicle.

It is important for your safety and enjoyment that you are aware of the weights and tow ratings of the RV you select. Consult a competent advisor for questions or advice. Whether you are new to RVing or a veteran, get a feel for the performance of your RV

before heading out on the roadways. When you tow a vehicle with your RV, you must drive differently than when you drive a single vehicle. Practice hooking up, driving, backing up and braking in a safe environment or seek out professional instruction. Jayco affixes a weight label to each RV which lists weight information for that vehicle. Refer to that label to verify the vehicle will meet your requirements. See specifications chart above.

2-YEAR WARRANTY*

Peace of mind comes standard.



BUMPER
to
BUMPER
LIMITED WARRANTY*

Nobody offers a better warranty than Jayco. With our exclusive 2-year CoPilot Limited Warranty, the only strings we attach are those that deliver the ultimate in reliability. At Jayco, your peace of mind is our priority, and that's the Jayco difference.

*For a copy of our 2-year limited warranty with full terms and conditions, please contact your local Jayco dealer or visit Jayco.com.

300 JAYCO DEALERS

A four-decade strong network.

From the sales experience to service after the sale, we consider our dealers to be an important part of the Jayco family. Establishing a solid relationship with your local Jayco dealer is a key component in the enjoyment of your new Jayco. By purchasing from a local dealer, you will have a convenient location for sales, parts and service support. We hope you consider them a part of your camping family.

Your local dealer

1-YEAR FREE

Roadside Assistance

Travel worry-free with Jayco's Customer First Roadside Assistance program, yours at no cost during your first year of ownership. This program is offered through Coach-Net, the country's largest RV emergency road service, and gives you immediate access to assistance.

Coach-Net
RV Technical & Roadside Assistance



Generations of family fun.

THE JAYCO STORY BEGAN IN 1968 WITH OUR FAMILY—THE BONTRAGERS. Lloyd Bontrager created an innovative, easy-to-use lifter system that led to a better fold-down camper. Loaded with more conveniences, he believed his camper would bring families closer together.

Since then, Jayco has helped generation after generation create family stories — good, old-fashioned family fun built around campfires with a Jayco RV nearby. At Jayco, we strive to build family-friendly products that will outlast just about everything but your memories. We'd love nothing more than to be a part of your family story. Join us in our generations of family fun.

eco advantage™

Jayco's long-term commitment to protecting the environment.



Scan this QR code with your smartphone to watch a video about our efforts and the impact we're making on our planet.
jayco.com/ecoadvantage

Follow us on



Jayco, Inc., P.O. Box 460, Middlebury, IN 46540, www.jayco.com RVIA

See dealer for further information and prices. All information in this brochure is the latest available at the time of publication approval. Jayco reserves the right to make changes and to discontinue models without notice or obligation. Photos in this brochure may show optional equipment and props for photography purposes. RVs built for sale in Canada may differ to conform to Canadian codes. ©2013 Jayco, Inc. 14-GREY-PL 1013-60K Printed in U.S.A.