

THOR
MOTOR COACH

THOR
MOTOR COACH

TUSCANY
XTE

WHERE LUXURY MEETS THE ROAD

TUSCANY XTE



WELCOME TO THE GOOD LIFE.

THOR MOTOR COACH IS THE #1 MANUFACTURER OF MOTORHOMES IN NORTH AMERICA. OUR AMERICAN MADE PRODUCTS OFFER A HIGHER LEVEL OF FUNCTION AND FEATURES. WITH THE STRENGTH OF THOR INDUSTRIES BEHIND US, WE ARE FINANCIALLY STRONG. BUILDING FROM MORE THAN 25 YEARS OF MANUFACTURING EXPERTISE, WE ARE COMMITTED TO OFFERING PRODUCTS THAT MEET AND EXCEED THE EXPECTATION OF TODAY'S CONSUMERS.



AT THOR MOTOR COACH WE CONTINUALLY CHALLENGE OUR ENGINEERING AND PRODUCT DEVELOPMENT TEAMS TO FIND THE "NEXT GREAT" THING IN MOTORHOMES. THIS CHALLENGE IS FOCUSED ON YOU, OUR CUSTOMERS. IT IS BECAUSE OF THIS FOCUS WE ARE DRIVEN TO CREATE GREAT PRODUCTS.

WHEN YOU STEP INTO A NEW THOR MOTOR COACH MOTORHOME, WE HOPE THAT IT IS ONLY THE BEGINNING OF WHAT WILL BE YOUR... GOOD LIFE!

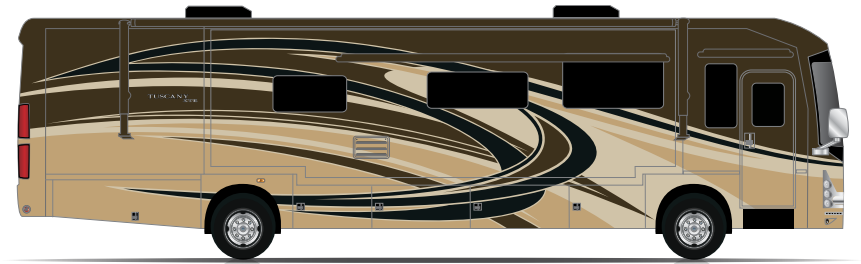

MIRAGE

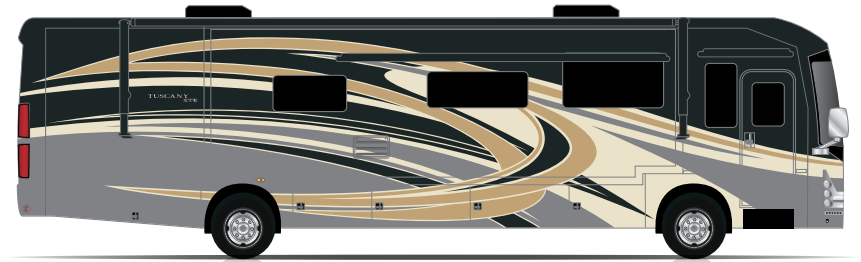

OLYMPUS

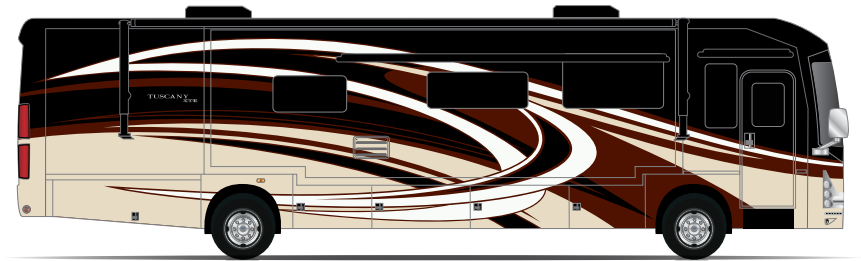

PALISADE

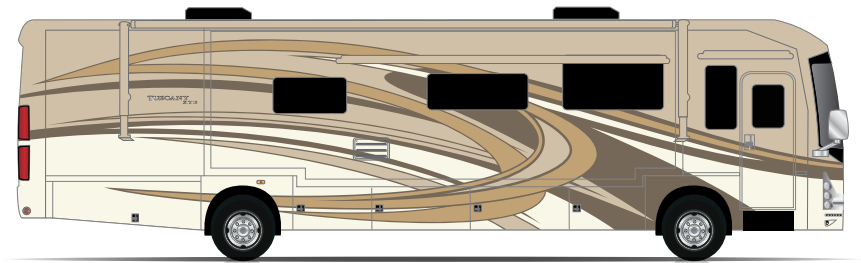

VERONA

WHERE LUXURY MEETS THE ROAD



A FULL BODY PAINT

A striking exterior graphics design provides a jaw-dropping appearance. The paint process includes multiple layers of paint and clear coat to provide a silky exterior finish.

B FRAMELESS WINDOWS

Sleek, automotive style, frameless windows look great with an added twist of functionality. The windows are hinged to open outward for ventilation, even in rainy weather.

C POWER AWNING

A legless, lateral arm awning is fully encased in a metal box protecting it during driving. When extended, the awning does not have legs intruding into the camp area and it has the ability to self-retract in windy conditions.

D LED ACCENT LIGHTING

A beautifully sculpted front cap is fully illuminated with LED accents, including the Tuscani nameplate and accompanying driving lights.

E SIDE VISION CAMERAS

Side vision cameras, integrated into the exterior mirror housing, vastly increase the line of sight along the side of the coach helping keep you safe out on the road.

MORE THAN SKIN DEEP

A HOUSE NEEDS TO BE A STRONG FOUNDATION AND THAT INCLUDES A HOME THAT ROLLS DOWN THE ROAD. WE HAVE PARTNERED WITH FREIGHTLINER CUSTOM CHASSIS AND MOR/RYPDE MANUFACTURING TO ENGINEER THE BEST FOUNDATION IN THE BUSINESS. FREIGHTLINER'S ADVANCED CHASSIS TECHNOLOGY PROVIDES A SAFE AND STABLE PLATFORM FOR MANEUVERING THE COACH

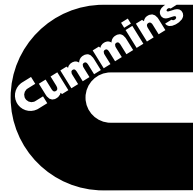

The finest products start with the best ingredients.

DOWN THE ROAD, WHILE MOR/RYPDE'S STEEL STRUCTURE ENSURES THE PERFECT INTEGRATION OF CHASSIS TO THE HOME.

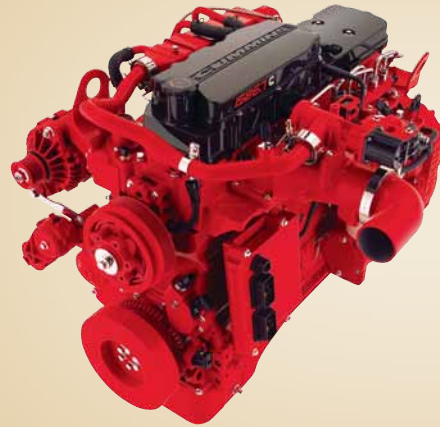

BACKED BY CUMMINS® POWER

Premium motorhome buyers don't settle for second best. That's why Cummins® is the number-one choice for diesel power. The Tuscany XTE's ISB-XT diesel engine is mated to a 6-speed Allison MH-3000 automatic transmission, providing 360-hp and 800 ft/lb torque. This combination delivers maximum performance, reliability and durability.

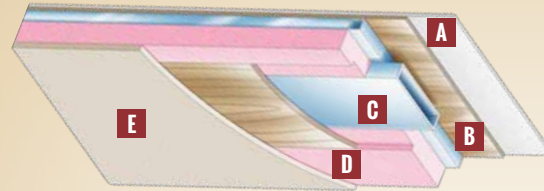

ROOF

- A** One-piece exterior TPO membrane
- B** Lauan panels
- C** Aluminum structure with bowed framing
- D** Block foam insulation
- E** Interior panel with soft touch vinyl covering

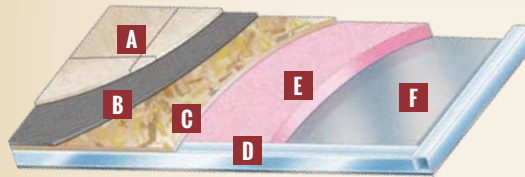

FLOOR

- A** Porcelain Tile flooring
- B** 1/4" cement board underlayment
- C** OSB structurewood base
- D** Structural steel framing
- E** Block foam insulation
- F** Lauan with woven plastic exterior finish

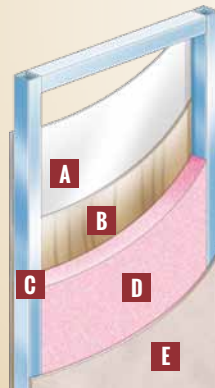

SIDEWALLS

- A** High-gloss or gel-coat fiberglass
- B** Lauan panels
- C** Aluminum structure with framing at all openings
- D** Block Foam insulation
- E** Interior panel with designer wall covering

All roof, wall and floor structures are vacuum bond laminated. This process ensures constant and consistent glue coverage over all layers of the structure. This time sensitive process is necessary to provide stronger and more secure motorhomes with increased longevity.



SUPERIOR STRENGTH



A FRONT DISC BRAKES

Large 17" air disc brakes help stop the coach quickly, while dissipating heat to help prevent brake fade.

B 55-DEGREE WHEEL CUT

With 55-degrees of wheel cut, turning circles can be drastically reduced. The Tuscany XTE can turn around in even the tightest of spaces.

C RAISED RAIL CHASSIS

The elevated design allows for substantial more pass-through storage under the coach.

D DEF TANK

Almost all truck stops offer DEF in bulk at the pump, but only on the drive's side of the island. The Tuscany XTE is thoughtfully designed to include a DEF tank that's easy to fill.

E 10,000 LB HITCH

The diesel engine has plenty of torque to pull the heaviest of towed vehicles. The hitch includes a 7-way round connector for ease of use.



40GQ / IVORY SONATA DECOR / OLYMPIC CHERRY WOOD



OLYMPIC CHERRY



VINTAGE MAPLE



IVORY SONATA

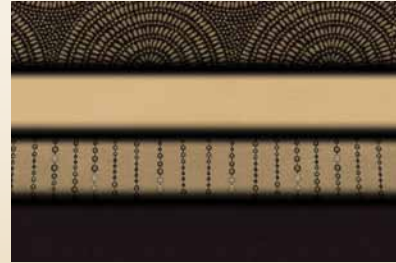

KONA BEAN



LUNA CREST

WIDE OPEN SPACES MAXIMUM LIVING AND SEATING SPACE IS AT THE FOREFRONT OF THE TUSCANY XTE. LUSH, WELL-APPOINTED DECORS ENHANCE THE HANDCRAFTED HARDWOOD CABINETRY, ALONG WITH HIGH-END AMENITIES MAKING THESE WIDE OPEN SPACES FEEL JUST LIKE HOME.



40GQ / IVORY SONATA DECOR / OLYMPIC CHERRY WOOD

HIGH-DEFINITION

THE TUSCANY XTE IS OUTFITTED WITH A PREMIUM ENTERTAINMENT SYSTEM. SONY TVs AND BLUE-RAY HOME THEATER BRING MOVIES AND MUSIC TO LIFE. INDIVIDUAL CEILING SPEAKERS SURROUND VIEWERS WITH IMMERSIVE SOUND, WHILE THUNDERING BASS IS PROVIDED BY A SEPARATE SUB-WOOFER. HIGH DEFINITION PROGRAMMING IS WIRED THROUGHOUT THE COACH VIA HDMI SWITCHES AND CABLING.

It's all about a great night's sleep. With a Euro Top Supreme from Denver Mattress™ you will get that and more. Luxury and comfort never felt so good.



34ST / WASHER & DRYER / VINTAGE MAPLE WOOD



36MQ / IVORY SONATA DECOR / VINTAGE MAPLE WOOD





36MQ / IVORY SONATA DECOR / OLYMPIC CHERRY WOOD

SPECIFICATIONS

| | |
|-------------------------------------|------------|
| Gross Vehicle (GVWR) | 32,400 |
| Gross Combined (GCWR) | 42,400 |
| Wheel Base | 208" |
| Exterior Length (w/o ladder)* | 35'-5" |
| Exterior Height (w/ AC) | 12'-9" |
| Exterior Width (w/o mirrors) | 101" |
| Interior Height | 85" |
| Awning Size | 16'-5" |
| Fuel (gal) | 100 |
| LPG (lbs) | 126 |
| Fresh/Waste/Grey Water (gal) | 91/51/51 |
| Furnace (BTUs) | (2) 20,000 |
| Exterior Storage Capacity (cu. ft.) | 140 |

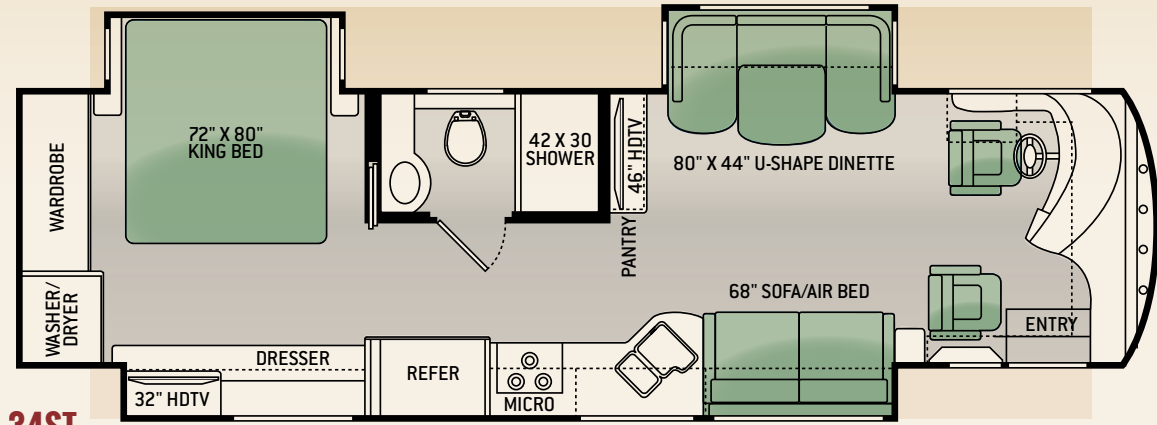

34ST

| | |
|-------------------------------------|------------|
| Gross Vehicle (GVWR) | 32,400 |
| Gross Combined (GCWR) | 42,400 |
| Wheel Base | 236" |
| Exterior Length (w/o ladder)* | 37'-9" |
| Exterior Height (w/ AC) | 12'-9" |
| Exterior Width (w/o mirrors) | 101" |
| Interior Height | 85" |
| Awning Size | 13' |
| Fuel (gal) | 100 |
| LPG (lbs) | 126 |
| Fresh/Waste/Grey Water (gal) | 91/51/51 |
| Furnace (BTUs) | (2) 20,000 |
| Exterior Storage Capacity (cu. ft.) | 185 |

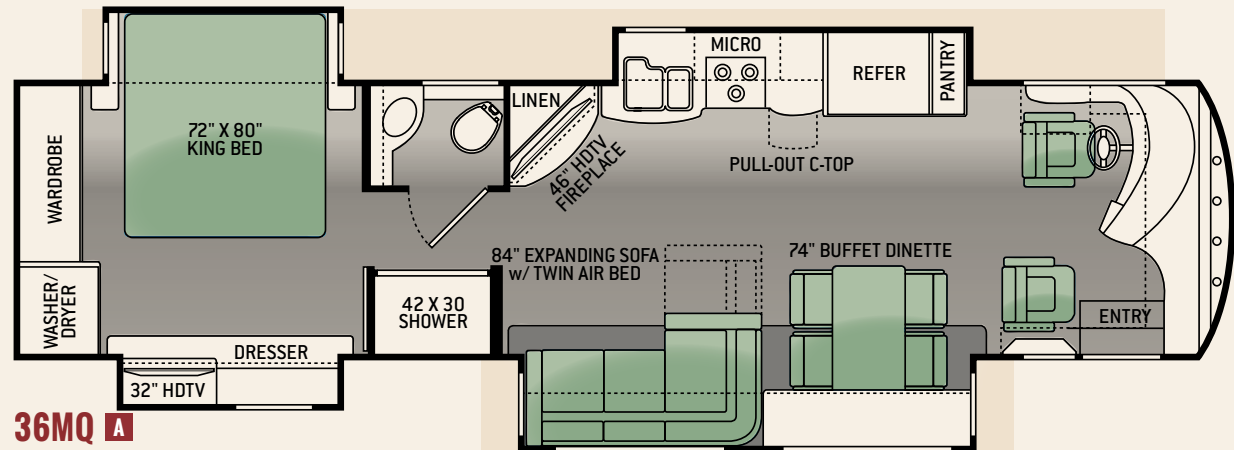

36MQ A

THE TUSCANY XTE OFFERS A WIDE VARIETY OF FLOOR PLANS TO SUIT YOUR LIFESTYLE. OPTIONAL FURNITURE PACKAGES HELP CUSTOMIZE THE INTERIOR TO FIT INDIVIDUAL TASTES.

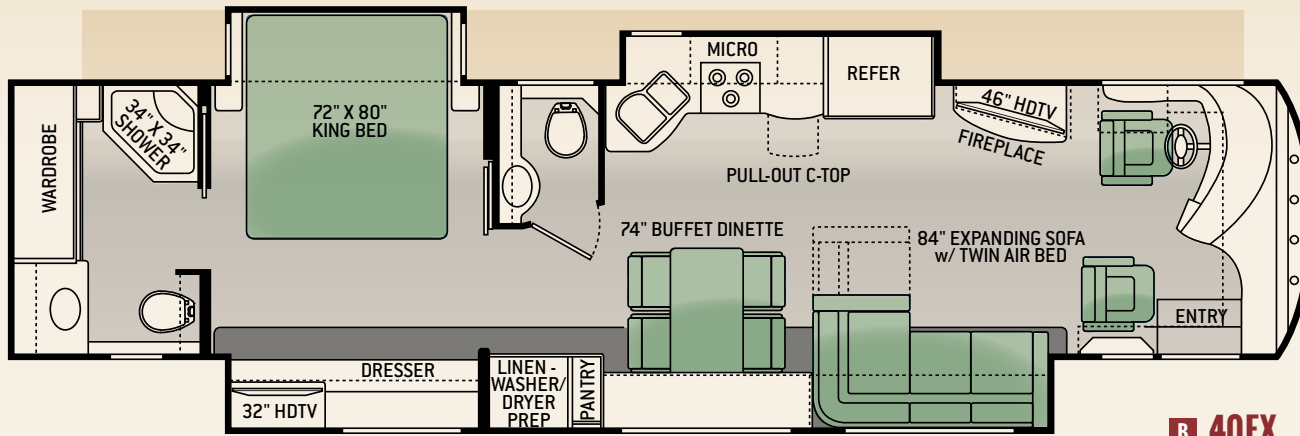

B 40EX

| | |
|-------------------------------------|-------------------------|
| Gross Vehicle (GVWR) | 32,400 |
| Gross Combined (GCWR) | 42,400 |
| Wheel Base | 266" |
| Exterior Length (w/o ladder)* | 40'-3" |
| Exterior Height (w/ AC) | 12'-9" |
| Exterior Width (w/o mirrors) | 101" |
| Interior Height | 85" |
| Awning Size | 16'-5" |
| Fuel (gal) | 100 |
| LPG (lbs) | 126 |
| Fresh/Waste/Grey Water (gal) | 91/51/51 |
| Furnace (BTUs) | (I) 20,000 / (I) 25,000 |
| Exterior Storage Capacity (cu. ft.) | 215 |

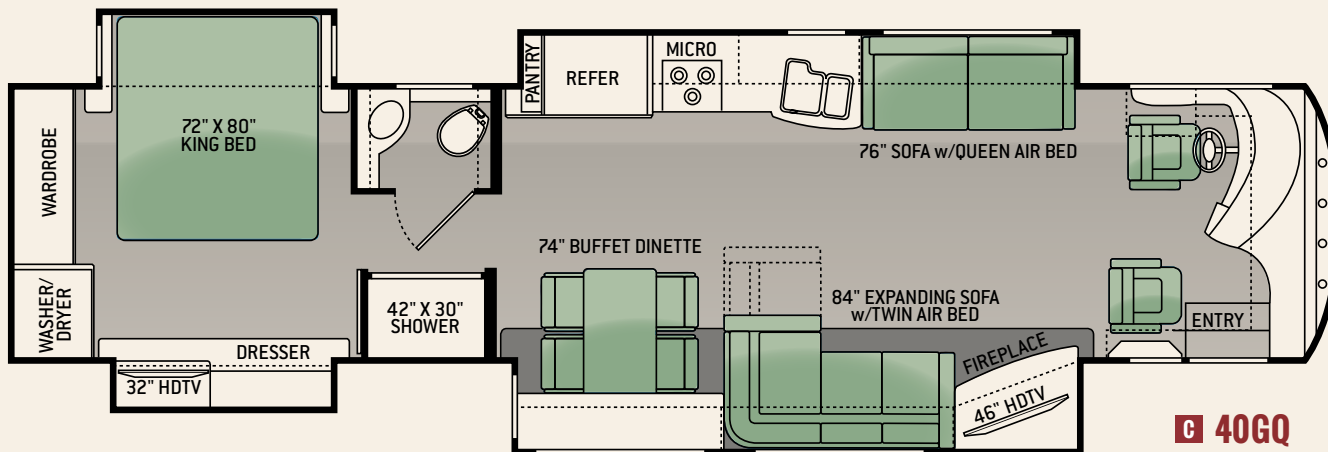

C 40GQ

| | |
|-------------------------------------|-------------------------|
| Gross Vehicle (GVWR) | 32,400 |
| Gross Combined (GCWR) | 42,400 |
| Wheel Base | 276" |
| Exterior Length (w/o ladder)* | 41'-1" |
| Exterior Height (w/ AC) | 12'-9" |
| Exterior Width (w/o mirrors) | 101" |
| Interior Height | 85" |
| Awning Size | 16'-5" |
| Fuel (gal) | 100 |
| LPG (lbs) | 126 |
| Fresh/Waste/Grey Water (gal) | 91/51/51 |
| Furnace (BTUs) | (I) 20,000 / (I) 25,000 |
| Exterior Storage Capacity (cu. ft.) | 225 |

FURNITURE OPTIONS

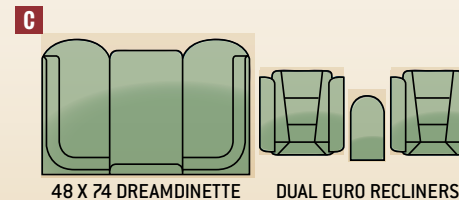
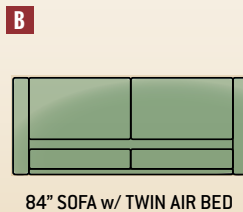
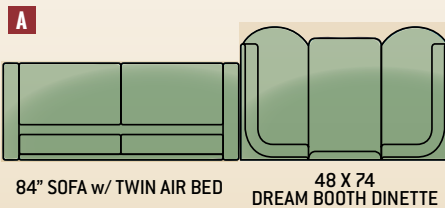

❖ CHASSIS

| MODEL | 34ST | 36MQ | 40EX | 40GQ |
|---|------|------|------|------|
| Freightliner XC Raised Rail Chassis | S | S | S | S |
| ISB-XT 360-hp Cummins Engine with 800 ft lb of Torque | S | S | S | S |
| 6 Speed Allison MH-3000 Automatic Transmission | S | S | S | S |
| 22.5" Radial Tires with Aluminum Wheels | S | S | S | S |
| Front Axle with Air Disc Brakes and 55° Wheel Cut | S | S | S | S |
| Air-Ride Suspension | S | S | S | S |
| Exhaust Brake | S | S | S | S |
| Under-Hood Light | S | S | S | S |
| Dual Fuel Fills | S | S | S | S |
| Emergency Start Circuit | S | S | S | S |
| 10,000 lb Trailer Hitch | S | S | S | S |
| Automatic Leveling Jacks with Touch Pad Controls | S | S | S | S |

❖ CONSTRUCTION & EXTERIOR

| MODEL | 34ST | 36MQ | 40EX | 40GQ |
|--|------|------|------|------|
| Fiberglass Front and Rear Caps | S | S | S | S |
| Tinted One Piece Windshield | S | S | S | S |
| Frameless Dual Pane Windows | S | S | S | S |
| Full Body Paint with Gel Coat Wall | S | S | S | S |
| Invisible Bra | S | S | S | S |
| Electric Entry Door Awning | S | S | S | S |
| Lateral Arm Electric Patio Awning | S | S | S | S |
| Slide Out Topper Awnings | S | S | S | S |
| Fog Lights | S | S | S | S |
| Pass-Through Storage | S | S | S | S |
| Easy Slide Storage Tray | S | S | S | S |
| Side-Hinged/Locking Aluminum Compartment Doors | S | S | S | S |
| Rear Ladder | S | S | S | S |

❖ AUTOMOTIVE & COCKPIT

| MODEL | 34ST | 36MQ | 40EX | 40GQ |
|---|------|------|------|------|
| Electric Windshield Day / Night Privacy Shade | S | S | S | S |
| Manual Side Day / Night Privacy Shades | S | S | S | S |
| Leatherette Reclining/Swivel Driver and Passenger Seats with 6-Way Power Adjustment | S | S | S | S |
| Driver and Passenger Overhead Storage Cabinetry | S | S | S | S |
| Chrome Power Mirrors with Heat and Integrated Side View Camera System | S | S | S | S |
| Touch Screen Dash Radio with CD Player and Back-up Monitor | S | S | S | S |
| Electronic Cruise Control | S | S | S | S |
| Air Horn | S | S | S | S |
| Dash Fans | S | S | S | S |
| Electric Step Cover | S | S | S | S |

❖ INTERIOR

| MODEL | 34ST | 36MQ | 40EX | 40GQ |
|---|------|------|------|------|
| Hardwood Cabinetry Throughout with Raised Panel Cabinet Doors | S | S | S | S |
| Day / Night Roller Shades in Living Area & Bedroom | S | S | S | S |
| Porcelain Tile Throughout | S | S | S | S |
| LED Ceiling Lights | S | S | S | S |
| Fireplace | - | S | S | S |
| Leatherette Sofa/Air Bed on Drivers Side | S | - | - | S |
| Leatherette Expanding L-Sofa on Passenger Side | - | S | S | S |
| U-Shaped Dinette | S | - | - | - |
| Cantilever Buffet with Computer Workstation and Two Chairs | - | S | S | S |
| Leatherette Sofa/Air Bed on Passenger Side | - | 0 | 0 | - |
| Dual Euro Recliners with End Table | - | - | - | 0 |
| Sectional Dinette | - | 0*1 | - | 0 |

0*1 - Exterior Entertainment Center is Not Available with the Sectional Dinette

❖ BEDROOM & BATH

| MODEL | 34ST | 36MQ | 40EX | 40GQ |
|---|------|------|------|------|
| King Size Denver Mattress "RV Supreme Euro Top" | S | S | S | S |
| Bedsprad with Throw Pillows | S | S | S | S |
| 12-volt Attic Fan in Bedroom | S | S | S | S |
| Full Height Shower with Door | S | S | S | S |
| Porcelain Toilet | S | S | S | S |

❖ KITCHEN

| MODEL | 34ST | 36MQ | 40EX | 40GQ |
|---|------|------|------|------|
| Stainless Steel Residential Refrigerator with In-Door Ice & Water Dispenser | S | S | S | S |
| 3-Burner Cooktop | S | S | S | S |
| 30" Stainless Steel Over-the-Range Convection Microwave Oven | S | S | S | S |
| Solid Surface Kitchen Countertop, Range Cover and Sink Covers | S | S | S | S |
| Single Lever Faucet with Sprayer & Water Filter | S | S | S | S |
| Tile Kitchen Backsplash | S | S | S | S |
| Mini Blinds at Kitchen Window | S | S | S | S |
| 12-volt Attic Fan | S | S | S | S |

❖ MULTIMEDIA

| MODEL | 34ST | 36MQ | 40EX | 40GQ |
|---|------|------|------|------|
| 46" HDTV in Living Area | S | S | S | S |
| 32" HDTV in Bedroom | S | S | S | S |
| 32" HDTV in Cockpit Overhead | 0 | 0 | 0 | 0 |
| 32" HDTV in Exterior Entertainment Center | 0 | 0*1 | 0 | 0 |
| Surround Sound Home Theater with Blue-Ray Disc/DVD Player | S | S | S | S |
| HD Video Distribution Via HDMI | S | S | S | S |
| Satellite Dish Prep | S | S | S | S |
| Stationary HD Satellite (DirecTV or Shaw Direct) | 0 | 0 | 0 | 0 |

❖ ELECTRICAL AND PLUMBING

| MODEL | 34ST | 36MQ | 40EX | 40GQ |
|--|------|------|------|------|
| Dual 15K BTU Ducted Central Air Conditioners with Heat Pumps | S | S | S | S |
| Dual 20K BTU Ducted Electronic Ignition Furnace | S | S | S | S |
| 50-amp, 120-volt Service | S | S | S | S |
| Onan RV QD 8000 Diesel Generator | S | S | S | S |
| Auto Gen Start | S | S | S | S |
| 2000-watt inverter / 100-amp Converter | S | S | S | S |
| (4) 6-volt Auxiliary House Batteries | S | S | S | S |
| Energy Management System | S | S | S | S |
| 10-gallon Gas/Electric Water Heater with Electric Ignition | S | S | S | S |
| Stackable Washer and Dryer | S | S | S | S |
| Enclosed Heated Potable and Holding Tanks | S | S | S | S |
| Black Tank Flush | S | S | S | S |
| E-Z Flow Water Panel with Whole-House Water Filtration | S | S | S | S |
| Exterior Shower | S | S | S | S |

❖ SAFETY & CONVENIENCE

| MODEL | 34ST | 36MQ | 40EX | 40GQ |
|--|------|------|------|------|
| Fire Extinguisher | S | S | S | S |
| Carbon Monoxide, Propane & Smoke Detectors | S | S | S | S |
| Systems Control Panel | S | S | S | S |
| Central Vacuum System | S | S | S | S |
| Exterior GFCI Recept | S | S | S | S |



40EX / IVORY SONATA DECOR / OLYMPIC CHERRY WOOD



40EX / IVORY SONATA DECOR / OLYMPIC CHERRY WOOD



OPTIONAL 32" EXTERIOR ENTERTAINMENT CENTER

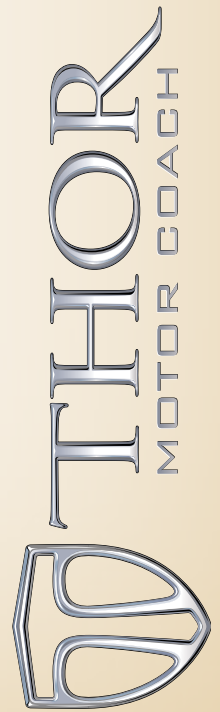

A INFORMATION CENTER

All vital information about the chassis and engine is well within arms reach. Crucial information about the trip such as M.P.G., Trip Distance, Engine Temperature and Cruise Speed are viewable in one place.

B TILT & TELESCOPING STEERING WHEEL

The TRW steering column infinitely adjusts to match the perfect driving position for every driver.

C TOUCH SCREEN DASH DISPLAY

The radio is equipped with a 7" screen, AM/FM/CD capabilities, and the side view camera's and back-up camera images display here when in use.

D EUROPEAN INSPIRED DASH

The smooth lines and subtle background colors of the dash wrap around you and immerse you in the driving experience. Identifying and navigating the controls and switches is a breeze with our thoughtful design.



NOW GET OUT AND ENJOY.
TUSCANYXTERV.COM

OUR SERVICE & WARRANTY PUTS YOU IN THE DRIVERS SEAT.

GOLD STAR INSPECTION

Every Thor Motor Coach must pass an extensive systems check, ensuring all of the major components are ready for the road ahead.

CONCIERGE CONNECTION

New owners receive a personalized contact right from the factory to answer questions about their new motorhome purchase.

24/7 SUPPORT

Day or night, highly trained Thor Motor Coach technicians can diagnosis and offer solutions to operational & service needs, providing owners with peace of mind.

RAPID RESPONSE

It is Thor Motor Coach's commitment to have essential parts stocked for quick shipment to get units back on the road.

ONE SOURCE WARRANTY

Consumers and dealers have the strength of Thor Motor Coach to help facilitate warranty service.



IMPORTANT-PLEASE READ: Information published within this brochure reflects product design, fabrication, material, components and specifications at the date of printing. If your vehicle was manufactured before this brochure was published this information may not be accurate because vehicles assembled before the brochure was published may not have the same design, fabrication, materials, components and specification as represented in the brochure. If your vehicle was manufactured after this sales brochure was published the representations may not be accurate because, for product improvement reasons, we reserve the unilateral right, at any time, without prior notice, to make changes in product design, material, components and specifications. The date the brochure was published (i.e. "Julian date") is set forth on the last page of the brochure. **IF CERTAIN INFORMATION PUBLISHED WITHIN THIS BROCHURE IS SIGNIFICANT TO YOUR PURCHASING DECISION, PLEASE CONSULT WITH YOUR SELLING DEALERSHIP TO CONFIRM THAT THE INFORMATION IS ACCURATE WITH RESPECT TO THE VEHICLE YOU ARE CONSIDERING PURCHASING.** Photographs in the brochure may depict optional equipment or may only be available in certain floor plans. We reserve the right to make changes in prices and models and to discontinue models without notice or obligation. Components, appliances and the chassis may have been manufactured in a calendar year before the vehicle's designated model year. All capacities are approximate. The actual length of the vehicle may differ from that indicated in the brochure due to variances in the manufacturing processes and/or installed components. All dry weights are based on standard model features and do not include optional features or equipment. Components, appliances and features may differ to conform to local codes. Due to EPA environmental restrictions, engine power and torque ratings may change during any model year. The Thor Motor Coach logo and its design are registered trademarks. Other products and company names are trademarks and/or registered trademarks of their respective manufacturer. While the color of the motorhome's exterior and the interior fabrics depicted in this brochure are fair and reasonable depictions, the colors depicted may not be exact match of the actual colors because of variances in photo processing and printing. Component part and appliance manufacturers issue limited warranties covering portions of the vehicle not covered under the limited warranty we issue. To learn specific details regarding warranty coverage please consult your selling dealership or review the warranty packet inside the vehicle.

YOUR LOCAL THOR MOTOR COACH DEALER:



P.O. BOX 1486 • ELKHART, IN 46515 • CUSTOMER SERVICE: 800-860-3812 • SALES DEPARTMENT: 800-860-5658 • TUSCANYRV.COM/XTE



COPYRIGHT THOR MOTOR COACH, INC. © 2013