



BANSHEE

2012

CAMPING TRAILERS



A NEW DAY BEGINS...GO GET IT!

2012 PALOMINO | CAMPING TRAILERS

BANSHEE » Floorplans

B SERIES

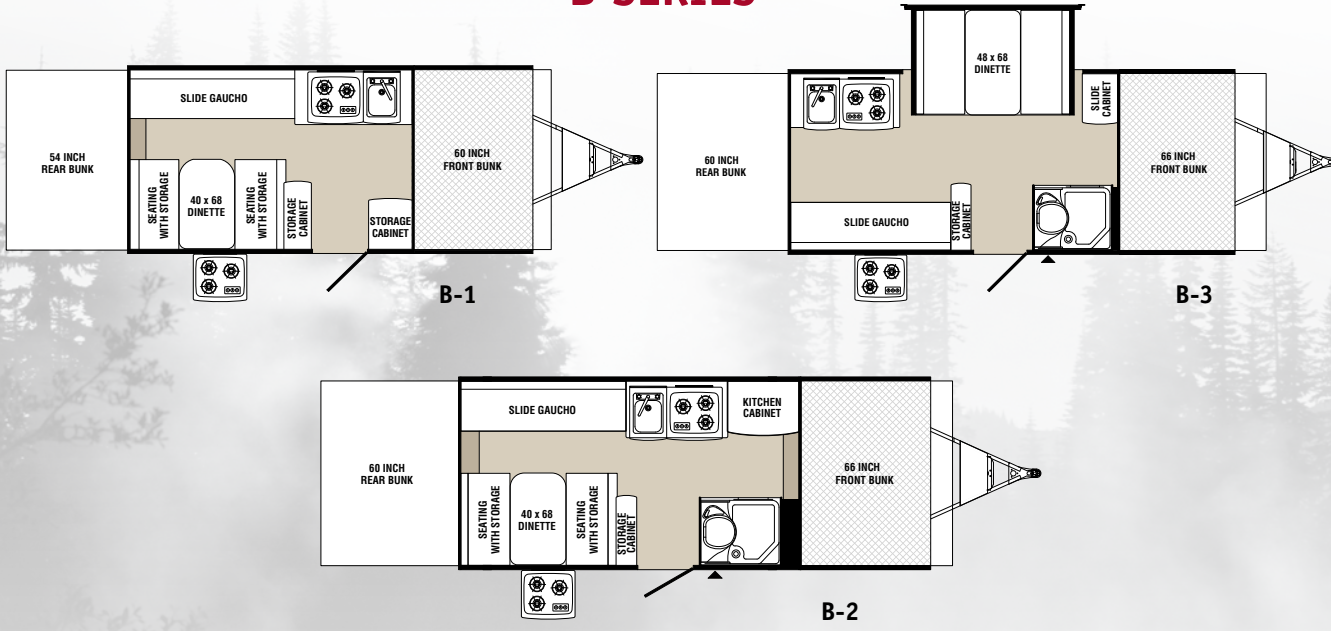

SV SERIES

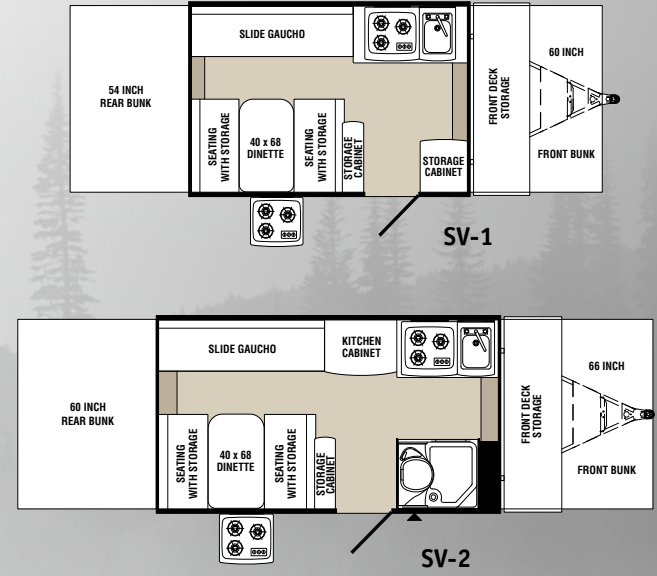

INTERIOR » SV-1



INTERIOR » B-3



BANSHEE » Standards & Options

STANDARDS

- » Aluminum Wheels
- » Dometic® A & E Awning
- » B.A.L. Jacks w/Sand Pads (4)
- » Clothes Bar
- » 25 AMP Converter w/Battery Charger
- » Double LP Gas Bottles w/Cover
- » Alko® Electric Brakes
- » Entry Step (2-Step)
- » Exterior 120 Volt GFI Outlet
- » Fiberglass Exterior Surface
- » Filon Fiberglass One-Piece Roof
- » Five-Piece Sectionalized Omnova® Tent
- » Gas DSI Water Heater

- » Hot Water Outside Shower w/Water Filter (Opt. B-1, SV-1)
- » 3-Burner Stove
- » Kitchen Faucet w/Water Pump
- » Outside Gas Grill
- » Patio Light
- » Roof Air Ready-Pre-Framed 14x14
- » Spare Tire, Bracket
- » Torsion Independent Suspension Easy Lube Axle
- » 23 Gal. Under Floor Water Tank (30 Gal. SV-1, SV-2)
- » Window Curtains & Vented Bed End Curtains

OPTIONS

- » 20,000 BTU Suburban Furnace
- » AM/FM CD Player

- » Air Conditioning - 13,500 BTU
- » Battery Box
- » Bunk Light w/Fan
- » Canadian Bottles & Tags
- » Carbon Monoxide Detector (Mandatory Option)
- » Create-A-Breeze™ Fan (Mandatory Option)
- » Dometic® Refrigerator - 3-Way - 2 Cu. Ft.
- » Electric Lift
- » Hanging Pantry
- » Hanging Wardrobe (N/A B-1)
- » Heated Bunk Mattresses (Mandatory Option)
- » Potti Privacy Drape (Std. B-2)
- » Screen Room w/Privacy Flaps
- » Hot Water Outside Shower w/Water Filter (Std. B-2, B-3, BSV-2)

BANSHEE » Specifications

	B-1	B-2	B-3	SV-1	SV-2
Travel Length	18' 8"	20' 9"	20' 8"	17' 0"	18' 5"
Travel Width	85"	85"	85"	85"	85"
Travel Height	64"	64"	64"	64"	64"
Interior Open Length	20' 2"	23' 10"	23' 10"	20' 2"	23' 10"
Interior Open Height	6' 7"	6' 7"	6' 7"	6' 7"	6' 7"
Front Sleeping Area	60" x 80"	66" x 80"	66" x 80"	60" x 80"	66" x 80"
Rear Sleeping Area	54" x 80"	60" x 80"	60" x 80"	54" x 80"	60" x 80"
Tire Size	15"	15"	15"	15"	15"
Fresh Water Capacity	36	42	42	36	42
Hitch Weight (Approx.) Dry	322 lbs.	363 lbs.	384 lbs.	217 lbs.	278 lbs.
Axle Weight (Approx.) Dry	2110 lbs.	2258 lbs.	2535 lbs.	1894 lbs.	2129 lbs.
Total Dry Weight	2432 lbs.	2621 lbs.	2919 lbs.	2111 lbs.	2407 lbs.
Cargo Capacity (Approx.) Dry	1183 lbs.	985 lbs.	758 lbs.	1210 lbs.	841 lbs.
Front Deck Size	54" x 83"	54" x 83"	54" x 83"	25" x 83"	25" x 83"
Awning	9'	11'	11'	11'	11'

AL-KO

B.A.L.
RV PRODUCTS GROUP

FAN-TASTIC VENT
Atwood Mobile Products, LLC

Dometic

Flair
INTERIORS



Learn More

Scan this barcode using a QR Reader on your smart phone to learn more about Forest River.



A Berkshire Hathaway company.



Follow Us On Facebook



Palomino RV

1047 East M-86 • Colon, MI 49040
Phone: (269) 432-3271 • Fax: (269) 432-2516
www.palominorv.com

All illustrations and specifications contained in this literature are based on the latest product information at time of publication. Palomino RV reserves the right to make changes in prices, colors, materials, equipment and specifications and to discontinue models at anytime without notice or obligation and assumes no responsibility for any error in this literature.

Palomino Camping Trailers are designed to meet the varied needs of the customer. It is the responsibility of the owner to select the proper load combination for their individual needs without exceeding the listed axle weight capacities.



Forest River, Inc. encourages our customers to purchase their Forest River products from a local dealership whenever possible for the following reasons:

- 1) Forest River, Inc. dealers are independently owned and operated businesses so priority service and scheduling is at their discretion and is often provided to customers that purchased their unit at that dealership.
- 2) Purchasing locally allows customers to establish meaningful relationships with a dealer, enhancing the RV experience through assistance with product questions, user tips or RV regulations for your state or country, and much more!
- 3) Canadian customers must meet requirements to bring an RV purchased out of the country to their home. These requirements may involve additional inspections and certifications, taxes and fees. Your local Canadian Dealer is a professional at meeting these requirements.
- 4) Scheduling timely warranty repairs and adjustments through a local dealership provides far greater flexibility and convenience to you, the customer!

It is the goal of Forest River, Inc. that all of our RV owners fully enjoy the RV experience and that customer satisfaction meets or exceeds their expectations!



PRE-DELIVERY INSPECTION FACILITY

20,000 square feet of quality assurance. The bare essentials for a premium product. This state-of-the-art facility gives immediate daily feedback to production for quality assurance in every unit built.

Dealer Information: