

2014 JAY FLIGHT TRAVEL TRAILERS BY JAYCO

JAY FLIGHT



NO MATTER WHERE YOUR ADVENTURES
TAKE YOU, TRAVEL IN CONFIDENCE WITH JAYCO
THE BEST WARRANTY IN THE BUSINESS



Read more about our industry-leading **2-YEAR WARRANTY** on the back cover!



Jayco®

Generations of family fun.



JAY FLIGHT 28BHBE | SANDALWOOD



JAY FLIGHT 32RLDS | PLATINUM



1

FLEXIBLE FOR FAMILIES

Making the most of space, select model dinettes feature a removable ottoman and roomy storage below, making this U-dinette a family must.

AMERICA'S BEST-SELLING TRAVEL TRAILER!



ON EVERY FAMILY'S WISHLIST

Spacious slideouts. Check. Well-planned living areas. Check. Residential-style amenities. Check. The **2014 JAY FLIGHT** travel trailer continues to be America's #1 selling travel trailer for eight years in a row. With an endless list of high-end features, Jay Flight exceeds your family's every wish.



JAY FLIGHT 28BHBE | SANDALWOOD



2 8 CU. FT. FRIDGE

Pack a few gallons of milk. With an 8 cu. ft. double-door refrigerator, Jay Flight boasts more space than a typical 6 cu. ft. fridge.



3 AMPLE STORAGE

There's no shortage of durable storage thanks to Amish-crafted cabinetry, complete with full-extension, 75-lb. rated ball bearing drawer guides.



4 DENVER MATTRESS

The secret to a good night's sleep? Your RV. With Jay Flight's standard pillowtop Denver Mattress, you can tell those numbered sheep to give it a rest, too.



JAY FLIGHT 28BHBE | SANDALWOOD

5 BUNK ROOMS

Jay Flight sleeps up to 12 thanks to multiple sleeping arrangements, featuring a variety of kid-friendly bunk room floorplans.

Superior craftsmanship starts at the top at Jayco.

We've built a reputation for superior construction and quality craftsmanship.

We pride ourselves on always using top-quality materials and innovative manufacturing techniques. That commitment has led to one of our latest construction advancements, the exclusive Magnum Truss Roof System. Fifty percent stronger than other roofs in the industry, this Jayco roof is built to weather Mother Nature.

OUR ROOF FEATURES ...

- 1 4 1/2" crowned wood trusses: Uses 2"x 2" vertical studs to maximize load capacity, while oversized nail plates provide a tighter design
- 2 3/8" roof decking, screwed down at every seam: More durable than typical stapled construction, provides a fully walkable roof
- 3 Residential attic-style insulation: Helps maintain interior temperatures
- 4 One-piece, sidewall-wrapped Alpha Ply material: Provides leak protection



TO LEARN MORE ABOUT OUR THE
MAGNUM TRUSS ROOF SYSTEM, SCAN
HERE WITH YOUR SMARTPHONE.

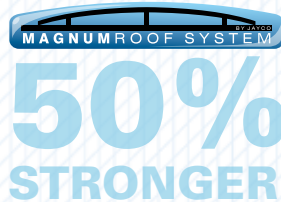

JAYCO'S ROOF



OTHER ROOFS



SCREWED CONSTRUCTION VS. STAPLED



OVERSIZED NAIL PLATES VS. SMALLER PLATES



2" X 2" VERTICAL WOOD STUDS VS. 1" ALUMINUM



7" HEADER BEAM VS. 2" X 6" LUMBER



4,500 LBS. ON A JAYCO ROOF VS. OTHER ROOFS

WALL CONSTRUCTION

- 5 2" x 2" wooden studs: Creates Jay Flight's long-lasting framework
- 6 Hand-tucked and glued fiberglass insulation (R-7): Prevents insulation from sagging over time (vs. blanket-insulation technique), while helping increase insulation value near studs
- 7 Extra-wide corner seals: Prevents leaks on the corner molds, baggage/entrance doors, window seals

FLOOR CONSTRUCTION

- 8 5/8" tongue-and-groove plywood deck on 2" x 3" wooden floor joists: Moisture resistant, plywood holds up to the elements
- 9 Fiberglass insulation (R-7): Maintains interior temperatures
- 10 Full-width outriggers: Supports wall weight with no more than 4-foot spacing (vs. 8-foot spacing) and wall-to-wall, full-width design

FEATURES

- 11 Galvanized-steel wheel wells: Reduces heat loss through floor; prevents floor damage in case of a blown tire
- 12 WaterWorks system: Boasts 75-plus gallons of fresh water
- 13 Innovative, aerodynamic front profile: Eliminates angled profile, increasing towability

STANDARDS AND OPTIONS



UTILITY LIGHTING SYSTEM

Every family needs a night light. Jay Flight provides light in all the right areas thanks to the standard utility lighting system, complete with entrance step light, baggage compartment light, hitch light and dump station light.

LED AWNING LIGHT

Jay Flight also features a new LED light strip on its optional electric awning to complete this patio package.



HIDE-A-BED

Your guests will rest well on a standard hide-a-bed sofa, complete with tri-fold Denver Mattress.



COMMAND CENTER

The command center hides all of your controls behind a convenient message board with 12V cell phone charger outlet.



BENCH STORAGE

Jay Flight is packed with innovative ways to maximize space, like the 28BHB's versatile storage bench.



BLACK TANK FLUSH

You'll love Jay Flight's standard black tank flush, especially since our WaterWorks system comes with 75-plus gallons of fresh water.

STANDARD EXTERIOR EQUIPMENT

- I-Class cambered structural-steel I-beam frame with fully integrated A-frame
- Magnum Truss Roof System with one-piece seamless Alpha Ply 5/8" tongue-and-groove plywood floor decking
- Two-sided reflective foil insulation in flush-floor slideout floors
- Electric slideouts with enclosed gear system (slide models)
- 30" x 72" main entrance door
- Utility lighting system
- Exterior marine-grade speakers (2)
- G20 dark-tint windows
- Radial tires with galvanized-steel, impact-resistant wheel wells
- E-Z Lube axles
- Spare tire with carrier
- Aerodynamic, rounded front profile with front diamond plate
- 30-amp power service
- Black tank flush sprayer
- WaterWorks system with 75+ gallon freshwater capacity and durable, winterized Tuff Pex water lines
- Stabilizer jacks with sand pads (4)

- 8 cu. ft. Norcold double-door refrigerator
- Atwood auto ignition furnace with wall thermostat
- Cable/satellite prep
- Denver Mattress pillowtop mattress
- Plywood bed, dinette and bunk bases
- J-Steel jack-knife sofa
- Diamondflor vinyl flooring
- Residential-grade carpet with padding
- Porcelain stool with foot flush
- 300-lb. rated bunks (600-lb. rating on double bunks)

CUSTOMER VALUE PACKAGE (MANDATORY)

- Dual 30-lb. propane bottles with easy access ABS cover
- Outside shower
- Water heater bypass
- 13,500-BTU air conditioner with directional/closeable vents
- Microwave with built-in hood over range
- Oven
- ABS shower surround with bath skylight and fan

POWER PACKAGE

- Power tongue jack
- Power awning with LED light

THERMAL PACKAGE

- Insulated, heated and enclosed underbelly and 2-sided reflective foil insulation in main roof and slideout roof

OPTIONS

- Customer Value Package with 15,000-BTU air conditioner
- Aluminum rims
- Chil N' Stor outside baggage compartment with 1.7 cu. ft. exterior refrigerator (select models)
- Electric stabilizer jacks
- Roof ladder
- Outside kitchen (select models)
- Outside bumper-mount grill
- Bike rack/cargo tray system (select models)
- Technology Package: 26" LED HDTV (32" on 32RLDS) and Premium Multi-Media Sound System with CD/DVD player (n/a on 33RLDS with Ledgestone fireplace option)
- Free-standing table with 4 chairs (select models)
- Swivel rockers in lieu of door-side sofa (2) (select models)
- Door-side hide-a-bed sofa (33RLDS)
- Hide-a-bed sofa with Denver Sleep System (most models)
- Ledgestone fireplace with 32" LED HDTV (select models)
- Linoleum living area (select models)
- 50-amp service (select models)
- 2nd air conditioner in bedroom (select models)
- Queen bed with bunk (19RD)
- Trundle beds in lieu of J-Cube (select models)
- J-Cube futon in lieu of folding bunk (select models)
- Double bunk over double bed (select models)

PLATINUM

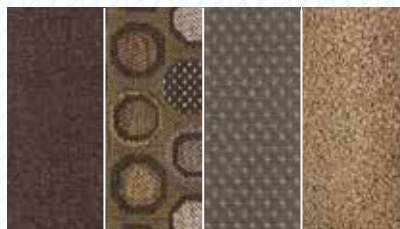

HAZELNUT

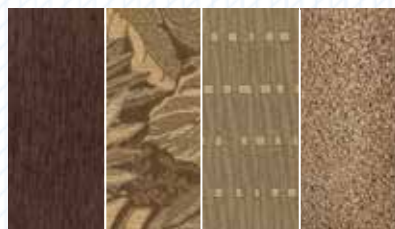

SANDALWOOD



- 1 Sofa
- 2 Accent
- 3 Bedspread
- 4 Carpet

FLOORPLANS

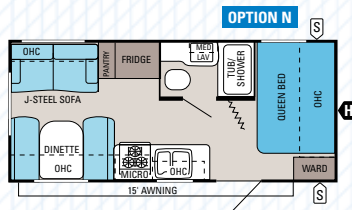

JAY FLIGHT | 19RD

Ext. Length: 23' 1" Ext. Height: 127" Unloaded Wt. (lbs.): 3,785 Sleeps: 4-7

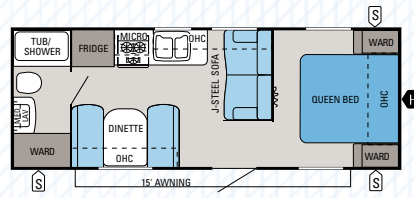

JAY FLIGHT | 22FB

Ext. Length: 26' 5" Ext. Height: 127" Unloaded Wt. (lbs.): 4,125 Sleeps: 4-6

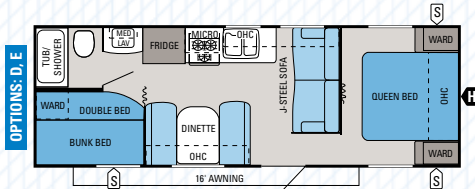

JAY FLIGHT | 26BH

Ext. Length: 29' 1" Ext. Height: 126" Unloaded Wt. (lbs.): 4,505 Sleeps: 7-9

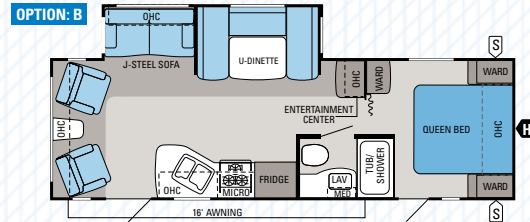

JAY FLIGHT | 26RLS

Ext. Length: 30' Ext. Height: 134" Unloaded Wt. (lbs.): 6,145 Sleeps: 4-6

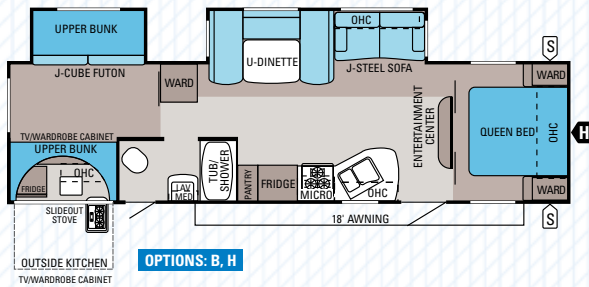

JAY FLIGHT | 32BHDS

Ext. Length: 35' 6" Ext. Height: 133" Unloaded Wt. (lbs.): 7,590 Sleeps: 8-10

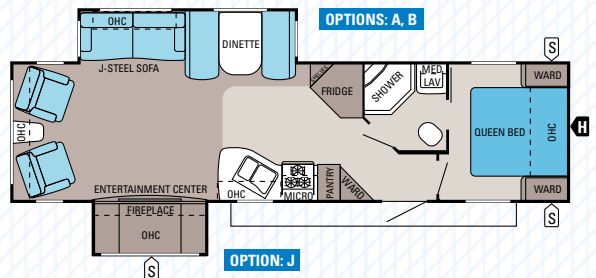

JAY FLIGHT | 32RLDS

Ext. Length: 35' 6" Ext. Height: 134" Unloaded Wt. (lbs.): 7,400 Sleeps: 3-6

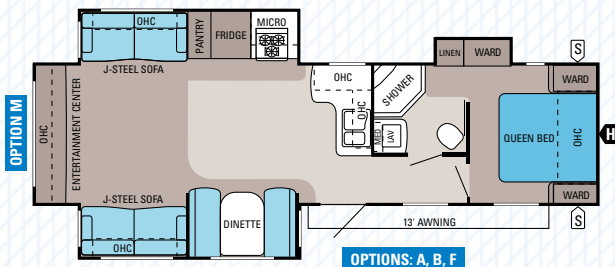

JAY FLIGHT | 33RLDS

Ext. Length: 35' 5" Ext. Height: 134" Unloaded Wt. (lbs.): 7,885 Sleeps: 3-8

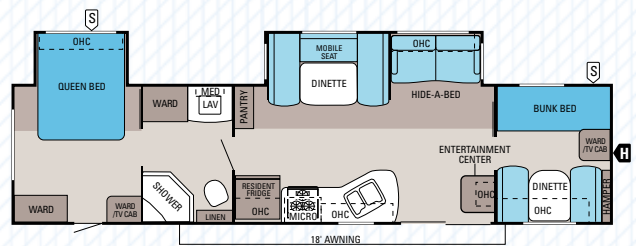

JAY FLIGHT | 36BHDS

Ext. Length: 37' 11" Ext. Height: 134" Unloaded Wt. (lbs.): 7,895 Sleeps: 8-10

OPTIONS

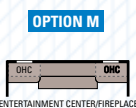
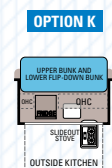
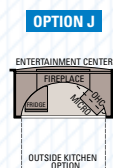
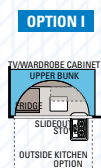
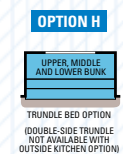
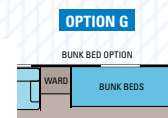
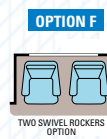
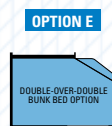
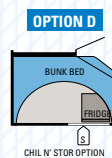
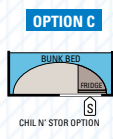
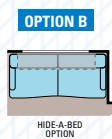
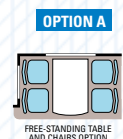

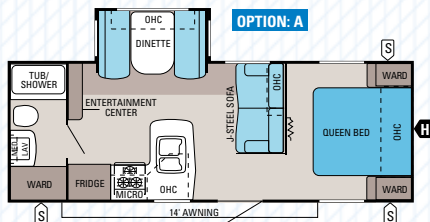

JAY FLIGHT | 24FBS

Ext. Length: 26' 11" Ext. Height: 132" Unloaded Wt. (lbs.): 4,860 Sleeps: 3-6

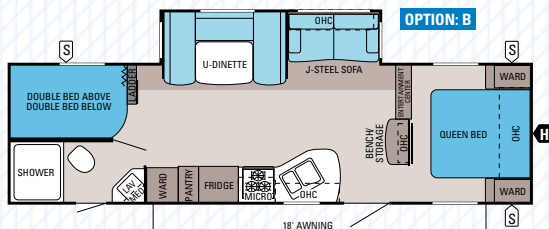

JAY FLIGHT | 28BHBE

Ext. Length: 33' 3" Ext. Height: 134" Unloaded Wt. (lbs.): 6,495 Sleeps: 8-10

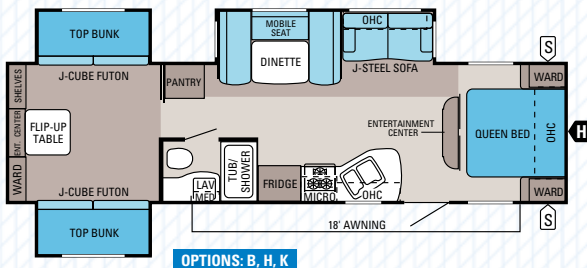

JAY FLIGHT | 32TSBH

Ext. Length: 35' 6" Ext. Height: 133" Unloaded Wt. (lbs.): 7,855 Sleeps: 11-12

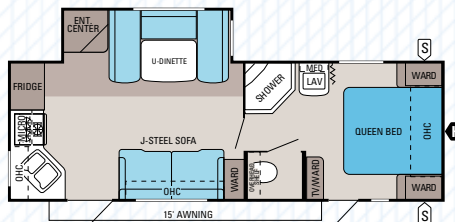

JAY FLIGHT | 25RKS

Ext. Length: 28' 8" Ext. Height: 134" Unloaded Wt. (lbs.): 5,830 Sleeps: 4-6

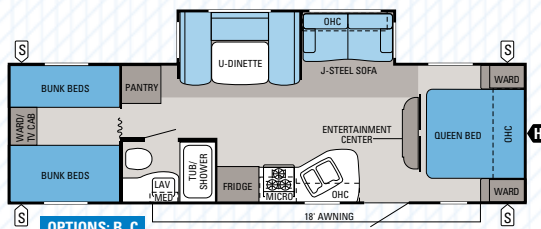

JAY FLIGHT | 29QBH

Ext. Length: 33' 3" Ext. Height: 134" Unloaded Wt. (lbs.): 6,415 Sleeps: 9-10

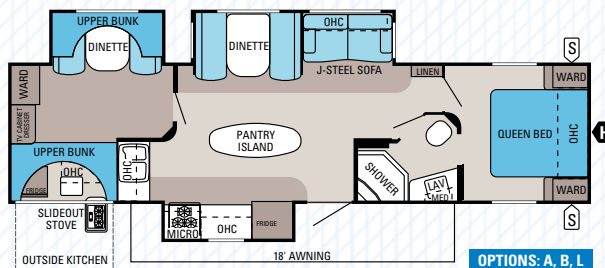

JAY FLIGHT | 33BHBS

Ext. Length: 36' 11" Ext. Height: 134" Unloaded Wt. (lbs.): 8,310 Sleeps: 6-10

SPECIFICATIONS

FLOORPLAN	EXTERIOR LENGTH	EXTERIOR WIDTH	EXTERIOR HEIGHT (WITH A/C)	INTERIOR HEIGHT	UNLOADED VEHICLE WEIGHT (LBS.)	DRY HITCH WEIGHT (LBS.)	GROSS VEHICLE WEIGHT RATING (LBS.)	CARGO CARRYING CAPACITY (LBS.)	FRESH WATER CAPACITY (GAL.) (WITH WATER HEATER)	GRAY WASTEWATER CAPACITY (GAL.)	TOILET/BLACK WASTEWATER CAPACITY (GAL.)
19RD	23' 1"	96"	127"	81"	3,785	430	6,200	2,415	90	32.5	32.5
22FB	26' 5"	96"	127"	81"	4,125	510	6,500	2,375	90	32.5	32.5
24FBS	26' 11"	96"	132"	81"	4,860	535	7,500	2,640	90	32.5	32.5
25RKS	28' 8"	96"	134"	81"	5,830	735	8,400	2,570	86	65	32.5
26BH	29' 1"	96"	126"	81"	4,505	445	7,500	2,995	90	32.5	32.5
26RLS	30'	96"	134"	81"	6,145	850	8,500	2,355	86	32.5	32.5
28BHBE	33' 3"	96"	134"	81"	6,495	700	9,250	2,755	86	32.5	32.5
29QBH	33' 3"	96"	134"	81"	6,415	800	9,250	2,835	86	32.5	32.5
32BHDS	35' 6"	96"	133"	81"	7,590	870	9,975	2,385	86	32.5	32.5
32RLDS	35' 6"	96"	134"	81"	7,400	980	10,250	2,850	86	32.5	32.5
32TSBH	35' 6"	96"	133"	81"	7,855	825	10,500	2,645	86	32.5	32.5
33BHBS	36' 11"	96"	134"	81"	8,310	885	10,500	2,190	86	65	32.5
33RLDS	35' 5"	96"	134"	81"	7,885	1,060	10,300	2,415	86	32.5	32.5
36BHDS	37' 11"	96"	134"	81"	7,895	920	10,500	2,605	90	32.5	32.5

The weights of certain options and/or option packages are not included in the UVW listed above.

Unloaded Vehicle Weight (UVW): Sometimes referred to as "Dry Weight," UVW means the typical weight of this trailer as built at the factory. The UVW, as used in product literature and other promotional materials, does not include cargo, fresh water, propane, options or dealer-installed accessories.

Gross Vehicle Weight Rating (GVWR): GVWR means the maximum permissible weight of the trailer, including the UVW plus passengers, personal items, all cargo, fluids, options, and dealer-installed accessories. The GVWR is equal to or greater than the sum of the UVW and the CCC.

Cargo Carrying Capacity (CCC): CCC means the maximum weight of all passengers, personal items, food, fresh water, propane, tools, other cargo and dealer-installed accessories that can be carried by the trailer. CCC is equal to or less than GVWR minus UVW. The addition of options will decrease the CCC.

Hitch Weight (HW): The hitch weight, as used in product literature and other promotional materials, does not include cargo, fresh water, propane gas, options or dealer-installed accessories. The addition of these types of items will either add to or subtract from the stated hitch weight.

It is important for your safety and enjoyment that your tow vehicle be adequately sized and equipped to tow and handle the GVWR of the RV you select. Review weights and rating of your tow vehicle and consult a competent advisor for questions or advice. Whether you are new to RVing or a veteran, get a feel for the performance of your tow vehicle before heading out on the roadways. When you tow an RV, you must drive differently than when you drive a single vehicle. Practice hooking up, driving, backing up and braking in a safe environment or seek out professional instruction. Jayco affixes a weight label to each RV which lists weight information for that vehicle. See specifications chart above.

2-YEAR WARRANTY

Peace of mind
comes standard



BUMPER
to
HITCH
LIMITED WARRANTY*

Nobody offers a better warranty than Jayco. With our exclusive 2-year Co-Pilot Warranty, the only strings we attach are those that deliver the ultimate in reliability. At Jayco, your peace of mind is our priority, and that's the Jayco difference.

*For a copy of our 2-year limited warranty with full terms and conditions, please contact your local Jayco dealer or visit Jayco.com.

300 JAYCO DEALERS

A four-decade strong network

From the sales experience to service after the sale, we consider our dealers to be an important part of the Jayco family. Establishing a solid relationship with your local Jayco dealer is a key component in the enjoyment of your new Jayco. By purchasing from a local dealer, you will have a convenient location for sales, parts and service support. We hope you consider them a part of your camping family.

Your local dealer

1-YEAR FREE

Roadside Assistance

Travel worry-free with Jayco's Customer First Roadside Assistance program, yours at no cost during your first year of ownership. This program is offered through Coach-Net, the country's largest RV emergency road service, and gives you immediate access to assistance.

Coach-Net
RV Technical & Roadside Assistance



Generations of family fun.

THE JAYCO STORY BEGAN IN 1968 WITH OUR FAMILY—THE BONTRAGERS. Lloyd Bontrager created an innovative, easy-to-use lifter system that led to a better fold-down camper. Loaded with more conveniences, he believed his camper would bring families closer together.

Since then, Jayco has helped generation after generation create family stories — good, old-fashioned family fun built around campfires with a Jayco RV nearby. At Jayco, we strive to build family-friendly products that will outlast just about everything but your memories. We'd love nothing more than to be a part of your family story. Join us in our generations of family fun.

eco advantage™

Jayco's long-term commitment
to protecting the environment



Scan this QR code with your smartphone to watch a video about our efforts and the impact we're making on our planet.
jayco.com/ecoadvantage

Follow us on



Jayco, Inc., P.O. Box 460, Middlebury, IN 46540, www.jayco.com  **RVIA**

See dealer for further information and prices. All information in this brochure is the latest available at the time of publication approval. Jayco reserves the right to make changes and to discontinue models without notice or obligation. Photos in this brochure may show optional equipment and props for photography purposes. RVs built for sale in Canada may differ to conform to Canadian codes. ©2013 Jayco, Inc. 14-JFLT-PL 0713-100K Printed in U.S.A.