

THOR
MOTOR COACH

THOR
MOTOR COACH

Palazzo 30

FUEL YOUR ADVENTURE WITH BEAUTY

PALAZZO



WELCOME TO THE GOOD LIFE

THOR MOTOR COACH IS THE #1 MANUFACTURER OF MOTORHOMES IN NORTH AMERICA. OUR AMERICAN MADE PRODUCTS OFFER A HIGHER LEVEL OF FUNCTION AND FEATURES. WITH THE STRENGTH OF THOR INDUSTRIES BEHIND US, WE ARE FINANCIALLY STRONG. BUILDING FROM MORE THAN 25 YEARS OF MANUFACTURING EXPERTISE, WE ARE COMMITTED TO OFFERING PRODUCTS THAT MEET AND EXCEED THE EXPECTATION OF TODAY'S CONSUMERS.



AT THOR MOTOR COACH WE CONTINUALLY CHALLENGE OUR ENGINEERING AND PRODUCT DEVELOPMENT TEAMS TO FIND THE "NEXT GREAT" THING IN MOTORHOMES. THIS CHALLENGE IS FOCUSED ON YOU, OUR CUSTOMERS. IT IS BECAUSE OF THIS FOCUS WE ARE DRIVEN TO CREATE GREAT PRODUCTS.

WHEN YOU STEP INTO A NEW THOR MOTOR COACH MOTORHOME, WE HOPE THAT IT IS ONLY THE BEGINNING OF WHAT WILL BE YOUR... GOOD LIFE!



BLACK CANYON



BOARDWALK



PARK AVENUE



RIDGEWOOD

STUNNING BEAUTY & FEATURES



A FULL BODY PAINT

A striking exterior graphics design provides a jaw-dropping appearance. The paint process includes multiple layers of paint and clear coat to provide a silky exterior finish.

B LARGE PASS-THRU STORAGE

Multiple compartments provide plenty of space to take everything along on the trip. Most models have a larger pass-thru compartment that even includes a sliding tray to increase capacity.

C FRAMELESS WINDOWS

Sleek, automotive-styled, frameless windows look great with an added twist of functionality. The windows are hinged to open outward for ventilation, even in rainy weather.

D POWER PATIO AWNING

A legless, lateral arm awning is fully encased in a metal box protecting it during driving. When extended, the awning does not have legs intruding into the camp area and it has the ability to self-retract in windy situations.

E SIDE VISION CAMERAS

Integrated into the exterior mirror housing, vastly increase the line of sight along the side of the coach helping keep you safe out on the road.

MORE THAN SKIN DEEP

A HOUSE NEEDS A STRONG FOUNDATION AND THAT INCLUDES A HOME THAT ROLLS DOWN THE ROAD. WE HAVE PARTNERED WITH FREIGHTLINER CUSTOM CHASSIS AND MOR/RYPDE MANUFACTURING TO ENGINEER THE BEST FOUNDATION IN THE BUSINESS. FREIGHTLINER'S ADVANCED CHASSIS TECHNOLOGY PROVIDES A SAFE AND STABLE



The finest products start with the best ingredients.

PLATFORM FOR MANEUVERING THE COACH DOWN THE ROAD, WHILE MOR/RYPDE'S STEEL STRUCTURE ENSURES THE PERFECT INTEGRATION OF CHASSIS TO THE HOME.

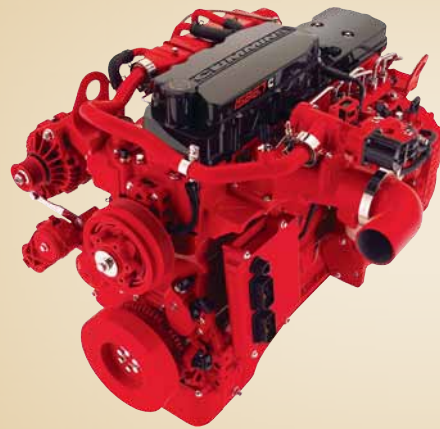

BACKED BY CUMMINS POWER

Premium motorhome buyers don't settle for second best. That's why Cummins is the number-one choice for diesel power. The Palazzo's ISB diesel engine is mated to a 6-speed Allison automatic transmission, providing 300-HP and 660 ft.lb. of torque. This combination delivers maximum performance, reliability and durability.

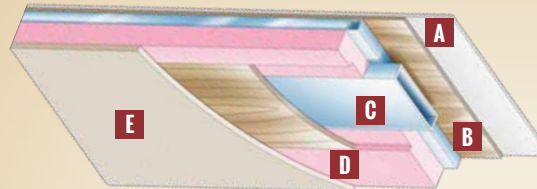

ROOF

- A** One-piece exterior TPO membrane
- B** Luan panels
- C** Aluminum structure with bowed framing
- D** Block foam insulation
- E** Interior panel with soft touch vinyl covering

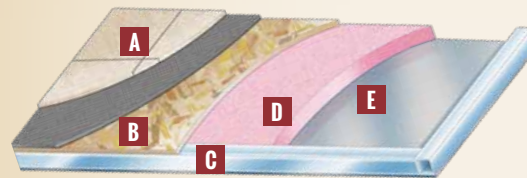

FLOOR

- A** Residential vinyl flooring or carpet
- B** OSB structure wood base
- C** Structural steel framing
- D** Block foam insulation
- E** Luan with woven plastic exterior finish

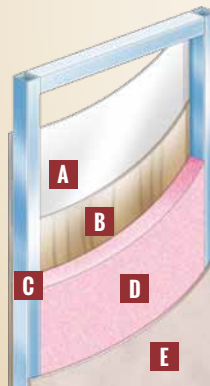

SIDEWALLS

- A** High-gloss or gel-coat fiberglass
- B** Luan panels
- C** Aluminum structure and framing at all openings
- D** Block Foam insulation
- E** Interior panel with designer wall covering

All roof, wall and floor structures are vacuum bond laminated. This process ensures constant and consistent glue coverage over all layers of the structure. This time sensitive process is necessary to provide stronger and more secure motorhomes with increased longevity.

SUPERIOR STRENGTH



A 55° WHEEL CUT

With 55-degrees of wheel cut, turning circles can be drastically reduced. The Palazzo can turn around in even the tightest of spaces.

B STEEL STRUCTURE

The steel structure below the floor is rigid and capable of enduring the stresses of driving down the road. Steel trusses span the frame both vertically and horizontally to make the strongest motorhome foundation.

C DEF TANK

Almost all truck stops offer DEF in bulk at the pump, but only on the driver's side of the island. The Palazzo is thoughtfully designed to include a DEF tank that's easy to fill.

D 10,000 LBS. HITCH

The diesel engine has plenty of torque to pull the heaviest of towed vehicles. The hitch includes a 7-way round connector for ease of use.





OLYMPIC CHERRY



VINTAGE MAPLE



RHAPSODY



SUMMER SONG



SUMMIT PARK

YOU DESERVE THE FINER THINGS IN LIFE

THERE ARE MANY REASONS WHY PALAZZO HAS GAINED THE LARGEST MARKET SHARE GROWTH FOR ANY DIESEL PUSHER IN NORTH AMERICA. RELIABLE PERFORMANCE, STRIKING GOOD LOOKS AND UNBEATABLE VALUE ARE JUST A FEW EXAMPLES. A FINE SELECTION OF WOOD COLORS AND DÉCORS CAN MAKE THE PALAZZO YOUR VERY OWN.



36.1 / SUMMER SONG DECOR / OLYMPIC CHERRY WOOD

EVERY DETAIL WELCOMES YOU HOME

UNSURPASSED ATTENTION TO DETAIL IS ENGINEERED INTO EVERY PALAZZO FLOOR PLAN. ORGANIZED KITCHEN WORKSPACES AND CREATIVE FURNITURE LAYOUTS FEEL LIKE HOME. CREATIVE BATHROOM ARRANGEMENTS AND BEDROOM DWELLINGS MAKE THE MOST OF SPACE WHILE REMAINING COMFORTABLE AND FUNCTIONAL. EVERY DETAIL IN THE PALAZZO SEEMS TO SAY, "WELCOME".

It's all about a great night's sleep. With the Denver Mattress™ Weekender model, you will get that and more. Luxury and comfort never felt so good.



ELECTRIC DROP DOWN OVERHEAD BUNK



33.2 BATHROOM



33.3 BUNK BEDS



36.1 / SUMMER SONG DECOR / OLYMPIC CHERRY WOOD

SPECIFICATIONS

| | |
|-------------------------------------|------------------|
| Chassis | Freightliner XCS |
| Gross Vehicle (GVWR) | 26,000 |
| Gross Combined (GCWR) | 30,000 |
| Wheel Base | 208" |
| Exterior Length (w/o ladder)* | 34'-8" |
| Exterior Height (w/ AC) | 11'-10" |
| Exterior Width (w/o mirrors) | 101" |
| Interior Height | 82" |
| Awning Size | 18' |
| Fuel (gal) | 90 |
| LPG (lbs) | 104 |
| Fresh/Waste/Grey Water (gal) | 95/43/43 |
| Water Heater (gallons) | 10 |
| Furnace (BTUs) | 35,000 |
| Exterior Storage Capacity (cu. ft.) | 126 |

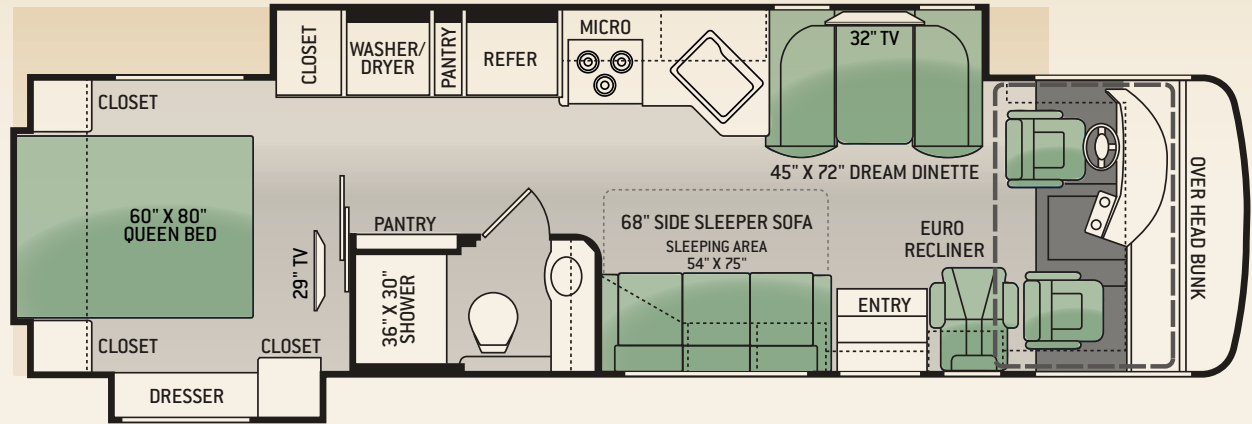

33.2

| | |
|-------------------------------------|------------------|
| Chassis | Freightliner XCS |
| Gross Vehicle (GVWR) | 26,000 |
| Gross Combined (GCWR) | 30,000 |
| Wheel Base | 208" |
| Exterior Length (w/o ladder)* | 34'-8" |
| Exterior Height (w/ AC) | 11'-10" |
| Exterior Width (w/o mirrors) | 101" |
| Interior Height | 82" |
| Awning Size | 18' |
| Fuel (gal) | 90 |
| LPG (lbs) | 104 |
| Fresh/Waste/Grey Water (gal) | 95/43/43 |
| Water Heater (gallons) | 10 |
| Furnace (BTUs) | 35,000 |
| Exterior Storage Capacity (cu. ft.) | 126 |

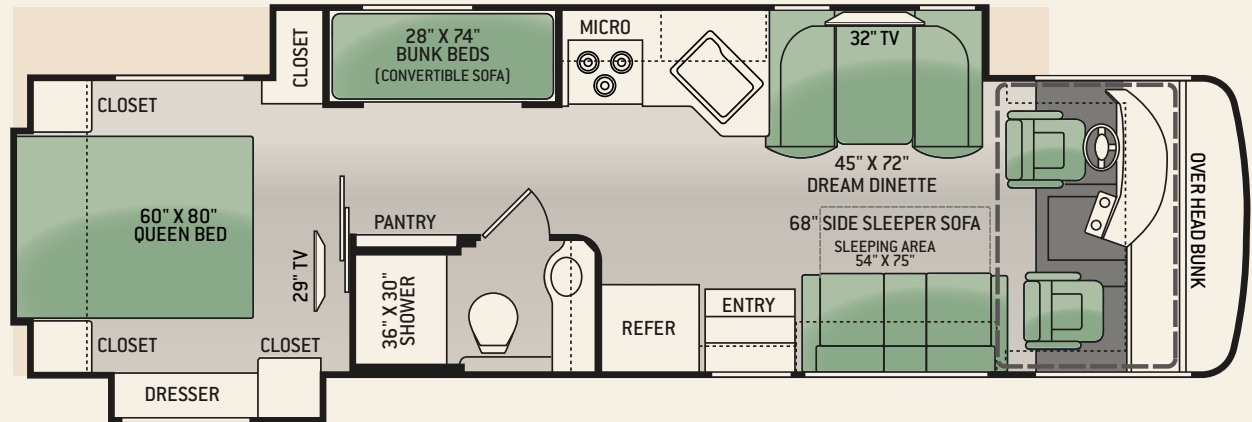

33.3

THE PALAZZO OFFERS A WIDE VARIETY OF FLOOR PLANS TO SUIT YOUR WAY OF LIFE. FAMILIES OF ALL SIZES WILL APPRECIATE THE NUMEROUS LAYOUTS AVAILABLE TO SUIT EVERY LIFESTYLE. EVERY INCH OF SPACE, INSIDE AND OUTSIDE, IS DESIGNED TO MAKE LIFE OUT ON THE ROAD MORE LIVABLE.

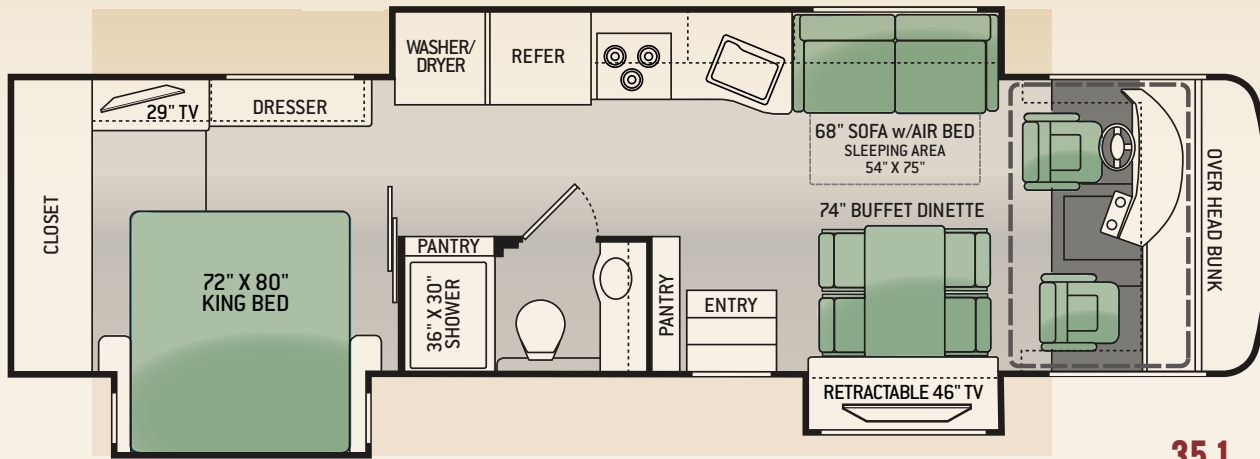

35.1

| Chassis | Freightliner XCS |
|-------------------------------------|------------------|
| Gross Vehicle (GVWR) | 28,000 |
| Gross Combined (GCWR) | 33,000 |
| Wheel Base | 220" |
| Exterior Length (w/o ladder)* | 35'-8" |
| Exterior Height (w/ AC) | 12'-0" |
| Exterior Width (w/o mirrors) | 101" |
| Interior Height | 82" |
| Awning Size | 18' |
| Fuel (gal) | 90 |
| LPG (lbs) | 104 |
| Fresh/Waste/Grey Water (gal) | 95/43/43 |
| Water Heater (gallons) | 10 |
| Furnace (BTUs) | (2) 20,000 |
| Exterior Storage Capacity (cu. ft.) | 130 |

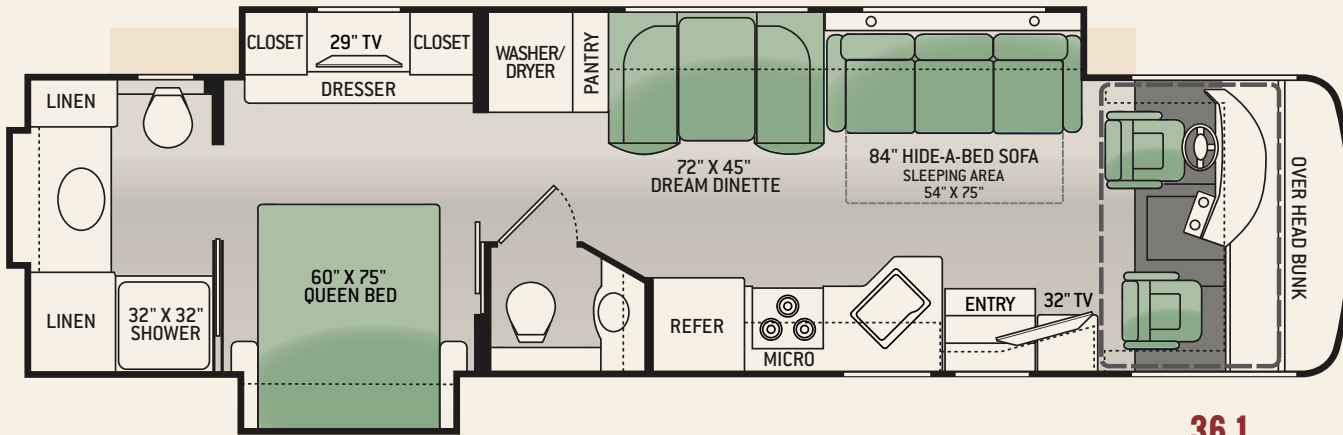

36.1

| Chassis | Freightliner XCS |
|-------------------------------------|------------------|
| Gross Vehicle (GVWR) | 28,000 |
| Gross Combined (GCWR) | 33,000 |
| Wheel Base | 242" |
| Exterior Length (w/o ladder)* | 37'-6" |
| Exterior Height (w/ AC) | 12'-0" |
| Exterior Width (w/o mirrors) | 101" |
| Interior Height | 82" |
| Awning Size | 17' |
| Fuel (gal) | 90 |
| LPG (lbs) | 104 |
| Fresh/Waste/Grey Water (gal) | 95/60/43 |
| Water Heater (gallons) | 10 |
| Furnace (BTUs) | 35,000 |
| Exterior Storage Capacity (cu. ft.) | 170 |

❖ **CHASSIS**

| MODEL | 33.2 | 33.3 | 35.1 | 36.1 |
|--|------|------|------|------|
| Freightliner® XGS Straight Rail Chassis | S | S | S | S |
| Cummins® ISB Diesel Engine (300 hp., 660-ft./lb. torque) | S | S | S | S |
| 6-Speed Allison Automatic Transmission | S | S | S | S |
| Full Air Front Disc and Rear Drum Anti-Lock Brakes | S | S | S | S |
| Exhaust Brake | S | S | S | S |
| I-Beam Front Axle with 55° Wheel Cut | S | S | S | S |
| Air-Ride Suspension | S | S | S | S |
| 22.5" Tires with Stainless Steel Wheel Liners | S | S | S | S |
| 10,000 lb. Trailer Hitch | S | S | S | S |
| Automatic Leveling Jacks with Touch Pad Controls | S | S | S | S |
| Dual Fuel Fills | S | S | S | S |
| Under-Hood Light | S | S | S | S |

❖ **CONSTRUCTION & EXTERIOR**

| MODEL | 33.2 | 33.3 | 35.1 | 36.1 |
|---|------|------|------|------|
| One-Piece Fiberglass Front and Rear Caps | S | S | S | S |
| Invisible Bra | S | S | S | S |
| One-Piece Windshield | S | S | S | S |
| Full-Body Paint with Gel-Coat Walls | S | S | S | S |
| Fiberglass Lined, Pass-Through Basement Storage (Select Compartments) | S | S | S | S |
| Side Hinged Flush Mount Radius Luggage Doors | S | S | S | S |
| Electric Patio Awning | S | S | S | S |
| Slide Out Topper Awnings | S | S | S | S |
| Frameless Dual Pane Windows | S | S | S | S |
| Roof Ladder | S | S | S | S |
| Automatic Leveling Jacks with Touch Pad Controls | S | S | S | S |
| Automatic Electric Entry Step | S | S | S | S |
| Outside Shower | S | S | S | S |
| Dual Fuel Fills | S | S | S | S |
| Low Profile Basement Slide Tray | S | S | - | S |

❖ **AUTOMOTIVE/COCKPIT**

| MODEL | 33.2 | 33.3 | 35.1 | 36.1 |
|---|------|------|------|------|
| Touch Screen Dash Radio with CD Player and Back-up Monitor | S | S | S | S |
| Heated, Remote Exterior Mirrors with Integrated Side View Cameras | S | S | S | S |
| Power Front Roller Shade with Accordion Style Side Window Shades | S | S | S | S |
| Generator Start Switch on Dash | S | S | S | S |
| Ceiling Mounted Dome Light with Dash Switch | S | S | S | S |
| Reclining/Swivel Leatherette Captain's Chairs | S | S | S | S |
| Six-way Power Driver Seat | S | S | S | S |
| Fog Lights | S | S | S | S |
| PC Workstation with 110-volt & 12-volt Outlets | S | S | S | S |

❖ **INTERIOR**

| MODEL | 33.2 | 33.3 | 35.1 | 36.1 |
|---|------|------|------|------|
| Residential Vinyl Flooring Throughout | S | S | S | S |
| Hardwood Raised Panel Cabinet Doors | S | S | S | S |
| Hardware with Nickel Finish | S | S | S | S |
| Soft Touch Vinyl Ceiling | S | S | S | S |
| LED Ceiling Lighting | S | S | S | S |
| Solar & Privacy Shades - Living Area | S | S | S | S |
| Leatherette Euro-Recliner with Integrated Ottoman | S | - | - | - |
| Leatherette Hide-a-Bed Sofa with Air Mattress | S | S | S | S |
| Free Standing Buffet Dinette with 4 Chairs | - | - | S | - |
| Dream Dinette | S | S | - | S |
| Electric Drop Down Overhead Bunk | S | S | S | S |

❖ **KITCHEN**

| MODEL | 33.2 | 33.3 | 35.1 | 36.1 |
|--|------|------|------|------|
| 18 cuft Whirlpool® Residential Refrigerator | S | S | S | S |
| 3-Burner High-Output Gas Cooktop | S | S | S | S |
| 30" Over-the-Range Microwave Oven | S | S | S | S |
| Solid Surface Countertops | S | S | S | S |
| Large Double Bowl Sink w/Single Lever Kitchen Faucet | S | S | S | S |
| 12-volt Attic Fan | S | S | S | S |

❖ **ENTERTAINMENT**

| MODEL | 33.2 | 33.3 | 35.1 | 36.1 |
|--|------|------|------|------|
| 46" HD Television in Living Room | - | - | S | - |
| Always-in-View 32" HD Television in Living Room Entertainment Center | S | S | - | S |
| DVD Player with Surround Sound Bar | S | S | S | S |
| 29" HD Television in Bedroom | S | S | S | S |
| A 13" and a 22" HD Televisions in Bunks | - | S | - | - |
| Exterior 32" HD Television | S | S | S | 0 |
| HD/DSS Satellite Prep | S | S | S | S |
| Cable Television Prep | S | S | S | S |

❖ **BEDROOM & BATH**

| MODEL | 33.2 | 33.3 | 35.1 | 36.1 |
|---|------|------|------|------|
| King-Size Denver Mattress Weekender | - | - | S | - |
| Queen-Size Denver Mattress Weekender | S | S | - | S |
| Bedsread and Pillow Shams | S | S | S | S |
| Attractive Headboard and Sconce Wall Lighting | S | S | S | S |
| Porcelain Toilet | S | S | S | S |
| Over-sized Shower with Glass Door | S | S | S | S |
| 12-volt Attic Fan in Bathroom | S | S | S | S |

❖ **ELECTRICAL AND PLUMBING**

| MODEL | 33.2 | 33.3 | 35.1 | 36.1 |
|---|------|------|------|------|
| Onan® RV QD 6000 Diesel Generator | S | S | S | S |
| Automatic Generator Start | - | S | S | S |
| Dual 13,500 BTU Ducted Roof Air Conditioners | S | S | S | S |
| Dual 20,000 BTU Ducted Electronic Ignition Furnaces | - | - | S | - |
| 35,000 BTU Ducted Electronic Ignition Furnace | S | S | - | S |
| 10-gallon Gas/Electric Water Heater | S | S | S | S |
| Water Heater Bypass System | S | S | S | S |
| Four Auxiliary House Batteries | S | S | S | S |
| 50-amp Service Power Cord | S | S | S | S |
| Black Tank Flush | S | S | S | S |
| Outside Shower | S | S | S | S |
| Stackable Washer/Dryer | S | - | S | S |

❖ **SAFETY & CONVENIENCE**

| MODEL | 33.2 | 33.3 | 35.1 | 36.1 |
|---------------------------------------|------|------|------|------|
| Entry Door with Dead bolt Lock | S | S | S | S |
| Systems Control Center | S | S | S | S |
| Smoke, LPG, Carbon Monoxide Detectors | S | S | S | S |
| Fire Extinguisher | S | S | S | S |
| Valve Stem Extenders on Rear Tires | S | S | S | S |



35.1 / SUMMER SONG DECOR / OLYMPIC CHERRY WOOD



35.1 / SUMMER SONG DECOR / OLYMPIC CHERRY WOOD



A AUTO LEVELING JACK CONTROL

Provides immediate access & availability to operations of jacks as needed, with one simple and convenient control.

B INFORMATION CENTER

With a touch of a button, vital information on operation of the coach is at your fingertips. And so is peace of mind and convenience.

C TOUCH SCREEN RADIO

Large, easy to view screen makes changing channels and modes a breeze. No extra multiple buttons and controls to clutter the dash.

D MULTIPLE CUP HOLDERS

Multiple cup holders provide plenty of spaces for all your favorite beverages.



NOW GET OUT AND ENJOY.
PALAZZORV.COM

OUR SERVICE & WARRANTY PUTS YOU IN THE DRIVERS SEAT.

GOLD STAR INSPECTION

Every Thor Motor Coach must pass an extensive systems check, ensuring all of the major components are ready for the road ahead.

CONCIERGE CONNECTION

New owners receive a personalized contact right from the factory to answer questions about their new motorhome purchase.

24/7 SUPPORT

Day or night, highly trained Thor Motor Coach technicians can diagnosis and offer solutions to operational & service needs, providing owners with peace of mind.

RAPID RESPONSE

It is Thor Motor Coach's commitment to have essential parts stocked for quick shipment to get units back on the road.

ONE SOURCE WARRANTY

Consumers and dealers have the strength of Thor Motor Coach to help facilitate warranty service.



IMPORTANT-PLEASE READ: Information published within this brochure reflects product design, fabrication, material, components and specifications at the date of printing. If your vehicle was manufactured before this brochure was published this information may not be accurate because vehicles assembled before the brochure was published may not have the same design, fabrication, materials, components and specification as represented in the brochure. If your vehicle was manufactured after this sales brochure was published the representations may not be accurate because, for product improvement reasons, we reserve the unilateral right, at any time, without prior notice, to make changes in product design, material, components and specifications. The date the brochure was published (i.e. "Julian date") is set forth on the last page of the brochure. **IF CERTAIN INFORMATION PUBLISHED WITHIN THIS BROCHURE IS SIGNIFICANT TO YOUR PURCHASING DECISION, PLEASE CONSULT WITH YOUR SELLING DEALERSHIP TO CONFIRM THAT THE INFORMATION IS ACCURATE WITH RESPECT TO THE VEHICLE YOU ARE CONSIDERING PURCHASING.** Photographs in the brochure may depict optional equipment or may only be available in certain floor plans. We reserve the right to make changes in prices and models and to discontinue models without notice or obligation. Components, appliances and the chassis may have been manufactured in a calendar year before the vehicle's designated model year. All capacities are approximate. The actual length of the vehicle may differ from that indicated in the brochure due to variances in the manufacturing processes and/or installed components. All dry weights are based on standard model features and do not include optional features or equipment. Components, appliances and features may differ to conform to local codes. Due to EPA environmental restrictions, engine power and torque ratings may change during any model year. The Thor Motor Coach logo and its design are registered trademarks. Other products and company names are trademarks and/or registered trademarks of their respective manufacturer. While the color of the motorhome's exterior and the interior fabrics depicted in this brochure are fair and reasonable depictions, the colors depicted may not be exact match of the actual colors because of variances in photo processing and printing. Component part and appliance manufacturers issue limited warranties covering portions of the vehicle not covered under the limited warranty we issue. To learn specific details regarding warranty coverage please consult your selling dealership or review the warranty packet inside the vehicle.

YOUR LOCAL THOR MOTOR COACH DEALER:



P.O. BOX 1486 • ELKHART, IN 46515 • CUSTOMER SERVICE: 800-860-3812 • SALES DEPARTMENT: 800-860-5658 • PALAZZORV.COM

COPYRIGHT THOR MOTOR COACH, INC. © 2013

