



# REDHAWK

2014 MOTORHOMES BY JAYCO

RAISE YOUR **EXPECTATIONS.**



2014 REDHAWK | MOTORHOMES BY JAYCO



Read more about our industry-leading **2-YEAR WARRANTY** on the back cover!





# REDHAWK

WE ANTICIPATED THE NEEDS  
YOU DIDN'T KNOW YOU HAD.



The 2014 Redhawk makes the journey as fun as the destination!

Packed with an extraordinary list of standard features, Jayco's most affordable Class C — the 2014 Redhawk — is equipped with everything you need at a price you wouldn't expect. Remote-controlled side-view mirrors, an electric-powered entry step, 400-watt inverter and an Onan 4,000-watt generator deliver complete power. So take that next step up and know you made the right move.

## FEATURES FOR THE ROAD. ENJOY A SMOOTH RIDE.

305 HP ENGINE



### TRITON ENGINE

Thanks to a robust 305 HP Triton engine, Redhawk boasts 19,500 GCWR with up to 5,000 lbs. of towing capacity on a Ford E-450 chassis.

HELLWIG SPRINGS



### HANDLING

- ① Hellwig helper springs and
- ② rubber-isolation body mounts stabilize and quiet the ride.

MORE CLEARANCE



### ENTRY STEPS

The standard, electric-powered, double-entrance step has 37% more clearance than other motorhome steps when closed.





High-end kitchen with Washington Glazed cabinetry

Queen-sized bed with Denver Mattress and bedspread



REDHAWK 29XK | PRALINE



REDHAWK 29XK | PRALINE



REDHAWK 29XK | PRALINE

Bunk beds in the 31XL for a maximum 9-person sleeping capacity



REDHAWK 31XL | PRALINE

## STANDARD FEATURES THAT SURPASS EXPECTATIONS.



### 32" LED TV

Prepare to be entertained. A 32" LED TV turns Redhawk into your home away from home.



### AWNING

Finding shade is easy thanks to an electric awning with push-button adjustable pitch.



### WINDOWS

Redhawk boasts frameless windows, a standard feature you won't find on other motorhomes at this price point!



# JAYCO CONSTRUCTION

At Jayco, we've built a reputation for superior construction and craftsmanship. We always use top-quality materials and innovative manufacturing techniques—down to the smallest details. The result? Unmatched resale value and peace of mind in an RV that's built to handle whatever the road throws at it, while outlasting everything but your memories.

## INTERIOR DÉCOR CHOICES

### TOFFEE

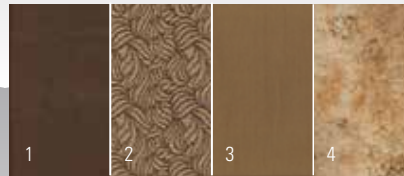

### PRALINE

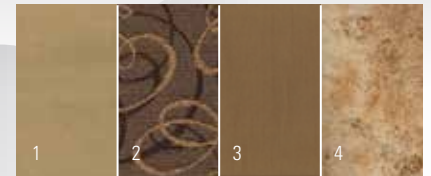

- 1 Sofa and Driver/ Passenger Seats
- 2 Accent
- 3 Drapery
- 4 Vinyl Flooring



## WALL CONSTRUCTION

- 1 Vacuum bonded:** Features laminated layers of high-gloss fiberglass, luan, aluminum framing, R-7 bead-foam insulation and vinyl paneling
- 2 Seamless fiberglass front cap:** Boasts an industry-best 30-month warranty in which Jayco will repair or replace any cap found to be defective 30 months after manufacture date\*
- 3 Standard frameless windows:** An industry-first feature, creates a stunning exterior package

## FLOOR CONSTRUCTION

- 4 Vacuum bonded:** Features laminated layers of Darco underbelly, a welded aluminum frame, R-9 bead-foam insulation and 5/8" Structurwood
- 5 Welded aluminum frame:** Lighter and more corrosion-resistant than competing steel floors, this frame provides more cargo capacity
- 6 Structurwood floors:** Features wood strips that are compressed and bonded with wax and resin adhesives; these high-mechanical properties make Structurwood ideal for long-lasting durability

## ROOF CONSTRUCTION

- 7 Vacuum-bonded layers:** Features laminated layers of 5" arched aluminum trusses, moisture-resistant 1/4" plywood decking, R-23 bead-foam insulation and hardboard ceiling
- 8 Seamless one-piece rubber roof:** Features one-piece construction for better leak protection

## PERFORMANCE

- 9 Ford E-450 chassis and Triton 6.8L V-10 305 HP engine:** Features 19,500 lbs. GCWR with up to 5,000 lbs. of towing capacity
- 10 MOR/ryde frame:** Extends chassis for optimal weight distribution and features one-piece, laser-shear construction for a tight-fit design
- 11 Hellwig helper springs with rubber body mounts:** Work with existing springs to give the RV more support, improving sway control under heavy loads while dampening vibration throughout the unit

\* See warranty policy for details; Customer Value Package

## FLOORPLANS

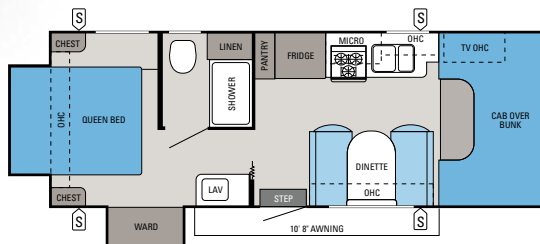

### REDHAWK | 23XM

Ext. Length: 26' 9" Exterior Height: 139" Sleeps: 6-7

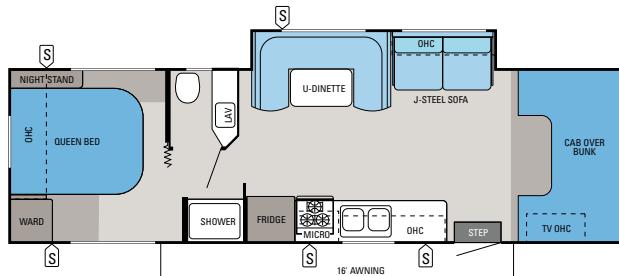

### REDHAWK | 29XK

Ext. Length: 32' 5" Exterior Height: 139" Sleeps: 6-7

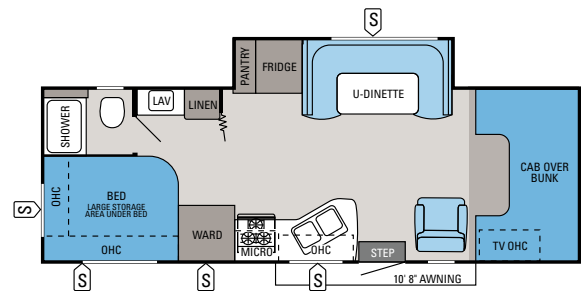

### REDHAWK | 26XS

Ext. Length: 28' 9" Exterior Height: 139" Sleeps: 4-6

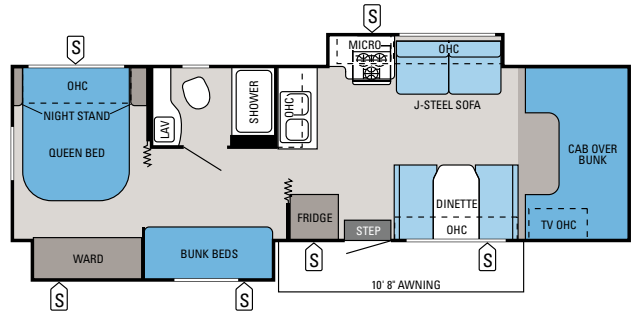

### REDHAWK | 31XL

Ext. Length: 32' 5" Exterior Height: 139" Sleeps: 7-9

## STANDARDS AND OPTIONS

### CUSTOMER VALUE PACKAGE

12V electric patio awning  
Front-molded seamless fiberglass cap  
Deluxe high-gloss Champagne fiberglass sidewalls  
Frameless windows  
Rear back-up camera and monitor  
8 cu. ft. flush-mount refrigerator with double doors  
32" digital LED HDTV  
iPod input jack  
Black holding tank sprayer  
Heated holding tanks, 12V pads  
400-watt inverter

### STANDARD EXTERIOR EQUIPMENT

TuffShell vacuum-bonded laminated roof, floor and sidewalls  
80" tall fiberglass, radius-cornered entrance door and screen door  
Electric-powered, double-entrance step  
Aluminum running boards  
Pass-through storage compartment with light (select models)  
12V electrical system with 120V, 60-amp power converter  
30-amp power cord  
120V G.F.C.I. protected exterior receptacle  
Onan 4,000-watt MicroQuiet generator  
Slideout battery tray  
Battery disconnect switch

Outside shower  
Hookup for city water  
4" tube-bumper sewer hose storage  
Roof ladder

### STANDARD INTERIOR EQUIPMENT

84" ceiling height  
Washington Glazed cabinetry with flat-panel cabinet doors and brushed-nickel cabinet hardware  
Ball bearing drawer guides, 75-lb. capacity, full-drawer extension  
3-burner range with 9,000-BTU SuperBurner and piezo igniter  
Microwave oven  
12V demand water pump  
6 gal. gas/electric DSI auto-ignition water heater  
Water purification system  
Dream Dinette mechanism, raises and lowers dinette tabletop (select models)  
Vinyl flooring throughout unit  
Interior Command Center  
Cable TV hookup with RG-6 coax  
Digital antenna with signal booster  
15,000-BTU ducted air conditioner  
31,000-BTU furnace with wall thermostat  
ABS shower with one-piece surround  
Marine toilet with foot pedal flush

Removable clothing rod in tub  
Skylight in shower  
Large wardrobes  
Queen-sized bed with Denver Mattress and bedspread  
Under-bed storage, bed lifts easily on gas struts (select models)  
Full cab-over bunk mat with headboard

### STANDARD CAB EQUIPMENT

Driver and passenger air bags  
Auxiliary start switch  
Ford E-450 chassis  
Triton 6.8L EFI V-10 305 HP engine with 420 lbs./ft. torque  
5-speed automatic TorqueShift series transmission with overdrive  
Hellwig helper springs with rubber isolation body mounts  
55-gal. fuel tank  
120-amp alternator  
5,000-lb. hitch with 7-pin plug  
Power anti-lock brakes with power steering  
A/C and cruise control from factory  
Tilt steering wheel  
Power windows and door locks  
Deluxe remote-controlled, side-view mirrors  
Third brake light

## SPECIFICATIONS

FLOORPLAN	EXT. LENGTH	EXT. WIDTH	EXT. HEIGHT (WITH A/C)	INT. HEIGHT	GROSS VEHICLE WEIGHT RATING (LBS.)	GROSS COMBINED WEIGHT RATING (LBS.)	ENGINE/SIZE	WHEEL BASE	FURNACE AUTO-IGNITION (BTUS)	FRESH WATER CAPACITY (GALS.)	GRAY WASTE WATER CAPACITY (GALS.)	BLACK WASTE WATER CAPACITY (GALS.)
23XM	26' 9"	100"	139"	84"	14,500	19,500	6.8L TRITON EFI V-10	181"	31M	32	34	32
26XS	28' 9"	100"	139"	84"	14,500	19,500	6.8L TRITON EFI V-10	181"	31M	32	40	32
29XK	32' 5"	100"	139"	84"	14,500	19,500	6.8L TRITON EFI V-10	223"	31M	32	41	32
31XL	32' 5"	100"	139"	84"	14,500	19,500	6.8L TRITON EFI V-10	223"	31M	32	40	32

**Gross Vehicle Weight Rating (GVWR):** The maximum permissible weight of the motorhome, including the Unloaded Vehicle Weight (UUV) plus passengers, personal items, all cargo, fluids, options and dealer-installed accessories. The GVWR is equal to or greater than the sum of the UUV and the Cargo Carrying Capacity.

**Gross Combined Weight Rating (GCWR):** The maximum allowable combined weight of the motorhome used as a tow vehicle and the attached towed vehicle.

It is important for your safety and enjoyment that you are aware of the weights and tow ratings of the RV you select. Consult a competent advisor for questions or advice. Whether you are new to RVing or a veteran, get a feel for the performance

of your RV before heading out on the roadways. When you tow a vehicle with your RV, you must drive differently than when you drive a single vehicle. Practice hooking up, driving, backing up and braking in a safe environment or seek out professional instruction. Jayco affixes a weight label to each RV which lists weight information for that vehicle. Refer to that label to verify the vehicle will meet your requirements. See specifications chart above.

# 2-YEAR WARRANTY\*

Peace of mind comes standard.



**Nobody offers a better warranty than Jayco.** With our exclusive 2-year CoPilot Limited Warranty, the only strings we attach are those that deliver the ultimate in reliability. At Jayco, your peace of mind is our priority, and that's the Jayco difference.

\*For a copy of our 2-year limited warranty with full terms and conditions, please contact your local Jayco dealer or visit [Jayco.com](http://Jayco.com).

## 300 JAYCO DEALERS

A four-decade strong network.

From the sales experience to service after the sale, we consider our dealers to be an important part of the Jayco family. Establishing a solid relationship with your local Jayco dealer is a key component in the enjoyment of your new Jayco. By purchasing from a local dealer, you will have a convenient location for sales, parts and service support. We hope you consider them a part of your camping family.

Your local dealer

## 1-YEAR FREE

Roadside Assistance

Travel worry-free with Jayco's Customer First Roadside Assistance program, yours at no cost during your first year of ownership. This program is offered through Coach-Net, the country's largest RV emergency road service, and gives you immediate access to assistance.

**Coach-Net**  
RV Technical & Roadside Assistance



Generations of family fun.

**THE JAYCO STORY BEGAN IN 1968 WITH OUR FAMILY—THE BONTRAGERS.** Lloyd Bontrager created an innovative, easy-to-use lifter system that led to a better fold-down camper. Loaded with more conveniences, he believed his camper would bring families closer together.

Since then, Jayco has helped generation after generation create family stories — good, old-fashioned family fun built around campfires with a Jayco RV nearby. At Jayco, we strive to build family-friendly products that will outlast just about everything but your memories. We'd love nothing more than to be a part of your family story. Join us in our generations of family fun.

**eco**advantage™

Jayco's long-term commitment to protecting the environment.



Scan this QR code with your smartphone to watch a video about our efforts and the impact we're making on our planet.  
[jayco.com/ecoadvantage](http://jayco.com/ecoadvantage)

Follow us on



Jayco, Inc., P.O. Box 460, Middlebury, IN 46540, [www.jayco.com](http://www.jayco.com) 

See dealer for further information and prices. All information in this brochure is the latest available at the time of publication approval. Jayco reserves the right to make changes and to discontinue models without notice or obligation. Photos in this brochure may show optional equipment and props for photography purposes. RVs built for sale in Canada may differ to conform to Canadian codes. ©2013 Jayco, Inc. 14-RDHK-PL 0813-60K Printed in U.S.A.