

2014 Autumn Ridge

TRAVEL TRAILERS BY STARCRAFT®

# Autumn Ridge

50 YEARS OF CAMPING | PURE AND SIMPLE



*The Gold Edition*

- ◆ 2-YEAR WARRANTY
- ◆ 38" DEEP DINETTE DRAWERS
- ◆ OUTSIDE TV PREP UNDER PATIO AWNING
- ◆ 6 GAL. GAS/ELECTRIC DSI WATER HEATER



STARCRAFT





AUTUMN RIDGE 286KBS | PRISM



*Autumn Ridge*  
Value, Simplified.

- 1 NEW OPTIONAL FIBERGLASS SIDEWALLS
- 2 XTEND-A-BED, FEATURING 60" x 80" FULL-SIZED QUEEN BED (50<sup>TH</sup> ANNIVERSARY PACKAGE)
- 3 ELECTRIC AWNING WITH LED LIGHTING STRIP (50<sup>TH</sup> ANNIVERSARY PACKAGE)
- 4 OPTIONAL BUMPER-MOUNTED GRILL
- 5 8 CU. FT. GAS/ELECTRIC REFRIGERATOR/FREEZER
- 6 FAMILY-FRIENDLY, DOUBLE-OVER-DOUBLE BUNKS WITH 600-LB. RATING





# Yesterday's Lessons

At Starcraft, we're a family-owned business in the business of making camping fun. Over the last 50 years, we've created a solid reputation building dependable campers at affordable prices, using only the highest-quality materials. In that time, we've learned a thing or two about camping. We know why people like to camp, and what they like to do when camping. We put that knowledge into every camper we build.



Camping. Pure and Simple.





AUTUMN RIDGE 286KBS | PRISM



AUTUMN RIDGE 266RKS | SANDSTONE



AUTUMN RIDGE 289BHS | NICKEL



AUTUMN RIDGE 266RKS | SANDSTONE



AUTUMN RIDGE 289BHS | NICKEL



AUTUMN RIDGE 266RKS | SANDSTONE



## Standards and Options

### STANDARD CONSTRUCTION EQUIPMENT

3/8" decking on roof  
5/8" tongue-and-groove plywood main floor decking  
2" x 3" longitudinal floor joists on 16"-18" centers  
8 1/2" living room ceiling height  
Hardwood screwed-stile cabinet construction  
I-Class cambered structural-steel I-beam frame  
In-floor ducted heat  
One-piece seamless rubber roof material  
Roof rafters constructed of residential-style tapered 4-1/2" trusses

### STANDARD EXTERIOR EQUIPMENT

15" radial tires  
30" x 72" radius-cornered main entry door with screen door  
120V G.F.C.I. protected exterior receptacle  
Black tank flush  
Bumper with drain hose carrier and end caps  
Cable and satellite TV prep  
Crank-up HDTV antenna with signal booster  
E-Z Lube axles  
Galvanized steel wheel wells (insulated on non-slide models)  
New-R-Adjust electric brakes  
Outside kitchen with refrigerator, sink and bumper-mounted grill (309BHL and 329BHU)  
Outside TV prep  
Patio awning  
Prep for bumper-mount grill  
Propane bottle cover made of molded ABS  
Roof-mounted antenna for radio  
Security lights (2)  
Spare tire with carrier  
Stabilizer jacks (4)  
Starmaxx pass-through storage with tool hooks and courtesy light  
Step light at entry door  
Tinted safety-glass windows

### STANDARD INTERIOR EQUIPMENT

A/C Chillgrille  
Auto-ignition furnace with wall thermostat  
Ball-bearing drawer guides, 50-lb. capacity with full-drawer extension  
Bourbon Glaze beech wood doors and drawers throughout  
Decorative lighting package  
Double-over-double bunk bed with 600-lb. bunk capacities (278BH and 289BHS)  
Command Center with centrally located switches  
Evergreen mattress with upgraded radius corners  
Hinged storage lids in bedroom  
Marine-grade table leg and pedestal base  
Multi-Media Sound System AM/FM/CD stereo with MP3 input jack  
Overhead cabinetry in slideout room above sofa  
Pleated shades  
Porcelain toilet with foot flush  
Quilted bunk mats  
Queen-sized bed (king-sized in 286KBS)  
Radius shower (select models)

### STANDARD KITCHEN EQUIPMENT

3-burner range with 9,000-BTU SuperBurner and piezo igniter  
Deep storage drawers under booth dinette seat (2)  
Double drawer with integrated silverware dividers  
Extra large picture window at dinette  
Flush-mounted refrigerator  
Kitchen backsplash  
Oversized 21" oven  
Pots and pans drawer, below oven (select models)  
Range hood with light and exhaust fan  
Residential-style faucet with pull-out sprayer  
Sink covers with integrated drying rack

Spice rack storage integrated into valance  
Storable cutting board

### CUSTOMER CONVENIENCE PACKAGE

6-gal. gas/electric DSI auto-ignition water heater  
30-lb. propane bottles (2) with auto changeover  
13,500 or 15,000-BTU A/C with wall thermostat and louvered directional ceiling vents  
ABS tub surround  
Bathroom power vent  
Exterior speakers, high-output marine-grade (2)  
Front diamond plate  
Microwave oven with carousel  
Outside shower  
Tub/shower skylight  
Water heater bypass system

### OPTIONS

22" LED TV In bedroom with inside/outside bracket  
26" LED TV (select models)  
32" LED TV (346RESA)  
50-amp service with 2nd A/C prep (select models)  
Aluminum rims  
Arctic Package: Insulated, heated and enclosed underbelly and foil insulation in roof  
Arctic Package with full-foil wrap  
Bumper-mounted grill (select models)  
Exterior fiberglass sidewalls  
Free-standing table with hidden leaf and four chairs (select models)  
Front and rear electric stabilizer jacks  
Hide-a-bed sofa (select models)  
Ledgestone fireplace with 40" TV (select models)  
Recliner chair in lieu of swivel rocker (select models)  
Recliner chair (2) in lieu of door-side sleeper sofa (346RESA)  
Roof ladder  
Second door-side hide-a-bed (346RESA)  
Sleeper sofa (select models)  
Thermal-pane patio door with bedroom entry door (select models)  
Thermal-pane windows

### PREMIER PACKAGE

Aluminum rims  
Glass shower doors  
Hardwood refrigerator door inserts  
Headboard  
Large folding grab handle  
Raised-panel overhead cabinetry in kitchen  
Residential-style kitchen backsplash  
Sink covers  
Skylight with LED lighting in living room/kitchen  
Solid-surface kitchen countertops with under-mounted sink

### 50TH ANNIVERSARY PACKAGE (MANDATORY)

8 cu. ft. refrigerator  
12V dual USB outlet  
50th Anniversary spare tire cover  
CD/DVD with MP3 and iPod input jack  
Electric awning with LED lighting  
Electric tongue jack  
Xtend-A-Bed (on 74" beds)



SCAN  
for a complete list of  
standards and options,  
OR VISIT  
[starcraftcamping.com](http://starcraftcamping.com)

1



2



3



4



# Premier Package



THE AMENITIES YOU WANT  
AT A PRICE YOU CAN AFFORD.

1 21" round skylight with LED light

2 Glass shower doors

3 Residential-style kitchen backsplash

4 Headboard

And

◆ ALUMINUM RIMS

◆ HARDWOOD REFRIGERATOR DOOR INSERTS

◆ LARGE FOLDING GRAB HANDLE

◆ RAISED-PANEL OVERHEAD CABINETS IN KITCHEN

◆ SINK COVERS

◆ SOLID-SURFACE KITCHEN COUNTERTOPS WITH UNDER-MOUNTED SINK



# Floorplans

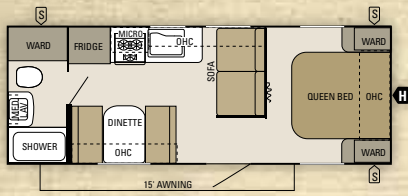

Autumn Ridge 235FB **OPTION: C**

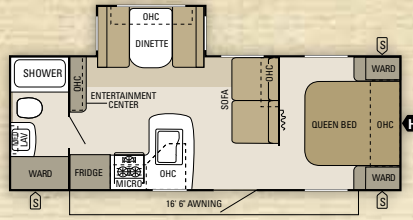

Autumn Ridge 245DS **OPTION: A, C**

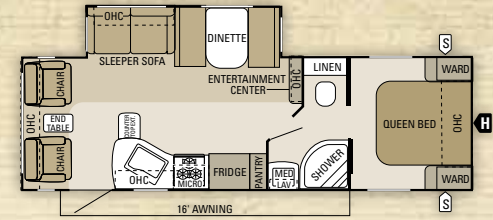

Autumn Ridge 265RLS **OPTIONS: A, B**

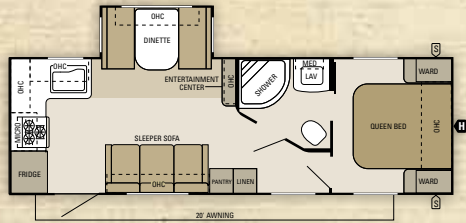

Autumn Ridge 266RKS **OPTIONS: A, B**

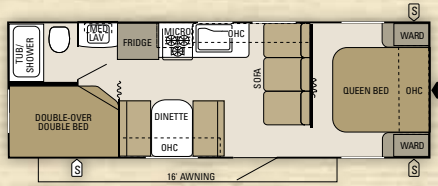

Autumn Ridge 278BH **OPTION: C**

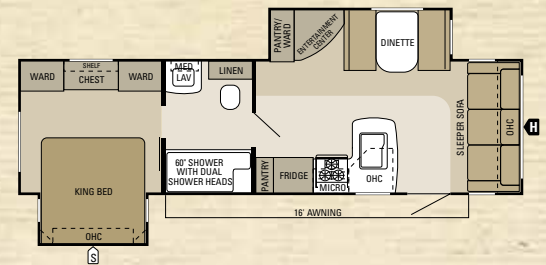

Autumn Ridge 286KBS **OPTIONS: A, B**

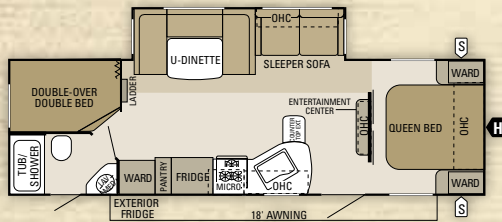

Autumn Ridge 289BHS **OPTION: B**

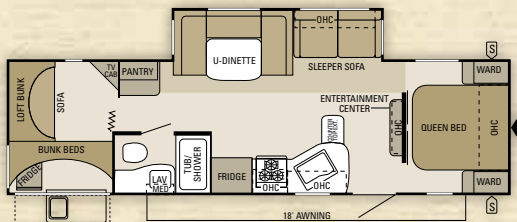

Autumn Ridge 309BHL **OPTION: B**

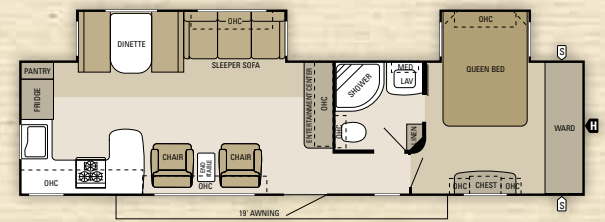

Autumn Ridge 315RKS **OPTIONS: A, B, D, F**

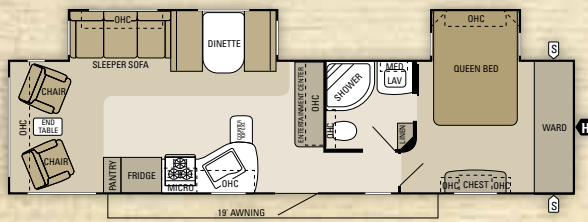

Autumn Ridge 325RLSA **OPTIONS: A, B, D, F**

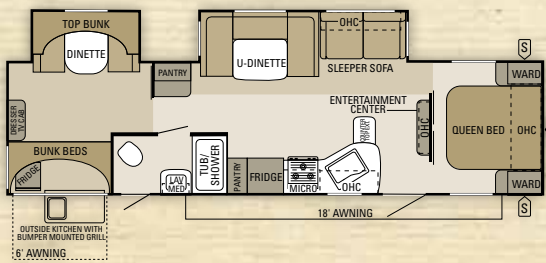

Autumn Ridge 329BHU **OPTION: B**

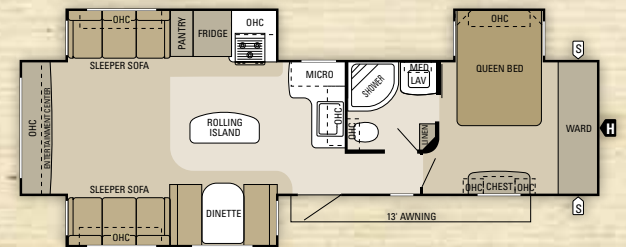

Autumn Ridge 346RESA **OPTIONS: A, B, E, F, G**



**OPTION A**



**OPTION B**



**OPTION C**



**OPTION D**

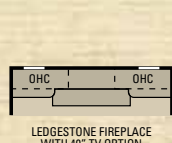

**OPTION E**

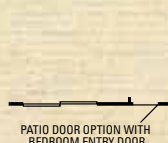

**OPTION F**

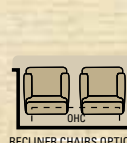

**OPTION G**

- S OUTSIDE STORAGE
- H TRAILER HITCH
- LAV BATHROOM SINK
- MICRO MICROWAVE
- OHC OVERHEAD CABINETS
- FRIDGE REFRIGERATOR
- WARD WARDROBE



# Interior Décor Options



**Sandstone**



**Prism**



**Nickel**

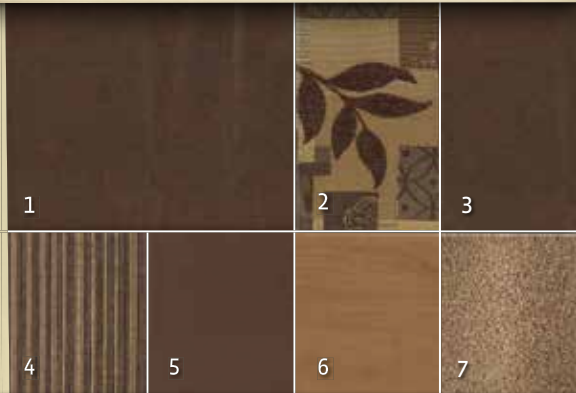

1 SOFA      2 ACCENT FABRIC



3 CHAIR      4 BEDROOM ACCENT      5 DRAPERY



6 WOOD      7 CARPET

## Specifications

Floorplan	Exterior Length	Exterior Height with A/C	Interior Height	Unloaded Vehicle Weight (lbs.)	Dry Hitch Weight (lbs.)	Gross Vehicle Weight Rating (lbs.)	Cargo Carrying Capacity (lbs.)	Fresh Water Capacity (gal.) (includes water heater)	Gray Waste Water Capacity (gal.)	Black Waste Water Capacity (gal.)
235FB	26' 9"	127"	81"	4,250	475	6,500	2,250	68.6	32.5	32.5
245DS	27' 6"	133"	81"	5,115	500	7,500	2,385	68.6	32.5	32.5
265RLS	30' 11"	135"	81"	6,130	645	8,250	2,120	68.6	32.5	32.5
266RKS	29' 10"	133"	81"	5,470	570	7,750	2,280	68.6	65	32.5
278BH	29' 4"	127"	81"	4,685	450	7,500	2,815	68.6	32.5	32.5
286KBS	33' 11"	134"	81"	7,160	865	9,500	2,340	68.6	65	32.5
289BHS	31' 9"	135"	81"	6,395	745	8,500	2,105	68.6	32.5	32.5
309BHL	33' 11"	134"	81"	6,865	765	9,250	2,385	68.6	32.5	32.5
315RKS	37' 9"	134"	81"	7,830	1,120	9,975	2,145	68.6	65	32.5
325RLSA	37' 9"	134"	81"	7,735	1,060	9,975	2,240	68.6	65	32.5
329BHU	36' 2"	134"	81"	7,765	780	9,950	2,185	68.6	32.5	32.5
346RESA	38' 3"	134"	81"	8,385	1,200	10,750	2,365	68.6	32.5	32.5

**UNLOADED VEHICLE WEIGHT (UUVW):** Sometimes referred to as "Dry Weight," UUVW means the typical weight of this trailer as built at the factory. The UUVW, as used in product literature and other promotional materials, does not include cargo, fresh water, propane, options or dealer-installed accessories. The weights of certain options and/or option packages are not included in the UUVW listed above. **GROSS VEHICLE WEIGHT RATING (GVWR):** GVWR means the maximum permissible weight of the trailer, including the UUVW plus passengers, personal items, all cargo, fluids, options, and dealer-installed accessories. The GVWR is equal to or greater than the sum of the UUVW and the CCC. **CARGO CARRYING CAPACITY (CCC):** CCC

means the maximum weight of all passengers, personal items, food, fresh water, propane, tools, other cargo and dealer-installed accessories that can be carried by the trailer. CCC is equal to or less than GVWR minus UUVW. The addition of options will decrease the CCC. **HITCH WEIGHT (HW):** The hitch weight, as used in product literature and other promotional materials, does not include cargo, fresh water, propane gas, options or dealer-installed accessories. The addition of these types of items will either add to or subtract from the stated hitch weight. It is important for your safety and enjoyment that your tow vehicle be adequately sized and equipped to tow and handle the GVWR of the RV you select. Review weights and rating

of your tow vehicle and consult a competent advisor for questions or advice. Whether you are new to RVing or a veteran, get a feel for the performance of your tow vehicle and the RV together before heading out on the roadways. When you tow an RV, you must drive differently than you do when driving a single vehicle. Practice hooking up, driving, backing up and braking in a safe environment or seek out professional instruction. Starcraft affixes a weight label to each RV which lists weight information for that vehicle. See specification chart above.



CELEBRATING

# 50 Years of Innovation



Starcraft is one of the most dependable names in the camping industry, thanks to 50 years of unwavering innovation.

**Our family-owned company remains devoted to building quality campers purely built for camping — all at an affordable price.**

With a versatile lineup, Starcraft delivers everything you need to have a great time in the great outdoors.



## EXTENDED CAMPING

Our optional Arctic Package extends your camping season and provides protection against cooler temperatures with its insulated, heated and enclosed underbelly. For additional protection, the optional full-foil wrap boosts your R-values to R-24 in the floor, R-19 in the walls and R-22 in the roof.



## eco advantage™

The Starcraft EcoAdvantage is our company's commitment to protecting the environment. Scan this QR code with your smartphone to watch a video about our efforts and the impact we're making on our planet.



## DURABLE CONSTRUCTION

Autumn Ridge's firm foundation is built on 2" x 3" floor joists with 5/8" tongue-and-groove plywood with R-7 fiberglass insulation. The walls provide a long-lasting structure with 2" x 2" wooden studs on 16" centers, .024 aluminum exterior siding and R-7 fiberglass insulation. A one-piece seamless rubber roof membrane covers 4 1/2" arched trusses, 3/8" decking and R-7 fiberglass insulation.



For a copy of the industry-leading warranty with full terms and conditions, ask your local Starcraft dealer.



## Roadside Assistance

Travel worry-free with the complimentary 1-Year Roadside Assistance program, which gives you immediate access to dependable roadside assistance with a simple phone call (available at participating dealers).



## The Value of Your Local Starcraft Dealer

Establishing a solid relationship with your local Starcraft dealer is a key component in the enjoyment of your new Starcraft. By purchasing from a local dealer, you will have a convenient location for sales, parts and service support.

FOLLOW US ON



© Starcraft RV • 536 Michigan St., Topeka, IN 46571

www.starcraftcamping.com  
See dealer for further information and prices. All information in this brochure is the latest available at the time of publication approval. Starcraft reserves the right to make changes and to discontinue models without notice or obligation. Photos in this brochure may show optional equipment and props for photography purposes. RV's built for sale in Canada may differ to conform to Canadian codes.

[www.starcraftcamping.com](http://www.starcraftcamping.com)

VISIT OUR WEBSITE FOR MORE INFORMATION OR TO FIND A DEALER NEAR YOU.