

MAC, CLASSIC, HIGH WALL & HARD SIDE TENT CAMPERS

# FLAGSTAFF

MAC, CLASSIC, HIGH WALL & HARD SIDE TENT CAMPERS

FLAGSTAFF





02

206ST



FLAGSTAFF

# MAC

## YOU DON'T HAVE TO ROUGH IT WITH A MAC.

*Yes, you're camping, but that does not mean your comfort stays home.* With features available like the three-speed Create-A-Breeze ventilation fan to pull in fresh outside ambient air so you remain comfortable at night, and swing level galley to keep kitchen utensils in their place are simple amenities that add tremendously to the comfort of your vacation. It's your vacation. Do it right.



Water Pump w/ Filter  
*(Std.)*



Easy glide scissorpole bed supports  
*(Except LTDs)*



Plywood Bed Ends  
*(N/A Hard Side)*

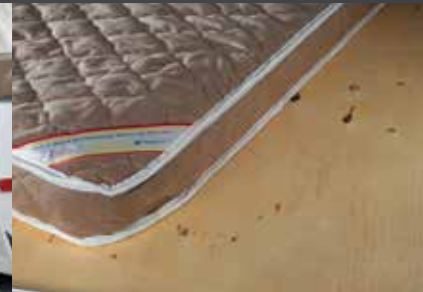

Heated Mattress  
*(Std. Opt.)*



Outside grill with work table  
*(Std. MAC, Classic, Hard Side, High Wall)*



Sliding Storage Trunk  
*(Some Models)*



Crank Down stabilizer Jack *(Std.)*



Swing down galley  
*(Except LTD, High Wall, Hard Side)*

# FLAGSTAFF CLASSIC

## TRADITIONALLY A GREAT CAMPING EXPERIENCE.

*The Flagstaff Classic is the top tent camper on the market today.* The expansive sliding storage trunk for that extra cargo space, a comfortable, heated, inner-spring mattress, for a peaceful night's sleep and the convenient power lift system for easier setup are some of the basic features that really make your camper a Classic.



Hanging Shirt Bar  
(Std. Classic & High Wall)

LED Bunk Light and Fan  
(Std. Classic & High Wall)

Metal Full Extension Drawer  
Guides (Std.)

One-Piece Door  
(Except LTD, Hard Side)



Bike Rack Option  
(Most Models)

Fantastic Fan (Except LTDs.)

Outside Shower  
(Incl. w/ Hot Water Pkg: Std:  
Classic, Hard Side, High Wall  
and Opt: MAC)

Large Entry Assist Handle  
(Except LTDs)





627D





HW27KS

FLAGSTAFF

# HIGH WALL

## KISS THE CAMPGROUND BATH HOUSE GOODBYE.

*Tired of giving up the comforts of home while camping? Welcome to the Flagstaff High Wall Series. We have designed this series for the camping family who wants the refinement of larger vacationing units in a light-weight camper. Ample counterspace, upgraded appliances and tasteful interiors make this camper a gorgeous option to experience.*



AM/FM Stereo with CD Player (Std. Classic, Hard Side & High Wall. HW29SC Std. w/ AM/FM/CD Stereo with DVD Player)

Hanging Wardrobe (Opt. all Models Except MAC, Hard Side & LTD's)

Power Lift (Std. Classic, High Wall and MAC BR models. Opt. MAC/LTD)

Double Entry Step (Std. MAC BR Models and All HW Models)



Beautiful hardwall shower with a residential-style flush toilet complete with a 12-gallon black water holding tank. (Std. High Wall)



Black water hose storage (Std. HW models)



Add-a-Room with Privacy Panels (Opt. all Models Except Hard Side)





FLAGSTAFF

# QUALITY CONSTRUCTION

## HIGH QUALITY CAMPERS WHICH ARE BUILT TO ENDURE.

Quality built trailers always bring the same results: long-lasting products you can depend on to enjoy with your family year after year. These are some of our highlights.

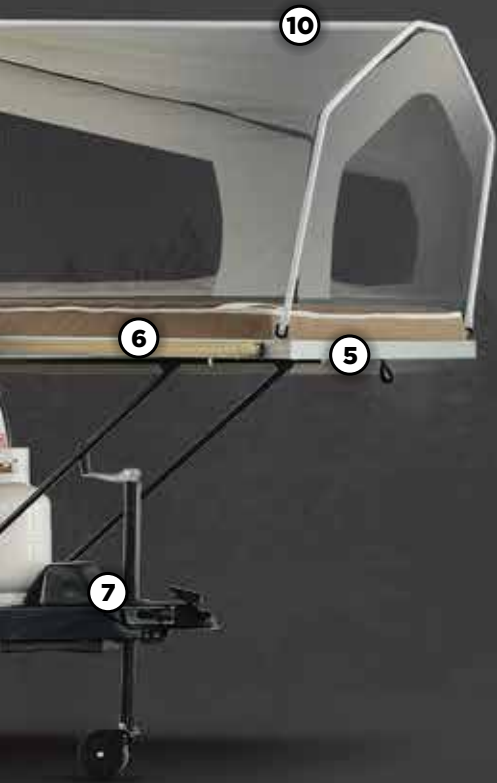

- 1) Three Stage Double Arm Lifter Posts (*NA Hard Side*)
- 2) Fiberglass Vacuum Bonded Radius Roof w/ No Center Seam (*NA Hard Side*)
- 3) Five-Piece Vinolon Supreme Tenting (*NA Hard Side*)
- 4) E-Z Crank Down Stabilizer Jacks w/Sand Pads
- 5) Full Perimeter Aluminum Bed Frames (*NA Hard Side*)
- 6) Plywood Bunk Ends (*NA Hard Side*)
- 7) Seven-Way Pigtail Wiring
- 8) Under Floor 20 Gallon Fresh Water Tank (*LTDs 11 Gallon Above Floor*)
- 9) Powder Coated Tubular Steel Frame
- 10) Powder Coated Rafter Poles and Bed Bows (*NA Hard Side*)
- 11) Air Conditioner Reinforcing Laminated Into Roof (*NA Hard Side*)
- 12) Steel Belted Radial Tires
- 13) Easy Lube Axles (*Except LTDs*)
- 14) Smooth Fiberglass Vacuum Bonded Exterior (*NA on MAC/LTDs*)
- 15) One-Piece Door (*Except LTDs & Hard Side*)



The UltraLube™ Hubs allow you to repack bearings quickly and easily without disassembly.

## AL-KO® TORSION AXLES AND EASY LUBE HUBS

AL-KO Axles offer many advantages over conventional axles:

- Fully Independent Wheel Suspension
- No Metal to Metal Contact and No Springs, Shackles, Hangers, or U-bolts to Break or Wear Out
- Lower Trailer Center of Gravity For Improved Stability

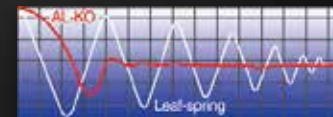

Note: Torsion Axles on Classics, HS's and HW's only. Easy-Lube Hubs on all units except LTDs.

FLAGSTAFF

# HARD SIDE

## QUITE POSSIBLY THE BEST OF BOTH WORLDS.

When you combine the solid exterior of a travel trailer with a Classic tent camper, you get the Flagstaff Hard Side Series, giving your camping experience the best of both. Bringing a smooth, fiberglass vacuum bonded exterior with a quick, easy set up, while retaining the towing and storage advantages of a tent camper, the Hard Side camper is the perfect blend.



Hard Side Awning & Screen Room option.

## SPECIFICATIONS

Model number of any particular unit does not necessarily reflect the overall length of the unit itself. Dry weights are estimates.

MODEL	T12RB	T12RBST	T12TST	T12DDST	T12BH	T12RBTH	T12SDTH	T19SCHW	T19QBHW
BASE/DRY UNIT WEIGHT	1893	1955	1982	1886	1943	2186	2152	2052	2100
BASE DRY HITCH WEIGHT	247	283	268	275	268	354	349	327	330
BASE DRY AXLE WEIGHT	1646	1672	1714	1611	1675	1832	1803	1725	1770
CARGO CAPACITY	1005	1217	1217	1217	1217	1630	1678	1237	1192
BOX SIZE	12'	12'	12'	12'	12'	12'	12'	12'	12'
TRAILER SIZE (CLOSED W/ HITCH)	17' 1"	18' 11"	18' 11"	18' 11"	19' 2"	22' 1"	22' 1"	18' 11"	18' 11"
HEIGHT (CLOSED)	60"	60"	60"	60"	60"	65"	65"	66"	66"
FRESH WATER CAPACITY	26	26	26	26	26	26	26	26	26

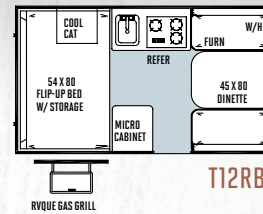

T12RB

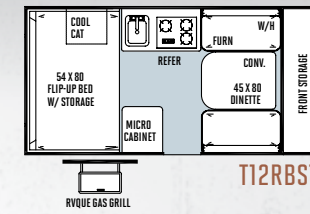

T12RBST

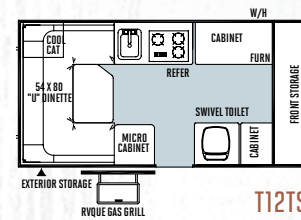

T12TST

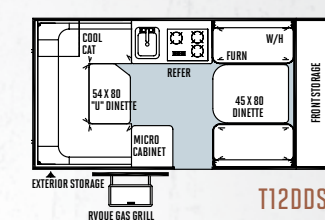

T12DDST

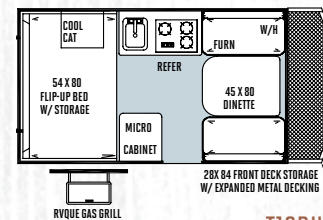

T12BH

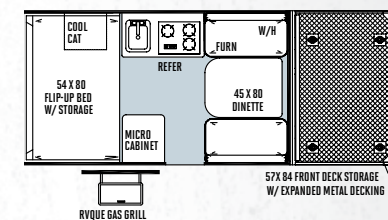

T12RBTH

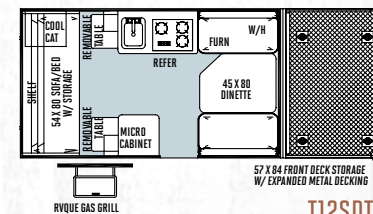

T12SDTH

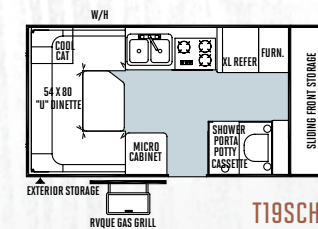

T19SCHW

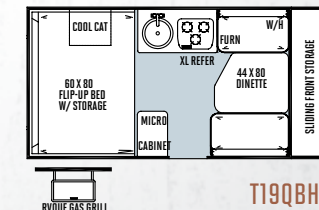

T19QBHW

\* Refer to the back cover for a view of the Flagstaff Hard Side High Wall.



T12RBST



# FLAGSTAFF

# CLASSIC

## SPECIFICATIONS

Model number of any particular unit does not necessarily reflect the overall length of the unit itself.  
Dry weights are estimates.

MODEL	425D	625D	627D	823D
BASE/DRY UNIT WEIGHT	2446	2473	2555	2445
BASE DRY HITCH WEIGHT	303	292	370	358
BASE DRY AXLE WEIGHT	2143	2181	2185	2087
CARGO CAPACITY	838	800	796	894
BOX SIZE	12'	12'	14'	12'
TRAILER SIZE (Closed w/ Hitch)	19' 1"	19' 1"	19' 4"	19' 1"
HEIGHT (Closed)	61"	61"	61"	61"
TRAILER LENGTH (Open)	23' 9"	23' 9"	25' 9"	23' 9"
FRESH WATER CAPACITY	26	26	26	26

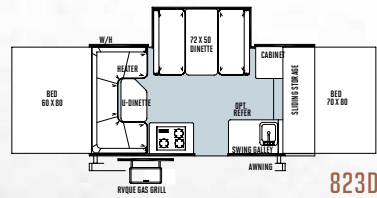
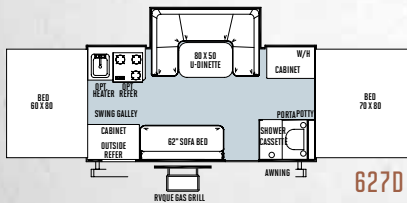
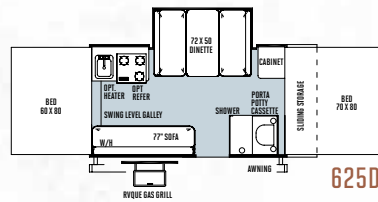
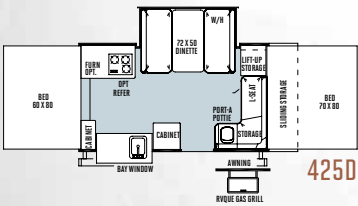

# FLAGSTAFF

# HIGH WALL

## SPECIFICATIONS

Model number of any particular unit does not necessarily reflect the overall length of the unit itself.  
Dry weights are estimates.

MODEL	HW 27SC	HW 27KS	HW29SC	HW31SCTH
BASE/DRY UNIT WEIGHT	2806	2962	3135	3738
BASE DRY HITCH WEIGHT	279	370	373	337
BASE DRY AXLE WEIGHT	2527	2592	2762	3401
CARGO CAPACITY	935	870	1217	2317
BOX SIZE	14'	14'	16'	14'
TRAILER SIZE (Closed w/ Hitch)	19' 4"	19' 4"	21' 4"	28' 4"
HEIGHT (Closed)	71"	71"	72"	71"
TRAILER LENGTH (Open)	25' 9"	25' 9"	27' 9"	33' 9"
FRESH WATER CAPACITY	26	26	26	26
GRAY WATER CAPACITY	12	12	12	12
BLACK WATER CAPACITY	12	12	12	12

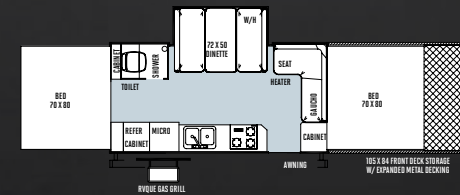
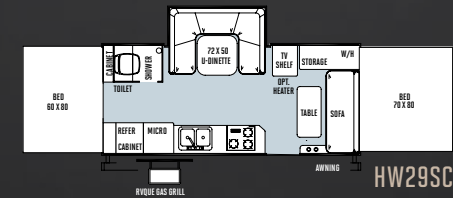
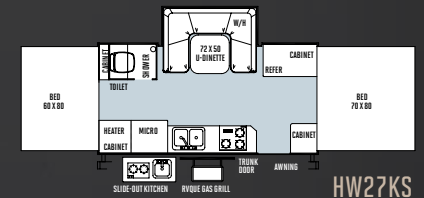
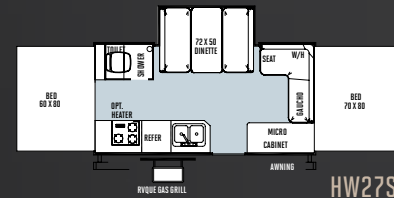

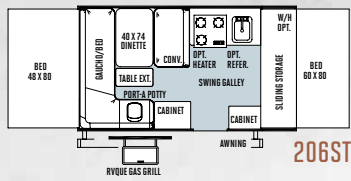

206ST

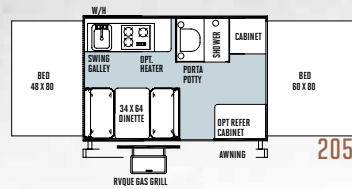

205

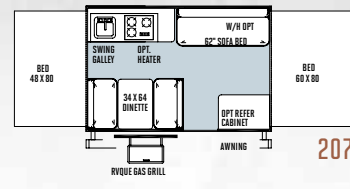

207

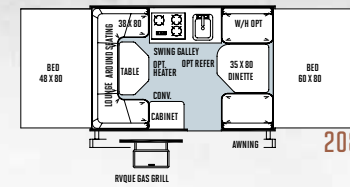

208

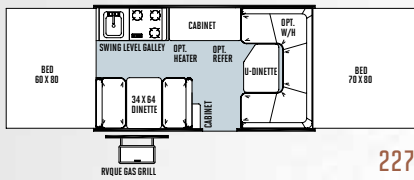

227

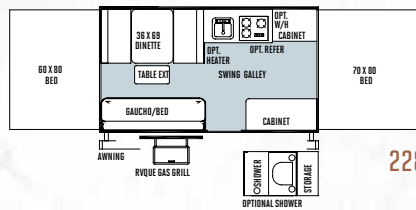

228

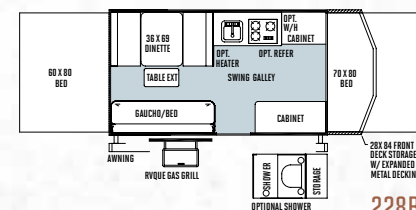

228BH

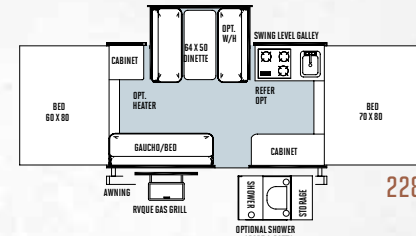

228D

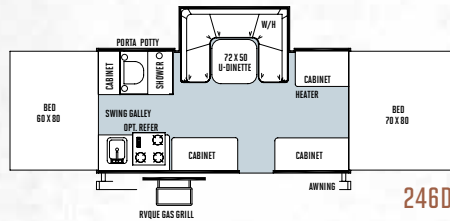

246D

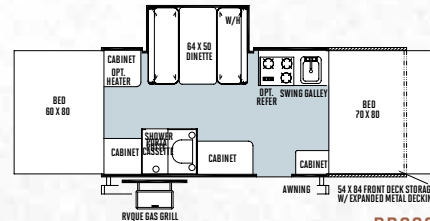

BR23SC

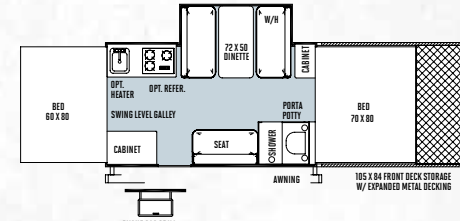

BR28TSC

## FLAGSTAFF

# MAC

### SPECIFICATIONS

Model number of any particular unit does not necessarily reflect the overall length of the unit itself.  
Dry weights are estimates.

MODEL	206ST	205	207	208	227	228	228BH	228D	246D	176LTD	206LTD	BR23SC	BR28TSC
BASE/DRY UNIT WEIGHT	1944	1732	1764	1737	2006	2050	2122	2153	2364	1344	1493	2579	2975
BASE DRY HITCH WEIGHT	245	240	252	219	293	331	382	313	249	190	174	310	219
BASE DRY AXLE WEIGHT	1699	1492	1512	1518	1713	1719	1740	1840	2115	1154	1319	2269	2756
CARGO CAPACITY	1032	917	866	866	966	966	991	891	866	683	762	1212	2317
BOX SIZE	10'	10'	10'	10'	12'	12'	12'	12'	14'	8'	10'	12'	12'
TRAILER SIZE (Closed w/ Hitch)	17' 1"	15' 3"	15' 3"	15' 3"	17' 2"	17' 2"	18' 8"	17' 2"	19' 2"	12'	14'	21' 9"	26'
HEIGHT (Closed)	57"	57"	57"	57"	57"	57"	57"	57"	57"	56"	56"	62 1/2"	62 1/2"
TRAILER LENGTH (Open)	20' 4"	20' 1"	20' 1"	20' 1"	23' 10"	23' 10"	23' 10"	23' 10"	25' 10"	17' 1"	20' 1"	26' 5"	30' 8"
FRESH WATER CAPACITY	20	26	20	20	20	20	20	20	26	11	11	26	26

# STANDARDS & OPTIONS

Standards & Options are subject to change.

MODELS	LTD	M	C	HS	HW
<b>STANDARD &amp; OPTIONAL FEATURES</b>					
Cherry Interior with "Tile-Look" Linoleum	--	--	S	S	S
Hickory Interior with "Tile-Look" Linoleum	S	S	--	--	--
Two-Tone Fabric Interiors	S	S	S	S	S
Residential Style Kitchen Faucet	S	S	S	S	--
Stainless Steel Look Appliances and Sink	--	--	S	S	S
Double Pan Sink with High Rise Faucet (HS: T19SCHW Only)	--	--	--	S*	S
Electric Water Pump	S	S	S	S	S
Hot Water Package (Incl. Water Filter, Outside Shower, Six Gallon DSI Hot Water Heater) (M: 206ST, 207, 208, 227, 228, 228BH, 228D)	--	0*	S	S	S
Port-a-Potty (M: 206ST Only C: 425D Only HS: T12RB, T12RBST, T12BH, T12DDST, T12RBTH, T12SDTH, T19QBHW)	--	S*	S*	S*	--
Cassette Swivel Toilet w/ Fresh Water Flush (HS: T12TST Only)	--	--	--	S*	--
Shower Cassette Package Incl. Water Filtration System, Six Gallon DSI Hot Water Heater, Demand Water Pump, and Cassette Toilet (Opt. M: 228, 228BH, 228D) (Std. L: 205, 246D, BR23SC, BR28TSC C: 625D, 627D)	--	S*/0*	S*	S*	--
Hard Wall Shower with Residential Flush Toilet	--	--	--	--	S*
Fold Over Galley with Upper and Lower Storage (Std. C: 425D Only)	S	--	S*	--	--
Two Burner Free-Standing Range	S	--	--	--	--
Swing Level Galley with Storage (N/A C: 425D, 823D)	--	S	S*	--	--
Permanently Mounted 3-Burner Indoor Range w/ Stove Cover	--	S	--	--	--
Permanently Mounted 3-Burner Indoor Range w/ Glass Stove Top Cover	--	--	S	S	--
Three Burner Glass Top Stove with Oven (HS: T19SCHW Only)	--	--	--	S*	S

MODELS	LTD	M	C	HS	HW
Microwave	--	--	--	S	S
Large Built-In Icebox	S	S	S	--	--
110V Electric Outside Accessible Refer (C: 627D Only)	--	--	S*	--	--
3 Way Refer 1.9 cu. ft.	0	0	--	--	--
3 Way Refer 2.5 cu. ft.	--	--	0	S	--
Extra Large 3 Way Refer (HS: T19SCHW, T19QBHW Only)	--	--	--	S*	0
Free Standing Lite-Ply Table – High Pressure Laminate	S	S	S	S	S
Comfortable Family Style Dinette w/ 4" Cushions	S	S	S	S	S
Residential Style Raised Panel Doors	--	--	S	S	S
Wood Drawers w/ Full Extension Metal Guides	S	S	S	S	S
Large Clothes Bar	--	--	S	S	S
Hanging Wardrobe	--	--	0	--	0
Hanging Pantry	--	0	0	--	0
AM/FM Stereo with CD player	--	--	S	S	S
AM/FM Stereo with CD and DVD player (HW29SC Only)	--	--	--	--	S*
TV Outlet with Cable and Satellite Hook Up	--	S	S	S	S
LCD TV (HW29SC Only)	--	--	--	--	S*
30 Amp Detachable Power Cord w/ Storage Bag	--	S	S	S	S
25 Amp Converter w/ Built in Battery Charger	S	--	--	--	--
35 Amp Converter w/ Built in Battery Charger	--	S	S	S	S
12V Safety Breaker	S	S	S	S	S
Roof Vent	S	--	--	--	--
Create-A Breeze Three Speed Fantastic Fan	--	SO	SO	SO	SO
Air Conditioner Wiring Kit	0	0	0	--	0
10k BTU Cool Cat Heat Pump	--	--	--	S	--
13.5k BTU Air Conditioner (Factory Installed)	--	--	--	--	0
20k BTU Forced Air Furnace w/ Electric Ignition	0	0	0	0	0
Interior Floor Lights	--	--	--	S	S
2 Ceiling LED Lights w/ Jacks for Accessories	S	--	--	--	--
2 Ceiling LED Lights	--	--	--	S	--
3 Ceiling LED Lights w/ Jacks for Accessories	--	S	S*	--	--

MODELS	LTD	M	C	HS	HW
4 Ceiling LED Lights w/ Jacks for Accessories (P: 627D Only)	--	--	S*	--	S
Bunk LED Light with Fan	--	--	S	--	S
Additional LED Bunk Light (M: 228D, 246D, BR23SC, BR28TSC Only)	--	S*	S	--	S
LP Leak Detector	S	S	S	S	S
Carbon Monoxide Detector	0	0	0	0	0
Privacy Curtains	S	CP	CP	S	CP
Roof Valances	--	CP	CP	--	CP
Quilted Top Bed Mattresses	S	S	--	--	--
Quilted Top Innerspring Mattresses (HS: T12RB, T12BH, T12RBST, T12RBTH Only)	--	--	S	S*	S
Quilted Top 60" x 80" Innerspring Mattresses (HS: 19QBHW Only)	--	--	--	S*	--
Thermostatically Controlled Heated Mattresses (HS: T12RB, T12BH, T12RBST, T12RBTH, T19QBHW Only)	SO	SO	SO	S*	SO
Leaf-Spring Axle	S	S	--	--	--
Independent Torsion Axles	--	--	S	S	S
Easy Lube Axles	--	S	S	S	S
Spare Tire, Cover and Mount	S	TP	TP	S	TP
12" Radial Tires	S	--	--	--	--
13" Radial Tires	--	S*	--	--	--
13" Radial Tires with Aluminum Wheels	--	--	S	S	--
14" Radial Tires with Aluminum Wheels	--	--	--	--	S
15" Mud Rover Radial Tires, Aluminum Wheels (Std. T12RBTH, T12SDTH Only) w/ Shocks (Std. M: BR23SC, BR28TSC Only)	--	S*	--	S*	--
Electric Brakes	0	S	S	S	S
Slam Latches on Front Trunk Side Doors (C: 823D, 425D, 625D Only)	--	--	S*	--	--

LTD = LIMITED  
M = MAC  
C = CLASSIC

HS = HARD SIDE  
HW = HIGH WALL

S = STANDARD  
SO = STANDARD OPTION  
0 = OPTIONAL

-- NOT AVAILABLE  
TP OR CP = OPTION PACKS  
\* = SELECTED MODELS



MODELS	LTD	M	C	HS	HW
Sliding Storage Tray on All Front Trunk Models (HS: T19SCHW, T19QBHW Only)	--	S*	S*	S*	--
28.5" Front Storage Deck w/ 200 # Weight Capacity (Std. M: 228BH, HS: T12BH Only)	--	S*	--	S*	--
54" Front Storage Deck w/ 650 # Wt. Capacity (Std. C: BR23SC)	--	S*	--	--	--
57" Front Storage Deck w/ 650 # Wt. Capacity (Std. HS: T12RBTH, T12SDTH)	--	--	--	S*	--
105" Front Storage Deck w/ 1300 # Weight Capacity (Std. M: BR28TSC, HW: HW31SCTH Only)	--	S*	--	--	S*
(4) Bike Rack (N/A M: BR23SC BR28TSC HS: T12RBTH, T12SDTH HW: HW31SCTH)	0	0*	0	0*	0*
(Note: HS: T12RB - 2 Bikes only)	0	0*	0	0*	0*
Power Lift System (Std. M: BR23SC, BR28TSC)	0	0*	S	--	S
Built-in A-Frame Mounting Provision for Equalizer					
Hitch Bar Installation	S	S	S	S	S
Battery Box and Wiring Kit	0	S	S	S	S
20 lb. LP Bottle	S	S	S	--	--
(2) 20 lb. LP Bottles (Std. M: BR23SC, BR28TSC Only)	--	S*	--	--	--
Dual 20 lb. LP Bottles with Cover	--	0	0	S	S
Automatic LP Regulator	--	0	0	S	S
Diamond Plated Front Cap	--	--	--	--	S
Diamond Plated Front, Rear and Side Skirt (M: BR23SC, BR28TSC Only)	--	S*	--	--	--
Awning	S	S	S	--	S
Awning/Screen Room	--	--	--	0	--
Screen Room w/ Privacy Panels	0	0	0	--	0
Outdoor Gas Grill w/ Worktable	0	S	S	S	S
Outside Speaker	--	--	S	S	S
Patio Light (LTD: 206LTD Only)	S*	CP	CP	S	CP
Courtesy Light on Front (M: 228BH, BR23SC, BR28TSC HS: All Models)	--	S*	--	S	--

MODELS	LTD	M	C	HS	HW
110V Exterior Outlet (LTD: 206LTD only)	S*	CP	CP	S	CP
Black Water Hose Storage	--	--	--	--	S
Door Step	S	TP*	TP	S	--
Double Door Step (M: BR23SC, BR28TSC Only, HW: All Models)	--	TP*	--	--	TP
One Piece Screen Door	--	S	S	--	S
Vented Entrance Door Window w/ Screen	--	--	--	S	--
Folding Grab Handle	--	S	S	S	S
Exterior Graphic Design	S	S	S	S	S
<b>TRAVEL PACK</b> (Incl. Spare Tire, Tire Bracket, Tire Cover, Installed Step)	--	0	0	--	0
<b>CONVENIENCE PACK</b> (Incl. Privacy Curtains, Roof Valances, A/C Bracing, Patio Light, 110V Exterior Outlet)	--	0	0	--	0
<b>STANDARD CONSTRUCTION FEATURES</b>					
Completely Enclosed Living Area	--	--	--	S	--
Fiberglass Vacuum Bonded Roof with Metal Interior Roof	--	--	--	S	--
Large Rear Roof Tinted Sky Light with Shade	--	--	--	S	--
Two Front Roof Tinted Windows with Shades	--	--	--	S	--
Fiberglass Vacuum Bonded Radius Roof w/ No Center Seam	S	S	S	--	S
Steel Air Conditioner Vent Reinforcing Laminated Into Roof	S	CP	CP	--	CP
CP 3-Stage Double Arm Lifter Posts	S	S	S	--	S
Smooth Fiberglass Vacuum Bonded Exterior	--	--	--	S	--
Lower Door Operational in Closed Position	S	S	S	--	S
Five Piece Sectionalized Vinolon Supreme Tenting and Slide Out	S	S	S	--	S
Tent Permanently Attached on Bunk Ends	S	S	S	--	S
Plywood Bunk Ends	S	S	S	--	S
Full Perimeter Aluminum Bed Frames	S	S	S	--	S

MODELS	LTD	M	C	HS	HW
Easy Glide Scissor Pole Bed Supports	--	S	S	--	S
Powder Coated Rafter Poles and Bed Bows	S	S	S	--	S
Tinted Vinyl Windows	S	S	S	--	S
Large, Opening Picture Window	--	--	--	S	--
One Piece Undercoated Structure Wood Floor	S	S	S	S	S
Powder Coated Tubular Steel Frame	S	S	S	S	S
Rear Crank Down Stabilizer Jacks w/ Sand Pads	S	--	--	--	--
(4) E-Z Crank-Down Stabilizer Jacks w/ Sand Pads	--	S	S	S	S
Seamless, High Density Polyethylene Wheel Wells	S	S	S	S	S
11 Gallon Fresh Water Tank	S	--	--	--	--
Under Floor 20 Gallon Fresh Water Tank	--	S	S	S	S
12 Gallon Gray Water Holding Tanks	--	--	--	--	S
12 Gallon Black Water Holding Tank	--	--	--	--	S
2000 lb. Tongue Jack w/ Swivel Wheel	S	S	S	S	S
Power Front Jack	--	--	--	0	0
7-Way Pigtail Plug	S	S	S	S	S

LTD = LIMITED  
M = MAC  
C = CLASSIC

HS = HARD SIDE  
HW = HIGH WALL

S = STANDARD  
SO = STANDARD OPTION  
O = OPTIONAL

-- NOT AVAILABLE  
TP OR CP = OPTION PACKS  
\* = SELECTED MODELS



#### PRE-DELIVERY INSPECTION FACILITY

20,000 square feet of quality assurance. The bare essentials for a premium product. This state-of-the-art facility gives immediate daily feedback to production for quality assurance in every unit built.



Forest River, Inc. encourages our customers to purchase their Forest River products from a local dealership whenever possible for the following reasons:

- 1) Forest River, Inc. dealers are independently owned and operated businesses so priority service and scheduling is at their discretion and is often provided to customers that purchased their unit at that dealership.
- 2) Purchasing locally allows customers to establish meaningful relationships with a dealer, enhancing the RV experience through assistance with product questions, user tips or RV regulations for your state or country, and much more!
- 3) Canadian customers must meet requirements to bring an RV purchased out of the country to their home. These requirements may involve additional inspections and certifications, taxes and fees. Your local Canadian Dealer is a professional at meeting these requirements.
- 4) Scheduling timely warranty repairs and adjustments through a local dealership provides far greater flexibility and convenience to you, the customer!

It is the goal of Forest River, Inc. that all of our RV owners fully enjoy the RV experience and that customer satisfaction meets or exceeds their expectations!

#### 24/7 EMERGENCY ROADSIDE ASSISTANCE

For a worry-free ownership experience

Forest River includes one

year of Coach-Net RV Technical & Roadside Assistance with each RV purchase. Whether new to the RV lifestyle or an experienced RV enthusiast, Forest River owners have 24/7 access to technical, operational and emergency road service coverage throughout the US & Canada.

Coach-Net's fast, dependable service is just a phone call away.

## Coach-Net®

RV Technical & Roadside Assistance

## INTRODUCING THE FLAGSTAFF HARD SIDE HIGH WALL.

These models bring added conveniences and taller counter tops to our Hard Side line of campers.

*\*See page 10 for floorplans.*



T19SCHW



# FLAGSTAFF WARRANTY

For details on Flagstaff's complete warranty program, see your Flagstaff dealer. When it comes to backing products with the same quality and commitment it does when it begins the manufacturing process, the only name you have to remember when you're looking for a recreational vehicle is Flagstaff. Flagstaff offers the following additional limited warranties to the original purchasers. Consult written warranty for details.

1. Five-year roof warranty,
  2. Twenty-five-year floor warranty,
  3. Five-year frame warranty,
  4. Five-year tent warranty,
  5. Five-year warranty on torsion axle suspension,
  6. Limited lifetime warranty of lifter system,
  7. One-year bumper to bumper.
- Ask your dealer about the available lifetime structural warranty.

YOUR FLAGSTAFF DEALER

201 West Elm Millersburg, IN 46543 | [www.forestriverinc.com/Flagstaff](http://www.forestriverinc.com/Flagstaff)  
574.642.2640



#### Learn More

Scan this barcode using a QR Reader on your smart phone to learn more about Forest River.



A Berkshire Hathaway company.

All specifications contained herein are based on the latest product information at time of printing. Forest River reserves the right to make changes in colors, materials, equipment and specifications at any time without notice and assumes no responsibility for any errors in this brochure. Litho. U.S.A. 2013.11.06