

# LANDMARK

**DSI**  
Annual RVDA DEALER  
SATISFACTION INDEX  
AWARD WINNER



**2+5** Year  
Warranty  
Warranty for Full Time RVing  
Additional Equipment may be required for certain climate conditions.



*Full Time Residential Luxury*



Deluxe Coffered Ceiling Option

*Full Time  
Residential Luxury*

Model Key Largo  
Shown in Monte Carlo Decor  
with Honey Maple Cabinets



Pull-out Work Center

Exquisite interiors are the hallmark of the LANDMARK series of flagship, luxury fifth wheels by Heartland RV, and this Key Largo design is one of the best ever. You'll love LANDMARK kitchen's extraordinary storage and countertop space – featuring all hardwood cabinetry with detailed raised panels and pencil edge solid-surface counter tops. The appliances feature matching hardwood fronts, while the custom hanging pendant fixtures overhead lend to the coach's true residential look and feel.



Model Savannah  
with Chestnut Cabinets

Whether you're preparing meals or hosting guests, this LANDMARK is sure to impress with its stunning looks and spacious design. The layout of this model allows for a full wall pantry next to the optional 4-door refrigerator, 82 inch sofa and theater seating opposite the entertainment center featuring a 46" HD LCD TV, custom built-in fireplace and home office work station in the rear living area.



Dyson  
Cordless Vacuum  
Standard in all  
Landmarks



**KING  
BED**



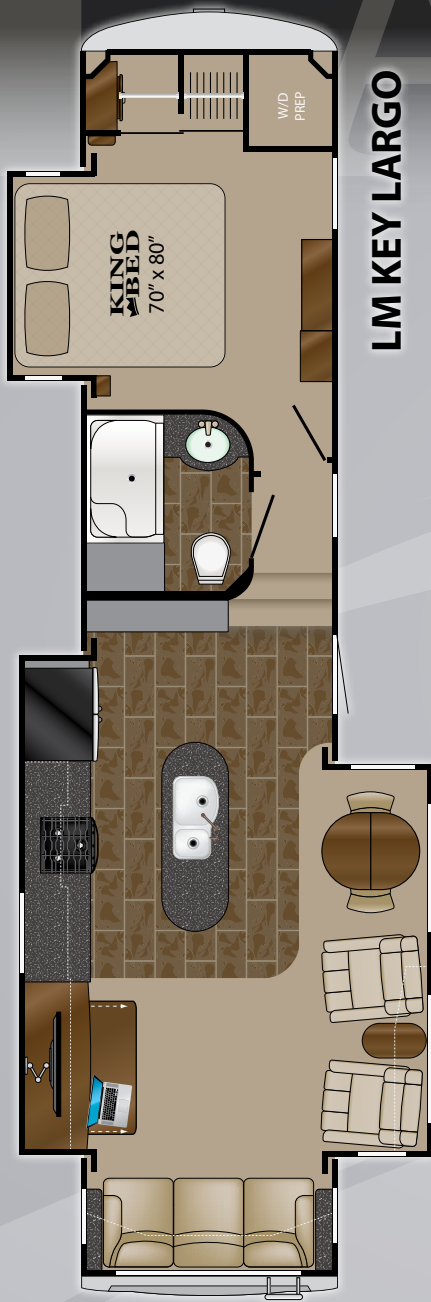

Length: 40' 2" Height: 13' 3"  
 Dry: 12,972 Hitch: 2,460  
 GVWR: 16,250

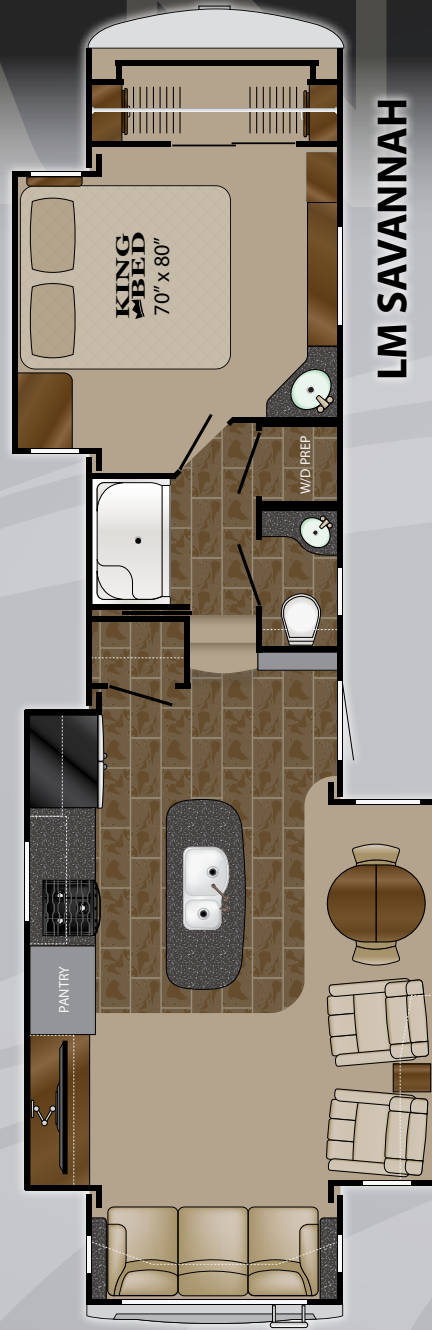

Length: 40' 0" Height: 13' 3"  
 Dry: 13,458 Hitch: 3,130  
 GVWR: 16,250



Length: 40' 7" Height: 13' 3"  
 Dry: 13,488 Hitch: 2,860  
 GVWR: 16,250

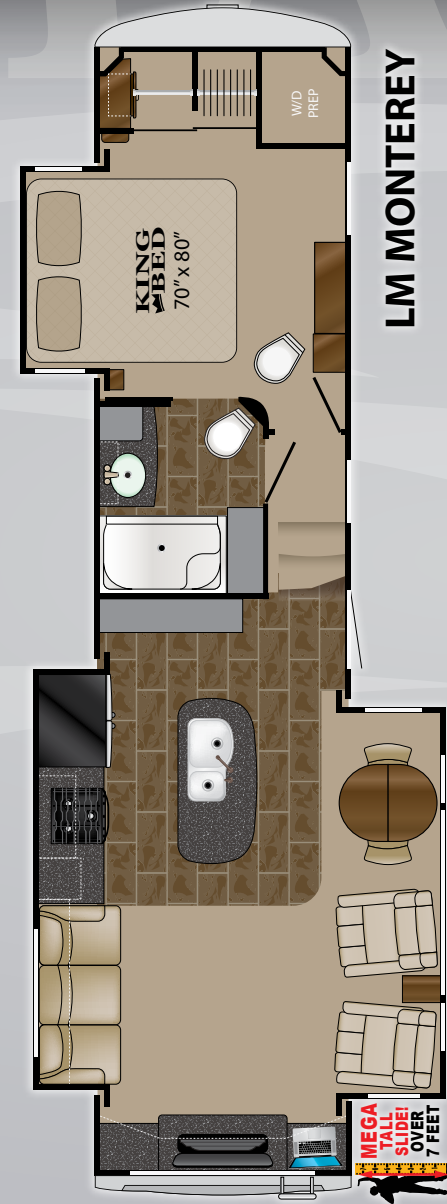

Length: 36' 10" Height: 13' 3"  
 Dry: 13,194 Hitch: 2,600  
 GVWR: 16,250



Note: Length defined as tow point (Ball coupler for travel trailers / King pin for 5th wheel trailers) to rear bumper. It does not include the rear ladder. Add 9" w/ Extended Pin Box

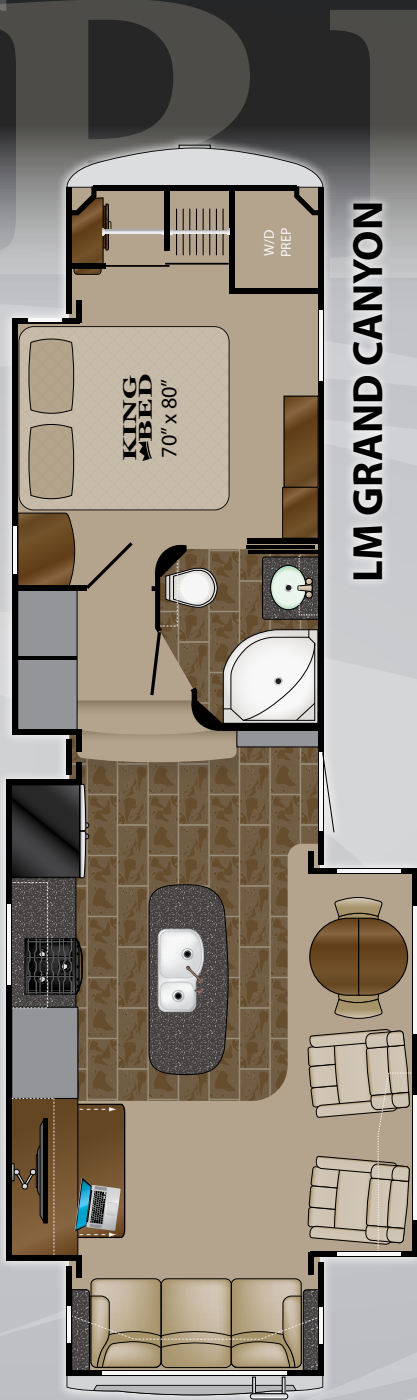

Length: 38' 8"    Height: 13' 3"  
 Dry: 12,629    Hitch: 2,295  
 GVWR: 16,250

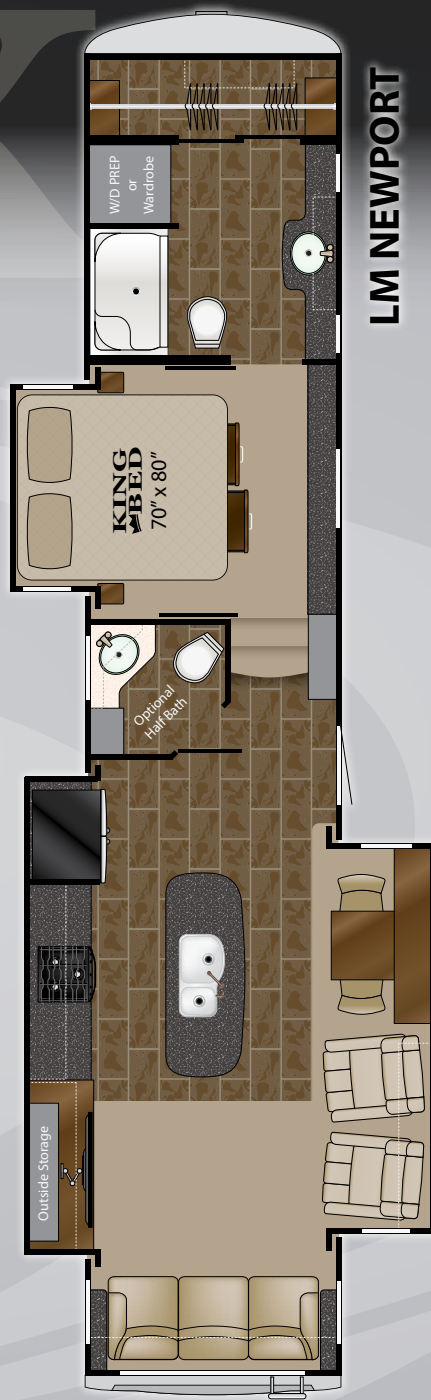

Length: 42' 7"    Height: 13' 3"  
 Dry: TBD    Hitch: TBD  
 GVWR: 16,250



Partial Body Paint  
 Pearl Sidewall Option



Chocolate  
 Full Body  
 Paint Option



Silver Full Body  
 Paint Option



**2<sup>nd</sup> Year Limited Bumper-to-Bumper.**  
**5<sup>th</sup> Year Structural Warranty.**



**Warranty for Full Time RVing**  
Additional Equipment may be Required for Certain Climate Conditions



## Full-Timer Package

Convenience Features, Direct from the Factory...

- ✓ Tire Pressure Monitoring System
- ✓ Complete Coach Surge Protector
- ✓ Accessory Receiver



One Touch Six Point Hydraulic Auto Leveling System option. Spend more time relaxing and less time leveling your coach. The Auto Level function will level your coach in less than 30 seconds!



180 170 160 150 140 130 120 110 100 90 80 70 60 50 40 30 20 10 0

**NOTHING TURNS LIKE THE ORIGINAL**  
**88°**  
**ACHIEVE 88° TURNING!**  
**IN A SHORT-BED, EXTENDED CAB TRUCK**  
 CORNERING IN-TOWN or BACKING INTO CAMPSITES

**BEWARE OF IMITATIONS!**  
**PATENT PENDING!**

**Perfect for Short-Bed, Extended-Cab Trucks**

**LED LIGHTING**  
*Lighting for the 21<sup>st</sup> Century*

**Brighter  
 Longer Life  
 Runs Cooler  
 Conserves Power**

- ✓ Laminated Floor R-40
- ✓ Heated, Enclosed & Insulated Underbelly
- ✓ Laminated SideWalls R-11
- ✓ Laminated Roof R-38
- ✓ Radiant Technology Insulated Caps R-38
- ✓ Insulated Slide Room Floor R-38
- ✓ Laminated, Insulated Bath & Bedroom Deck
- ✓ Pex Plumbing - Tested to -40°C / °F
- ✓ Dual Pane Window Option



R38 Radiant Technology Insulation:  
 110 Volt holding tank heating pads:  
 Insulated Main water line and  
 12V auto sensing heater line

# Whisper Quiet

A Landmark Exclusive

The Whisper Quiet is a unique combination of a high performance air conditioner, duct work and an exceptional top mounting design for maximum performance.

The Whisper Quiet system significantly reduces noise produced by traditional RV ceiling mounted A/C systems. Heartland mounts the A/C units outside the coach on top of the roof blows the cool air throughout the entire length of the coach through insulated ducts thus eliminating the intruding, noisy, unsightly A/C dump vent in the living area and bedroom.

This residential style system keeps noise and vibration outside your coach and away from the living space for greater comfort and quiet surroundings.

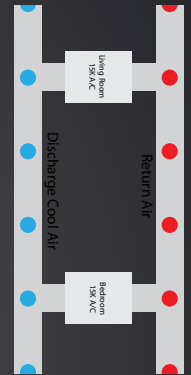

Even Circulation of **Cool** air and **Return** air from front to rear

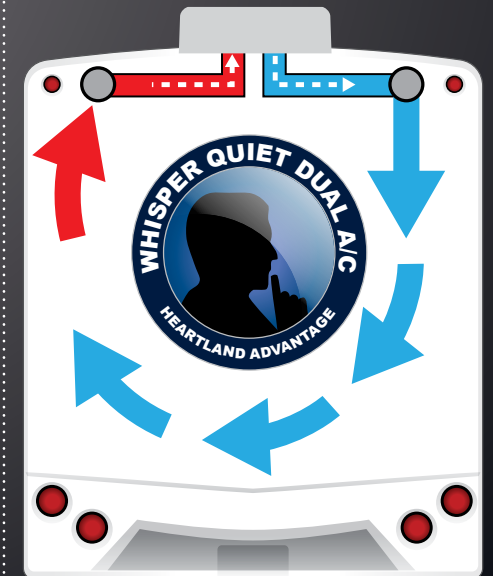

## STANDARDS

### INTERIOR

- Pull Out Storage Drawer in Steps
- Three Decors to Choose From
- Amish-Crafted Natural All-Hardwood Cabinet Stiles, Fascia, Doors and Drawers with Hand Rubbed Finish
- Hardwood Window Surrounds
- Hidden Cabinet Hinges
- All Cabinet Frames are Pre-Drilled, and Screwed Together - not stapled
- Deluxe Ball-Bearing, Full Extension Drawer Guides
- Hydraulic Slide System w/Independent Switches
- Custom Crafted Wardrobe with Cedar Lined Built-In Storage Rack and Dresser
- 32" Deep Bedroom Slide Rooms featuring one of the largest bedrooms available (N/A on Grand Canyon)
- Washer/Dryer Prep – with Closet for a Stackable Washer/Dryer
- 6'-4" Bedroom Ceiling Height Throughout
- Colossal 18 Cubic Foot Under-Bed Storage
- Deluxe Memory Foam Pillow Top King Size Bed with Pillow Package
- Welcome Back Light
- Dyson Cordless Vacuum Cleaner

### EXTERIOR

- High Gloss Laminated Fiberglass Sidewalls
- Double-Welded Aircraft Quality Aluminum SUPER-STRUCTURE Cage Construction Both 1.5" and 3" Tubular Design
- Deluxe Electric Awning w/LED Light
- Drip Rail with Down Spouts
- Frameless, Tinted Safety Glass Windows with UV Inhibitor
- Running Lights & Exterior Lights
- Entrance Step Light - Under Steps
- Automotive/Aerodynamic Styled Rear Cap
- LED Tail Lights (most models)
- Rear Ladder for Easy Roof Access
- Exterior Entertainment Center Prep
- One-Piece Seamless EPDM Rubber Roof
- 12" I-Beam Frame with Rust Prohibitive Coating
- Hydraulic Landing Gear (14X Faster than Electric)
- Heavy-Duty Load Range G 16" Goodyear Tires
- Deluxe 16" Aluminum Rims
- Recessed 16" Steel Rim Spare Tire
- E-Z Flex Rubber Dampening Suspension by Dexter
- 7,000 lb. Dexter Axles with E-Z Lube™ Hubs
- Four Heavy Duty Shock Absorbers
- 2 x 12" Nev-R-Adjust Brakes By Dexter
- Correct Track Alignment System
- 2 x 40# LP Bottles
- Exterior Fade-Resistant UV Protected Vinyl Graphics
- Linc Multipurpose Wireless Remote System with LCD Touch Screen Operates Slides, Power Awning, Front Landing Gear and Step Light
- One Touch Six Point Auto Leveling System

### UNDERBELLY

- Seamless Corrugated Underbelly Material
- Heated and Enclosed Underbelly with Direct Heat to Insulated Holding Tanks, Gate Valves and Registers
- Dual Insulation System (Flexfoil R-14 and a Formaldehyde Free Blanket of R-14)

### PLUMBING

- Universal Docking Center (U.D.C.) with High Pressure Fresh Water Fill System
- Color-Coded Water Lines with Limited Warranty
- AquaJet ARV 5.3 Variable Speed Smart Pump Quick & Easy Winterization System in U.D.C.

### POWER

- Upgraded 80 AMP/12V DC Converter
- 50 Amp Marine Cord with Electric Power Cord Reel with 34' Cord
- Dual Battery Box - One 12V Battery (room for two)
- Convenient Battery Shut-Off Switch

### HEATING

- Seamless One Piece In-Floor Heat Duct
- 42,000 BTU Furnace
- Heated Stool Room (Most Models)

### COOLING

- Whisper Quiet Air Conditioner System Featuring Fully Ducted, Dual 15,000 BTU high efficiency A/C
- Rain Sensor Fan Thermostat in Kitchen (Moves 1,000 cu. ft. of air per minute)
- Air Conditioned Stool Room (most models)

### TOTAL INSULATION VALUES

- Walls - R11 Insulation
- Roof - R38 Insulation
- Floor System - R40 Insulation
- Slide Room Floors - Radiant Tech R38 equivalent

### ENTERTAINMENT & CONNECTIONS

- 40" or 46" LCD TV (depending on model)
- Sound Bar w/ Subwoofer & Bluetooth Compatible
- Cable/Satellite TV Hookups in Bedroom and Exterior Storage Compartment
- Pre-wired for Winegard Trav'ler Satellite System
- Large Computer Desk/Work Station (most models)
- Blu-ray Player w/ Wireless Smart Technology

### LIVING ROOM

- Upgraded Ultra Leather Recliners (2)
- Ultra Leather Hide-a-Bed Flip & Fold Sleeper Sofa
- 110V Ceiling Fan (most models)

### APPLIANCES AND LIGHTING

- 12 Cu.Ft Refrigerator with Raised Wood Fronts
- 3-Burner Cook Top with Under Storage Cabinet
- Matching Solid Surface Cook Top Covers

- Over the Range 30" Convection Microwave Oven
- 12 Gal. Gas/Electric DSI W.H.
- Water Heater DSI Switch
- Full System Monitoring Panel

### KITCHEN

- True Solid Surface Countertops and sink covers
- Residential, Hardwood Cabinets with Hidden Hinges
- Backsplash Behind Oven
- Brushed Nickel Fixtures
- Cold Crack Resistant Flooring
- Deep Double Bowl Residential Stainless Steel Sink
- Boutique Pull Out Sprayer Faucet
- Deluxe Ball-Bearing, Full Extension Drawer Guides
- Pots/Pans Storage Cabinet
- Custom Crafted Dinette Table, 2 Stationary & 2 Foldable Chairs with Storage in both the Table and Chairs
- Large, Deep Pantry (N/A with 4 Door Refer)
- Fantastic Fan with Rain Sensor

### BATH AREA

- One Level Floor for the Entire Suite
- 6'-4" Bath/Bed Ceiling Height
- Linen Cabinet Storage (most models)
- True Solid-Surface Countertop with Pencil Edge
- Large Mirrored Medicine Cabinet
- Under mount Sink with solid surface Sink Cover
- Towel Racks, Robe Hook, Tooth Brush Holder and Soap Dish

### COMMODOE ROOM

- Power Roof Ventilation
- Dual 12V Lights with Soft Lighting Lenses
- Real China Commode with Foot Flush
- Heat Duct and Air Conditioning Duct in the Commode Room (Most Models)

### SHOWER

- Residential One-Piece Radius Fiberglass Shower with Decorative Glass Door (Floor plan specific)
- Mini-Meg Shower with Residential Style Shower Door (Floor Plan specific)
- Radius Domed Skylight

### FOR YOUR PROTECTION

- Fire Extinguisher by Entry Door
- Smoke, LP, CO2 Detectors
- Fire Escape Windows

### OPTIONS EXTERIOR

- Moryde™ Pin Box
- Disc Brakes
- Generator Prep
- 5.5KW Onan LP Generator
- Slide Awnings
- ABS Hitch Cover

- Two Custom Full Body Paint Exterior Graphic Options
- Outdoor Entertainment Center with 32" TV, Stereo/DVD and Speakers
- 17.5" Aluminum Wheels with H Rated Tires
- Wireless Back up Camera w/ Monitor

### INTERIOR

- 32" LED Flat Screen TV/DVD Combo for Bedroom
- 22 cu ft Residential Refrigerator w/ Stainless Steel Appliances
- Power Theater Seating
- Programmable Safe
- Glazed Chestnut Cabinetry
- Deluxe Coffered Ceiling
- Queen Bed in place of King Bed

### APPLIANCES

- Electric Fireplace
- Stackable Washer/Dryer
- Three Burner Cook Top with Oven (ask dealer)
- Dishwasher (Some Models)

### HEATING & COOLING

- Fantastic Fan in Bathroom w/Rain Sensor
- Dual Pane Windows with UV Protect. Tint
- Heat pumps Available

### Yeti Extreme Weather Package

- The Ultimate for Cold Weather Survival
- Heated Tank Pads
- Radiant Technology Insulation in Front & Rear Caps
- Heated Main Water Line
- -Low Volt Polymer Heating Cable

### Full-Timer Package (Generator Prep Required)

- Tire Pressure Monitoring System
- Complete Coach Surge Protector
- 1¼" Accessory Receiver

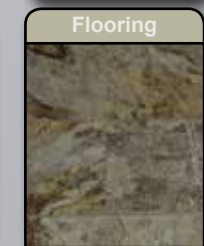
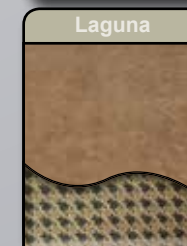
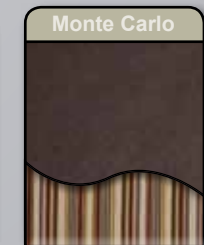
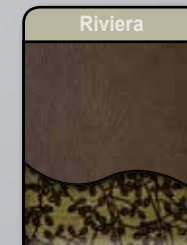



Heartland Recreational Vehicles

1001 All-Pro Drive • Elkhart, IN 46514 • 574-262-5992

### Community. Convenience. Close-to-home.

Where you purchase your recreational vehicle is ultimately your decision but Heartland urges you to consider buying at your local dealer. Dealers are part of your community, providing jobs and contributing to your local economy. These dealers are under obligation to provide warranty service for products they sell, but are not legally required to service products purchased from other dealers. At some point, you may need to return to the dealer you buy from - why not stay close to home? After all, home is where your Heartland is!

### BENEFITS OF PURCHASING YOUR RV LOCALLY:

- You enjoy valuable relationship building with Dealer Representatives, close to your home, who will explain the features and benefits of the product.
- You receive a full product orientation prior to delivery, which includes hands-on directions for many of the coach's systems and functions. You are also introduced to the Dealership's Service/Parts/Warranty personnel who are at the ready to help you with any issues you may encounter, now and in the future.
- You enjoy customer PRIORITY. Dealerships generally service their purchasing customers first - others may experience long delays and miss opportunities to use their RV. What is it worth for you to have a dealership's full attention and motivation to satisfy you when you need service - in a timely manner?
- Valuable TAX dollars and jobs stay in YOUR community which pays for your roads, schools, police and fire departments.

### DON'T UNDERESTIMATE CUSTOMER SERVICE AND PERSONAL CARE!

For Canadian Residents: If you purchase an RV out-of-country, there are additional fees, taxes and inspections that must be met before bringing your product home. Your local Canadian dealers are experts in these provisions.

Visit HEARTLAND on:



Your Authorized Heartland Dealer:

HEARTLAND PROUDLY PARTNERS WITH THE HIGHEST QUALITY VENDORS  
in manufacturing our recreational vehicles:



# LANDMARK

BY HEARTLAND

*Full Time Residential Luxury*



**HEARTLAND  
CUSTOMER SERVICE  
WE'VE GOT YOUR BACK!**

Over 40 men and women located in a dedicated facility servicing our customers every day. With a dealer network of over 400 locations across the U.S. and Canada, you're never far from an authorized Heartland dealer.

[www.HEARTLANDRVs.com](http://www.HEARTLANDRVs.com)



- Experience:**
- Product Walk-Through Videos
  - Side By Side Comparisons
  - Feature Videos • Photo Galleries
  - Virtual 360° Tours
  - Detailed Floor Plans
  - News • Testimonials
  - Dealer Locator • Owners Club
  - Customer Service • Service Locator
  - and More at our Informative Web Site



Product information is as accurate as possible as of the date of publication of this brochure. Due to Heartland's commitment to continuous product improvement - floorplans, materials, components, features, specifications, options, etc. are subject to change without notice or obligation to Heartland Recreational Vehicles. Product information and specifications apply to coaches beginning with serial number 273679.

**Tow Vehicle Caution:** Owners of Heartland recreational vehicles are solely responsible for the selection and proper use of tow vehicles. All customers should consult with a motor vehicle manufacturer or their dealer concerning the purchase and use of suitable tow vehicles for Heartland products. Heartland disclaims any liability or damages suffered as a result of the selection, operation, use or misuse of a tow vehicle. Heartland's limited warranty does not cover damage to the recreational vehicle or the tow vehicle as a result of the selection of the tow vehicle.

See your nearest Heartland dealer to review a current model.