

# RESIDENCE

by Keystone

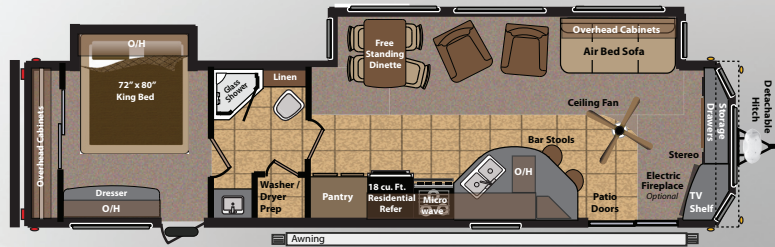

**401FE** LENGTH: 40' 11"  
WEIGHT: 10,889

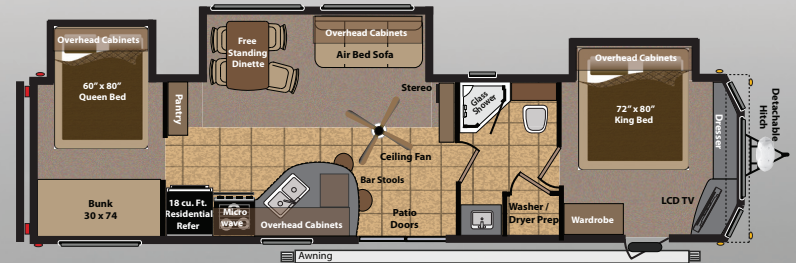

**402BH** LENGTH: 40' 11"  
WEIGHT: 11,713

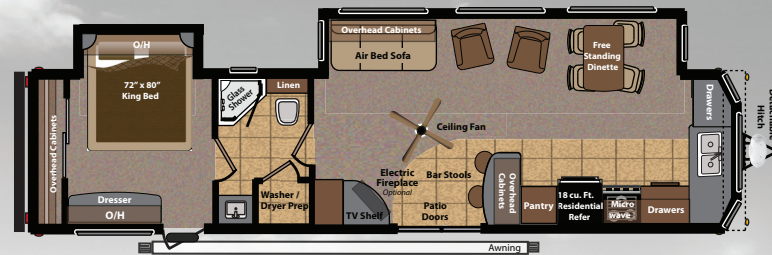

**403FK** LENGTH: 40' 11"  
WEIGHT: 10,886

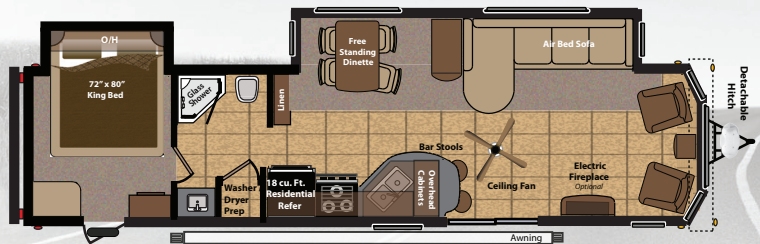

**405FL** LENGTH: 40' 11"  
WEIGHT: 10,778

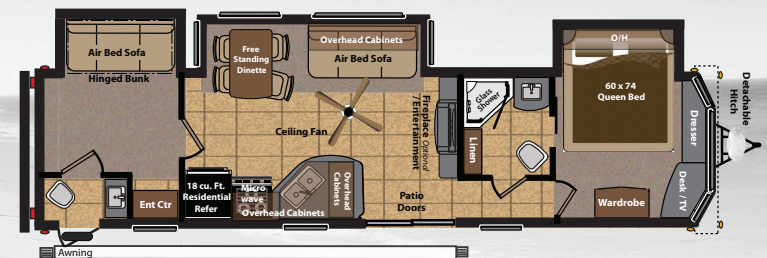

**406FB** LENGTH: 40' 11"  
WEIGHT: 11,774



Get the free mobile app  
at <http://gettag.mobi>  
and scan this Tag.

[www.keystonerv.com/residence](http://www.keystonerv.com/residence)



# Standards & Options

## APPLIANCES / EQUIPMENT

- 18 Cu. Ft. Residential Refrigerator\*\*\*
- 16 Gallon Gas/Electric Water Heater with DSI\*\*\*
- 100 Amp Power Converter
- In Floor Rigid Heat Ducting
- Smoke Detector
- L. P. Detector
- Dual 30 Lbs L. P. Bottles with/Auto Change Over\*\*\*
- 4 Stabilizer Jacks
- TV Antenna with Booster
- Satellite TV Prep
- Water Purifier\*\*\*
- Three Burner, High Output Range with 22" Oven
- 40,000 BTU Forced Air DSI Furnace with Thermostat
- Range Hood with 12 Volt Light and Exhaust Fan
- Fire Extinguisher
- CO2 Detector
- Hot Water By-Pass
- L. P. Bottle Cover
- 15,000 BTU Ducted A/C\*\*\*
- Cable TV Hook-Up
- Telephone Jack\*\*\*
- Space Maker Water System\*\*\*

## BATHROOM

- Glass Shower Enclosure
- Power Vent with Remote
- Lighted Medicine Cabinet with mirror
- Porcelain Stool with Foot Pedal
- Washer / Dryer Prep\*\*\*
- Shower Surround
- Skylight
- Linen Storage
- Toilet Paper Holder

## KITCHEN

- Raised Panel Upper Cabinets
- Faucet with Pull Out Sink Sprayer
- Microwave\*\*\*
- Spice Rack built in under the Kitchen Sink
- Extra Large Pantry
- Extra Large Residential Sink
- Extra Large Overhead Cabinets
- Extra Large Picture Window at Dinette
- Systems Monitor Panel
- Water Purifier\*\*\*

## LIVING ROOM

- Free Standing Table with 4 Chairs\*\*\*
- Swivel Rockers (N/A on all Models)
- Living Room Ceiling Fan\*\*\*
- Cable TV Hook Up
- Extra Large Picture Windows in the Slide
- 60" Dual Pane Sliding Glass Door
- Carpeting with Padding
- Vertical Blinds at the Patio Door
- AM/FM/CD/DVD Player with Speakers\*\*\*
- Residential Curtain Package with Day / Night Shades\*\*\*
- Air Hide-a-Bed Sofa\*\*\*
- Satellite Ready
- Extra Large Overhead Cabinets in Slide Room
- Residential Style 110 Volt Light Fixtures in the Slide Room
- Residential Style Furniture
- Wall Paper Border

## EXTERIOR

- XL Entry Swing Out Handle\*\*\*
- 16" Radial Tires
- Black Tank Flush\*\*\*
- Tinted Safety Glass Windows
- Hose Carrier Bumper with/ End Caps
- Patio Awning\*\*\*
- 50 Amp Electrical Service with/ Detachable Cord\*\*\*
- Outside Speakers
- Rain Gutter
- Radius Clamp Ring Windows
- Detachable Hitch
- Outdoor Activity Light\*\*\*

## MASTER BEDROOM

- 72" x 80" King Bed with Pillow Top\*\*\*
- Cable TV Hook Up
- Overhead Cabinets in Bedroom Slide
- Bedspread
- Mattress\*\*\*
- Satellite Ready
- Bedroom Entry / Exit Door

## CONSTRUCTION

- 12" Powder Coated I-Beam Frame
- 2" x 3" Floor Joists 12" on Center
- 102" Exterior Width
- 80" Slide Room Height

- 2" x 2" Sidewall Studs
- 5/8" Floor Decking
- 96" Interior Height
- One Piece Crowned Rubber Roof

## RESIDENTIAL PACKAGE

- 18 Cu. Ft. Residential Refrigerator
- 16 Gallon Gas / Electric Water Heater
- Dual 30 Lbs. L. P. Bottles with Automatic Change Over
- 15,000 Btu Ducted Air Conditioner
- Telephone Jack
- Water Purifier
- Microwave
- Free Standing Table with 4 Chairs
- Washer / Dryer Prep
- AM/FM/CD/DVD Player with Speakers
- Residential Curtain Package with Day / Night Shades
- Living Room Ceiling Fan
- Air Hide-a-Bed Sofa
- 72" x 80" King Bed with Pillow Top Mattress
- XL Entry Assist Swing Out Handle
- 50 Amp Electrical Service with Detachable Cord
- Black Tank Flush
- Patio Awning
- Outdoor Activity Light
- TV Cabinet with Shelf

## OPTIONS

- Outside Shower
- Bedroom Ceiling Fan
- 2nd 13,500 Btu Air Conditioner
- Delete Patio Awning
- Spare Tire Kit
- 4 Stabilizer Jacks
- LCD TV (floorplan specific)
- Fireplace
- Canadian Compliance

\*\*\* Feature is part of the Residential Package

**RESIDENCE**  
by Keystone

 **Keystone RV  
Company**

DISCLAIMER: Product information is as accurate as possible as of the date of publication of this brochure. All features, floor plans, and specifications in this brochure are subject to change without notice. Please also consult Keystone's web site at [www.keystonerv.com](http://www.keystonerv.com) for more current product information and specifications. Tow Vehicle Disclaimer. CAUTION: Owners of Keystone recreational vehicles are solely responsible for the selection and proper use of tow vehicles. All customers should consult with a motor vehicle manufacturer or their dealer concerning the purchase and use of suitable tow vehicles for Keystone products. Keystone disclaims any liability or damages suffered as a result of the selection, operation, use or misuse of a tow vehicle. KEYSTONE'S LIMITED WARRANTY DOES NOT COVER DAMAGE TO THE RECREATIONAL VEHICLE OR THE TOW VEHICLE AS A RESULT OF THE SELECTION, OPERATION, USE OR MISUSE OF THE TOW VEHICLE. \*Length is defined as the distance from the centerline of hitch pin/coupler to rear bumper of trailer. 03/13