

# Wildcat



**AFFORDABLE LUXURY  
WITHOUT COMPROMISE**

WILDCAT FIFTH WHEELS BY FOREST RIVER

# AFFORDABLE LUXURY WITHOUT COMPROMISE



Shown in Topaz décor, the new Wildcat 327CK features swivel glider recliners, a 39" Toshiba® HDTV with fully digital HDMI and iPod® connectors, Corian® kitchen countertops, abundant storage space, giant L-shaped aerobed® hide-a-bed sofa, as well as a 4600 BTU space-heating LED fireplace — ALL STANDARD! The dual facing slide rooms with numerous windows, including openable ceiling to floor atrium windows, provide ample square footage for the Shaw® residential grade carpeting with R2X™ stain and pet guard (also available with minimal carpeting).

## 327CK



The new 327CK features over 160 cu. ft. of pass through storage space (above) due to Wildcat's exclusive NXG drop frame and a giant-sized residential shower with seat (below)!

# Wildcat

For over a decade, Wildcat has been Forest River's best selling fifth wheel brand. This exceptional record began with innovative floor plans, class-defining features, and a rich set of options. It endures today with strong focus on unique designs, advanced construction using the latest building materials and technology, and a commitment to continuous improvement that sets Wildcat apart from the competition. When you choose Wildcat, you'll know why so many experienced RVers trust our family of products for their camping experience!



Optional 110V ceiling fan



The 327CK kitchen provides plentiful countertop real estate and boasts huge pantry and cupboard storage as well. And the refrigerator can still be accessed with the slide rooms closed! Shown with optional "wood plank" vinyl flooring.



The 327CK bedroom (right) has plenty of space for long or short term stays and offers optional washer/dryer prep. Wildcat's barrel roof provides an open and airy arched ceiling with plenty of headroom — fully 6'7" at its crown. Shown with optional 29" LED HDTV.



# 312BHX / 312QBX



Optional 110V ceiling fan

Both the Wildcat eXtraLite 312BHX with standard outside kitchen and 312QBX with standard kid's dinette and exterior cooktop stove and refrigerator, shown in Summerstone décor (above), feature Corian® countertops, aerobed® hide-a-bed sofa, and an entertainment center with a 39" Toshiba® LED HDTV including an iPod® connector and HDMI hook-up, another Wildcat class-exclusive feature.

## BIGGEST BEDROOM IN ITS CLASS



The arched roofline of Wildcat's eXtraLite bedroom (pictured above) features flush floors, 6'4" plus ceiling height, a wardrobe/linen slide room with window for cross ventilation, ample floor space around the bed, dual nightstands (with 110V outlets), a built in 12V/USB phone charger, and adjustable LED lighting. Paired with a curved shower door private bathroom (right), Wildcat has the biggest bedroom in its class!

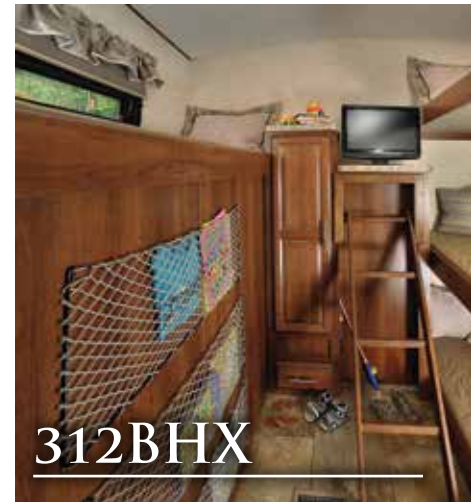

## 312BHX

In the rear of the 312BHX, this spacious bunkhouse sleeps 4 on wide staggered bunks (above) with storage nets, a swing-out ladder, wardrobe, and TV hook-up. Wildcat bunkhouse models also feature hard doors on all bunk rooms so kids or guests easily have privacy. Shown with optional 24" LED HDTV.



# 317RL



The 317RL with standard Outside Kitchen, shown in Buckskin décor (above), features a Corian® solid-surface kitchen countertop and an open rear living area with standard built-in 39" Toshiba® LED HDTV entertainment center, electric LED fireplace (a 4,600 BTU space heater!), and full width aerobed® sofa. Shown with optional 110V ceiling fan and reclining theater seating.



The 317RL features Wildcat's exclusive Weber® outside kitchen, with standard refrigerator, slot-wall, cable TV prep and overhead storage. Shown with optional 24" LED HDTV.

# 317RL

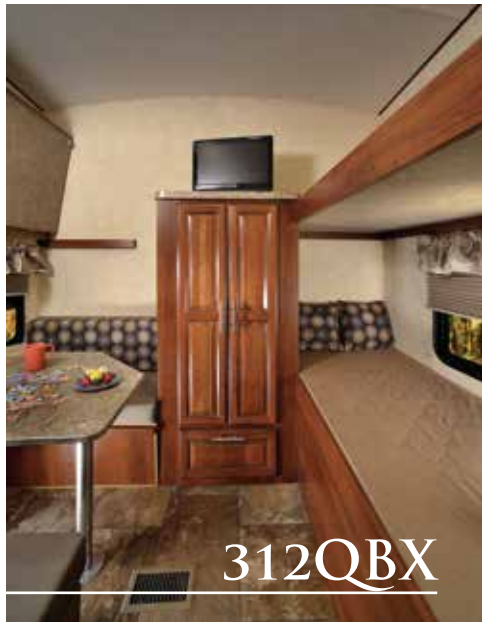

# 312QBX

The 312QBX bunkhouse features a stowable kid's dinette with folding bunk above, dual wide bunks, wardrobe, and TV hookup above. A stow-and-go door on the exterior wall allows for storage access during travel. Shown with optional 24" LED HDTV.

# WILDCAT: SUPERIOR CONSTRUCTION AND ENGINEERING

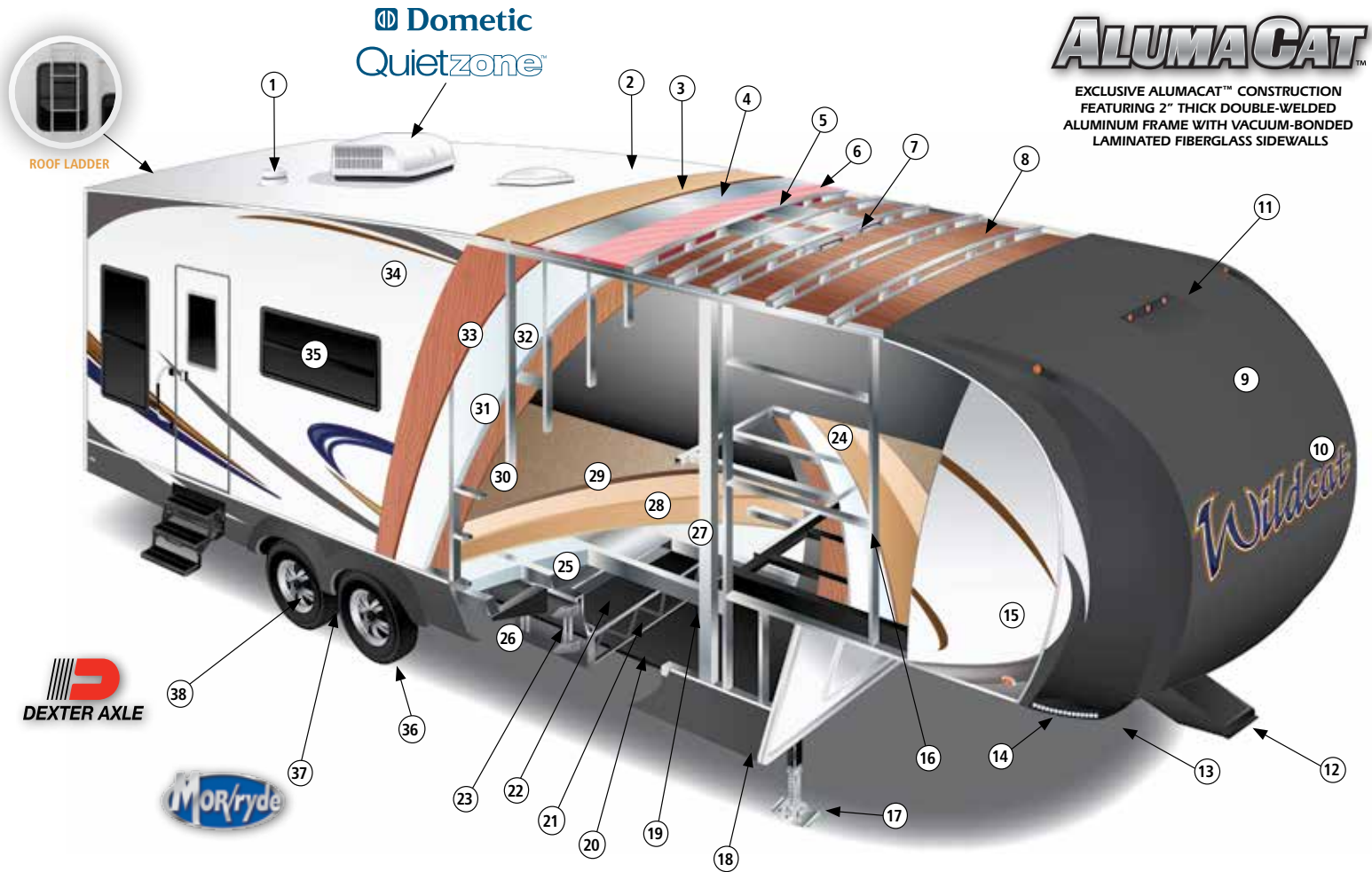

## ALUMACAT™

EXCLUSIVE ALUMACAT™ CONSTRUCTION  
FEATURING 2" THICK DOUBLE-WELDED  
ALUMINUM FRAME WITH VACUUM-BONDED  
LAMINATED FIBERGLASS SIDEWALLS

1. Attic Vent
2. One-Piece EPDM Rubber Roof Membrane (12 Year Warranty)
3. 3/8" Roof Decking (Full Walk-On Roof)
4. R+HEATSHIELD® Radiant Barrier Insulation
5. 5" Arched Aluminum Rafters on 16" Centers
6. Fiberglass Batt Roof Insulation (R-14)
7. Dual Ducted, Triple Insulated, Foil Wrapped, Light Weight Ducts
8. Laminated Vinyl Ceiling Decking with Luan Backer
9. Aerodynamic Custom-colored Fiberglass Front Cap
10. Custom Automotive-Grade Graphics Package
11. Built-in LED Lights
12. Extended MOR/ryde Pinbox
13. Optimized Turning Radius
14. Low Power/High Impact Exterior LED Lighting Kit
15. 2" Thick ALUMACAT™ Vacuum-Bonded Fiberglass Laminated Sidewalls
16. Welded CAD-Designed Cross Members
17. Spring-Loaded Quick Release Jack Pins on Landing Gear Legs
18. Laminated Radius-Wrap Aluminum Skirt Metal
19. 2" Aluminum Floor Joists, 12" on Center
20. Fully Enclosed Underbelly
21. Woven Moisture And Vapor Barrier
22. 50 Gallon Holding Tank with Black Tank Flush
23. 10.75" HSLA (High Strength, Low Alloy) Electrocoated NXG Frame by BAL (see image below)
24. Fully Laminated and Insulated Upper Bath Deck
25. 2" Dense Block Foam Insulation
26. Huck® Fastener Frame Assembly (vs. welded)
27. Fully Laminated Floor
28. Premium Carpet Padding
29. Residential-grade Shaw® Carpeting with R2X® Stain and Pet Guard
30. Interior Decorative Wall Board
31. Dense Block Foam Insulation (R-10)
32. 2" Welded Tubular Aluminum Wall Studs
33. Luan Backer
34. **Premium True High Gloss Gel Coat Exterior Sidewall (MANDATORY OPTION)**
35. Best in Class Black Frame Tinted Safety Glass Windows
36. 16" Custom Aluminum HiSpec Safety Wheels with Load Range 'E' 10-Ply Radial Tires
37. Premium MOR/ryde CRE/3000™ Suspension System
38. Dexter Axles with E-Z Lube™ Hubs

## ④ R+HEATSHIELD

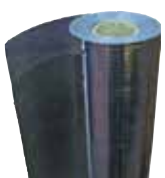

Wildcat's radiant barrier insulation is made from a woven polyethylene material covered by a metalized film. This metalized film provides a reflective surface that blocks 94 percent of radiant heat, so it helps keep your RV cooler in summer and warmer in winter.



**CLIMATECH™ UNDERBODY PROTECTION**  
FEATURING ENCLOSED, INSULATED, AND  
HEATED UNDERBELLY, TANKS, AND STORAGE

②③

Wildcat's new NXG Frame by BAL is a superior quality, highly engineered product that provides customers with a strong, light weight, consistent foundation. The HSLA (High Strength, Low Alloy) Prime Steel is Electrocoated and then assembled using Huck™ Fasteners for consistent clamp load.

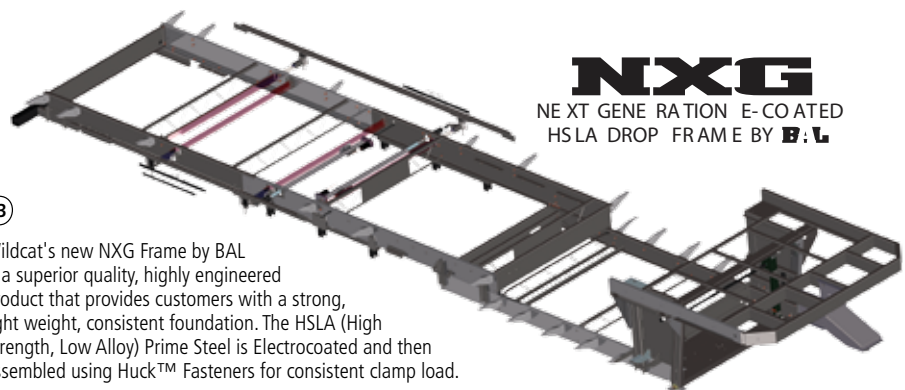

**NXG**  
NEXT GENERATION E-COATED  
HSLA DROP FRAME BY BAL

# BRAND NAME STANDARDS AND OPTIONS

MORE BRAND NAME RESIDENTIAL COMPONENTS AND FEATURES THAN ANY OTHER RV MID-PROFILE FIFTH WHEEL



Easy to maintain acrylic solid surface **Corian®** countertops by DuPont® provide beauty without sacrificing function.



All Wildcats feature residential **Shaw®** carpeting with patented and exclusive R2X® stain and pet guard. MADE IN THE USA!



Wildcat's fully digital entertainment system features a 120Hz refresh rate 39" **Toshiba®** LED HDTV connected via **HDMI®** to a DVD/CD/AM/FM/USB stereo system with **iPod®** dock connector — a class exclusive feature.



Optional luxury, high definition printed and embossed **IVC®** "wood plank" vinyl flooring features a multi-layer anti-slip/anti-stain shield, fiberglass strength layer, and comfort foam backing that resists mold and mildew.



The newly updated fully enclosed and LED lighted docking center includes a removable coiled hose outside shower, black tank flush, winterization kit, water heater bypass, battery disconnect, and dedicated cable and satellite jacks.



Low power, high impact exterior LED lighting is both highly visible and energy efficient. All of Wildcat's interior lighting is LED as well!



A 4600 BTU space-heating fireplace with LED lighting technology provides added warmth and ambiance in select models.



All Wildcat fifth wheels are pre-wired for the **Voyager®** digital wireless observation system, featuring **WiSight™** technology, providing a rear view camera while traveling and easier backing up at your site.



The new standard 16" custom aluminum **HiSpec®** Safety Wheels feature Provider brand load range 'E' 10-ply radial tires balancing style and safety.



Wildcat's new stylish hide-a-bed sofas all feature truly residential **aerobed®** mattresses. Setup is easy with the built in pump and putting it away is quick as well using their signature **Whoosh™** valve.



The 12V **Jensen®** 975 AM/FM/CD/DVD/USB AV System with Remote and Authentic **iPod®** Dock Connector Hook-up features fully digital **HDMI** hookups as well — a class exclusive feature!



Wildcat's new optional **Serta®** king sized memory foam mattress upgrade provides residential comfort and a huge sleeping area in most floor plans.



The standard **MOR/ryde CRE 3000™** suspension system utilizes a 3" travel slot and compression rubber equalizer for a smoother, safer ride.



Residential quality **Mastercraft™** swivel glider recliners ensure comfort and luxury where ever your travels may take you.



The easy to setup and easy to stow optional **Weber®** Q grill is capable of reaching a 600°F cooking surface for a true gourmet grilling experience!



The optional **Dyson®** DC35 digital slim vacuum is the most powerful cordless vacuum on the market today and the perfect way to keep your Wildcat dust and dirt-free.

# WILDCAT FIFTH WHEEL STANDARD FEATURES

## EXECUTIVE CHEF KITCHEN

- Raised Panel Hardwood Glazed Cherry Cabinetry
- Teflon Spacers in Cabinet Doors
- Residential Hidden Hinges
- Solid Core Cabinet Stiles with Screwed (not stapled) Construction

**NEW!** Residential Brushed Chrome Finish Door and Drawer Hardware

- Residential Full-Extension Steel Ball-Bearing Drawer Glides
- Ⓐ • **NEW!** Stainless Steel Microwave Oven with Turntable
- Ⓐ • Large 8 Cu. Ft. Dometic® Refrigerator
- Raised 6 Panel Hardwood Glazed Cherry Refrigerator Door Front Insert
- **NEW!** Stainless Steel Kitchen Backsplash
- Ⓐ • Design Collection Corian® Solid Surface Countertop (Kitchen)
- Flush-mount Corian® Sink Covers (Kitchen)
- Extra Large Dual-Basin American Stonecast™ Composite Sink (withstands temperatures up to 450 degrees!)
- Brushed Chrome Finish Pull-out Residential Style Metal Sprayer Faucet
- Ⓐ • **NEW!** Stainless Steel Range Vent with Light and Fan
- Ⓐ • **NEW!** Stainless Steel 22" Oven (16" in 272RLX Only) with Sealed Burner Range and Cover
- Extra Large Pot and Pan Drawer Below Oven (Most Models)
- Deep Storage Overhead Kitchen Cabinets
- Extra Large Residential Pantry
- Toe Kicks in Kitchen Cabinet Base
- Ⓐ • **NEW!** Premium Residential Congoleum® "Tile" Linoleum

## LIVING ROOM

- Ⓐ • **NEW!** Hardwood Glazed Cherry Slide Room Fascia
- Booth Dinette with Pedestal Table (Converts to Bed, N/A 327CK or 333MK)
- **NEW!** Full-Extension Storage Drawer and XL Utility Storage Cabinet under Booth Dinette
- Huge Panoramic Picture Window at all Dinettes (25% Larger!)
- **NEW!** Decorative Soft Shade "Crystal Ball" LED Lighting
- Overhead Cabinets in the Slide Out (Dinner Plate Depth)
- Pleated Night Shades
- Ⓐ • **NEW!** aerobed® Hide-A-Bed Sofa
- Ⓣ • 12V Jensen® 975 AM/FM/CD/DVD/USB AV System with Remote and Authentic iPod® Dock Connector Hook-up
- Ⓐ • **NEW!** 39" TOSHIBA® Flat Panel LED HDTV (1080p, 120Hz refresh rate) with **HDMI®** Hook-up (Fully Digital!)
- 2" Thick Alumacat™ Vacuum-bonded Laminated Slide Out (Including WALLS, CEILING, and END WALLS!)
- Taller Interior Slide Out Heights (6'2" + Standard in All Floor Plans!)
- Independent Satellite, Cable, & **HDMI®** Hook-ups
- 12V Lighting in Slide Out (vs. 110V)
- Ⓐ • LED Fireplace (4600 BTU Electric Space Heater, Heats Up to 400 Sq. Ft.!) with Multi-Function Remote (Select Models)
- Ⓐ • Swivel Glider Recliner Set (2, Standard in Select Models)
- All Windows in Slide Out Room Open for Cross-Ventilation
- Ⓣ • Interior LED Lighting (Low Power Draw, Cool, Efficient, High-Output!)
- Ⓐ • Shaw® Residential Carpeting with R2X™ Stain Guard

## BATHROOM

- Residential Porcelain Toilet with Foot Pedal Flush
- **NEW!** Extra Large Stainless Steel Lavatory Sink
- Fully Built-in Wood Medicine Cabinet with Mirror
- GFI Receptacles in Bathroom
- **NEW!** Residential Tile Pattern Shower Surround
- Glass Shower Enclosure
- **NEW!** Rounded Glass Sliding Door Shower (all Wardrobe Slide Floor Plans)
- Shower Skylight
- Residential Metal Shower Drains in Tubs and Showers (vs. Competitor's Plastic Drains)
- Power Vent Fan

## BEDROOM

- **NEW!** Exclusive Wildcamp™ Eco-Foam Queen-size Pillowtop Mattress
- **NEW!** Updated Custom Queen-size Bedspread and Pillows with Upgraded Headboard
- 6'4" Standing Height Throughout Bedroom (Most Interior Headroom and Floor Space in Class!)
- Ⓣ • **NEW!** USB/12V phone charging station in bedroom
- Dual LED Reading Lights over Bed (Cool to the Touch!)
- **NEW!** Dual-Ducted Air Conditioner Runs to Every Bedroom
- Hydraulic Struts To Lift the Bed Up for Storage (Select Models)
- **NEW!** Convenient 110V Outlets on Each Side of Bed
- Fully Finished Bed Bases
- **NEW!** Wardrobe Slide Room with Window for Cross Ventilation (Select Models)
- **NEW!** Nightstand in Bed Slides (Select Models)
- True Wood Privacy Doors to All Bunk Rooms
- **NEW!** All Bedrooms Pre-Wired for TV (Cable and Satellite Prep) with Backer in Wall

## EXTERIOR

- Ⓐ • Aerodynamic Custom Colored Fiberglass Front Cap with Built-in LED Lighting
- MOR/ryde Extended Pin Box (Adjustable)
- Ⓣ • LED Exterior Lighting (Including Running, Marker, Signal, and Tail Lights)
- Custom Colored Skirt Metal
- Spring-Loaded Quick Release Jack Pins on Landing Gear Legs
- Ⓐ • One-Touch Adjustable Electric Awning
- Flexible Extended Drip Spouts
- **NEW!** Outside Kitchen with Weber® Grill and Exterior Refrigerator (293REX, 303BHX, 312BHX, 317RL, 337FB, and 344QB)
- Dual Marine-grade Outside Stereo Speakers
- Roof-Mounted Adjustable Amplified TV Antenna (Digital Signal Compatible)
- Ⓐ • **NEW!** Custom Aluminum HiSpec Safety Wheels
- Ⓐ • 16" Load Range 'E' 10-Ply Radial Tires (ST235/80/R16/E)
- Ⓐ • Dexter Axles with EZ Lube™ Hubs and 12" Brakes
- Ⓐ • MOR/ryde CRE/3000™ Suspension System
- Ⓐ • **NEW!** Upgraded Universal Docking Center:
  - **NEW!** Water Heater Bypass
  - **NEW!** Winterization System
  - **NEW!** Separate Cable and Dedicated Satellite Jacks
  - Black Tank Flush
  - **NEW!** LED Lighting
  - **NEW!** Outside Shower Hookup with Detachable Quick Connect Coiled Hose
- Molded Fender Skirts
- Custom Automotive-Grade Graphics Package
- Ⓐ • Bus-style, Side Hinged Slam-Latch Exterior Baggage Doors (with Metal Catches, Locks, and Strike Plates vs. Plastic used by Competition)
- Over-sized Pass Through Storage Garage (Biggest in Class! Up to 160 cu. ft. of Space!)
- Ⓣ • **NEW!** LED Lighting in Pass-Through Storage
- Door Side Pass-Through Storage Entertainment Center Hook-ups (cable and 110V Outlets)
- Patio Light
- Folding Triple Entry Step with Step Light at Main Entry Door
- Attic Vents for Roof Ventilation
- Black Frame Tinted Safety Glass
- Cable/Satellite TV Hook-ups
- **NEW!** Furrion™ 30 Amp Powersmart™ LED Shore Power Inlet and Marine-style Heavy Duty Cordset
- Dual 30# LP Tanks Saddle-Mounted on Each Side of the Frame for Superior Weight Distribution
- **NEW!** LP Gas Quick Connect
- Manual Stabilizer Jacks

Ⓐ ADVANTAGE PACKAGE

Ⓣ TECHNOLOGY PACKAGE



## FOR YOUR SAFETY

- Manual Backup on all Main Slide Outs
- T-Mold Bulb Seals on all Slide Outs
- LP Leak Detector
- Smoke Detector
- Fire Extinguisher
- **NEW!** Furrion™ Faultsmart™ LED Heavy Duty Cordset (with Reverse Polarity and Neutral Loss Indicators)
- Carbon Monoxide Detector
- ⓐ **NEW!** LED Nightlight on Stairs
- **NEW!** Interior Stairwell Handrail
- Custom Made Grab Handle at the Entry Door
- GFI Receptes (in Appropriate Locations)
- Folding Entry Handle
- ⓐ **NEW!** Battery Disconnect
- Break Away Switch
- **NEW!** Folding Rear Ladder
- ⓐ **NEW!** Voyager® Wireless Backup/Rearview Camera Ready (Pre-Wired)
- Spare 16" Load Range 'E' 10-Ply Radial Tire
- Scare Light
- One Year Emergency Roadside Assistance Plan

## ⓐ WILDCAT'S NEW AND IMPROVED ALUMACAT™ 6-SIDED ALUMINUM CONSTRUCTION:

- 2" Thick Vacuum-Bonded Fiberglass Laminated Sidewalls (with Ultra Dense Block Foam Insulation)
- 2" Thick Vacuum-Bonded Fiberglass Laminated Slide Out (vs. Hollow, Hung Fiberglass)
- 2" Laminated and Insulated Floor (with Ultra Dense Block Foam Insulation)
- 5" Barrel Roof Truss System (Arched Ceiling Throughout Interior!)
- Gel-Coated Fiberglass Exterior Skin
- Extra Large Rolled Side Metal
- Black Frame Tinted Safety Glass Windows (Fully Aluminum Framed vs. No Framing in Competition!)
- Fully Aluminum Framed, Laminated and Insulated Upper Bath Deck (6'4" Height)
- 3/8" Decked (Front to Back) Full Walk-On Roof

## WILDCAT'S CLIMATECH™ INSULATION

### POLAR PACKAGE :

- R-10 Ultra Dense Block-foam Side Wall and End Wall Insulation
- R-14 Fiberglass Batt Roof, Cap, and Rear Wall Insulation
- ⓐ **NEW!** R+HEATSHIELD™ Radiant-Barrier Insulation (Blocks 94% of Radiant Heat Transfer!) Enhances R-Values
- Fully Enclosed, Heated and Insulated Underbelly and Valves
- Duct Heated Holding Tanks (Active vs. Passive Heating in Competition)
- Insulated Bedroom and Bunk Room Floors (R-10 vs. no Insulation in Competition)
- Insulated and Heated Full Pass-Through Storage

## UTILITIES

- ⓐ • 10 Gallon DSI Gas/Electric Quick Recovery Water Heater (Over 17 Gallons per Hour!)
- ⓐ • 35,000 BTU High-Output Furnace with Auto-Ignition (Largest in Class!)
- ⓐ • **NEW!** 13.5K BTU Dometic® Quiet Zone™ Ducted Premium Air Conditioner (26% MORE AIRFLOW!)
- **NEW!** Dual Ducted Air Conditioner "Racetrack" with Triple Insulated, Foil Wrapped, Light Weight Ducts
- Digital Thermostat
- 65 Amp Power Converter
- 12V Water Pump
- ⓐ • Black Tank Flush

## DRY CAMPING FEATURES

- Large Holding Tank Capacities (Largest in Our Class!)
- ⓐ **NEW!** All Lights 12V LED (Including all Slide Out Lights)
- Space for Multiple Batteries
- Fully Enclosed Underbelly (Keeps Debris off Tanks, Water Lines, etc.)

## WILDCAT EXCLUSIVE INNOVATIONS!

- C.T.S. (Central Trash System) Integrated Trash Can Storage with Access Door (select models)
- **NEW!** NXG™ BAL® Electrocoated HSLA Chassis (select models)
- **NEW!** NXG™ BAL® Electrocoated Drop-frame HSLA Chassis with Pass-through Storage Garage (select models)
- **NEW!** Voyager® Wireless Backup/Rearview Camera Ready (pre-wired and ready for plug and play installation!)
- **NEW!** Repositionable Rear Bumper for Bike Rack Upgrade
- **NEW!** HDMI® (High Definition Multimedia Interface) Entertainment Centers with Built-In HDMI® Cables (fully digital connections vs. competitor's ANALOG setup!)

ⓐ ADVANTAGE PACKAGE

ⓐ TECHNOLOGY PACKAGE

- **NEW!** Five New Custom Décor Options: Buckskin, Topaz, Summerstone, Bark and Hazelnut
- ⓐ • **MANDATORY OPTION PACKAGE:** Wildcat Advantage Package
- ⓐ **MANDATORY OPTION PACKAGE:** Wildcat Technology Package
- **MANDATORY OPTION: True High-Gloss Gel Coat Exterior Walls (Premium High-Gloss Surface with Smooth Finish)**
- Rear Electric Stabilizer Jacks
- 110V Ceiling Fan
- **NEW!** Hardwood Free Standing Table (with Slide-out Leaf) with 2 Storage Chairs and 2 Upholstered Folding Chairs
- 50 Amp Service & Dual Ducted 2nd A/C Prep (MANDATORY on 293RFX, 295RSX, 317RL, 327CK, 333MK, 337FB, and 344QB)
- **NEW!** 15K BTU Dometic® Quiet Zone™ Ducted Premium Air Conditioner (26% MORE AIRFLOW, in Place of Standard 13.5K A/C)
- **NEW!** Low-Profile Second 13.5K A/C with Pre-Wired Thermostat (Requires 50 Amp Service Option)
- **NEW!** IVC® Trekk™ "Wood Plank" Vinyl Flooring (minimal carpeting)
- Folding Bike Rack
- Washer/Dryer Prep (313RE, 317RL, 327CK, 333MK, 344QB only)
- 24" LED HDTV (Outside Kitchen or Bunkhouse Location)
- 29" LED HDTV (Bedroom Location)
- **NEW!** Serta® King Size Memory Foam Mattress upgrade (72" x 80", N/A 317RL, or 337FB)
- **NEW!** Reclining Theater Seating (select models, in place of recliners)
- La-Z-Boy® Recliner Upgrade (select models, set of 2, in place of standard swivel glider recliners)
- J-Lounge Sofa (282RFX Only, in place of recliners)
- **NEW!** Second aerobed® Air Mattress Hide-A-Bed Sofa (282RFX, 317RL, 327CK, and 333MK)
- **NEW!** Party Couch Dinette/Sleeper Sofa (select models, in place of hide-a-bed and dinette)
- **NEW!** Dyson® Digital Slim™ DC35 cordless vacuum (Select Models)
- **NEW!** Platinum Automotive Paint Package
- **NEW!** Voyager® Wireless Backup/Rearview Camera and Monitor Kit
- 12V Heated Tank Warmers
- Dual-Pane Windows
- CSA Seal (Canada Only)
- **NEW!** Minimal Carpeting (varies per floor plan)
- **NEW!** LP Gas Outside Kitchen Grill (in place of Weber® Electric Grill)



Platinum Automotive Paint Package

# FLOORPLANS

## 272RLX

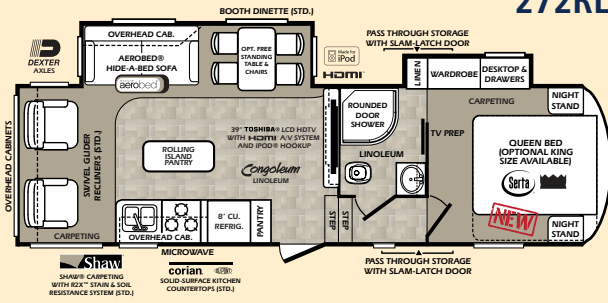

## 282RKX

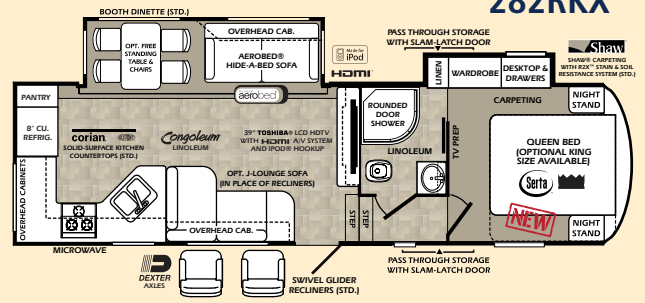

## 293REX

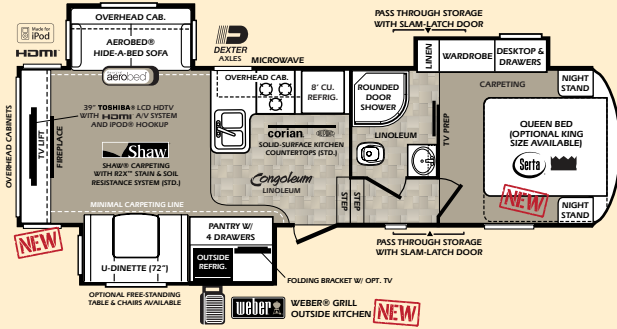

## 295RSX

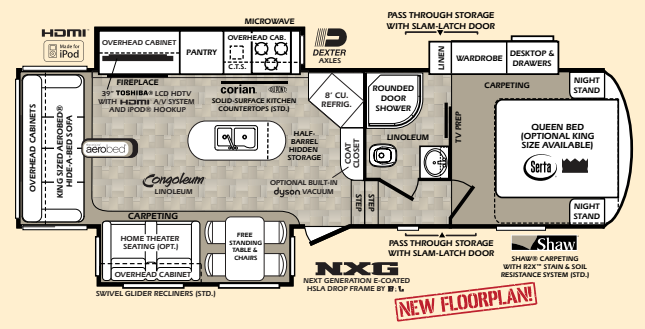

## 303BHX

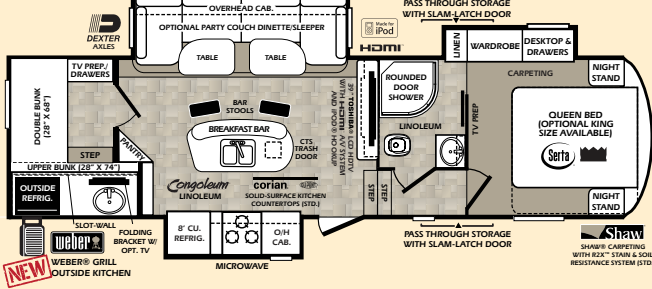

## 312BHX

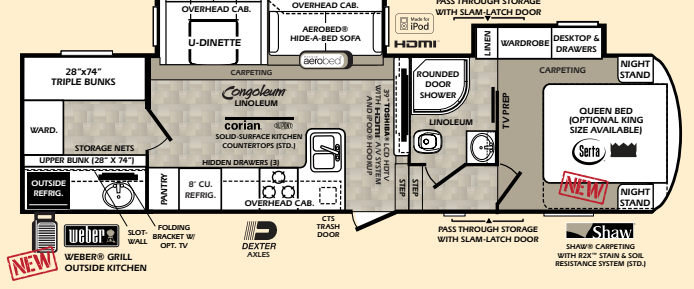

## 312QBX

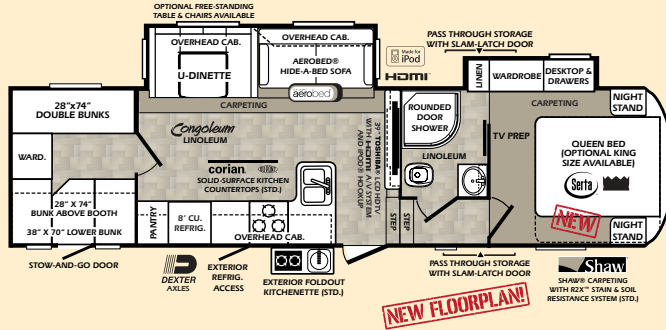

MODEL	272RLX	282RKX	293REX	295RSX	303BHX	312BHX	312QBX
HITCH WEIGHT	1,505 lbs.	1,385 lbs.	1,700 lbs.	1,630 lbs.	1,685 lbs.	1,720 lbs.	TBA
SHIP WEIGHT	8,225 lbs.	8,320 lbs.	8,905 lbs.	9,363 lbs.	9,310 lbs.	9,110 lbs.	TBA
GVWR	11,665 lbs.	11,785 lbs.	11,999 lbs.	11,999 lbs.	11,999 lbs.	11,999 lbs.	11,999 lbs.
CARGO CAPACITY	3,751 lbs.	3,406 lbs.	3,016 lbs.	2,636 lbs.	2,652 lbs.	2,831 lbs.	TBA
EXTERIOR LENGTH	30' 4"	31' 4"	31' 9"	32' 5"	32' 1"	34' 3"	34' 3"
EXTERIOR HEIGHT	12' 6"	12' 6"	12' 6"	12' 6"	12' 6"	12' 6"	12' 6"
FRESH WATER	60 gal.	60 gal.	60 gal.	50 gal.	60 gal.	60 gal.	60 gal.
GRAY WATER	100 gal.	100 gal.	100 gal.	100 gal.	100 gal.	150 gal.	100 gal.
BLACK WATER	50 gal.	50 gal.	50 gal.	50 gal.	50 gal.	50 gal.	50 gal.
L.P. CAPACITY	2x 30 lbs.	2x 30 lbs.	2x 30 lbs.	2x 30 lbs.	2x 30 lbs.	2x 30 lbs.	2x 30 lbs.
TIRE SIZE	ST235/80R16/E	ST235/80R16/E	ST235/80R16/E	ST235/80R16/E	ST235/80R16/E	ST235/80R16/E	ST235/80R16/E

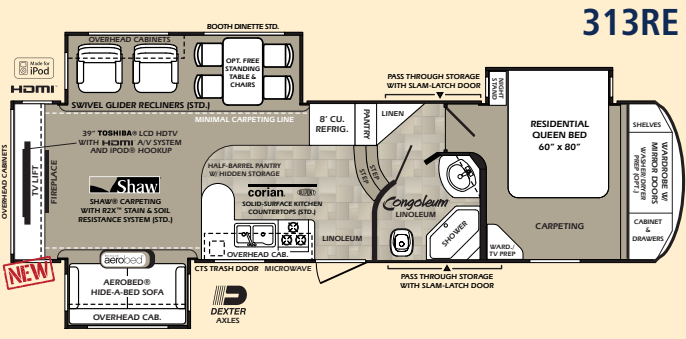

313RE

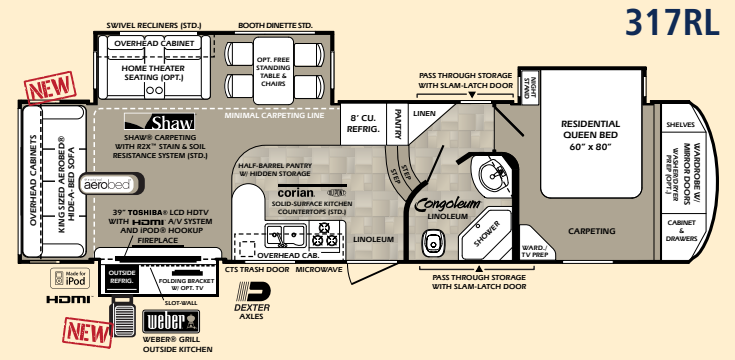

317RL

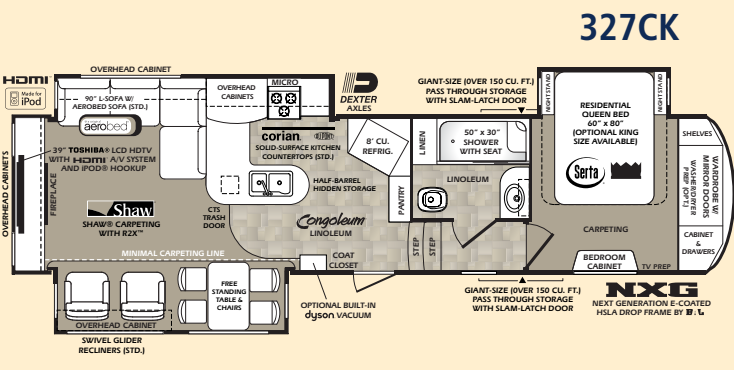

327CK

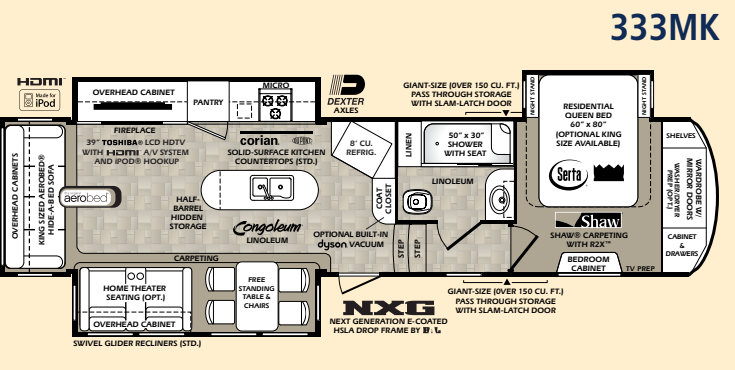

333MK

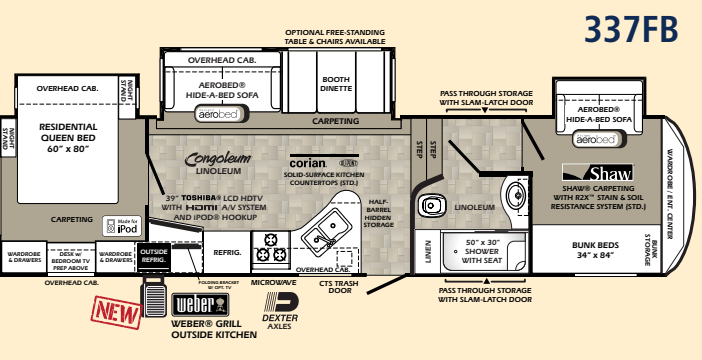

337FB

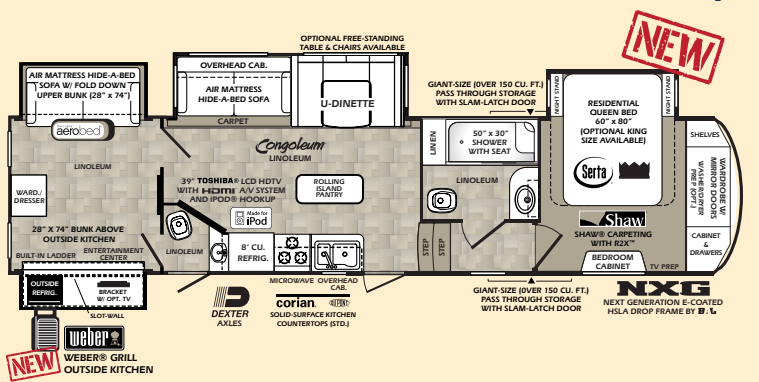

344QB

MODEL	313RE	317RL	327CK	333MK	337FB	344QB
HITCH WEIGHT	1,935 lbs.	1,855 lbs.	1,815 lbs.	2,020 lbs.	1,830 lbs.	1,735 lbs.
SHIP WEIGHT	9,865 lbs.	10,085 lbs.	10,410 lbs.	10,345 lbs.	10,615 lbs.	11,380 lbs.
GVWR	12,335 lbs.	12,255 lbs.	12,215 lbs.	12,420 lbs.	13,830 lbs.	13,735 lbs.
CARGO CAPACITY	2,411 lbs.	2,111 lbs.	1,746 lbs.	2,016	3,156 lbs.	2,296 lbs.
EXTERIOR LENGTH	35' 6"	36' 1"	37' 8"	38' 4"	38' 11"	38' 10"
EXTERIOR HEIGHT	12' 6"	12' 6"	12' 6"	12' 6"	12' 6"	12' 6"
FRESH WATER	60 gal.	60 gal.	60 gal.	60 gal.	60 gal.	60 gal.
GRAY WATER	100 gal.	100 gal.	100 gal.	100 gal.	100 gal.	100 gal.
BLACK WATER	50 gal.	50 gal.	50 gal.	50 gal.	50 gal.	100 gal.
L.P. CAPACITY	2x 30 lbs.	2x 30 lbs.	2x 30 lbs.	2x 30 lbs.	2x 30 lbs.	2x 30 lbs.
TIRE SIZE	ST235/80R16/E	ST235/80R16/E	ST235/80R16/E	ST235/80R16/E	ST235/80R16/E	ST235/80R16/E



SUMMERSTONE

BUCKSKIN

HAZELNUT

BARK

TOPAZ



**PRE-DELIVERY INSPECTION FACILITY**

20,000 square feet of quality assurance. The bare essentials for a premium product. This state-of-the-art facility gives immediate daily feedback to production for quality assurance in every unit built.

**24/7 EMERGENCY ROADSIDE ASSISTANCE**

For a worry-free ownership experience Forest River includes one year of Coach-Net RV Technical & Roadside Assistance with each RV purchase. Whether new to the RV lifestyle or an experienced RV enthusiast, Forest River owners have 24/7 access to technical, operational and emergency road service coverage throughout the US & Canada. Coach-Net's fast, dependable service is just a phone call away.

**Coach-Net<sup>®</sup>**

RV Technical & Roadside Assistance



**Wildcat**

Forest River, Inc. • Wildcat Division  
57475 County Road 3 • Elkhart, IN 46517 • (574) 389-3232  
www.forestriverinc.com/wildcat

 Visit our facebook page:  
[www.facebook.com/WildcatRVs](http://www.facebook.com/WildcatRVs)



**Forest River, Inc. encourages our customers to purchase their Forest River products from a local dealership whenever possible for the following reasons:**

- 1) Forest River, Inc. dealers are independently owned and operated businesses so priority service and scheduling is at their discretion and is often provided to customers that purchased their unit at that dealership.
- 2) Purchasing locally allows customers to establish meaningful relationships with a dealer, enhancing the RV experience through assistance with product questions, user tips or RV regulations for your state or country, and much more!
- 3) Canadian customers must meet requirements to bring an RV purchased out of the country to their home. These requirements may involve additional inspections and certifications, taxes and fees. Your local Canadian Dealer is a professional at meeting these requirements.
- 4) Scheduling timely warranty repairs and adjustments through a local dealership provides far greater flexibility and convenience to you, the customer!

It is the goal of Forest River, Inc. that all of our RV owners fully enjoy the RV experience and that customer satisfaction meets or exceeds their expectations!

**YOUR WILDCAT DEALER**



**Learn More**  
Scan this barcode using a QR Reader on your smart phone to learn more about Forest River.



A Berkshire Hathaway company.

©2014 Wildcat - a division of Forest River Inc. All specifications herein are based on the latest product information at time of printing. Forest River reserves the right to make changes in colors, materials, equipment and specifications at any time without notice and assumes no responsibility for any errors in this brochure. The photos in this brochure may show props and/or optional equipment. PRINTED 01/14