

# HILL COUNTRY



HCT31BH



Bathroom with tub/shower



Living Space



Kitchen/Dining Area

The exclusive Texas edition of the Hill Country line was designed to give you unmatched comfort. As you set up - the power awning, power stabilizer jack and power tongue jack make the “work” easy. Inside, the bed is a full-sized queen to give you a restful night’s sleep. The barrel roof ceiling offers nearly 7' of interior height while the deep slides expand your living space. You can relax in the living space cooled by the 15,000BTU air conditioner while you enjoy the special Texas flavor of Hill Country – ostrich feel furniture and Lone Star décor!



Master Bedroom

# FLOORPLANS

**HCT250RB** — TRAVEL TRAILER



**HCT28BH** — TRAVEL TRAILER



**HCT290QB** — TRAVEL TRAILER



**HCT29SS** — TRAVEL TRAILER



**HCT26RB** — TRAVEL TRAILER



**HCT30RE** — TRAVEL TRAILER



**HCT30RK** — TRAVEL TRAILER



**HCT32BH** — TRAVEL TRAILER

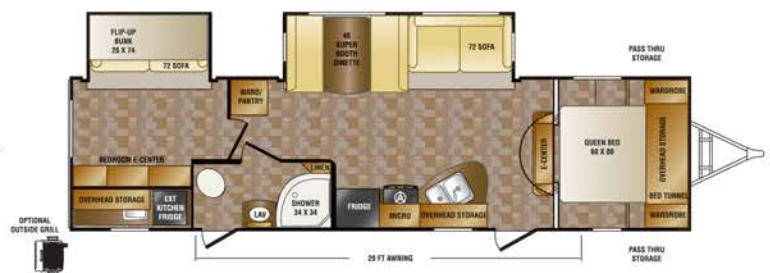

# SPECS

| HILL COUNTRY     | HCT250RB   | HCT290QB   | HCT26RB    | HCT28BH    | HCT29SS    | HCT30RE    | HCT30RK    | HCT32BH    |
|------------------|------------|------------|------------|------------|------------|------------|------------|------------|
| SHIPPING WEIGHT  | 5362       | 5811       | 6284       | 6464       | TBD        | 6244       | 6252       | 7081       |
| CARRYING CAP     | 2278       | 1985       | 3210       | 3038       | TBD        | 3230       | 3176       | 2489       |
| HITCH WEIGHT     | 640        | 796        | 694        | 702        | TBD        | 674        | 628        | 770        |
| AXLE WEIGHT      | 4722       | 5015       | 5590       | 5762       | TBD        | 5570       | 5624       | 6311       |
| EXT LENGTH       | 28' 9"     | 33'        | 30' 1"     | 32' 2"     | TBD        | 34' 5"     | 34' 5"     | 35' 11"    |
| EXT. HEIGHT W/AC | 11' 2"     | 11' 2"     | 11' 2"     | 11' 2"     | TBD        | 11' 2"     | 11' 2"     | 11' 2"     |
| FRESH WATER      | 40         | 40         | 40         | 40         | TBD        | 40         | 40         | 40         |
| BLACK WATER      | 26         | 26         | 40         | 40         | TBD        | 40         | 40         | 40         |
| GRAY             | 26         | 26         | 80         | 80         | TBD        | 40         | 80         | 80         |
| TIRE SIZE        | 205/75R15C | 205/75R15C | 225/75R15D | 225/75R15D | 225/75R15D | 225/75R15D | 225/75R15D | 225/75R15D |



# STANDARDS & OPTIONS

## EXTERIOR STANDARDS

- 6 Gallon (DSI) water heater gas/electric
- Tinted safety glass windows
- Outside speakers
- Swing out assist handle
- Secure stance suspension
- Outside shower
- 15" Aluminum wheels
- Black tank flush
- EZ lube axles
- TV antenna with booster
- Enclosed underbelly
- Automotive window trim seal
- LED awning
- TV bracket

- Pack-N-Play doors (varies by model)

## INTERIOR STANDARDS

- Microwave
- Freeze safe vinyl flooring
- Magnetic fridge panel
- Range with oven
- LED TV with bracket
- Double door 8 cu. ft. fridge
- CD/DVD surround stereo – blue tooth
- Designer privacy shades
- Skylight in shower
- Cable/satellite hook up
- Foot flush toilet – porcelain

- Ducted furnace
- Carbon monoxide detector
- Smoke detector
- LP detector
- Fire extinguisher
- Extra large bathrooms

## TEXAS PACKAGE

- 15,000 BTU A/C
- Bumper mount grill
- Power stabilizer jacks (on most)
- Power awning
- Power tongue jack (on most)
- Deco lighting

- Tub or shower glass enclosure (on most)
- Hide-a-bed – tri-fold (on most)
- Spare tire with bracket
- 60 x 80 True queen bed
- 48" Super booth (on most)
- Ostrich furniture

## OPTIONS

- ApolloTech insulation
- End table
- 4 Chairs with table
- 50 AMP service, wired for 2nd A/C
- 2nd A/C 13,5000 BTU

Product information is as accurate as possible at the date of publication. All features, floorplans, and specifications in this brochure are subject to change without notice.



# HILL COUNTRY