

# SOLAIRE

BY PALOMINO



PURE MICHIGAN®

190 X IN INDIGO



## SOLAIRE EXPANDABLES

All new Solaire Expandables represent true quality in the industry with a complete aluminum framed superstructure all floorplans come standard with true queen beds, efficient ride of the torsion axle and a barreled full walk on laminated roof, Palomino has truly hit the target with these 5 remarkable floorplans.

## SOLAIRE SEVENS

This sleek yet strong and graceful design allows for easy towability and exceptional rear visibility. Our laminated, crowned roof that's fully walkable and allows for increased interior head room. With interiors designed to make your camping experience a relaxing adventure.

25 BHSS IN ALMOND





318 TSBHK IN INDIGO

# SOLAIRE ULTRA LITES

The Ultra Lites are the results of superior design and modernization. Striving to meet all the customer's demand this trailer provides a smooth ride with independent suspension axles, aluminum superstructure frame for light weight towing and barreled ceilings for a more spacious interior.



# SOLAIRE WITH ECLIPSE PACKAGE

Our Eclipse package brings additional luxury into our Ultra Lite floorplans. From a fiberglass front cap with LED lighting and Line X® rock guard, frameless windows, aluminum wheels and upgraded Serta Trump® Mattress and several other features we have all the amenities encompassed.

\*\* This package will increase trailer weight by approximately 250 lbs.



315 RLTSEK IN CHESTNUT



190 X IN INDIGO



# SOLAIRE EXPANDABLES

Expandables are available in 5 spacious floorplans to meet all the needs of the consumer with both pearl and white fiberglass exterior available.



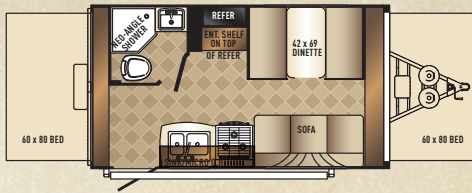

### 147 X\*

#### WEIGHTS & MEASURES

Hitch Dry Weight	<b>315 LBS.</b>	Exterior Width	<b>8'</b>
Dry Axle Weight	<b>2720 LBS.</b>	Travel Length	<b>18'4"</b>
Total Dry Weight	<b>3011 LBS.</b>	Fresh Water Capacity	<b>32 GALS.</b>
GVWR	<b>3815 LBS.</b>	Gray Water Capacity	<b>30 GALS.</b>
Interior Height	<b>6'8"</b>	Black Water Capacity	<b>30 GALS.</b>
Exterior Height *	<b>10'10"</b>	Cargo Carrying Capacity	<b>746 LBS.</b>

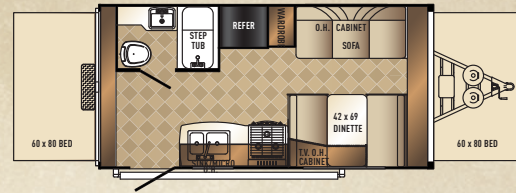

### 163 X

#### WEIGHTS & MEASURES

Hitch Dry Weight	<b>400 LBS.</b>	Exterior Width	<b>8'</b>
Dry Axle Weight	<b>3060 LBS.</b>	Travel Length	<b>20'2"</b>
Total Dry Weight	<b>3392 LBS.</b>	Fresh Water Capacity	<b>20'2"</b>
GVWR	<b>7400 LBS.</b>	Gray Water Capacity	<b>32 GALS.</b>
Interior Height	<b>6'8"</b>	Black Water Capacity	<b>30 GALS.</b>
Exterior Height *	<b>10'10"</b>	Cargo Carrying Capacity	<b>3906 LBS.</b>

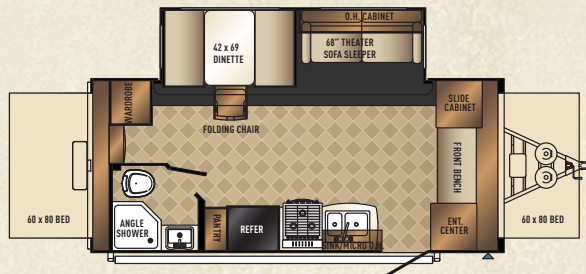

### 190 X

#### WEIGHTS & MEASURES

Hitch Dry Weight	<b>620 LBS.</b>	Exterior Width	<b>8'</b>
Dry Axle Weight	<b>3990 LBS.</b>	Travel Length	<b>22'11"</b>
Total Dry Weight	<b>4622 LBS.</b>	Fresh Water Capacity	<b>22'11"</b>
GVWR	<b>7620 LBS.</b>	Gray Water Capacity	<b>32 GALS.</b>
Interior Height	<b>6'8"</b>	Black Water Capacity	<b>30 GALS.</b>
Exterior Height *	<b>10'10"</b>	Cargo Carrying Capacity	<b>30 GALS.</b>
			<b>2976 LBS.</b>

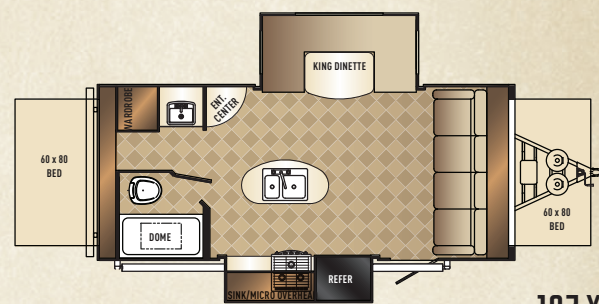

### 197 X

#### WEIGHTS & MEASURES

Hitch Dry Weight	<b>600 LBS.</b>	Exterior Width	<b>8'</b>
Dry Axle Weight	<b>4085 LBS.</b>	Travel Length	<b>23'9"</b>
Total Dry Weight	<b>4645 LBS.</b>	Fresh Water Capacity	<b>23'9"</b>
GVWR	<b>7600 LBS.</b>	Gray Water Capacity	<b>32 GALS.</b>
Interior Height	<b>6'8"</b>	Black Water Capacity	<b>30 GALS.</b>
Exterior Height *	<b>10'10"</b>	Cargo Carrying Capacity	<b>38 GALS.</b>
			<b>2881 LBS.</b>



### 213 X

#### WEIGHTS & MEASURES

Hitch Dry Weight	<b>605 LBS.</b>	Exterior Width	<b>8'</b>
Dry Axle Weight	<b>3675 LBS.</b>	Travel Length	<b>25'2"</b>
Total Dry Weight	<b>4280 LBS.</b>	Fresh Water Capacity	<b>25'2"</b>
GVWR	<b>7605 LBS.</b>	Gray Water Capacity	<b>32 GALS.</b>
Interior Height	<b>6'8"</b>	Black Water Capacity	<b>30 GALS.</b>
Exterior Height *	<b>10'10"</b>	Cargo Carrying Capacity	<b>30 GALS.</b>
			<b>3291 LBS.</b>

\* 147 X SINGLE AXLE WITH 5 CU. FT. REFRIGERATOR AND NO DUCTED A/C.

ALL EXPANDABLES HAVE A 19" TV OPTION.

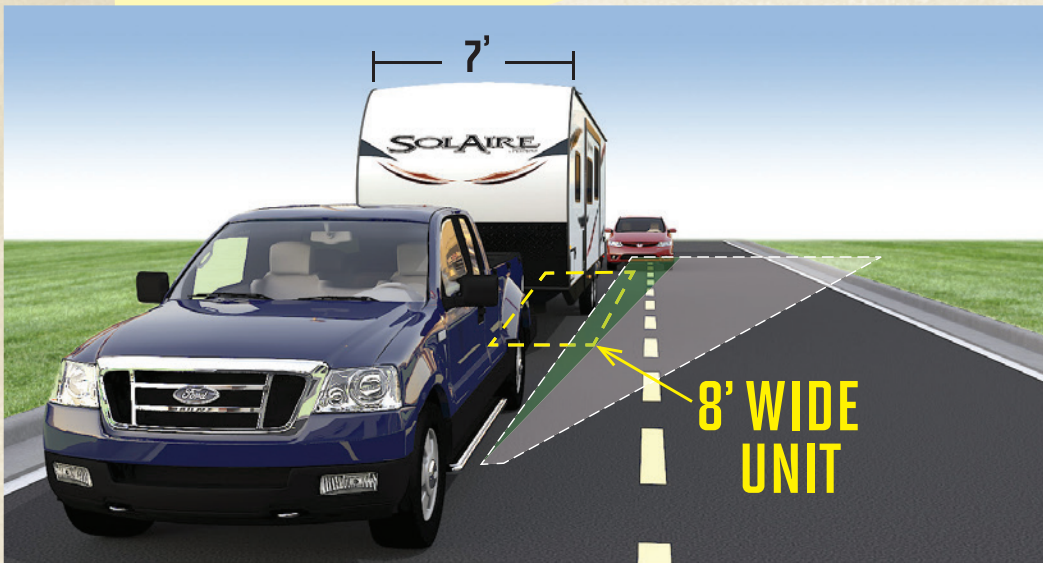
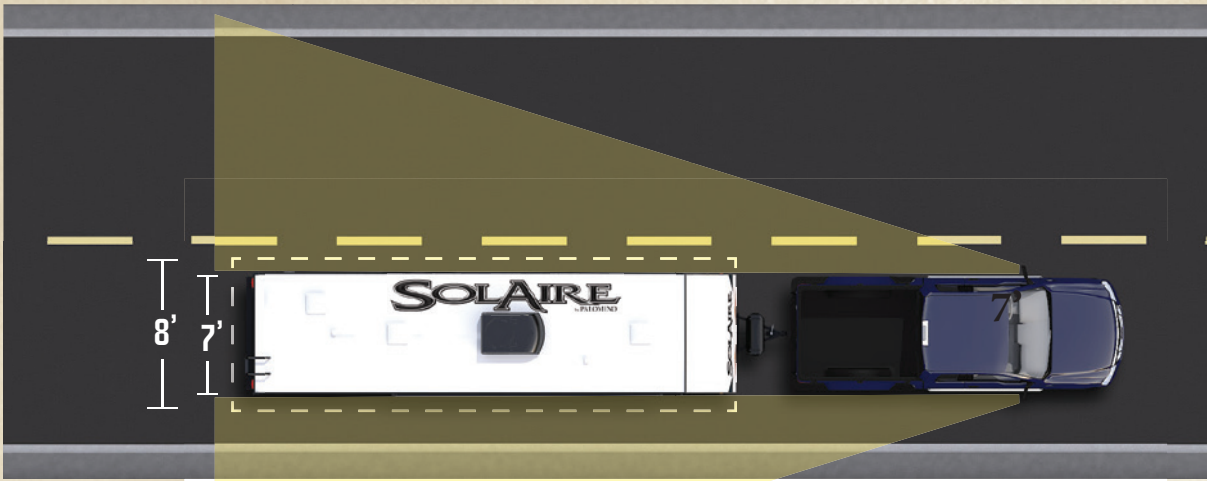

# SOLAIRE SEVENS

These innovative 7' wide travel trailers allow for a more aerodynamic towing experience. Suited for all your camping needs and creatively designed to be your home away from home.



25 BHSS IN ALMOND

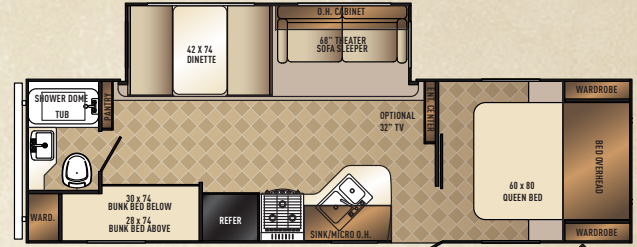

25 BHSS

**WEIGHTS & MEASURES**

Hitch Dry Weight	545 lbs.	Travel Length	29'5"
Dry Axle Weight	4220 lbs.	Fresh Water Capacity	32 gals.
Total Dry Weight	4690 lbs.	Gray Water Capacity	60 gals.
GVWR	7545 lbs.	Black Water Capacity	30 gals.
Interior Height	6'6"	Cargo Carrying Capacity	2746 lbs.
Exterior Width	7'		

Show in almond interior. Three available floor plans all standard with hard wood cherry cabinetry and LED interior lighting and optional 32" LED TV.

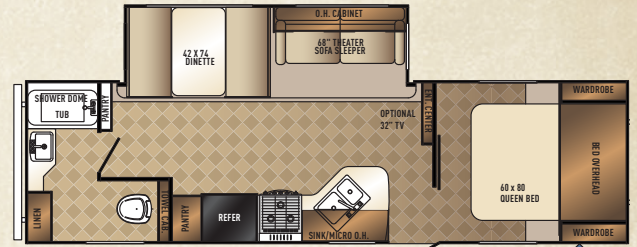

26 RBSS

**WEIGHTS & MEASURES**

Hitch Dry Weight	570 lbs.	Travel Length	29'5"
Dry Axle Weight	4190 lbs.	Fresh Water Capacity	32 gals.
Total Dry Weight	4695 lbs.	Gray Water Capacity	60 gals.
GVWR	7570 lbs.	Black Water Capacity	30 gals.
Interior Height	6'6"	Cargo Carrying Capacity	2776 lbs.
Exterior Width	7'		



25 BHSS

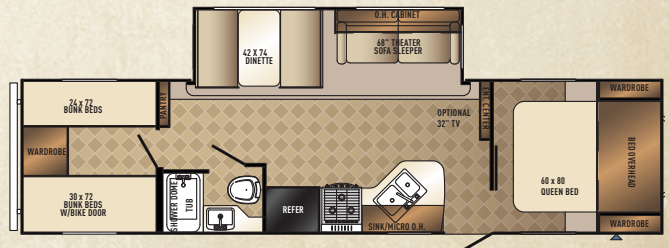

28 QBSS

**WEIGHTS & MEASURES**

Hitch Dry Weight	610 lbs.	Travel Length	32'6"
Dry Axle Weight	4390 lbs.	Fresh Water Capacity	32 gals.
Total Dry Weight	4990 lbs.	Gray Water Capacity	30 gals.
GVWR	7610 lbs.	Black Water Capacity	30 gals.
Interior Height	6'6"	Cargo Carrying Capacity	2576 lbs.
Exterior Width	7'		

318 TSBHK IN INDIGO



# SOLAIRE ULTRA LITE

Exceptional elegance with all the residential features you could desire. These Ultra Lite travel trailers are light weight with plenty of comforts to make your family camping trips a dream come true.



Pass thru storage with LED lighting



Bunk house floorplans available



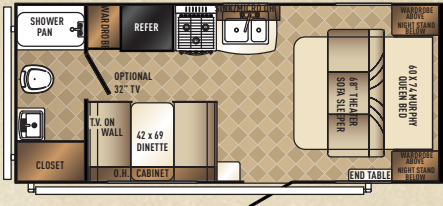

**192 RB \***

**WEIGHTS & MEASURES**

Hitch Dry Weight	400 LBS.	Travel Length	23'6"
Dry Axle Weight	3390 LBS.	Fresh Water Capacity	32 GALS.
Total Dry Weight	3742 LBS.	Gray Water Capacity	30 GALS.
GVWR	7400 LBS.	Black Water Capacity	30 GALS.
Interior Height	6'8"	Cargo Carrying Capacity	3576 LBS.
Exterior Height	10'10"		

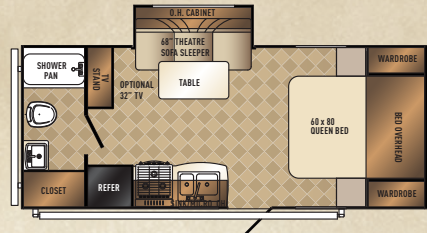

**201 SS**

**WEIGHTS & MEASURES**

Hitch Dry Weight	460 LBS.	Travel Length	23'6"
Dry Axle Weight	3390 LBS.	Fresh Water Capacity	32 GALS.
Total Dry Weight	3826 LBS.	Gray Water Capacity	38 GALS.
GVWR	7460 LBS.	Black Water Capacity	30 GALS.
Interior Height	6'8"	Cargo Carrying Capacity	3576 LBS.
Exterior Height	10'10"		

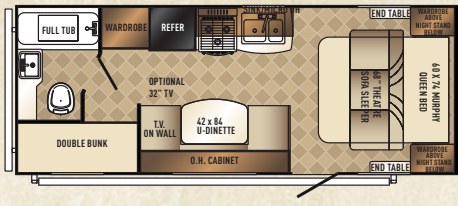

**209 BH \***

**WEIGHTS & MEASURES**

Hitch Dry Weight	550 LBS.	Travel Length	25'4"
Dry Axle Weight	3325 LBS.	Fresh Water Capacity	32 GALS.
Total Dry Weight	3851 LBS.	Gray Water Capacity	30 GALS.
GVWR	7550 LBS.	Black Water Capacity	30 GALS.
Interior Height	6'8"	Cargo Carrying Capacity	3641 LBS.
Exterior Height	10'10"		

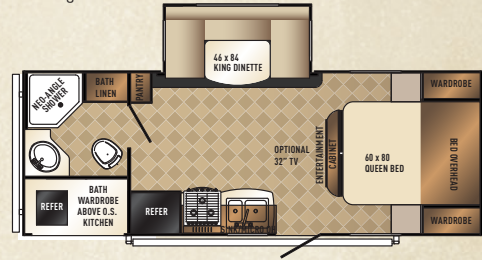

**226 RBK**

**WEIGHTS & MEASURES**

Hitch Dry Weight	710 LBS.	Travel Length	25'10"
Dry Axle Weight	4305 LBS.	Fresh Water Capacity	32 GALS.
Total Dry Weight	4991 LBS.	Gray Water Capacity	68 GALS.
GVWR	7710 LBS.	Black Water Capacity	38 GALS.
Interior Height	6'8"	Cargo Carrying Capacity	2661 LBS.
Exterior Height	10'10"		

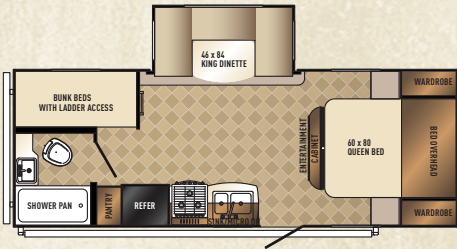

**229 BHS**

**WEIGHTS & MEASURES**

Hitch Dry Weight	730 LBS.	Travel Length	26'1"
Dry Axle Weight	3985 LBS.	Fresh Water Capacity	32 GALS.
Total Dry Weight	4691 LBS.	Gray Water Capacity	68 GALS.
GVWR	7730 LBS.	Black Water Capacity	38 GALS.
Interior Height	6'6"	Cargo Carrying Capacity	2981 LBS.
Exterior Height	10'10"		



**239 DSBH**

**WEIGHTS & MEASURES**

Hitch Dry Weight	800 LBS.	Travel Length	27'1"
Dry Axle Weight	4590 LBS.	Fresh Water Capacity	32 GALS.
Total Dry Weight	5239 LBS.	Gray Water Capacity	68 GALS.
GVWR	7800 LBS.	Black Water Capacity	38 GALS.
Interior Height	6'8"	Cargo Carrying Capacity	2376 LBS.
Exterior Height	10'10"		

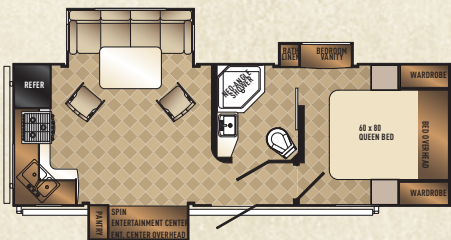

**247 RKES**

**WEIGHTS & MEASURES**

Hitch Dry Weight	590 LBS.	Travel Length	27'10"
Dry Axle Weight	5075 LBS.	Fresh Water Capacity	32 GALS.
Total Dry Weight	5463 LBS.	Gray Water Capacity	76 GALS.
GVWR	8590 LBS.	Black Water Capacity	38 GALS.
Interior Height	6'8"	Cargo Carrying Capacity	2891 LBS.
Exterior Height	10'10"		

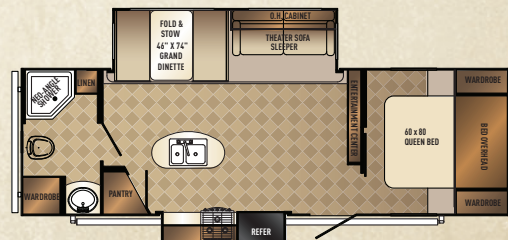

**263 RBDSK**

**WEIGHTS & MEASURES**

Hitch Dry Weight	790 LBS.	Travel Length	30'0"
Dry Axle Weight	5175 LBS.	Fresh Water Capacity	32 GALS.
Total Dry Weight	5895 LBS.	Gray Water Capacity	68 GALS.
GVWR	7790 LBS.	Black Water Capacity	38 GALS.
Interior Height	6'8"	Cargo Carrying Capacity	1791 LBS.
Exterior Height	10'10"		

\* 192 RB & 209 BH HAVE MURPHY BEDS

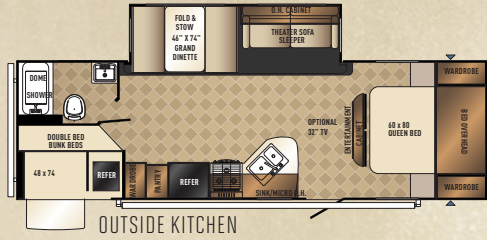

**WEIGHTS & MEASURES**

Hitch Dry Weight	885 LBS.	Travel Length	30'11"
Dry Axle Weight	4475 LBS.	Fresh Water Capacity	32 GALS.
Total Dry Weight	5290 LBS.	Gray Water Capacity	76 GALS.
GVWR	7885 LBS.	Black Water Capacity	38 GALS.
Interior Height	6'8"	Cargo Carrying Capacity	2491 LBS.
Exterior Height	10'10"		

**267 BHSK**



**WEIGHTS & MEASURES**

Hitch Dry Weight	955 LBS.	Travel Length	32'3"
Dry Axle Weight	4655 LBS.	Fresh Water Capacity	32 GALS.
Total Dry Weight	5590 LBS.	Gray Water Capacity	76 GALS.
GVWR	8955 LBS.	Black Water Capacity	38 GALS.
Interior Height	6'8"	Cargo Carrying Capacity	3311 LBS.
Exterior Height	10'10"		

**269 BHDSK**

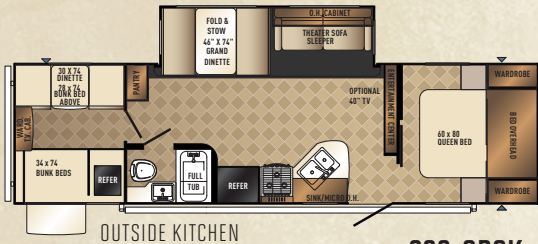

**WEIGHTS & MEASURES**

Hitch Dry Weight	780 LBS.	Travel Length	33'4"
Dry Axle Weight	4955 LBS.	Fresh Water Capacity	32 GALS.
Total Dry Weight	5683 LBS.	Gray Water Capacity	38 GALS.*
GVWR	7780 LBS.	Black Water Capacity	38 GALS.*
Interior Height	6'8"	Cargo Carrying Capacity	2011 LBS.
Exterior Height	10'10"		

**292 QBSK**

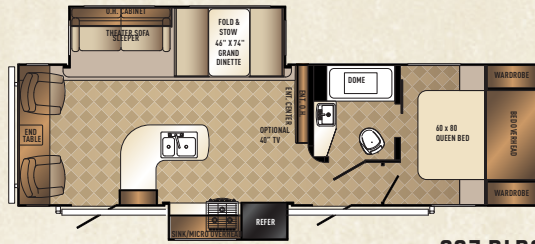

**WEIGHTS & MEASURES**

Hitch Dry Weight	615 LBS.	Travel Length	32'9"
Dry Axle Weight	5275 LBS.	Fresh Water Capacity	32 GALS.
Total Dry Weight	5773 LBS.	Gray Water Capacity	68 GALS.
GVWR	8615 LBS.	Black Water Capacity	38 GALS.
Interior Height	6'8"	Cargo Carrying Capacity	2691 LBS.
Exterior Height	10'10"		

**297 RLDS**

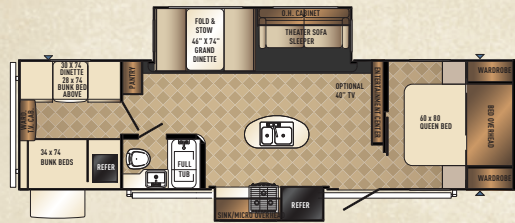

**WEIGHTS & MEASURES**

Hitch Dry Weight	835 LBS.	Travel Length	33'11"
Dry Axle Weight	5290 LBS.	Fresh Water Capacity	32 GALS.
Total Dry Weight	5960 LBS.	Gray Water Capacity	30 GALS.
GVWR	8835 LBS.	Black Water Capacity	38 GALS.*
Interior Height	6'8"	Cargo Carrying Capacity	2676 LBS.
Exterior Height	10'10"		

**307 QBDSK**

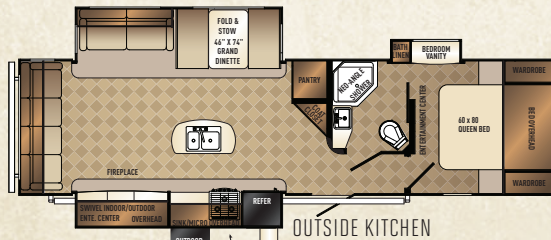

**WEIGHTS & MEASURES**

Hitch Dry Weight	815 LBS.	Travel Length	35'4"
Dry Axle Weight	5975 LBS.	Fresh Water Capacity	32 GALS.
Total Dry Weight	6588 LBS.	Gray Water Capacity	76 GALS.
GVWR	8815 LBS.	Black Water Capacity	38 GALS.
Interior Height	6'8"	Cargo Carrying Capacity	1991 LBS.
Exterior Height	10'10"		

**315 RLTSK**

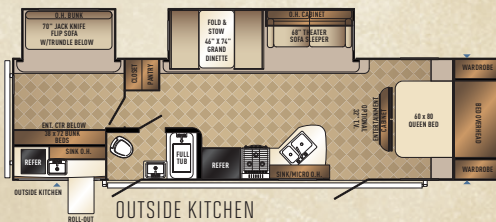

**WEIGHTS & MEASURES**

Hitch Dry Weight	625 LBS.	Travel Length	35'1"
Dry Axle Weight	6200 LBS.	Fresh Water Capacity	32 GALS.
Total Dry Weight	6726 LBS.	Gray Water Capacity	38 GALS.
GVWR	8625 LBS.	Black Water Capacity	38 GALS.*
Interior Height	6'8"	Cargo Carrying Capacity	1766 LBS.
Exterior Height	10'10"		

**317 BHSK**

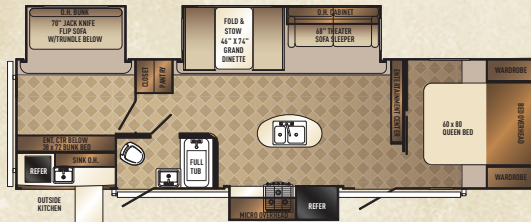

**WEIGHTS & MEASURES**

Hitch Dry Weight	890 LBS.	Travel Length	35'4"
Dry Axle Weight	6235 LBS.	Fresh Water Capacity	32 GALS.
Total Dry Weight	7125 LBS.	Gray Water Capacity	38 GALS.
GVWR	8890 LBS.	Black Water Capacity	38 GALS.
Interior Height	6'8"	Cargo Carrying Capacity	1731 LBS.
Exterior Height	10'10"		

**318 TSBHK**

\* OUTSIDE KITCHEN DRAINS INTO BLACK WATER TANK

315 RLTSK IN TOFFEE



# SOLAIRE WITH THE ECLIPSE PACKAGE

Upgrade your Ultra Lite trailer with the quality and durability of our Eclipse package which offers the elements of a fiberglass front cap with LED lights and Line X® rock guard, solid surface counter tops and much more.



OUTSIDE KITCHEN STANDARD ON 317 BHSK AND 318 TSBHK



# SOLAIRE WITH THE ECLIPSE PACKAGE

FLOORPLANS & SPECIFICATIONS



CHESTNUT



ALMOND



TOFFEE



INDIGO



MORTISE AND TENON  
CHERRY HARD WOOD  
CABINET DOORS

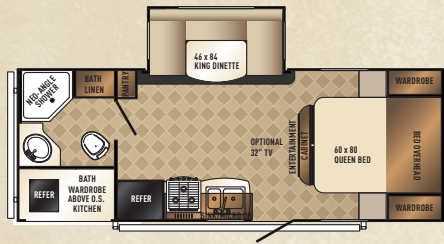

226 RBK

**WEIGHTS & MEASURES**

Hitch Dry Weight	710 LBS.	Travel Length	25'10"
Dry Axle Weight	4305 LBS.	Fresh Water Capacity	32 GALS.
Total Dry Weight	4991 LBS.	Gray Water Capacity	68 GALS.
GVWR	7710 LBS.	Black Water Capacity	38 GALS.
Interior Height	6'8"	Cargo Carrying Capacity	2661 LBS.
Exterior Height	10'10"		

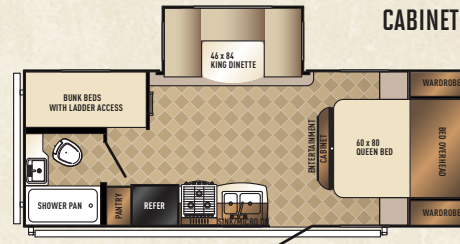

229 BHS

**WEIGHTS & MEASURES**

Hitch Dry Weight	730 LBS.	Travel Length	26'1"
Dry Axle Weight	3985 LBS.	Fresh Water Capacity	32 GALS.
Total Dry Weight	4691 LBS.	Gray Water Capacity	76 GALS.
GVWR	7730 LBS.	Black Water Capacity	30 GALS.
Interior Height	6'6"	Cargo Carrying Capacity	2981 LBS.
Exterior Height	10'10"		



239 DSBH

**WEIGHTS & MEASURES**

Hitch Dry Weight	800 LBS.	Travel Length	27'1"
Dry Axle Weight	4590 LBS.	Fresh Water Capacity	32 GALS.
Total Dry Weight	5239 LBS.	Gray Water Capacity	68 GALS.
GVWR	7800 LBS.	Black Water Capacity	38 GALS.
Interior Height	6'8"	Cargo Carrying Capacity	2376 LBS.
Exterior Height	10'10"		

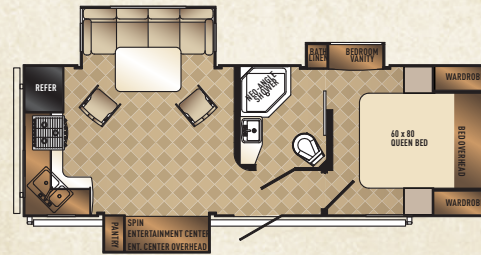

247 RKES

**WEIGHTS & MEASURES**

Hitch Dry Weight	590 LBS.	Travel Length	27'10"
Dry Axle Weight	5075 LBS.	Fresh Water Capacity	32 GALS.
Total Dry Weight	5463 LBS.	Gray Water Capacity	76 GALS.
GVWR	8580 LBS.	Black Water Capacity	38 GALS.
Interior Height	6'8"	Cargo Carrying Capacity	2891 LBS.
Exterior Height	10'10"		

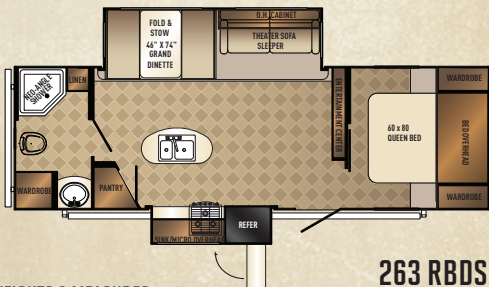

263 RBDSK

**WEIGHTS & MEASURES**

Hitch Dry Weight	790 LBS.	Travel Length	30'0"
Dry Axle Weight	5175 LBS.	Fresh Water Capacity	32 GALS.
Total Dry Weight	5895 LBS.	Gray Water Capacity	68 GALS.
GVWR	7790 LBS.	Black Water Capacity	38 GALS.
Interior Height	6'8"	Cargo Carrying Capacity	1791 LBS.
Exterior Height	10'10"		

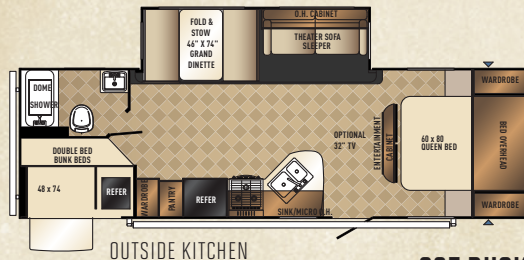

267 BHSK

**WEIGHTS & MEASURES**

Hitch Dry Weight	885 LBS.	Travel Length	30'11"
Dry Axle Weight	4475 LBS.	Fresh Water Capacity	32 GALS.
Total Dry Weight	5290 LBS.	Gray Water Capacity	76 GALS.
GVWR	7885 LBS.	Black Water Capacity	38 GALS.
Interior Height	6'8"	Cargo Carrying Capacity	2491 LBS.
Exterior Height	10'10"		

# ECLIPSE PACKAGE AVAILABLE

1. Fiberglass Front Cap w/ LED Lights and Line X® Rock Guard
  2. Power Stabilizer Jack Pack (Includes Electric Tongue Hitch)
  3. Frameless Windows
  4. Serta® TruPrest Metropolitan Mattress
  5. Solid Surface Countertops
  6. Aluminum Wheels
- NOTE: THE ECLIPSE PACKAGE WILL ADD 250 LBS.

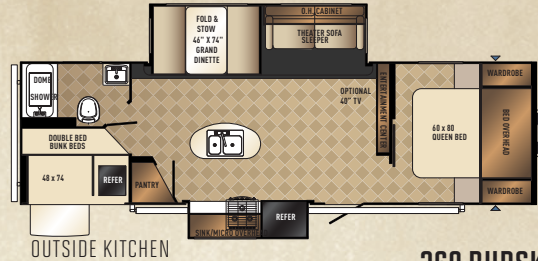

OUTSIDE KITCHEN

**269 BHDSK**

**WEIGHTS & MEASURES**

Hitch Dry Weight	955 LBS.	Travel Length	32'3"
Dry Axle Weight	4655 LBS.	Fresh Water Capacity	32 GALS.
Total Dry Weight	5590 LBS.	Gray Water Capacity	76 GALS.
GVWR	8955 LBS.	Black Water Capacity	38 GALS.
Interior Height	6'8"	Cargo Carrying Capacity	3311 LBS.
Exterior Height	10'10"		

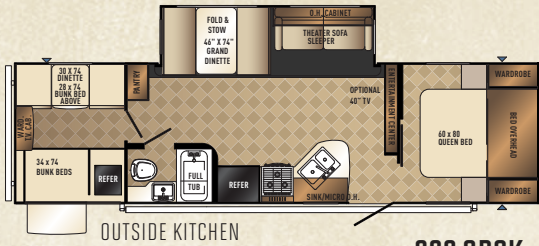

OUTSIDE KITCHEN

**292 QBSK**

**WEIGHTS & MEASURES**

Hitch Dry Weight	780 LBS.	Travel Length	33'4"
Dry Axle Weight	4955 LBS.	Fresh Water Capacity	32 GALS.
Total Dry Weight	5683 LBS.	Gray Water Capacity	38 GALS.*
GVWR	7780 LBS.	Black Water Capacity	38 GALS.*
Interior Height	6'8"	Cargo Carrying Capacity	2011 LBS.
Exterior Height	10'10"		

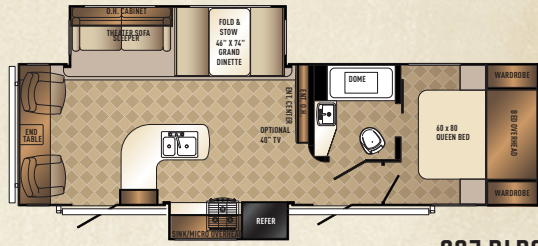

**297 RLDS**

**WEIGHTS & MEASURES**

Hitch Dry Weight	615 LBS.	Travel Length	32'9"
Dry Axle Weight	5275 LBS.	Fresh Water Capacity	32 GALS.
Total Dry Weight	5773 LBS.	Gray Water Capacity	68 GALS.
GVWR	8615 LBS.	Black Water Capacity	38 GALS.
Interior Height	6'8"	Cargo Carrying Capacity	2691 LBS.
Exterior Height	10'10"		

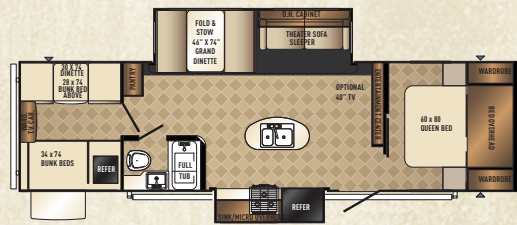

OUTSIDE KITCHEN

**307 QBDSK**

**WEIGHTS & MEASURES**

Hitch Dry Weight	835 LBS.	Travel Length	33'11"
Dry Axle Weight	5290 LBS.	Fresh Water Capacity	32 GALS.
Total Dry Weight	5960 LBS.	Gray Water Capacity	30 GALS.
GVWR	8835 LBS.	Black Water Capacity	38 GALS.*
Interior Height	6'8"	Cargo Carrying Capacity	2676 LBS.
Exterior Height	10'10"		

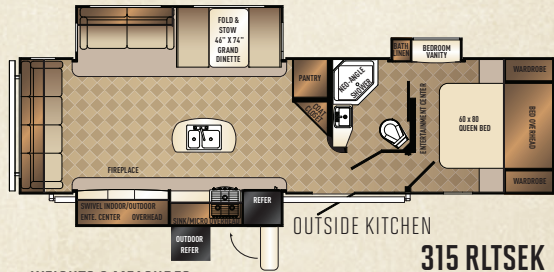

OUTSIDE KITCHEN

**315 RLTSK**

**WEIGHTS & MEASURES**

Hitch Dry Weight	815 LBS.	Travel Length	35'4"
Dry Axle Weight	5975 LBS.	Fresh Water Capacity	32 GALS.
Total Dry Weight	6588 LBS.	Gray Water Capacity	76 GALS.
GVWR	8815 LBS.	Black Water Capacity	38 GALS.
Interior Height	6'8"	Cargo Carrying Capacity	1991 LBS.
Exterior Height	10'10"		

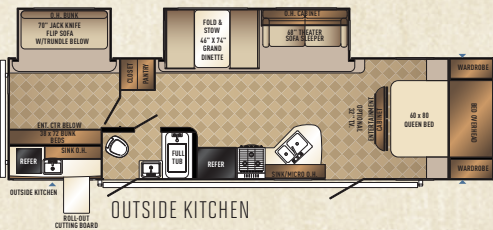

OUTSIDE KITCHEN

**317 BHSK**

**WEIGHTS & MEASURES**

Hitch Dry Weight	625 LBS.	Travel Length	35'1"
Dry Axle Weight	6200 LBS.	Fresh Water Capacity	32 GALS.
Total Dry Weight	6726 LBS.	Gray Water Capacity	38 GALS.
GVWR	8625 LBS.	Black Water Capacity	38 GALS.*
Interior Height	6'8"	Cargo Carrying Capacity	1766 LBS.
Exterior Height	10'10"		

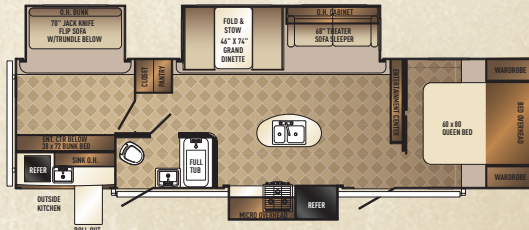

OUTSIDE KITCHEN

**318 TSBHK**

**WEIGHTS & MEASURES**

Hitch Dry Weight	890 LBS.	Travel Length	35'4"
Dry Axle Weight	6235 LBS.	Fresh Water Capacity	32 GALS.
Total Dry Weight	7125 LBS.	Gray Water Capacity	38 GALS.
GVWR	8890 LBS.	Black Water Capacity	38 GALS.
Interior Height	6'8"	Cargo Carrying Capacity	1731 LBS.
Exterior Height	10'10"		

\* OUTSIDE KITCHEN DRAINS INTO BLACK WATER TANK

# SOLAIRE ROCK-SOLID CONSTRUCTION



A. Alpha Super Flex Membrane

B. Luan Substrate

C. Fiberglass Exterior

D. Luan substrate

E. High density block foam insulation

F. Fiberglass exterior

G. High density block foam insulation

H. Luan substrate

I. Fiberglass front cap w/LED lights and Line X® Rock Guard (Eclipse Package only)

J. Residential Style Carpeting

K. Fully welded aluminum super structure

L. High density block foam insulation

M. Luan substrate – top

N. Luan substrate – bottom

O. Beau Flor® -vinyl flooring

P. Under floor holding tanks

Q. Upgraded aluminum wheels (Eclipse package only)

# SOLAIRE POPULAR FEATURES



Solid surface exterior kitchen counter tops standard on available floorplans for added durability in all climate conditions.



Solaires include a standard torsion axle with independent wheel suspension (N/A on Sevens) and includes rubber cushioning to eliminate the metal on metal contact.



Optional Serta Trump® Mattress upgrade – provides a restful sleep with the most advanced 900 coil support system. The superior quality of the Serta Trump® helps provide the luxuries of home in your R.V.

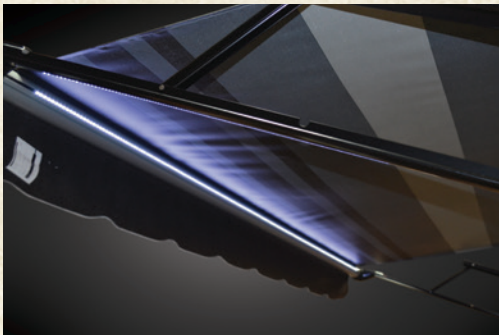

The electric awning with self-contained LED light strip provides quick and easy set-up.



LED interior lighting provides:

- 80% less power
- Emits less heat
- LED's last 30,000 hours vs. 1,000 hours of halogen
- COB (chip on board) is the latest technology in LED lighting
- COB's and bulbs are both 3200k, for consistent appearance throughout



**VACUUM-BONDED LAMINATED CONSTRUCTION**  
Solaires provides a fully 6 sided vacuum-bonded trailer. Our walls, floors, roof, fronts and backs are all built vacuum-bonded to ensure a light weight strong structural trailer.



**VAULTED RADIUS ROOF**  
Vacuum bonded radius roof with vaulted ceiling providing superior insulation and more interior height.

# SOLAIRE

## STANDARDS & OPTIONS

### STANDARD FEATURES

- 6 Sided vacuum bonded construction
- Dexter or AL-KO torsion axle (N/A Sevens)
- Laminated full walk on barreled roof
- Full welded aluminum super structure
- Beau Flor® - vinyl flooring
- Mortise and Tenon Cherry hard wood cabinet
- Pocket screw lumber core cabinets
- Laminated roof w/ducted A/C (Except 147 X)
- Pleated fabric window shades
- Pantries w/removable shelves and clothes rods
- Gel coated pearl fiberglass

### COMMONLY ORDERED OPTIONS

- Aluminum wheels
- Counter top extension (N/A on all floorplans)
- High gloss white fiberglass exterior
- RVQ grill w/ bumper mount (bumper mount N/A on X's)
- Roof Ladder (N/A on X's and 297 RLDS, 315 RLTSK, 239 DSBH)
- Spare tire, carrier and cover
- LED TV (sizes vary depending on floorplan)
- Solid surface counter tops
- Serta Trump® Mattress Upgrade
- Power front jack
- Power Stabilizer Jacks
- Water Tank Heaters
- Tri-Fold Hide A Bed
- Island fireplace

- See our website for a complete list of available options



Forest River, Inc. encourages our customers to purchase their Forest River products from a local dealership whenever possible for the following reasons:

- 1) Forest River, Inc. dealers are independently owned and operated businesses so priority service and scheduling is at their discretion and is often provided to customers that purchased their unit at that dealership.
- 2) Purchasing locally allows customers to establish meaningful relationships with a dealer, enhancing the RV experience through assistance with product questions, user tips or RV regulations for your state or country, and much more!
- 3) Canadian customers must meet requirements to bring an RV purchased out of the country to their home. These requirements may involve additional inspections and certifications, taxes and fees. Your local Canadian Dealer is a professional at meeting these requirements.
- 4) Scheduling timely warranty repairs and adjustments through a local dealership provides far greater flexibility and convenience to you, the customer!

It is the goal of Forest River, Inc. that all of our RV owners fully enjoy the RV experience and that customer satisfaction meets or exceeds their expectations!



### PRE-DELIVERY INSPECTION FACILITY

20,000 square feet of quality assurance. The bare essentials for a premium product. This state-of-the-art facility gives immediate daily feedback to production for quality assurance in every unit built.



**FREE MEMBERSHIP**  
to Forest River Owners' Group

[www.forestriverfrog.com](http://www.forestriverfrog.com)



SOLAIRE DEALER



**Learn More**  
Scan this barcode using a QR Reader on your smart phone to learn more about Forest River.



A Berkshire Hathaway company.



### PALOMINO RV

1047 EAST M-86 | COLON, MI 49040

P: 269.432.3271 | F: 269.432.2516

[www.palominoRV.com](http://www.palominoRV.com)