

# Via



## Why Via?

- Mercedes-Benz® Sprinter chassis
- Fuel-efficient and easy to maneuver
- Threshold™ Quiet RV Door and retractable screen door
- MCD solar/blackout shades
- Available StudioLoft™ (25P & 25T)
- HDTVs
- Ultraleather™ furniture
- Infotainment Center with Rand McNally RV GPS
- Swivel cab seats

# Via



Click on this icon throughout the brochure to link to more information on the web.



On the cover: 25P Dark Gray Mica Full-Body Paint

25P Twitter with Aosta Cherry Cabinetry

## Imagine the Possibilities

With a bold look and impressive fuel economy, people are taking notice of the Winnebago Via® and the surprisingly large livability that puts this coach in a class of its own. Built on the nimble Mercedes-Benz® Sprinter chassis, the Via has reinvented what is possible in a Class A coach with innovations such as the Flex Bed System and StudioLoft™. Three floorplans offer something for everyone, including

the new 25P with a spacious lounge and a generous rear storage area. Three rich wood choices let you pick your style while LED lighting reduces your energy consumption by up to 70 percent. With Sprinter chassis mobility, plenty of options, impressive fuel economy, and Winnebago Industries'® legendary construction quality, you can make all your dreams come true with the Winnebago Via.



**Recognized Quality** The RV Dealers Association bestows its annual Quality Circle Award based on dealer ratings to the manufacturers that provide exceptional products, service and support. Only one manufacturer has received this honor for seventeen consecutive years: Winnebago Industries.®

## Best in Class

See how Winnebago Industries takes motorhome design and function to the next level, and why we've earned the right to be called the Most Recognized Name in Motorhomes.®



Click on this icon throughout the brochure to link to more information on the web.

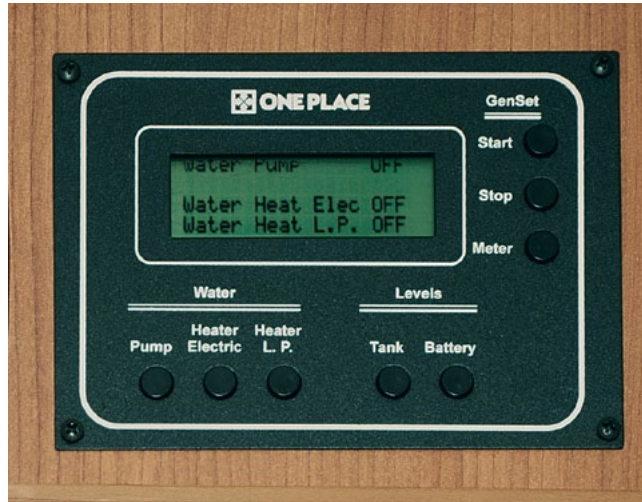

**Easy** The OnePlace® Systems Center lets you check major systems at the touch of a button.



**Drive in Style** The Ultraleather™ cab seats are impressively comfortable and swivel to face the inviting lounge area.



**Instant Bed** The StudioLoft™ bed easily drops down from the cab ceiling for instant sleeping space.



**On the Mark** The BenchMark® full comfort dinette (25P) offers premium innerspring seating that makes for exceptionally comfortable dining. The seats flip up to access hidden storage compartments and easily convert into a cozy sleeping space.



**Night and Day** The available acrylic windows are lightweight, scratch-resistant, and feature built-in screens and shades that pull up from the window base so you can enjoy a cool breeze while maintaining privacy.



25P Twitter with Aosta Cherry Cabinetry

Relaxing with family and friends in the Via is made easy thanks to the comfortable cab seats that swivel to face the inviting living area. Your media entertainment comes courtesy of an HDTV and coach stereo system with Bluetooth™ so you can stream all your favorite music. The available lightweight, scratch-resistant windows feature built-in screens and shades that pull up from the window base. Tinted windows with MCD solar/blackout roller shades come standard for complete control over light and privacy. The interior LED lighting reduces energy consumption by up to 70 percent, which significantly extends power when dry camping.



HDTV



Available Acrylic Windows with Pull-Up Shades

Whether you're making gourmet meals or preparing snacks, the full-featured galley puts everything you need within reach. Bake your favorite dishes in the microwave/convection oven and store your cold items in the double-door Norcold® refrigerator/freezer. Cleanup is easy with a deep stainless steel sink and a faucet that folds beneath a glass cover for added countertop space.



25P Galley



Refrigerator/Freezer



Full-Extension Drawer Slides

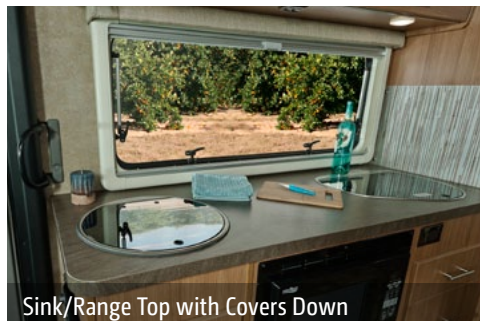

Sink/Range Top with Covers Down



Sink/Range Top with Covers Up

Via offers three different floorplans, each with a unique bathroom and bedroom design that includes a 22" HDTV. The new 25P features a corner double bed and wardrobe with plenty of drawer space below, while the 25Q offers a walk-around queen size bed and a mid-coach bath. For those who need more versatile sleeping arrangements, the Flex Bed in the 25T converts the twin beds into a queen bed while offering an available StudioLoft™ bed that drops down from the cab ceiling. It also offers a large, dynamically-angled mid-coach bath.





Dash

Get behind the wheel of a fuel-efficient Via and you'll feel like you're driving an easy-to-maneuver crossover instead of a Class A motorhome, thanks to the Mercedes-Benz® Sprinter chassis. You'll appreciate the latest in-dash communications technology found in the Infotainment Center with Rand McNally RV GPS. It delivers safe and easy trip routing with turn-by-turn voice guidance on a 6" touch-screen color monitor that includes AM/FM radio with a CD/DVD player, SiriusXM™ availability, an MP3 player input and a color rearview camera.



Powered Mirrors



Infotainment Center with Rand McNally RV GPS

One thing you'll notice is the Via is remarkably quiet. That's because the innovative Threshold™ Quiet RV Door utilizes an airplane door-inspired seal design that reduces wind and road noise. It also works seamlessly with the retractable screen door. Once settled at the campsite, a simple push of the button extends your electric patio awning for delightful shade. Before re-entering the Via, do a quick cleanup of your gear, kids or pets at the exterior service center wash station. A driver-side door with a power lock and window is available (NA with StudioLoft™).



Electric Patio Awning with LED Lighting



Exterior Service Center



Driver-Side Storage Compartment (NA with Driver-Side Door)



Threshold™ Quiet RV Door



Retractable Screen Door



Door Seal



Automatic Entrance Steps



Available Stylized Aluminum Wheels



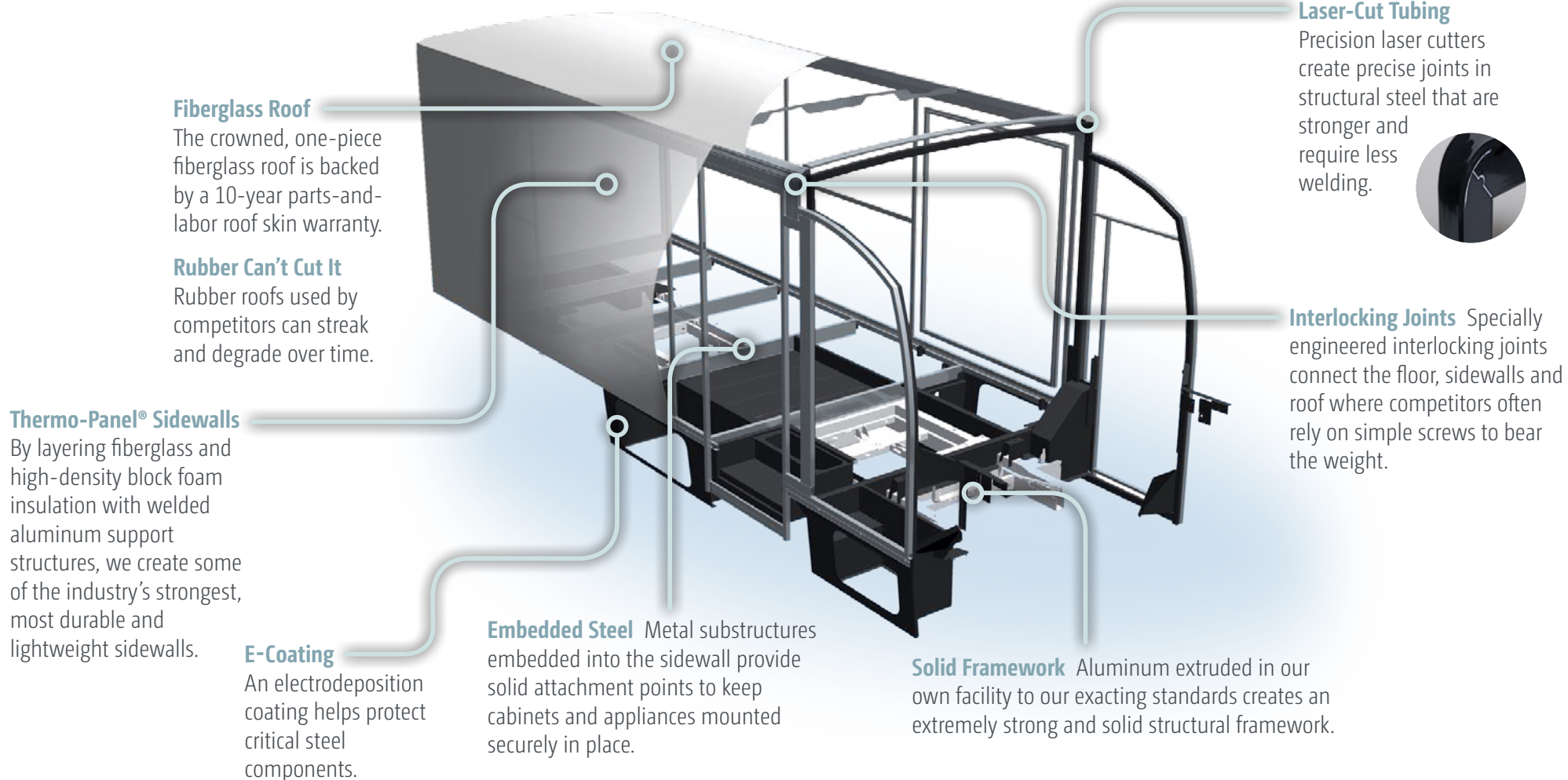

### Fiberglass Roof

The crowned, one-piece fiberglass roof is backed by a 10-year parts-and-labor roof skin warranty.

### Rubber Can't Cut It

Rubber roofs used by competitors can streak and degrade over time.

### Thermo-Panel® Sidewalls

By layering fiberglass and high-density block foam insulation with welded aluminum support structures, we create some of the industry's strongest, most durable and lightweight sidewalls.

### E-Coating

An electrodeposition coating helps protect critical steel components.

**Embedded Steel** Metal substructures embedded into the sidewall provide solid attachment points to keep cabinets and appliances mounted securely in place.

**Solid Framework** Aluminum extruded in our own facility to our exacting standards creates an extremely strong and solid structural framework.

### Laser-Cut Tubing

Precision laser cutters create precise joints in structural steel that are stronger and require less welding.



**Interlocking Joints** Specially engineered interlocking joints connect the floor, sidewalls and roof where competitors often rely on simple screws to bear the weight.

# SUPER STRUCTURE

BUILT TO LAST

Every coach—from our smallest Class C to our largest diesel pusher model—is built to Winnebago Industries'® legendary SuperStructure construction standards. It's a process developed and refined over more than 50 years of building some of the strongest, most durable coaches in the industry.

**TESTING** Before rolling out of our factories, every coach undergoes an extensive 113-point inspection. Each coach also passes a high-pressure water test that simulates rain at a rate of 50-inches per hour to check for leaks. During the design process, computer simulations, our physical testing center and rigorous test track ensure each model is built to last.



**DETAILS** At Winnebago Industries, we treat the features you can't see with the same care as the ones you can. Look in the access panels of some of our competitors' coaches and you'll see loose insulation and wires haphazardly strewn about. Winnebago Industries maintains a clean fit and finish throughout so your coach will last for the long haul.



**BUILT IN-HOUSE** We extrude our own aluminum. We rotocast our own plastic components. In fact, we manufacture most of our own parts so they are designed to fit the space, rather than fitting the space to an awkward off-the-shelf component size.

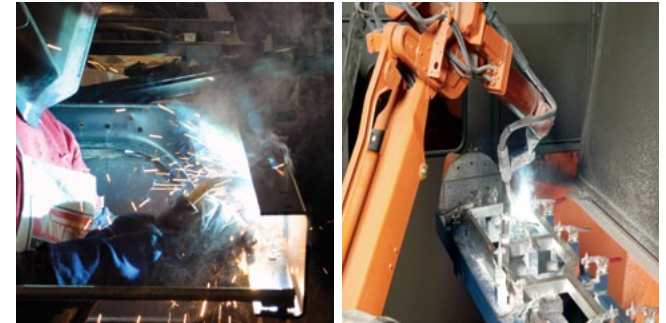

**SUPER  
STRUCTURE**<sup>®</sup>  
BUILT TO LAST

Visit [BetterBuiltRVs.com](http://BetterBuiltRVs.com) to gain real insight into what goes into a Winnebago Industries motorhome.

**TAKE A TOUR** We're proud of our processes, state-of-the-art facilities and the people who make Winnebago Industries number one. We invite you to visit our complex in Forest City, Iowa, for a first-hand look at the dedication and technology behind every motorhome we build.



## NEW 25P

The exciting new 25P features a corner double bed, large wardrobe with three bottom drawers and a stylish tambour sliding bath door.

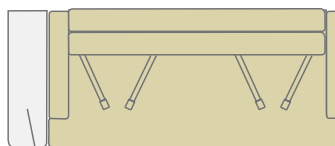
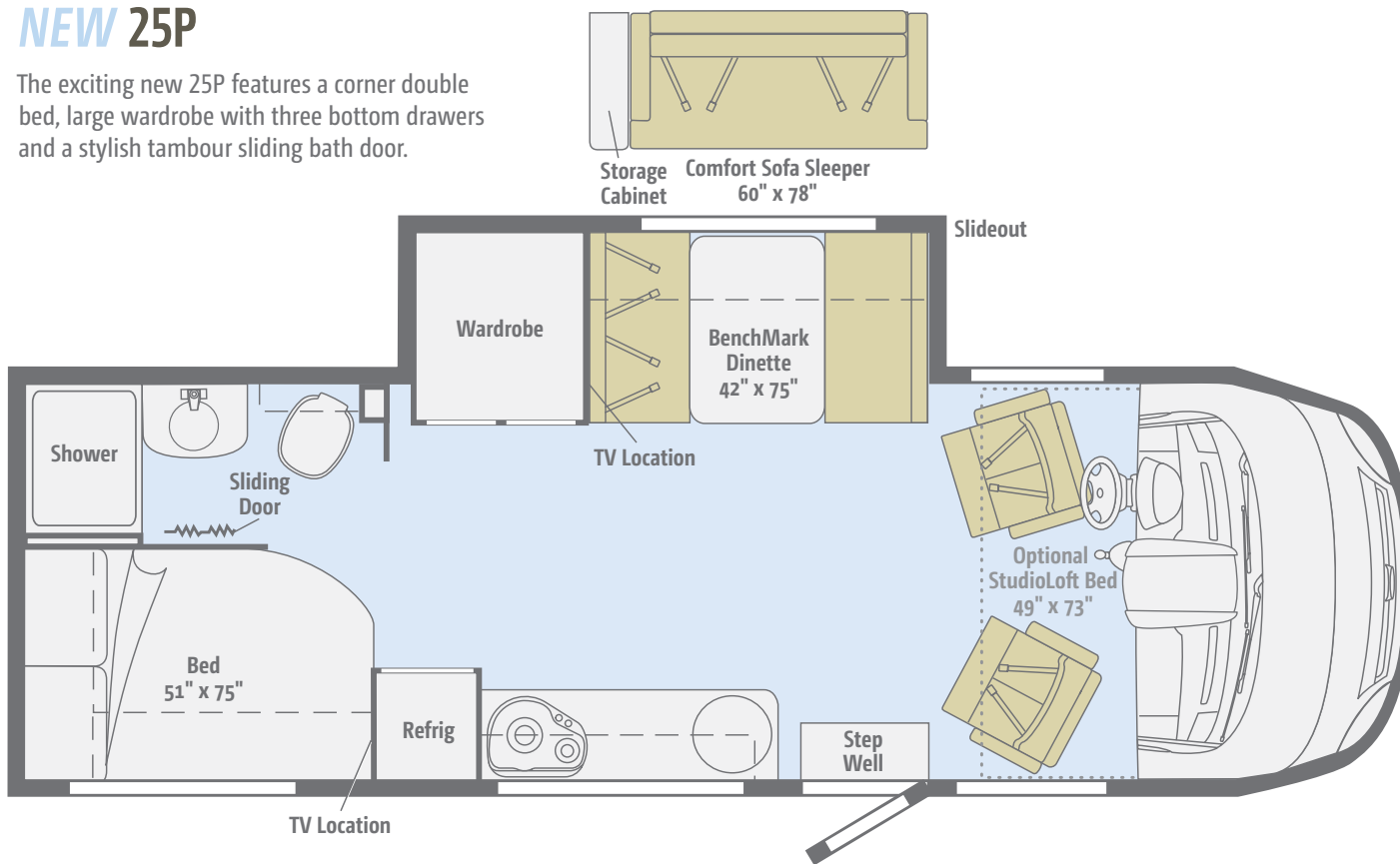

Storage Cabinet  
Comfort Sofa Sleeper  
60" x 78"



Standard  
Ultraleather

Vinyl

Dimensions shown are for sleeping space only and may vary due to styling differences. Dashed lines denote overhead storage areas. Floorplans and specifications are also available online at [GoWinnebago.com](http://GoWinnebago.com).

# 25Q

Two slideouts make for a generous bedroom with a walk-around queen bed and a spacious lounge with the Comfort Sofa Sleeper.

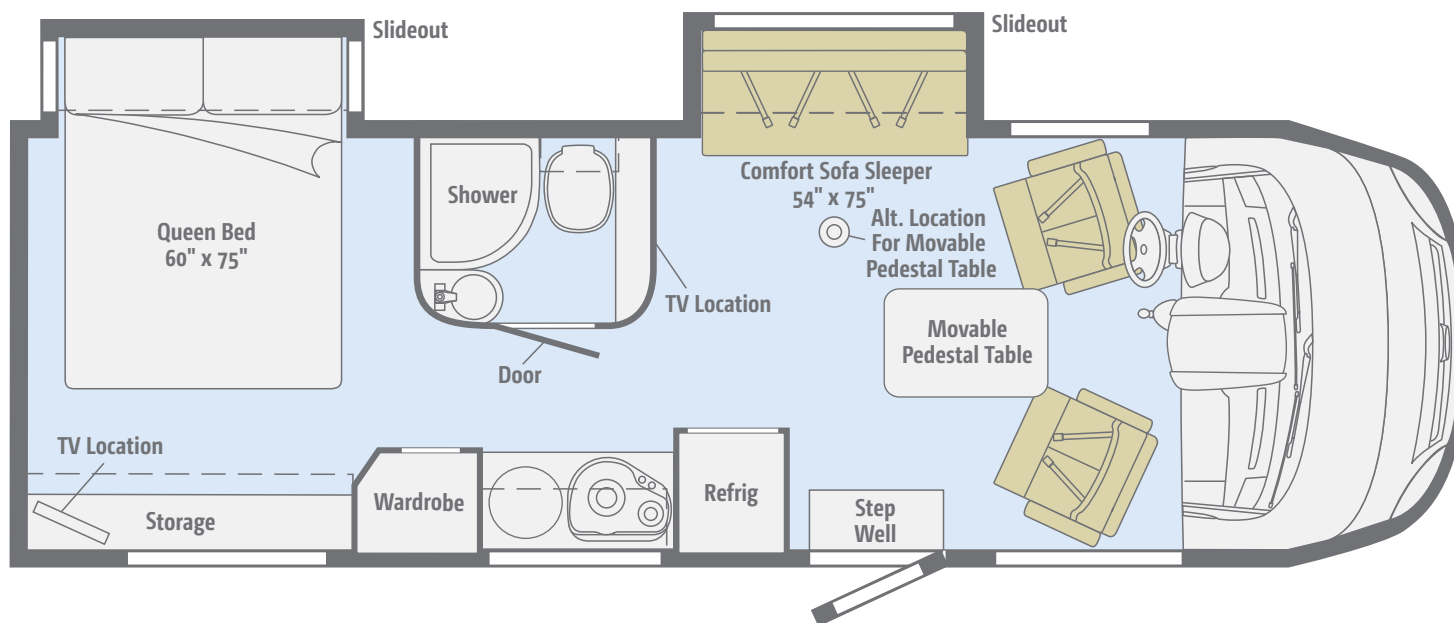



Dimensions shown are for sleeping space only and may vary due to styling differences. Dashed lines denote overhead storage areas. Floorplans and specifications are also available online at [GoWinnebago.com](http://GoWinnebago.com).

# 25T

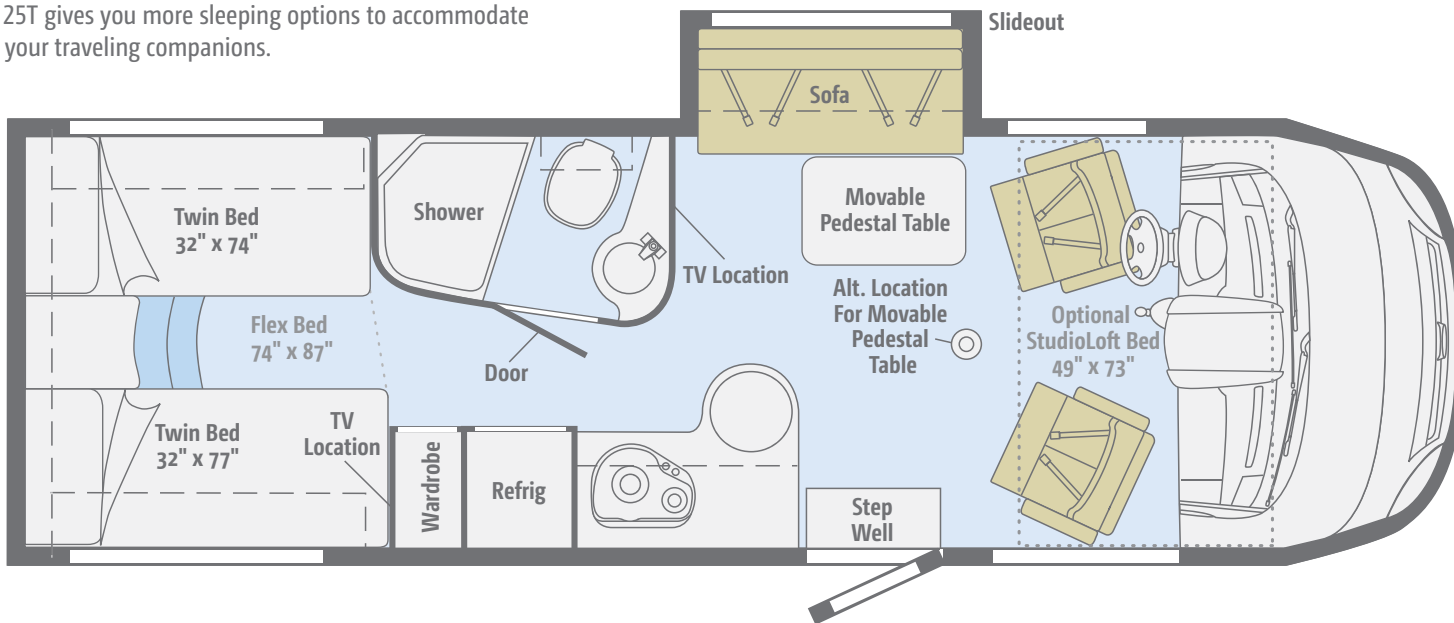
With the Flex Bed System and available StudioLoft™, the 25T gives you more sleeping options to accommodate your traveling companions.



		
Standard Ultraleather	Carpet	Vinyl

Dimensions shown are for sleeping space only and may vary due to styling differences. Dashed lines denote overhead storage areas. Floorplans and specifications are also available online at [GoWinnebago.com](http://GoWinnebago.com).

Choose from three fabric collections and three wood finishes, each with Satin Nickel hardware.

## Hologram



Ultraleather



Accent



Bedspread



Laminate Countertop



Wall Board



Vinyl



Aosta Cherry



Marbella Cherry



Sunset Cherry

Choose from three fabric collections and three wood finishes, each with Satin Nickel hardware.

## Eclipse



Ultraleather



Accent



Bedspread



Laminate Countertop



Wall Board



Vinyl



Aosta Cherry



Marbella Cherry



Sunset Cherry

Choose from three fabric collections and three wood finishes, each with Satin Nickel hardware.

## Twitter



Ultraleather



Accent

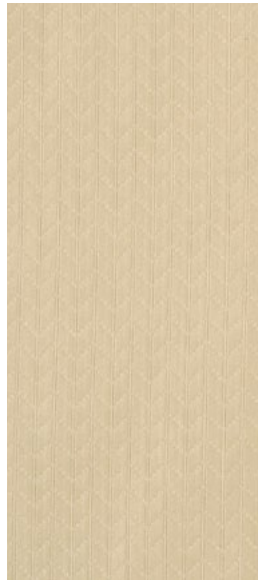

Bedspread



Laminate Countertop



Wall Board



Vinyl



Aosta Cherry



Marbella Cherry



Sunset Cherry



The streamlined appearance of the Via is enhanced with deluxe graphics or available full-body paint.



**Carbon**  
DELUXE GRAPHICS



**Black Garnet**  
DELUXE GRAPHICS

The streamlined appearance of the Via is enhanced with deluxe graphics or available full-body paint.



**Dark Gray Mica**  
FULL-BODY PAINT



**Pearl**  
FULL-BODY PAINT



**Cabernet**  
FULL-BODY PAINT



**Bronze**  
FULL-BODY PAINT

## Weights & Measures

	25P	25Q	25T
Length	25'5"	25'5"	25'5"
Exterior Height <sup>1</sup>	11'	11'	11'
Exterior Width	7'6"	7'6"	7'6"
Exterior Storage <sup>2</sup> (cu. ft.)	70	54	92
Awning Length	16'	16'	16'
Interior Height	6'5"	6'5"	6'5"
Interior Width	7'3"	7'3"	7'3"
Freshwater Tank Capacity <sup>3</sup> (gal.)	29	27	28
Water Heater Capacity (gal.)	6/Continuous <sup>6</sup>	6	6
Holding Tank Capacity - Black/Gray <sup>3</sup> (gal.)	34/40	40/30	36/36
LP Capacity <sup>4</sup> (gal.)	13	13	13
Fuel Capacity (gal.)	26.4	26.4	26.4
GCWR <sup>5</sup> (lbs.)	15,250	15,250	15,250
GVWR (lbs.)	11,030	11,030	11,030
GAWR - Front (lbs.)	4,410	4,410	4,410
GAWR - Rear (lbs.)	7,720	7,720	7,720
Wheelbase	170"	170"	170"

## Chassis

### Mercedes-Benz® Sprinter F50 Chassis

188-hp Mercedes-Benz 3.0L 6-cylinder turbo-diesel engine

5-speed automatic transmission w/Tip Shift technology

Hydraulic brakes w/ABS

Adaptive ESP® technology

220-amp. alternator

Trailer Hitch<sup>6</sup> 5,000-lb. drawbar/500-lb. maximum vertical tongue weight w/7-pin connector

Stainless steel wheel liners

### OPTIONAL EQUIPMENT

Stylized aluminum wheels



Mercedes-Benz®  
Sprinter F50 Chassis

## Cab Conveniences

**Cab Seats** armrest, adjustable lumbar support, swivel/slide, recline

**Power steering w/tilt and telescoping wheel**

**Power door lock w/remote for main entry door**

**Dash appliqué package**

**Seat belts**

**Removable one-piece fitted carpet liner**

**12-volt powerpoints**

**Power mirrors w/defrost and built-in sideview video camera system**

**Cruise control**

**Chassis/house battery radio power switch**

**Sunvisors**

**Front wraparound curtain**

**Infotainment Center with Rand McNally RV GPS**  
6" touch screen color monitor w/split screen function, Rand McNally RV GPS safe & easy routing, amenities & tools, trips & content, turn-by-turn voice guidance, AM/FM radio w/CD/DVD player, handheld remote, SiriusXM™ (subscription not included), compass, outside temperature, iPod®/iPhone® audio integration, Bluetooth™, color rearview camera

## Interior

**OnePlace® Systems Center**

**Key-activated slideroom master lock switch**

**Soft vinyl ceiling**

**Privacy curtain**

**Stereo System** AM/FM, alarm clock, CD/DVD player, Bluetooth™ input jack

**26" HDTV (25Q, 25T)**

**32" HDTV (25P)**

**Satellite system ready**

**Tinted windows**

**LED ceiling lights** (coach)

**MCD solar/blackout roller shades**

**Amplified digital TV antenna system**

**Powered roof vent** (bath)

**Roof vent w/powerful ventilator fan** (galley 25P, 25Q)

### OPTIONAL EQUIPMENT

**StudioLoft™ and powered sunvisor** (25P, 25T) (NA w/ optional driver-side door)

**Satellite TV antenna system**

**Dual-pane coach windows w/built-in screen and shade**

## Galley

**Microwave/convection oven**

**Vented range hood** (25T)

**2-burner range top w/glass cover**

**Norcold® double-door refrigerator/freezer**

**Stainless steel sink w/glass cover and folding faucet**

**Laminate countertops**

**Decorative backsplash**

**Water filtration system w/cold water faucet**

## Bath

**Flexible showerhead**

**Retractable, self-cleaning shower screen** (25P, 25T)

**Shower curtain** (25Q)

**Skylight**

## Bedroom

**Flex Bed System** twin beds/queen bed w/foam mattress, pillows w/shams and access to storage below (25T)

**Double bed** w/headboard, foam mattress, mattress cover, pillow shams (25P)

**Queen bed** w/headboard, innerspring mattress, pillows, shams, bedspread and access to storage below (25Q)

**22" HDTV**

## Exterior

**Premium high-gloss sidewall skin**

**16' electric patio awning w/LED lighting**

**Threshold™ Quiet RV Door**

**Retractable screen door**

**Automatic entrance door steps**

**Lighted storage compartment** (in select compartments)

**Mud flaps** (rear)

**Porch light**

**Stepwell light**

**Golf bag storage compartment w/framework and straps to secure 2 golf bags**

### OPTIONAL EQUIPMENT

**Driver-side door w/power lock and power window** (NA w/StudioLoft)

**Lower front protective mask** (requires full-body paint)

## Heating & Cooling System

**14,800 BTU roof-mount air conditioner w/heat pump**

**20,000 BTU low-profile furnace**

## Electrical System

**Service Center** cable TV input, 30 amp. power cord, portable satellite dish hook-up

**AC/DC load center, 45-amp. converter/charger**

**Auxiliary start circuit**

**Battery disconnect system** (coach)

**2 deep-cycle, Group 24 RV batteries**

**Automatic dual-battery charge control**

**3,600-watt Cummins Onan® MicroQuiet™ LP generator**

**1,000-watt DC/AC inverter**

**Exterior TV jack and AC duplex**

### OPTIONAL EQUIPMENT

**3,200-watt Cummins Onan diesel generator**

## Plumbing System

**Service Center** color-coded labels, city water hookup/tank diverter fill, drainage valves, 10' sewer hose, exterior wash station w/lighted pump switch

**TrueLevel™ holding-tank monitoring system**

**6-gallon water heater w/electric ignition, 110 V/LP**

**Winterization Package** water heater bypass valve and siphon tube

**On-demand water pump**

**Permanent-mount LP tank w/remote fill**

**Heated drainage system**

**Water tank fill w/lockable door**

### OPTIONAL EQUIPMENT

**Tankless water heater** (25P)

## Safety

**Child seat tether anchor** (25P)

**LP, smoke and carbon monoxide detectors**

**10 BC fire extinguisher**

**Ground fault interrupter**

**High-mount brake lamps**

**Daytime running lamps**

**Fog lamps**

## Warranty<sup>7</sup>

**12-month/15,000-mile basic warranty<sup>8</sup>**

**36-month/36,000-mile limited warranty on structure<sup>8</sup>**

**10-year limited parts-and-labor warranty on roof skin<sup>8</sup>**

- The height of each model is measured to the top of the tallest standard feature and is based on the curb weight of a typically equipped unit. The actual height of your vehicle may vary by several inches depending on chassis or equipment variations. Please contact your dealer for further information.
- The load capacity of your motorhome is designated by weight, not by volume, so you cannot necessarily use all available space when loading your motorhome.
- Capacities are based on measurements prior to tank installation. Slight capacity variations can result due to installation applications.
- Capacities shown are tank manufacturer's listed water capacity (W.C.). Actual filled LP capacity is 80% of listing due to overfilling prevention device on tank.
- Actual towing capacity is dependent on your particular loading and towing circumstances which includes the GVWR, GAWR, and GCWR, as well as adequate trailer brakes. Please refer to the Operator's Manual of your vehicle for further towing information.
- For vehicles manufactured 5/9/13 or later.
- See separate chassis warranty.
- See your dealer for complete warranty information.

Winnebago Industries® continuing program of product improvement makes specifications, equipment, model availability, and prices subject to change without notice. Published content reflects the most current product information at time of printing. Please consult your dealer for individual vehicle features and specifications.

# GoWinnebago.com Has All The Answers.

Visit [GoWinnebago.com](http://GoWinnebago.com) on your computer, smartphone or tablet for the most current product information and updates.



## **PREFERRED CARE PROGRAM**

We back our motorhomes with best-in-class support both before *and* after the sale:

- 12-month/15,000-mile basic warranty
- 36-month/36,000-mile limited warranty on structure
- 10-year limited parts-and-labor warranty on roof skin
- Complimentary 24-hour roadside assistance program



**TRIP**Saver  
FAST TRACK PARTS

- TripSaver® Fast Track Parts guarantees that in-stock warranty parts ship directly to your dealer within 24 hours
- National dealer service network



**WIT CLUB**

## Join the Club, Join the Fun

As a Winnebago motorhome owner, you are invited to join the WIT Club. It's a great way to take full advantage of your new coach and meet fun-loving WIT Club members from across the country who make motorhome adventures a way of life.



### Members enjoy:

- Caravans and rallies
- Newsletters
- Local and state group activities
- RV travel benefits

See more on [WITclub.com](http://WITclub.com)

## WIT CLUB GNR WILD WEST 2013



### Grand National Rally

Each year, thousands of Winnebago Industries motorhome owners descend upon Forest City, Iowa, for the Grand National Rally. Rally goes connect with old friends and enjoy concerts, tours, activities and more in a weeklong celebration of the motorhome lifestyle. Join us this July for a week you'll never forget.