

Wildcat Maxx

With new colors and styles, Wildcats new family of products are sure to make your next trip a fun filled adventure.



Enjoy year around vacations in our new "All Season Designs"

Wildcat

TRAVEL TRAILERS Maxx

*Touring
Edition*



Features

RADIAL TIRES
ELECTRIC AWNING
CARBON MONOXIDE DETECTOR
AIR MATTRESS HIDE-A-BED SOFA (OPTIONAL T27FLS)
SKYLIGHT OVER SHOWER
RAISED PANEL CHERRY HARDWOOD CABINET DOORS
FOLDING ENTRY HANDLE
TV ANTENNA WITH CABLE
OUTDOOR ALL WEATHER SPEAKERS
BLACK FRAMED TINTED SAFETY GLASS WINDOWS
COMMAND CENTER
CUSTOM ALUMINUM WHEELS
EXTREME 'CLIMATECH' POLAR PACKAGE
GEL-COATED FILON FIBERGLASS SIDEWALLS
BALL BEARING, FULL EXTENSION DRAWER GUIDES
KITCHEN WALL BORDER
PILLOW-TOP MATTRESS
SHOWER SURROUND
MP3/AUX HOOK-UP
22" OVEN WITH PIEZO IGNITION
PLEATED NIGHT SHADES
6 gal. DSI HOT WATER HEATER
13.5 BTU AIR CONDITIONING
MICROWAVE OVEN
RESIDENTIAL HIDDEN HINGES
ALUMINUM FRAMED FLOOR
ALUMINUM FRAMED 2" SIDEWALLS
BEDROOM ROOF VENT
BLACK TANK FLUSH
26" LCD TV
HI END 12VOLT AM/FM/CD/DVD
SURROUND SOUND SPEAKERS
PORCELAIN TOILET
OUTSIDE SHOWER
DUAL TOILET PAPER HOLDER
PAPER TOWEL HOLDER
WALL CLOCK
STORAGE UNDER BOOTH DINETTE
UPGRADED LIGHT FIXTURES
KNIFE RACK
RANGE COVER
OUTSIDE LP QUICK CONNECT FOR BBQ
5200 LB E-Z LUBE AXLES
SPARE TIRE, CARRIER AND COVER
MAGAZINE RACK
SPICE RACK
HAIR DRYER

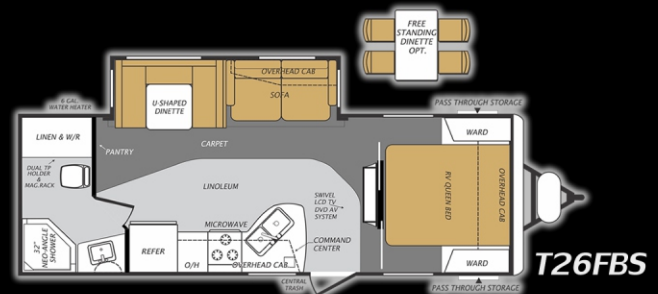
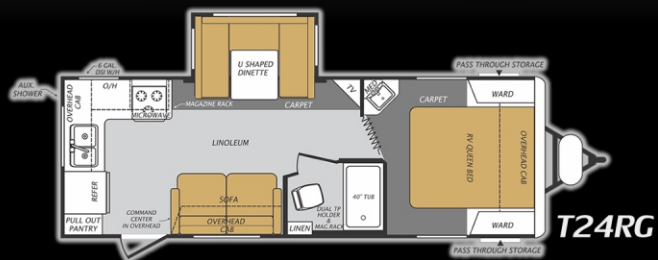

1/2 Ton Series



Slate Edition

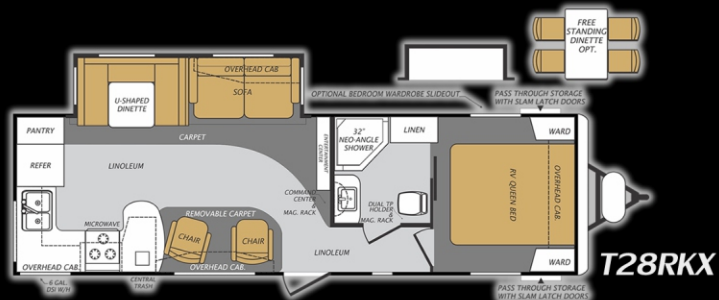
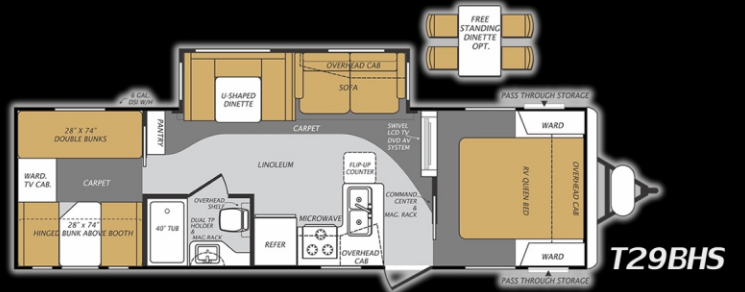
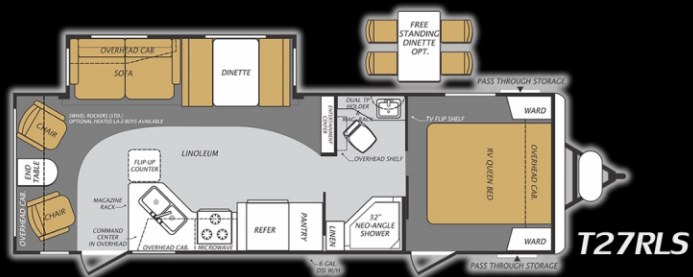
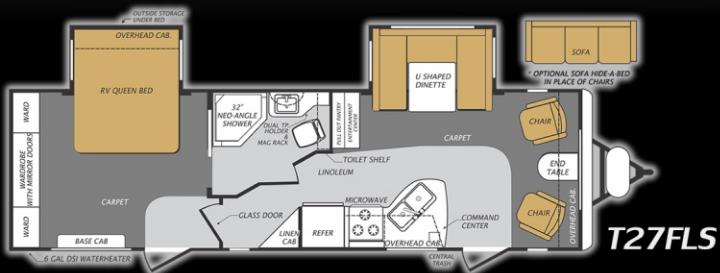

1/2 Ton Series

5th Wheel Mid-Profile Design



Touring Edition

Features

RADIAL TIRES
ELECTRIC AWNING
CARBON MONOXIDE DETECTOR
AIR MATTRESS HIDE-A-BED SOFA (OPTIONAL 252RLX)
SKYLIGHT OVER SHOWER
RAISED PANEL CHERRY HARDWOOD CABINET DOORS
FOLDING ENTRY HANDLE
TV ANTENNA WITH CABLE
OUTDOOR ALL WEATHER SPEAKERS
BLACK FRAMED TINTED SAFETY GLASS WINDOWS
COMMAND CENTER
CUSTOM ALUMINUM WHEELS
EXTREME 'CLIMATECH' POLAR PACKAGE
BALL BEARING, FULL EXTENSION DRAWER GUIDES
SLAM-LATCH EXTERIOR STORAGE DOORS
QUICK RELEASE JACK PINS
GEL-COATED MOLDED FRONT CAP
OUTSIDE LP QUICK CONNECT FOR BBQ
PLEATED NIGHT SHADES
6 gal. DSI HOT WATER HEATER
SHOWER SURROUND
VACUUM BONDED UPPER BATH DECK
RANGE COVER
ALUMINUM FRAMED 2" SIDEWALLS
FRONT ELECTRIC LANDING GEAR
MP3/AUX HOOK-UP
GEL-COATED FIBERGLASS SIDEWALLS
CUTTING BOARD

SPARE TIRE, CARRIER AND COVER
MAGAZINE RACK
SPICE RACK
HAIR DRYER
UNIVERSAL DOCKING STATION
LAUNDRY CHUTE
PILLOW TOP MATTRESS
13.5 BTU AIR CONDITIONING
BEDROOM ROOF VENT
MICROWAVE OVEN
RESIDENTIAL HIDDEN HINGES
BLACK TANK FLUSH
26" LCD TV
HI END 12VOLT AM/FM/CD/DVD
SURROUND SOUND SPEAKERS
PORCELAIN TOILET
OUTSIDE SHOWER
DUAL TOILET PAPER HOLDER
PAPER TOWEL HOLDER
WALL CLOCK
STORAGE UNDER BOOTH DINETTE
UPGRADED LIGHT FIXTURES
KNIFE RACK
HITCH COVER
REAR LADDER
22" OVEN WITH PIEZO IGNITION
5200 LB E-Z LUBE AXLES

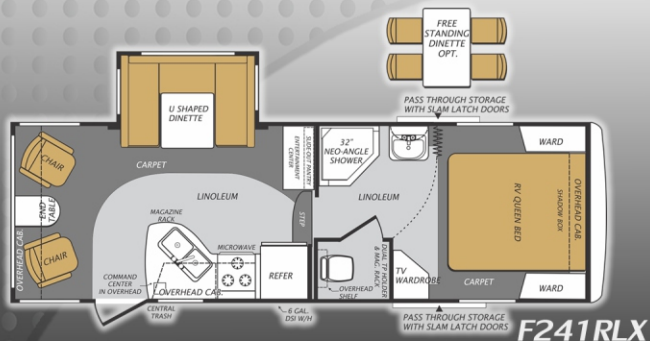

F241RLX

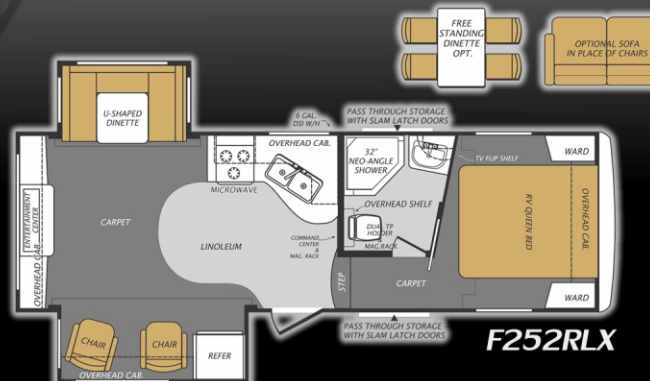

F252RLX

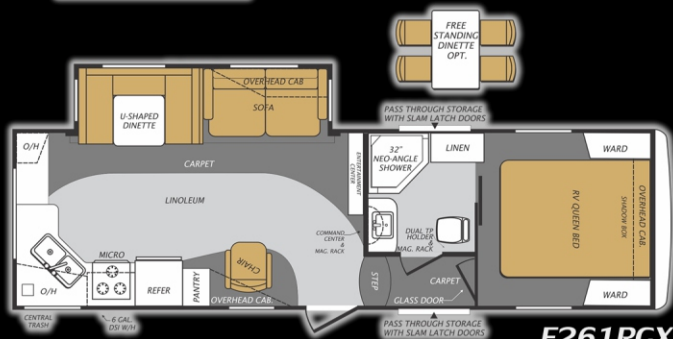

F261RGX



F281RKX

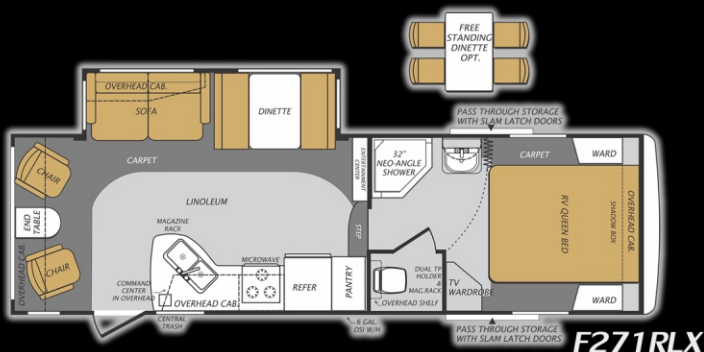

F271RLX

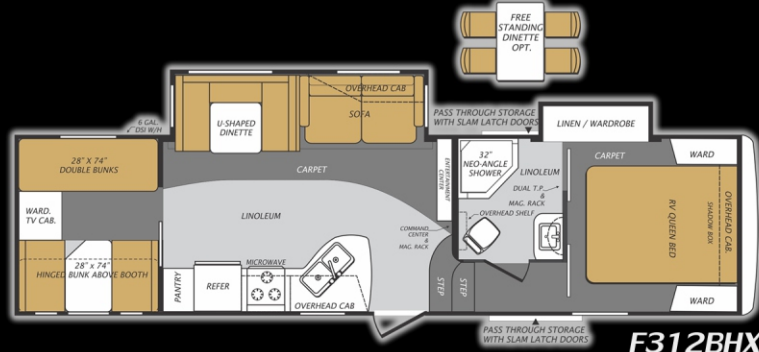

F312BXH

Wildcat

Fifth Wheels Maxx



5th Wheel Standard Series

Features

13.5 DUCTED A/C
SPARE TIRE, CARRIER & COVER
FRONT ELECTRIC LANDING GEAR
REAR ELECTRIC STABILIZER JACKS
QUICK RELEASE JACK PINS
6000 LB E-Z LUBE AXLES
DOOR SIDE SCARE LIGHT
REAR LADDER
TV ANTENNA
OUTSIDE LP QUICK CONNECT FOR BBQ
16" ALUMINUM WHEELS & 'E' RANGE TIRES
OUTSIDE SHOWER
HITCH COVER
SLAM-LATCH EXTERIOR DOORS
FIBERGLASS FRONT CAP
UNIVERSAL DOCKING STATION
8' CUBIC REFER
RAISED 6 PANEL REFER INSERT
CUTTING BOARD
PAPER TOWEL HOLDER
CORIAN® SOLID SURFACE KITCHEN COUNTERS
22" OVEN WITH PIEZO IGNITION
RANGE COVER
RESIDENTIAL BALL BEARING DRAWER GUIDES
BLACK FRAME TINTED SAFETY GLASS WINDOWS

ELECTRIC AWNING
OUTSIDE SPEAKERS
AIR MATTRESS HIDE-A-BED SOFA
2 SWIVEL ROCKING CHAIRS
32" LCD HDTV (26" ON 282RK)
CABLE TV W/SATELLITE HOOK-UP
AM/FM, CD/DVD WITH REMOTE
COMMAND CENTER
10 GALLON DSI WATER HEATER
PLEATED NIGHT SHADES
CHERRY HARDWOOD CABINETS
PORCELAIN FOOT FLUSH TOILET
DUAL TOILET PAPER HOLDER
HAIR DRYER
BLACK TANK FLUSH
SHOWER SKYLIGHT
LP LEAK DETECTOR
FOLDING ASSIST HANDLE
6000 LB E-Z LUBE AXLES
PILLOW-TOP MATTRESS
MAGAZINE RACK
HIDDEN HINGES
WALL CLOCK
KITCHEN WALL BORDER
MICROWAVE OVEN

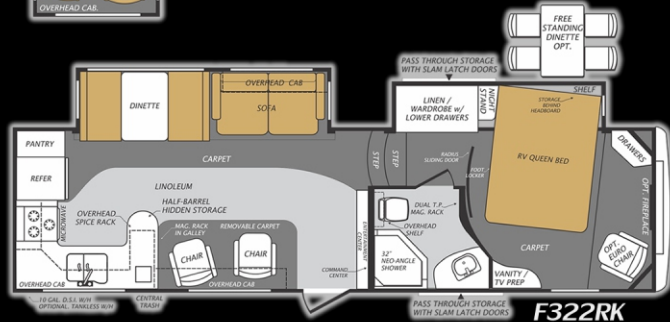
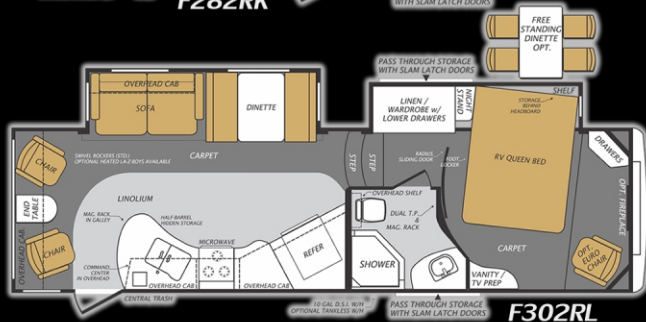
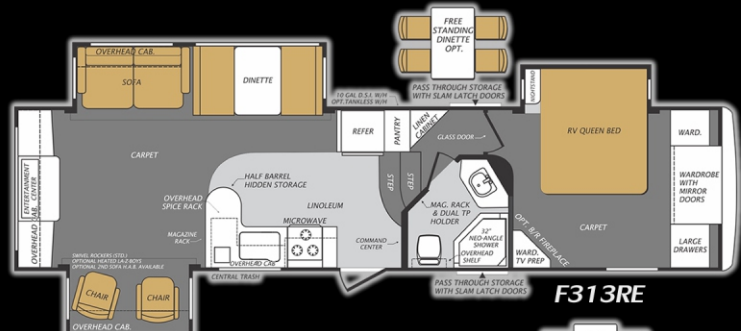
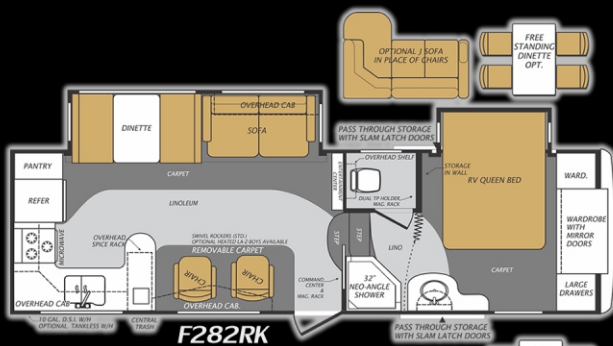

Wildcat Maxx



Structural Details

1. 3/8" OSB Roof Decking
2. Insulated A/C Duct-work
3. Heavy Duty Steel I-Beam Chassis
4. Rolled Fiberglass Insulation, High Density Foam In Walls
5. Vinyl Covered Interior Decorative Wall Board
6. Full Size Radius Entry Door
7. 13.5K BTU Air Conditioner
8. 5/8" One Piece Laminated Floor
9. One-Piece EPDM Rubber Roof Membrane (12 Year Warranty)
10. 5" Engineered and Fabricated Roof Rafters on 16" Centers
11. Fiberglass Blanket Roof Insulation (R-14), (R-38) with Astrofoil
12. Fiberglass Blanket Floor Insulation (R-14), (R-38) with Astrofoil
13. Aerodynamic Gel-coated Fiberglass Front Cap
14. Decorative Hitch Cover
15. Optimized Turning Radius
16. 2" Thick ALUMACAT™ Vacuum-Bonded Fiberglass Laminated Sidewalls
17. Spring-Loaded Quick Release Jack Pins on Landing Gear Legs
18. Radius-Wrap Aluminum Skirt Metal
19. Fully Enclosed Underbelly
20. Premium Carpet Padding
21. Residential-grade Shaw® Carpeting with R2X™ Stain and Pet Guard
22. Load Range 'E' Radial Tires
23. E-Z Lube Axles
24. Molded Fender Skirt

R-38 Rating In Ceiling And Floors

Our products are designed with the latest insulation products and engineered to withstand extreme environments. Insulation and reflective foil is added above the protective water barriers on the bottom of each unit. We also add vented areas in the ducting to heat each units underbelly.

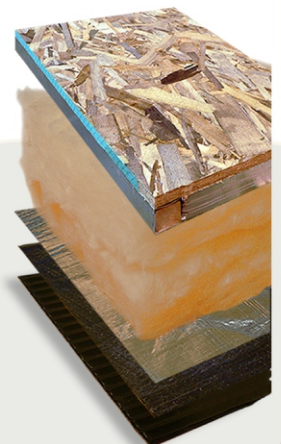

Heavy Duty Aluminum Framing

We use heavier tubing than most of our competition. Our vacuum bonded, two inch side walls are insulated with solid block foam.



Double Insulated Ceiling With Relective Foil Standard

This Is A Space Age Insulation System. Our System Has A Calculated R Value Of 38 At 80 Degrees Fahrenheit And Can Double Your Heating And Cooling Efficiencies





Cranberry Interior With Soft Touch Rawhide Option

Onyx Interior With Mojave Black Rawhide Option

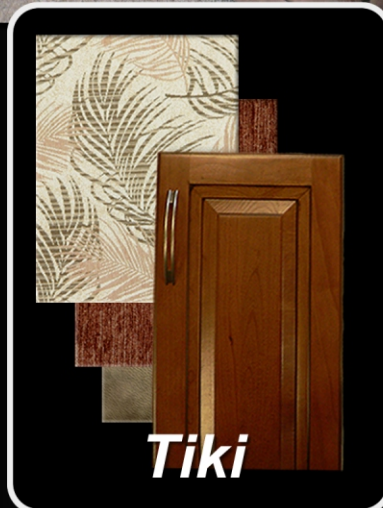

Tiki

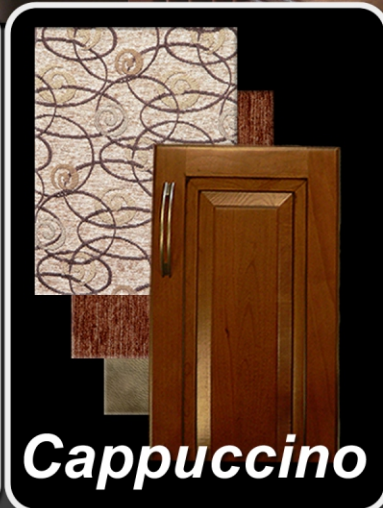

Cappuccino

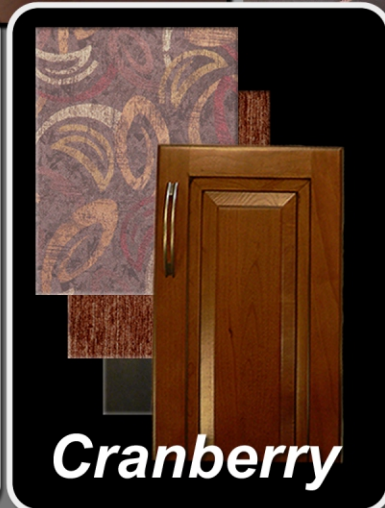

Cranberry



Onyx -
Mojave Black Rawhide

Wildcat Maxx

Travel Trailer & Fifth Wheel Specifications

	Exterior Length	Exterior Height	Exterior Width	Fresh Water Capacity	Grey Water Capacity	Black Water Capacity	Awning Size	Dry Hitch Weight	Unloaded Vehicle Weight	Gross Vehicle Weight	Cargo Carrying Capacity
TRAVEL TRAILERS											
T24RG	28 FT 2 IN	11 FT	96 IN	42 GAL	32 GAL	32 GAL	18 FT	712 LB	5,975 LB	10,872 LB	4,838 LB
T26BHS	30 FT 3 IN	11 FT	96 IN	42 GAL	32 GAL	32 GAL	17 FT	705 LB	6,190 LB	10,865 LB	4,616 LB
T26FBS	29 FT 4 IN	11 FT	96 IN	42 GAL	64 GAL	32 GAL	18 FT	700 LB	6,180 LB	10,860 LB	4,621 LB
T27FLS	33 FT	11 FT	96 IN	42 GAL	64 GAL	32 GAL	20 FT	845 LB	7,205 LB	11,005 LB	3,741 LB
T27RLS	31 FT 4 IN	11 FT	96 IN	42 GAL	64 GAL	32 GAL	18 FT	770 LB	6,675 LB	10,930 LB	4,196 LB
T28RKX	33 FT	11 FT	96 IN	42 GAL	64 GAL	32 GAL	18 FT	785 LB	6,825 LB	10,945 LB	4,061 LB
T28RLS	34 FT 5 IN	11 FT	96 IN	42 GAL	64 GAL	32 GAL	19 FT	900 LB	7,410 LB	11,060 LB	3,591 LB
T29BHS	33 FT 2 IN	11 FT	96 IN	42 GAL	32 GAL	32 GAL	19 FT	825 LB	6,555 LB	10,985 LB	4,371 LB
HALF TON 5TH WHEEL											
F241RLX	27 FT 6 IN	11 FT 11 IN	96 IN	59 GAL	74 GAL	37 GAL	15 FT	1,122 LB	7,127 LB	11,282 LB	4,100 LB
F252RLX	28 FT 8 IN	12 FT 2 IN	96 IN	59 GAL	50 GAL	50 GAL	9 FT	1,199 LB	7,769 LB	11,359 LB	3,531 LB
F261RGX	29 FT 10 IN	12 FT 7 IN	96 IN	59 GAL	100 GAL	50 GAL	17 FT	1,254 LB	7,639 LB	11,414 LB	3,716 LB
F271RLX	29 FT 5 IN	11 FT 10 IN	96 IN	59 GAL	100 GAL	50 GAL	18 FT	1,180 LB	7,575 LB	11,340 LB	3,706 LB
F281RKX	30 FT 3 IN	12 FT 1 IN	96 IN	59 GAL	100 GAL	50 GAL	19 FT	1,080 LB	7,850 LB	11,240 LB	3,330 LB
F312BHX	33 FT 10 IN	12 FT 6 IN	96 IN	59 GAL	100 GAL	50 GAL	17 FT	1,629 LB	8,879 LB	11,789 LB	2,851 LB
STANDARD 5TH WHEEL											
F282RK	30 FT 3 IN	12 FT 5 IN	96 IN	63 GAL	100 GAL	50 GAL	19 FT	1,455 LB	8,450 LB	11,615 LB	3,106 LB
F302RL	32 FT 11 IN	12 FT 5 IN	96 IN	63 GAL	100 GAL	50 GAL	19 FT	1,595 LB	8,795 LB	11,755 LB	2,901 LB
F313RE	34 FT 8 IN	12 FT 8 IN	96 IN	63 GAL	100 GAL	50 GAL	16 FT	1,744 LB	9,828 LB	11,904 LB	2,017 LB
F322RK	34 FT 2 IN	12 FT 3 IN	96 IN	63 GAL	100 GAL	50 GAL	19 FT	1,690 LB	9,090 LB	11,850 LB	2,701 LB



Forest River, Inc. encourages our customers to purchase their Forest River products from a local dealership whenever possible for the following reasons:

It is the goal of Forest River, Inc. that all of our RV owners fully enjoy the RV experience and that customer satisfaction meets or exceeds their expectations!

- 1) Forest River, Inc. dealers are independently owned and operated businesses so priority service and scheduling is at their discretion and is often provided to customers that purchased their unit at that dealership.
- 2) Purchasing locally allows customers to establish meaningful relationships with a dealer, enhancing the RV experience through assistance with product questions, user tips or RV regulations for your state or country, and much more!
- 3) Canadian customers must meet requirements to bring an RV purchased out of the country to their home. These requirements may involve additional inspections and certifications, taxes and fees. Your local Canadian Dealer is a professional at meeting these requirements.
- 4) Scheduling timely warranty repairs and adjustments through a local dealership provides far greater flexibility and convenience to you, the customer!

24/7 EMERGENCY ROADSIDE ASSISTANCE

For a worry-free ownership experience Forest River includes one

Coach-Net®
RV Technical & Roadside Assistance

year of Coach-Net RV Technical & Roadside Assistance with each RV purchase. Whether new to the RV lifestyle or an experienced RV enthusiast, Forest River owners have 24/7 access to technical, operational and emergency road service coverage throughout the US & Canada. Coach-Net's fast, dependable service is just a phone call away.

Floor plans and specifications are based on the latest product information. Forest River, Inc. reserves the right to make changes in drawings and specifications at any time without notice and assumes no responsibility for any errors in the document. The model number does not necessarily reflect the overall length of a particular unit. All standards and features pertain to models manufactured after October 1st 2012.

Dealer Address



Learn More
Scan this barcode using a QR Reader on your smart phone to learn more about Forest River.

