

KNIGHT® | 2013
Class A Diesel



NAVISTAR

TRAVEL WELL — ARRIVE IN STYLE

The 2013 Knight bears the unmistakable design and engineering of a Monaco coach and offers the best ride in the industry. Appointed in luxurious details, the multiple floorplan configurations in lengths 36 to 40 ft, give you the space and storage you need. The distinctive chevron front and rear face details and bold graphics signal you have arrived.



KEY FEATURES

RIDE AND DRIVE

- 350 horsepower, 1150 lbs/ft torque MaxxForce 10 engine.
- Custom built for Navistar RVs, Roadmaster chassis with 8 airbag suspension.
- Ergonomically designed cockpit for optimal visibility, reach and leg room.

INTERIOR

- 42" LCD living room TV, 32" LCD bedroom TV.
- Residential refrigerator, sealed 3-burner gas cooktop.
- 1 or 1-1/2 bath available floorplans with solid surface countertop, handcrafted tile backsplash.
- King bed standard with optional air mattress.
- Optional stackable washer and dryer.
- Quiet Cool™ 15 BTU roof air conditioners with heat pumps and digital thermostat control.

EXTERIOR

- Hot and cold exterior shower, holding tank rinsing system, optional RV Sanicon tank drainage system.
- Side swing aluminum storage doors with seamless rotocast pass through storage with slide out trays.
- Full body 4-color paint with clear front mask.
- 3-point locking position entry door.
- Optional Exterior entertainment center with 42" LCD TV.



MOCHA



PLATINUM



NEO CINNABAR



GRANITE



CABERNET



MOCHA SPLENDOR

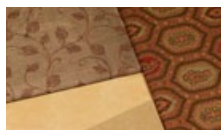

NEO CINNABAR

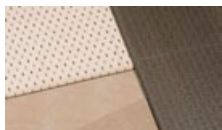

PLATINUM



ITALIAN
SIENNA



ITALIAN
SIENNA
GLAZED

36PFT

A B E H

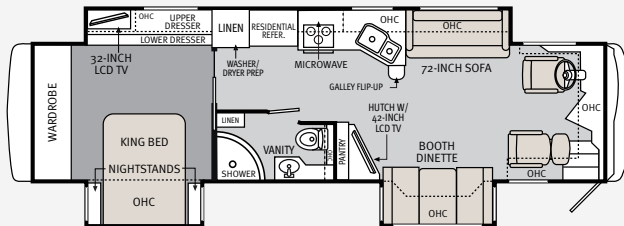

- Full-Wall slide
- 42" Mid-Ship TV
- King Bed w/Optional Air Mattress

40PDQ

A C D E

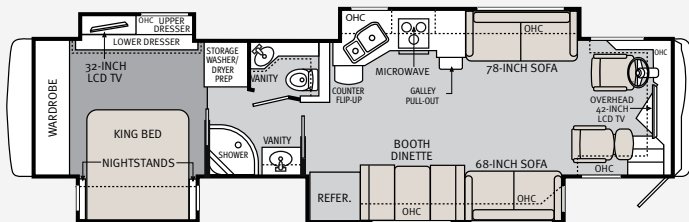

- Quad slide
- Ultra-Leather Jack-Knife Sofa
- Split-Bath
- King Bed w/Optional Air Mattress

40PBT

B F H I

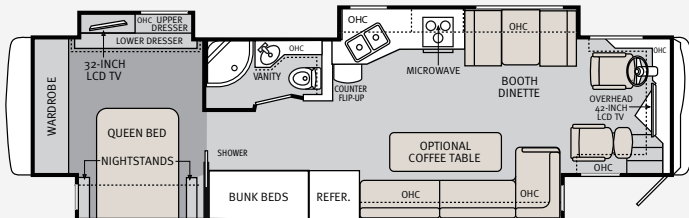

- Full-Wall Slide
- 42" Mid-Ship TV
- Large Extendable Sofa

38PFT

E F I

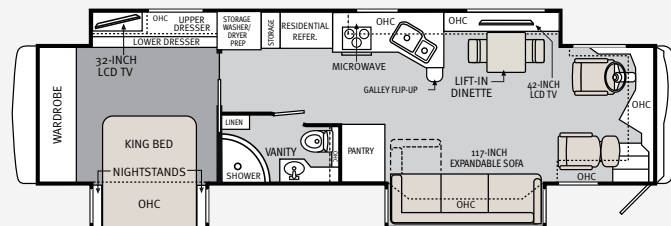

- Full-Wall Slide
- Freestanding Dinette w/Liftable TV
- Large Extendable Sofa
- King Bed w/Optional Air Mattress

40DFT

A C D E I

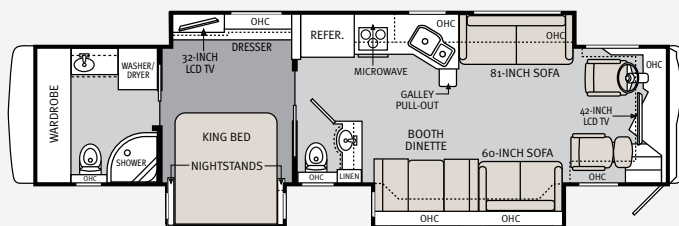

- Full-Wall Slide
- 1-1/2 Baths
- Extendable Sofa
- King Bed w/Optional Air Mattress

Due to continuous product improvements, please visit us online at monacocoach.com for the latest in standards, options, specifications and technical data.

FURNITURE OPTIONS

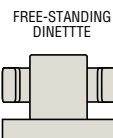

A

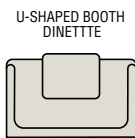

B

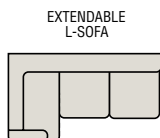

C

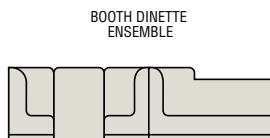

D



E



F



G

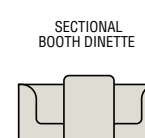

H

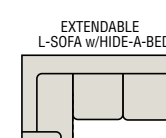

I



9-LAYERED ROOF CONSTRUCTION (TOP TO BOTTOM)

- One-piece peaked fiberglass roof
- Luaun backing
- Thick, tapered bead foam insulation
- Aluminum double I-beam superstructure filled with fiberglass insulation
- Vapor barrier
- Structure foam: thermal insulation barrier
- 1/2" bead foam insulation
- Foam padding for extra insulation
- Padded vinyl ceiling

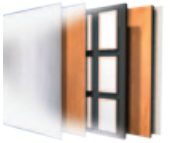

LAYERED SIDEWALL CONSTRUCTION

- Wallpaper
- Decor Board
- Square tubular aluminum frame
- High performance insulation
- Gelcoat fiberglass composite sidewall

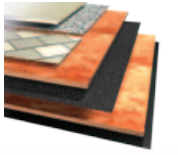

FLOOR CONSTRUCTION (TOP TO BOTTOM)

- Structurwood®
- 1-1/2" aluminum tube
- High-performance thermal insulation foam
- Luaun
- 3-ply Backer

WEIGHTS*	36PFT	38PFT	40PDQ	40DFT	40PBT
Gross Vehicle Weight Rating	36,000	36,000	36,000	36,000	36,000
Gross Combined Weight Rating	46,000	46,000	46,000	46,000	46,000
Front Gross Axle Weight Rating	13,000	13,000	13,000	13,000	13,000
Rear Gross Axle Weight Rating	23,000	23,000	23,000	23,000	23,000
MEASUREMENTS					
Wheelbase	213"	237"	261"	261"	261"
Overall Length	37' 4"	39' 4"	41' 4"	41' 4"	41' 4"
Overall Height with A/C	12'-7"	12'-7"	12'-7"	12'-7"	12'-7"
Interior Height	7' 0"	7' 0"	7' 0"	7' 0"	7' 0"
Interior Width	94.5"	94.5"	94.5"	94.5"	94.5"
Exterior Width	100.5	100.5"	100.5"	100.5"	100.5"
TANK CAPACITIES (GAL)**					
Water Heater	10	10	10	10	10
Grey Tank	62	62	62	62	62
Black Tank	40	40	40	40	40
Fresh Tank	100	100	100	100	100
LP Tank ***	39	39	39	39	39
Fuel Tank	100	100	100	100	100

*Towing capacity is limited by GCWR; your vehicle's towing capacity is the difference between the GCWR and the actual vehicle weight, including all water, fuel, passengers and cargo. Your towed vehicle should be equipped with auxiliary brakes if the weight of the towed vehicle exceeds 1,000 lbs. Consult your owner's manual for further towing information.

**All tank capacities are estimated based upon calculations provided by the tank manufacturers and represent approximate capacities. The actual "usable capacity" may be greater or less than the estimated capacities based upon fabrication and installation of the tanks.

***Actual filled LP capacity is 80% of listing due to safety shut-off required on tank.

For more information on standards and options, please go to www.monacocoach.com
606 Nelson's Parkway, Wakarusa IN 46573 • 877 252 4666

ROADMASTER™ CHASSIS

Built to deliver the very best diesel motorhome experience, Roadmaster construction utilizes advanced design and engineering, along with its eight outboard-mounted air bags and shock absorbers, to distribute stress evenly throughout the entire chassis, reducing the possibility of twisting and increasing durability and reliability. It's the ultimate foundation for a luxury ride.



MAXXFORCE® ENGINE

The MaxxForce 10 design grew from a big idea: bring to the mid-range diesel market traditional big bore features like wet-sleeve design and in-chassis rebuild capability. This model, which brings increased 9.3-liter displacement by longer stroke, meets the requirements of more demanding applications.



The high-output MaxxForce 10 offers these features plus the performance you would expect from larger heavy-duty engines in a weight-saving medium-duty package.

AROUND THE CLOCK SERVICE AND SUPPORT

When you take delivery of your new recreational vehicle, it's just the beginning of our exclusive around-the clock Owner Advantage Program™.

We offer an extensive support program that provides complete roadside assistance and special motor club benefits that follow you wherever your travels take you. We've teamed up with the most trusted RV emergency road service company in the country to give you immediate access to fast, dependable service when and where you need it.

Add our toll-free service appointment assistance, plus a technical assistance hotline, and you have the security of 24-hour, full-time support at your fingertips.

WARRANTY INFORMATION

Enjoy your next RV adventure with the peace of mind that comes with a 12 month/24,000 mile basic limited warranty; a 5 year/50,000 mile limited warranty on aluminum or steel frame structure; and a 3 year/50,000 mile limited warranty on the Chassis. Review your coach's limited warranty in full for complete terms and conditions.

SERVICE AND SUPPORT

24/7 service and support – Toll-free 877-211-8135.