



TOWABLES



WINNEBAGO MINNIE

Minnie



## NEVER UNDERESTIMATE THE HEART OF A MINNIE

### SUPERB STYLE, FEATURES, CONSTRUCTION & VALUE

The Winnebago MINNIE is a light weight towable RV that performs at a higher level. Exterior color choices and designer interiors make each MINNIE distinctive. Features like memory foam mattress, Touch Elite stereo with Bluetooth streaming music and full size appliances make Minnie uncompromising. High quality materials and construction methods like aluminum framed floors with plywood decking assure that MINNIE is built to last. All of this and affordable pricing makes MINNIE a great value!

**2101 FBS SHOWN**



# MINNIE FLOORPLANS

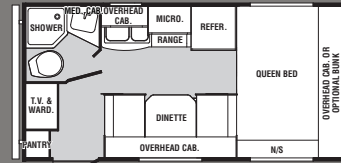

1801 FB

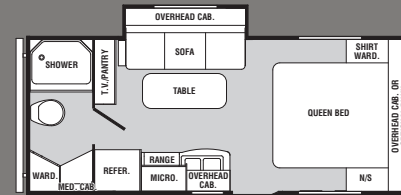

2101 FBS

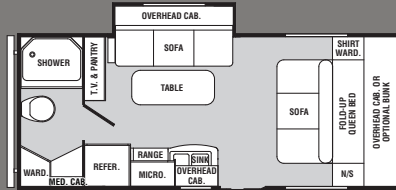

2101 DS

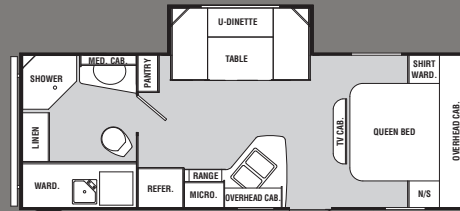

2201 DS

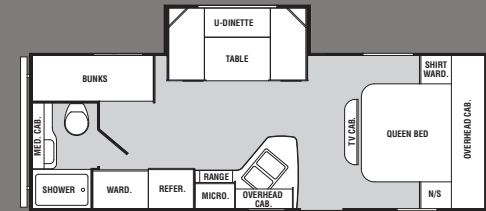

2451 BHS

# SPECIFICATIONS

| Model    | Measurements     |                   |                |                 | Capacities               |                     |                        |                       |                       |                      |
|----------|------------------|-------------------|----------------|-----------------|--------------------------|---------------------|------------------------|-----------------------|-----------------------|----------------------|
|          | Exterior Length* | Exterior Height** | Exterior Width | Interior Height | Dry Hitch Weight/Lbs.*** | Ship Weight/Lbs.*** | Carrying Capacity/Lbs. | Fresh Water Cap./Gal. | Black Water Cap./Gal. | Gray Water Cap./Gal. |
| 1801 FB  | 19'-2"           | 10'-0"            | 7'-6"          | 76"             | 340                      | 3,330               | 5,500                  | 49                    | 25                    | 25                   |
| 2101 FBS | 21'-11"          | 10'-0"            | 7'-6"          | 76"             | 460                      | 3,840               | 5,500                  | 49                    | 25                    | 25                   |
| 2101 DS  | 21'-11"          | 10'-0"            | 7'-6"          | 76"             | 460                      | 3,780               | 5,500                  | 49                    | 25                    | 25                   |
| 2201 DS  | 26'-9"           | 10'-1"            | 8'-0"          | 77"             | TBD                      | TBD                 | 5,500                  | 49                    | 25                    | 41                   |
| 2451 BHS | 26'-9"           | 10'-1"            | 8'-0"          | 77"             | TBD                      | TBD                 | 5,500                  | 49                    | 25                    | 41                   |

\*From center of coupler to rear bumper \*\*Includes AC on roof \*\*\*Not including options

# EXTERIOR OPTIONS



# STANDARDS AND OPTIONS

## CONSTRUCTION

- Laminated Aluminum Framed Walls
- Hi Gloss Gel Coated Fiberglass Exterior
- Aluminum Framed & Plywood Decked Floor
- One Piece Rubber Roof
- Radius Roof Trusses
- Full Walk On Roof
- 30 Amp Detachable Power Cord
- I-Beam Frame

## EXTERIOR FEATURES & EQUIPMENT

- Large Patio Awning
- Exterior Storage Compartment
- Digital, Roof Mounted Antenna
- Cable Ready
- Exterior Speakers
- Front Diamond Plate Rock Guard
- Black, Dark Tinted, Radius Safety Glass Windows
- EZ Lube Axles
- Radial Tires
- LP Bottle Cover

## INTERIOR FEATURES & EQUIPMENT

- Maple Cabinetry
- Solid Wood Core Cabinets
- Pre-drilled and Screwed Cabinet Frames
- Nickel Door and Drawer Hardware
- Full Extension, Steel Ball Bearing Drawer Guides
- Large Pantry in Kitchen
- Large Bowl Kitchen Sink
- Microwave with Turn Table
- Hi Rise Kitchen Faucet
- Mini Blinds
- AM/FM/CD/DVD Touch Elite Stereo System with MP3 Plug In & Blue Tooth Wireless Control
- Ever-Pedic Memory Foam Mattress
- Residential Folding Sofa (Where Applicable)
- Porcelain Foot Flush Toilet
- Medicine Cabinet
- ABS Tub Surround
- Radius "Space Maker" Shower Door (N/A 1801)
- 12 V Exhaust Fan in Bath
- Skylight Over Shower
- Shirt Closets

## APPLIANCES

- Large 2-Door Refrigerator
- 6 Gallon Gas/Electric Water Heater
- Quick Recovery Mode for Water Heater
- Hi Capacity Gas Furnace
- 3 Burner Range Top
- Range Hood with Light
- Water Heater Bypass
- Hi Capacity Water Pump
- 13,500 BTU Air Conditioner
- 55 AMP Convertor

## SAFETY EQUIPMENT

- CO Detector
- LP Detector
- Fire Extinguisher
- Dual Hitch Safety Chains
- Smoke Alarm
- Safety Glass Windows

## OPTIONS

- Exterior Gel Coat Fiberglass Color
  - (White, Lemon, or Lime)
- Minnie Convenience Package
  - Oven
  - Spare Tire, Carrier & Cover
  - 4-Stabilizer Jacks
  - Counter Top Extension (Where Applicable)
  - Hub Covers
- 15,000 BTU Air Conditioner
- 19" LCD Television (1801)
- 26" LCD Television (2101, 2201 & 2451)
- Night Shades
- Deluxe Aluminum Wheels
- Rear Ladder
- Fold Away Grab Handle
- 30# LP Bottles
- Exterior TV Hookup with Bracket
- 12 V Power Awning
- Enclosed Underbelly
- Outside Shower
- Front Overhead Cabinet Bunk
- Outdoor Kitchen (2201)



TOWABLES

## Winnebago Of Indiana, LLC

201 14th Street | P.O. Box 2001  
Middlebury, IN 46540 | (574) 825-5250

[www.winnebagoind.com](http://www.winnebagoind.com)

your Minnie Dealer:

Tow Vehicle Disclaimer. CAUTION: Owners of Winnebago Of Indiana, LLC recreational vehicles are solely responsible for the selection and proper use of tow vehicles. All customers should consult with a motor vehicle manufacturer or their dealer concerning the purchase and use of suitable tow vehicles for Winnebago Of Indiana, LLC products. Winnebago Of Indiana, LLC disclaims any liability or damages suffered as a result of the selection, operation, use or misuse of a tow vehicle. WINNEBAGO OF INDIANA, LLC'S LIMITED WARRANTY DOES NOT COVER DAMAGE TO THE RECREATIONAL VEHICLE OR THE TOW VEHICLE AS A RESULT OF THE SELECTION, OPERATION, USE OR MISUSE OF THE TOW VEHICLE.

All illustrations and specifications contained in this literature are based on the latest product information available at the time of printing. Winnebago Of Indiana, LLC reserves the right to make changes to colors, materials, specifications and pricing without notice or obligation. Photography may show optional equipment available at an additional cost. Items used as props in photography are not part of the packages. All liquid capacities and weights are approximate and dimensions are nominal. Winnebago reserves the right to make changes and improvements without incorporating these changes into similar models produced at an earlier date. Consult your local, authorized Winnebago of Indiana, LLC dealer for the latest information and changes. Winnebago Of Indiana, LLC continues to be a member in good standing of the RVIA.