

# NASH



www.northwoodmfg.com

## FORGED ON THE FRONTIER

Model Number	17K	18L	23B	23D	23F	25C
Dry Axle Weight (approx. Lbs.)	3860	4075	4595	4770	4420	5245
Dry Hitch Weight (approx. Lbs.)	500	520	430	500	420	575
Net Carrying Capacity	2640	2405	1975	1730	2160	2180
Gross Dry Weight-lbs (approx. Lbs.)	4360	4595	5025	5270	4840	5820
Gross Vehicle Weight Rating (GVWR)-Lbs.	7000	7000	7000	7000	7000	8000
Exterior Length (approx. w/hitch)	22' 4"	23'3"	27'7"	25'10"	26'4"	28'-5"
Exterior Height (approx. incl. AC unit)	10'7"	10'7"	10'7"	10'11"	10'7"	10'11"
Exterior Width (approx. w/o awning)	8'	8'	8'	8'	8'	8'
Tire Size	ST205 75R15	ST205 75R15	ST205 75R15	ST205 75R15	ST205 75R15	ST225 75R15
Load Range	C	C	C	C	C	D
Fresh Water Capacity (approx gal)	46	46	46	46	46	42
Gray Water Tank (approx. gallons)	35	41	41	41	41	41
Black Water Tank (approx. gallons)	42	35	35	35	35	35
LPG Capacity (approx. gallons)	14	14	14	14	14	14
CSA - Canadian Dealers Only	YES	YES	YES	YES	YES	YES
Auto Ignition Furnace (1,000 BTU's)	20	20	25	25	25	25

**\*All dry weights are calculated before adding options.**

Verify the towing capacity of your tow vehicle. If you don't know or aren't sure, you can ask your automotive dealership or contact your tow vehicle manufacturer. All weights above are average approximations and may vary. Specifications are subject to change without notice.



Your Local Dealer:



MORE ABOUT NASH



PO BOX 3359 \* 59948 Downs Road \* La Grande, OR 97850  
Phone 541.962.6274 \* Fax 541.963.4392 \* www.northwoodmfg.com

SUMMER  
2013

July 2012

# NASH



## FORGED ON THE FRONTIER

*DLX*  
FULL  
FEATURED  
MODELS

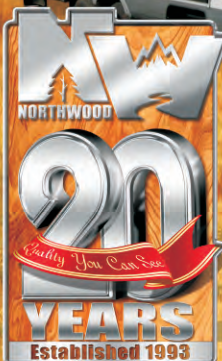

www.northwoodmfg.com



# NASH

## NEW FROM THE GROUND UP!



### The Nash DLX

A good idea is always a good idea. Ron Nash broke into the RV business with his no-nonsense Northwest Rugged "Pretty One in Work Boots"...The Nash Travel Trailer, and that idea took off like wildfire. The Nash DLX remains true to its roots as an affordable, well-made trailer that will last for years; a durable RV you can take off-road and be used in any season. The concept is sensible and simple. We build RVs how YOU like them. It was a good idea 20 years ago and it's a good idea today!

The Nash DLX is equipped to not only meet the needs of the introductory RV buyer, but also offers amazing features not found on other entry level RVs. The Nash has always been known for rugged off-

road durability but never before has it come so fully equipped and so reasonably priced. This new Nash is loaded with standard features:

- ✓ Equaflex Suspension
  - ✓ Certified Off-Road Chassis
  - ✓ TG Plywood Floor and Roof Deck
  - ✓ Multi Layered Fiberglass Wall
- ...and standard amenities such as:
- ✓ 12 Volt Power Awning
  - ✓ Rear Receiver Hitch
  - ✓ 10 Gal. Water Heater
  - ✓ Generator Ready

That's correct - you can have an optional generator on any Nash DLX model. If you are concerned about being fully self-contained, the Nash DLX is your best answer! So, whether your idea of camping is an elk camp in winter or the campsite nearest the swimming pool at your favorite campground, you will feel equally at home in your new Nash DLX.



## ...AND ALL THESE FEATURES ARE STANDARD!



Equaflex Suspension



TG Plywood Floor & Roof Deck



Multi Layered Laminated Fiberglass Wall



12 Volt Power Awning



10 Gal. Water Heater



Northwood Built Structural Steel Certified Off-Road Chassis



Rear Receiver Hitch



Generator Ready





# NASH

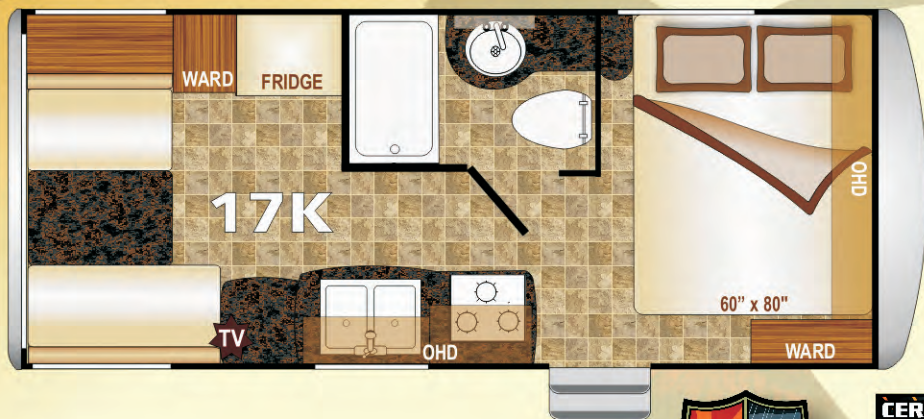

**Large Double Door Fridge**  
**Lots of Storage**  
**Big Bathroom**  
**Lightweight**

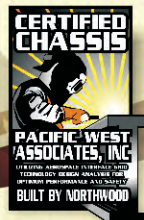

Morning Dew

## Nash 17K DLX



[www.northwoodmfg.com](http://www.northwoodmfg.com) for more about Nash & other products



# NASH

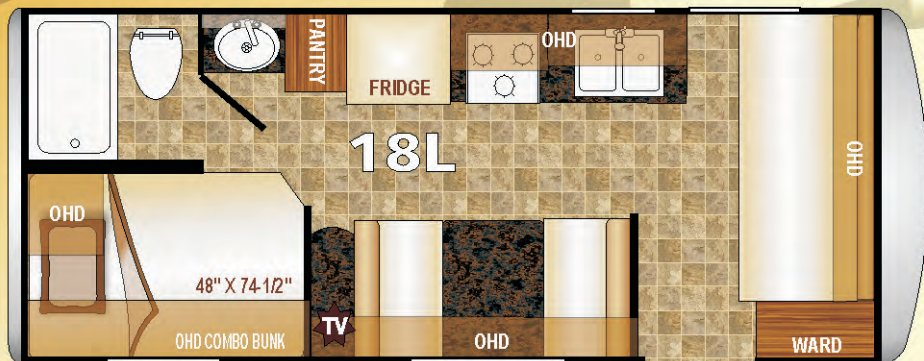

**Big Bunkhouse / Sleeps 7**  
**Convenience Bathroom Sink**  
**Big Living / Dining Area**  
**Pantry Cabinet**

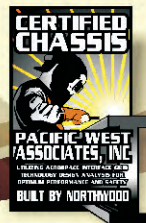

Morning Dew

**Nash 18L DLX**



High Desert

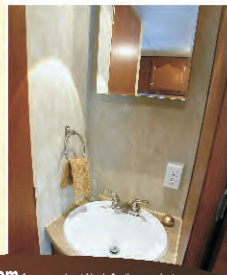

[www.northwoodmfg.com](http://www.northwoodmfg.com) for more about Nash & other products



# NASH



Sit n Sleep Option



**Bunkhouse**  
**Lots of Storage**  
**Huge U-Shaped Dinette**  
**Sit-N-Sleep Sofa Option**



High Desert



Morning Dew

## Nash 23B DLX

[www.northwoodmfg.com](http://www.northwoodmfg.com) for more about Nash & other products



# NASH

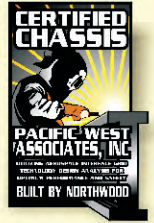

Sit n Sleep Option



**Lots of Storage**  
**Large Kitchen & Bath**  
**Huge U-Shaped Dinette**  
**Sit-N-Sleep Sofa Option**



High Desert



## Nash 23D DLX

[www.northwoodmfg.com](http://www.northwoodmfg.com) for more about Nash & other products



# NASH



**Massive Storage Capacity**  
**Large Rear Bath**  
**Big Living Area**  
**Private Bedroom**

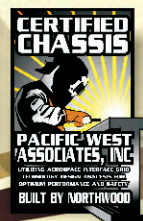

High Desert

**Nash 23F DLX**

[www.northwoodmfg.com](http://www.northwoodmfg.com) for more about Nash & other products



# NASH



**Bunkhouse  
Dual Entry  
Large Bath  
Huge U-Shaped Dinette**



Morning Dew

**Nash 25C DLX**

[www.northwoodfg.com](http://www.northwoodfg.com) for more about Nash & other products



# NASH

## Northwood Built: Heavy Duty Certified Structural Steel Off Road Chassis



### We Build Our Chassis!

Because there is so much riding on it, we build our own chassis. The RV chassis is comparable to the foundation of a home. Ask someone who has had their home settle if they think a solid foundation is important. Quality design combined with quality steel and quality welding results in a better chassis. That is why we certify Northwood chassis through an independent testing laboratory for quality assurance. This is one of the keys to our renowned strength and durability.

### Raising the Roof: A Reason to Celebrate

Using special construction jigs which allow us to use bow trusses, the Northwood ceiling improves upon industry application by adding adhesives to further bind the structure and by using snap batten track molding to ensure a ceiling that stays in place. The ceiling structure is constructed as a single unit and is raised to cap the entire RV in a single step.



## ...QUALITY & DURABILITY YOU CAN RELY ON!



### Glue Bonded Laminate Walls

Our wall studs are 16" on center select lumber (better than competitor's #2 grade). We use R7 fiberglass insulation which is hand tucked and secured. We apply a one-piece laminated exterior wall of corona treated fiberglass and double layers of lauan plywood. This wall forms an amazingly strong one piece



seamless panel. Industrial strength construction adhesives glue bonds the framing to triple layered exterior siding. This provides the "Absolute strength" of the Nash sidewall.



### Residential Quality Face Frame Cabinetry



### A True 4 Season Coach



Solid Wood Cabinet doors ensure lasting beauty and rugged strength.



Face Frame construction gives our cabinets "high end" residential quality.



Structurally Integrated cabinetry is anchored to the walls and ceiling structure of our coaches making both the RV and the cabinets stronger.



R-7 Fiberglass in Walls & Floor  
R-14 Fiberglass in the Roof  
R-15 Reflective Foil - Ceiling & Floor  
Heated & Enclosed Tanks  
Heated & Enclosed Valves





# NASH

Hello Ron and Sherry Nash,

My husband and I have just returned from a three week tour of the Grand Teton, Yellowstone, and Glacier National Parks—in our brand new Nash 17K. We wanted to share some of our photos and some of our story.

This was the longest trip we have taken in a recreational vehicle. Though we have owned larger RV's in the past, mostly motorized Class A and C motorhomes, we have never been on the road this many consecutive nights and days. Our most recent RV was a deluxe tent trailer and we knew it would be an inadequate way to travel this far, this long, and this old.

We decided to look into a small travel trailer we could tow with our Toyota Tundra. Fully expecting to purchase something used, we decided to give our local business a first look: The owner let us go scouting his inventory of new and used trailers. Once in his yard, we spotted three new trailers that were somehow “different”: different color, different shape, and different size. All these features were attractive.



He had three models of Nash on his lot. After going in and out of all three models about fifty times each, we told him we would take this small, compact 17K. Apparently your new Nash designs had not been on the lot for more than a few days, and he was embarrassed to say that he really did not have all the info on them—but he would get it.

One week later, our Nash was parked on our property and ready to be packed for a one night trial before we got busy on our serious trip. All systems worked perfectly in our remote, rustic campsite outside Quemado, NM—and they continued to surpass our expectations for capability, reliability, and easability. We are 100% satisfied customers! We would be happy to answer any questions other potential buyers might ask.

We appreciate your attention to detail and superior quality, and we love our Northwood Owner's Calendar.

Sincerely,

Steve and Jealyn White  
Silver City, New Mexico





# NASH



While owning the Nash, we were able to make a number of suggestions to Ron Nash and Matt Turley about design considerations on our trailer and for future product upgrades. I was impressed to see a number of those suggestions implemented in newer models. Ron always had an ear for us and he would greet us 'Hi Linda and Dave', with a cup of coffee. I feel very good about the team Ron has assembled and the way they are moving the company forward. I am proud to say that we may have been the first owners of a Nash with heated and enclosed holding tanks because of our hunting camp use. This 4-Season feature soon became standard on all Nash products.

We have been 'trailing' for over 45 years and the Nash was our **8th trailer**, so we are not new to the RV industry.

It has really been fun watching Northwood develop and having a part in some of the changes. Thanks for a great product and wonderful, personal service, Northwood!"

Linda and Dave Wiley, Sublimity, Oregon

We have owned both Nash and Arctic Fox products from Northwood.

In 1996 we bought our first Northwood product, the Nash 26J and we used it for 6 years. We did a lot of traveling in the Nash. We then decided to move to a slide-out model and got our 25R Fox. In 10 years of use, our 25R Fox has followed our 4x4 Dodge wherever we have gone, on and off the pavement. It has aged better than we have!

We love to boondock, so we seldom go into RV parks except for rallies and visiting relatives. We do a lot of volunteer work with Rocky Mountain Elk, Oregon Hunters and work on projects with the Forest Service and Fish and Wildlife, so we mostly camp in remote sites.

We first met Ron and Sherry Nash at the Eugene RV Show back in 1993 where they were showing their new products. We also met them a few times at the Portland RV shows. When they came out with the 26J in 1996, we bought one.

Our first Northwood product was a 2002 Nash 29V and we pretty much ran the tires off of it.

The service people here at Northwood have been excellent, they have saved me a great deal of time and Northwood is probably the best manufacturer I have ever dealt with.

The fit and finish in the Nash is 'all there!' I can't



give high enough praise for the product and the backing the company gives you.

Dave Thomas  
Eugene, Oregon



# NASH

## STANDARD FEATURES & OPTIONS

### Standard Construction Features

Northwood built / certified / off-road chassis  
Equaflex suspension  
Enclosed and heated fresh water tanks  
Fiberglass durable, seamless exterior siding  
5/8" tongue-and-groove plywood main floor decking  
Fully decked 3/8" plywood 'Full Walk-On' roof  
One-piece, seamless, roof membrane  
Wood structural framing throughout  
2" X 2" studs, 16" on center in walls, front & rear  
2" X 3" longitudinal joists 16" on center  
5" truss residential-style tapered wood roof rafters  
R-7 fiberglass insulation in sidewalls, roof, and floor  
Double layer R-7 with reflective foil roof insulation  
Reflective Foil insulation throughout underbelly  
Darco one-piece RV under siding  
1/2" plywood bed and bunk platforms  
2" thick laminated route-out dinette platforms  
Electric-power rack and pinion slideouts

### Standard Interior Features

Stereo/AM/FM/CD  
High Valley Maple cabinetry throughout  
Solid wood mortise and tenon cabinet doors  
Solid wood drawer faces  
Armstrong residential wear surface floor covering  
Designer décor border  
Valance window treatments  
Jack knife sofa (converts for sleeping)  
12V light fixtures throughout  
110 electrical outlets throughout  
Square cabinet door frames  
Mini-blind privacy shades throughout  
Residential furniture by Homestyle  
10" electric brakes on all wheels



Northwood Manufacturing, 59948 Downs Rd., PO Box 3359, La Grande, OR 97850 • (541) 962-6274 • [www.northwoodmfg.com](http://www.northwoodmfg.com)

### Standard Exterior Features

Generator ready  
Solar ready  
Rear receiver for cargo rack / bike carrier  
15" radial tires  
Metal wheels and hub covers  
Leaf spring suspension system and straight axles  
Amber patio light with interior switch and hitch light  
Large luggage compartments w/radius corner doors and metal pulls  
Non-skid retractable entry step  
Entry assist handle and hurricane door latch  
Bumper with drain hose storage and end caps  
Galvanized steel wheel wells  
Insulated wheel wells on non-slide models  
Mud flaps  
Molded ABS LPG tank cover  
Fiberglass entry door with radius top corners  
Screen door with kick panel  
Rain gutters with oversized down spouts  
Diamond plate front gravel guard  
Radius cornered windows with screens  
Dual battery rack welded into A-frame  
Park cable TV hook-up with RG6 cable  
Digital TV antenna w/signal booster  
Roof-mount antenna for radio  
Hook-up for satellite TV reception  
12 volt power awning  
Custom gray fiberglass exterior  
Exterior shower

### Standard Safety Features

Dual safety chains on A-frame  
Break-away switch  
GFCI circuit protection  
Smoke alarm  
LPG leak detector  
Carbon monoxide detector  
Fire extinguisher  
Dead bolt lock on entry door  
Egress windows (for emergency escape)

### Standard Bathroom Features

Marine toilet  
Shower surround  
Shower curtain with curved track  
Additional décor shower curtain  
Skylight above tub/shower  
Exhaust fan  
Wall mounted light switch  
Large bathroom sink  
Medicine cabinet with mirror  
Towel bar  
Towel ring  
Toilet paper holder  
Electrical outlet with GFCI circuit protection

### Standard Bedroom Features

Bedroom roof vent  
Quilted bedspread with reverse sham  
Designer headboard  
Camping clothes storage  
Below-bed storage with gas strut assist  
Night stand top and drawer  
Reading lights  
Mini blind privacy shades  
Electrical outlets  
Inner spring mattress  
Designer privacy curtain  
TV mount pre-block w/ hook-ups

### Standard Heat, Power, and Water Equipment

12V electrical system with deluxe 110V 45-amp power converter  
30 amp park power cord - 30 feet  
Auto-ignition furnace with wall thermostat  
In-floor heat ducting  
In-ceiling A/C ducting  
120V GFCI circuit protected exterior patio outlet  
12V demand water pump system  
Hook-up for city water  
10-gal gas water heater  
Two (2) 30 lbs. propane gas tanks with regulator  
ABS holding tanks  
Systems monitor panel  
Water system winterization kit  
Water heater by-pass  
Black tank flush



### Standard Kitchen Features

Nash signature key holder  
3-burner cook top with one 9,000 BTU burner  
Large oven  
Range hood with light and exhaust fan  
Back splash protection behind cook top  
Double door gas/electric refrigerator (most models)  
Designer refrigerator door panel inserts  
Acrylic residential-style sink  
High profile galley faucet  
Sink cover / cutting board  
Large drawers in galley cabinet  
Galley overhead storage cabinets  
Ventilating window at galley sink  
Large picture window at dinette  
Large dinette table  
Access to dinette booth storage  
Reversible dinette cushions  
Laminated countertops  
Microwave oven with carousel

### Options

Exterior marine grade stereo speakers  
Stereo/AM/FM/CD with DVD  
Heated and enclosed holding tanks  
Stabilizer jacks - front and rear  
Sit -N- Sleep sofa sleeper  
Air conditioner  
Range cover  
Generator  
Cargo rack  
Bike rack  
LCD TV



MORE ABOUT NASH

*Thank you*

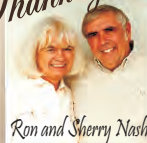

Ron and Sherry Nash

When you've been in the RV industry for nearly 1/2 a century, you've seen it all, and one thing never changes, quality sells and re-sells.

We started Northwood in 1993, building the best quality RV for the best price. That principle has never changed and we are absolutely committed to maintaining our reputation for quality in the RV industry.

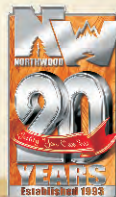

[www.northwoodmfg.com](http://www.northwoodmfg.com) for more information about Nash and other Northwood products