



Arctic Fox



Classic &
Silver Fox Edition

ABSOLUTE NORTHWOOD

Our Guarantee of
**Quality
 Strength
 Durability**

- D. DUAL RACK & PINION RAM MAIN SLIDE ROOM**
 22 Gray Accent Fiberglass Finish on Slide Out Side Wall
 23 4 Seal System w/Inner & Outer Bulb Seal
 24 ...including Wiper Seal for Continual Seal (Any Position)
 25 ...and Outer Bulb Seals

ROOF

- ✓ Full Walk On Roof with Bonded Roof Truss System

FRAME

- ✓ Thick Wall Aluminum w/Solid Anchor Blocking

SLIDE OUTS

- ✓ 4 Seals, Dual Rack & Pinion Rams (main slides)
 Insulated, Cross Ventilating Windows

FLOORS

- ✓ Commercial Grade Linoleum, Fully Insulated
 Tongue and Groove Plywood (not chipboard)

CHASSIS

- ✓ Custom Built, Independently Tested & Certified

CABINETS

- ✓ Wall & Ceiling Mounted, Face Frame Construction

INSULATION

- ✓ A True 4 Seasons Coach



A. NORTHWOOD ROOF TRUSS SYSTEM

- 1 Heavy Gauge One Piece Roof Membrane
- 2 3/8" Plywood Sheathing (Bonded to Trusses)
- 3 R-15 Reflective 'Arctic' Foil Insulation
- 4 R-18 Dual Layer Fiberglass Insulation
- 5 Bow Style Roof Trusses (Bonded to Ceiling)
- 6 Interior Lamination Grade Lauan Plywood
- 7 Quiet/Soft Plush Ceiling Carpet Finish

B. HIGH DENSITY ONE PIECE LAMINATED WALLS

- 8 Designer Interior Decor Finish Paneling
- 9 Lamination Grade Lauan Plywood Interior Wall
- 10 Heavy Gauge Fully Welded Aluminum Superstructure
- 11 Solid Wood Fill - Full Thread Depth Anchor Blocking
- 12 Virgin 2 lb Rigid Dense Block Foam Insulation
- 13 Steel Inlaid Bonderizer Anchor Strips
- 14 Lamination Grade Lauan Plywood Exterior Wall Layer
- 15 Fiberloc Exact Specification Thickness Exterior Wall Layer
- 16 Corona Treated High Durability Fiberglass Outer Layer

C. ULTIMATE DURABILITY FLOOR STRUCTURE

- 17 Residential Quality Plush Commercial Carpeting
- 18 Commercial Grade Linoleum with 20 mil Surface
- 19 5/8" T&G Plywood Decking (not chipboard)
- 20 R-7 Residential Grade Fiberglass Insulation
- 21 Reinforced Woven Highways Moisture Barrier

Our Northwood Built Chassis are Independantly Tested & Certified by Pacific West Associates, Inc.

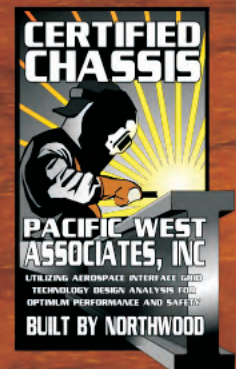

E. MORE ABSOLUTE NORTHWOOD QUALITY FEATURES

- 26 Independantly Certified Custom Built Northwood Chassis
- 27 R-7 Residential Quality Formaldehyde Free Fiberglass Insulation
- 28 Corrugated Underbelly Panels
- 29 Heated and Insulated Large Capacity Holding Tanks
- 30 Easy Lube Axles and Shocks
- 31 Heavy Duty Load Range (E-G) Radial Tires
- 32 Sealed All Metal Heat Ducts
- 33 Aerodynamic Fiberglass Front Cap
- 34 5th Airborne Premium Fifth-Wheel Air-Ride Hitch
- 35 All Foam Condensation Resistant A/C Ducts
- 36 Extra Large 'Starlite' Bedroom Skylight
- 37 Large Skylight
- 38 Hi Output Roof Mount A/C
- 39 Roto Molded High Durability Wheel Skirts
- 40 Diamond Scored Sidewall Skirts

Arctic Fox is a True Four Season Coach





Classic

Travel Trailers



- Aluminum Frame Construction
- Front Fiberglass Cap
- R-18 Fiberglass plus...
- ...Reflective Foil Insulation in the Roof
- Certified Chassis w/ HD Suspension
- Heated and Enclosed Tanks
- Wide Body Construction
- Kitchen Skylight w/ Shade
- New Convenience Headboard
- Interior Command Center
- Privacy Tint Windows w/Night Shade

25' Royal Estate

SIT & SLEEP OPTION



GVWR: 7,500 Dry Weight: 5,050
Length: 23' 10" Width: 8' 6" Height 10' 3"

22G

SWIVEL CHAIR OPTION
REPLACE THE JACKKNIFE SOFA WITH A PAIR OF SWIVEL CHAIRS

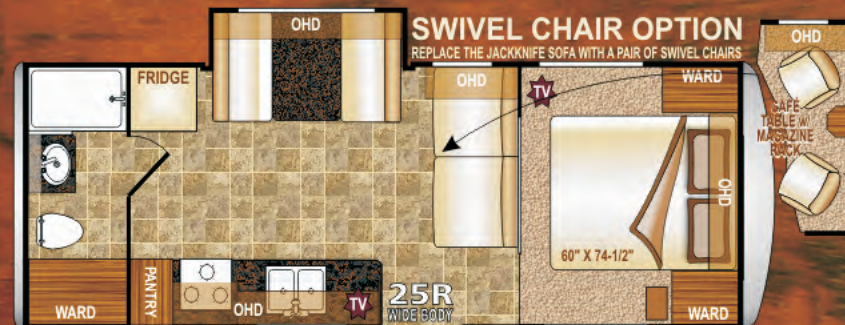

GVWR: 10,000 Dry Weight: 6,485
Length: 27' 03" Width: 8' 6" Height 10' 8"

25R

*Classic
Travel Trailers*



GVWR: 7,500 Dry Weight: 5,050
Length: 23' 10" Width: 8' 6" Height 10' 3"

22H

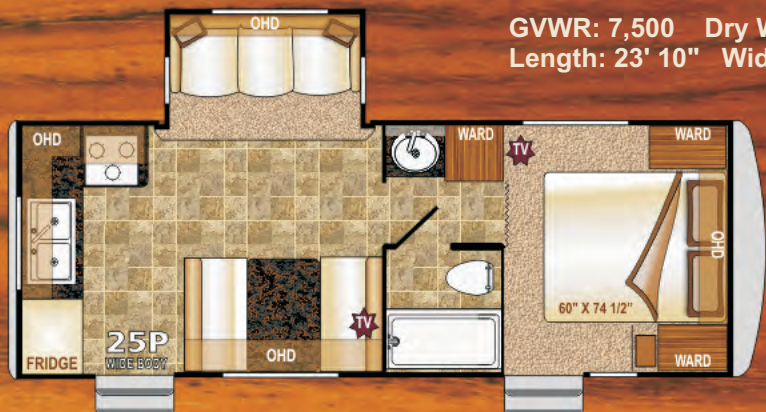

GVWR: 10,000 Dry Weight: 6,760
Length: 27' 01" Width: 8' 6" Height 10' 11"

25P

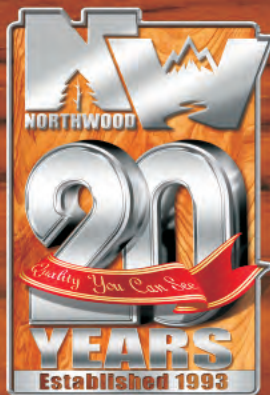

GVWR: 10000 Dry Weight: 6,863
Length: 29' 06" Width: 8' 6" Height 10' 11"

25W

SWIVEL CHAIR OPTION
REPLACE THE JACKKNIFE SOFA WITH A PAIR OF SWIVEL CHAIRS

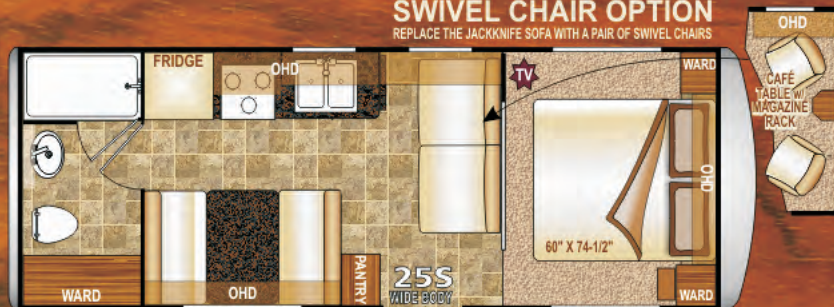

GVWR: 8,000 Dry Weight: 5,260
Length: 26' 11" Width: 8' 6" Height 10' 3"

25S



GVWR: 10,000 Dry Weight: 7,050
Length: 30' 0" Width: 8' 6" Height 10' 11"

25Y

What is ABSOLUTE NORTHWOOD?



Our Guarantee of

Quality
Strength
Durability

When you purchase an Arctic Fox, you are investing in the best quality materials, construction and craftsmanship. That is why the resale value in an Arctic Fox remains higher, and your investment retains its value longer. If you ever decide to trade in your Fox, you will get top dollar. That is why you don't see many used Arctic Foxes on the market, folks buy them up as quickly as they become available because Arctic Fox has a reputation for durability and longevity.

ABSOLUTE CHASSIS

✓ Custom Built, Tested, Certified,

ABSOLUTE FRAME

✓ Thick Wall Aluminum w/Solid Anchor Blocking

ABSOLUTE ROOF

✓ Full Walk On, Bonded Roof Truss System

ABSOLUTE CABINETS

✓ Wall & Ceiling Mounted, Face Frame Construction

ABSOLUTE INSULATION

✓ A True 4 Seasons Coach

NORTHWOOD BUILT CERTIFIED CHASSIS

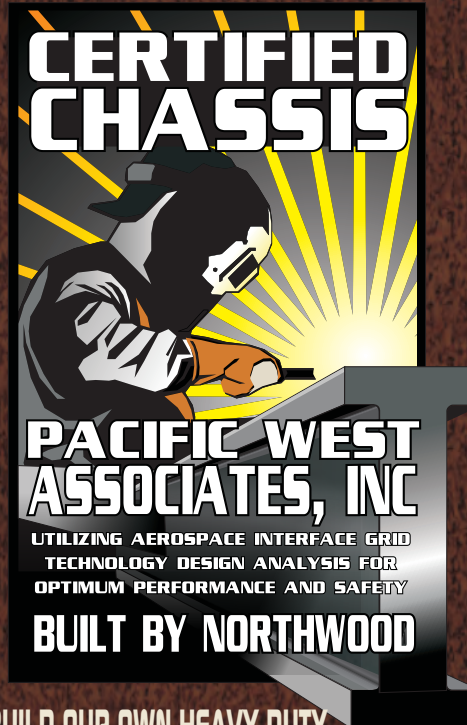

WE BUILD OUR OWN HEAVY DUTY STRUCTURAL STEEL OFF-ROAD CHASSIS

We are one of the few manufacturers who build their own chassis. The name NORTHWOOD is known throughout the industry for quality chassis and we certify ours through an independent testing laboratory for quality assurance.



THICK WALL TUBULAR ALUMINUM SUPERSTRUCTURE

.125"-.060"
(Up to 1/8" Thick)
heavy gauge thick wall aluminum tubing in our travel trailers & fifth wheels



SOLID CORE ANCHOR BLOCKING AND CONTINUOUS WELDS

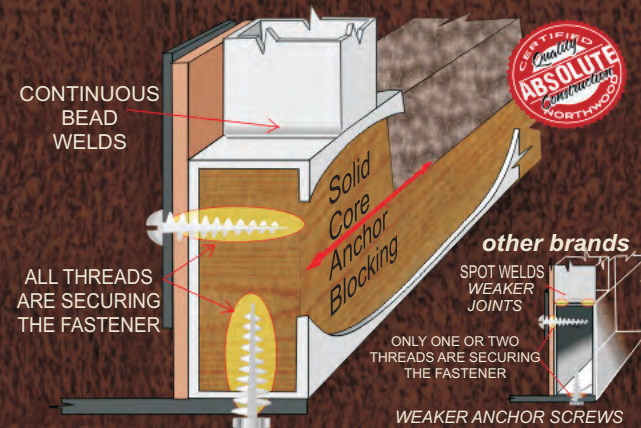

Now that's an **ABSOLUTE** Quality Superstructure!

OUR BONDED ROOF TRUSS SYSTEM ENSURES A FULL WALK-ON ROOF

BONDED ROOF TRUSS SYSTEM



The Northwood Bonded Roof Truss System bonds all the components of the roof structure together as a unit. The ceiling, trusses and roof plywood are unified in a bonded system that gives superior load distribution and maximum load bearing capacity.

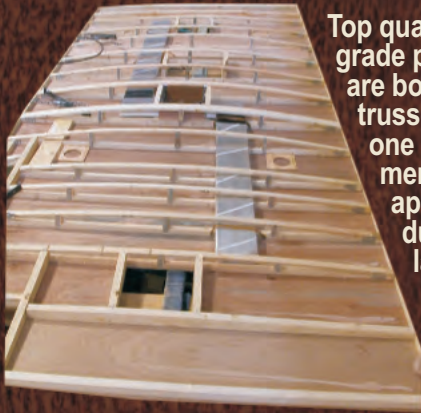

Top quality exterior grade plywood panels are bonded to the trusses and a thick one piece roofing membrane is then applied for a durable, long lasting seal to protect you and your coach from the elements.

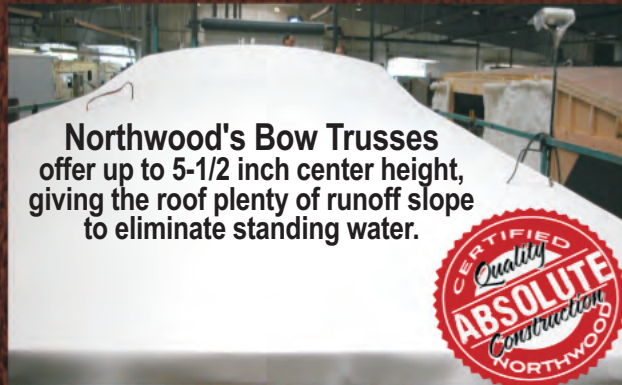

Northwood's Bow Trusses offer up to 5-1/2 inch center height, giving the roof plenty of runoff slope to eliminate standing water.



CUSTOM BUILT FACE FRAME CABINETS

CABINERY w/SOLID WOOD DOORS, BUILT USING RESIDENTIAL FACE FRAME CONSTRUCTION METHODS & INTEGRATED w/ THE WALL & CEILING.

BEAUTIFUL & STRONG



MATERIALS



CONSTRUCTION



INSTALLATION

Solid Wood cabinet doors ensure lasting beauty and rugged strength.



Face Frame construction gives our cabinets 'high end' residential quality.



Structurally Integrated cabinetry is anchored to the walls and ceiling structure of our coaches making both the RV and the cabinets stronger.

A TRUE FOUR SEASONS ALL CONDITIONS UNIT



HEATED ENCLOSED HOLDING TANKS & DUMP VALVES. DESIGNED FOR COLD NORTHERN/HOT SOUTHERN CLIMATES

Northwood builds true 4-Season Coaches. Our fully insulated holding tank area circulates warm air around the suspended tanks providing the best protection from freezing. Our knife valves are also enclosed to keep them from freezing. Our 4-Season coaches are insulated with various types of residential quality *Rigid Foam, *Batten & *Reflective Foil insulation to protect you from the winter cold & summer heat.



Silver Fox Edition

Travel Trailers



32A - Crystal Onyx

- Gray Fiberglass Cap w/ Integrated LP Cover
- 12 Volt Power Jack
- Chassis Mounted Spare Tire Carrier
- Slam Latch, 1" Thick, Luggage Doors
- Tru-Rest Memory Foam Mattress
- Telescoping Lighted Vanity Mirror
- Bedroom Starlight with Shade
- Antique Glazed Kitchen Cabinetry
- Keyless Entry Door
- Ozite Ceiling Liner
- Solid Surface Counter Tops

Silver Fox Edition

Travel Trailers



GVWR: 10,400 Dry Weight: 7,200
 Length: 28' 5" Width: 8' 0" Height 11' 2"



GVWR: 10,400 Dry Weight: 7,225
 Length: 28' 8" Width: 8' 0" Height 11' 2"



GVWR: 10,400 Dry Weight: 8,265
 Length: 32' 0" Width: 8' 0" Height 11' 3"



GVWR: 10,400 Dry Weight: 8,140
 Length: 32' 4" Width: 8' 0" Height 11' 3"

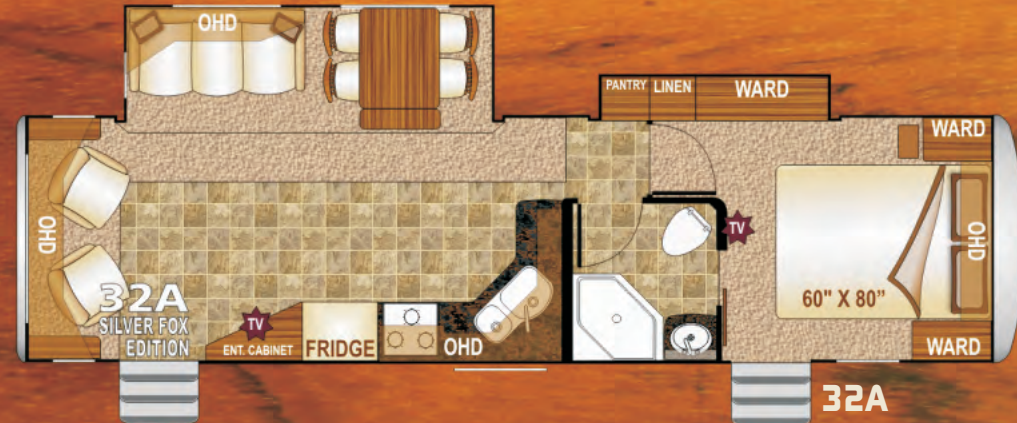

GVWR: TBA Dry Weight: TBA
 Length: 34' 4" Width: 8' 0" Height 11' 3"



Silver Fox Edition

5th Wheels



- Gray Fiberglass Front Cap
w/ Turning Radius
- Exterior Convenience Center
- Certified Store More Chassis
- Slam Latch, 1" Thick, Luggage Doors
- Keyless Entry Door
- Wide Body Construction
- Solid Surface Counter Tops
- 6'6" Main Floor Slideouts
- Tru-Rest Memory Foam Mattress
- Ultra Deck Sleep System
- Antique Glazed Kitchen Cabinetry

29-5R Shimmering Sands

Silver Fox Edition

Fifth Wheels

CERTIFIED CHASSIS



PACIFIC WEST ASSOCIATES, INC

UTILIZING AEROSPACE INTERFACE GRID TECHNOLOGY DESIGN ANALYSIS FOR OPTIMUM PERFORMANCE AND SAFETY

BUILT BY NORTHWOOD



NW

ALL CONDITIONS UNIT

FOUR SEASON



GVWR: 13,945 Dry Weight: 11,245
Length: 31' 3" Width: 8' 6" Height 13' 0"

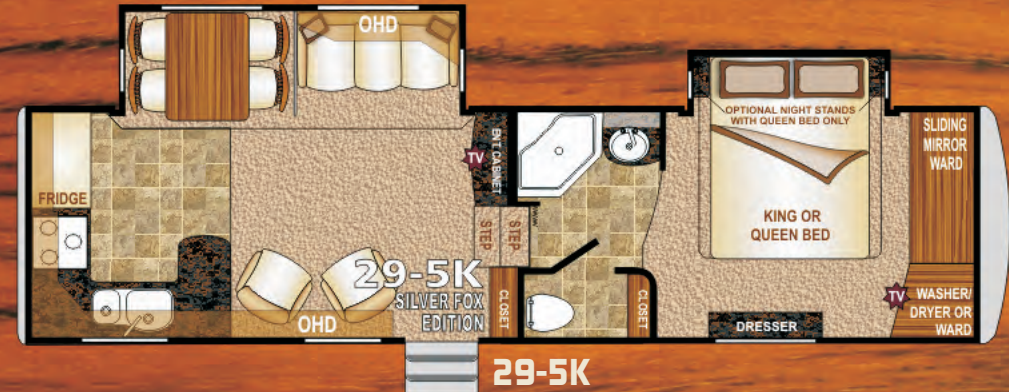

GVWR: 16,900 Dry Weight: 12,120
Length: 33' 11" Width: 8' 6" Height 13' 0"

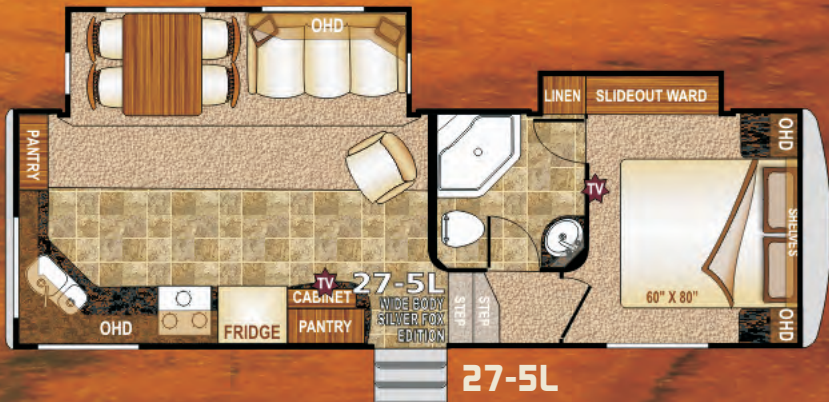

GVWR: 13,900 Dry Weight: 10,210
Length: 28' 1" Width: 8' 6" Height 12' 6"



GVWR: 13,900 Dry Weight: 10,210
Length: 28' 1" Width: 8' 6" Height 12' 6"

Arctic Fox 'Fox Talk'



Left: Walnut Hills Campground in Stuarts Draft, VA. Stuarts Draft is about 20 miles outside of Charlottesville, VA in middle of the Blue Ridge Mountains. Steve and Bonnie Zimmerer, Canton, MS.

Left: "In 10 years of use our 2002 25R has followed our 4x4 Dodge wherever we have gone, on and off the pavement. It has aged better than we have! Thanks for a great product and wonderful, personal service, Northwood!"

We've been Northwood owners since 1996 with our Nash 26J.

We sold it in 2002 for a new 25R. At our age we probably won't be in the market for another trailer, although I want the new Nash 23D!

Linda and Dave Wiley ~ Sublimity, Oregon

In 2009 we towed our 29V over 3000 miles of the northernmost roads in North America – all unpaved primitive roads—in addition to the usual Alaska Highway stuff. The trailer experienced only trivial problems even though the trip killed our Chevy 2500HD Duramax/Allison.



The Arctic Circle on the Dempster Highway



Left: Our campsite...
...a few miles north of Atigun Pass on the Dalton Highway, Alaska.

Right: We currently have a Arctic Fox 24-5N .





'Arctic Fox trailers are the best for all weather Fishing. I always catch bigger Fish when I'm in my Arctic Fox!' Started with a 2009 Arctic Fox 22H. Loved it so much we upgraded to the 30U. We like to dry camp right at the rivers edge all year round. The Arctic Fox keeps us warm colder months and cool in the Summer. There is enough room for me, my wife, 2 dogs and all the fish! Thanks for a great product,

Art & Joanne Host



Our purchase of a 2007 22H Arctic Fox has proven to be great decision. The quality of the Arctic Fox out-performs any other new unit I've seen or researched. Thanks, Bretan Baumgardt Calgary, AB

Travel Trailers

Laura and I have owned 3 Northwood products now. We started with a 2006 Nash 25S, moved to a 2007 AF 29V and then last year had the chance to move up to our dream rig a Arctic fox 365V. We have always been very impressed with the build quality, and the fit and finish on the Arctic Fox is 2nd to none! We make 2 trip to Phoenix AZ from Springfield OR for the NASCAR races and camp at the track with our friends who also have a Arctic Fox (29 5E). The pictures are from our Nov. 2010 trip to the track. We love our Fox and always look forward to spending time camping in it no matter where we go.

Scott and Laura Lahey, Springfield, OR



We enjoyed our trouble free AF24-5N for 5 years. So when it was time to upgrade the decision was simple: May I present our 2011 AF27-5L. Oh by the way, we just exceeded 6,000 miles and everything is working just fine!

Jay & Jackie Yake ~ Bend, Oregon

....and of course "Ping" the Border Collie

5th Wheels

Below: Holiday Harbor RV Park and Marina in Hilton Head, SC. We travel extensively in our 27-5L and absolutely love our time in our home away from home. Steve and Bonnie Zimmerer, Canton, MS.



Aluminum SuperStructure



32-5M



25W

Classic

Silver Fox Edition



27-5L



Arctic Fox - Standard Features

Laminated Aluminum Frame Construction
 Fiberglass Front Cap w/Integrated LPG Tank Cover
 4 Season All Weather Package
 Front Security/Convenience Lights
 Reflective Foil Insulation in Slideout Floors
 R-18 Roof Insulation (plus Reflective Insulation)
 Flat Screen LCD TV
 Carefree Travel'R 12 Volt Power Awning
 AM/FM-CD/DVD Player w/ Int. & Ext. Speakers
 Aluminum Wheels
 Deep Tint Windows
 Decorative Wall Clock
 Residential Style Furniture

Shock Absorbers on All Four Wheels
 Stabilizing Jacks
 Roof Rack and Ladder
 Solid Wood Drawer and Door Fronts
 Deluxe Slideout Flange Treatment
 Upgraded Interior Fabrics and Styling
 Oil Rubbed Bronze Décor Light Fixtures
 Pleated Privacy/Night Shades
 Fantastic Fan
 Kitchen Skylight with Shade
 Porcelain Marine Toilet w/ Foot Pedal
 Bath Skylight- DSI Gas/Electric Water Heater
 Retractable Shower Screen or Glass Enclosure

Tru-Rest Memory Foam Mattress
 Designer Bedspread w/ Pillow Shams
 Digital TV Antenna
 Galley Fluorescent Light
 Park TV Cable Jack
 Pre-Wired for Satellite & Solar Panel
 Microwave Oven
 Large Exterior Entry Assist Handle
 LED Running and Tail Lights
 12 Volt Disconnect Switch
 Interior Command Center
 Beauflor Durable Floor Covering
 Cargo Netting Inside Wardrobe

Silver Fox Edition -Additional Enhancements

Gray Front Cap w/ Integrated LPG Tank Cover
 10 Gal. DSI Gas/Electric Water Heater
 Antique Glazed Kitchen Cabinetry
 Chassis Mount Spare Tire Carrier
 Variable Recessed Halogen Light
 Low Profile Fluorescent Lights
 Telescoping Lighted Vanity Mirror
 Decorative Iron Décor Items
 Custom Designer Back Splash

Keyless Entry
 Ozite Ceiling Liner
 12 Volt Power Jack
 8, 10 & 12 Cubic Foot Refers
(Std or Opt in certain model - See your dealer)
 16" Aluminum Wheels
 Slam Latch Luggage Doors
 Molded Rear Fiberglass Cap
 Solid Surface Counter Tops
 Bedroom Starlight with Shade

5th Wheel Exclusives

Gray Front Cap with Turning Radius
 Wide Body Construction
 Certified Store More Chassis
 6'6" Slideout Height on 30 Ft & Larger
 Ultra Deck Sleep System
 Exterior Convenience Center
 Generator Ready



Classic

Silver Fox Edition

Description

Description	Arctic Fox Travel Trailers								Arctic Fox 5th Wheel Models						
	22G	22H	25P	25R	25S	25W	25Y	26X	27T	29L	30U	27-5L	29-5K	29-5T	32-5M
Model Number	22G	22H	25P	25R	25S	25W	25Y	26X	27T	29L	30U	27-5L	29-5K	29-5T	32-5M
Dry Axle Weight (approx. Lbs.)	4500	4455	5900	5835	4690	6088	6265	6200	6325	7205	7075	8255	9220	8930	9880
Dry Hitch Weight (approx. Lbs.)	550	595	860	650	570	775	785	1000	900	1060	1065	1955	2900	2315	2600
Net Carrying Capacity	2450	2450	3240	3515	2740	3137	2950	3200	3175	2135	2260	3690	4780	3755	4120
Gross Dry Weight-lbs (approx. Lbs.)	5050	5050	6760	6485	5260	6863	7050	7200	7225	8265	8140	10210	12120	11245	12480
Gross Vehicle Weight Rating (GVWR)-Lbs.	7500	7500	10000	10000	8000	10000	10000	10400	10400	10400	10400	13900	16900	15000	16600
Exterior Length (approx. w/hitch)	23'10"	23'10"	27'1"	27'3"	26'11"	29'6"	30'	28'5"	29'8"	32'	32'4"	28'1"	33'11"	32'5"	34'11"
Exterior Height (approx. incl. AC unit)	10'3"	10'2"	10'11"	10'8"	10'3"	10'11"	10'11"	11'2"	11'2"	11'3"	11'3"	12'6"	13'	13'	13'
Exterior Width (approx. w/o awning)	8'6"	8'6"	8'6"	8'6"	8'6"	8'6"	8'6"	8'	8'	8'	8'	8'6"	8'6"	8'6"	8'6"
Tire Size	ST205 75R15	ST205 75R15	ST225 75R15	ST225 75R15	ST205 75R15	ST225 75R15	ST225 75R15	ST235 80R16	ST235 80R16	ST235 80R16	ST235 80R16	ST235 80R16	ST235 85R16	ST235 80R16	ST235 85R16
Load Range	C	C	D	D	C	D	D	E	E	E	E	E	G	E	G
Fresh Water Capacity (approx gal)	44	46	50	58	58	58	47	67	66	67	67	76	82	75	82
Gray Water Tank (approx. gallons)	41	41	40/35	41	41	35/35	47	30/25	54	35/25	54	35/35	72/35	50	72
Black Water Tank (approx. gallons)	35	35	35	35	35	35	36	44	42	44	42	35	65	35	65
LPG Capacity (approx. gallons)	14	14	14	14	14	14	14	14	14	14	14	20	20	20	20
CSA - Canadian Dealers Only	YES	YES	YES	YES	YES	YES	YES	YES	YES	YES	YES	YES	YES	YES	YES
Auto Ignition Furnace (1,000 BTU's)	25	25	25	25	25	30	30	30	30	30	30	35	35	35	35

ABSOLUTE NORTHWOOD

Our Guarantee of
 ✓ Quality
 ✓ Strength
 ✓ Durability

