



DURANGO



Come
home
to KZ!



Durango 1500



A true half-ton towable, these fifth wheels are beautifully appointed for all your travels, whether a weekend get-away or long-term excursion. See pages 3-4.



Optional Full Body Sandlewood Package



Optional Partial Paint Package

Durango



Created for the experienced traveler, KZ comfort and convenience surrounds you while discovering the great outdoors in these full profile fifth wheels. See pages 6-7.



Optional Full Body Sandlewood Package



Optional Partial Paint Package

Durango 1500



D295CS Shale Décor

D295CS Two slide-outs provide a generous living space featuring a sofa, two chairs, 32" LCD TV and optional table and chairs. Overhead cabinetry, side table between recliners and corner entertainment center offer storage space for all your traveling needs.



D296BH Shale Décor

D296BH Sleeping space for all your family and friends with convertible dinette, queen bed and triple rear bunks. Optional rear entry door offers easy access to second restroom for kids with wet swimsuits or muddy feet.



Durango 1500

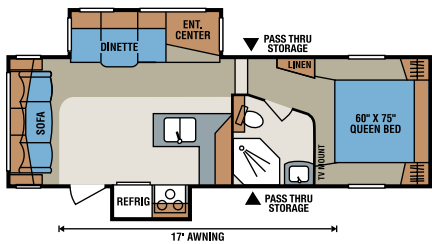

D245SB • Wardrobe Closet Slide Option available

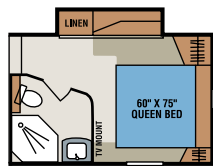

D245SB
Wardrobe Closet Slide Option

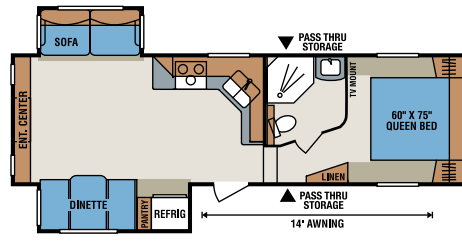

D275RE

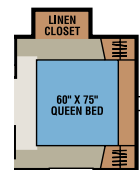

D275RE
Wardrobe Closet Slide Option

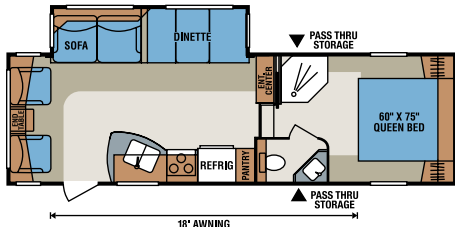

D275RL • Wardrobe Closet Slide Option available

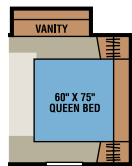

D275RL
Wardrobe Closet Slide Option

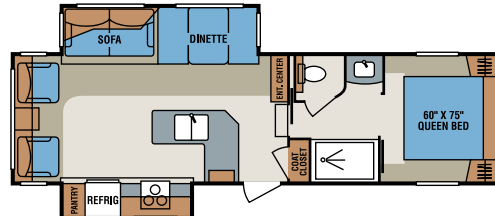

D2857 • Wardrobe Closet Slide Option available

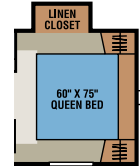

D2857
Wardrobe Closet Slide Option

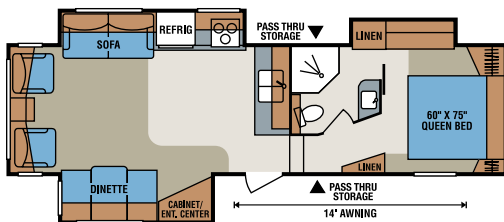

D295CS

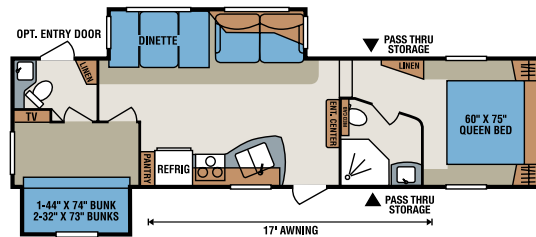

D296BH

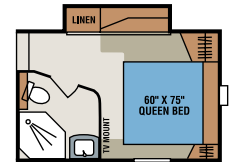

D296BH
Wardrobe Closet Slide Option

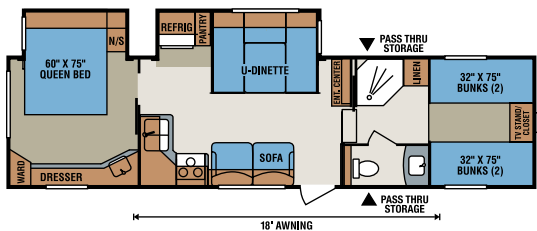

D305BH

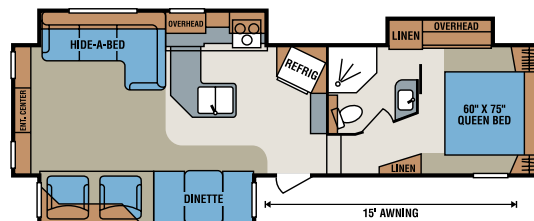

D326CS

FIFTH WHEELS	D245SB	D275RE	D275RL	D2857	D295CS	D296BH	D305BH	D326CS
UVW (Unloaded Vehicle Weight) *	7,122	7,273	7,196	8,121	8,143	8,183	8,170	8,780
Dry Hitch Weight*	1,317	1,206	1,105	1,170	1,375	1,208	1,305	1,380
Dry Axle Weight*	5,805	6,067	6,091	6,951	6,768	6,975	6,865	7,400
NCC (Net Carrying Capacity)	2,103	1,952	2,029	2,029	2,007	1,967	1,980	2,020
GVWR	9,225	9,225	9,225	10,150	10,150	10,150	10,150	10,800
Exterior Height	145"	143 ½"	144"	144"	143"	142"	142 ½"	144"
Exterior Width	96"	96"	96"	96"	96"	96"	96"	96"
Exterior Length	27' 11"	29' 8"	29' 4"	31' 8"	31' 11"	33' 11"	34' 1"	34' 3"
Refrigerator (cu. feet)	6	6	6	6	6	6	6	6
Water Heater Cap. (gal. G/E w/DSI)	6	6	6	6	6	6	6	6
Fresh Water Cap. (gal.)	55	55	55	55	55	55	55	55
Waste Water Cap. (gal.)	32	32	32	32	32	32	32	32
Gray Water Cap. (gal.)	32	32	32	32	32	64	32	32
LP Gas Cap. (lbs.)	60	60	60	60	60	60	60	60
Furnace BTUs (1,000s)	30	30	30	30	30	30	30	35
Tire Size	15"	15"	15"	15"	15"	15"	15"	15"
Awning	16'	14'	18'	15'	14'	17'	18'	14'

*This weight reflects the rolling average unit weight for each model. Your trailer weight will vary according to optional equipment.



- 1 13,500 BTU A/C
- 2 1 piece seamless roofing material
- 3 3/8" decking
- 4 Vinyl interior ceiling panel
- 5 4 3/8" truss rafter, 16" O.C.
- 6 R-14 batten insulation
- 7 Insulated ductwork
- 8 Exterior clearance and brake lights
- 9 One-piece fiberglass front cap
- 10 Expanded Polystyrene – R-9

- 11 Fiberglass exterior with integrated luan backing
- 12 1/8" luan decorative wall board
- 13 1/8" luan wall board
- 14 2" aluminum framed sidewall
- 15 Residential style ducted heat run in floor
- 16 Darco® moisture barrier
- 17 Large capacity pass-thru storage with bus style slam latch doors
- 18 Heavy duty I-beam frame construction
- 19 R-7 batten insulation
- 20 2x3 floor joist, 16" O.C.
- 21 Heated & enclosed underbelly
- 22 Insulated and heated water tanks
- 23 Fully welded outriggers

- 24 5/8" tongue & groove plywood
- 25 Heavy duty leaf springs
- 26 Heavy duty steel wheels
- 27 Residential style carpet pad
- 28 Rack and pinion electric slide with manual override with 2x2 tube slide out ram
- 29 Residential carpet or linoleum
- 30 Tinted safety glass windows
- 31 Triple sealed slide outs
- 32 Exterior security/Scare lights
- 33 Snap jacks pull pins
- 34 Extra long drip spouts
- 35 Satellite preparation
- 36 Exterior speakers
- 37 16" tires (15" on D285RL, D315RE and all Durango 1500 floorplans)
- 38 Drop bi-level frame (N/A on Durango 1500)
- 39 Spare tire/carrier/cover (Optional on Durango 1500)
- 40 Bedroom Slide (Optional on D245SB, D275RE, D275RL, D2857, and D296BH)
- 41 Dexter **NEV-R-ADJUST™** Brakes



Coach-Net®

RV Membership Plans

*One Year **FREE**
Road Side Assistance
courtesy of KZ!*

Durango



D336RE Shale Décor



D336RE A residential-style kitchen awaits you in this new floorplan. Standard solid wood raised panel cabinetry, large refrigerator, ceiling fan and solid surface countertops highlight the wrap-around peninsula offering plenty of storage and counter space. Amenities abound with two chairs, L-shape hide-a-bed sofa, coordinating sofa pillows and optional table with 4 chairs.



D331RK Relax in the living room featuring a 32" LCD TV and optional fireplace. Enjoy a view of the outdoors while cooking in this rear kitchen, accentuated with windows over the sink and cooktop.



D331RK Shale Décor

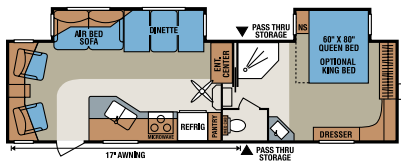

D285RL

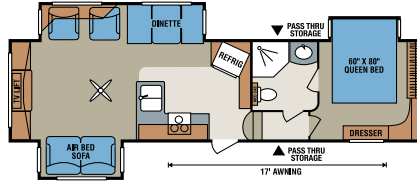

D315RE

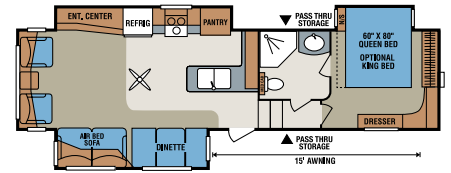

D325CK

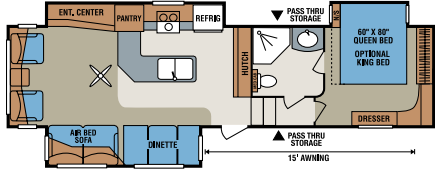

D325RL

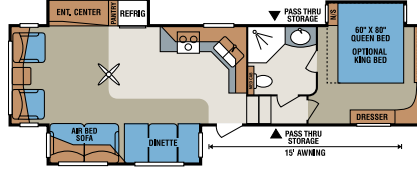

D325SB

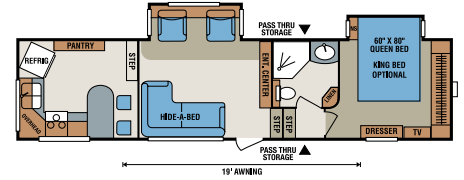

D331RK

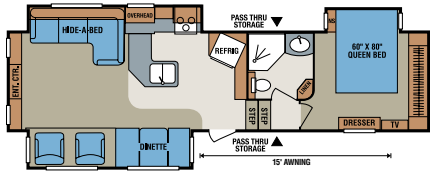

D336RE

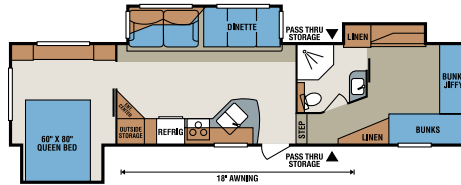

D345BH

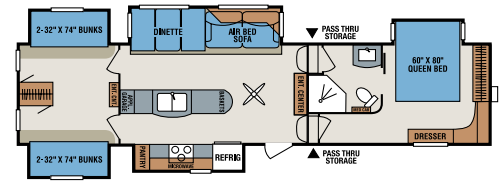

D355BH

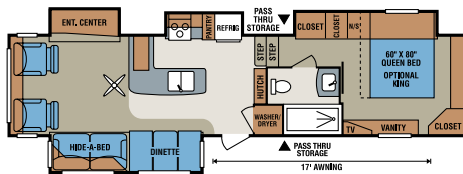

D355RL

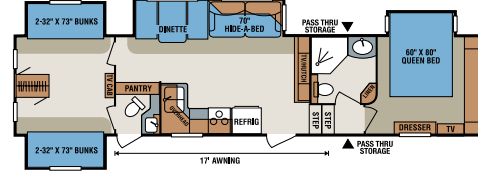

D358BH

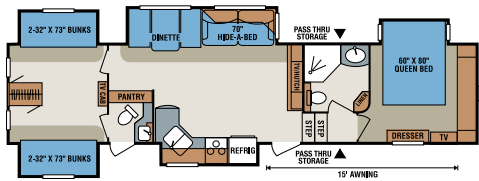

D358BHK

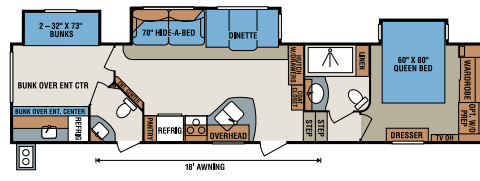

D365BH

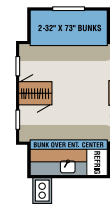

Outside Kitchen Option

Available on D355BH,
D358BH and D358BHK.

FIFTH WHEELS	D285RL	D315RE	D325CK	D325RL	D325SB	D331RK	D336RE	D345BH	D355BH	D355RL	D358BH	D358BHK	D365BH
UVW (Unloaded Vehicle Weight)*	8,750	9,769	10,046	10,071	9,878	9,740	10,070	10,162	11,344	10,784	10,980	11,677	10,920
Dry Hitch Weight*	1,943	1,846	1,930	1,956	1,888	1,880	1,830	1,900	1,914	1,930	2,010	2,101	2,030
Dry Axle Weight*	6,807	7,923	8,116	8,115	7,990	7,860	8,240	8,262	9,430	8,854	8,970	9,576	8,890
NCC (Net Carrying Capacity)	2,050	2,531	2,454	2,429	2,622	2,760	2,430	2,538	2,506	2,616	2,420	2,723	2,480
GVWR	10,800	12,300	12,500	12,500	12,500	12,500	12,500	12,700	13,850	13,400	13,400	14,400	13,400
Exterior Height	156"	156"	156"	151"	156"	148"	153"	156"	158"	158"	153"	156"	12' 8"
Exterior Width	96"	96"	96"	96"	96"	96"	96"	96"	96"	96"	96"	96"	96"
Exterior Length	31' 2"	34' 8"	35' 2"	35' 2"	35' 2"	37' 0"	34' 9"	37' 5"	39' 5"	37' 6"	39' 8"	39' 8"	40' 2"
Refrigerator (cu. feet)	8	8	8	8	8	8	8	8	8	8	8	8	8
Water Heater Cap. (gal. G/E w/DSI)	12	12	12	12	12	12	12	12	12	12	12	12	12
Fresh Water Cap. (gal.)	55	55	55	55	55	55	55	55	55	55	55	55	55
Waste Water Cap. (gal.)	57	57	57	57	57	57	57	57	40	57	85 ½	57	57
Gray Water Cap. (gal.)	57	57	57	57	57	57	57	57	80	57	85 ½	114	114
LP Gas Cap. (lbs.)	60	60	60	60	60	60	60	60	60	60	60	60	60
Furnace BTUs (1,000s)	30	30	30	30	30	35	30	35	35	30	35	35	35
Tire Size	15"	15"	16"	16"	16"	16"	16"	16"	16"	16"	16"	16"	16"
Awning	17'	17'	15'	15'	15'	18'	15'	18'	17'	17'	17'	16'	18'

*This weight reflects the rolling average unit weight for each model. Your trailer weight will vary according to optional equipment.

Ruby Décor

Shale Décor

Walnut Décor

Standards

Stabilizer Jacks
One-Piece Aerodynamic High Gloss Fiberglass Front Cap
Awning with Drip Rail and Spouts
Microwave with Turn Table
13,500 BTU Ducted A/C
Enclosed Pin Box
Security Light
6 Gallon Gas/Electric DSI Water Heater (Durango 1500 Only)
12 Gallon Gas/Electric DSI Water Heater (N/A on Durango 1500)
Skylight Over Tub
Pillows for Sofa
Wire for Satellite
Heated Tanks and Enclosed Underbelly
Tinted Safety Glass Windows
Black Tank Flush System
Power Jacks
6 Cubic Foot Refrigerator with Raised Panel Wood Insert (Durango 1500 Only)
8 Cubic Foot Refrigerator with Raised Panel Wood Insert (Optional on Durango 1500)
32" LCD TV
Assist Grab Handle
Night Shades
AM/FM/CD/DVD Player with USB Port
Porcelain Toilet
Outside Speakers
Innerspring Mattress
Roller Ball Bearing Drawer Guides
Dexter **NEV-R-ADJUST™** Brakes
Gas Struts on Bed Base
Outside Shower
Solid Surface Countertops
Decorative Light Above Dinette
Screwless Exterior Moulding
Easy Read Command Center
Bus Style Slam Latch Baggage Doors
Hide-A-Bed (Optional on Durango 1500, forced on D326RE)
Bedroom Slide (Optional on D245SB, D275RE, D275RL, D2857, and D296BH)

16" tires (15" on D285RL, D315RE, and all Durango 1500 floorplans)
Spare Tire/Carrier/Cover (Optional on Durango 1500)
Drop Bi-Level Frame (N/A on Durango 1500)
Wire for A/C in Bedroom (N/A on Durango 1500)
Ceiling Fan (N/A on Durango 1500)
2 Halogen Lights Above Sofa (N/A on Durango 1500)

Options

Partial Paint Package
King Bed (N/A on Durango 1500)
Table and 4 Chairs with Leaf
Recliners – 1 or 2
Jiffy Sofa in Bunk Slide (D296BH, D355BH, D358BH, and D358BHK Only)
2 Barrel Chairs IPO Sofa (D245SB Only)
Entry Door in Bathroom (D296BH Only)
Fireplace (N/A on D275RL)
Dyson® Vac
Fan-Tastic Vent® (Bedroom and Bathroom)
50 Amp Service (N/A on Durango 1500)
Glass Shower Door (D2857, D355RL, and D365BH Only)
Closet Wardrobe Slide (Standard on Durango 2500, Optional on D245SB, D275RE, D275RL, D2857, and D296BH)
15,000 BTU A/C (IPO 13,500 BTU)
2nd 13,500 BTU A/C in Bedroom (N/A on Durango 1500)
Dual Pane Windows (N/A on Durango 1500)
Ladder
Bike Rack/Cargo Tray
Power Awning
Aluminum Wheels (4)
Dexter E-Z Flex® Heavy Duty Rubber Suspension
Power Rear Jacks (N/A on Durango 1500)
4 Point Leveling System (N/A on Durango 1500)
Remote for 4 Point Leveling System (N/A on Durango 1500)

Outside Grill
Sidewinder Hitch
Winegard Dome Satellite (N/A on Durango 1500)
19" Bedroom TV (N/A on Durango 1500)
Residential Refrigerator (D315RE and D324IK Only)
Katching ZZ's Mattress Upgrade
High Gloss Fiberglass (N/A on Durango 1500)
Washer/Dryer Prep. (D355RL and D365BH Only)
Lighted Power Awning
Radiant Technology, calculated reflective value of R38
Outside Kitchen Option (D355BH, D358BH, and D358BHK Only)
Sandlewood Exterior
12V LED Light Package

Premium Package (N/A on Durango 1500)

Dyson® Vac
Fireplace (Where Available)
Recliners – 2 (Where Available)

Luxury Package (N/A on Durango 1500)

Aluminum Wheels with 16" Tires
Dexter E-Z Flex® Heavy Duty Rubber Suspension
Ladder
15,000 BTU A/C
Wire for 2nd A/C in Bedroom
50 Amp Service
12 Gallon Gas/Electric DSI Water Heater
Power Awning
Fan-Tastic® Fan with Remote
Innerspring Mattress
Table and 4 Chairs with Leaf

Road Trip Package (Durango 1500 Only)

Aluminum Wheels
Dexter E-Z Flex® Heavy Duty Rubber Suspension

Spare Tire/Carrier/Cover
8 Cubic Foot Refrigerator
Innerspring Mattress
Ladder
Power Awning

Premium Package (N/A on Durango 1500)

Dyson® Vac
Fireplace
Recliners – 2

Luxury Package (N/A on Durango 1500)

Aluminum Wheels with 16" Tires
Dexter E-Z Flex® Heavy Duty Rubber Suspension
Ladder
15,000 BTU A/C
Wire for 2nd A/C in Bedroom
50 Amp Service
12 Gallon Gas/Electric DSI Water Heater
Power Awning
Fan-Tastic® Fan with Remote
Innerspring Mattress
Table and 4 Chairs with Leaf

Road Trip Package (Durango 1500 Only)

Aluminum Wheels
Dexter E-Z Flex® Heavy Duty Rubber Suspension
Spare Tire/Carrier/Cover
8 Cubic Foot Refrigerator
Innerspring Mattress
Ladder
Power Awning

New Style
Utility Center



Dealer Satisfaction Index: Ratings of manufacturers, by dealers, have consistently awarded KZ top honors for excellence of design, reliability, overall quality and value, communications and dealer support.

ASK ABOUT OUR 2-YEAR LIMITED WARRANTY!



Join our Family Forum at
www.kzfamforum.com

Dealer:



Portions of this brochure were used with the expressed authority of Dexter Axle, but Dexter Axle is not responsible for the accuracy of the information contained herein.

For more product details and in-depth information, visit us at www.kz-rv.com |



0985 N 900 W • Shipshewana, IN 46565
E-mail kz@kz-rv.com • www.kz-rv.com



Due to continual research and advances, manufacturer reserves the right to change specifications, design, price and equipment without notice, and assumes no responsibility for any error in this literature. Some items shown are not included as standard or optional equipment. ©2012KZ | 10/8/12 | 30M