

Welcome to the Outdoors



"Follow the Wind to Your Dreams"



Climate Designed Four Seasons Travel Trailers

- *** All New "Armor Shield" Feather-Light Construction
- *** HD Fiberglass Front Cap with Diamond Plate Protection & LED Lights
- *** Outdoors Climate Designed Four Seasons Package
- *** Outdoors Off Road Tough Package
- *** E-Stone Solid Surface Galley Countertops
- *** Ultra-Sleek Frameless Tinted Windows
- *** XL Fridge (20% More Groceries)





"Follow the Wind to Your Dreams"...



27ORLDS - Crystal Lake Interior

27ORLDS - What a great place to sit back and relax. The two opposing slides make the living space feel huge. Comfortable sleeper sofa with family sized U-shaped dinette, large rear picture window and a 32" 12v LED HD TV that powers up and down into the cabinet behind the optional fireplace - now this is how one should enjoy the "Outdoors".

KITCHEN STORAGE - 22" glass front sealed burner range, pot & pan drawer, XL fridge (20% more groceries), 11 drawers (count them) with metal full extension guides, full size pantry, and the list goes on...also notice the gourmet kitchen cabinetry and picture window...no more bending down to look out the window...the reason we all go camping is to enjoy the Outdoors and now while preparing meals for the family the Outdoors is right in front of you!

THE BATHROOM - The WindRiver does not take shortcuts even in here...notice the built-in wood medicine cabinet, bathroom hairdryer, porcelain toilet, glass shower enclosure and even this model has the popular side aisle bathroom with two separate entrances...full function bathroom is an understatement!



280FKS - Saddle Ridge Interior



28ORLS - Crystal Lake Interior

Welcome to the Outdoors

...with one look at the inside of the **All New** 2013 WindRiver you will see that this RV has been taken to a new level in "Outdoors" comfort. From the stone diagonal flooring, mountain alder cabinetry, ultra leather furniture, E-Stone solid surface galley countertops and the list goes on...

THE BEDROOM – Two full size wardrobes, full length headboard shelf, nightstands on both sides of the bed, three convenient plug-ins, individual bullet reading lights, "Dream Soft" Pillow Top Mattress, bedroom pillows, and incredible under-bed storage...so many RV manufacturers take this part of the RV for granted...not Outdoors RV – we are active users of the products we produce and this was one area we knew was extremely important to the seasoned RVer!

FRONT KITCHEN – Now this is a kitchen you would not expect in a travel trailer.

The counter space and storage is simply amazing. The living room has a comfortable sleeper sofa, ultra leather lounge recliner, thermal insulated living room skylight, 32" 12v LED HD TV, and if you spec in the optional fireplace your friends and neighbors will be knocking on your door to relax with you.

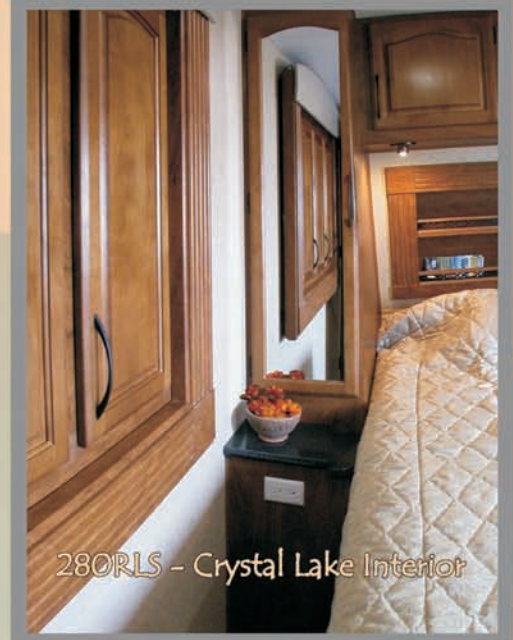

280RLS – Crystal Lake Interior



280FKS – Saddle Ridge Interior



250RLSW – Saddle Ridge Interior



280RLS – Crystal Lake Interior

ENTERTAINMENT AREA – 32" 12v LED HD TV with iPod docking station, DVD system, sub woofer, home theatre speakers and even an optional cozy living room fireplace (most models). Add in the comfort style sleeper sofa, thermal insulated skylight with shade, energy saving LED lights and ultra leather residential comfort style lounge recliners with three panoramic picture windows (250RLSW, 280RLS) and you have a wonderful place to enjoy the beautiful scenery from.... Today's luxury RV buyer desires comfort and amenities just like home and with the 2013 WindRiver they will be able to sit back, relax and take in all that our backyard "The Outdoors" has to offer.

Wind River



FOR MORE INFO
SCAN HERE

New Floorplan



Wind River

2013

"Follow the Wind River
to Your Adventure"



Dimensions & Capacities

	240RKSW	250RDSW	250RLSW	270RLDS	280FKS	280RLS
Full Featured Dry Weight (lbs)	7150	TBA	6800	7500	7300	7800
Cargo Carrying Capacity (lbs)	1750	TBA	1900	1900	1900	2195
Hitch Dry Weight (lbs)	650	TBA	675	910	950	1080
Maximum Trailer Weight	8900	TBA	8700	9400	9200	9995
Length (including hitch)	29'10"	TBA	29'8"	31'11"	32'8"	34'4"
Height (including A/C)	10'11"	10'11"	10'11"	10'11"	10'11"	10'11"
Fresh Water Holding Tank (gal)	66	66	66	66	66	66
Grey Water Holding Tank (gal)	40/40	40	40	40	40/40	40/40
Black Water Holding Tank (gal)	40	40	40	40	40	40
Propane Capacity (lbs)	60	60	60	60	60	60
Heavy Duty 6 Lug Axles (lbs)	5200 (2)	5200 (2)	5200 (2)	5200 (2)	5200 (2)	5200 (2)
Goodyear Tire Size (load range)	ST225/ 75 15D	ST225/ 75 15D	ST225/ 75 15D	ST225/ 75 15D	ST225/ 75 15D	ST225/ 75 15D

*All dry weights are calculated on full featured production units

*Verify the towing capacity of your tow vehicle. If you don't know or aren't sure, you can ask your automotive dealership or contact your tow vehicle manufacturer.

*All weights above are average approximations and may vary. Weights are calculated before adding options.

*Specifications are subject to change without notice.

River

and
Dreams™

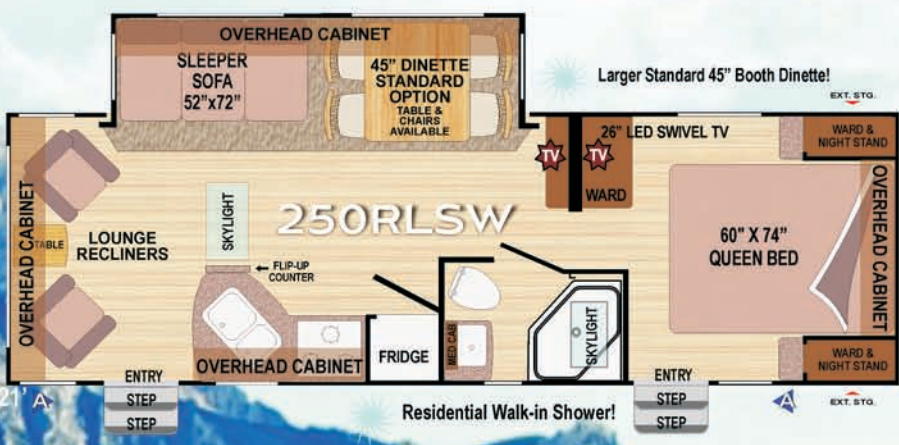

STANDARD ON ALL MODELS

Welcome to the Outdoors

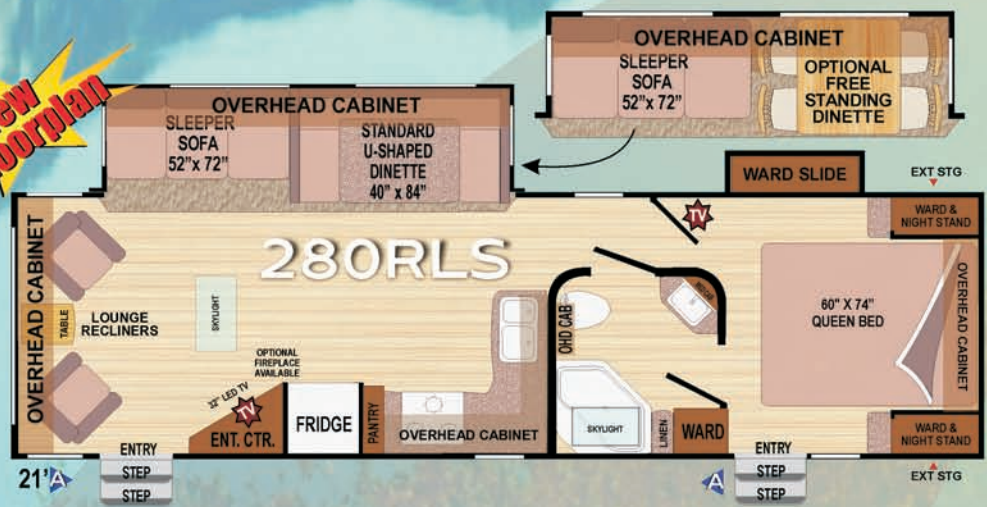

Standard

Interior – Throughout

- * E-Stone Solid Surface Galley Countertops
- * 26"-32" 12v LED HD TV with DVD Home Theatre System
- * Surround Sound Ceiling Mount Speakers & Sub Woofer
- * All In One Universal Command Center
- * Norcold XL Fridge with Hardwood Front Panels (20% More Groceries)
- * Thermal Insulated Dual Pane Living Area Skylight with Shade
- * XL Dinette Drawer System
- * XL Full Extension Metal Drawer Guides (all drawers)
- * Two Tone Day / Night Shades – Living Room & Bedroom
- * Halogen Ceiling Lights
- * Bullet Reading Lights (Sofa, Chairs, Bedroom)
- * Real Hardwood Cabinet Doors
- * Full Width Slide-Out Overhead Cabinets
- * Hardwood Slide-Out Corner Plinths
- * Cross Ventilation Slide-Out End Wall Windows
- * Comfort Style Sleeper Sofa (where applicable)
- * Ultra Leather Dinette Seats
- * Comfort Style Ultra Leather Lounge Recliners (where applicable)
- * XL Dinette Drawer System
- * Coleman 13.5 BTU A/C, Microwave, TV Ant
- * Single Lever Water Heater Bypass System
- * Welcome to the Outdoors Entry Mat
- * Forced Air-Direct Spark Ignition Furnace w/ Thermostat

Galley

- * Silverware Drawer
- * 22" Glass Front Sealed Burner Range
- * Stainless Steel Backsplash & Knife Rack
- * Rechargeable Flashlight / Night-light

- * Pot & Pan Drawer Under Range
- * Gourmet Kitchen Cabinetry & Kitchen Window (where applicable)
- * Range Cover / Dual Sink Covers with Deep Metal Sink
- * Flip-Up Counter Extension (where applicable)
- * Hi-Rise Chrome Single Lever Kitchen Faucet

Bedroom

- * Fantastic Vent Fan
- * Built-in Storage Headboard (where applicable)
- * "Dream Soft" Pillowtop Mattress
- * Bedroom Pillows
- * Bullet Reading Lights
- * Strut-Assisted Lift-Up Bed Platform with Below Bed Storage
- * Aluminum Frame Bed Construction
- * Two Full Wardrobes, Dual Night-Stands, and Plug-ins

Bath

- * Residential Style Glass Shower Enclosure
- * Wall Mounted Hair Dryer
- * Porcelain Toilet
- * Chrome Showerhead & Faucets
- * Bathroom Window (where applicable)
- * Towel Hooks, Towel Bar(s)
- * Thermal Insulated Dual Pane Shower Skylight
- * Wall Switched Ceiling Light
- * Built-in Wood Medicine Cabinet

Exterior – Throughout

- * Ultra Sleek Frameless Tinted Windows
- * Eco-Friendly Battery Saving Roof Mounted Solar Panel
- * "True Full Size Outdoor Style" BBQ Hookup Bib & Hose (BBQ sold separately)

Standards & Options

- * Adjustable Pitch Electric Awning with Rain Dump Arm
- * Indoor/Outdoor TV Ready
- * Exterior Lighting Package - Security Light, Entry Step, Dump Valve, Luggage Compartments
- * Black Tank Flush

Outdoors "Built Tough"

Construction

- * "Armor Shield" Feather-Light Construction
- * Rigid Lightweight Steel Roof Trusses (Triple Load Bearing Strength)
- * 8 Zone Aluminum Frame (Front, Back, Sides & Floor)
- * Aluminum Framing in Luggage Compartments
- * Aluminum Framing in Bed & Dinette Construction
- * Laminated Fiberglass Construction (Back Wall, 2 Sidewalls plus Exterior Slide-Out Wall)
- * HD Fiberglass Front Cap with Diamond Plate Protection and LED Lights
- * Fiberglass Wall-Cutouts - Dinette Construction - 40% Thicker Cushions
- * Trail-Air Rubberized Suspension System

Outdoors "Off Road Tough"

Package Includes:

- * Custom Built Cambered Off Road Chassis - HD Shock Absorbers
- * Rugged A-Frame - Protected Junction Box Wiring
- * Diamond Plate Wrap Bumper
- * Heavy Duty 6 Lug 5200 LB Axles with Off Road Brake System
- * Off Road High Impact Wheel Skirts - Mud Flaps
- * Laminated Fiberglass Slide-Out Floor
- * Beauflor "Outdoors Tough" Flooring - 7 Layers - Cold Cracking Warranty to -50
- * Roto-Torqued "Outdoors Tough" Real Wood Cabinetry (all cabinets)

- * 15" GoodYear Radial Trailer Approved Tires
- * Safety/Warranty (Heavy Ply D Range)
- * Metal Entry Door & Luggage Door Catches
- * Off Road Clearance Lights
- * Radius Crowned Full Walk-On Roof with Ladder

Options

- * Bedroom LCD TV w/ DVD Player (NA 250RLSW)
- * Living Room Fireplace (N/A 250RDSW, 250RLSW)
- * CSA — 
- * 12v Heat Pad (Fresh Water Tank)
- * "Camping At Your Fingertips" Power Package - Power Tongue Jack, Power Stab Jacks, Wireless Remote



- * "Eco-Friendly" Tankless Water Heater, LED Interior & Exterior Lights



- * "Mountain Extreme" Thermal Pane Windows
- * Bike Rack Receiver Hitch
- * Keyless Entry with Touchpad
- * Eco-Camping 95 Watt Solar Panel System w/30 AMP Controller 
- * Slide-Out Topper Awning(s)
- * Dinette Table & 4 Chairs with Storage (NA 250RDSW)
- * Bedroom Carpet
- * Outdoors RV Spare Tire Cover
- * 2 Ultra Leather Lounge Recliners - Replaces Sleeper Sofa in 250RDSW
- * Tankless Water Heater
- * LED Interior and Exterior Lights



Thermal Pane Windows



Outdoors "Climate Designed Four Seasons" Package

Climate Designed Travel Trailers



Triple Layered Four Seasons Roof Insulation



Fully Enclosed Front to Back Heated Insulated Underbelly Double Mountain Floor Insulation



1" Thick Thermal Insulated Luggage Door Compartments



Insulated Snap Cover for Bedroom Fantastic Roof Vent Fan



Exterior Shower Insulated by 1" Thick Thermal Insulated Luggage Door



15% Larger XL Furnace (Extreme Camping Heat System)

**Climate Designed - Four Seasons Camping
Designed for Mountain States & Western Canada**



R-15 Astro-Foil Roof, Slide-Out Floor, Entire Underbelly, Additional Wrap Around Holding Tanks



"Follow the Wind to Your Dreams"

Wind River

All New "Armor Shield" Feather-Light Construction

Dare to Compare - Why don't others do this? \$\$\$

Roof Construction:

Rigid Light-Weight Steel Roof Trusses

Triple Load Bearing Strength



Aluminum Frame:

Eight Different Areas:
Front, Rear, Sides, Slide-Out Wall, Floor, Bed, Dinette & Luggage Compartments

Laminated High End 5th Wheel Construction:

Back Wall, Both Sidewalls, Slide-Out Walls, 2" Thick Walls for Strength & Insulation

Wind River

 **OUTDOORS RV**
MANUFACTURING

Outdoors RV Manufacturing is located in a picturesque mountain valley of Eastern Oregon. The focus of this company is to design RV's for the NW and Western Canada and merchandise the products through a hand selected group of dealers with the end goal of having our customers enjoy an Outdoor experience like no other.

The NW and Western Canada will be the targeted area for the products produced here. This area has an incredible percentage of people that enjoy the RV lifestyle and why wouldn't they with the Outdoors right outside most people's backdoor. Our goal is not to be the largest manufacturer in the country nor follow market share graphs. We simply want to design and build great RV's.

Here at Outdoors RV the management team has over 260 years of combined RV experience. A few examples:

Jim Croxton - General Manager (28 Years)

Darin Nelson - Sales Manager (19 Years)

Rod Glass - Canadian Sales Manager (26 Years)

Robin Larsen - Canadian Training/Sales (21 Years)

Troy Johnson/Brad Croxton - US Sales (12 Years Combined)

Rick Ewing - Service Manager (33 Years)

Darren Moschkau - Production Manager (32 Years)

Rick Hudson - Asst Production Manager (28 Years)

Karen Evans - Sales Administrator (10 Years)

Paul Christensen - Purchasing Manager (36 Years)

James Baker - Product Development (23 Years)

Wind River



FOR MORE INFO
SCAN HERE

2011 WINNER!

DSI

18th Annual RVDA DEALER
SATISFACTION INDEX

Your Local Outdoors RV Dealer is:

 **OUTDOORS RV**
MANUFACTURING

PO BOX 1047
62582 Pierce Road
La Grande, OR 97850

Phone 541.624.5500
Fax 541.963.2448
www.outdoorsrvmf.com

March 2012- Production information is accurate as of the date of publication of this brochure. Outdoors RV is continuously improving product design features, materials, components and these items are subject to change without notice or obligation to Outdoors RV.