

Launch



- ✓ FRONT DIAMOND PLATE
- ✓ DARK-TINTED, SAFETY-GLASS WINDOWS
- ✓ 6-GAL. WATER HEATER (CUSTOMER CONVENIENCE PKG.)
- ✓ VACUUM-BONDED LAMINATED SIDEWALLS
- ✓ RADIAL TIRES
- ✓ 18,000-BTU FURNACE



STARCRAFT

LAUNCH



- ✓ **AMAZING PRICE**
- ✓ **ONE-PIECE SEAMLESS RUBBER ROOF**
- ✓ **TOWABLE BY MOST MINIVANS***
- ✓ **78" INTERIOR CEILING HEIGHT**

* Consult with your authorized automobile manufacturer and vehicle owners manual.



Launch 16RB



Launch 16RB



Launch 16RB



Launch 18BH

STANDARDS AND OPTIONS

STANDARD CONSTRUCTION FEATURES

2" hitch coupler
78" interior ceiling height
Fully decked roof with 3/8" decking
One-piece seamless roof
Poly Flex one-piece underbelly covering
R-7 insulation in sidewalls, roof and floor
Roof rafters constructed of residential-style tapered 3" trusses
Screwed stile cabinetry with hardwood stiles

STANDARD EXTERIOR EQUIPMENT

20-lb. propane gas bottle
120V G.F.C.I. protected exterior receptacle
AquaShield Aqualon water-repellent sectionalized tent with 7-year warranty (15FD and 16RB)
Bumper with drain hose carrier and end caps
Bunk-end tent permanently attached to bed base (15FD and 16RB)
Cable TV prepped
Crank-up HDTV antenna with signal booster
Electric brakes
Front diamond plate
Front window with flush-mounted stone guard (select models)
Outside storage
Radial tires
Rain guttering, molded with drip spouts

STANDARD INTERIOR EQUIPMENT

2-burner range
54" booth dinette (n/a 16RB)
8,000-BTU A/C
18,000-BTU furnace with auto ignition
Acrylic sink with faucet
Bourbon Glaze beech wood cabinetry
Hardwood cabinet doors
Inside/outside dinette table with folding legs
LED light in bunk area (15FD and 16RB)
Pleated shades
Quilted bunk mats
Range hood with light and exhaust fan
Roof-mounted antenna for radio
Skylight in tub/shower
Sofa with inside storage below (select models)
Systems monitor panel
TuffShell vacuum-bonded laminated sidewalls
Water heater bypass system

CUSTOMER CONVENIENCE PACKAGE

4 cu. ft. refrigerator
6-gal. water heater
Microwave oven with carousel
Patio awning
Rear stabilizer jacks with sand pads
Spare tire with carrier
Stereo with AM/FM and iPod/MP3 connection

OPTIONS

13,500-BTU A/C



AQUASHIELD AQUALON TENTS
Avoid stretching, shrinking or cracking with our mold-resistant, double-stitched AquaShield Aqualon tents, backed by a 7-year warranty (select models).

DURABLE CONSTRUCTION

Our cabinets are handmade with hardwood stiles and screwed construction for increased durability and longer cabinet life.



4 CU. FT. REFRIGERATOR/FREEZER

Thanks to Launch's 4 cu. ft. refrigerator/freezer, you can leave the ice and coolers at home (Customer Convenience Package).

OUTSIDE STORAGE

TRAILER HITCH

LAV BATHROOM SINK

MICRO MICROWAVE

OHC OVERHEAD CABINETS

FRIDGE REFRIGERATOR

WARD WARDROBE

FLOORPLANS

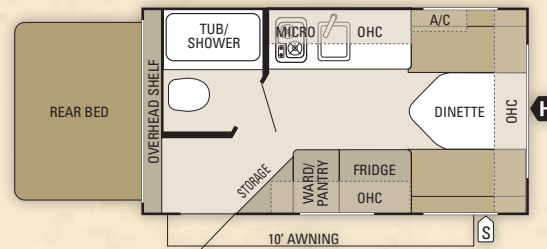

Launch 15FD

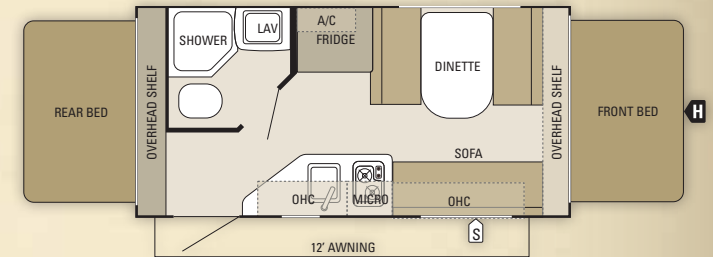

Launch 16RB

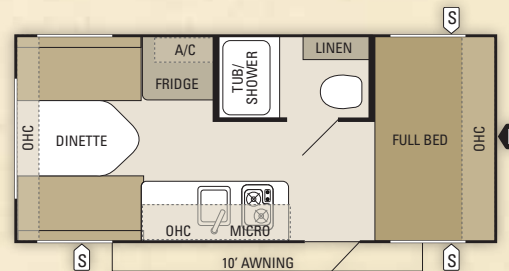

Launch 17FB

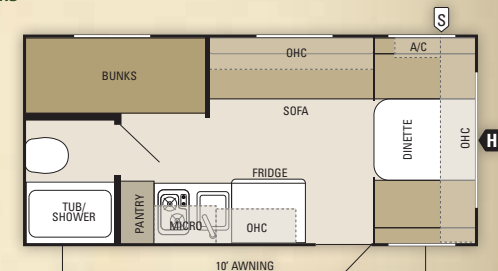

Launch 18BH



SCAN
for a complete list of standards and options,
OR VISIT
starcraftcamping.com

SPECIFICATIONS

Floorplan	Exterior Length	Exterior Height	Exterior Height with opt A/C	Interior Height	Unloaded Vehicle Weight (lbs)	Dry Hitch Weight (lbs)	Cargo Carrying Capacity (lbs)	Fresh Water Capacity (gal) (includes water heater)	Gray Waste Water Capacity (gal)	Black Waste Water Capacity (gal)
15FD	17' 6"	106"	118"	78"	2,435	215	865	16	15	9
16RB	18' 4"	108"	117"	78"	2,585	290	915	16	15	9
17FB	20' 6"	108"	117"	78"	2,670	360	830	26	15	9
18BH	20' 6"	109"	118"	78"	2,655	390	845	26	15	9

UNLOADED VEHICLE WEIGHT (UVW): Sometimes referred to as "Dry Weight," UVW means the typical weight of this trailer as built at the factory. The UVW, as used in product literature and other promotional materials, does not include cargo, fresh water, propane, options or dealer-installed accessories. The weights of certain options and/or option packages are not included in the UVW listed above. **GROSS VEHICLE WEIGHT RATING (GVWR):** GVWR means the maximum permissible weight of the trailer, including the UVW plus passengers, personal items, all cargo, fluids, options, and dealer-installed accessories. The GVWR is equal to or greater than the sum of the UVW and the CCC. **CARGO CARRYING CAPACITY (CCC):** CCC means the maximum weight of all passengers, personal items, food, fresh water, propane, tools, other cargo and dealer-installed accessories that can be carried by the trailer. CCC is equal to or less than GVWR minus UVW. The addition of options will decrease the CCC. **HITCH WEIGHT (HW):** The hitch weight, as used in product literature

and other promotional materials, does not include cargo, fresh water, propane gas, options or dealer-installed accessories. The addition of these types of items will either add to or subtract from the stated hitch weight. It is important for your safety and enjoyment that your tow vehicle be adequately sized and equipped to tow and handle the GVWR of the RV you select. Review weights and rating of your tow vehicle and consult a competent advisor for questions or advice. Whether you are new to RVing or a veteran, get a feel for the performance of your tow vehicle and the RV together before heading out on the roadways. When you tow an RV, you must drive differently than you do when driving a single vehicle. Practice hooking up, driving, backing up and braking in a safe environment or seek out professional instruction. Starcraft affixes a weight label to each RV which lists weight information for that vehicle. See specification chart above.



AIR CONDITIONING
Stay cool with a standard 8,000-BTU air conditioner or turn it up a notch with the optional 13,500-BTU roof A/C.



AM/FM/AUX STEREO SYSTEM
Relax with your favorite music using Launch's handy stereo, offering AM/FM and MP3/iPod inputs.



SIMPLY THE BEST CONSTRUCTION

At Starcraft, we've built a strong reputation for making reliable, durable campers for almost 50 years. We use only the highest-quality materials and state-of-the-art production techniques. **It's this devotion to durability that has helped our company become a recognized manufacturer with a full lineup of affordable towables.** In short, the last thing you have to worry about when you're camping is your camper.



eco advantage™

The Starcraft EcoAdvantage is our company's commitment to protecting the environment. Scan this QR code with your smartphone to watch a video about our efforts and the impact we're making on our planet.

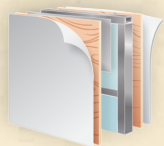

FIBERGLASS WALLS

Launch boasts TuffShell vacuum-bonded lamination, featuring welded aluminum framing, fiberglass sidewalls and metal backers, making it one of the lowest-priced fiberglass travel trailers on the market.



www.starcraftcamping.com

VISIT OUR WEBSITE FOR MORE INFORMATION OR TO FIND A DEALER NEAR YOU.



Warranty

Each Starcraft is warranted to the original purchaser for twelve (12) months from the original date of purchase against defects in materials and workmanship. For a copy of the limited warranty with full terms and conditions, ask your local Starcraft dealer.



Roadside Assistance

Travel worry-free with the complimentary Good Sam Roadside Assistance program, which gives you immediate access to dependable roadside assistance with a simple phone call.



The Value of Your Local Starcraft Dealer

Establishing a solid relationship with your local Starcraft dealer is a key component in the enjoyment of your new Starcraft. By purchasing from a local dealer, you will have a convenient location for sales, parts and service support.

FOLLOW US ON



© Starcraft RV • 536 Michigan St., Topeka, IN 46571
www.starcraftcamping.com

See dealer for further information and prices. All information in this brochure is the latest available at the time of publication approval. Starcraft reserves the right to make changes and to discontinue models without notice or obligation. Photos in this brochure may show optional equipment and props for photography purposes. RV's built for sale in Canada may differ to conform to Canadian codes.