

JAMBOREE® DSL 2013

JAMBOREE SPORT® DSL

CLASS C DIESEL |  FLEETWOOD RV



JAMBOREE® DSL 2013

JAMBOREE SPORT® DSL

JAMBOREE® DSL 2013

FLEETWOOD RV | CLASS C DIESEL



Tungsten

MODERN EFFICIENCY

- Full Swivel Seats Available
- Walk-Around Queen Bed
- Glazed Hardwood Cabinet Doors with Hidden Hinges
 - Soft-Touch Ceiling
 - Flexsteel® Furniture
 - Corian® Countertops
- High-Gloss Exterior Fiberglass
 - Full-body Paint
 - Rear Slide Technology



Concord



Sandrif

LINEN OASIS	LUSTROUS GOLD	MYSTIC MIDNIGHT		CABINETRY
			SATIN SPICE	
			SATIN CHESTNUT	



JAMBOREE® DSL FLOOR PLAN

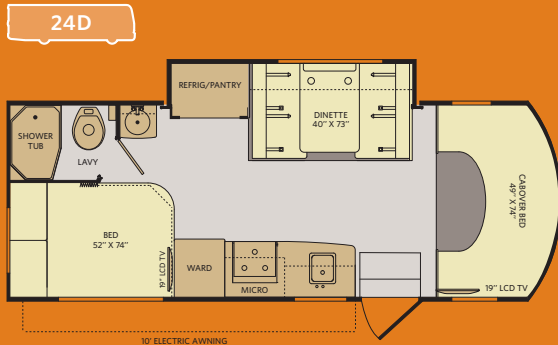

INTERIOR STORAGE CAPACITY: 43 CU. FT.
EXTERIOR STORAGE CAPACITY: 33 CU. FT.

Available Options: 351

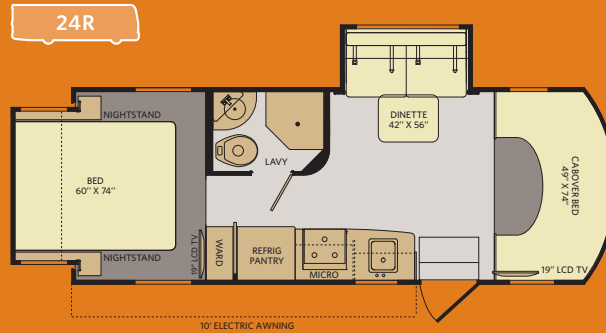

INTERIOR STORAGE CAPACITY: 35 CU. FT.
EXTERIOR STORAGE CAPACITY: 33 CU. FT.

Available Options: 351

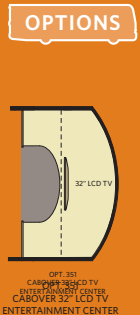

JAMBOREE SPORT® DSL 2013

FLEETWOOD RV | CLASS C DIESEL



Standard

LOW PROFILE EFFICIENCY

- Low Profile Design
- Glazed Hardwood Cabinet Doors with Hidden Hinges
- Soft-Touch Ceiling
- High-Gloss Exterior Fiberglass
- Full Basement Storage
- Flexsteel® Furniture
- Corian® Countertops
- PEX Plumbing System
- Rear Slide Technology

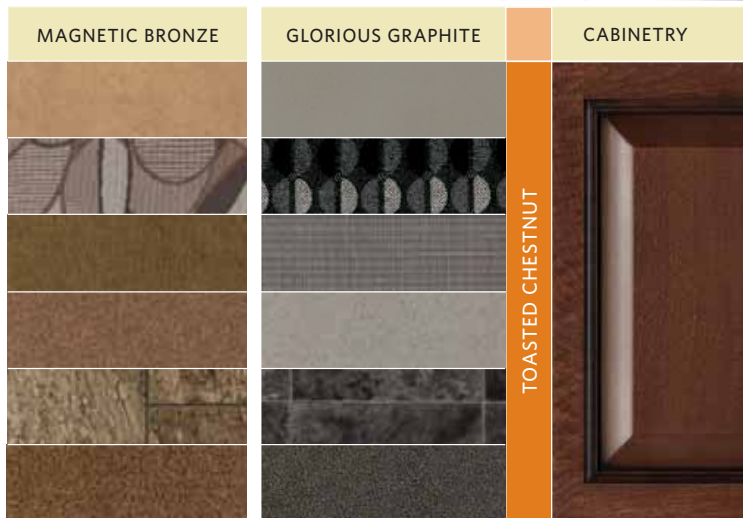

Jamboree® Sport DSL 24L shown in Glorious Graphite interior decor with Toasted Chestnut wood cabinetry



JAMBOREE® SPORT DSL FLOOR PLAN

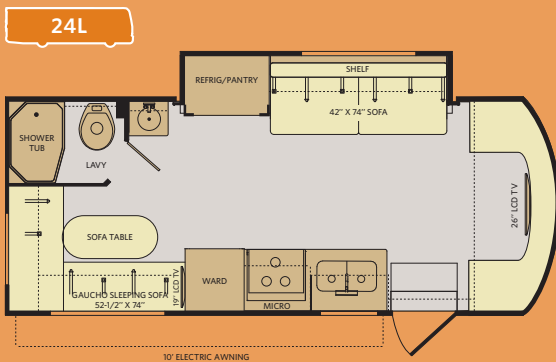

INTERIOR STORAGE CAPACITY: 43 CU. FT.
EXTERIOR STORAGE CAPACITY: 33 CU. FT.

Available Options: 068, 070, 219

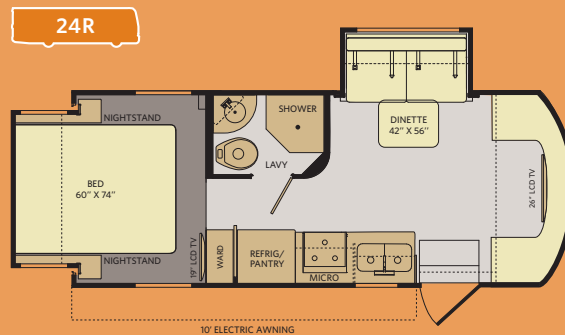

INTERIOR STORAGE CAPACITY: 35 CU. FT.
EXTERIOR STORAGE CAPACITY: 33 CU. FT.

Available Options: 068, 070

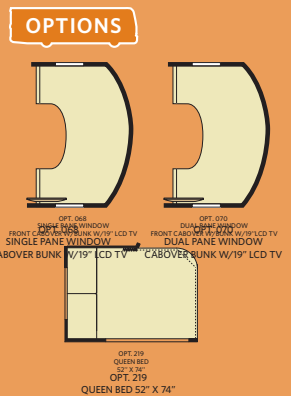

WEIGHTS & MEASUREMENTS

CHASSIS	MERCEDES-BENZ®		
	24D	24L	24R
MODELS			
Wheelbase (inches)	170"	170"	170"
GVWR (lbs) ¹	11,030	11,030	11,030
Front GAWR (lbs) ²	4,410	4,410	4,410
Rear GAWR (lbs) ²	7,720	7,720	7,720
GCWR (lbs) ³	14,530	14,530	14,530
Hitch Rating Weight (lbs) ^{5,††}	3,500	3,500	3,500
Tongue Weight (lbs) ¹	350	350	350
Fuel Capacity (gal)	26	26	26

MERCEDES-BENZ® CHASSIS

Model: Mercedes-Benz®	Alternator: 220 Amp
Engine: 3.0L 6-Cyl. Diesel	Torque: 325 lb-ft @ 1,400 - 2,400 RPM
Transmission: 5-Speed, Automatic	Horsepower: 188HP

DIMENSIONS & CAPACITIES

MODELS	24D	24L	24R
Overall Length ⁴	25' 2"	25' 2"	25' 2"
Overall Height (with A/C)	11' 4"	11' 4"	11' 4"
Overall Width (maximum) ^{5,6}	91.5"	91.5"	91.5"
Interior Height (maximum)	80"	80"	80"
Interior Width (maximum)	88"	88"	88"
Fresh Water Holding Tank (gal)	29	29	29
Grey Water Holding Tank (gal)	33	33	33
Black Water Holding Tank (gal)	33	33	33
Appliance Propane Tank (gal) (WC) ⁷	24	24	24
Water Heater Tank (gal)	6	6	6

Liquid Weight Reference:

Water (gal) = (8.3 lbs/3.8 kgs) Fuel (gal) = (6.1 lbs/2.8 kgs) Propane (gal) = (4.2 lbs/1.9 kgs)

Metric Conversion:

Multiply pounds x 0.453 to obtain kilograms. Multiply gallons x 3.785 to obtain liters.

Multiply liters x 61 to obtain cubic inches.



Jamboree® DSL 24D shown in Mystic Midnight interior decor with Satin Chestnut wood cabinetry



Jamboree® Sport DSL 24L shown in Glorious Graphite interior decor with Toasted Chestnut wood cabinetry

CONFIGURE A COACH THE WAY YOU WANT!

COLORS • FLOOR PLANS • OPTIONS • DÉCOR

WWW.FLEETWOODRV.COM



FLEETWOOD RV IS AN ALLIED SPECIALTY VEHICLE COMPANY.

Addendums

- GVWR (Gross Vehicle Weight Rating) is the maximum permissible weight of this fully loaded motor home. The GVWR is equal to or greater than the sum of the (UVW) unloaded vehicle weight plus the (OCCC) occupant cargo-carrying capacity*.
- GAWR (Gross Axle Weight Rating) is the maximum permissible loaded weight a specific axle is designed to carry.
- GCWR (Gross Combined Weight Rating) is the value specified by the motor home manufacturer as the maximum allowable loaded weight of this motor home with its towed vehicle. Towing and braking capacities may be different. Refer to Fleetwood and chassis manufacturer's manuals for complete information.
- Length measured from front bumper to rear bumper (excludes accessories).
- Excludes safety equipment and awnings.
- Motor homes feature a body width over 96" which will restrict your access to certain roads. Before purchasing, you should research any state and/or province road laws which may affect your usage.
- Tank manufacturer's listed water capacity (WC). Actual propane capacity is 80% of water listing as required by the safety code.

† The chassis manufacturer recommends the installation of a supplemental brake control system to activate the brakes on the vehicle or trailer you are towing. Hitch receiver ratings expressed are maximum for the hitch receiver installed and may require the purchase of additional equipment that is dependent on the weight of the towed load. Consult with hitch receiver manufacturer for further information.

* UVW and OCCC are found on the label containing the federal certification tag in each RV.

†† The Minimum Towable Load of this vehicle is the available weight capacity, up to GCWR, when the coach is fully loaded to maximum GVWR. However, if the coach is loaded to something less than maximum GVWR, that extra available weight capacity can be added to your Towable Load. For example, if your coach is loaded to 1000lbs less than maximum GVWR, your Towable Load increases accordingly. Do not exceed the hitch rating weight, GVWR or GCWR.

IMPORTANT—PLEASE READ

Product information, photography and illustrations included in this publication were as accurate as possible at the time of printing. For further product information and changes, please visit our website at www.fleetwoodrv.com or contact your local Fleetwood RV dealer. Prices, materials, design and specifications are subject to change without notice. All weights, fuel, liquid capacities and dimensions are approximate. Fleetwood RV has designed its recreational vehicles to provide a variety of uses for customers. Each vehicle features optimal seating, sleeping, storage and fluid capacities. The user is responsible for selecting the proper combination of loads (i.e., occupants, equipment, fluids, cargo, etc.) to ensure that the vehicle's capacities are not exceeded.

CONTACT US

To locate a dealer near you, visit our website at www.fleetwoodrv.com or call 1-800-322-8216. We can also be contacted at Fleetwood RV Customer Relations, P.O. Box 1007, Decatur, IN 46733.



*All 2013 Fleetwood RV motorhomes include a 1-year emergency roadside assistance membership. For complete info, see your Fleetwood RV dealer.

©2012 Fleetwood RV Inc. Printed in USA. Inventory Control Number JDSL_JASPTDSL13F1, 04/12. Model Year 2013, First Edition.