

ASPEN TRAIL

ASPEN TRAIL



2810BHS

ASPEN TRAIL



**Where high-end looks
and features meet
affordability.**

Aspen Trail's residential-styled furniture and two-toned walls add a sense of comfort and warmth.

Mega-slides are over a foot wider and offer a 6' ceiling height.

Our spacious sliderooms include an oversized 83" x 48" U-shaped convertible dinette and 68" fold-down sofa.



Aspen Trail 2810BHS, shown in Peppercorn



Aspen Trail 2810BHS, shown in French Roast



Aspen Trail 2810BHS



Aspen Trail 3117RLDS



Aspen Trail 2810BHS

Aspen Trail's kitchens are versatile, offering tons of storage space, larger cabinets, multiple drawers, a 2-door pantry and generous countertops.



Heavy Duty Steel
Roller Ball-Bearing
Drawer Guides

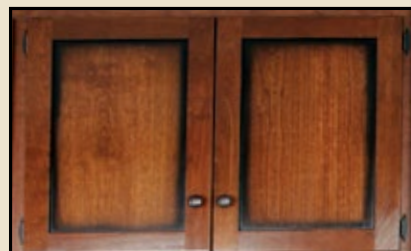

Solid Wood Cherry-Glazed
Cabinet Doors



Aspen Trail 3117RLDS, shown in French Roast

Hanging wardrobe closets and true queen walkaround bed with 60" x 80" mattress.



Aspen Trail 2810BHS

Aspen Trail offers roomy closets and storage shelves.



Acu-Weight Certification

All Units Weighed
at the Factory –
Includes Options!

WALL CONSTRUCTION

- ① .024 Gauge Heavy Duty Aluminum Finish
- ② 16" on Center Wall Studs
- ③ Steel Hurricane Straps - Tie Walls to Roof & Floor
- ④ R7 Fiberglass Insulation
- ⑤ Durable Vinyl Decor Board
- ⑥ Deep Tint Safety Glass Windows
- ⑦ Patio Awning
- ⑧ Diamond Plate Rock Guard
- ⑨ ABS LP Bottle Cover with Quick Access (Option)
- ⑩ "Super Slide" - 40" Deep Slide Rooms (See Floor Plans)
- ⑪ Aerodynamic Front Profile

PREMIUM CONSTRUCTION

ROOF CONSTRUCTION

- ① TPO Roof with 12 Year Manufacturer's Warranty
- ② 3/8" "Walk-On" Roof Decking
- ③ 5" Truss-Style Crowned Roof Rafters - 16" on Center
- ④ R7 Fiberglass Insulation
- ⑤ Vinyl Decorator Ceiling Board
- ⑥ 13,500 BTU Roof Ducted A/C
- ⑦ Foam Core A/C Ducting System

Includes:
**Radial Tires &
E-Z Lube Axles**

FLOOR CONSTRUCTION

- ① 10" Steel I-Beam Powder Coated Chassis on Deep Slides
- ② Rear Stabilizer Jacks
- ③ Folding Entry Door Steps
- ④ Radial Tires (Mandatory Option)
- ⑤ Heated and Enclosed Underbelly
- ⑥ Water Resistant Floor Liner
- ⑦ 12" on Center Floor Joists
- ⑧ Aluminum Heat Ducting in Floor
- ⑨ R7 Fiberglass Insulation
- ⑩ 5/8" Tongue and Groove Floor Decking
- ⑪ Beauflor® Residential Vinyl Flooring
- ⑫ Residential Carpeting

MEGA STORAGE



Our pass-thru storage compartments are up to
3 times larger than the competition.

AERODYNAMIC FRONT PROFILE



Aspen Trail's aerodynamic profile is designed
to push air up the front wall and over the roof
to improve towability and fuel economy.

**Improves
Aerodynamics
Protects Tanks
and Floor**

**Enclosed &
Heated Underbelly**



MINIS

1400RB

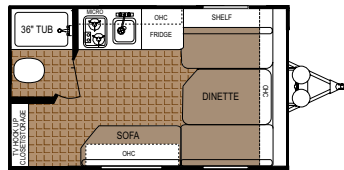

Hitch Weight (lbs) 300
 Unloaded Weight (lbs) 2,596
 Cargo Capacity (lbs) 804
 Overall Height w/Opt AC 9' 7"
 Overall Length 17' 6"

Fresh Water Capacity 20.5
 Black Water Tank(s) 28
 Grey Water Tank(s) 28
 Furnace BTU Output 18,000

1500BH

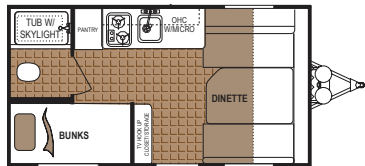

Hitch Weight (lbs) 326
 Unloaded Weight (lbs) 2,715
 Cargo Capacity (lbs) 1,085
 Overall Height w/Opt AC 9' 11"
 Overall Length 18' 9"

Fresh Water Capacity 20.5
 Black Water Tank(s) 28
 Grey Water Tank(s) 28
 Furnace BTU Output 18,000

1600QB

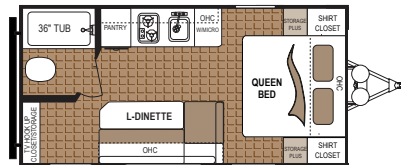

Hitch Weight (lbs) 352
 Unloaded Weight (lbs) 3,072
 Cargo Capacity (lbs) 728
 Overall Height w/AC 9' 1"
 Overall Length 21' 5"

Fresh Water Capacity 27
 Black Water Tank(s) 28
 Grey Water Tank(s) 28
 Furnace BTU Output 18,000

2470BS

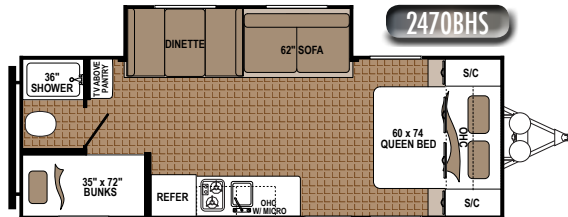

Hitch Weight (lbs) TBD
 Unloaded Weight (lbs) TBD
 Cargo Capacity (lbs) TBD
 Overall Height w/AC 10' 1"
 Overall Length 27' 6"

Fresh Water Capacity 26.5
 Black Water Tank(s) 28
 Grey Water Tank(s) 28
 Furnace BTU Output 18,000

1700DB

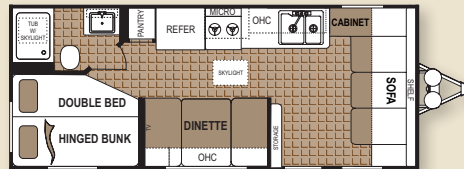

Hitch Weight (lbs) 464
 Unloaded Weight (lbs) 4,052
 Cargo Capacity (lbs) 3,548
 Overall Height w/AC 10' 7"
 Overall Length 23' 10"

Fresh Water Capacity 52
 Black Water Tank(s) 42
 Grey Water Tank(s) 42
 Furnace BTU Output 18,000

1900RB

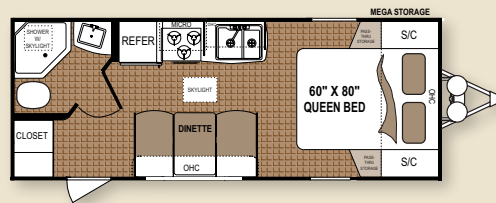

Hitch Weight (lbs) 504
 Unloaded Weight (lbs) 4,096
 Cargo Capacity (lbs) 3,504
 Overall Height w/AC 10' 8"
 Overall Length 24' 8"

Fresh Water Capacity 52
 Black Water Tank(s) 42
 Grey Water Tank(s) 42
 Furnace BTU Output 18,000

2110RBS

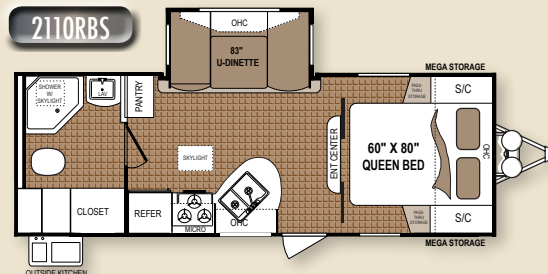

Hitch Weight (lbs) 567
 Unloaded Weight (lbs) 5,446
 Cargo Capacity (lbs) 2,154
 Overall Height w/AC 11' 3"
 Overall Length 26' 6"

Fresh Water Capacity 52
 Black Water Tank(s) 42
 Grey Water Tank(s) 42
 Furnace BTU Output 25,000

2390RKS

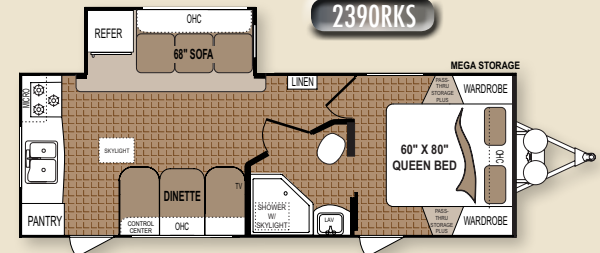

Hitch Weight (lbs) 782
 Unloaded Weight (lbs) 5,494
 Cargo Capacity (lbs) 2,106
 Overall Height w/AC 11' 4"
 Overall Length 27' 2"

Fresh Water Capacity 52
 Black Water Tank(s) 42
 Grey Water Tank(s) 42
 Furnace BTU Output 25,000

2460RLS

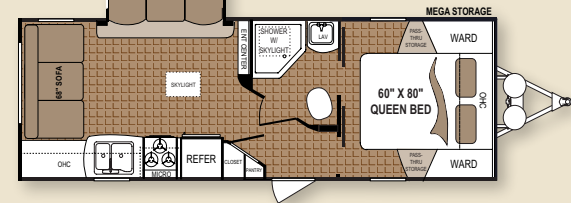

Hitch Weight (lbs) 526
 Unloaded Weight (lbs) 5,479
 Cargo Capacity (lbs) 2,121
 Overall Height w/AC 11' 2"
 Overall Length 27' 8"

Fresh Water Capacity 52
 Black Water Tank(s) 42
 Grey Water Tank(s) 42
 Furnace BTU Output 25,000

2500BH

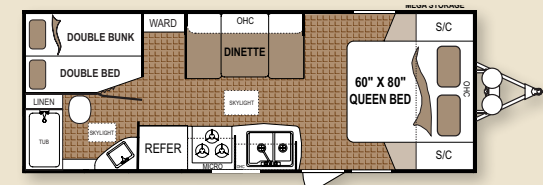

Hitch Weight (lbs) 554
 Unloaded Weight (lbs) 4,290
 Cargo Capacity (lbs) 3,310
 Overall Height w/AC 10' 7"
 Overall Length 25' 7"

Fresh Water Capacity 52
 Black Water Tank(s) 42
 Grey Water Tank(s) 42
 Furnace BTU Output 18,000

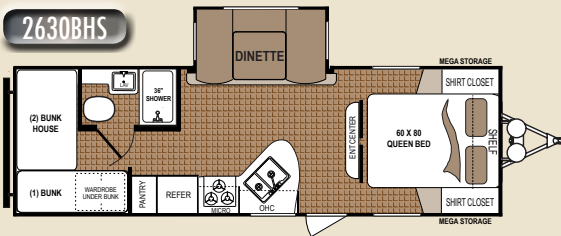

Hitch Weight (lbs) 616
 Unloaded Weight (lbs) 6,250
 Cargo Capacity (lbs) 3,430
 Overall Height w/AC 11' 3"
 Overall Length 29'

Fresh Water Capacity 52
 Black Water Tank(s) 42
 Grey Water Tank(s) 42
 Furnace BTU Output 25,000

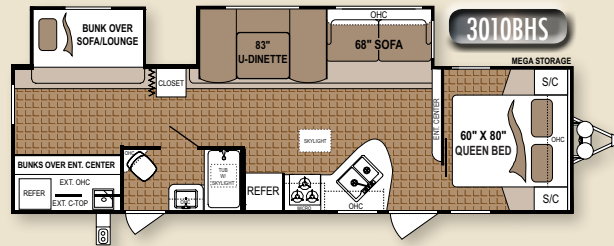

Hitch Weight (lbs) 944
 Unloaded Weight (lbs) 7,778
 Cargo Capacity (lbs) 1,902
 Overall Height w/AC 11' 7"
 Overall Length 35' 9"

Fresh Water Capacity 52
 Black Water Tank(s) 42
 Grey Water Tank(s) 42
 Furnace BTU Output 34,000

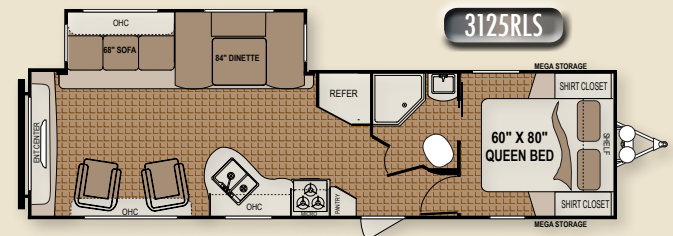

Hitch Weight (lbs) 853
 Unloaded Weight (lbs) 6,850
 Cargo Capacity (lbs) 2,830
 Overall Height w/AC 11' 4"
 Overall Length 34' 2"

Fresh Water Capacity 52
 Black Water Tank(s) 42
 Grey Water Tank(s) 42
 Furnace BTU Output 34,000

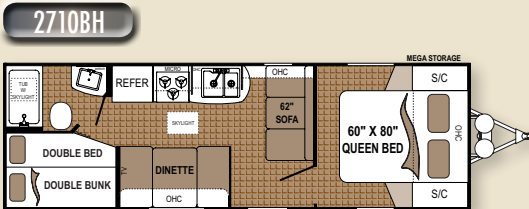

Hitch Weight (lbs) 543
 Unloaded Weight (lbs) 4,624
 Cargo Capacity (lbs) 2,976
 Overall Height w/AC 10' 7"
 Overall Length 28' 7"

Fresh Water Capacity 52
 Black Water Tank(s) 42
 Grey Water Tank(s) 42
 Furnace BTU Output 25,000

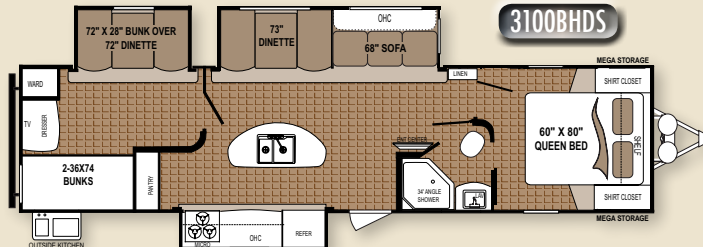

Hitch Weight (lbs) 986
 Unloaded Weight (lbs) 8,337
 Cargo Capacity (lbs) 2,839
 Overall Height w/AC 11' 8"
 Overall Length 36' 11"

Fresh Water Capacity 52
 Black Water Tank(s) 42
 Grey Water Tank(s) 78
 Furnace BTU Output 34,000

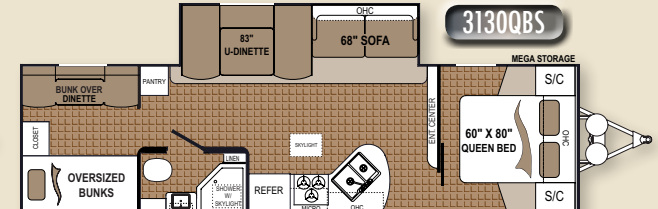

Hitch Weight (lbs) 827
 Unloaded Weight (lbs) 6,888
 Cargo Capacity (lbs) 2,792
 Overall Height w/AC 11' 6"
 Overall Length 34'

Fresh Water Capacity 52
 Black Water Tank(s) 42
 Grey Water Tank(s) 42
 Furnace BTU Output 34,000

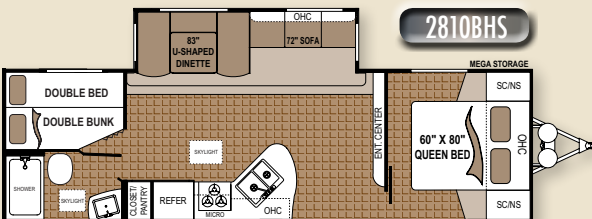

Hitch Weight (lbs) 814
 Unloaded Weight (lbs) 6,512
 Cargo Capacity (lbs) 3,168
 Overall Height w/AC 11' 4"
 Overall Length 32' 4"

Fresh Water Capacity 52
 Black Water Tank(s) 42
 Grey Water Tank(s) 42
 Furnace BTU Output 34,000

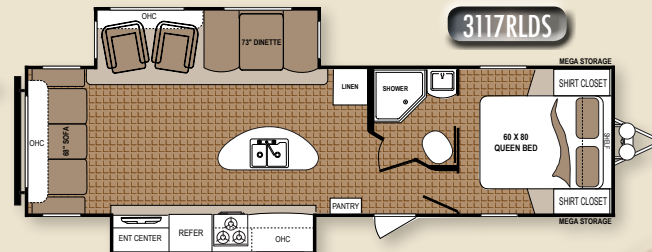

Hitch Weight (lbs) 992
 Unloaded Weight (lbs) 7,444
 Cargo Capacity (lbs) 2,236
 Overall Height w/AC 11' 4"
 Overall Length 34' 7"

Fresh Water Capacity 52
 Black Water Tank(s) 42
 Grey Water Tank(s) 42
 Furnace BTU Output 34,000

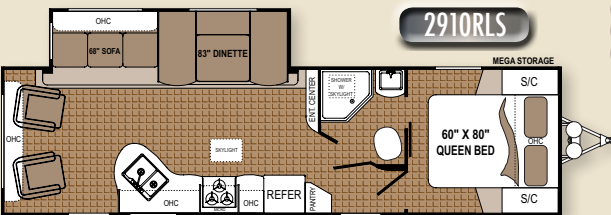

Hitch Weight (lbs) 682
 Unloaded Weight (lbs) 6,776
 Cargo Capacity (lbs) 2,904
 Overall Height w/AC 11' 5"
 Overall Length 32' 10"

Fresh Water Capacity 52
 Black Water Tank(s) 42
 Grey Water Tank(s) 42
 Furnace BTU Output 34,000

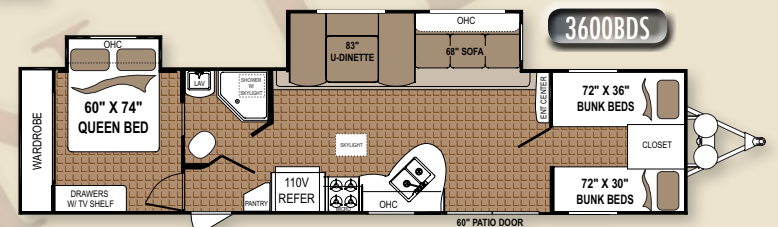

Hitch Weight (lbs) 1,071
 Unloaded Weight (lbs) 8,184
 Cargo Capacity (lbs) 2,992
 Overall Height w/AC 11' 5"
 Overall Length 39' 3"

Fresh Water Capacity 52
 Black Water Tank(s) 42
 Grey Water Tank(s) 78
 Furnace BTU Output 34,000

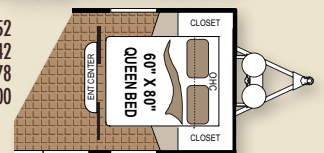

STANDARD AND OPTIONAL FEATURES

ASPEN TRAIL VALUE ADDED PACKAGE

Aerodynamic Front Profile
Front Diamond Plate Rock Guard
Jensen® Stereo
Interior and Exterior Speakers
Central Command Center
Full Extension Roller Ball Bearing Drawer Guides in Galley
Cherry Glazed Hardwood Cabinet Doors
Laundry Chute (See Floor Plans) - Slide Models Only
Evergreen 60" x 80" Deluxe Quilted Mattress
Beauflor® Wood Plank Premium Vinyl Flooring
"Mega Storage" Pass Thru Storage
Compartment (See Floor Plans)
82" Interior Ceiling Height
"Super Slide" Slide Room with 72" Interior Height

INTERIOR FEATURES

KITCHEN

Residential Microwave Oven with Carousel
Auto Ignition 3 Burner Range with Oven (Slide Models)
3 Burner Cook Top (Non Slide Models)
Large 6 Cubic Foot Double Door Gas/Electric Refrigerator
Extra Large, Double Bowl Sink with High Rise Faucet
Power Range Hood with 12 Volt Light and Exhaust Fan

LIVING AREA FEATURES

Premium Residential Furniture
Large Radius Corner Slide-Out Overhead Cabinets
Premium Slide-Out Fascia
12 Volt Lights Over Dinette
Designer Window Treatments with Mini Blinds Throughout
Swivel Chairs (See Floor Plans)
Fold-Down Sofa (See Floor Plans)
83" U-Shaped Convertible Dinette (See Floor Plans)
Wall Switches for Overhead Lights

BEDROOM FEATURES

TV Hook-Ups In Bedroom (See Floor Plans)
Lift-Up Bed Storage (See Floor Plans)
Designer Bedding Package with Bedspread
Reading Lights
Privacy Curtain for Bunks
Sliding Bedroom Doors

BATHROOM FEATURES

ABS Tub & Shower Surround
Shower/Exhaust Fan
Glass Shower Door (See Floor Plans)
Designer Mirror
110V GFI Outlet
GFI Protected 110 Volt
Duplex Receptacles
Towel Hooks
Foot Flush Toilet

"STORE MORE" CABINETRY

Radius Corner - Full Access Cabinet
Cherry Glazed Hardwood Panel Drawer Fronts and Cabinet Doors in Galley
Deep Slide Room Cabinets with Decorative Glass Inserts

APPLIANCES AND SAFETY EQUIPMENT

6 Gallon Gas DSI Water Heater
Water Heater By-Pass
34K BTU Furnace (Most Models - See Floor Plans)
13.5 BTU Roof Ducted Air Conditioning (Most Models - See Floor Plans)
Premium 12 Volt Water Pump
55 Amp Electronic Converter
Digital TV Antenna with Booster
Wired for Cable
Monitor Panel
Smoke Detector
Carbon Monoxide Detector
LP Leak Detector

CONSTRUCTION

CHASSIS
Heavy Duty Steel I-Beam Frame
Dual Battery Tray
2 5/16" Coupler
Break-Away Trailer Switch
Heavy Duty Safety Chains
(2) 20 lb. LP Bottles
Rear Stabilizer Jacks
Easy Lube Axles
Steel Rims
Folding Entry Steps
Rear Bumper
46 Gallon Fresh Water Tank

FLOOR

16" on Center Studs
5/8" Tongue and Groove Floor Decking

ROOF

Walk-On Roof with Fiberglass Insulation R-7
Seamless TPO Roof with 12 Year Mfg. Warranty
3/8" Roof Decking
Roof Ducted Air Conditioning (Most Models - See Floor Plans)
Extended Rain Gutters

WALLS

Manual Awning with Adjustable Legs
Detachable 30 Amp Power Cord
Hurricane Straps Integrate Walls to Roof and Floor
Heavy Duty .024" Mesa Sidewall Metal
R7 Fiberglass Insulation
Key-Locking, Radius Corner Exterior
"Mega Storage" Compartments
Pebble Finish Entry Door
Patio Light
Tinted Safety Glass Windows
Large Picture Window at Dinette
120V Exterior Outlet

ACU-WEIGHT CERTIFICATION

Real Weights - All Units Weighed Before Leaving the Factory
Weights Include Options - See Acu-Weight Decal on Unit

OPTIONAL FEATURES

Tri-Fold Sofa
Table & 4 Chairs
Aztec Grey Fiberglass
15,000 BTU A/C Upgrade
Radial Tires (Mandatory)
Spare Tire and Cover
Front Stabilizer Jacks
Sink Covers
Oven (Non Slides)
6 Gallon Quick Recovery Gas/Electric/DSI Water Heater
Exterior Wash Station
30 lb. LP Bottles with Deluxe ABS LP Bottle Cover
Power Stabilizer Jacks
Power Awning



Scan our quick response code to open our website, and explore the many products we have to offer!

Product information is as accurate as possible as of the date of publication of this brochure. Features, floorplans and specifications are subject to change without notice. Please also consult our website for more current product information and specifications.

Tow Vehicle Disclaimer CAUTION: Owners of Dutchmen Manufacturing, Inc., recreational vehicles are solely responsible for the selection and proper use of tow vehicles. All customers should consult with a motor vehicle manufacturer or their dealer concerning the purchase and use of suitable tow vehicles for Dutchmen products. Dutchmen disclaims any liability or damages suffered as a result of the selection, operation, use or misuse of a tow vehicle. Dutchmen's limited warranty does not cover damage to the recreational vehicle or the tow vehicle as a result of the selection, operation, use or misuse of the tow vehicle.

www.AspenTrailRV.com

Dutchmen Manufacturing, Inc.
PO Box 2164
2164 Caragana Court
Goshen, Indiana 46527
(574)537-0600



Dutchmen

Your Local Dealer

FABRICS

FRENCH ROAST



ENTOURAGE



PEPPERCORN

