

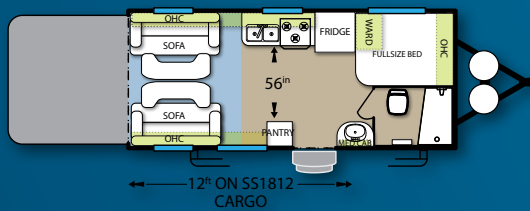

LUXURY Toy HAULERS

Travel Trailers

SS1812



SK2112

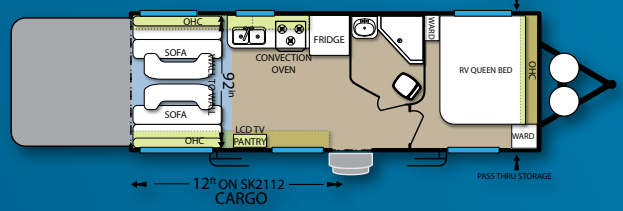

SS2216

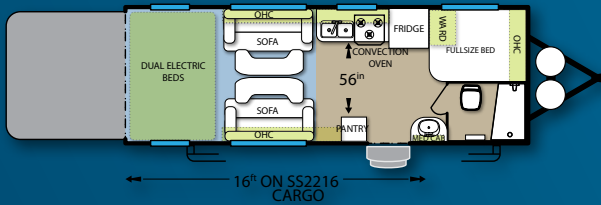

FB2312

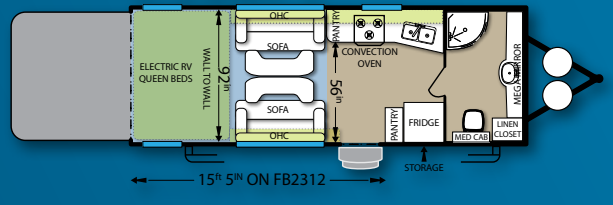

FS2410

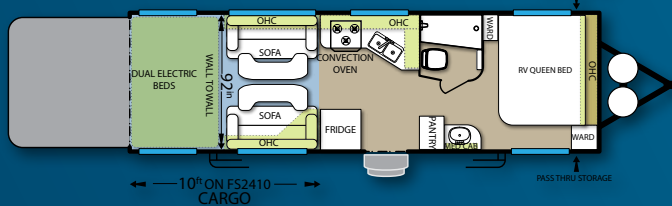

FS2612

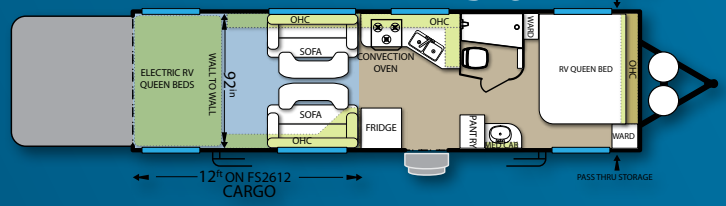

COMING SUMMER 2012

WA2715

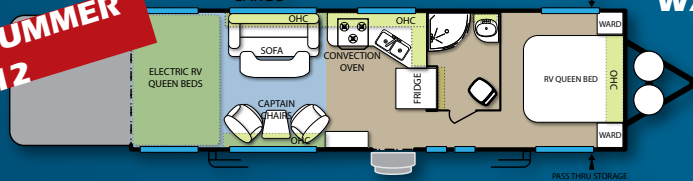

WA2715

Fifth Wheels

LX3112

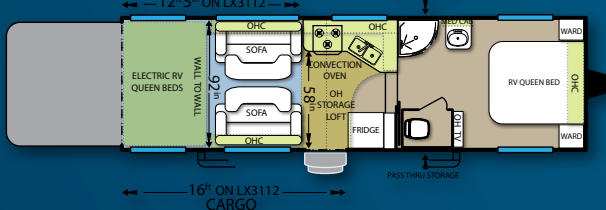

CK3012 - CK3214

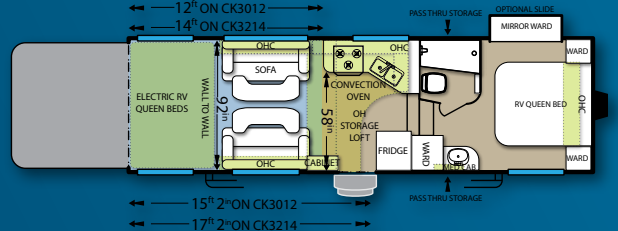

MODEL	HITCH WEIGHT	AXLE WEIGHT	GVWR	CCC	TOTAL LENGTH	TOTAL HEIGHT	FRESH WATER	GREY/BLACK
SS1812	601bs	4,434lbs	7,601lbs	3,167lbs	22'10"	11'2"	56gal	40/35gal
SK2112	613lbs	5,343lbs	7,613lbs	2,270lbs	26'10"	11'5"	106gal	40/40gal
SS2216	732lbs	4,818lbs	7,732lbs	2,182lbs	26'10"	11'3"	106gal	40/40gal
FB2312	655lbs	4,823lbs	10,815lbs	5,278lbs	27'8"	11'6"	106gal	40/40gal
FS2410	860lbs	4,957lbs	11,020lbs	5,144lbs	28'11"	11'6"	106gal	40/40gal
FS2612	802lbs	5,620lbs	10,962lbs	4,540lbs	30'11"	11'6"	106gal	40/40gal
WA2715	COMING SUMMER 2012!!							
LX3112	1,896lbs	5,984lbs	12,056lbs	4,176lbs	33'4"	12'3"	106gal	40/40gal
CK3012	2,118lbs	5,701lbs	12,278lbs	4,400lbs	30'9"	12'3"	106gal	40/40gal
CK3214	2,233lbs	5,788lbs	12,393lbs	4,313lbs	32'9"	12'3"	106gal	40/40gal

* The Cargo Carrying Capacity does not include the weight of water, fluids, all popular options. Weights and capacities are approximate, the addition of optional equipment including fiberglass siding will increase the overall weight.

Standard Features

- 106gal Fresh Water Capacity (56gal on 1812)
- 13.5k BTU Air Conditioner (opt on 1812)
- 15" Chrome Wheels (per fp)
- 20,000 BTU Thermostat Controlled Furnace
- 3 Burner Cook Top
- 4.0 Generator (per fp, NA 1812)
- 40gal Grey Tank, 40gal Black Tank Capacity
- 6 cuft Double Door 2-Way Full Auto Refer (gas & 110v)
- 6gal, Direct Spark, Gas Water Heater w/ By-Pass
- All LED Running Lights
- Automotive Baked Enamel Aluminum Exterior
- Back Up Lights
- Built In Convection Microwave Oven (opt on 1812)
- Custom Radius Ramp Door
- Dual 5gal LPG Tanks (Exchange Ready)
- Dual Electric RV Beds (NA SS1812, SK2112)
- Flood Light
- Flush Steel Mounted Tie Downs

- Fuel Station W/ 40gal Tank (Door Side, opt on 1812)
- Heavy Duty Wide Stance Chassis
- High Rate Battery Charger
- Hitch Light
- Matching Spare Tire & Carrier (opt on 1812)
- Full Walk on Seamless Rubber Roof
- Outside Shower (na 1812)
- Radius Entry Step
- Residential Ball Bearing Full Extension Drawer Guides
- Sewer Hose Carrier
- Stabilizer Jacks (4) (per fp)
- Steel Jack Knife Sofa Beds w/ Tables (2)
- Stereo AM/FM/CD w/ Interior & Exterior Speakers (opt on 1812)
- Upgraded Pillow Top Mattress (per fp)
- White Powder Coated Bumper & Horseshoe
- Wide Track Axles w/ Chrome Rims (per axle, per fp)
- Wired For Satellite System, Cable and Local TV (opt on 1812)

Optional Upgrades

- Flat Panel LED TV
- Rear Bed Flip Sofa (per fp)
- 4.0kw Onan Generator (per fp)
- Alloy Wheels (per fp)
- Night Shades
- Electric Awning
- Alumna-Wall Fiberglass Exterior

- Toy Lok
- Upgraded Carpet Kit
- Arctic Package (Insl & Encl Tanks, Dbl Insl Roof & Floor, 12v Heat Strips)
- Add-A-Wall
- Retractable Ladder



Premium CD/AM/FM Stereo Unit



Central control panel



Dual bowl sink, pull out sprayer, flush mount sink lids



OPT 40gal fuel tank w/ pump (per fp)



6cu ft refrigerator



OPT LED TV w/ built in DVD player



Convection microwave (per fp)



OPT Aluminum rims



Chrome rims



Flood Light (opt on 1812)

WIDE LITE Travel Trailers

SERIES

SA2714

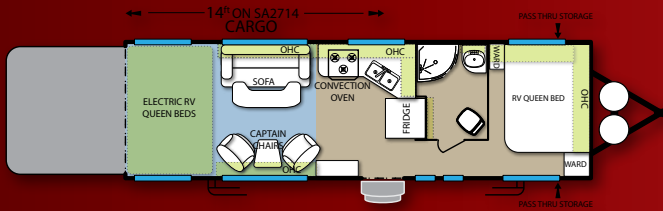

FSC2812

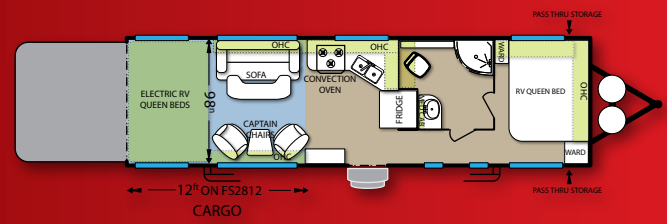

Fifth Wheels

RG3210

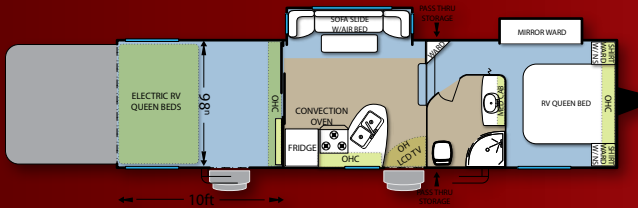

SA3516

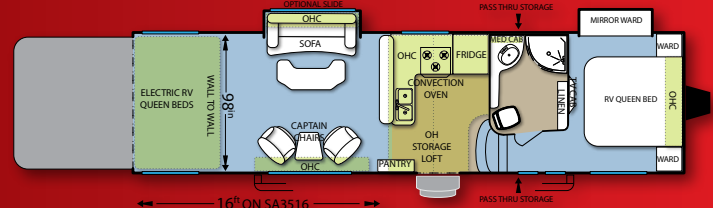

CR3716

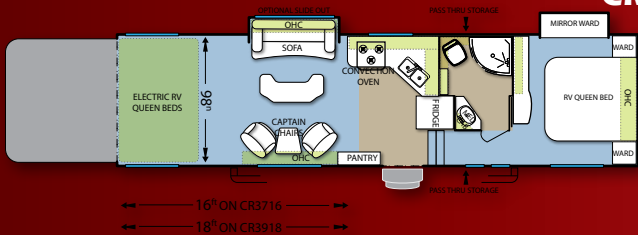

LM3814

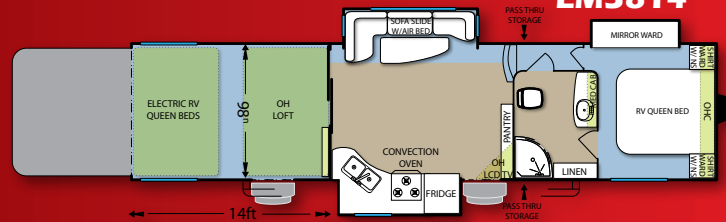

Convection microwave oven



Large HD LCD TV's w/ built in DVD players



One stop Command Center



Ducted A/C



Fat Boy captain chairs

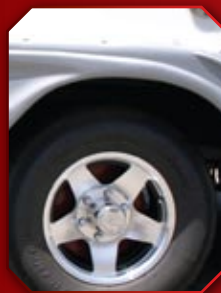

Alloy rims



Exterior high output marine speakers



Push button electric awning, hi-intensity exterior light

MODEL	HITCH WEIGHT	AXLE WEIGHT	GVWR	CCC	TOTAL LENGTH	TOTAL HEIGHT	FRESH WATER	GREY/BLACK
SA2714	1,051lbs	5,650lbs	11,451lbs	4,750lbs	30'4"	11'6"	106gal	40/40gal
FSC2812	1,354lbs	7,629lbs	14,000lbs	4,958lbs	34'2"	12'0"	106gal	50/50gal
RG3210	2,696lbs	7,690lbs	14,696lbs	4,310lbs	35'	13'1"	106gal	70/35gal
SA3516	2,545lbs	9,741lbs	19,000lbs	7,314lbs	38'7"	13'6"	106gal	50/50gal
CR3716	2,834lbs	9,907lbs	19,000lbs	6,200lbs	39'4"	13'6"	106gal	50/50gal
LM3814	2,611lbs	9,731lbs	19,000lbs	6,609lbs	41'8"	13'6"	106gal	70/70gal

* The Cargo Carrying Capacity does not include the weight of water, fluids, all popular options. Weights and capacities are approximate, the addition of optional equipment including fiberglass siding will increase the overall weight.

Standard Features

- 106 gal Fresh Water Capacity
- 13,500 BTU Air Conditioner
- 2,000lb Capacity Flush Steel Mounted Tie Downs
- 30,000 BTU Furnace Thermostat Controlled (Ducted)
- 4.0 Generator
- 6gal, Direct Spark, Gas Water Heater w/ By-Pass
- 8 cuft Large Double Door 2-Way Full Auto Refer (gas & 110v)
- A&E Awning
- All LED Running Lights
- All Wheel Electric Brakes
- Aluma-Wall Fiberglass Exterior
- Back Up Lights
- Built In Convection Microwave Oven
- Ceiling Fan (5th Wheel Only)
- Custom Front Cap
- Custom Radius Ramp Door
- Dual Electric RV Beds
- Flat Panel LCD TV (Opt on TT's)
- Fuel Station w/ 40gal Tank (Door Side)
- Heavy Duty Wide Stance Chassis
- High Rate Battery Charger
- Huge Bay Windows & Chairs (WA)
- Matching Spare Tire and Carrier
- Full Walk On One Piece Seamless Rubber Roof
- Pressure Washer
- Radius Entry Steps
- Residential Ball Bearing Full Extension Drawer Guides
- Sewer Hose Carrier
- Steel Jack Knife Sofa Beds w/ Tables (2) (per fp)
- Stereo AM/FM/CD w/ Interior & Exterior Speakers
- Upgraded Carpet Kit (Cargo Area)
- Upgraded Pillow Top Mattress
- White Powder Coated Bumper & Horseshoe
- Wired for Satellite System, Cable and Local TV

Optional Upgrades

- Additional 100gal Fresh Water Tank (total 200gal, per fp)
- Arctic Package (Insl & Encl Tanks, Dbl Insl Roof & Floor, 12v Heat Strips)
- Double Insulation Roofs and Floors
- Heat Strips 12volt
- Insulated and Enclosed Tanks
- LCD TV in Bedroom
- TV/DVD in Cargo
- Tough Ply Flooring
- ToyLok Security System
- Night Shades
- Add-A-Wall Rear Drape
- Rear Bed Flip Sofa
- Onan 4.0kw Generator
- Onan 5.5kw Generator
- Electric Awning
- Retractable Ladder



RG3210 Shown in Mocha Decor



Dual electric beds, shown with optional double sofa in place of the lower queen bed (per fp)

Aluma-Wall Fiberglass Siding

1. High Gloss Fiberglass Siding
2. Extra Thick Backer
3. High Density Foam Core Insulation
4. Hard Wood Water Resistant Backing
5. Vinyl Easy Clean Wall Paneling
6. Heavy Gauge Aluminum Framing w/ Welds At Every Junction and Runners For Electrical

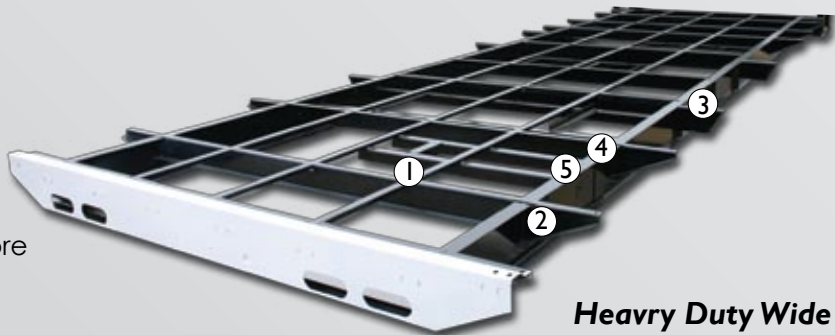
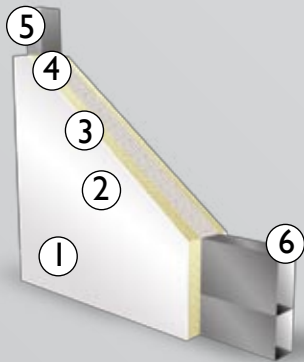

Heavy Duty Wide Stance Chassis

1. Flush Mount Steel Framing
2. Short 11" Z-Style Outriggers
3. 6" Tube Outriggers by Axles
4. Widened I-Beams for stability
5. Support gussets around all holes and notches

Decors

RUST

MOCHA

WICKED EDITION

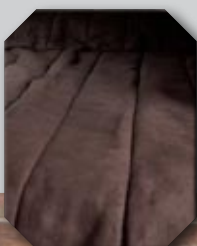
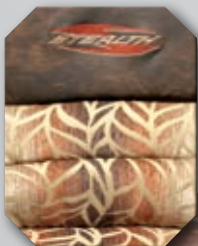

BEDSPREAD

BEDSPREAD

LINOLEUM

LINOLEUM



FSC2812 Full Wide Body Interior shown in our NEW Wicked Decor. 98" wall to wall interior width means 2 full size quads fit side to side maximizing your storage and cargo capacities. With its beaver tail rear entry and hidden wheel wells, this model was designed with the UTV enthusiast in mind.



Quads, Dirt Bikes, UTVs, Street Bikes, Choppers, Trikes, the RG3210 with its 10' Garage and Beavertail rear entry fits them all. Higher capacity tie downs, mounted into steel, means your toys are safe and secure. Convenience and usability make this fifth wheel a viable option for those RV's who need a big roomy living area and still have room for their toys.

Premium Structure (Wide Lites)

1. Aluminum Stud Sidewalls
2. High Gloss Fiberglass Exterior
3. Gel Coat Fiberglass Front Cap
4. 2x5 Bowed Truss Rafters
5. 3/8" OSB Roof Deck
6. One Piece Rubber Roof Sheathing
7. Insulated A/C Duct work
8. Steel I-Beam Frame
9. Steel Floor Runners
10. Rolled Fiberglass Insulation, Foam Core in Walls
11. Stain Resistant Nylon Carpet
12. Vinyl Covered Interior Decorative Wall Board
13. Fiberglass Positive Pressure Laminated Sidewall
14. Tinted Slider Windows
15. Full Size Radius Entry Door
16. Fold Down Radius Entry Steps
17. 13.5k BTU Air Conditioner
18. 5/8" One Piece Laminated Floor

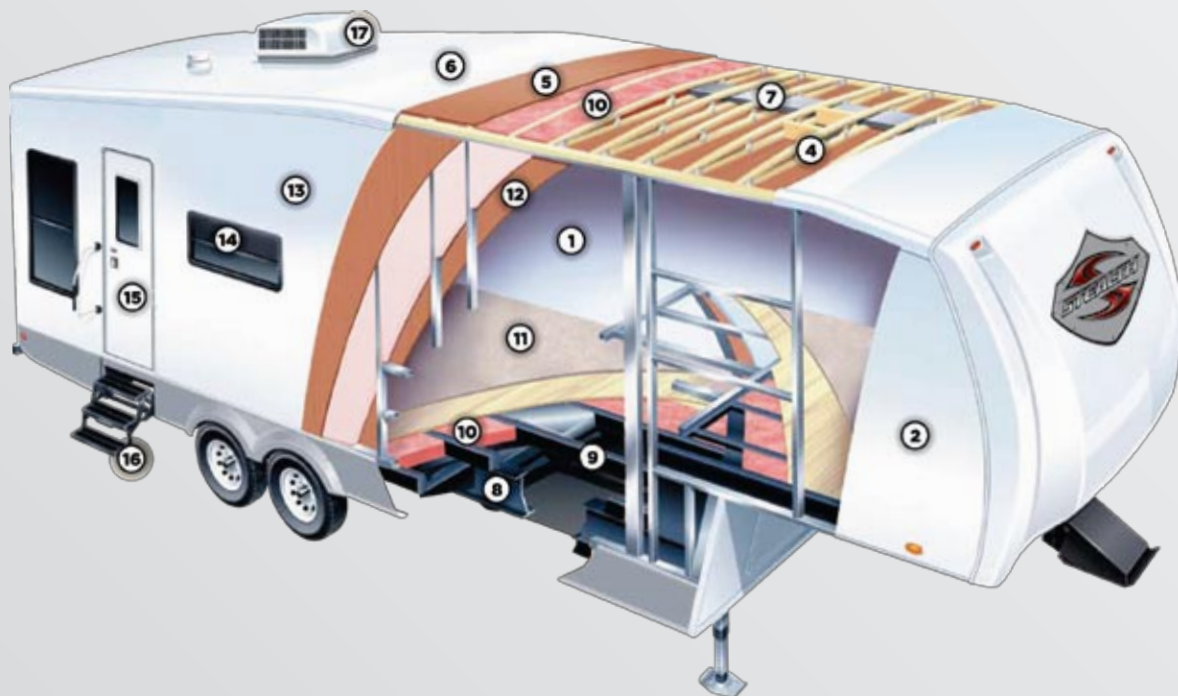

"Peace of Mind"

Forest River Inc. Exclusive

Benefits

- Emergency Roadside Assistance
- Service Assistance
- Nationwide Service Appointment Assistance
- Mobile Mechanics
- \$2,000 Trip Interruption Reimbursement
- 24-Hour Toll-Free Emergency Message Service
- Custom Trip Routing and Full Color Maps

By Coach-Net®



Forest River, Inc. encourages our customers to purchase their Forest River products from a local dealership whenever possible for the following reasons:

It is the goal of Forest River, Inc. that all of our RV owners fully enjoy the RV experience and that customer satisfaction meets or exceeds their expectations!

- 1) Forest River, Inc. dealers are independently owned and operated businesses so priority service and scheduling is at their discretion and is often provided to customers that purchased their unit at that dealership.
- 2) Purchasing locally allows customers to establish meaningful relationships with a dealer, enhancing the RV experience through assistance with product questions, user tips or RV regulations for your state or country, and much more!
- 3) Canadian customers must meet requirements to bring an RV purchased out of the country to their home. These requirements may involve additional inspections and certifications, taxes and fees. Your local Canadian Dealer is a professional at meeting these requirements.
- 4) Scheduling timely warranty repairs and adjustments through a local dealership provides far greater flexibility and convenience to you, the customer!

WIDE LITE FW'S RG3210



LIMITED TT'S FS2410



Dealer Info

www.forestriverinc.com/stealth

California Division

255 S. Pepper Ave • Rialto, CA 92376 • (909) 873-3777

All illustrations and specifications contained in this literature are based on the latest product information at time of publication. Forest River reserves the right to make changes in price, colors, materials, equipment, and specifications at any time without notice and assumes no responsibility for any error in this literature.



Learn More

Scan this barcode using a QR Reader on your smart phone to learn more about Forest River.



A Berkshire Hathaway company.