

# Wildcat



**AFFORDABLE LUXURY WITHOUT COMPROMISE**  
**2013 WILDCAT FIFTH WHEELS BY FOREST RIVER**



YOUR HOME AWAY FROM HOME

## WILDCAT - 327CK

Center Kitchen with Rear Entertainment



Shown in Steel décor, Wildcat's all new 327CK features swivel glider recliners, a 40" Toshiba® HDTV with HDMI and iPod® connectors, Corian® kitchen countertops, abundant storage space, giant L-shaped hide-a-bed sofa, as well as a space-heating fireplace — ALL STANDARD! The dual facing slide rooms provide huge floor space and use Shaw® residential grade carpeting with R2X® stain and pet guard.

# Wildcat

## AFFORDABLE LUXURY WITHOUT COMPROMISE

For over a decade, Wildcat has been Forest River's top-selling fifth wheel brand. This exceptional record began with innovative floor plans, class-defining features, and a rich set of options. It endures today with strong focus on unique designs, advanced construction using the latest building materials and technology, and a commitment to continuous improvement that sets Wildcat apart from the competition. When you choose Wildcat, you'll know why so many experienced RVers trust our fifth wheels for their camping experience!

### MORE STANDARD FEATURES THAN ANY OTHER FIFTH WHEEL IN OUR CLASS!



Optional 110V ceiling fan



The 327CK bedroom (right) has plenty of space for long or short term stays and offers optional washer/dryer prep. Convenient storage shelves in the mirrored wardrobe provide a quick and easy way to keep your belongings organized.

Wildcat's barrel roof provides an open and airy arched ceiling with plenty of headroom — fully 6' 7" at it's crown.

THE KING OF BUNKHOUSES!

## WILDCAT - 312BHX-OK

Bunk House

Outside Kitchen



The Wildcat eXtraLite 312BHX-OK with optional Outside Kitchen, shown in Bark décor, features Corian® countertops, air mattress hide-a-bed sofa, and a full entertainment center: the 40" Toshiba® HDTV including an iPod® connector and HDMI hook-up is another Wildcat class-exclusive feature.



The arched roofline of the eXtraLite 312BHX-OK bedroom (pictured at left) features flush floors, 6'4"+ ceiling height, a wardrobe/linen slide room, ample space around the bed, dual nightstands (with 110V outlets) and adjustable LED lighting. Paired with a private bathroom (far left), it's the biggest bedroom in it's class!

The optional outside kitchen on the 312BHX-OK (right) features Wildcat's exclusive Jack-Knife Cooktop™ with dual burner stove and LP gas grill, outside refrigerator, ceiling TV bracket, removable cutting board, 12V dual overhead lighting, and huge Slam-Latch™ door, which creates an awning. Optional 24" LED TV shown.



Optional 110V ceiling fan

Inside the 312BHX-OK, this spacious rear bunkhouse with U-dinette (above) sleeps 4 on staggered bunks (below) with plenty of storage space, a ladder, wardrobe, and TV hook-up. Wildcat bunkhouse models also feature hard doors on all bunk rooms so kids or guests easily have privacy.





Optional 110V ceiling fan

The 317RL with standard Outside Kitchen, shown in Hazelnut décor (above), features a Corian® solid-surface kitchen countertop and an open rear living area with standard built-in 40" Toshiba® HDTV entertainment center, electric fireplace, and swivel glider recliners. The 317RL bedroom (below right) offers ample wardrobe storage, optional washer/dryer prep, and a residential (60" x 80") queen size bed.





ONLY IN A WILDCAT

# WILDCAT - 317RL

Rear Living Room	Outside Kitchen
------------------	-----------------

The all new 317RL features Wildcat's exclusive Jack-Knife Cooktop™ (below) with dual burner stove, LP gas grill, outside refrigerator, and TV.



# WILDCAT- BUILDING A BETTER RV

**CLIMATECH™**  
 CLIMATECH™ UNDERBODY PROTECTION  
 FEATURING ENCLOSED, INSULATED, AND  
 HEATED UNDERBELLY, TANKS, AND STORAGE

**ALUMACAT™**  
 EXCLUSIVE ALUMACAT™ CONSTRUCTION  
 FEATURING 2" THICK DOUBLE-WELDED  
 ALUMINUM FRAME WITH VACUUM-BONDED  
 LAMINATED FIBERGLASS SIDEWALLS



ROOF LADDER

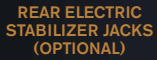
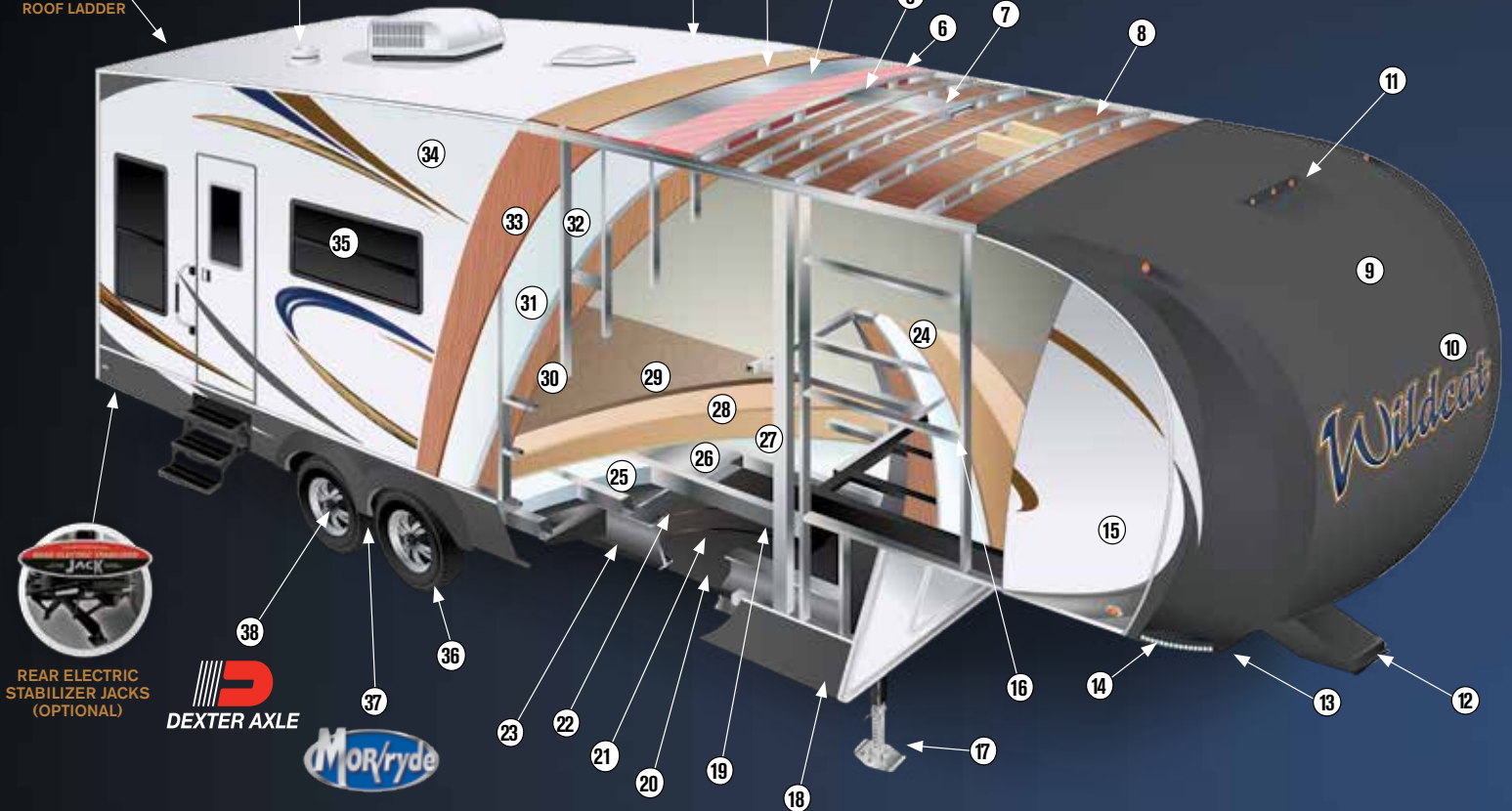

REAR ELECTRIC STABILIZER JACKS (OPTIONAL)



- |   |  |   |
|---|--|---|
| <ol style="list-style-type: none"> <li>1. Attic Vent</li> <li>2. One-Piece EPDM Rubber Roof Membrane (12 Year Warranty)</li> <li>3. 3/8" Roof Decking (Full Walk-On Roof)</li> <li>4. R+HEATSHIELD® Radiant Barrier Insulation</li> <li>5. 5" Arched Aluminum Rafters on 16" Centers</li> <li>6. Fiberglass Batt Roof Insulation (R-14)</li> <li>7. Triple Insulated, Foam-Core Air Conditioning Duct</li> <li>8. Laminated Vinyl Ceiling Decking with Luan Backer</li> <li>9. Aerodynamic Custom-colored Fiberglass Front Cap</li> <li>10. Custom Automotive-Grade Graphics Package</li> <li>11. Built-in LED Lights</li> <li>12. Extended Pinbox</li> <li>13. Optimized Turning Radius</li> </ol> | <ol style="list-style-type: none"> <li>14. Low Power/High Impact Exterior LED Lighting Kit</li> <li>15. 2" Thick ALUMACAT™ Vacuum-Bonded Fiberglass Laminated Sidewalls</li> <li>16. Welded CAD-Designed Cross Members</li> <li>17. Spring-Loaded Quick Release Jack Pins on Landing Gear Legs</li> <li>18. Full Radius-Wrap Aluminum Skirt Metal</li> <li>19. 3" Aluminum Floor Joists, 12" on Center</li> <li>20. Fully Enclosed Underbelly</li> <li>21. Woven Moisture And Vapor Barrier</li> <li>22. 50 Gallon Holding Tank with Black Tank Flush</li> <li>23. 8" or 10" Steel Rolled, Pre-Cambered, Powder-Coated I-Beam Chassis (N/A 297RLX)</li> <li>24. Fully Laminated and Insulated Upper Bath Deck</li> </ol> | <ol style="list-style-type: none"> <li>25. 3" Dense Block Foam Insulation</li> <li>26. 3" Large Capacity Insulated Heat Duct</li> <li>27. 3" Laminated Floor</li> <li>28. Premium Carpet Padding</li> <li>29. Residential-grade Shaw® Carpeting with R2X® Stain and Pet Guard</li> <li>30. Interior Decorative Wall Board</li> <li>31. Dense Block Foam Insulation (R-10)</li> <li>32. 2" Welded Tubular Aluminum Wall Studs</li> <li>33. Luan Backer</li> <li>34. Gel-Coated Filon Fiberglass Sidewall</li> <li>35. Best in Class Black Frame Tinted Safety Glass Windows</li> <li>36. 16" Custom Aluminum Wheels with Load Range 'E' 10-Ply Radial Tires</li> <li>37. MOR/ryde CRE 3000</li> <li>38. Dexter E-Z Lube Hub and Axles</li> </ol> |
|---|--|---|

## R+HEATSHIELD

Wildcat's radiant barrier insulation is made from a woven polyethylene material covered by a metalized film. This metalized film provides a reflective surface that blocks 94 percent of radiant heat, so it helps keep your RV cooler in summer and warmer in winter.

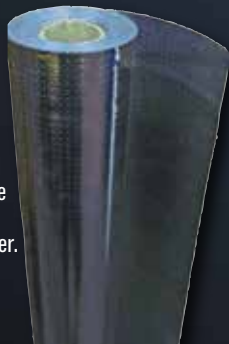

### 5" BARREL ROOF

Using new curved aluminum rafters in the roof, all Wildcat fifth wheels feature arched ceilings, adding much more interior height in bedrooms and giving a spacious barrel roof throughout the main floor.



# SETTING A NEW INDUSTRY STANDARD FOR STANDARD FEATURES

MORE STANDARD RESIDENTIAL AND BRAND NAME COMPONENTS AND FEATURES THAN ANY RV IN OUR CLASS!



A fully enclosed and lighted docking center, including outside shower and black tank flush, puts all your dump valves and connections in one place.



16" custom aluminum wheels with nitrogen-filled load range 'E' 10-Ply radial tires offer style and safety. Nitrogen reduces deterioration and helps maintain proper PSI over time.



Bus-style Slam-Latch™ baggage doors are hinged on the side for easier access to the expansive pass-through storage. Metal catches slam and lock on metal strike plates, unlike the plastic latches used by the competition.



Easy to use "one-touch" electric awnings (with fully adjustable arms) allow for quick setup and retraction at your camp site.



Low power, high impact exterior LED lighting is both highly visible and energy efficient. All of Wildcat's interior lighting is LED as well!



All Wildcats feature residential-grade Shaw® carpeting with patented and exclusive R2X® stain and pet guard.



Residential quality hardwood Cherry drawers use full-extension steel ball bearing drawer glides for greater access and support.



Many floor plans feature deep pot and pan drawers on full-extension steel ball bearing drawer glides.



A 4600 BTU fireplace with LED lighting technology, provides added warmth and ambiance. (Select models)



Wildcat's all new aerodynamic custom-colored fiberglass front cap, with built in LED lights, improves turning radius and helps cut fuel costs.



Wildcat's digital AV system features a 40" Toshiba™ HDTV connected via HDMI to a DVD/CD/AM/FM/USB stereo system with iPod® dock connector – a best in class feature.



All new Wildcats include a night light on padded, carpeted steps for safe and easy navigation through your coach after hours.



The MOR/ryde CRE 3000 suspension system uses a compression rubber equalizer for a smoother, safer ride.



Acrylic solid surface Corian® countertops by DuPont™ provide beauty without sacrificing function.



Residential quality Mastercraft™ swivel glider recliners ensure comfort and luxury where ever your travels may take you.



The 10 gallon DSI gas/electric quick recovery water heater (16.2 gallons per hour) provides an abundant supply of hot water and is great while dry-camping too.

A WILDCAT EXCLUSIVE

## WILDCAT - 337FB

Front Bunk

Outside Kitchen

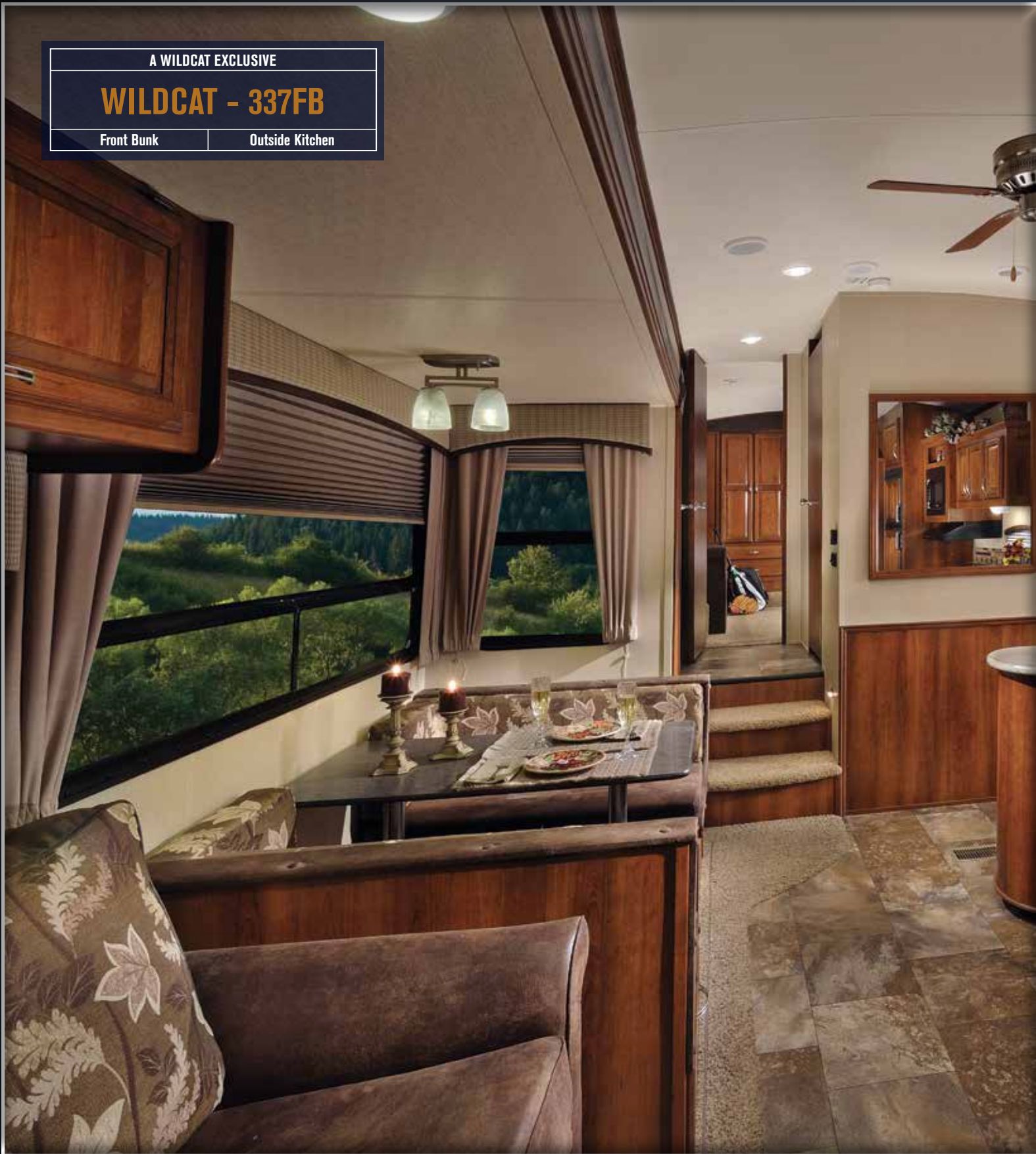

## ONLY IN A WILDCAT

The new 337FB front bunkhouse with standard Outside Kitchen, in Bark décor (above), is just one of many unique Wildcat floor plans. With a rear master bedroom and two standard air mattress hide-a-beds, this bunkhouse is designed for the whole family with plenty of room for friends.



Optional 110V ceiling fan



A



B



C



D

Wildcat's all new front bunkhouse floor plan features a large kitchen and living area (A), 8 cubic ft. refrigerator, built-in entertainment center, and a spacious rear master bedroom with residential 60" x 80" queen bed (B). The huge front bunkhouse (C) with standard air mattress hide-a-bed sofa and 34" x 74" bunks offers space for larger kids and even adults! The 337FB also features Wildcat's exclusive Jack-Knife Cooktop™ (D) folding/stowable dual burner stove with LP gas grill (and LP quick connect), 110v outside refrigerator (3.5 cu. ft.), fold-down ceiling TV bracket (with 110v/cable hook-up), countertop space with removable cutting board, 12v overhead lighting and a huge Slam-Latch™ door. Optional 24" LED TV shown.

# THE ALL NEW *Wildcat* STANDARD FEATURES

## EXECUTIVE CHEF KITCHEN

- Raised Panel Hardwood Glazed Cherry Cabinetry
- Residential Hidden Hinges
- Ergonomic Brushed Nickel Finish Door and Drawer Hardware
- Residential Full-Extension Steel Ball-Bearing Drawer Glides
- Raised 6 Panel Hardwood Glazed Cherry Refrigerator Door Front Insert
- **NEW!** 8 Cu. Ft. Refrigerator
- Storage Above Refrigerator (Select Models)
- Upgraded Microwave Oven with Built-in Spice Rack
- New! Brushed Nickel Finish Pull-out Residential Style Metal Sprayer Faucet
- **NEW!** Corian® Solid Surface Countertop (Kitchen)
- **NEW!** Extra Large Dual-Basin Kitchen Sink with Flush-mount Sink Covers
- Deep Storage Overhead Kitchen Cabinets
- Extra Large Pot and Pan Drawer Below Oven (Most Models)
- Extra Large Residential Pantry
- Toe Kicks in Kitchen Cabinet Base
- Upgraded Residential Congoleum® Linoleum
- **NEW!** 22" Oven and 3-Burner Range with Cover and Built-in Knife Rack (16" on 272RLX Only)
- Residential Style Range Vent with Light and Fan

## LIVING ROOM

- Booth Dinette with Pedestal Table (Converts to Bed, N/A 327CK)
- Full-Extension Storage Drawer under Booth Dinette
- Huge Panoramic Picture Window at all Dinettes (25% Larger!)
- Overhead Cabinets in the Slide Out (Dinner Plate Depth)
- Pleated Night Shades
- **NEW!** Air Mattress Hide-A-Bed Sofa
- 12V Jensen™ 975 AM/FM/CD/DVD/USB AV System with Remote and iPod® Hook-up
- **NEW!** 40" TOSHIBA™ Flat Panel HDTV with **HDMI™** Hook-up (Fully Digital! n/a 297RLX)
- 2" Thick Alumacat™ Vacuum bonded Laminated Slide Out (Including WALLS, CEILING, and END WALLS!)
- **NEW!** Taller Interior Slide Out Heights (More Head Room... up to 6'4"!)
- Satellite & Cable Hook-ups
- 12V Lighting in Slide Out (vs. 110V)
- **NEW!** All Chairs are Swivel Glider Recliners (Select Models)
- Slider Windows at Both Ends of Slide Out



- **NEW!** Interior LED Lighting (Low Power Draw, Cool, Efficient, High-Output!)
- Shaw® Residential Carpeting with R2X® Stain Guard

## BATHROOM

- Residential Porcelain Toilet with Foot Pedal Flush
- Extra Large Stainless Steel Lavatory Sink
- Fully Built-in Wood Medicine Cabinet
- GFI Receptcs in Bathroom
- Residential Tile Pattern Shower Surround
- Shower Skylight
- Residential Metal Shower Drains in Tubs and Showers (vs. Competitor's Plastic Drains)
- Power Vent Fan

## BEDROOM

- Inner Spring Residential Queen Bed
- Upgraded Residential Queen-size Bedspread and Headboard with Matching Pillows
- 6'4"+ Standing Height Throughout ENTIRE Bedroom (Most Interior Headroom and Floor Space in Class!)
- Hydraulic Struts To Lift the Bed Up for Storage (Select Models)
- Fully Finished Bed Bases

## EXTERIOR

- **NEW!** Aerodynamic Custom Colored Fiberglass Front Cap with Built-in LED Lighting
- LED Exterior Lighting
- **NEW!** Custom Colored Skirt Metal
- Spring-Loaded Quick Release Jack Pins on Landing Gear Legs
- One-Touch Adjustable Electric Awning
- Door Side Exterior Entertainment Center Hook-ups (cable and 110V Outlets)
- Dual Marine-grade Outside Stereo Speakers
- Adjustable Amplified TV Antenna
- 16" Custom Aluminum Wheels
- 16" Load Range 'E' 10-Ply Radial Tires (ST235/80/R16/E)
- **NEW!** Dexter EZ Lube™ Hub and Axles
- **NEW!** MOR/ryde CRE/3000™ Suspension System
- Molded Fender Skirts
- Custom Automotive-Grade Graphics Package
- Bus-style Side Hinged Slam-Latch™ Exterior Baggage Doors (with Metal Catches, Locks, and Strike Plates vs. Plastic used by Competition)
- Over-sized Pass Through Storage (Best in Class!)
- 12V Lighting in Pass-Through Storage
- Fully Enclosed and Lighted Universal Docking Center
- Outside Shower
- Patio Light

- Step Light at Main Entry Door
- Attic Vent
- Black Frame Tinted Safety Glass
- Cable/Satellite TV Hook-ups
- Quick Disconnect Marine-style Shore Cord
- Dual 30# LP Tanks Saddle-Mounted on Each Side of the Frame for Superior Weight Distribution
- Manual Stabilizer Jacks

### FOR YOUR SAFETY

- Manual Backup on all Main Slide Outs
- **NEW!** T-Mold Bulb Seals on all Slide Outs
- LP Leak Detector
- Smoke Detector
- Fire Extinguisher
- Carbon Monoxide Detector
- Nightlight on Stairs
- Custom Made Grab Handle at the Entry Door
- Lower Entry Steps with Step Lighting
- Folding Entry Handle
- Attic Vent
- Rear Ladder
- Spare 16" Load Range 'E' 10-Ply Radial Tire
- Scare Light

### UTILITIES

- **NEW!** 10 Gallon DSI Gas/Electric Quick Recovery Water Heater (16.2 Gallons per Hour)
- 30,000 BTU Furnace
- 13.5K BTU Ducted Air Conditioner
- Fully Ducted Air Conditioning with Triple Insulated, Foil Wrapped, Light Weight Ducts
- Black Tank Flush

### DRY CAMPING FEATURES

- Large Holding Tank Capacities (Largest in Our Class!)
- All Lights 12V (Including all Slide Out Lights)
- LED Exterior and Interior Lighting
- Space for Multiple Batteries
- Fully Enclosed Underbelly (Keeps Debris off Tanks, Water Lines, etc.)

### WILDCAT'S NEW AND IMPROVED 6 SIDED ALUMACAT™ CONSTRUCTION:

- 2" Thick Vacuum-Bonded Fiberglass Laminated Sidewalls (with Ultra Dense Block Foam Insulation)
- 2" Thick Vacuum-Bonded Fiberglass Laminated Slide Out (vs. Hollow, Hung Fiberglass)
- Gel-Coated Filon Fiberglass
- **NEW!** 5" Barrel Roof Truss System (Arched Ceiling Throughout Interior!)

- Extra Large Rolled Side Metal
- Black Frame Tinted Safety Glass Windows
- **NEW!** 3" Laminated and Insulated Floor (with Ultra Dense Block Foam Insulation)
- Fully Aluminum Framed, Laminated and Insulated Upper Bath Deck (6'4"+ Height)
- 3/8" Decked (Front to Back) Full Walk-On Roof

### WILDCAT'S CLIMATECH™ COLD WEATHER INSULATION PACKAGE:

- R-10 Ultra Dense Block-foam Side Wall Insulation
- R-14 Fiberglass Batt Roof Insulation
- R+HEATSHIELD™ Radiant-Barrier Insulation (Blocks 94% of Radiant Heat Transfer!)
- Fully Enclosed, Heated and Insulated Underbelly and Valves
- Duct Heated Holding Tanks
- Insulated Bedroom and Bunk Room Floors (R-10 vs. no Insulation in Competition)
- Insulated and Heated Full Pass-Through Storage

### WILDCAT FIFTH WHEEL OPTIONS

- Rear Electric Stabilizer Jacks
- **NEW!** 110V Ceiling Fan
- Hardwood Free Standing Table (with Slide-out Leaf ) and 4 Chairs with Under Seat Storage
- 50 Amp Service & 2nd A/C Prep (MANDATORY on 313RE, 317RL, 327CK, 337FB, and 344QB)
- 15K BTU Ducted Roof A/C (in Place of Standard 13.5K A/C)
- **NEW!** 2nd 13.5K A/C (Requires 50 Amp Service Option)
- La-Z-Boy® Recliner Set (2)
- **NEW!** Folding Bike Rack
- **NEW!** Washer/Dryer Prep (313RE, 317RL, 327CK, 344QB)
- Jack-Knife Cooktop™ Outside Kitchen (312BHX and 344QB Only, STANDARD on 293REX, 317RL, and 337FB!)
- Custom 110V Outside Refrigerator (312BHX without Outside Kitchen Only)
- 24" LED HDTV (Outside Kitchen or Bunkhouse Location)
- **NEW!** 32" TOSHIBA® HDTV in Master Bedroom Location
- **NEW!** J-Lounge Sofa (282RKX Only in Place of Recliners)
- Dual-Pane Windows
- CSA Seal (Canadian Dealers Only)



272RLX

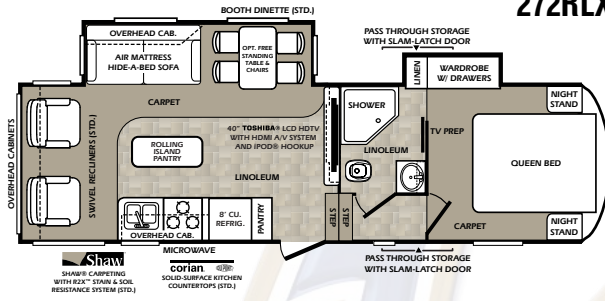

282RKX

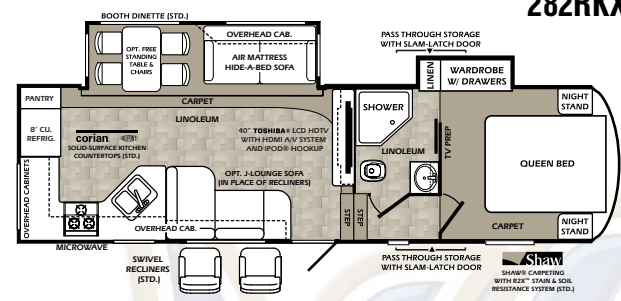

293REX

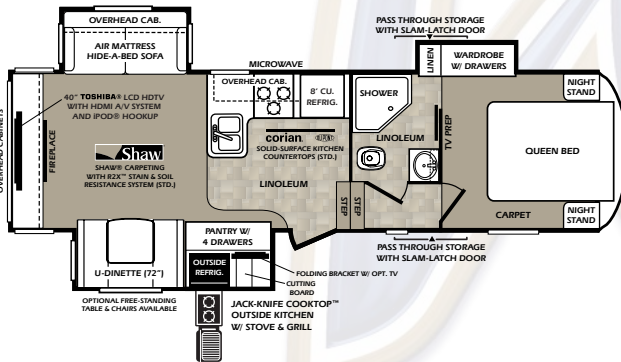

297RLX

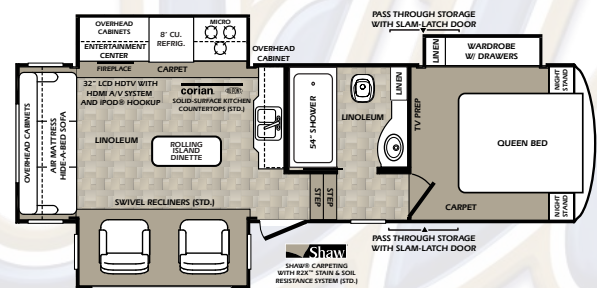

312BHX

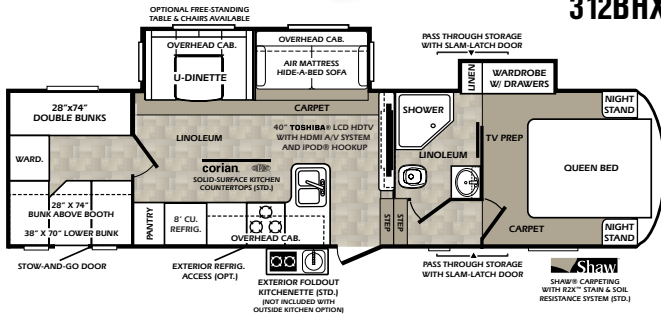

312BHX-OK

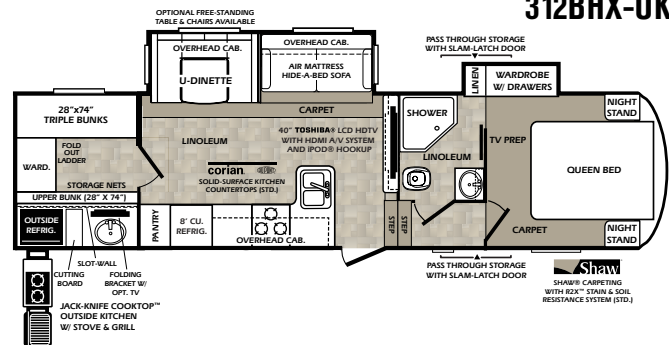

MODEL	272RLX	282RKX	293REX	297RLX	312BHX	312BHX-OK
LENGTH	30' 4"	31' 0"	31' 3"	31' 6"	33' 10"	33' 10"
DRY WEIGHT (LBS.)	7,855	7,980	8,510	8,515	8,220	8,550
HITCH WEIGHT (LBS.)	1,505	1,280	1,440	1,785	1,560	TBA
CCC (LBS.)	3,751	3,401	3,271	2,011	3,441	3,111
HEIGHT	12' 6"	12' 6"	12' 6"	12' 6"	12' 6"	12' 6"
L.P. CAPACITY	2x 30 lbs.	2x 30 lbs.	2x 30 lbs.	2x 30 lbs.	2x 30 lbs.	2x 30 lbs.
SLEEPING CAPACITY	6	6	6	4	10	10
FRESH WATER GALLONS	60	60	60	47	60	60
TOTAL WASTE GALLONS (G,B)	150 (100,50)	150 (100,50)	150 (100,50)	70 (35,35)	200 (150,50)	200 (150,50)
TIRE SIZE	ST235/80R16/E	ST235/80R16/E	ST235/80R16/E	ST235/80R16/E	ST235/80R16/E	ST235/80R16/E

### 313RE

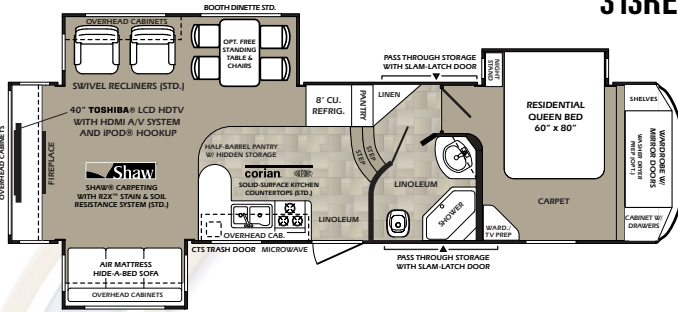

### 317RL

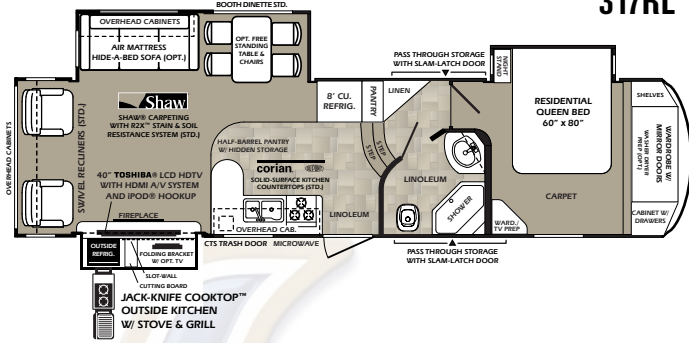

### 327CK

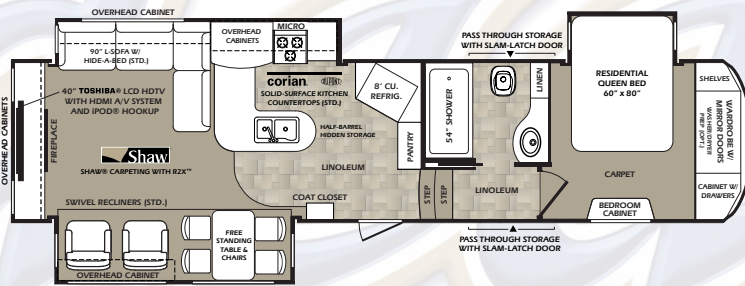

### 337FB

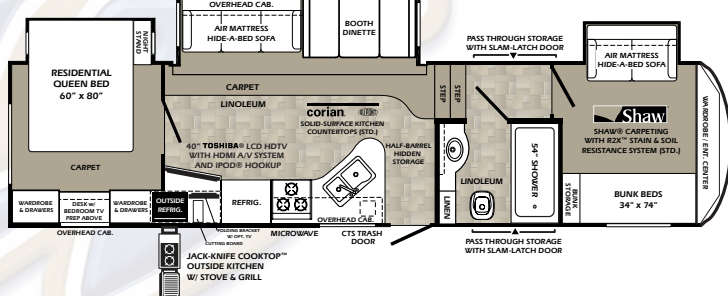

### 344QB

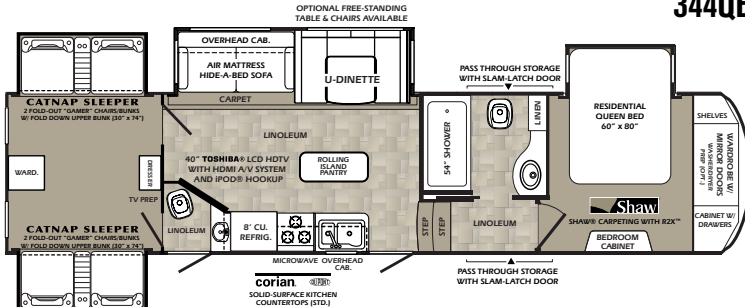

### 344QB-OK

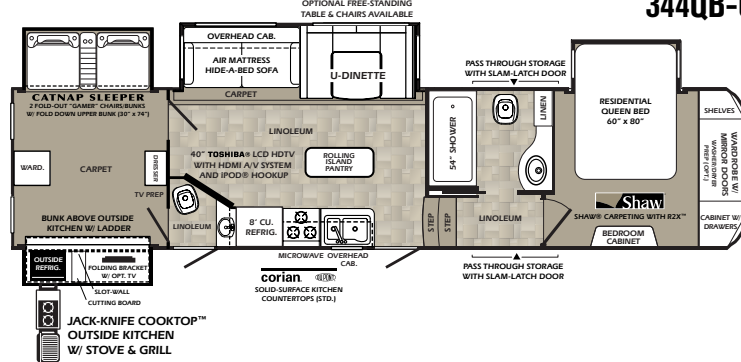

MODEL	313RE	317RL	327CK	337FB	344QB	344QB-OK
LENGTH	34' 8"	35' 3"	37' 6"	38' 7"	38' 9"	38' 9"
DRY WEIGHT (LBS.)	9,855	10,185	10,020	10,696	10,550	10,880
HITCH WEIGHT (LBS.)	1,715	TBA	1,650	2,135	1,675	TBA
CCC (LBS.)	1,961	TBA	1,971	1,780	3,066	TBA
HEIGHT	12' 6"	12' 6"	12' 6"	12' 6"	12' 6"	12' 6"
L.P. CAPACITY	2x 30 lbs.	2x 30 lbs.	2x 30 lbs.	2x 30 lbs.	2x 30 lbs.	2x 30 lbs.
SLEEPING CAPACITY	6	6	4	10	12	10
FRESH WATER GALLONS	60	60	60	60	60	60
TOTAL WASTE GALLONS (G,B)	150 (100,50)	150 (100,50)	150 (100,50)	150 (100,50)	200 (100,100)	200 (100,100)
TIRE SIZE	ST235/80R16/E	ST235/80R16/E	ST235/80R16/E	ST235/80R16/E	ST235/80R16/E	ST235/80R16/E

## DECOR OPTIONS

HAZELNUT



STEEL



BARK



LAUREN



### PRE-DELIVERY INSPECTION FACILITY

20,000 square feet of quality assurance. The bare essentials for a premium product. This state-of-the-art facility gives immediate daily feedback to production for quality assurance in every unit built.

### 24/7 EMERGENCY ROADSIDE ASSISTANCE

For a worry-free ownership experience Forest River includes one

## Coach-Net<sup>®</sup>

RV Technical & Roadside Assistance

year of Coach-Net RV Technical & Roadside Assistance with each RV purchase. Whether new to the RV lifestyle or an experienced RV enthusiast, Forest River owners have 24/7 access to technical, operational and emergency road service coverage throughout the US & Canada. Coach-Net's fast, dependable service is just a phone call away.



Visit our facebook page:  
[www.facebook.com/WildcatRV's](http://www.facebook.com/WildcatRV's)

# Wildcat

Forest River, Inc. • Wildcat Division  
57475 County Road 3 • Elkhart, IN 46517 • (574) 389-3232  
[www.forestriverinc.com/wildcat](http://www.forestriverinc.com/wildcat) • [www.forestriveraccessories.com](http://www.forestriveraccessories.com)



**Learn More**  
Scan this barcode using a QR Reader on your smart phone to learn more about Forest River.



A Berkshire Hathaway company.



Forest River, Inc. encourages our customers to purchase their Forest River products from a local dealership whenever possible for the following reasons:

- 1) Forest River, Inc. dealers are independently owned and operated businesses so priority service and scheduling is at their discretion and is often provided to customers that purchased their unit at that dealership.
- 2) Purchasing locally allows customers to establish meaningful relationships with a dealer, enhancing the RV experience through assistance with product questions, user tips or RV regulations for your state or country, and much more!
- 3) Canadian customers must meet requirements to bring an RV purchased out of the country to their home. These requirements may involve additional inspections and certifications, taxes and fees. Your local Canadian Dealer is a professional at meeting these requirements.
- 4) Scheduling timely warranty repairs and adjustments through a local dealership provides far greater flexibility and convenience to you, the customer!

It is the goal of Forest River, Inc. that all of our RV owners fully enjoy the RV experience and that customer satisfaction meets or exceeds their expectations!

### YOUR WILDCAT DEALER