

# KOMFORT

*By Dutchmen*

THE LEGACY LIVES ON

KOMFORT



# KOMFORT



Front Lounge 3650FFL  
in Trackstopper Decor



3650FFL  
Kitchen



3650FFL Kitchen  
and Front Lounge

## Stunning Contemporary Interior Design

*Komfort's new "Front Lounge" floor plan features an expansive 6' 8" upper deck crowned ceiling, with taller slide rooms that make way for expansive windowscaping providing plenty of natural light and incredible views.*

*You'll feel right at home with Komfort's roomy kitchen featuring a slide room that includes the dinette and standard 12 cu ft 4 door refrigerator and a flip down desk that could be used as an appliance center.*





*Komfort's custom furniture includes a combination lounge sofa, dinette, air mattress bed and large storage drawers.*



## Genuine Maple Hardwood Doors and Drawers

*Komfort features elegant European style hardware. The hidden hinges are fully adjustable and spring loaded to keep cabinets closed tightly.*



*Beautiful  
Residential  
Hardware*



*Hidden Hinges*

*75 Lb. Capacity  
Full Extension  
Drawer Glides* ▶



◀ *Solid Surface  
Counter Tops*

*High end solid surface counter tops, undermount stainless steel sink and a deluxe pull out sprayer/faucet are standard features on Komfort. This feature is only available for Fifth Wheels.*





3130FRL

*Komfort's 3130FRL floor plan features massive amounts of countertop space for even the most discriminating chef. The taller slide again allows us to use larger windows that provides plenty of natural light and incredible views. Beautiful Beauflor flooring continues from the door all the way to the recliners.*



6

3130FRL



3130FRL in Buchshot Decor

## Stunning Bedroom Suites and Spacious Baths

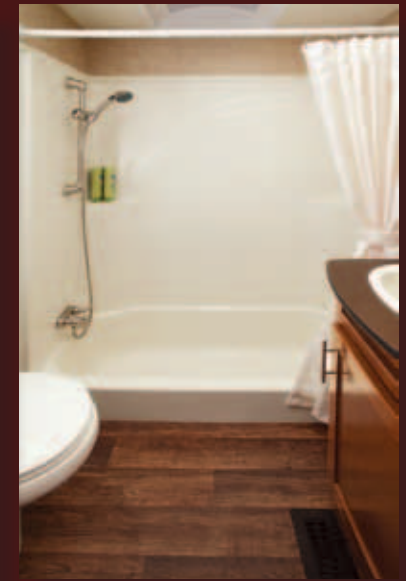

*Step Down  
Shower and Tub  
(3530FBH only)*



## 6'8" CEILING HEIGHT IN BEDROOM

*Komfort's fifth wheel bedroom design includes two industry firsts! An innovative, laminated, crowned ceiling design and the cedar suite full walk-in closet.*

*The arched ceiling design provides for more headroom than any other product in its class, a full 6'8". Plus, increased headroom in the bedroom allows our slide rooms to be taller than most competitors.*

*The cedar suite walk in closet utilizes the entire front cap area to create the largest amount of hanging space, a dedicated shoe rack, shirt wardrobes and sliding drawers. Plus, the storage area is prepped for a washer and dryer.*

3130FRL

# Stacked Rail Chassis



**1" Thick Insulated Baggage Doors with Slam Latch Hardware**



Komfort fifth wheels feature a stacked rail chassis design. This chassis design uses double I-beam frame rails to increase the amount of storage space under the bath/bedroom deck. Many models feature an amazing 150 cubic feet of storage – almost 60% more than the competition!

# Endless Komfort Package



**Heated/Enclosed Underbelly**

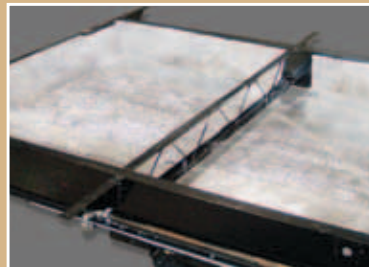

Heated, insulated and enclosed underbelly tanks & valves are all standard on Komfort travel trailers and fifth wheels.

### R VALUES

- R40 in roof, floor and behind front cap
- R24 in slide room floors
- R9 in walls

# 90° Extended Turning Radius Front Cap



Komfort's expanded turning radius front cap includes a back-up mirror and LED lights to make hitching-up a breeze.

Perfect for extended cab or short bed trucks.

# Komfort Power Package

Komfort's power package includes a multi function remote control for power accessories. Plus, a 10 gallon water heater and 8 cu. ft. refrigerator. Standard on fifth wheels.

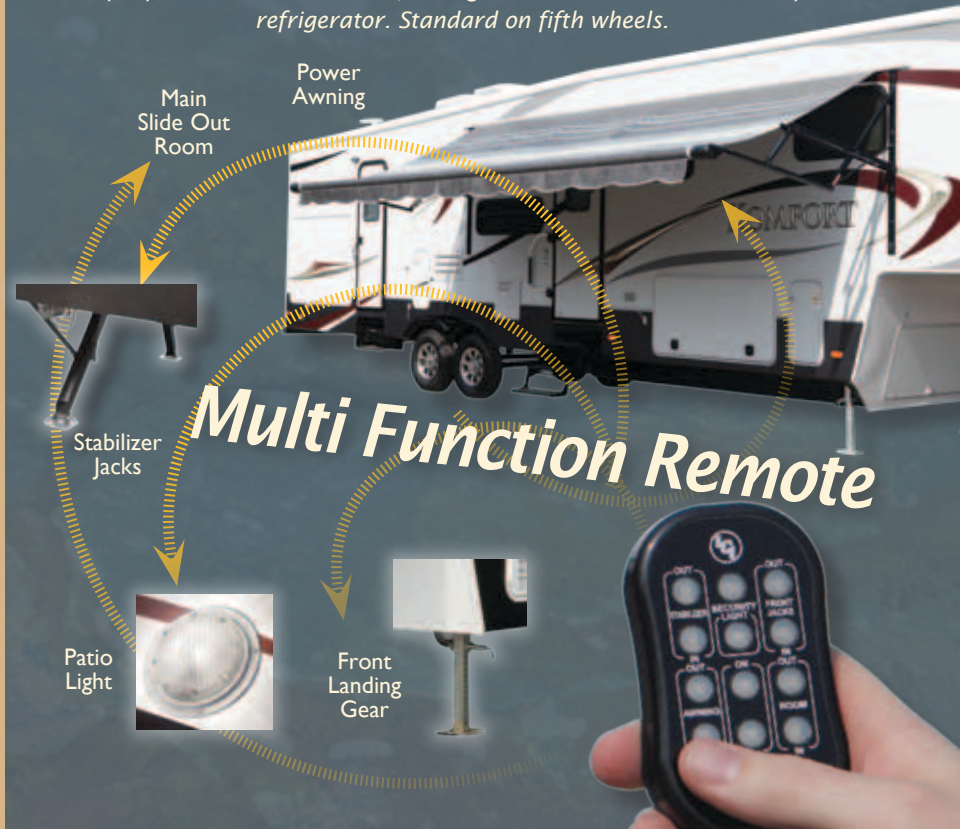

# Multi Function Remote



## Premium Entertainment System



Komfort's Premium Entertainment System features the latest technology in the industry. Fifth wheels include a 32" LCD HD wide screen TV and a Sony® 5.1 Dolby® digital stereo system with sub woofer and five surround sound speakers. The system also includes an AM/FM/CD/DVD player with an IPOD® docking station. Travel trailers feature a 32" LCD HD (26" in 3050QB) wide screen TV and a 12 volt AM/FM/CD/DVD player with IPOD® inputs.

## Central Command Center

Our central command center groups together all of your essential interior and exterior light switches, tank monitors, awning controls and water heater switch.



## Premium Flooring



Beauflor® Premium vinyl flooring is designed to withstand extreme weather changes—excessive cold or heat. Plus it is more durable than any other vinyl flooring. Notice how Komfort runs the Beauflor® throughout the coach—less carpet to clean!

## Washer Dryer Prep



Washer dryer prep is a standard feature on Komfort fifth wheels. (Not available on 3130FRL).

## Decor Choices

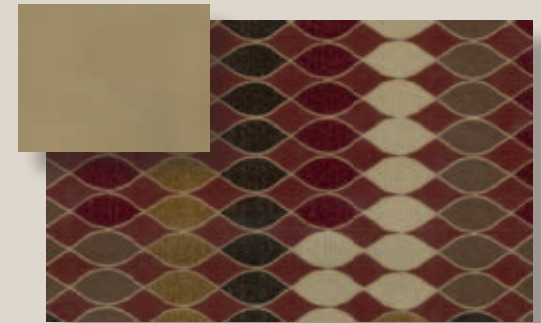

### Buckshot



### Trackstopper



### Circles Galore

## Fifth Wheel Utility Docking Station



- Fresh and City Water Fills
- Black Tank Flush
- By-Pass Valves
- 110V Outlet, Light, Cable and Satellite TV Hookups
- Quick Connect Hose with Sprayer

## Trail-Air Equa-Flex Suspension



Trail-Air Equa-Flex rubber equalizer suspension system is standard on Komfort fifth wheels. The system protects your investment by allowing axles to travel independently to reduce road vibrations and create a smoother ride.

# Travel Trailers

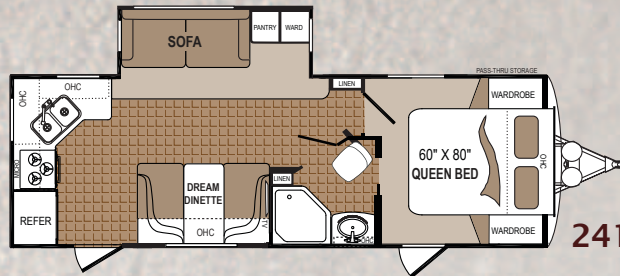

**2410RK**

**Unloaded Weight (lbs)** ..... 6,627  
**Hitch Weight (lbs)** ..... 711  
**Cargo Capacity (lbs)** ..... 1,773  
**Overall Height w/AC** ..... 11' 6"  
**Overall Length** ..... 29' 4"

**Fresh Water Tank(s)** ..... 52  
**Black Water Tank(s)** ..... 42  
**Grey Water Tank(s)** ..... 84  
**Furnace BTU Output** ..... 30,000

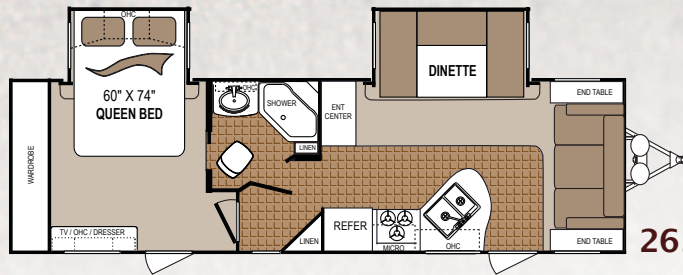

**2650FL**

**Unloaded Weight (lbs)** ..... 7,326  
**Hitch Weight (lbs)** ..... 1,134  
**Cargo Capacity (lbs)** ..... 3,850  
**Overall Height w/AC** ..... 11' 6"  
**Overall Length** ..... 32' 7"

**Fresh Water Tank(s)** ..... 46  
**Black Water Tank(s)** ..... 42  
**Grey Water Tank(s)** ..... 42  
**Furnace BTU Output** ..... 30,000

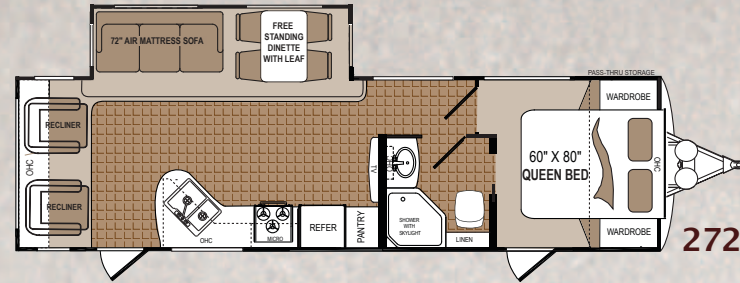

**2720RL**

**Unloaded Weight (lbs)** ..... 7,212  
**Hitch Weight (lbs)** ..... 963  
**Cargo Capacity (lbs)** ..... 3,964  
**Overall Height w/AC** ..... 11' 6"  
**Overall Length** ..... 34'

**Fresh Water Tank(s)** ..... 52  
**Black Water Tank(s)** ..... 42  
**Grey Water Tank(s)** ..... 42  
**Furnace BTU Output** ..... 30,000

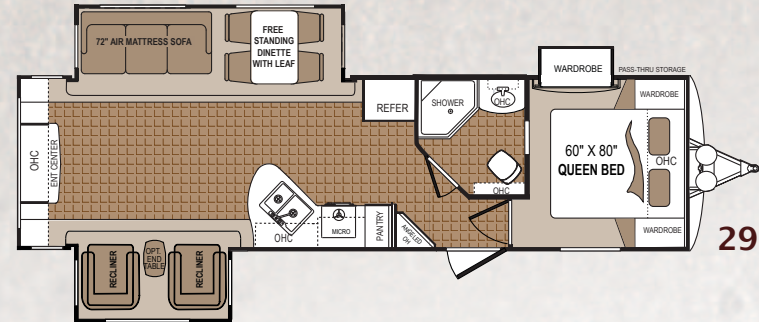

**2955RE**

**Unloaded Weight (lbs)** ..... 8,212  
**Hitch Weight (lbs)** ..... 950  
**Cargo Capacity (lbs)** ..... 2,964  
**Overall Height w/AC** ..... 11' 6"  
**Overall Length** ..... 35' 2"

**Fresh Water Tank(s)** ..... 52  
**Black Water Tank(s)** ..... 42  
**Grey Water Tank(s)** ..... 42  
**Furnace BTU Output** ..... 30,000

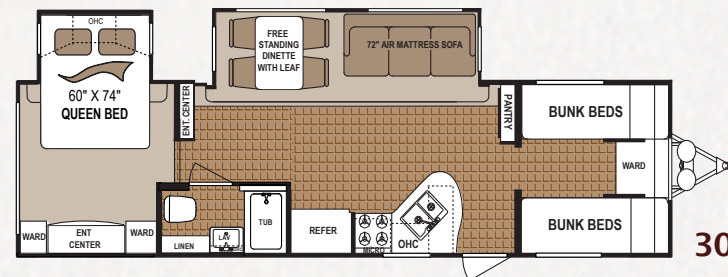

**3050QB**

**Unloaded Weight (lbs)** ..... 8,017  
**Hitch Weight (lbs)** ..... 1,148  
**Cargo Capacity (lbs)** ..... 3,159  
**Overall Height w/AC** ..... 11' 6"  
**Overall Length** ..... 34' 8"

**Fresh Water Tank(s)** ..... 52  
**Black Water Tank(s)** ..... 42  
**Grey Water Tank(s)** ..... 42  
**Furnace BTU Output** ..... 30,000

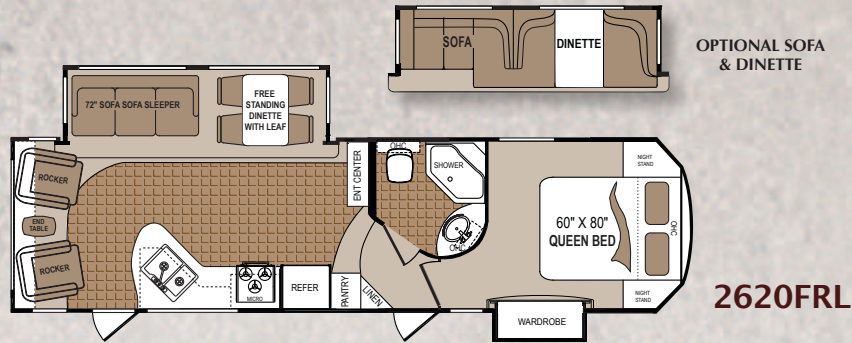

|                             |         |                           |        |
|-----------------------------|---------|---------------------------|--------|
| Unloaded Weight (lbs) ..... | 8,617   | Fresh Water Tank(s) ..... | 57     |
| Hitch Weight (lbs) .....    | 1,675   | Black Water Tank(s) ..... | 33     |
| Cargo Capacity (lbs) .....  | 1,943   | Grey Water Tank(s) .....  | 66     |
| Overall Height w/AC .....   | 12'     | Furnace BTU Output .....  | 30,000 |
| Overall Length .....        | 31' 10" |                           |        |

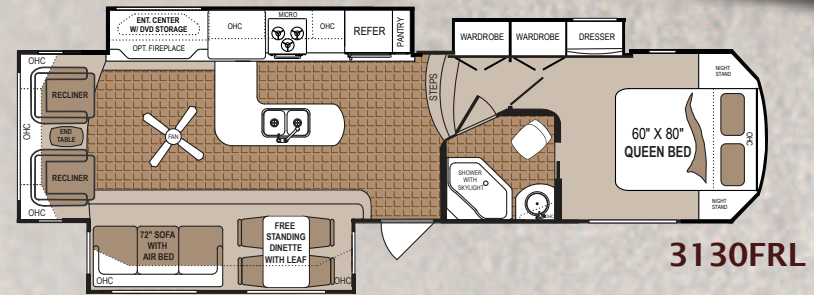

|                             |        |                           |        |
|-----------------------------|--------|---------------------------|--------|
| Unloaded Weight (lbs) ..... | 10,044 | Fresh Water Tank(s) ..... | 67     |
| Hitch Weight (lbs) .....    | 2,127  | Black Water Tank(s) ..... | 48     |
| Cargo Capacity (lbs) .....  | 5,050  | Grey Water Tank(s) .....  | 48     |
| Overall Height w/AC .....   | 12' 7" | Furnace BTU Output .....  | 34,000 |
| Overall Length .....        | 35'    |                           |        |

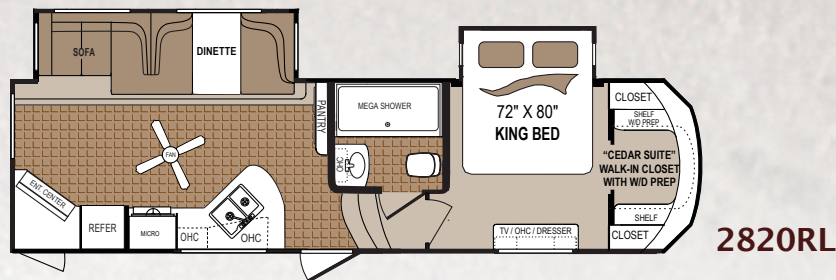

|                             |       |                           |        |
|-----------------------------|-------|---------------------------|--------|
| Unloaded Weight (lbs) ..... | 9,563 | Fresh Water Tank(s) ..... | 57     |
| Hitch Weight (lbs) .....    | 1,970 | Black Water Tank(s) ..... | 48     |
| Cargo Capacity (lbs) .....  | 5,937 | Grey Water Tank(s) .....  | 48     |
| Overall Height w/AC .....   | 12'   | Furnace BTU Output .....  | 30,000 |
| Overall Length .....        | 32'   |                           |        |

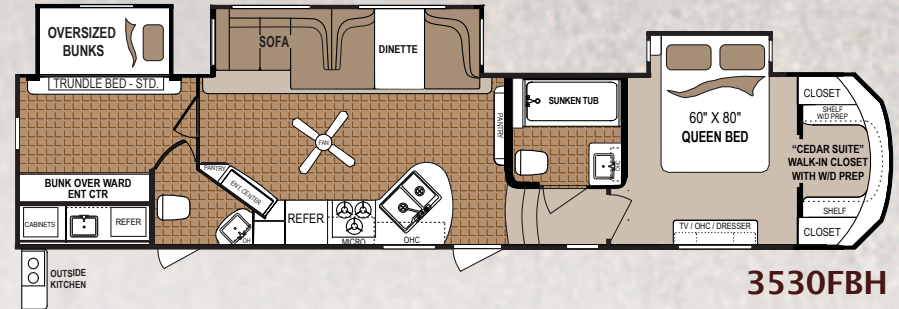

|                             |        |                           |        |
|-----------------------------|--------|---------------------------|--------|
| Unloaded Weight (lbs) ..... | 11,640 | Fresh Water Tank(s) ..... | 67     |
| Hitch Weight (lbs) .....    | 2,526  | Black Water Tank(s) ..... | 96     |
| Cargo Capacity (lbs) .....  | 3,860  | Grey Water Tank(s) .....  | 96     |
| Overall Height w/AC .....   | 12' 7" | Furnace BTU Output .....  | 34,000 |
| Overall Length .....        | 40'    |                           |        |

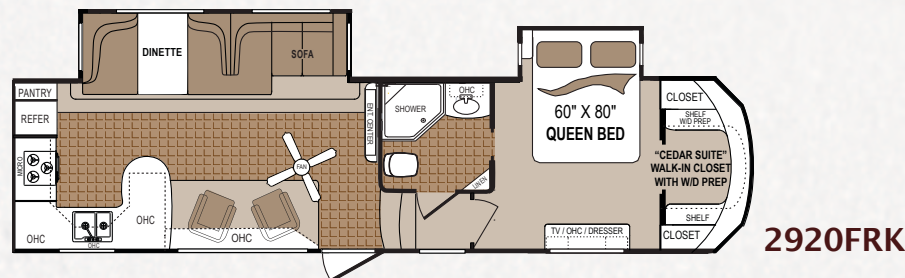

|                             |         |                           |        |
|-----------------------------|---------|---------------------------|--------|
| Unloaded Weight (lbs) ..... | 10,044  | Fresh Water Tank(s) ..... | 67     |
| Hitch Weight (lbs) .....    | 2,212   | Black Water Tank(s) ..... | 48     |
| Cargo Capacity (lbs) .....  | 5,456   | Grey Water Tank(s) .....  | 96     |
| Overall Height w/AC .....   | 12' 10" | Furnace BTU Output .....  | 34,000 |
| Overall Length .....        | 34' 4"  |                           |        |

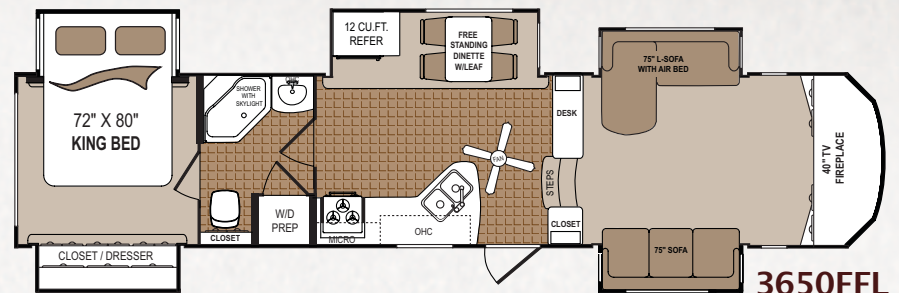

|                             |        |                           |        |
|-----------------------------|--------|---------------------------|--------|
| Unloaded Weight (lbs) ..... | 12,034 | Fresh Water Tank(s) ..... | 57     |
| Hitch Weight (lbs) .....    | 2,463  | Black Water Tank(s) ..... | 48     |
| Cargo Capacity (lbs) .....  | 3,466  | Grey Water Tank(s) .....  | 96     |
| Overall Height w/AC .....   | 12'    | Furnace BTU Output .....  | 34,000 |
| Overall Length .....        | 40' 2" |                           |        |

# Standard and Optional Features

## Komfort Platinum Exterior Package

- Platinum Fiberglass Exterior
- Fully Laminated Side and Rear Walls
- Frameless Windows
- 16" Load Range "E" Radial Tires\*
- 15" Radial Tires Std (Travel Trailers)
- Equa-Flex Suspension\*
- Easy Lube Axles
- "Eye Sight" Hitch-Vision Fiberglass Front Cap with Expanded Turning Radius\* (Fifth Wheels)
- Fiberglass Front Cap
- LED Loading Lights on Front Cap
- Stacked Rail Chassis Construction\*
- Sewer Hose Storage
- Slam Latches on Primary Baggage Doors\*
- Central Convenience Center\*
- 6'4" Tall Entry Door With "Welcome Back" Light\*
- LP Quick Disconnect
- Rear Ladder\* (Option on TT's)
- Tinted Safety Glass Windows
- Pivoting Entry Handle
- Front and Rear Stabilizer Jacks
- Electric Patio Awning
- Exterior 110V and Cable Connections
- Detachable Power Cord - 30 Amp TT's, 50 Amp FW's

## Komfort Platinum Interior Package

- Beauflor® "No Crack" Premium Flooring
- Halogen Ceiling Lighting\*
- Crowned Roof on Upper Deck\*
- Crowned Roof Throughout (TT's)
- Residential Wood Window Blinds in Living Area
- Wrought Iron Window Treatments with Curtains
- Maple Cabinetry with Hidden Hinges
- Upgraded Contemporary Styled Furniture
- Air Mattress Hide-A-Bed Sofa
- Solid Surface Kitchen Counter Tops\*
- Stainless Steel Kitchen Sink with Pull Out Sprayer\*
- "Cedar Suite" Walk In Closet (Most Models)\*
- Washer/Dryer Prep (Most Models)\*
- Designer Wall Board in Slide Rooms\*
- Residential Cove Molding At Ceiling
- Chair Rail in Living Area

## Komfort "Power Package" STD - FW's,

- Wireless Remote Control System: (Operates)
  - Power Front Landing Gear
  - Power Rear Stabilizers
  - Power Front and Rear Stabilizer (TT's)
  - Power Patio Awning
  - Exterior Patio Light
  - Main Slide Out Room
- 8 Cubic Foot Refrigerator
- 10 Gallon Gas/Electric/DSI Water Heater

## Endless Komfort Package

- Extra Large Furnace
- Heated and Enclosed Underbelly and Plumbing
- Radiant Foil Insulation in the Roof, Floor and Front Cap

## Other Exterior Features

- Leaf Spring Suspension with Equa-Flex\*
- Outside Speakers (TT's)
- Hitch Light
- 6'4" Entry Door\*
- "Welcome Back" Lighted Door
- LP Cover (TT's)
- 30 Pound LP Bottles
- Extended Down Spouts
- TV Antenna
- Vented Attic
- Triple Entry Step

## Other Interior Features

- Central Vacuum\* (Req Opt)
- Beauflor® Flooring
- Night Shades In Bedroom
- Bath Skylight
- Glass Shower Door (See Floorplans)
- Tub/Shower Surround (See Floor Plans)
- Toilet Tissue Holder
- 12V Bath Exhaust Fan
- Convection Microwave\*
- Large Oven (TT's)

## Other Interior Features (Continued)

- 3 Burner Cook Top
- 10 Gallon Gas/Electric/DSI Water Heater
- Sony 5.1 Surround Sound System with AM/FM/CD DVD Player (Fifth Wheels)
- AM/FM/CD/DVD Stereo (Travel Trailers)
- Cable and Satellite Prep
- Bedroom TV Hookup with LCD TV Prep
- 13,500 BTU Ducted AC (TT's)
- 15,000 BTU AC (STD FW's, OPT TT's)
- 8 Cu. Foot Double Door Refer (STD FW's, OPT TT's)

## Options

- Bedroom Fireplace (3650 Only)
- Ground Control Auto Leveling System\*
- Exterior Stereo with MP3 Connections\*
- Queen Bed with Nightstands IPO King (3650 & 2820)
- Free Standing Dinette W/4 Chairs (STD on 2720, 2955, 3050, 3130)
- 12 Cubic Foot Side-By-Side Refer (STD in 3650)\* (N/A & 3530)
- Solid Wood Refrigerator Front
- Solid Surface Sink Covers\*
- 21" Oven\*
- Dual Pane Windows
- Fireplace\* (STD on 3650)
- Maxx Air Fan with Rain Sensor in Bedroom
- Electric Tongue Jack (TT's)
- Pull Out Bike Rack
- Rear Ladder\* (STD FW's, OPT TT's)
- 15K BTU AC (STD FW's, OPT TT's)
- Second AC\*
- Hide-A-Bed Sofa in Bunk Room (3530)
- Recliner/Glider IPO Swivel Rockers (TT's)
- Super Sofa (Not available on 3130)
- Twin Convert-A-Lounge (3530 only)
- 22" LCD Bedroom TV
- Generator Prep\*
- Aluminum Wheels

\* Fifth Wheels Only

## "Extreme Weather" Pressurized Rain Bay Testing



Komfort travel trailers and fifth wheels are tested in a state-of-the-art pressurized rain bay. Units are drenched with pressurized water sprayed on all sides of the coach to simulate the harshest weather conditions.

All units are tested with slides in the in and out position, with over 4000 gallons of water used in each test to assure a water tight unit.

## Real Weights!



Did you know that every Komfort is weighed at the factory as it leaves the production line? Our certified Acu-Weight includes options!

Most competitors publish only a base weight that does not include options. Make sure that you know what the "REAL" weight of the unit is before you buy your next travel trailer or fifth wheel.

## Your Local Dealer

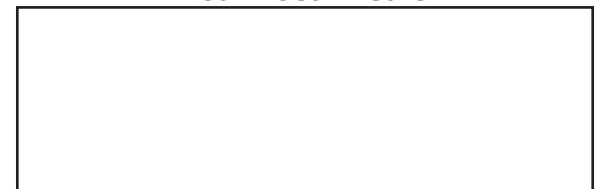

Follow "DutchmenRV" on



[www.Komfort-RV.com](http://www.Komfort-RV.com)



P.O. BOX 2164 • 2164 Caragana Court  
Goshen, Indiana 46526

Sales: 574.537.0600 • Fax: 574.975.6274

Product information is as accurate as possible as of the date of publication of this brochure. Features, floor plans and specifications are subject to change without notice. Please also consult Dutchmen's website at [www.DUTCHMEN.com](http://www.DUTCHMEN.com) for more current product information and specifications. Tow Vehicle Disclaimer CAUTION: Owners of Dutchmen recreational vehicles are solely responsible for the selection and proper use of tow vehicles. All customers should consult with a motor vehicle manufacturer or their dealer concerning the purchase and use of suitable tow vehicles for Dutchmen products. Dutchmen disclaims any liability or damages suffered as a result of the selection, operations, use or misuse of a tow vehicle. Dutchmen's limited warranty does not cover damage to the recreational vehicle or the tow vehicle as a result of the selection, operation, use or misuse of the tow vehicle.