

SEISMIC TOY HAULERS BY JAYCO

seismic



Quality

built for

YOUR ADVENTURE



Jayco®

MIDDLEBURY, IN

# PREMIUM PAINT



HORIZON



STORM



DESERT

*reinvent ...*

- ✓ YOUR TOYBOX
- ✓ YOUR GARAGE
- ✓ YOUR BEDROOM
- ✓ YOUR HOBBY
- ✓ YOUR PATIO



## YOU WANT PEACE OF MIND

That's why we offer our exclusive 2-year Co-Pilot Warranty, the industry's best and most comprehensive warranty program.

seismic

SEISMIC® TOY HAULERS BY JAYCO®

# REINVENT YOUR SPACE

Toy haulers, you've seen them. Property of the extreme enthusiast. But who says you have to be extreme to play with the best toys? Get ready for the Jayco Seismic — the toy hauler that redefines the category — and the people who own it. Boasting an ambitious list of extraordinary features, including three optional paint schemes, the Jayco Seismic is designed for more than just the typical off-roading enthusiast. It's designed for you, packed with everything you would expect in a traditional fifth wheel, but in a design that transforms the toy hauler landscape.



## WITH YOUR PURCHASE

Every Jayco RV undergoes rigorous quality control testing before it leaves the factory, so you can be confident your new Jayco will continue to provide the ultimate in reliability for years to come.

For a copy of our 2-year limited warranty with full terms and conditions, ask your local Jayco dealer.



TO LEARN MORE ABOUT  
OUR QUALITY CONTROL  
TESTING, SCAN HERE WITH  
YOUR SMARTPHONE.



SEISMIC 3210 | CANYON



SEISMIC TOY HAULERS

# CONTEMPORARY COMFORTS

Extra tall slideouts, curved walls and extendable dinettes give you the room you need, while a full-featured kitchen, boasting Glazed Maple cabinetry, high-gloss, solid-surface countertops and 8 cu. ft. double-door refrigerator, equip you with every kitchen comfort.



CARGO SCREEN



FUEL STATION

*exterior details*



SEISMIC 3914 | STONE



SEISMIC 3914 | STONE

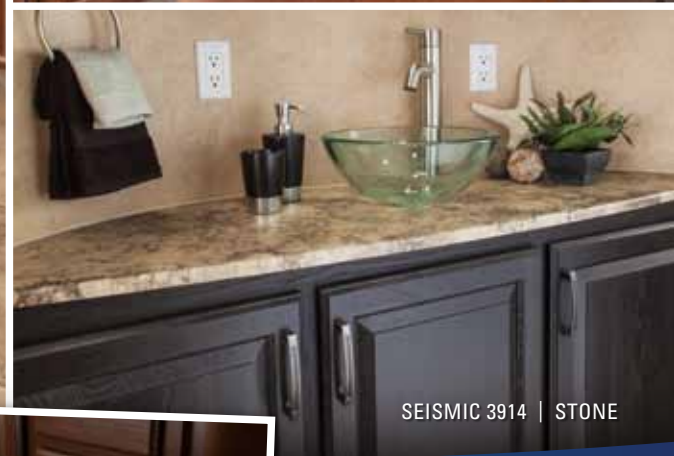

SEISMIC 3914 | STONE

## interior details



U-DINETTE WITH EXTENDABLE SEATING



SILENT GLIDE DAY/NIGHT SHADES



TOE-KICK CABINET LIGHTING

# jayco CONSTRUCTION

At Jayco, we've built a reputation for superior construction and quality craftsmanship. We pride ourselves on always using top-quality materials and innovative manufacturing techniques. That commitment has led to our latest construction advancement, the all-new exclusive Magnum Roof System, 50 percent stronger than other roofs in the industry, built to outlast everything but your memories.



## OUR NEW ROOF FEATURES ...

- 1 4 1/2" crowned wood trusses: Uses 2"x 2" vertical studs to maximize load capacity, while oversized nail plates provide a tighter design
- 2 3/8" roof decking, screwed down at every seam: More durable than typical stapled construction, provides fully walkable roof
- 3 Residential attic-style insulation: Maintains interior temperatures while allowing for room to run wiring, reducing risky electrical shorts
- 4 One-piece, sidewall-wrapped Alpha Ply material: Provides leak protection



## INTERIOR DÉCOR CHOICES

### ECLIPSE

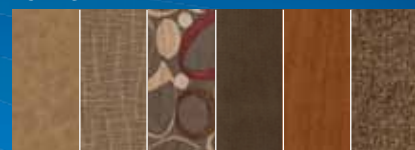

### STONE

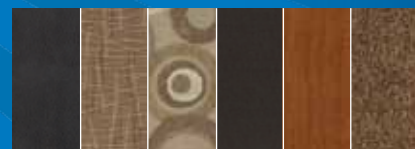

### CANYON



### PRALINE

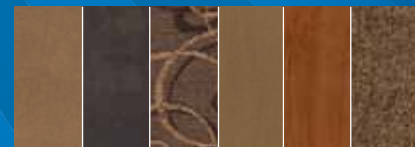

## WALL CONSTRUCTION

- 5 Vacuum-bonded layers: Involves 15-18 minutes of 144 tons of pressure to ensure a stronger bond
- 6 Smooth high-gloss fiberglass exterior: Withstands travel—and Mother Nature, too
- 7 Welded aluminum frames with metal backers: Creates long-lasting durability
- 8 Innovative contoured front cap: Protects unit's most vulnerable areas, while making Seismic more aerodynamic

## FLOOR CONSTRUCTION

- 9 5/8" tongue-and-groove plywood deck on 2" x 3" aluminum floor joists: More moisture resistant, plywood holds up to the elements
- 10 Floor radiant foil and residential insulation: Keeps heat in and cold out with an impressive R-25 insulation value
- 11 Poly Flex covering and an enclosed, heated underbelly: Increases aerodynamics while protecting the undertanks



**eco advantage™** [www.jayco.com/ecoadvantage](http://www.jayco.com/ecoadvantage)

THE JAYCO ECOADVANTAGE IS OUR COMPANY'S COMMITMENT TO PROTECTING THE ENVIRONMENT. Scan this QR code with your smartphone to watch a video about our efforts and the impact we're having on our world.

## SPECIFICATIONS

FLOORPLAN	EXT. LGTH.	EXT. WIDTH.	EXT. HT. WITH A/C	EXT. HT. WITH OPT. BEDROOM A/C	INT. HT.	UNLOADED VEHICLE WT. (LBS.)	DRY HITCH WT. (LBS.)	GROSS VEHICLE WT. RATING (LBS.)	CARGO CARRYING CAPACITY (LBS.)	FRESH WATER CAPACITY (GAL.) (WITH WATER HEATER)	GRAY WASTEWATER CAPACITY (GAL.)	TOILET/BLACK WASTEWATER CAPACITY (GAL.)
3210	37'	102"	161"	161"	103"	11,990	2,795	16,500	4,510	148	87	50
3712	42' 4"	102"	159"	159"	103"	13,835	2,950	19,000	5,165	148	122.5	85.5
3812	43' 2"	102"	159"	159"	103"	15,405	3,520	19,000	3,595	148	122.5	82.6
3912	44'*	102"	161**	161**	103"	TBD	TBD	19,000	TBD	148	122.5	82.6
3914	44' 2"	102"	159"	159"	103"	14,405	3,340	19,000	4,595	148	87	50

The weights of certain options and/or option packages are not included in the UVW listed above. \* Estimate. Visit your Jayco dealer or [www.jayco.com](http://www.jayco.com) for official specs.

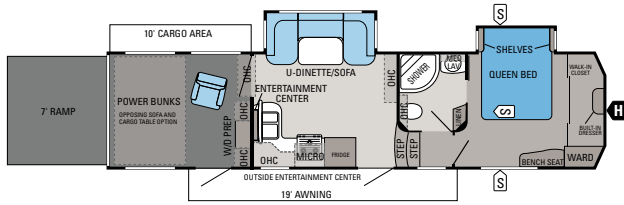

### SEISMIC FULL-PROFILE | 3210

Ext. Lgth: 37' Ext. Ht: 161" Unloaded Wt (lbs.): 11,990 Sleeps: 7-8

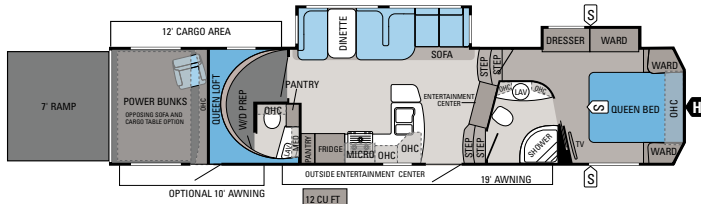

### SEISMIC FULL-PROFILE | 3712

Ext. Lgth: 42' 4" Ext. Ht: 159" Unloaded Wt (lbs.): 13,835 Sleeps: 9-11

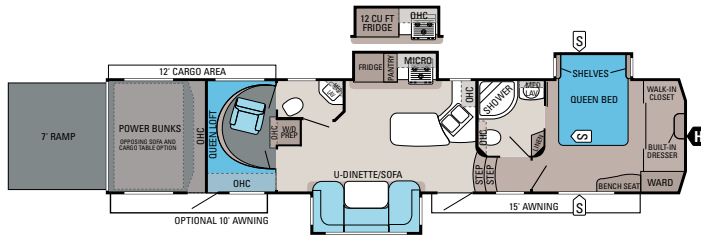

### SEISMIC FULL-PROFILE | 3812

Ext. Lgth: 43' 2" Ext. Ht: 159" Unloaded Wt (lbs.): 15,405 Sleeps: 8-10

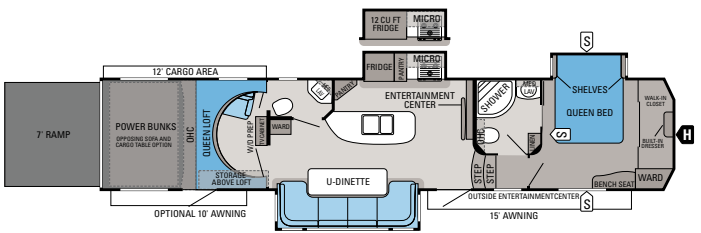

### SEISMIC FULL-PROFILE | 3912

Ext. Lgth: 44' 1/2" Ext. Ht: 161" Unloaded Wt (lbs.): TBD Sleeps: 8-10

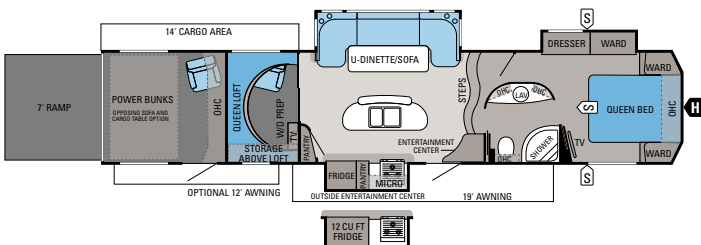

### SEISMIC FULL-PROFILE | 3914

Ext. Lgth: 44' 2" Ext. Ht: 159" Unloaded Wt (lbs.): 14,405 Sleeps: 8-10

#### STANDARD EXTERIOR EQUIPMENT

High-gloss fiberglass sidewalls  
3/8" wood roof decking on 5" crowned wood truss rafters (R-30)  
5/8" tongue-and-groove plywood main floor decking  
12" I-Class cambered structural-steel I-beam frame  
Heat reflective foil insulation in living area, bedroom, slideout floors  
One-piece seamless roof membrane  
16" radial tires and spare tire with carrier  
8-lug polished aluminum wheels  
E-Z Lube axles  
MOR/ryde CRE 3000 rubber axle equalizer  
Dexter Nev-R-Adjust brakes  
Pin box, long  
30" x 72" radius-cornered entrance door with step light, oversized window and Epad touch-pad gas-strut door locks  
Marine-grade exterior speakers (2)  
12V electric patio awning  
Hand-held remote for awning, slideouts, jacks and patio lights with remote located in Command Center  
Stor-Galore basement storage  
Slam-latch lockable baggage doors, insulated and radius-cornered  
Integrated LED front cap docking light  
Electric-powered front jacks  
Uni-Dock utility center, heated and enclosed  
5,500-watt generator prep with auto-changeover switch  
Double 30-lb. propane bottles with regulator with additional (1) 30-lb. tank storage  
Battery compartment and disconnect switch for two batteries  
30-gal. fuel station, dual, with command center gauge  
12-gal. gas/electric DSI water heater with auto-ignition  
148-gal. fresh water capacity  
Black holding tank sprayer and sewer hose compartment  
Water system winterization kit  
Outside shower  
Electric-powered rear stabilizer jacks (2)  
Black folding roof ladder  
Security lights (2)  
LED taillights

#### STANDARD INTERIOR EQUIPMENT

Residential-style pre-drilled and screwed cabinet construction with hidden hinges  
Ball bearing drawer guides, 100-lb. capacity with full-drawer extension  
Below-countertop trash receptacle  
Deep storage drawers under booth dinette  
High-gloss, solid-surface countertops with undermount stainless-steel sink with sink covers (2)  
Brushed nickel faucet with pull-out sprayer  
3-burner range with 9,000-BTU SuperBurner, piezo igniter and bi-fold metal cover  
Mirror feature behind stove  
8 cu. ft. flush-mount, double-door refrigerator with high-gloss black inserts  
24" microwave oven with carousel  
Oversized 21" oven  
Water heater bypass system  
Water purification system  
40,000-BTU furnace, auto-ignition and black digital thermostat  
Island/bar area long-stem pendent lights (select models)

Toe-kick kitchen accent lighting  
Halogen recessed lighting package  
15,000-BTU A/C with Whisper quiet feature and multi-directional, louvered-directional ceiling vents  
40" LCD HDTV in living area with dual cable and satellite prep  
Samsung 1,000-watt home theatre system  
Hide-a-bed sofa with air mattress (select models)  
Thermofoil countertops and clear bathroom vessel sink with high-rise nickel faucet  
Power bathroom vent with large blades  
Radius shower with colored ABS surround and skylight  
Flat-panel door with decorative glass insert  
Ceiling crown molding in bedroom with LED vibe lighting  
60" x 80" deluxe mattress, 312-coil with 2" top-side pad and gas-strut, under-bed storage  
Walk-in closet  
Bedroom cabinet with 22" LCD HDTV, DVD, satellite, cable jacks  
Bedroom wired and framed for second A/C

#### STANDARD RAMP & CARGO EQUIPMENT

Vacuum-bonded laminated 2" garage floor  
7' 10" hinged spring-assist ramp door, 3,000-lb. capacity, 93 3/8" wide opening with anti-slip, non-skid flooring  
18"-wide tread plate splash guard  
Tuff-ply, rubberized garage floor liner  
Welded-steel storage in garage floor/full-width beaver tail  
Flush floor-mounted tie-down rings anchored to frame, 2,500-lb. capacity each  
30" x 72" cargo bay door with LED step light  
Premium coach/cargo passage door with window (select models)  
Closeable and directional air conditioning ducts  
High-intensity, flush-mounted ramp lights (2)  
HappiJac electric bed lift  
Black retractable screen wall/cargo bay privacy curtain  
Patio door with screen (3914)  
3 cu. ft. refrigerator (select models)  
Washer/dryer prep, located in cargo area  
Cargo area vent ports and powered roof vent

#### OPTIONS

Customer Value Package  
Premium Paint Package  
Thermal pane safety-glass windows  
MOR/ryde pin box  
Additional electric patio awning  
Party Deck with folding rails and awning  
Roll-up carpet in cargo area  
Slideout awnings  
12 cu. ft. flush-mount, double-door refrigerator with high-gloss black inserts (n/a 3210)  
24" convection microwave  
High-top table and bar stools  
26" exterior LCD HDTV  
Dyson vacuum  
Satellite kit  
Sirius satellite radio package  
Swivel/reclining chair(s)  
Dual opposing electric sofas  
26" LCD HDTV in cargo area  
Cargo bay swivel chair(s)  
15,000-BTU 2nd bedroom A/C with black thermostat



# THE **Jayco**<sup>®</sup> family STORY

**THE JAYCO STORY BEGAN IN 1968 WITH OUR FAMILY—THE BONTRAGERS.** Lloyd Bontrager created an innovative, easy-to-use lifter system that led to a better fold-down camper. Loaded with more conveniences, he believed his camper would bring families closer together.

Since then, the Jayco family has grown. From our factory to our front office, from our salespeople to our suppliers, our family bond is four decades strong with the support of more than 300 Jayco dealers.

Together, we're helping make new family stories. **YOUR FAMILY STORY.**

*welcome* to the Jayco family



Establishing a solid relationship with your local Jayco dealer is a key component in the enjoyment of your new Jayco. By purchasing from a local dealer, you will have a convenient location for sales, parts and service support. We hope you enjoy working with them as much as we do.



Jayco proudly sponsors Tread Lightly!, a nonprofit organization whose mission is to empower generations to enjoy the outdoors responsibly through education and restoration.

**Unloaded Vehicle Weight (UVW):** Sometimes referred to as "Dry Weight," UVW means the typical weight of this trailer as built at the factory. The UVW, as used in product literature and other promotional materials, does not include cargo, fresh water, propane, options or dealer-installed accessories.

**Gross Vehicle Weight Rating (GVWR):** GVWR means the maximum permissible weight of the trailer, including the UVW plus passengers, personal items, all cargo, fluids, options, and dealer-installed accessories. The GVWR is equal to or greater than the sum of the UVW and the CCC.



From RV insurance to extended warranties, JayPlus has it covered. Ask your Jayco dealer about our exclusive JayPlus program today.

**Cargo Carrying Capacity (CCC):** CCC means the maximum weight of all passengers, personal items, food, fresh water, propane, tools, other cargo and dealer-installed accessories that can be carried by the trailer. CCC is equal to or less than GVWR minus UVW. The addition of options will decrease the CCC.

**Hitch Weight (HW):** The hitch weight, as used in product literature and other promotional materials, does not include cargo, fresh water, propane gas, options or dealer-installed accessories. The addition of these types of items will either add to or subtract from the stated hitch weight.



As a Jayco owner, you can be part of the Jayco Jafari International Travel Club. Ask your dealer about the Jafari "flight" in your area, write Jayco or visit our website.

It is important for your safety and enjoyment that your tow vehicle be adequately sized and equipped to tow and handle the GVWR of the RV you select. Review weights and rating of your tow vehicle and consult a competent advisor for questions or advice. Whether you are new to RVing or a veteran, get a feel for the performance of your tow vehicle before heading out on the roadways. When you tow an RV, you must drive differently than when you drive a single vehicle. Practice hooking up, driving, backing up and braking in a safe environment or seek out professional instruction. Jayco affixes a weight label to each RV which lists weight information for that vehicle. See specifications chart inside.

Jayco, Inc., P.O. Box 460, Middlebury, IN 46540, [www.jayco.com](http://www.jayco.com) 

See dealer for further information and prices. All information in this brochure is the latest available at the time of publication approval. Jayco reserves the right to make changes and to discontinue models without notice or obligation. Photos in this brochure may show optional equipment and props for photography purposes. RVs built for sale in Canada may differ to conform to Canadian codes. ©2012 Jayco, Inc. 13-SEIS-PL 0712-20K Printed in U.S.A.