

Springdale

Adventure Begins Here.



Springdale Summerland



Keystone RV
Company

Eastern Edition

Springdale | Travel Trailer

Springdale
VAULTED
— RAISING THE BAR —
6'1"



Springdale has so many features that offer the best value in the market and the best floorplans to fit your specific camping needs. Take a look at these action packed campers that offer exactly what you are looking for in front living spaces, bunks for the kids, plenty of storage, Super Slide Rooms (SSR), and roomy open spaces. If you have a need or a want, Springdale has the camper for your next Adventure!

**HUGE
STORAGE
CAPACITY**



Adventure Begins Here.

Springdale
CEILING
ON INNOVATION
10"



Full Extension Drawers
in all Springdales



Oversized and Deep High Impact Acrylic sinks
found in all Springdales



275FL Bedroom shown here in
Cordovan Decor

At Springdale we know that convenience and comfort are very important when you are on your Adventure and we strive to make that a reality for you. Prep work and cleanup is effortless in a Springdale and all Springdales have full extension pull out drawers and deep sinks that make the most experienced camper happy. Large bedrooms and room to roam in the main living areas make the Springdale easy to navigate for the entire camping crew!



Springdale | Travel Trailer

Springdale
VAULTED
— RAISING THE BAR —
6'1"



Springdale
CEILING
FOR INNOVATION
10"

Adventure Begins Here.



Springdale | Decor Options

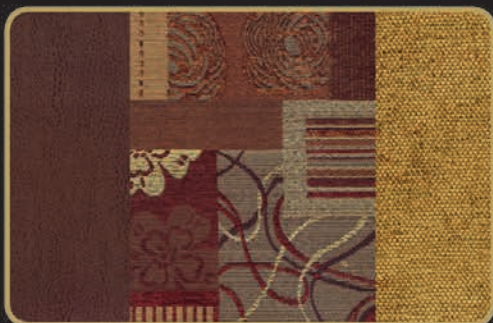

Cordovan



Morel



Redwood

Summerland | Travel Trailer

by SPRINGDALE

SUP
SL
RO



Why not have exactly what you want to go camping and do it with style and grace? Summerland by Springdale offers a great look and awesome features at a price that will fit any budget. Versatile floorplans, a variety of sizes, and packed with so many features you will not want to stay home! Summerland has what you want to begin your Adventure!



2820BH Bunks



2820BH Bedroom



2820BH Dinette

Adventure Begins Here.

PER
IDE
OM



As you can see, we made the new Summerland both beautiful and functional. With an abundance of cabinets, overheads, and closets, there is plenty of room to stow all your gear. And the Super Slide Room is spacious enough for you to stretch out and relax. The Summerland 2820BH shown here in Morel decor will whisk you into an adventure and memories you will not soon forget.



2820BH Bathroom



"Summerlounge" in the 2820BH



...conveniently converts to bunk room

VISIT OUR ALL NEW WEBSITE TO VIEW INTERIOR PHOTOS AND MUCH MORE AT KEYSTONERV.COM



Springdale | Fifth Wheel Floorplans



242FWRLSSR



253FWRLLS



247FWRLLS



280FWIKSSR



249FWBHSSR



284FWBHSSR

Springdale Fifth Wheel Specifications

Fifth Wheel	242FWRLSSR	247FWRLLS	249FWBHSSR	253FWRLLS	280FWIKSSR	284FWBHSSR
Shipping Weight	6268	6415	6380	6975	7260	7985
Carrying Capacity	1712	1560	1715	1195	2765	2125
Hitch Weight	980	975	1095	1170	1225	1310
Exterior Length*	26' 3"	27' 8"	27' 2"	29' 9"	31' 3"	32' 5"
Ext Height	11' 7"	12' 3"	11' 11"	11' 11"	11' 10"	12' 5"
Fresh Water	50	50	50	50	50	50
Waste Water	34	34	30	34	34	34
Grey Water	34	64	64	34	64	64
LPG Capacity	60	60	60	60	60	60

DISCLAIMER: Product information is as accurate as possible as of the date of publication of this brochure. All features, floor plans, and specifications in this brochure are subject to change without notice. Please also consult Keystone's web site at www.keystonerv.com for more current product information and specifications. Tow Vehicle Disclaimer. CAUTION: Owners of Keystone recreational vehicles are solely responsible for the selection and proper use of tow vehicles. All customers should consult with a motor vehicle manufacturer or their dealer concerning the purchase and use of suitable tow vehicles for Keystone products. Keystone disclaims any liability or damages suffered as a result of the selection, operation, use or misuse of a tow vehicle. KEYSTONE'S LIMITED WARRANTY DOES NOT COVER DAMAGE TO THE RECREATIONAL VEHICLE OR THE TOW VEHICLE AS A RESULT OF THE SELECTION, OPERATION, USE OR MISUSE OF THE TOW VEHICLE. *Length is defined as the distance from the centerline of hitch pin/coupler to rear bumper of trailer. 01/13

Summerland Travel Trailer Specifications

Travel Trailer	1790QB	1890FL	2100RB	2560RL	2570RL	2600TB	2670BH	2800BH	2820BH	2890BH	3030BH
Shipping Weight	3928	4059	5247	4657	5628	4712	5820	6320	6455	6328	7310
Carrying Capacity	2138	2351	2273	2958	1977	2833	1825	2080	3040	3187	2345
Hitch Weight	490	410	520	615	605	545	645	730	695	715	855
Exterior Length*	20' 10"	23' 7"	25' 11"	27' 11"	28' 8"	28' 10"	28' 11"	31' 9"	32' 1"	32' 7"	34' 11"
Ext Height	10' 6"	10' 6"	10' 6"	10' 6"	10' 6"	10' 6"	10' 11"	10' 11"	11' 3"	10' 11"	10' 11"
Fresh Water	50	50	50	50	50	50	50	50	45	50	50
Waste Water	30	34	34	34	34	34	30	34	34	30	30
Grey Water	30	30	64	34	30	30	34	64	64	34	34
LPG Capacity	40	40	40	40	40	40	40	40	60	40	40



Get the free mobile app at <http://gettag.mobi> and scan this Tag.



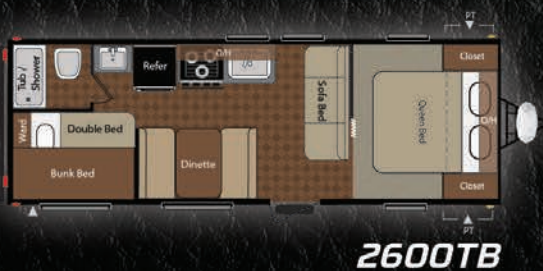
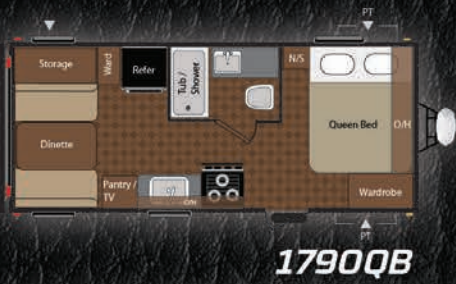

360° INTERIOR VIRTUAL TOUR
AVAILABLE AT KEYSTONERV.COM

Springdale | Travel Trailer Floorplans



266RLSSR



293RKGL



▲ Outdoor and More Storage

267BHSSR



▲ Outdoor Kitchen

294BHSSR



275FL



▲ Outdoor Kitchen

295RBSSR



282BHSSR



296BHSSR



292RLGL



297BHSSR

Adventure Begins Here.

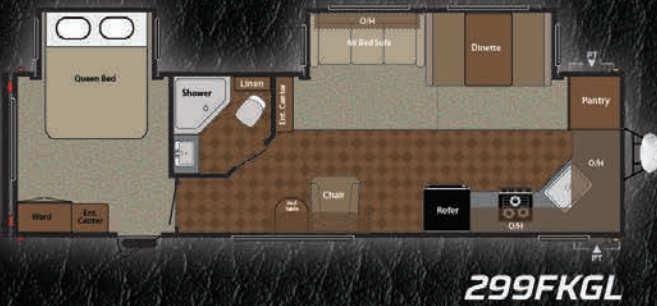

299FKGL



311REGL



303BHSSR



312RLGL

Springdale Travel Trailer Specifications

Travel Trailer	266RLSSR	267BHSSR	275FL	282BHSSR	292RLGL	293RKGL	294BHSSR
Shipping Weight	6458	6420	7470	7000	7095	7095	7135
Carrying Capacity	1282	1295	2115	2515	2360	2570	2525
Hitch Weight	740	715	785	715	655	865	860
Exterior Length*	29' 6"	29' 9"	33' 4"	32' 1"	33' 1"	33' 3"	33' 5"
Ext Height	11' 3"	11' 3"	10' 11"	11' 3"	11' 3"	11' 3"	11' 3"
Fresh Water	50	45	50	50	50	50	50
Waste Water	34	34	30	34	30	34	30
Grey Water	34	68	34	64	34	64	34
LPG Capacity	60	60	60	60	40	60	60

Travel Trailer	295RBSSR	296BHSSR	297BHSSR	299FKGL	303BHSSR	311REGL	312RLGL
Shipping Weight	7180	7090	7235	7555	8050	8215	8492
Carrying Capacity	2365	2420	2315	2205	1635	1545	1333
Hitch Weight	745	710	750	960	885	960	1025
Exterior Length*	32' 8"	33' 10"	33' 10"	34' 3"	35' 8"	35' 7"	36' 6"
Ext Height	11' 3"	11' 3"	11' 3"	11' 4"	11' 4"	11' 4"	11' 4"
Fresh Water	50	45	50	44	50	50	50
Waste Water	30	30	34	34	30	34	34
Grey Water	64	34	34	64	34	68	64
LPG Capacity	60	40	60	60	60	60	60

DISCLAIMER: Product information is as accurate as possible as of the date of publication of this brochure. All features, floor plans, and specifications in this brochure are subject to change without notice. Please also consult Keystone's web site at www.keystonerv.com for more current product information and specifications. Tow Vehicle Disclaimer. CAUTION: Owners of Keystone recreational vehicles are solely responsible for the selection and proper use of tow vehicles. All customers should consult with a motor vehicle manufacturer or their dealer concerning the purchase and use of suitable tow vehicles for Keystone products. Keystone disclaims any liability or damages suffered as a result of the selection, operation, use or misuse of a tow vehicle. KEYSTONE'S LIMITED WARRANTY DOES NOT COVER DAMAGE TO THE RECREATIONAL VEHICLE OR THE TOW VEHICLE AS A RESULT OF THE SELECTION, OPERATION, USE OR MISUSE OF THE TOW VEHICLE. *Length is defined as the distance from the centerline of hitch pin/coupler to rear bumper of trailer. 01/13

Standards & Options

Springdale
Fifth Wheels
Summerland

	Springdale	Fifth Wheels	Summerland
CONSTRUCTION			
2 - 30# LP Bottles w/auto change over (with cover TT)	●	●	
Manual Stabilizer Jacks (4)*	●		●
Stabilizer Jacks (2)*		●	
Electric Front Landing Gear		●	
Fiberglass Exterior*		●	
Spread Axle (models w/Slides)	●	●	●
E-Z Open Entry Step	●	●	●
Radial Tires	●	●	●
13.5K Ducted A/C (all Springdale most Summerland models)	●	●	●
Tub Surround	●	●	
2x3 Floor Construction 12" OC with 5/8ths Decking	●	●	●
16" on Center Side Walls	●	●	●
16" on Center Raised Roof Truss System	●	●	●
R-7 Insulation-Floor, Roof, Walls	●	●	●
Fully Enclosed Underbelly	●	●	
Powder Coated I-Beam Frame	●	●	●
Diamond Plate*	●		
Tinted Safety Glass	●	●	●
ENTERTAINMENT			
2 Exterior Speakers*	●	●	●
4 Interior Speakers*	●	●	
2 Interior Speakers			●
AM/FM/CD/DVD MP3 Player*	●	●	
AM/FM/CD Player			●
Cable and Satellite Prep	●	●	●
26" LCD HD TV*	●	●	
KITCHEN			
Wallpaper Border	●	●	●
High Impact Acrylic Sink	●	●	●
Steel Ball Bearing Drawer Guides	●	●	●
Residential Lighting in Slide	●	●	
Spice Rack below sink	●	●	●
22" Oven with 3 Burner Cooktop	●	●	
18" Oven with 3 Burner Cooktop			●
6 cu. ft. 110V/LP Refrigerator	●	●	●
Residential Microwave	●	●	●
Do More Dinette Table	●	●	
Plantation Blinds in Galley Area	●	●	
Vented Range Hood w/Light	●	●	●
Sink Cover*	●	●	
Stove Cover*	●	●	
Outside Shower*	●	●	
Fabric Pleated Night Shades through out	●	●	

Adventure Begins Here.

Springdale
Fifth Wheels
Summerland

	Springdale	Fifth Wheels	Summerland
BED BATH & MORE			
Night Stand w/Drawer in Bedroom	●	●	
Night Stand			●
Skylight Over Tub/Shower	●	●	
Forced Air DSI Furnace w/Thermostat (ducted most models)	●	●	●
6 Gal. Gas/Electric DSI Water Heater	●	●	
55 amp Converter	●	●	●
Water Heater Bypass	●	●	●
Manual Patio Awning			●
Jack Knife Sofa Bed			●
Porcelain Foot Flush Toilet	●	●	●
SUMMERLAND			
Summer Package*			●
Tub Surround			●
6 Gal. Gas DSI Water Heater			●
2-30# LP Gas Bottles w/Cover			●
Outside Shower			●
SPRINGDALE			
Advantage Package	●		
Electric Awning	●	●	
Vaulted Ceiling	●		
Power Tongue Jack	●		
Sofa with Air Mattress Hide-A-Bed	●	●	
Aluminum Rims	●	●	
XL Entry Assist Handle	●		
SAFETY			
Fire Extinguisher	●	●	●
Smoke Detector	●	●	●
LP Detector	●	●	●
CO Detector	●	●	●
Safety Chains	●	●	●
Emergency Brake-a-way switch	●	●	●

*Standard Build or Forced option
● Package

Springdale Popular Options
15K BTU A/C
Spare Tire

Connect with Keystone RV Company



Springdale

keystonerv.com/springdale

Summerland

keystonerv.com/summerland

Your Local Dealer is:

