

**PREMIER**  
ULTRA LITE BY BULLET

# PREMIER

www.keystone-premier.com *ULTRA LITE BY BULLET*



**THE PREMIER... LUXURY LIGHTWEIGHT**  
A NEW ERA IN ULTRA LITES

www.keystonerv.com/premier





# **PREMIER**

ULTRA LITE BY BULLET

***Premier by Bullet is the New Gold Standard in Ultra Lite RVs.***  
With vaulted ceilings almost 7 feet tall, huge frameless picture windows, and comfortable seating in the extra deep slideout rooms, Premier surrounds you with “at home” comfort.

[www.keystonerv.com/premier](http://www.keystonerv.com/premier)





- 1 Deep, full extension cabinet drawers
- 2 Laminated counter top with wrapped edges
- 3 Deep single-basin sink
- 4 Easy-access storage under the sink
- 5 17" conventional oven
- 6 Double-door 8 cu. ft. refrigerator
- 7 Residential pantry with removable shelves
- 8 Full-function microwave oven
- 9 Large, unobstructed overhead cabinet

## What's the big thing about Premier?

From floorplan layout to interior and exterior styling, Premier is in a class by itself. Take, for example, Premier's interior features: these include raised panel cabinet doors throughout, extra durable cushioned floors, plus floorplan designs that make efficient use of every square foot of interior space. With Premier, you'll enjoy a luxury RV that's functional, beautiful and can be towed by today's fuel-efficient SUVs and trucks.

*What's the big thing about Premier?* In a word, **EVERYTHING!**

# PREMIER

ULTRA LITE BY BULLET

## EXTERIOR FEATURES



**Largest Pass-Thru Storage** in its class. 40.3 cubic ft. of pass-thru storage for all of your camping gear.



**Frameless Tinted Windows** allow you to keep the windows open for air flow, even when it's raining.



**Electric Awning** makes it easy to extend/retract the awning. Awning is also equipped with adjustable arms.



**Rolled Roof Edge** promotes increased water runoff from crowned roof while also providing another layer of protection where the roof meets the sidewall.



**Wide Stance Axles** dramatically increases how the unit tows by reducing bouncing and swaying during travel.



**Exterior Shower** equipped with a fixed shower head and access to both hot and cold water.

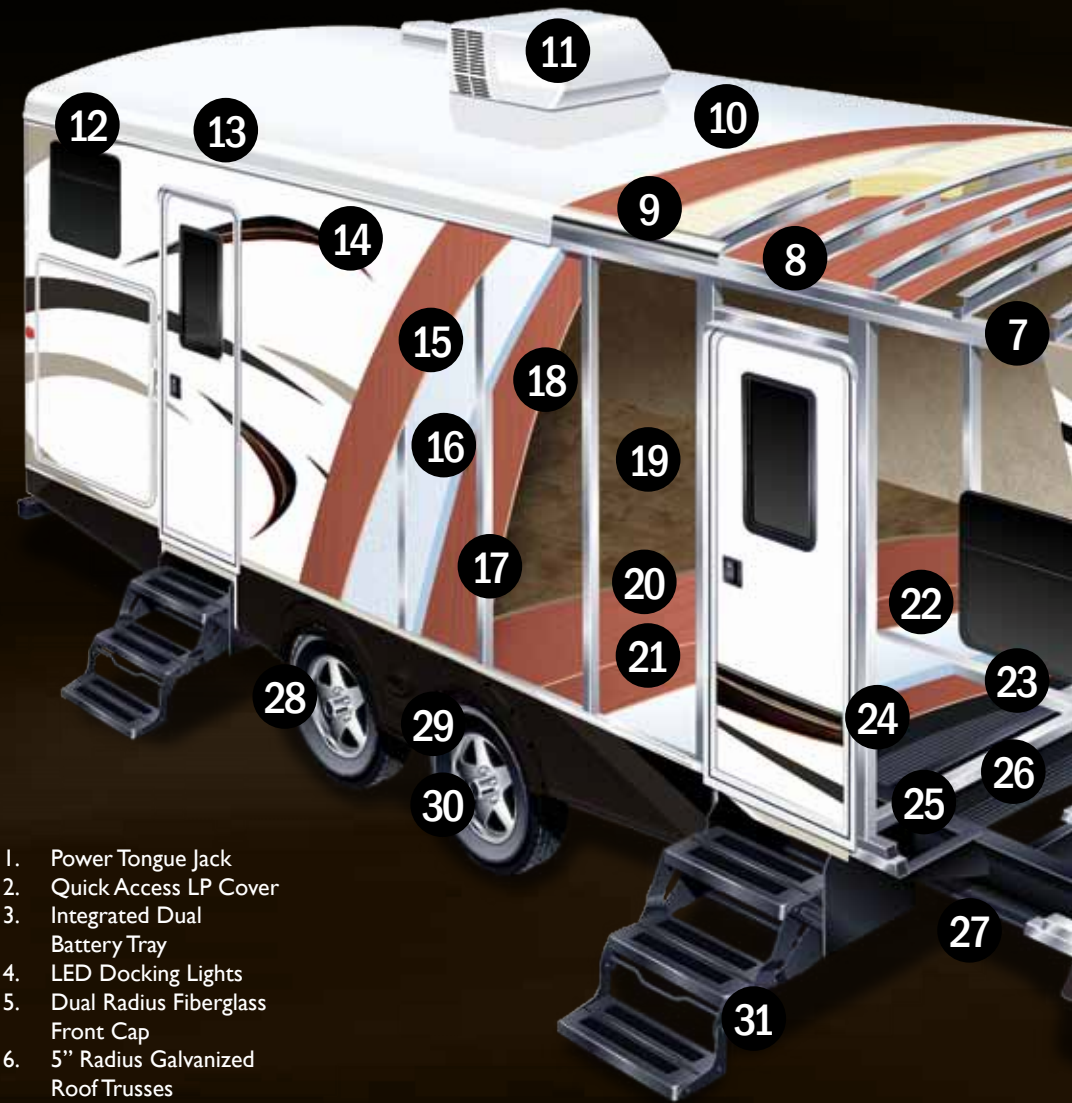

1. Power Tongue Jack
2. Quick Access LP Cover
3. Integrated Dual Battery Tray
4. LED Docking Lights
5. Dual Radius Fiberglass Front Cap
6. 5" Radius Galvanized Roof Trusses
7. Hurricane Straps
8. Fully Insulated Roof
9. Durable Roof Decking
10. One Piece EPDM Rubber Roof
11. 13.5 Quick Cool Air Conditioning
12. Full Length Rain Gutter and Spouts
13. Rolled Roof Edge
14. Smooth Fiberglass Exterior

15. 1/8" Luan Wall Backing
16. Hi-Density Block Foam Insulation
17. 1 1/2" Box Welded Aluminum Frame Structure
18. Decorative Interior Wall Board
19. Residential Stain Resistant Linoleum
20. 1st Layer Floor Decking

21. 2nd Layer Floor Decking
22. Hi-Density In Floor Block Foam Insulation
23. Welded Aluminum Floor Joists
24. 3rd Layer Floor Decking
25. Paco/I - Beam Frame
26. Darco Vapor Barrier Wrap





- 27. Enclosed Underbelly
- 28. Radial Tires with Electric Breaks (4)
- 29. Load Equalization Axle System
- 30. Easy Lube Axles
- 31. Radius Entry Steps
- 32. Frameless Tinted Windows

# LIGHTWEIGHT SOLID CONSTRUCTION

## INTERIOR FEATURES



**Laundry Chute** provides a convenient place to dispose of dirty clothes until you get home.



**9" Deep Single Basin Kitchen Sink** allows enough size and depth for washing pots and pans.



**Flush Mounted Puck Lighting** in the living room offers a more luxurious look compared to traditional RV interior lights



**Progressive Interior Lighting** located above the queen size bed in the master bedroom.



**Max Depth Slideout Room** is 36" deep allowing for larger dinette and sofa.



**CD/DVD/AM/FM Stereo w/ MP3 Hookup** gives you multiple option for entertainment on those rainy days at the campground.



**Visionary Sofa** offers a relaxed place to lounge during the day and gives your guests a comfortable sleeping option at night.



**Mullion doors** give customers the eye appeal found in high end 5th wheels





32BHPR | Large entertainment center



32BHPR | Outdoor Camp Kitchen



31BHPR | Bunk room shown with Garden View Decor

## You'll find a Premier floorplan to fit your lifestyle perfectly.

The entertainment center of the 32BHPR (shown upper left) shows the abundant amount of storage with an oversized 46" LCD HDTV – something you'll be hard pressed to find in other light weight travel trailers.

The Outdoor Camp Kitchen on the 32BHPR (photo directly above) offers refrigerator, cooktop, sink with hot and cold running water, storage and LCD TV. It's a great way to add to your tailgating experience or those lazy days hanging out beneath the patio awning.



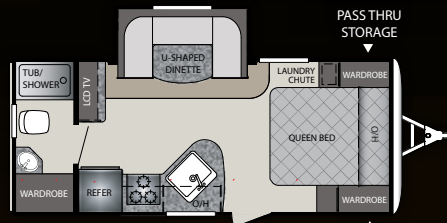

**19FBPR**

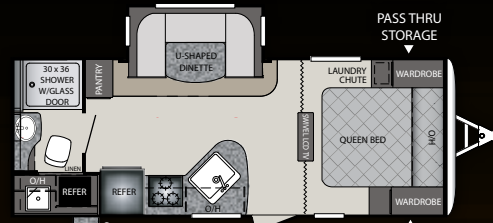

**22RBPR**

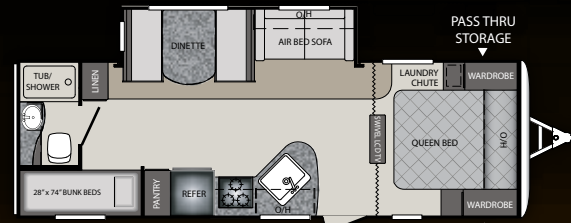

**26BHPR**

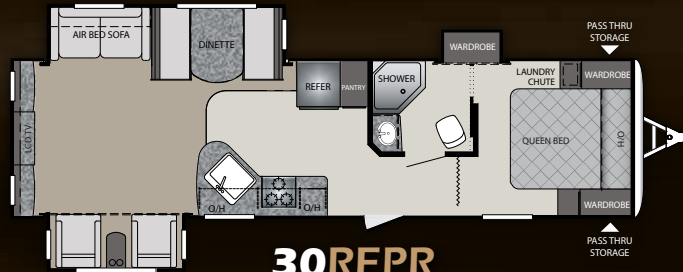

**30REPR**

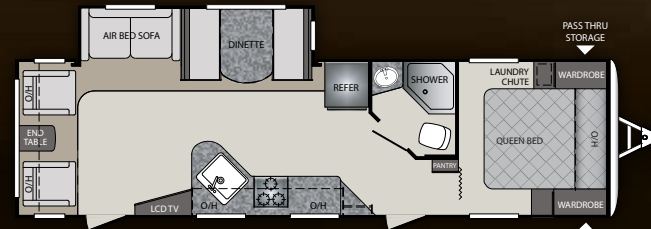

**30RLPR**

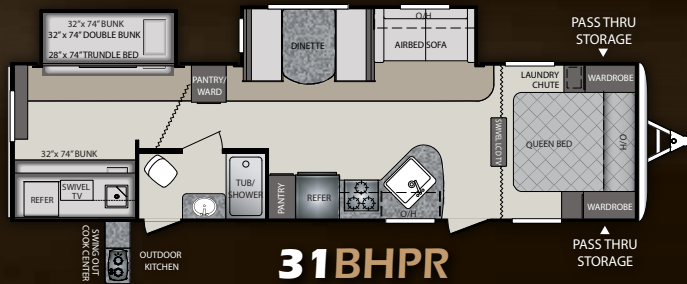

**31BHPR**



**32BHPR**

## WEIGHTS AND MEASUREMENTS

TRAVEL TRAILERS	19FBPR	22RBPR	26BHPR	30REPR	30RLPR	31BHPR	32BHPR	33BLPR
SHIPPING WEIGHT	4168	4520	5048	6410	5750	6440	6180	6530
CARRYING CAPACITY	2332	1980	1852	1590	1850	1560	1420	1470
HITCH WEIGHT	410	500	645	745	705	795	735	750
EXTERIOR LENGTH	23' 2"	25' 6"	29' 2"	34' 11"	33' 9"	35' 4"	34' 9"	35' 6"
EXTERIOR WIDTH	8'	8'	8'	8'	8'	8'	8'	8'
EXT. HEIGHT - A/C TOP	10' 11"	10' 11"	10' 11"	10' 11"	10' 11"	10' 11"	10' 11"	10' 11"
FRESH WATER (GAL.)	41	41	41	41	41	41	41	41
WASTE WATER (GAL.)	30	30	30	30	30	30	30	30
GRAY WATER (GAL.)	30	30	30	30	30	30	60	30
LP CAPACITY (LBS.)	40	40	40	40	40	40	40	40

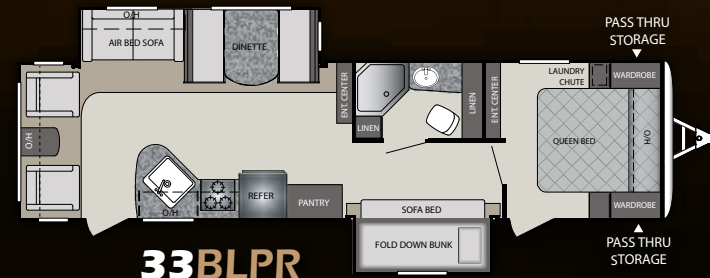

**33BLPR**



DUNE  
DECORSADDLE  
DECORGARDEN VIEW  
DECOR**CONSTRUCTION  
STANDARDS**

- Aggressive Front Profile for Increased Towability
- Aluminum Framed Front, End and Side Walls
- Laminated Fiberglass Exterior Side Walls
- 2" Thick Laminated Aluminum Floor
- In Frame Fresh, Grey, and Black Water Tanks
- 6" and 8" I-Beam with Full-Length Welded Outrigger
- ¼" ABS Enclosed Underbelly
- Darco Moisture Barrier
- One Piece Seamless Rubber Roof
- E-Z Lube Axles
- Electric Brake System (4 wheels)
- R-11 Insulation in Floor
- R-7 Insulation in Sidewalls
- R-11 Insulation in Roof

**EXTERIOR CAMPING  
PACKAGE**

- Wide Stance E-Z Lube Axles
- 6 Gallon Gas/Electric DSI Water Heater
- Radius Entry Door with Gas Strut
- Outside Speakers
- Outside Shower (Hot and Cold Water)
- 4 Stabilizer Jacks
- TV Antenna and Cable Hook-Up
- Electric Awning with Adjustable Arms
- Radial Tires

**EXTERIOR FEATURES**

- Outdoor Kitchen (22RB, 31BH, 32BH)
- Aluminum Wheels
- Dual Propane Tanks with Cover
- In Frame Dual Battery Rack
- Oversized Exterior Pass Thru Storage with Lighting
- LP Quick Connect
- Amber Patio Light
- Spare Tire
- Oversized Grab Handle (main door)
- Triple Entry Steps
- Slam Baggage Doors

**INTERIOR CAMPING  
PACKAGE**

- 13.5 BTU Ducted A/C
- Night Shades
- CD/DVD/AM/FM Stereo with Aux and I-Pod Hookup
- 26" LCD TV
- Microwave
- 8 cu./ft. Double Door Refrigerator
- 3 Burner High Output Range
- 9" Deep Oversized Single Basin Sink with Retractable Faucet
- All Raised Panel Hardwood Cabinet Doors
- Foot Flush Toilet
- Tub Surround with Shelves
- Full Extension Drawer Glides
- Visionary Sofa (select models)

**INTERIOR FEATURES**

- 6' 11" Vaulted Ceiling
- Trekk Linoleum
- Swivel Rockers
- Pillow Back Furniture
- Swivel TV with Mirror and Convenience Center
- Night Shades in Living Area
- 17" Oven
- Decorative Wall Border
- Stor-more dinette
- Retractable Kitchen Faucet

**BATHROOM**

- Deluxe Curved Shower Curtain
- Power Vent Fan
- Solid Wood Medicine Cabinet
- Linen Storage

**MASTER BEDROOM**

- Upgraded Memory Foam Mattress
- Mirrored Wardrobes
- Laundry Chute
- Under Bed Storage
- Individual Reading Lights
- Accent Wallboard

**SAFETY EQUIPMENT**

- Carbon Monoxide Detector
- Smoke Alarm
- Fire Extinguisher
- Electric Brakes
- Safety Chains
- Frameless Tinted Safety Glass Windows, Egress Windows (Fire Escape)
- GFI Receptals

**OPTIONS**

- RVO Grill All Models, N/A 22RB, 31BH, 32BH)
- 15K A/C

**THERMAL PACKAGE**

- Heated and Enclosed Underbelly
- 2" Pipe off of Furnace to Underbelly
- 30K BTU Furnace and Residential Heat Ducts

**PREMIER  
PACKAGE**

- Aerodynamic Fiberglass Front Cap
- Vaulted Ceiling System
- Frameless Tinted Windows
- Power Tongue Jack
- Visionary Sofa
- Max Depth Slides
- Flush Mounted Puck Lighting
- Upgraded Exterior Graphics Package
- Black Tank Flush



Get the free app at  
<http://gettag.mobi>  
and scan this tag.

YOUR LOCAL DEALER

Product information is as accurate as possible at the date of publication of this brochure. Features, floor plans, and specifications are subject to change without notice. Please also consult Keystone's web site at [keystonerv.com](http://keystonerv.com) for more current product information and specifications. Tow Vehicle Disclaimer. CAUTION: Owners of Keystone recreational vehicles are solely responsible for the selection and proper use of tow vehicles. All customers should consult with a motor vehicle manufacturer or their dealer concerning the purchase and use of suitable tow vehicles for Keystone products. Keystone disclaims any liability or damages suffered as a result of the selection, operation, use or misuse of a tow vehicle. KEYSTONE'S LIMITED WARRANTY DOES NOT COVER DAMAGE TO THE RECREATIONAL VEHICLE OR THE TOW VEHICLE AS A RESULT OF THE SELECTION, OPERATION, USE OR MISUSE OF THE TOW VEHICLE. 11/2012

[www.keystonerv.com/premier](http://www.keystonerv.com/premier)

**PREMIER**  
ULTRA LITE BY BULLET



[www.keystonerv.com](http://www.keystonerv.com)

2642 Hackberry Drive | PO Box 2000  
Goshen, IN 46527-2000  
(574) 535-2100

Member  
**Go RVing**  
Life's A Trip  
**RVIA**  
RECREATIONAL VEHICLE  
INDUSTRY ASSOCIATION