

FREEDOM EXPRESS

Experience the Freedom of Choice



Coachmen

A division of Forest River, Inc.

Lightweight & Ultra-Light Travel Trailers

Freedom Express ■ Deep Slides ■ Toy Haulers ■ LTZ ■ Expandables





301BLDS Deep Slide

Lighten Up and Explore

Whether you're hauling mini-bikes or motocross, four wheelers or Fat Boys, there's a Freedom Express Toy Hauler for you. The LTZ Series 260BL offers 2500 lbs. of carrying capacity and sleeps six (or more). The Deep Slide 301BLDS has a 10' enclosed garage with a slider patio door, raised roofline and a beavertail ramp transition.



301BLDS Choose an optional queen bed, Sit-N-Sleep sofa, or HappiJac dinette in the garage area to best fit your lifestyle.



246RKS LTZ

LTZ Series

Designed for smaller vehicles, the LTZ Ultra-light series are all under 30' and weigh less than 5000 lbs. Nicely equipped with all the necessities for a great camping experience, the LTZ series offers four trailer layouts, plus a lightweight toy hauler.



The open, airy kitchen in the **301BLDS** features a large 87" U-dinette slide. Lots of windows coupled with a slider patio door let in plenty of fresh air and natural light. (Shown in Copper décor)

LTZ	191RB	192RBS	230BH	246RKS	269BHS	LTZTH 260BL
Shipping Weight	3390	3680	3795	4305	4680	4850
Hitch Weight	364	370	404	495	430	792
Carrying Capacity	2310	2220	3109	2695	2320	2750
Exterior Length	22'3"	22'	26'11"	28'3"	29'10"	29'2"
Exterior Height	10'3"	10'3"	10'3"	10'3"	10'3"	10'3"
Awning Size	10'	12'	15'	15'	15'	15'
Fresh Water gal.	36	36	36	36	36	98
Grey Water gal.	30	30	30	30	30	30
Waste Water gal.	30	30	30	30	30	30
LPG Capacity lbs.	40	40	40	40	40	40



The **246RKS LTZ** shown in Merlot décor, offers a spacious corner kitchen and best-in-class interior storage.



LTZ Expandables	19SQX	21TQX	22DSX	23TQX
Shipping Weight	3223	3540	4350	TBD
Hitch Weight	448	430	550	TBD
Carrying Capacity	2445	2148	2650	TBD
Exterior Length	20'4"	22'7"	22'2"	24'3"
Exterior Height	10'3"	10'3"	10'3"	10'3"
Awning Size	10'	14'	15'	15'
Fresh Water gal.	36	36	36	36
Grey Water gal.	30	30	30	30
Waste Water gal.	30	30	30	30
LPG Capacity lbs.	40	40	40	40



LTZ Expandables

Pack all the livability of a 28'-33' travel trailer into the towability (and price) of a 19'-23' trailer. Freedom Express Expandables are easy to tow and come with the Secure-Lok tent system which eliminates the hassle of Velcro or bungees, making set-up and tear-down a snap – even for one person.

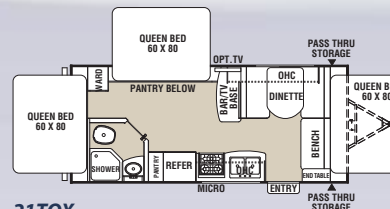

21TQX

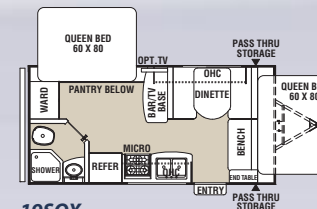

19SQX

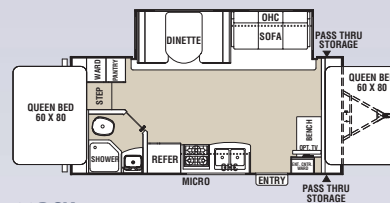

22DSX

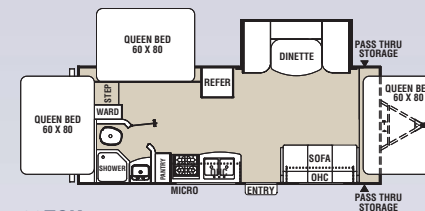

23TQX

21TQX LTZ Freedom Express Expandables feature exceptional floor space, storage and counter space – remarkable for an expandable! This triple-tent **21TQX** is shown in Greystone décor.

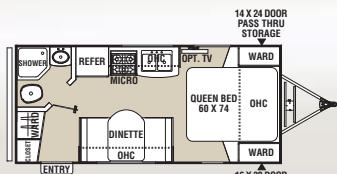

191RB

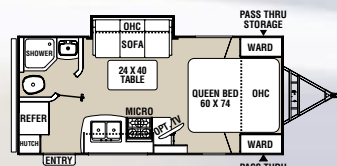

192RB

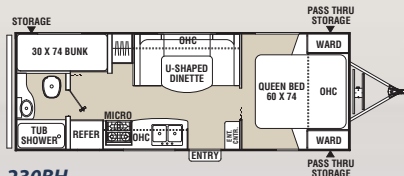

230BH

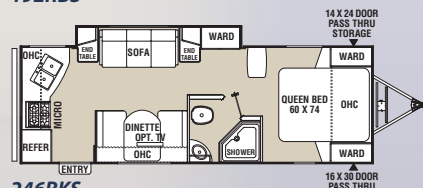

246RKS

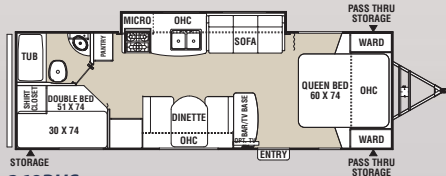

269BHS

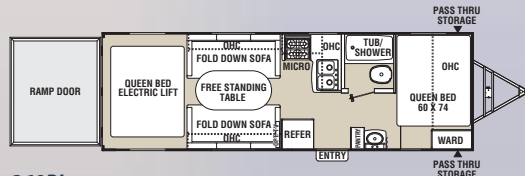

260BL





Lightweight Towability, Convenience and Choice

When there's a chance to escape from your busy life, Freedom Express makes it hassle free, fun and easy. With industry leading features and conveniences in five different travel trailer categories, you'll experience the freedom of choice, plus lightweight towability designed to be pulled by today's half-ton trucks and SUVs. *Want even more?* These upgrades are available for both Freedom Express and Deep Slide models:

Freedom Power Package – A power tongue jack, power stabilizer jacks and a power awning with automatic rain dump and adjustable tilt means no more cranking. The DVD player is built right into the stereo. Work less and play more!

Wide-Stance Stable-Ryd Axle – This design places the tires farther apart from side to side and adds an additional 9" between the axles. The wider base provides better tracking and a smoother tow.



297RLDS Deep Slide This ample bedroom features a large wardrobe, dresser and convenient 110V plugs on each side of the master bed.

310BHDS Deep Slide with Liberty Edition Upgrade shown in Caramel décor, with a standard 87" U-dinette and an optional hide-a-bed sofa.



Freedom Express

Experience a combination of lightweight towability and well planned convenience features. These floorplans with generous 18" slide outs are designed to be towed by today's half-ton trucks and SUVs.

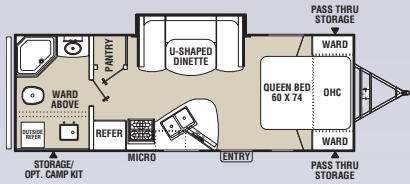

237RBS

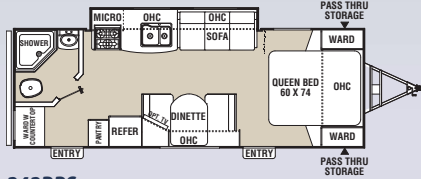

242RBS

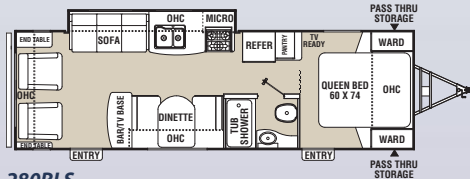

280RLS

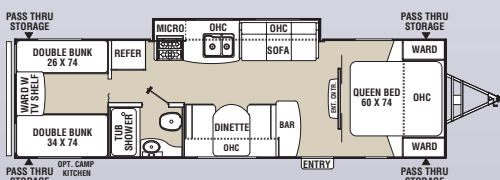

291QBS

Freedom Express	237RBS	242RBS	280RLS	291QBS
Base Weight	4790	4713	4991	5333
Hitch Weight	490	442	587	594
Carrying Capacity	2310	2287	2596	2267
Exterior Length	27'6"	27'9"	31'3"	33'4"
Exterior Height	10'3"	10'3"	10'3"	10'3"
Awning Size	14'	14'	15'	15'
Fresh Water gal.	49	49	49	49
Grey Water gal.	34	34	34	34
Waste Water gal.	32	32	32	32
LPG Capacity lbs.	40	40	40	40



Deep Slides

Freedom Express has created 38" Deep Slide models that offer expansive single, and double slide living areas, while remaining within today's half-ton truck tow ratings. Choose from the industry's best bunk and rear lounge models, as well as V-nose and Toy Hauler floorplans.

The Liberty Edition luxury upgrade is available on Deep slide models (Maple Leaf Edition in Canada). It includes high end amenities usually reserved for travel trailers and fifth-wheels costing thousands of dollars more. (See page 7 for details.)



302FKV Deep Slide with Liberty Edition in Latte décor and free standing table and chair option shown above.

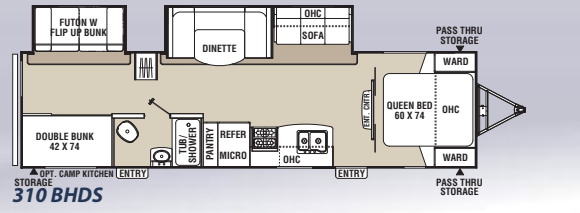
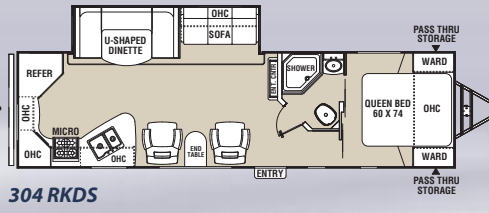
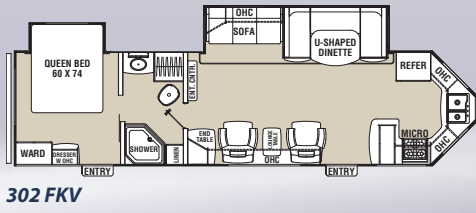
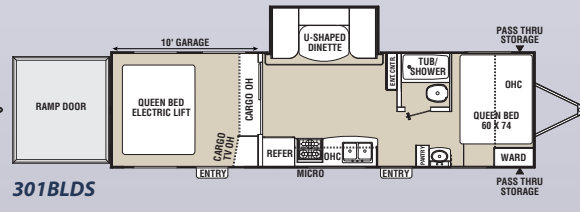
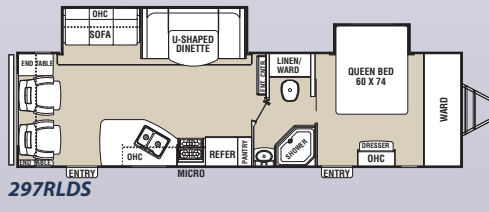
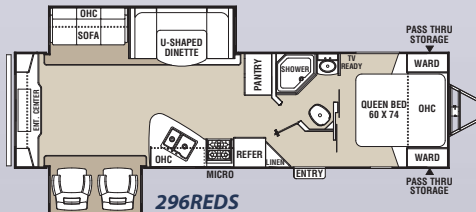
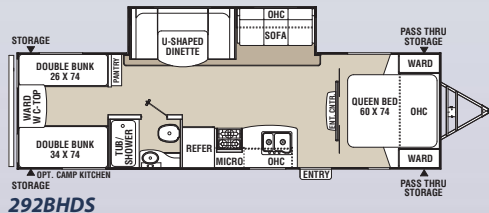
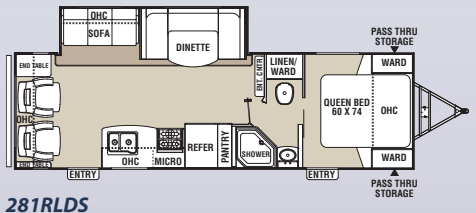
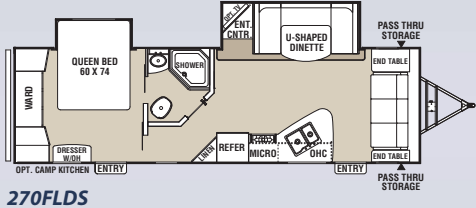

Deep Slide	270FLDS	281RLDS	292BHDS	296REDS	297RLDS	DS TH 301BLDS	V-Nose 302FKV	304RKDS	310BHDS
Shipping Weight	6385	6040	5590	6850	6805	6560	6893	6260	6890
Hitch Weight	886	658	740	667	898	980	889	740	865
Carrying Capacity	2348	1418	2010	3050	2953	3298	2865	2698	3010
Exterior Length	32'3"	31'8"	33'5"	34'2"	35'2"	33'3"	34'9"	34'4"	35'7"
Exterior Height	10'9"	10'7"	10'7"	10'9"	10'7"	11'9"	10'9"	10'9"	10'9"
Awning Size	15'	15'	15'	15'	18'	15'	18'	18'	15'
Fresh Water gal.	49	49	49	49	49	98	49	49	49
Grey Water gal.	34*	34	34	34	34	34	68	68	34
Waste Water gal.	32	32	32	32	32	32	32	32	32
LPG Capacity lbs.	40	40	40	40	40	40	40	40	40

*68 gallons with Camp Kitchen option

302FKV Deep Slide This gourmet kitchen in the 302FKV V-Nose with the Liberty Edition luxury upgrade has raised panel cabinetry, a solid surface counter top with undermount sink, and a pull out sprayer faucet.





Lightweight Towability and Enhanced Aerodynamics

Freedom Express Ultra-Light travel trailers are ideal for half-ton tow vehicles and optimized fuel efficiency. Designed with fully laminated, aluminum framed walls, floor and roof, Freedom Express travel trailers and hybrid expandables are incredibly lightweight and durable.



- 50% Lighter than wood
- No rot, mold or water damage
- R-2 thermal insulation
- Odorless, no formaldehyde
- Sound & energy absorbing
- Impact & puncture resistant
- Made in USA

Standard Decor

Greystone



Copper



Merlot



Liberty Edition Upgrade Decor

Caramel



Latte



Freedom Express & Deep Slide Standard Features & Options

FE = Freedom Express ■ DS = Deep Slide Models ■ LTZ = Travel Trailers/EXP/260BL Toy Hauler ■ EXP = Expandable Models ■ TH = Toy Hauler ■ Incl = Included (Not option)

	LTZ	FE/DS
INTERIOR & DÉCOR		
Cierra Cherry Colored Cabinetry with Chocolate Accents and Arched Overheads	X	X
Maple Hardwood Cabinet Doors and Drawer Faces	X	X
Furniture Grade, Pocket Drilled and Screwed Stile and Rail Cabinet Front Construction	X	X
Mortise & Tenon Cabinet Door Construction	X	X
Full Extension Roller Bearing Drawer Guides	X	X
Three Designer Decors - Copper, Greystone, Merlot	X	X
Soft Valance Window Treatments with Mini-Blinds	X	N/A
Designer Hard Valance Window Treatments	N/A	X
Pleated Night Shades in Living Area	N/A	X
Optic-Lense Lighting Package	X	X
Range Hood with 12V Exhaust and Light	X	X
Sealed/Seamless Countertops	X	X
Brushed Nickel Hardware	X	X
High-Rise Kitchen Faucet	X	X
60/40 Stonecast Composite Kitchen Sink	N/A	X
Silverware Drawer with Removable Tray	X	X
Jackknife Sofa	X	X
43" Deep Convertible Booth Dinettes (Select models)	X	X
87" Convertible U-Dinettes (Select models)	X	X
Dinette Storage Access Doors (Deep Slides)	N/A	X
Accent Wall With Designer Headboard in Master Bedroom (Most Models)	X	X
Evergreen Sleep System Mattress	X	X
Two Full-Length Mirrored Closets in Master, and Over-Bed Cabinets with Integrated Reading Lights	X	X
Two Nightstands with 110V Outlets (Most models)	X	X
Storage Under Master Bed and Bunks (Select models)	X	X
Wooden Privacy Slider Doors to Master Suite In Place of Curtain or Accordion Door (Most models)	N/A	X
Entertainment Tower with Rotating TV for Bedroom Viewing (Select models)	N/A	X
Exhaust Vent with Fan in Bathroom	X	X
Wood Medicine Cabinet with Bathroom Mirror	X	X
Foot Pedal Toilet	X	X
Four Interior Speakers with Selector Switch	N/A	X
Two Interior Speakers with Selector Switch	X	N/A
55 Amp Power Converter	X	X
GFI Receptacles in Bathroom and Kitchen	X	X
LP Leak Alarm	X	X
Fire Extinguisher	X	X
Smoke and Carbon Dioxide Detector	X	X
Multiple Egress Windows with Screen and Prop Rod	X	X

	LTZ	FE/DS
Shoe Storage (Select models)	X	X
Cable Support Tent Ends - 1000# Capacity (EXP)	EXP	N/A
Frame Mounted Tie-Down D-Rings In Floor	TH	TH
Adjustable High/Low Fresh Air Vents	TH	TH
Zippered Rollup Screen Wall with Privacy Panels at Ramp Door	TH	TH
Two Jackknife Sofas In Cargo Area (260BL)	TH	N/A
Large Indoor/Outdoor folding Table (260BL)	TH	N/A
Raised Roof Line - 90" Interior Cargo Height (301BLDS)	N/A	TH
Beavertail Ramp Transition (301BLDS)	N/A	TH
Sliding Patio Door Between Cargo and Living Areas (301BLDS)	N/A	TH
Helmet/Gear Storage in Cargo Area (301BLDS)	N/A	TH
Interior Package	N/A	X
Value Package	X	N/A
Convenience Package	X	N/A
EXTERIOR		
Aerodynamic Front Profile	X	X
Dual 20# LP bottles	X	X
LP Bottle Cover w/Valve Access	X	X
60° A-frame	X	X
Dual Battery Rack	X	X
Insulated and Painted Radius Entry Door w/Clear View Slider on Screen	X	X
Amber Patio Light	X	X
Double Entry Step	X	N/A
Triple Entry Step	N/A	X
Wide Stance Stable-Ryd Spread Axle Design	TH	X
Premium Five-Spoke Aluminum Rims	OPT	X
Nitrogen Filled Radial Tires	X	X
Automotive Process Painted Fenders	N/A	X
3M Digitally Printed, Breathable Graphics	X	X
Black Framed, Tinted, Safety Glass Windows	X	X
Marine Grade Exterior Speakers	X	X
Coleman 10K BTU Grill Station w/Storage	OPT	X
Lighted Expanded Pass-through Storage (Most models)	X	X
Winterization Kit	X	X
30 Amp Power Cord with Storage Compartment	X	X
Heavy Duty Welded Safety Chains	X	X
Four-Wheel Electric Brakes	X	X
Breakaway Safety Cable	X	X
Exterior GFI Outlet Near Awning	X	X
High-Capacity Roto-Cast Holding and Fresh Water Tanks	X	X
Hinge Mounted Spring Assist Ramp Door System	TH	TH
Integrated Bar and Latch Locking System on Ramp Door	TH	TH

	LTZ	FE/DS
Happijac Double Hat Rail, Rack & Pinion 12V Slide System (18" slides)	X	X
LCI Rack & Pinion 12V Slide System with Full Width Welded Ram (38" slides)	N/A	X
A-Frame Mounted Generator/Storage Rack (N/A on Liberty/Maple Leaf Editions)	TH	TH
Exterior Package	N/A	X
Freedom Power Package	N/A	X
CONSTRUCTION		
Powder E-Coated Welded I-Beam Frame with Full Width Outriggers	X	X
Alumicage Welded Aluminum Structure, Vacuum Bonded Floor and Sidewalls	X	X
Azdel Composite (IPO Iauan behind fiberglass)	X	X
Smooth Fiberglass Exterior Skin	X	X
Aluminum Framed Openings	X	X
Powder E-Coated Steps and Axles	X	X
Floorplan Specific Cambered Frame Design	X	X
Full Walk-on, Crowned, Aluminum Reinforced Roof with EPDM Membrane over 3/8" Roof Decking	X	X
Double Wiper Seals on All Slideouts	X	X
Enclosed and Heated Underbelly	N/A	X
STANDARD EXTRAS		
Green Certification	X	X
Seal Tech and Rain Bay Testing on Every Unit	X	X
One-Year Free Membership to Coachnet Roadside Assistance	X	X
One-Year Free Membership to Coachmen Owner's Association (C.O.A.)	X	X
OPTIONS		
15,000 BTU A/C	X	X
Coleman Slide-Out Grill Station	X	Incl
Hi-Output Grill (Select models)	X	N/A
Electric Awning (IPO Manual)	X	Incl
24" LED TV	X	Incl
Premium Five-Spoke Aluminum Rims	X	Incl
Stow-N-Go Storage Door (select models)	N/A	X
Freedom Camp Kitchen (select models)	N/A	X
Hide-A-Bed Sofa (most Deep Slide models)	N/A	DS
Free-Standing Dinette w/4 Chairs (Deep Slide only)	N/A	DS
Liberty/ Maple Leaf Edition Luxury Upgrade (DS only- description below)	N/A	DS
Electric Queen Track Bed	TH	TH
Sit-N-Sleep Sofa	TH	TH
Happijac Dinette w/ Indoor/Outdoor Table	N/A	TH
Canadian compliance	X	X

PACKAGES & OPTIONS	LTZ	EXP	260BL
Value Package	Incl	Incl	Incl
Convenience Package	Incl	Incl	Incl
Aluminum Wheels	Opt	Opt	Incl
Electric Awning	Opt	Opt	Opt
24" LED TV	Opt	Opt	Opt
Coleman Grill Station	Select	Select	Opt
15K BTU A/C	Opt	Opt	Opt
Electric Track Queen Bed	N/A	N/A	Opt
Sit-N-Sleep Sofa Bed	N/A	N/A	Opt
Coachmen Roadside Assistance	Incl	Incl	Incl
COA Membership (1-Year)	Incl	Incl	Incl
PACKAGES & OPTIONS	FE	DS	301BLDS
Exterior Package	Incl	Incl	Incl
Interior Package	Incl	Incl	Incl
Freedom Power Package	Incl	Incl	Incl
Aluminum Wheels	Incl	Incl	Incl
Stow-N-Go Door	Select	Select	N/A
Freedom Camp Kitchen	Select	Select	N/A
15K BTU A/C	Opt	Opt	Opt
Liberty/Maple Leaf Edition	N/A	Opt	Opt
Hide-A-Bed Sofa	N/A	Opt	N/A
Freestanding Table & Chairs	N/A	Opt	N/A
Electric Track Queen Bed	N/A	N/A	Opt
Sit-N-Sleep Sofa Bed	N/A	N/A	Opt
HappiJac Dinette w/Table	N/A	N/A	Opt
Coachmen Roadside Assistance	Incl	Incl	Incl
COA Membership (1-Year)	Incl	Incl	Incl

	LTZ	FE/DS
FREEDOM POWER PACKAGE	N/A	X
• Push Button Power Awning with Automatic Rain Dump and Tilt		
• Push Button Power Tongue Jack		
• Push Button Power Stabilizer Jacks		
• AM/FM/CD Player with MP3, Media Ports, and Built-in DVD Player		
LIBERTY/MAPLE LEAF EDITION	N/A	DS
(DS Models Only)		
• Raised Panel Sierra Cherry Glazed Maple Doors		
• Raised Panel Refer Insert		
• Solid Surface Kitchen Countertop with Undermount Sink		
• Hinged Door, Slider Door, and Pots and Pans Drawer Under Dinette		
• Two Upgrade Décors - Caramel or Latte		
• Porcelain Toilet with Foot Flush		
• Kitchen Feature Wall/Backsplash		
• Central Control Panel for Switches and Gauges		
• Congoleum Designer Carefree Premium Floorcovering		
• 32" LCD TV replaces 24"		
• Freedom Sky View Window with Pleated Shade and Hi-Intensity Puck Lights over Dinette		
• Sconce Light in Slide Out		
• LED Accent Lights in Kitchen		
• Painted Fiberglass Cap with LED Hitch and Marker Lights		
• Special Liberty/Maple Leaf Edition Graphics with Charcoal Skirt Metal		
• Slam Latch Baggage Doors on Pass Through Storage		
• Enclosed and Heated Gate Valves		
• Camp Side Security Light		
• Black Tank Flush System		
• Outside RG6 TV Hookup		

	LTZ	FE/DS
INTERIOR PACKAGE (FE/DS)	N/A	X
• Congoleum Designer Carefree Resilient Flooring		
• Privacy Night Shades (Living Areas)		
• Foot Flush Toilet		
• Sky Light in Bath		
• RG6 Satellite Ready Cable TV Hookup		
• Tile-Look Tub Surround with Built In Shelves		
• Large Double Door Refrigerator with Temperature Control		
• 13,500 BTU Ducted Roof A/C		
• Ducted Forced Air Furnace		
• Maple Mortise and Tenon Cabinet Doors, Arched Overheads		
• Maple Hardwood Drawer Faces		
• Microwave with Carousel		
• AM/FM/CD Player with MP3 and Media Ports		
• Oven with 3-Burner Cooktop		
• 24" HD-Ready LED TV		
EXTERIOR PACKAGE (FE/DS)	N/A	X
• Outdoor Slide-Out Grill Station		
• Coleman Portable Hi-Output Grill		
• 6-Gal. Gas/Electric DSI Water Heater		
• Tinted Safety Glass		
• Marine Grade Exterior Speakers		
• TV Antenna with Booster		
• 4 Stabilizer Jacks		
• Enclosed and Heated Underbelly		
• Hot and Cold Exterior Shower Station		
• Manual Patio Awning		
• A-Frame Mounted Spare Tire Kit		
• 24" Diamond Plate Front Rock Guard		
• Large Folding Entry-Assist Grab Handle		
• Super Lube Axle Hubs		
• RVIA Certification		

	LTZ	FE/DS
VALUE PACKAGE (LTZ)	X	N/A
• Congoleum Designer Carefree Resilient Flooring		
• Foot Flush Toilet		
• Tile-Look Tub Surround with Built In Shelves		
• 13,500 BTU Ducted Roof A/C		
• Maplewood Cabinet Doors and Drawer Faces		
• Microwave with Carousel		
• Range Hood with 12V Exhaust and Light		
• 3-Burner Cooktop		
• Monitor Panel		
• Tinted Safety Glass		
• A-Frame Mounted Spare Tire Kit		
• 4 Stabilizer Jacks		
• Dual 20# LP bottles		
• 24" Diamond Plate Front Rock Guard		
• Super Lube Axle Hubs		
• RVIA Certification		
CONVENIENCE PACKAGE (LTZ)	X	N/A
• Standard Patio Awning		
• Double Door Refer		
• 6 Gal Gas/Elec. Hot Water Heater		
• 3 Burner Cooktop with Oven		
• Hot and Cold Outside Shower		
• Deluxe LP Cover with Valve Access		
• AM/FM CD Player		
• 2 Interior, 2 Exterior Speakers		
• Cable Jack at TV Area		
• TV Antenna with Booster		



Freedom Express Construction Features

- | | | |
|-------------------------------------|-------------------------------------------------------------|------------------------------------------------------|
| 1. 3M breathable graphics | 8. Dual 20 lb. LP gas tanks | 14. HappiJac SureTrac™ rack and pinion slide systems |
| 2. Tinted, safety glass windows | 9. Aluminum structure, vacuum-bonded sidewalls and flooring | 15. Congoleum Designer Carefree Resilient Flooring |
| 3. Trussed crossmembers | 10. Smooth exterior fiberglass skin | 16. Powder E-coated, welded I-beam frame |
| 4. Crowned aluminum reinforced roof | 11. Aluminum framed openings | 17. Super-Lube® axle hubs |
| 5. EDPM rubber roofing | 12. Fully enclosed, heated underbelly | 18. Stable-Ryd® spread axle design |
| 6. Azdel Composite Panels | 13. Fully welded tubular aluminum floor structure | 19. Nitrogen filled radial tires |
| 7. Aerodynamic front profile | | |



Freedom Express is Truly Green

Freedom Express is TRA gold level rated. As a certified green RV, Freedom Express utilizes effective production techniques in combination with healthy materials, plus efficient usage of energy and water to produce a high quality RV with less environmental impact.



Freedom Express Wins the Annual DSI Quality Circle Award – Two Years in a Row!



423 N. Main Street ■ P.O. Box 30 ■ Middlebury, IN 46540

To learn more about Coachmen RV and our products and see how Coachmen is making the easy life easier, visit www.coachmenrv.com or call 1.800.353.7383.



Big benefits for new owners – FREE One Year Membership in the Coachmen Owners Association!

Coachmen is proud to sponsor the largest manufacturer sponsored camping club in North America... Coachmen Owners' Association (COA). COA provides you a world of ways to enjoy your RV. This is FUN ON OVERDRIVE and provides: Free Trip Routing, Exciting Tours & Rallies, Free Campground Directory, Local/State Club Activities, Easy RVing Magazine Free, Theme Park Discounts, Fuel Discounts, Free onebigplanet® Memberships with discounts at 180,000 merchants and Much More! Every new Coachmen RV buyer is eligible for a 1 Year FREE membership in the Coachmen Owners' Association. It all adds up to an easy ownership experience!



Travel Easy™ Roadside Assistance

RVing is easier with Coachmen's Travel Easy™ Roadside Assistance provided FREE the first year of ownership to those who purchase a New Coachmen RV. Administered by Coach-Net, this service provides you with 24/7 operational, technical and emergency road service coverage. Also included is towing, fuel delivery, jump starts, lockout service, tire changes, mobile mechanic and unlimited technical assistance. Anywhere. Anytime. Travel Easy™ is the security of knowing that help is an easy phone call away.



Forest River, Inc. encourages our customers to purchase their Forest River products from a local dealership whenever possible for the following reasons:

- 1) Forest River, Inc. dealers are independently owned and operated businesses so priority service and scheduling is at their discretion and is often provided to customers that purchased their unit at that dealership.
- 2) Purchasing locally allows customers to establish meaningful relationships with a dealer, enhancing the RV experience through assistance with product questions, user tips or RV regulations for your state or country, and much more!
- 3) Canadian customers must meet requirements to bring an RV purchased out of the country to their home. These requirements may involve additional inspections and certifications, taxes and fees. Your local Canadian Dealer is a professional at meeting these requirements.
- 4) Scheduling timely warranty repairs and adjustments through a local dealership provides far greater flexibility and convenience to you, the customer!

It is the goal of Forest River, Inc. that all of our RV owners fully enjoy the RV experience and that customer satisfaction meets or exceeds their expectations!



Learn More
Scan this barcode using a QR Reader on your smart phone to learn more about Forest River.



A Berkshire Hathaway company.