

# ROCKWOOD

Freedom • Premier • High Wall • Hard Side

ROCKWOOD Freedom • Premier • High Wall • Hard Side



ROCKWOOD  
**FREEDOM**



## **ROUGHING IT? NOT WITH THE FREEDOM. HERE'S WHY:**

*Yes, you're camping, but that does not mean your comfort stays home. Residential living standards that make life easy make camping easy.*

Features like the three-speed Create-A-Breeze ventilation fan to pull in fresh outside ambient air so you remain comfortable at night, and swing level galley to keep kitchen utensils in their place are simple amenities that add tremendously to the comfort of your vacation. It's your vacation. Do it right.



ROCKWOOD

# FREEDOM

## STANDARD & OPTIONAL FEATURES

*Here are a few features that make our tent campers meet and exceed expectations.*



Water Pump w/ Filter  
*(Std.)*



Easy Glide Scissorpole Bed Supports  
*(Except LTDs)*



Plywood Bed Ends  
*(N/A Hard Side)*



Heated Mattress  
*(Std. Opt.)*



Outside grill  
*(Std. Freedom, Premier, Hard Side,  
High Wall Opt. LTD)*



Under Floor 20 Gallon Water Tank  
*(Except LTDs)*



Crank Down Stabilizer Jack *(Std.)*



Swing Down galley *(Except LTDs)*



ROCKWOOD  
**PREMIER**



WE CALL IT  
**PREMIER**  
FOR A VERY GOOD REASON

*The Rockwood Premier is the premier tent camper on the market today.*

It is loaded with features that make your camping experience more enjoyable. From the expansive sliding storage trunk for that extra cargo space, to a comfortable, heated, inner-spring mattress, for a peaceful night's sleep and the convenient power lift system for easier setup are some of the basic features that really make your camper a Premier.



# ROCKWOOD PREMIER



Hanging Shirt Bar  
*(Std. Premier, Hard Side & High Wall)*



Bunk Light and Fan  
*(Std. Premier & High Wall)*

Metal Full Extension Drawer Guides  
*(Std.)*

One Piece Door *(Except LTD's, Hard Side)*



Sliding Storage Trunk *(Some Models)*



Fantastic Fan *(Except LTDs.)*



Outside Shower  
*(Incl. w/ Hot Water Pkg: Std: Premier, Hard Side, High Wall and Opt: Freedom)*



Large Entry Assist Handle  
*(Except LTD's)*



ROCKWOOD  
**HIGH WALL**



KEEP THE OTHER CAMPERS  
**GUESSING:**  
WHY DON'T THEY HAVE TO GO TO THE  
**BATH HOUSE**  
LIKE EVERYBODY ELSE?

*Wanting to camp, but tired of giving up the comforts of home? Welcome to the Rockwood High Wall Series.*

We have designed this series for the camping family who wants the refinement of larger vacationing units in a light-weight camper. Ample counterspace, upgraded appliances and tasteful interiors make this camper a gorgeous option to experience.

**HW 296**



# ROCKWOOD HIGH WALL



AM/FM Stereo CD Player w/ Outside Speaker  
(Std. Premier, Hard Side & High Wall)

Hanging Wardrobe  
(Opt. all Models Except Freedom,  
Hard Side & LTD's)

Double Entry Step (Std. Freedom XR  
Models and All HW Models)

Power Lift (Std. Premier, High  
Wall and Freedom XR models.  
Opt. LTD and Freedom)



Beautiful hardwall shower with a  
residential-style flush toilet complete  
with a 12-gallon black water holding  
tank. (Std. High Wall Except HW257)

Black water hose storage  
(Std. HW models Except HW 257)

Add-a-Room with Privacy Panels  
(Opt. all Models Except Hard Side)





ROCKWOOD

# QUALITY CONSTRUCTION



- 1) Three Stage Double Arm Lifter Posts *(NA Hard Side)*
- 2) Fiberglass Vacuum Bonded Radius Roof w/  
No Center Seam *(NA Hard Side)*
- 3) Five-Piece Vinolon Supreme Tenting *(NA Hard Side)*
- 4) E-Z Crank Down Stabilizer Jacks w/Sand Pads
- 5) Full Perimeter Aluminum Bed Frames *(NA Hard Side)*
- 6) Plywood Bunk Ends *(NA Hard Side)*
- 7) Seven-Way Pigtail Wiring
- 8) Under Floor 20 Gallon Fresh Water Tank  
*(LTDs 11 Gallon Above Floor)*
- 9) Powder Coated Tubular Steel Frame
- 10) Powder Coated Rafter Poles and Bed Bows  
*(NA Hard Side)*
- 11) Air Conditioner Reinforcing Laminated Into Roof  
*(NA Hard Side)*
- 12) Steel Belted Radial Tires
- 13) Easy Lube Axles *(Except LTDs)*
- 14) Smooth Fiberglass Vacuum Bonded Exterior  
*(NA on Freedoms)*
- 15) One-Piece Door *(Except LTDs & Hard Side)*



## AL-KO® AXLES AND EASY LUBE HUBS

AL-KO Axles offer many advantages over conventional axles:

- Fully Independent Wheel Suspension
- No Metal to Metal Contact and No Springs, Shackles, Hangers, or U-bolts to Break or Wear Out
- Lower Trailer Center of Gravity For Improved Stability

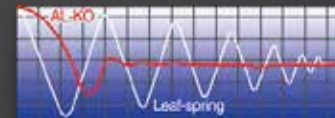

The UltraLube™ Hubs allow you to repack bearings quickly and easily without disassembly.

*Note: Torsion Axles on Premiers, HS's and HW's only. Easy-Lube Hubs on all units except LTDs.*

ROCKWOOD  
**HARD SIDE**



## WE'RE DEFINING HOW TO HAVE THE BEST OF BOTH

*When you combine the solid exterior of a travel trailer with a Premier tent camper, you get the Rockwood Hard Side Series, giving your camping experience the best of both.*

Bringing a smooth, fiberglass vacuum bonded exterior with a quick, easy set up, while retaining the towing and storage advantages of a tent camper, the Hard Side camper is the perfect blend.

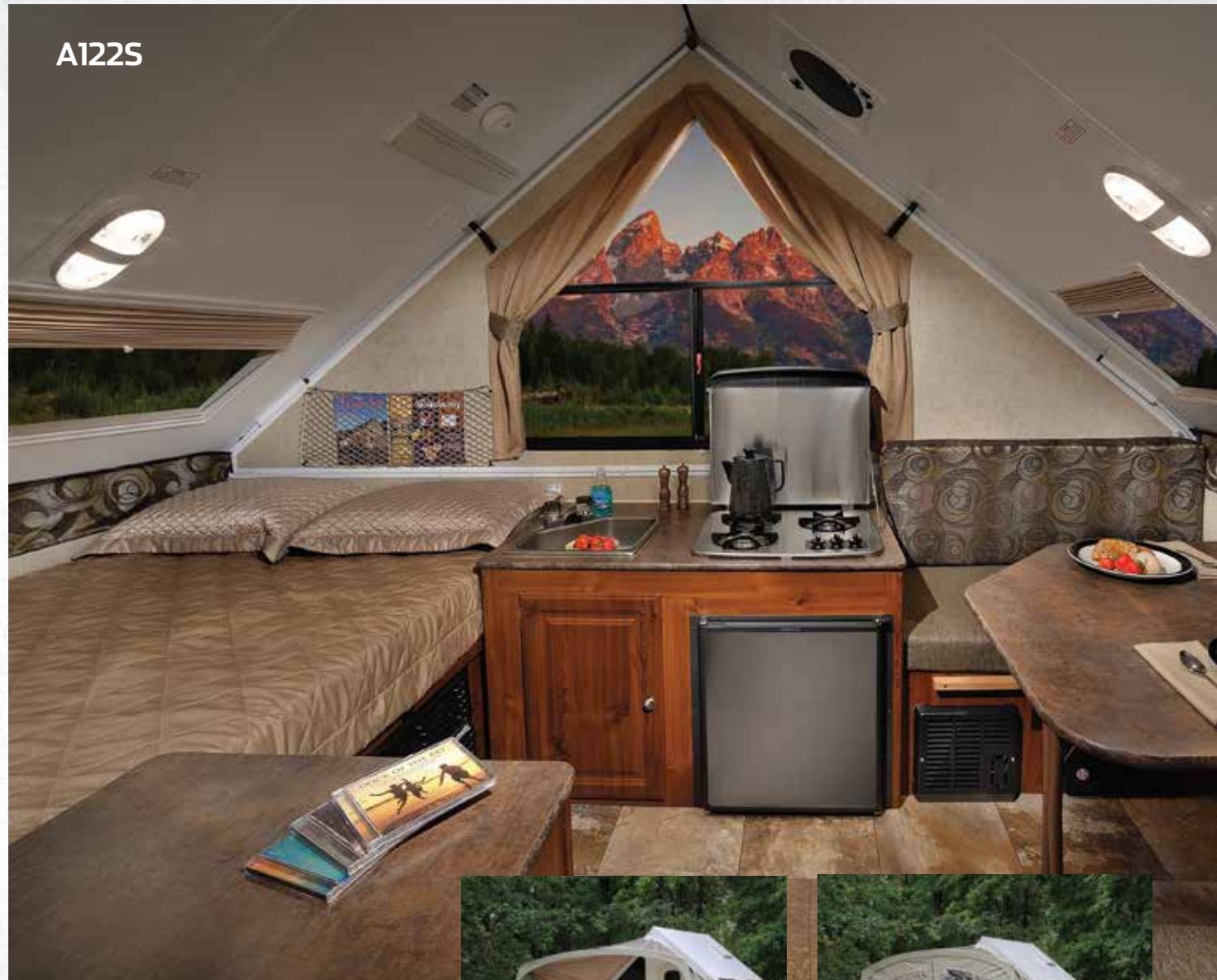

Hard Side Awning & Screen Room option.

# ROCKWOOD HARD SIDE

**A122**

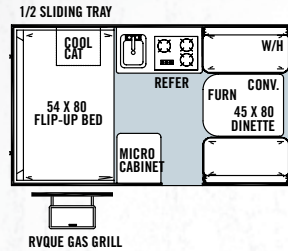

**A122S**

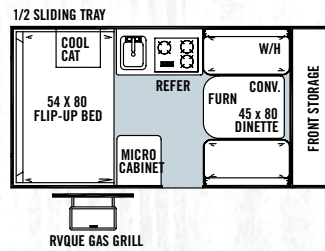

**A124S**

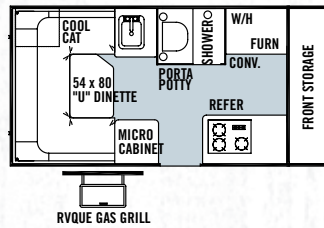

**A128S**

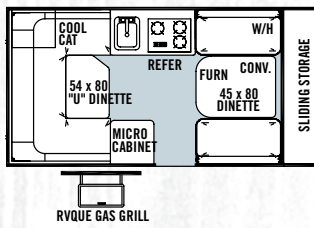

**A122BH**

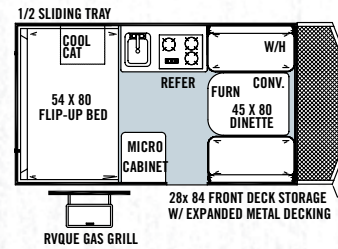

**A122TH**

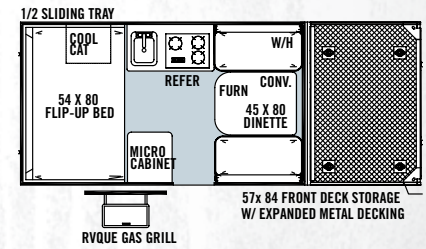

**A127TH**

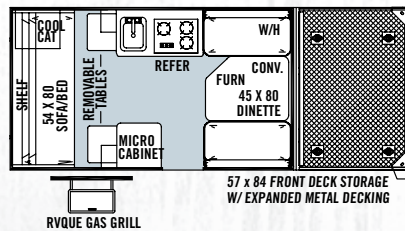

## Specifications

Model number of any particular unit does not necessarily reflect the overall length of the unit itself. Dry weight are estimates.

MODEL	A122	A122S	A124S	A128S	A122BH	A122TH	A127TH
GVWR (Gross Vehicle Weight Rating)	3261	3283	3280	3152	3292	3854	3849
BASE/DRY UNIT WEIGHT	1888	1955	1949	1916	1973	2186	2152
BASE DRY HITCH WEIGHT	261	283	280	262	292	354	349
BASE DRY AXLE WEIGHT	1627	1672	1669	1654	1681	1832	1803
CARGO CAPACITY	1017	1217	1217	1217	1217	1630	1678
BOX SIZE	12'	12'	12'	12'	12'	12'	12'
TRAILER SIZE (CLOSED W/ HITCH)	17' 1"	18' 11"	18' 11"	18' 11"	19' 2"	22' 1"	22' 1"
HEIGHT (CLOSED)	60"	60"	60"	60"	60"	65"	65"
FRESH WATER CAPACITY	26	26	26	26	26	26	26



# ROCKWOOD

# PREMIER

## Specifications

Model number of any particular unit does not necessarily reflect the overall length of the unit itself.  
Dry weight are estimates.

MODEL	1904	1907BH	2317G	2514G	2516G
GVWR (Gross Vehicle Weight Rating)	3212	3299	3358	3303	3292
BASE/DRY UNIT WEIGHT	1986	2018	2445	2446	2473
BASE DRY HITCH WEIGHT	258	299	358	303	292
BASE DRY AXLE WEIGHT	1728	1713	2087	2143	2181
CARGO CAPACITY	1017	1262	894	838	800
BOX SIZE	10'	10'	12'	12'	12'
TRAILER SIZE (Closed w/ Hitch)	17' 1"	17' 3"	19' 1"	19' 1"	19' 1"
HEIGHT (Closed)	57"	57"	61"	61"	61"
TRAILER LENGTH (Open)	20' 4"	20' 6"	23' 9"	23' 9"	23' 9"
FRESH WATER CAPACITY	26	26	26	26	26

1904

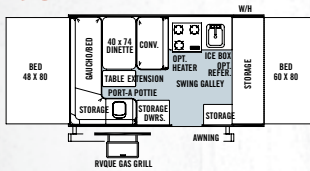

1907BH

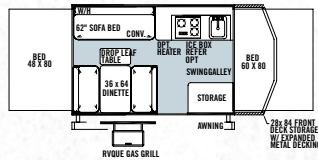

2317G

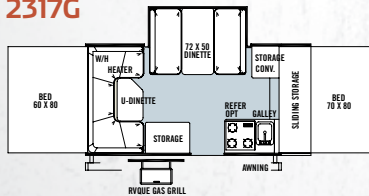

2514G

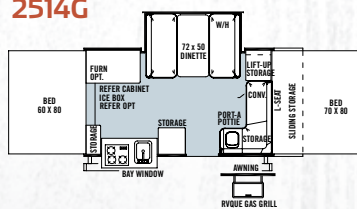

2516G

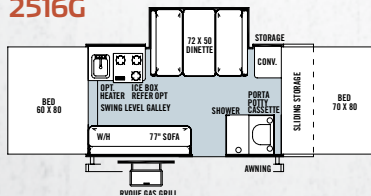

# ROCKWOOD

# HIGH WALL

## Specifications

Model number of any particular unit does not necessarily reflect the overall length of the unit itself.  
Dry weight are estimates.

MODEL	HW 257	HW 276	HW 277	HW 296	HW 316TH
GVWR (Gross Vehicle Weight Rating)	3815	3779	3859	4573	6250
BASE/DRY UNIT WEIGHT	2773	2806	2959	3135	3676
BASE DRY HITCH WEIGHT	315	279	359	373	404
BASE DRY AXLE WEIGHT	2458	2527	2600	2762	3272
CARGO CAPACITY	1042	935	862	1217	2317
BOX SIZE	12'	14'	14'	16'	14'
TRAILER SIZE (Closed w/ Hitch)	19' 1"	19' 4"	19' 4"	21' 4"	28' 4"
HEIGHT (Closed)	71"	71"	71"	72"	71"
TRAILER LENGTH (Open)	23' 9"	25' 9"	25' 9"	27' 9"	33' 9"
FRESH WATER CAPACITY	26	26	26	26	26
GRAY WATER CAPACITY	6	12	12	12	12
BLACK WATER CAPACITY	N/A	12	12	12	12

HW257

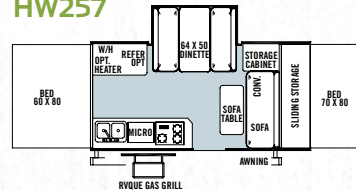

HW276

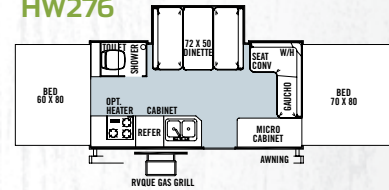

HW277

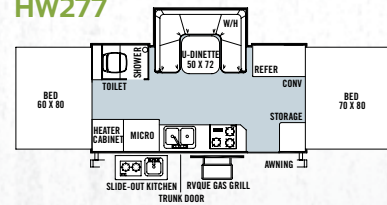

HW296

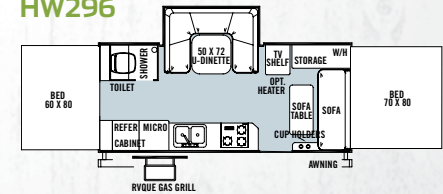

HW316TH

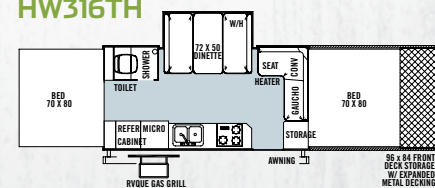

1910

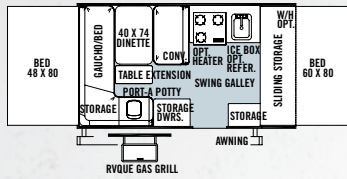

1950

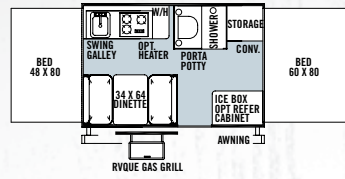

1970

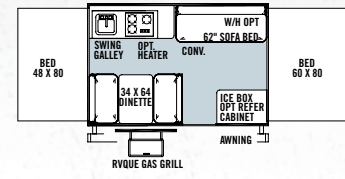

1980

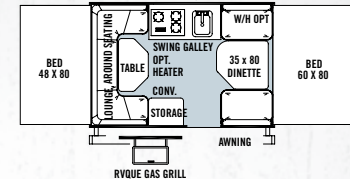

2270

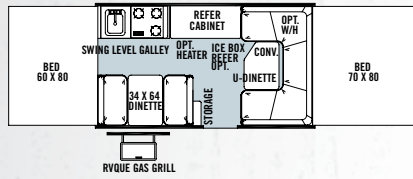

2280

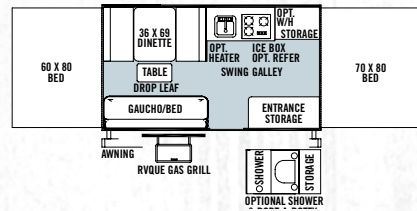

2280BH

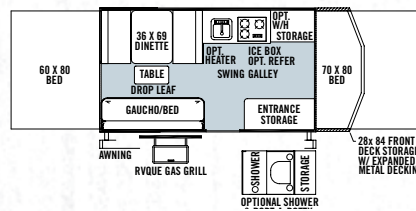

2318G

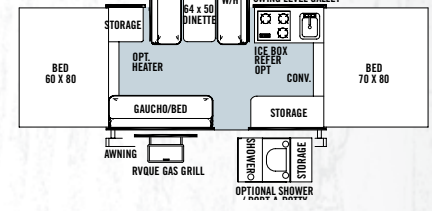

2560G

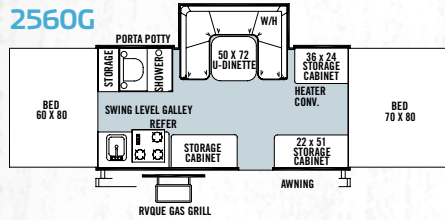

232XR

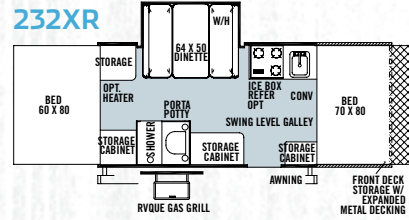

282TXR

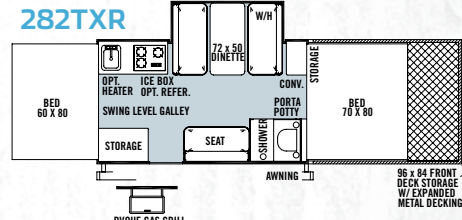

# ROCKWOOD FREEDOM

## Specifications

Model number of any particular unit does not necessarily reflect the overall length of the unit itself.  
Dry weight are estimates.

MODEL	1910	1950	1970	1980	2270	2280	2280BH	2318G	2560G	1640LTD	1940LTD	232XR	282TXR
GVWR (Gross Vehicle Weight Rating)	2983	2876	2786	2768	3043	3081	3100	3063	3249	2148	2274	3810	5579
BASE DRY UNIT WEIGHT	1867	1732	1764	1737	2006	2050	2064	2153	2364	1344	1493	2579	2975
BASE DRY HITCH WEIGHT	233	240	252	219	293	331	350	313	249	190	174	310	219
BASE DRY AXLE WEIGHT	1634	1492	1512	1518	1713	1719	1714	1840	2115	1154	1319	2269	2756
CARGO CAPACITY	1097	917	866	866	966	966	1017	891	866	683	762	1212	2317
BOX SIZE	10'	10'	10'	10'	12'	12'	12'	12'	14'	8'	10'	12'	12'
TRAILER SIZE (Closed w/ Hitch)	17' 1"	15' 3"	15' 3"	15' 3"	17' 2"	17' 2"	18' 8"	17' 2"	19' 2"	12'	14'	21' 9"	26'
HEIGHT (Closed)	57"	57"	57"	57"	57"	57"	57"	57"	57"	56"	56"	62.5"	62.5"
TRAILER LENGTH (Open)	20' 4"	20' 1"	20' 1"	20' 1"	23' 10"	23' 10"	23' 10"	23' 10"	25' 10"	17' 1"	20' 1"	26' 5"	30' 8"
FRESH WATER CAPACITY	20	26	20	20	20	20	20	20	26	11	11	26	26

# TENT CAMPER STANDARD & OPTIONS

MODELS	LTD	F	P	HS	HW
<b>STANDARD &amp; OPTIONAL FEATURES</b>					
Cherry Interior with "Tile-Look" Linoleum	--	--	S	S	S
Hickory Interior with "Tile-Look" Linoleum	S	S	--	--	--
Two-Tone Fabric Interiors	S	S	S	S	S
Residential Style Kitchen Faucet	S	S	S	S	--
Stainless Steel Look Appliances and Sink	--	--	S	S	S
Double Pan Sink with High Rise Faucet	--	--	--	--	S
Electric Water Pump	S	S	S	S	S
Hot Water Package (Incl. Water Filter, Outside Shower, Six Gallon DSI Hot Water Heater) (F: 1910, 1970, 1980, 2270, 2280, 2280BH, 2318G)	--	0*	S	S	S
Port-a-Potty (F: 1910 Only P: 1904, 2514G HS: A122, A122S, A122BH, A128S, A122TH, A127TH)	--	S*	S*	S*	--
Shower Cassette Package Incl. Water Filtration System, Six Gallon DSI Hot Water Heater, Demand Water Pump, and Cassette Toilet (Opt. F: 2280, 2280BH, 2318G) (Std. F: 1950, 2560G, 232XR, 282TXR P: 2516G, HS: A124S)	--	S*/O*	S*	S*	--
Hard Wall Shower with Residential Flush Toilet (N/A HW257)	--	--	--	--	S*
Fold Over Galley with Upper and Lower Storage (Std. P: 2514G Only)	S	--	S*	--	--
Two Burner Free-Standing Range	S	--	--	--	--
Swing Level Galley with Storage (N/A P: 2514G, 2317G)	--	S	S*	--	--
Permanently Mounted 3-Burner Indoor Range w/ Stove Cover	--	S	S	S	--
Three Burner Stove with Oven	--	--	--	--	S

MODELS	LTD	F	P	HS	HW
Microwave	--	--	--	S	S
Large Built-In Icebox	S	S	S	--	--
1.9 Cubic Ft. Refrigerator	0	0	--	--	--
3 Way Refer 2.5 cu. ft. 110V & 12V	--	--	0	S	--
Extra Large 4.0 cu. ft. Refrigerator	--	--	--	--	0
Free Standing Lite-Ply Table --					
High Pressure Laminate	S	S	S	S	S
Comfortable Family Style Dinette w/ 4" Cushions	S	OPA	S	S	S
Residential Style Raised Panel Doors	--	--	S	S	S
Wood Drawers w/ Full Extension Metal Guides	S	S	S	S	S
Large Clothes Bar	--	--	S	S	S
Hanging Wardrobe	--	--	0	--	0
Hanging Pantry	--	0	0	--	0
AM/FM Stereo with CD player	--	--	S	S	S
TV Outlet with Cable and Satellite Hook Up	--	S	S	S	S
LCD TV (HW296 Only)	--	--	--	--	S*
30 Amp Detachable Power Cord w/ Storage Bag	--	S	S	S	S
25 Amp Converter w/ Built in Battery Charger	S	--	--	--	--
35 Amp Converter w/ Built in Battery Charger	--	S	S	S	S
12V Safety Switch	S	S	S	S	S
Roof Vent	S	--	--	--	--
Create-A Breeze Three Speed Fantastic Fan	--	SO	SO	SO	SO
Air Conditioner Wiring Kit	0	0	0	--	0
10k BTU Cool Cat Heat Pump	--	--	--	S	--
13.5k BTU Air Conditioner	--	--	--	--	0
20k BTU Forced Air Furnace w/ Electric Ignition	0	0	0	0	0
Interior Floor Lights	--	--	--	S	S
2 Single Ceiling Lights	S	--	--	--	--

MODELS	LTD	F	P	HS	HW
3 Single Ceiling Lights	--	S	--	--	--
2 Double Ceiling Lights	--	--	--	S	--
3 Double Ceiling Lights w/ Jacks for Accessories	--	--	S	--	S
Bunk Light with Fan	--	--	S	--	S
LP Leak Detector	S	S	S	S	S
Carbon Monoxide Detector	0	0	0	0	0
Privacy Curtains	S	OPA	S	S	S
Lined Privacy Curtain	--	--	S	S	S
Roof Valances	--	OPA	S	--	S
Quilted Top Bed Mattresses	S	S	--	--	--
Quilted Top Innerspring Mattresses (HS: A122, A122BH, A122S, A122TH Only)	--	--	S	S*	S
Thermostatically Controlled Heated Mattresses (HS: A122, A122BH, A122S, A122TH Only)	0	0	0	S*	0
Leaf-Spring Axle	S	S	--	--	--
Independent Torsion Axles	--	--	S	S	S
Easy Lube Axles	--	S	S	S	S
Spare Tire, Cover and Mount	S	OPB	OPI	S	OPI
12" Radial Tires	S	--	--	--	--
13" Radial Tires (Except XR Models)	--	S*	--	--	--
13" Radial Tires with Aluminum Wheels	--	--	S	S	--
14" Radial Tires with Aluminum Wheels	--	--	--	--	S
15" Mud Rover Radial Tires, Aluminum Wheels (Std. A127TH) w/ Shocks (Std. F: 232XR, 282TXR Only)	--	S*	--	S*	--
Electric Brakes	0	S	S	S	S
Sliding Storage Tray on All Front Trunk Models (Except P: 1904)	--	S*	S*	--	S*

LTD = LIMITED,  
F = FREEDOM,  
P = PREMIER,

HS = HARD SIDE,  
HW = HIGH WALL

S = STANDARD  
SO = STANDARD OPTION  
O = OPTIONAL

-- NOT AVAILABLE  
\* = SELECTED MODELS  
OP = OPTIONAL PACKAGE



MODELS	LTD	F	P	HS	HW
28.5" Front Storage Deck w/ Removable Deck					
Railing (Std. F: 2280BH, P: 1907BH, HS: A122BH Only)	--	S*	S*	S*	--
54" Front Storage Deck (Std. F: 232XR)	--	S*	--	--	--
57" Front Deck Storage (Std. HS: 122TH, A127TH)	--	--	--	S*	--
105" Front Storage Deck (Std. F: 282TXR, HW: HW316TH Only)	--	S*	--	--	S*
(4) Bike Rack (N/A M: 232XR, 282TXR HS: 122TH, 127TH HW: HW316TH)(Note: HS: A122 - 2 Bikes only)	0	0*	0	0*	0*
Power Lift System (Std. F: 232XR, 282TXR)	0	0	S	--	S
Built-in A-Frame Mounting Provision for Equalizer					
Hitch Bar Installation	S	S	S	S	S
Battery Box and Wiring Kit	0	S	S	S	S
20 lb. LP Bottle	S	S	S	--	--
(2) 20 lb. LP Bottles (Std. F: 232XR, 282TXR Only)	--	S*	--	--	--
Dual 20 lb. LP Bottles with Cover	--	0	0	S	S
Automatic LP Regulator	--	0	0	S	S
Diamond Plated Front Cap	--	--	--	S	S
Diamond Plated Front, Rear and Side Skirt (F: 232XR, 282TXR Only)	--	S*	--	--	--
Awning	S	OPB	OPI	--	OPI
Awning/Screen Room	--	--	--	0	--
Screen Room w/ Privacy Panels	0	0	0	--	0
Outdoor Gas Grill w/ Worktable	0	S	S	S	S
Outside Speaker	--	--	S	S	S
Patio Light (LTD: 1940 Only)	S*	OPA	S	S	S
Courtesy Light on Front (F: 2280BH, 232XR, 282TXR P: 1907BH HS: All Models)	--	S*	S*	S	--
110V Exterior Outlet (LTD: 1940 only)	S*	OPA	S	S	S
Black Water Hose Storage (HW: N/A HW257)	--	--	--	--	S*
Installed Door Step	S	OPB	OPI	S	OPI

LTD = LIMITED,  
F = FREEDOM,  
P = PREMIER,

HS = HARD SIDE,  
HW = HIGH WALL

S = STANDARD  
SO = STANDARD OPTION  
O = OPTIONAL

-- NOT AVAILABLE  
\* = SELECTED MODELS  
OP = OPTION PACK

MODELS	LTD	F	P	HS	HW
Installed Double Step (F: 232XR, 282TXR Only, HW: All Models)	--	S*	--	--	S
One Piece Screen Door	--	S	S	--	S
Vented Entrance Door Window w/ Screen	--	--	--	S	--
Folding Grab Handle	--	S	S	S	S
Exterior Graphic Design	S	S	S	S	S
<b>Option Pack I</b> (Incl. Spare Tire, Tire Bracket, Tire Cover, Installed Step, Awning)	--	--	0	--	0
<b>Option Pack B</b> (Incl. Spare Tire, Tire Bracket, Tire Cover, Installed Step, Awning)	--	0	--	--	--
<b>Option Pack A</b> (Incl. Privacy Curtains, Roof Valances, 4" Foam Cushions w/ Cover, Under Floor 20 Gallon Fresh Water Tank, A/C Bracing, Patio Light, 110V Exterior Outlet)	--	0	--	--	--
<b>STANDARD CONSTRUCTION FEATURES</b>					
Completely Enclosed Living Area	--	--	--	S	--
Fiberglass Vacuum Bonded Roof with Metal Interior Roof	--	--	--	S	--
Large Rear Roof Tinted Sky Light with Shade	--	--	--	S	--
Two Front Roof Tinted Windows with Shades	--	--	--	S	--
Fiberglass Vacuum Bonded Radius Roof w/ No Center Seam	S	S	S	--	S
Steel Air Conditioner Vent Reinforcing Laminated Into Roof	S	OPA	S	--	S
3-Stage Double Arm Lifter Posts	S	S	S	--	S
Tan Colored Smooth Fiberglass Vacuum Bonded Exterior	--	--	S	--	S
Smooth Fiberglass Vacuum Bonded Exterior	--	--	--	S	--
Lower Door Operational in Closed Position	S	S	S	--	S

MODELS	LTD	F	P	HS	HW
Five Piece Sectionalized Vinolon Supreme Tenting and Slide Out	S	S	S	--	S
Tent Permanently Attached on Bunk Ends					
Plywood Bunk Ends	S	S	S	--	S
Full Perimeter Aluminum Bed Frames	S	S	S	--	S
Easy Glide Scissor Pole Bed Supports	--	S	S	--	S
Powder Coated Rafter Poles and Bed Bows	S	S	S	--	S
Tinted Vinyl Windows	S	S	S	--	S
Large, Opening Picture Window	--	--	--	S	--
One Piece Undercoated Structure wood Floor	S	S	S	S	S
Powder Coated Tubular Steel Frame	S	S	S	S	S
Rear Crank Down Stabilizer Jacks w/ Sand Pads (4) E-Z Crank-Down Stabilizer Jacks w/ Sand Pads	S	--	--	--	--
Seamless, High Density Polyethylene Wheel Wells	S	S	S	S	S
11 Gallon Fresh Water Tank	S	--	--	--	--
Under Floor 20 Gallon Fresh Water Tank	--	OPA	S	S	S
12 Gallon Gray Water Holding Tank (HW: N/A HW257)	--	--	--	--	S*
6 Gallon Gray Water Holding Tank (HW: HW257 Only)	--	--	--	--	S*
12 Gallon Black Water Holding Tank (HW: N/A HW257)	--	--	--	--	S*
2000 lb. Tongue Jack w/ Swivel Wheel	S	S	S	S	S
Power Front Jack	--	--	--	0	0
7-Way Pigtail Plug	S	S	S	S	S



### PRE-DELIVERY INSPECTION FACILITY

20,000 square feet of quality assurance. The bare essentials for a premium product. This state-of-the-art facility gives immediate daily feedback to production for quality assurance in every unit built.



Forest River, Inc. encourages our customers to purchase their Forest River products from a local dealership whenever possible for the following reasons:

- 1) Forest River, Inc. dealers are independently owned and operated businesses so priority service and scheduling is at their discretion and is often provided to customers that purchased their unit at that dealership.
- 2) Purchasing locally allows customers to establish meaningful relationships with a dealer, enhancing the RV experience through assistance with product questions, user tips or RV regulations for your state or country, and much more!
- 3) Canadian customers must meet requirements to bring an RV purchased out of the country to their home. These requirements may involve additional inspections and certifications, taxes and fees. Your local Canadian Dealer is a professional at meeting these requirements.
- 4) Scheduling timely warranty repairs and adjustments through a local dealership provides far greater flexibility and convenience to you, the customer!

It is the goal of Forest River, Inc. that all of our RV owners fully enjoy the RV experience and that customer satisfaction meets or exceeds their expectations!

### 24/7 EMERGENCY ROADSIDE ASSISTANCE

For a worry-free ownership experience

Forest River includes one

year of Coach-Net RV Technical & Roadside Assistance with each RV purchase. Whether new to the RV lifestyle or an experienced RV enthusiast, Forest River owners have 24/7 access to technical, operational and emergency road service coverage throughout the US & Canada.

Coach-Net's fast, dependable service is just a phone call away.

## Coach-Net®

RV Technical & Roadside Assistance



ROCKWOOD

# WARRANTY

For details on Rockwood's complete warranty program, see your Rockwood dealer. When it comes to backing products with the same quality and commitment it does when it begins the manufacturing process, the only name you have to remember when you're looking for a recreational vehicle is Rockwood. Rockwood offers the following additional limited warranties to the original purchasers. Consult written warranty for details.

1. Five-year roof warranty, 2. Twenty-five-year floor warranty, 3. Five-year frame warranty, 4. Five-year tent warranty, 5. Five-year warranty on torsion axle suspension, 6. Limited life-time warranty of lifter system, 7. One-year bumper to bumper. Ask your dealer about the available lifetime structural warranty.

YOUR ROCKWOOD DEALER

201 West Elm Millersburg, IN 46543 | [www.forestriverinc.com/rockwood](http://www.forestriverinc.com/rockwood)  
574.642.2640



#### Learn More

Scan this barcode using a QR Reader on your smart phone to learn more about Forest River.



A Berkshire Hathaway company.

All specifications contained herein are based on the latest product information at time of printing. Forest River reserves the right to make changes in colors, materials, equipment and specifications at any time without notice and assumes no responsibility for any errors in this brochure. Litho. U.S.A 2012.09.26