

COACHMEN

CLIPPER Hybrid Camping Trailers

Time to
Relax.

Coachmen
Clipper



Coachmen
Leader to the Great Outdoors.



Coachmen Clipper

Presenting the all new 2013 Coachmen Clipper Hybrid Camping Trailer. Rebuilt from the ground up in ways you can see – new aerodynamic styling for ease of towing, full width stone guard to protect your investment, and radial tires for the safety you need and desire. These are but a few of the new features you will enjoy with your new Clipper!



Features you can't live without



Sliding Storage Trunk (SST)



New E-Z One-Hand Swing Level Galley (Classics and V1)



Optional AM/FM/CD/DVD/MP3 Player with Int./Ext. Speakers (Std. on Classics and V-Trec)



Exterior Utility Shelf

◀ **NEW One-Piece Entry Door**
The one-piece door features door panels that allows finite adjustment for air and sunlight. (N/A LS Series)



E-Z Swing Stepper Door



Optional Dometic® 3-Way Refrigerator



Dual Drive Dual Purpose Winch by Canimex

Scissor Style Stabilizer Jack



Optional Modular Cassette Potti with Electric Flush



Retractable Clothes Bar (Classics and V-Trec)

The Clipper Difference.

Construction & Features Competitors Can't Match

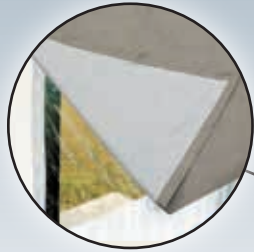

Lined drapes for improved privacy



Standard heated mattress features a Sunbeam® heating element.
(Opt. on 106 & 106ST)
(N/A on LS Series)



"Glide-N-Lock" bed system is the only cable-supported bed system in the industry. Simply pull out the beds until they lock into place. No more awkward poles to contend with!

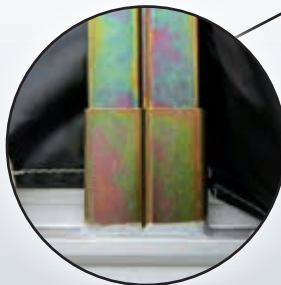

Goshen Stamping double-wide lifter post with limited lifetime warranty (N/A 806 LS)



Largest heating capacity of any folding camper.

- Optional 20M BTU Suburban® Furnace with forced air, electronic ignition and thermostat control.

VRX-14 Supreme Tent with storm cuff and tinted windows (No Stormcuff on LS Series)

Portable in/out dinette table



Polyflex woven moisture barrier laminated to all Clipper floors and bunks.

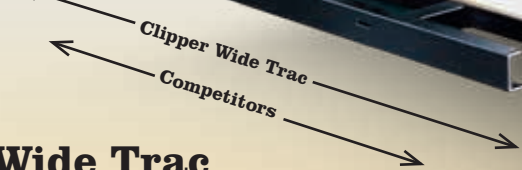
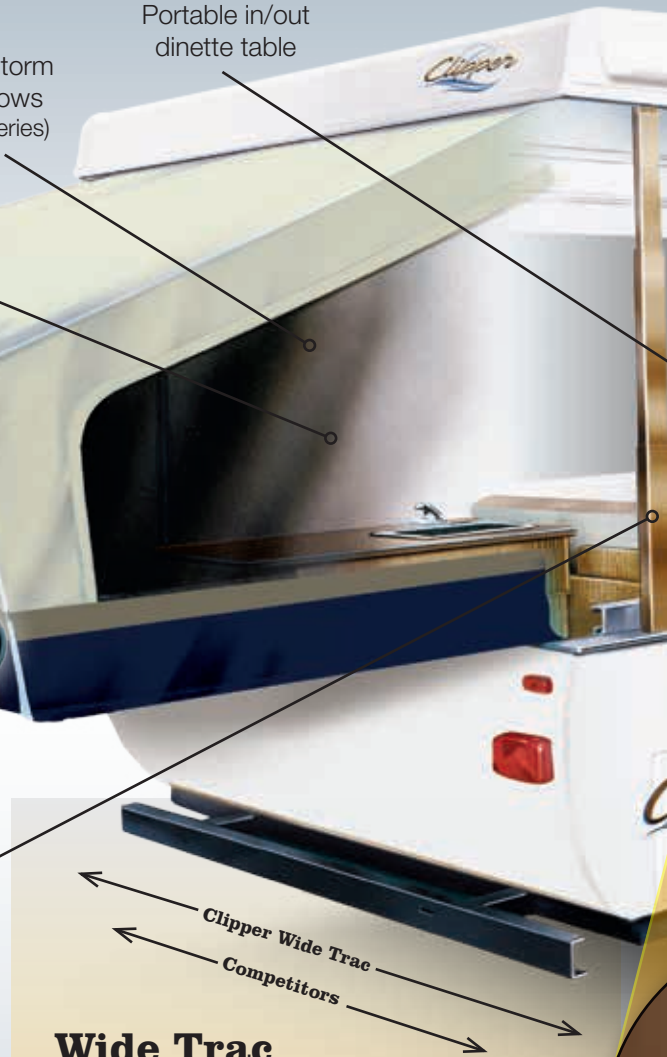

Wide Trac Suspension

Better safety and stability on the road.

- Widest stance of any folding camper
- Improves towing safety and stability
- Stronger axle beams than most competitors
- Steel frame with powdercoat protection

Dura Tuff Roof

A. One Piece Seamless Skin

B. Dura Tuff Wood Protective Layer

No one else includes the extra wood layer between the top skin and internal foam that provides stiffness and reduces the probability of damage due to hail, road debris, etc.

C. Foam Roof Structure

D. Steel Reinforced Wood Frame

The roof is framed with steel supports to accept A/C on all models without extra reinforcement.

- Roof vent is placed off to the side so the A/C can be center-mounted without having to remove the vent. This design allows you to have both the vent and A/C.



Fantastic Fan™ power roof vent is standard on all models (Except LS Models)



Low profile tongue jack

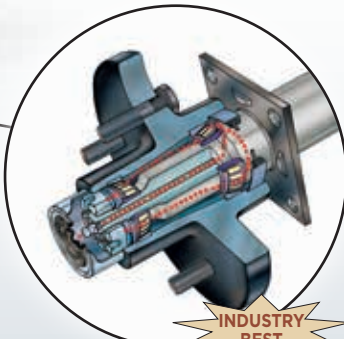

AL-KO® Ultralube axle bearing. Easier maintenance for improved safety

INDUSTRY BEST



Aluminum wheels (Standard on Classic & V-Trec)



Roof Side Z-Rail Channels water away.

1. Roof's Outside Skin
2. Body's Outside Skin
3. Water tight Seal
4. Z-Rail channels water away from wood

- Z-Rails on roof perimeter and sidewalls keep wood above water level collection points.
- Others use U channel where wood and water can come in contact at the bottom of the channel.
- Channels are kept open to allow water to run out like a gutter.
- Others attempt to seal channels to keep water out; when the seal is compromised, water will collect and cannot escape.

1-1/4" Laminated Insulated Bunkend

(N/A 806 LS)

- Double the industry standard thickness
- Solid wood, steel reinforced frame filled with 1" thick high density foam and laminated with wood panel on top and bottom
- Yields a more stable bedend vs. chipboard or spliced plywood used by other brands
- Insulation improves comfort and warmth

Clipper Standard



4" E-Z Sleep Quilted Mattress

1-1/4" Laminated Insulated Bunkend

Cold Outside Air

Competition



3" Mattress

5/8" Plywood

Cold Outside Air

Clipper
LS

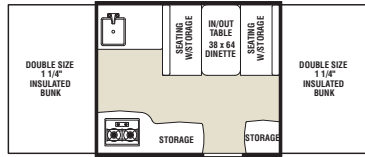

806 LS

Limited Warranty

- Lift System - Lifetime
- Vinyl Tent - 5 years
- Roll Out System - 5 years
- Frame - 5 years
- Roof Assembly - 5 years
- AL-KO® Ultralube Spring Axle - 1 year
- AL-KO® Ultralube Rubber Suspension Axle - 5 years
- Refrigerator - 3 years
- Plumbing System - 10/25 years
- Electronic Converter- 2 years
- Roof Exterior - 2 years

Clipper
Sport

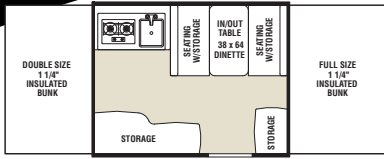

106

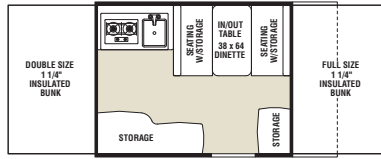

106 ST

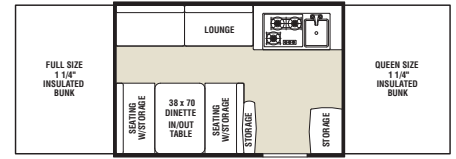

107

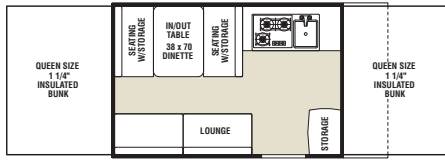

108 ST

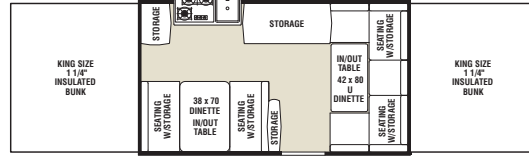

126

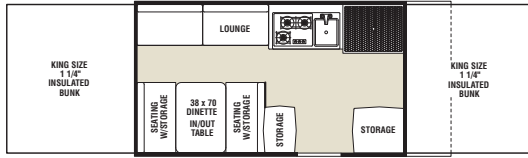

127 ST

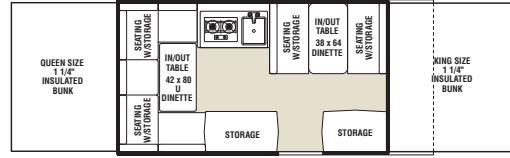

128 ST

Clipper
Classic

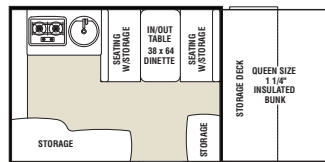

904 GS

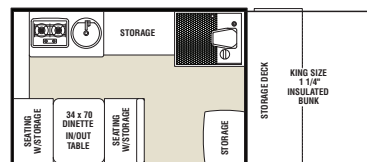

104 GS

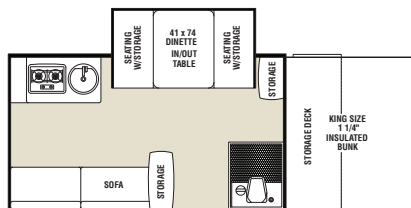

124 GS

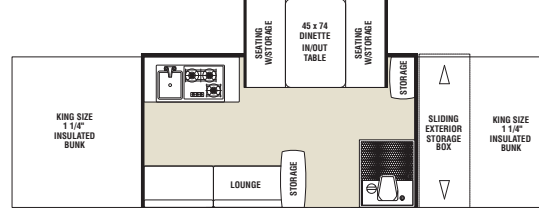

1285 SST

V-Trec

Specs | V1 V3

Interior Box Size	10'	12'
Travel Length	16'9"	21' 4"
Travel Width	85"	85"
Travel Height	65"	65"
Interior Open Length	20'5"	24' 5"
Interior Open Height	6' 10"	6' 10"
Sleeping Capacity	6	6
Front Sleeping Area	58 X 80	70 X 80
Rear Sleeping Area	58 X 80	70 X 80
Dinette Area	38 X 70	45 X 73
"U" Dinette	N/A	N/A
Lounge Area	N/A	N/A
Sofa Bed	N/A	N/A
Radial Tire Size	LT235/75R15	LT235/75R15
Tire Load Range	5 Bolt C	5 Bolt C
Hitch Weight # (approx.), (lbs./Kg)	252/114	420/191
Axle Weight # (approx.), (lbs./Kg)	1981/899	2700/1225
Dry Weight # (approx.), (lbs./Kg) **	2233/1013	3065/1390
Cargo Capacity # (approx.), (lbs./Kg)	1519/689	1325/601
GVWR (lbs./Kg)	3752/1702	4380/1987
Coupler Ball Size	2-5/16"	2-5/16"



V1

AT COACHMEN, we're all about easy. Our motorhomes, fifth wheels, travel trailers and folding campers are designed to be easy to use, easy to enjoy, easy to own. And our no hassle warranty keeps them that way.

Heavier Duty Than Other Folding Campers!

- 5" Tube Frame • 4000 Lb. Torsion Axle for Heavy Cargo Capacity
- Reinforced Diamond Plate Front Deck

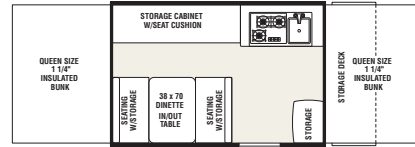

V1

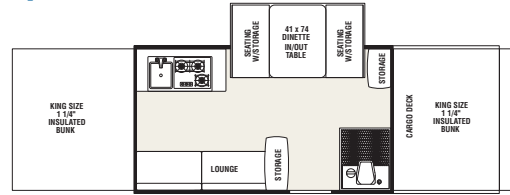

V3

V-Trec Series



Coachmen Recreational Vehicles
A Forest River Company
580 West Burr Oak Street
P.O. Box 549
Centreville, MI 49032
269.467.6321

To learn more about Coachmen RV and our products and see how Coachmen is making the easy life easier, visit www.coachmenrv.com.

All information contained in this brochure is believed to be accurate at the time of publication. However, during the model year, it may be necessary to make revisions and Coachmen reserves the right to make all such changes without notice, including changes in prices, colors, materials, equipment and specifications, as well as the addition of new models and the discontinuance of models shown in this brochure. Therefore, please consult with your Coachmen dealer and confirm the existence of any materials, design or specifications that are material to your purchase decision.



Free Roadside Assistance

Coachmen provides one year of free Travel Easy™

emergency roadside assistance for those who buy a new Coachmen RV. Administered by Coach-Net®, this service gives Coachmen owners 24/7 access to operational, technical and emergency road services, including towing, fuel delivery, jump starts, lockout service, tire changes, mobile mechanic and unlimited technical advice. So no matter where you go, we're ready to help!



Big Benefits For New Owners

Owners club discounts and more — A free one-year membership in the Coachmen Owners Association comes with the purchase of any Coachmen product. This add-on value not only provides a host of travel services and campground discounts, but also a 24/7 online service that locates needed services while offering member savings at more than 180,000 merchants across the country. And, of course, the COA is an excellent way to share experiences with other Coachmen owners through rallies and caravans.



Forest River, Inc. encourages our customers to purchase their Forest River products from a local dealership whenever possible for the following reasons:

- 1) Forest River, Inc. dealers are independently owned and operated businesses so priority service and scheduling is at their discretion and is often provided to customers that purchased their unit at that dealership.
- 2) Purchasing locally allows customers to establish meaningful relationships with a dealer, enhancing the RV experience through assistance with product questions, user tips or RV regulations for your state or country, and much more!
- 3) Canadian customers must meet requirements to bring an RV purchased out of the country to their home. These requirements may involve additional inspections and certifications, taxes and fees. Your local Canadian Dealer is a professional at meeting these requirements.
- 4) Scheduling timely warranty repairs and adjustments through a local dealership provides far greater flexibility and convenience to you, the customer!

It is the goal of Forest River, Inc. that all of our RV owners fully enjoy the RV experience and that customer satisfaction meets or exceeds their expectations!



Learn More
Scan this barcode using a QR Reader on your smart phone to learn more about Forest River.



A Berkshire Hathaway company.

Contact your Clipper Dealer for a complete list of parts and accessories: