

XLR THUNDERBOLT

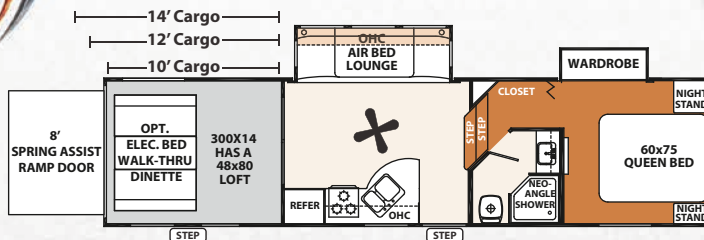

300X12
300X14



35X12
35X14

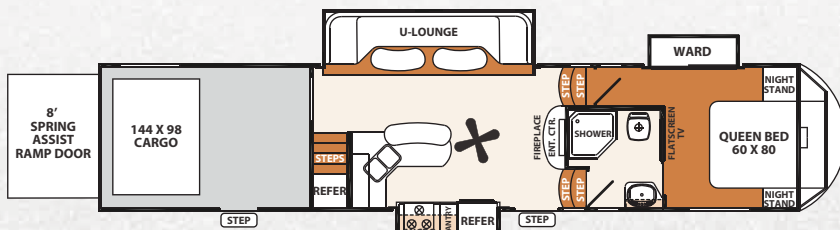

386X12



OPTIONAL
U-LOUNGE



OPTIONAL
FREE-STANDING DINETTE
THEATER SEATING

40X12

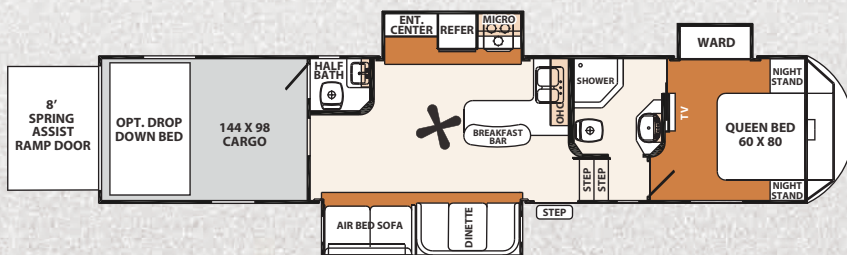

380AMP

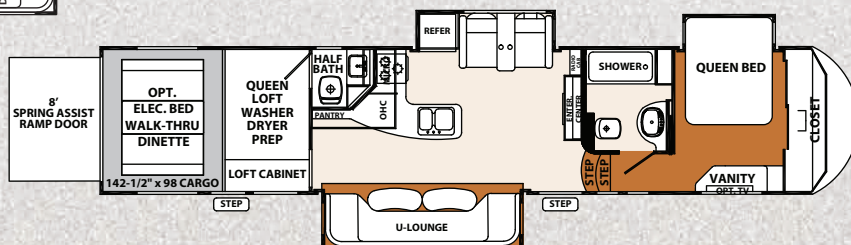

395AMP

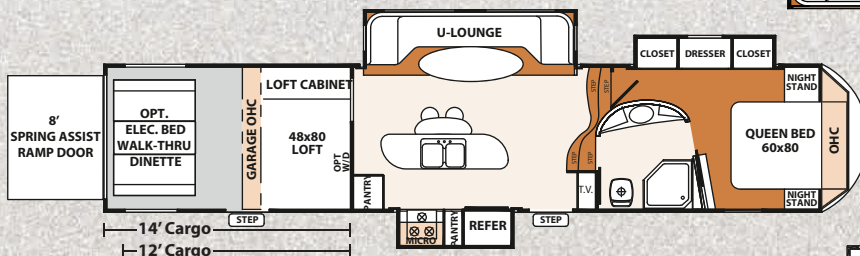

415AMP

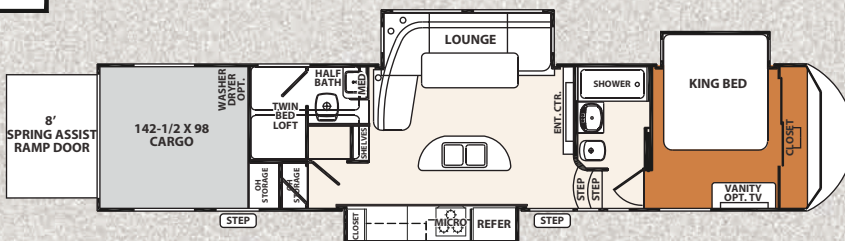

XLR THUNDERBOLT FEATURES

INTERIOR STANDARDS

- Professionally Designed Interiors
- Upgraded Waterfall Corian Countertops
- Crown Molding
- Night Shades
- Ceiling Fan (Select models)
- Attic Ventilation System
- Residential Large Microwave
- Stainless Steel Deep Bowl Kitchen Sink
- 7'6" Slide Room Height (AMP Series only)
- Living Room LCD HDTV
- Multi Zone Entertainment with Center Fade Switch
- 15K BTU Air Conditioner
- 150 Gallons Fresh Water (AMP Series only)
- Wired and Framed for 2nd ducted Air Conditioner
- Bathroom Fantastic Fan
- LED Shower Light
- 12 Gallon Gas/Electric/ DSI Water Heater
- Washer/Dryer Prep in Cargo Area
- Retractable Hid-M-Screen Wall
- Temperature Controlled Garage (Select Models)
- Dovetail Storage Box (AMP Series only)
- High Profile Cap
- Touch Green Stereo System with USB, Bluetooth, MP3, DVD I Phone and Android operating system
- Tongue and Groove Plywood Floor
- Custom Harwood Maple Cabinetry with Raised Panels

EXTERIOR STANDARDS

- Front Hydraulic Landing Gear
- Vacuum-Bonded Aluminum Framed Construction
- High Gloss Gel Coat Sidewalls
- Gel Coat Radius Front Cap with LED Lights
- Exterior LED Brake Lights and Marker Lights
- 6,000 lb. Ultra-Lube Axles
- 16" Gun Metal Panther Aluminum Wheels/Nitro Filled Tires
- Tri Tone Metal Skirting
- 50 AMP Service
- 100 AMP Converter
- Exclusive Hitch Pin Cover
- 5,000 lb. Flush Mount Tie Downs
- Generator Ready with Fuel Tank-18 Gal.
- Ultra View Frameless Windows
- Electric Awning with LED Lights
- Strut Assisted Entry Doors
- Slam Latch Baggage Doors
- Premium Ramp Door Compression Locks
- Bolted to Frame Fuel Tanks
- Collapsible Exterior Ladder
- Large Assist Handles on all Entry Doors
- Reverse Activated Rear Flood Lights
- Hydraulic Flush-Floor Slide (Main Slide)
- Black Laminated Slide-Out End Walls
- Satellite HD Ready Prewire
- Outside Shower
- Enclosed Termination Valves
- Triple 30# LP Tanks (AMP Series only)

OPTIONAL EQUIPMENT

- **Extreme Weather Package** – Dual Pane Windows, 12V Heated Holding Tanks, and Radiant Roof/floor/Slide Out Floor Insulation (R-38@80 F)
- **The Bitchin Outdoor Kitchen** – Weber grill, refrigerator, stainless steel sink w/hot and cold water hook ups, 5 gallon gray tank, 2-tier bar top, all weather ready!

- **Man Cave Garage Package** – Rock Star Entertainment center w/32" LCD TV, dual 10" subwoofers, 4 speakers, 2 sport rockers, Kegerator and ground effects exterior lighting.
- **Rockstar Entertainment Center** – 32" LCD TV, Kicker 300W Amp, 10" subwoofers and 4 speakers, AM/FM/CD/MP3/DVD stereo, external 110V, HDMI, gaming connections and TV/Cable/Satellite hook up.
- 5.5 Onan CARB EVAP Generator
- Mobile Fuel Station w/ Fuel Tank (30 gallon)
- Frame Mounted Toy Lock
- Party Dinette IPO Booth/Sofa
- Free Standing Table and Chairs
- Theater Seating IPO Sofa
- Sliding Glass Patio Door (Select models)
- Second Air Conditioner – Bedroom
- Dyson Digital Slim Cordless Vacuum
- Bedroom TV with Exterior Bracket
- 8 Function Wireless Remote with Touch Screen Control
- Wireless Back Up Security Camera
- Kegerator
- Removable Cargo Carpet Kit
- VIP Party Deck (N/A 10' Garage Models)
- Electric Bed with pass through Dinette
- Cargo Shower upgrade (40X12 only)
- Outside TV Hook Up
- MorRyde 50Amp Power Cord Reel
- Overhead Storage IPO Loft
- Level Up Hydraulic
- Second Power Awning
- **X-Tended Living/Recreation Package** – Sliding Glass Cargo Enclosure, 26" Fireplace with Mantle, LCD TV hook up.
- Comfort Sleep – Gel Memory Form Mattress

XLR THUNDERBOLT FIFTH WHEEL SPECIFICATIONS

Model	Hitch Weight	Ship Weight	GVWR	Cargo Capacity	Exterior Length	Exterior Height	Exterior Width	Fresh Water	Gray Water	Black Water	Awning Size
300X12HP	1858	10454	13858	3404	38' 0"	13' 2"	102	100	64	32	18
300X14HP				0	41' 0"	13' 2"	102	100	64	32	18
35X12HP	2094	13001	18000	4999	39' 11"	13' 2"	102	100	86	32	18
35X14	2452	12987	18000	5013	41' 11"	13' 2"	102	100	86	32	14
380AMP	2323	13475	18000	4525	42' 3"	13' 2"	102	162	54	108	13
386X12HP	2435	13028	18000	4972	42' 4"	13' 2"	102	100	54	54	18
395AMP	2647	14236	18000	3764	42' 2"	13' 2"	102	162	130	54	18
395AMP12	3174	13811	18000	4189	40' 2"	13' 2"	102	162	130	54	18
415AMP	2331	13719	18000	4281	42' 1"	13' 2"	102				
40X12HP	2383	12447	18000	5553	41' 9"	13' 2"	102	100	54	108	18

Actual towing capacity is dependent on your particular loading and towing circumstances, which includes GVWR, GAWR and GCWR, as well as adequate trailer brakes. Please refer to the Owners Manual of your vehicle for further information. All illustrations and specifications contained in this literature are based on the latest product information at the time of publication. Forest River, Inc. reserves the right to make changes in prices, colors, materials, equipment and specifications at anytime, without notice, and assumes no responsibility for any error in this literature. All units are shipped F.O.B. point of manufacture. 11/12 ©Forest River, Inc. 2012 XLR



FOREST RIVER

2431 E. Kercher Road ■ Goshen, IN 46526 ■ E-mail: XLRinfo@forestriverinc.com
 Phone: 574-975-0279 ■ Fax: 574-343-5909
www.forestriverinc.com/XLR ■ www.forestriveraccessories.com



Learn More
 Scan this barcode using
 a QR Reader on your
 smart phone to learn
 more about Forest River.

