

# Launch



**2012 Launch**

- ✓ 78" interior height
- ✓ Cable/satellite prep
- ✓ 6-gallon water heater
- ✓ Front window (select models)
- ✓ Spare tire with carrier
- ✓ Rear stabilizer jacks



# 2012 LAUNCH

- » AMAZINGLY AFFORDABLE
- » VACUUM-BONDED LAMINATED SIDEWALLS
- » TOWABLE BY MOST MINIVANS\*
- » SLEEPS UP TO 6



## 54" BOOTH DINETTE

Spacious with a nice view, Launch pairs a 54" booth dinette with a flush-mounted stone guard front window (select models) for the ultimate family meal.

## 4 CU. FT. REFRIGERATOR/FREEZER

Thanks to Launch's 4 cu. ft. refrigerator/freezer, you can leave the ice and coolers at home.

## AIR CONDITIONING

Escape from the heat with a standard 8,000-BTU air conditioner or add an extra blast of cool air with the optional 13,500-BTU roof A/C.

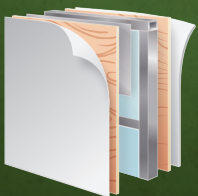

## SIMPLY THE BEST CONSTRUCTION

Launch features durable vacuum-bonded aluminum frame construction, making it one of the lowest-priced fiberglass travel trailers in the market.

\* Consult with your authorized automobile manufacturer and vehicle owners manual.



Launch 15FD



## Floorplans

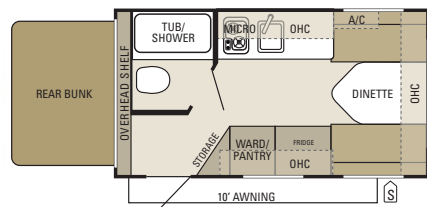

Launch 15FD

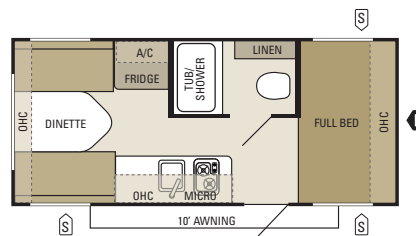

Launch 17FB

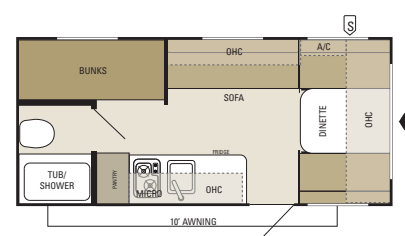

Launch 18BH

- OUTSIDE STORAGE
- TRAILER HITCH
- MICROWAVE
- OVERHEAD CABINETS
- FRIDGE
- WARDROBE

## Standards and options

### STANDARD CONSTRUCTION FEATURES

- 2" hitch coupler
- 78" interior ceiling height
- Fully decked roof with 3/8" decking
- One-piece seamless roof
- Poly Flex one-piece underbelly covering
- R-7 insulation in sidewalls, roof and floor
- Roof rafters constructed of residential-style tapered 3" trusses
- Screwed stile cabinetry with hardwood stiles

### STANDARD EXTERIOR EQUIPMENT

- AquaShield Aqualon water-repellent sectionalized tent with 7-year warranty (15FD)
- Bumper with drain hose carrier and end caps
- Bunk-end tent permanently attached to bed base (15FD)
- Cable/satellite prep
- Electric brakes
- Front diamond plate
- Front window with flush-mounted stone guard (select models)
- Outside storage
- Radial tires
- Rain guttering, molded with drip spouts

### STANDARD INTERIOR EQUIPMENT

- 2-burner range
- 8,000-BTU A/C
- 54" booth dinette
- Acrylic sink with faucet
- Bourbon Glazed beech wood cabinetry
- Crank-up HDTV antenna with signal booster

- Fan/light in bunk (15FD)
- Hardwood cabinet doors
- Inside/outside dinette table with folding legs
- Pleated shades
- Range hood with light and exhaust fan
- Roof-mounted antenna for radio
- Skylight in tub/shower
- Sofa with inside storage below (select models)
- TuffShell vacuum-bonded laminated sidewalls

### STANDARD HEAT, POWER AND ELECTRIC EQUIPMENT

- 20-lb. propane gas bottle
- 120V G.F.C.I. protected exterior receptacle
- 18,000-BTU furnace with auto ignition
- Systems monitor panel
- Water heater bypass system
- Water system winterization kit

### CUSTOMER CONVENIENCE PACKAGE

- 4 cu. ft. refrigerator
- 6-gal. water heater
- Carefree patio awning
- Microwave oven with carousel
- Rear stabilizer jacks
- Spare tire with carrier
- Stereo with AM/FM and iPod/MP3 connection

### OPTIONS

- 13,500-BTU A/C



### REAR BUNK

Our AquaShield Aqualon tent material, backed by a 7-year warranty, is water repellent and double stitched to protect a 1,100-lb. rated bunk end (select models).



### DURABLE CONSTRUCTION

Our handmade cabinets feature hardwood stiles with screwed construction for greater durability and longevity.



For a complete list of standards and options, scan here with your smartphone or visit [starcraftcamping.com](http://starcraftcamping.com).



### PATIO AWNING

Stay cool in the outdoors with our patio awning with adjustable pitch to provide convenient water runoff.

## Specifications

Floorplan	Exterior Length	Exterior Width	Exterior Height	Interior Height	Unloaded Vehicle Weight (lbs.)	Dry Hitch Weight (lbs.)	Gross Vehicle Weight Rating (lbs.)	Cargo Carrying Capacity (lbs.)	Fresh Water Capacity (gal.) (includes water heater)	Gray Waste Water Capacity (gal.)	Black Waste Water Capacity (gal.)
15FD	17' 7"	85"	106"	78"	2,380	210	3,300	920	10	15	9
17FB	20' 6"	85"	108"	78"	2,620	335	3,500	880	20	15	9
18BH	20' 6"	85"	109"	78"	2,530	335	3,500	970	20	15	9

**Unloaded Vehicle Weight (UVW):** Sometimes referred to as "Dry Weight," UVW means the typical weight of this trailer as built at the factory. The UVW, as used in product literature and other promotional materials, does not include cargo, fresh water, propane, options or dealer-installed accessories.

**Gross Vehicle Weight Rating (GVWR):** GVWR means the maximum permissible weight of the trailer, including the UVW plus passengers, personal items, all cargo, fluids, options, and dealer-installed accessories. The GVWR is equal to or greater than the sum of the UVW and the CCC.

**Cargo Carrying Capacity (CCC):** CCC means the maximum weight of all passengers, personal items, food, fresh water, propane, tools, other cargo and dealer-installed accessories that can be carried by the trailer. CCC is equal to or less than GVWR minus UVW. The addition of options will decrease the CCC.

**Hitch Weight (HW):** The hitch weight, as used in product literature and other promotional materials, does not include cargo, fresh water, propane gas, options or dealer-installed accessories. The addition of these types of items will either add to or subtract from the stated hitch weight.

It is important for your safety and enjoyment that your tow vehicle be adequately sized and equipped to tow and handle the GVWR of the RV you select. Review weights and ratings of your tow vehicle and consult a competent advisor for questions or advice. Whether you are new to RVing or a veteran, get a feel for the performance of your tow vehicle and the RV together before heading out on the roadways. When you tow an RV, you must drive differently than you do when driving a single vehicle. Practice hooking up, driving, backing up and braking in a safe environment or seek out professional instruction. Starcraft affixes a weight label to each RV which lists weight information for that vehicle. See specification chart above.

Launch 15FD

Launch 15FD



# BUILT ON TRADITION



The Starcraft name has been around for more than 40 years—becoming one of the most dependable names in the camping industry. Today, our strong balance sheet and family-oriented business approach means we'll be around for years to come. And with a full lineup of towables, you can bet our campers will fit your lifestyle and come with everything you need—all at an affordable price.

## Warranty

The Starcraft warranty is a manufacturer's limited warranty. Each Starcraft is warranted to the original purchaser for twelve (12) months from the original date of purchase against defects in materials and workmanship. Starcraft's limited warranty is not transferable. For a copy of the limited warranty with full terms and conditions, ask your local Starcraft dealer.

## Roadside Assistance

Travel worry-free with the complimentary National Motor Club program, which gives you immediate access to dependable roadside assistance with a simple phone call.

## Why a Local Starcraft Dealer is Important to You

Establishing a solid relationship with your local Starcraft dealer is a key component in the enjoyment of your new Starcraft. By purchasing from a local dealer, you will have a convenient location for sales, parts and service support.



We are one of few manufacturers that can say we are green-certified capable. Our processes and production materials are independently tested in six environmental categories.



To learn how the lightweight Launch is perfect for towing behind your minivan, SUV or crossover, scan here with your smartphone.

FOLLOW US ON



**STARCRAFT**

CAMPING | pure and simple.

© Starcraft RV • 536 Michigan St., Topeka, IN 46571 **RVIA**   
www.starcraftcamping.com

See dealer for further information and prices. All information in this brochure is the latest available at the time of publication approval. Starcraft reserves the right to make changes and to discontinue models without notice or obligation. Photos in this brochure may show optional equipment and props for photography purposes. RV's built for sale in Canada may differ to conform to Canadian codes.



[www.starcraftcamping.com](http://www.starcraftcamping.com) | STOP BY OUR HOME ON THE WEB FOR MORE INFORMATION OR TO FIND A DEALER NEAR YOU.