

Get Carried Away
**American
Coach**



Get Carried Away

2012





AMERICAN EAGLE 42M shown in Bittersweet Twilight interior décor with Satin Cabernet Glaze Cherry wood cabinetry



*Fall in Love Again.
And Again.*

Your pulse quickens at first glance.
Step inside and your heart skips a beat...
American Eagle's exquisite style, performance
and luxury will make you fall in love with
it over and over again.





Love is in the Air.

The best romances aren't just in novels. Step inside and be swept away by all of American Eagle's luxurious details... exquisite woodwork, beautiful interior décors, elegantly designed furnishings and the top of the line Sony® TV and Blu-ray® DVD and Bose® Home Theater System in the living area. Date night just got a bit more exciting.



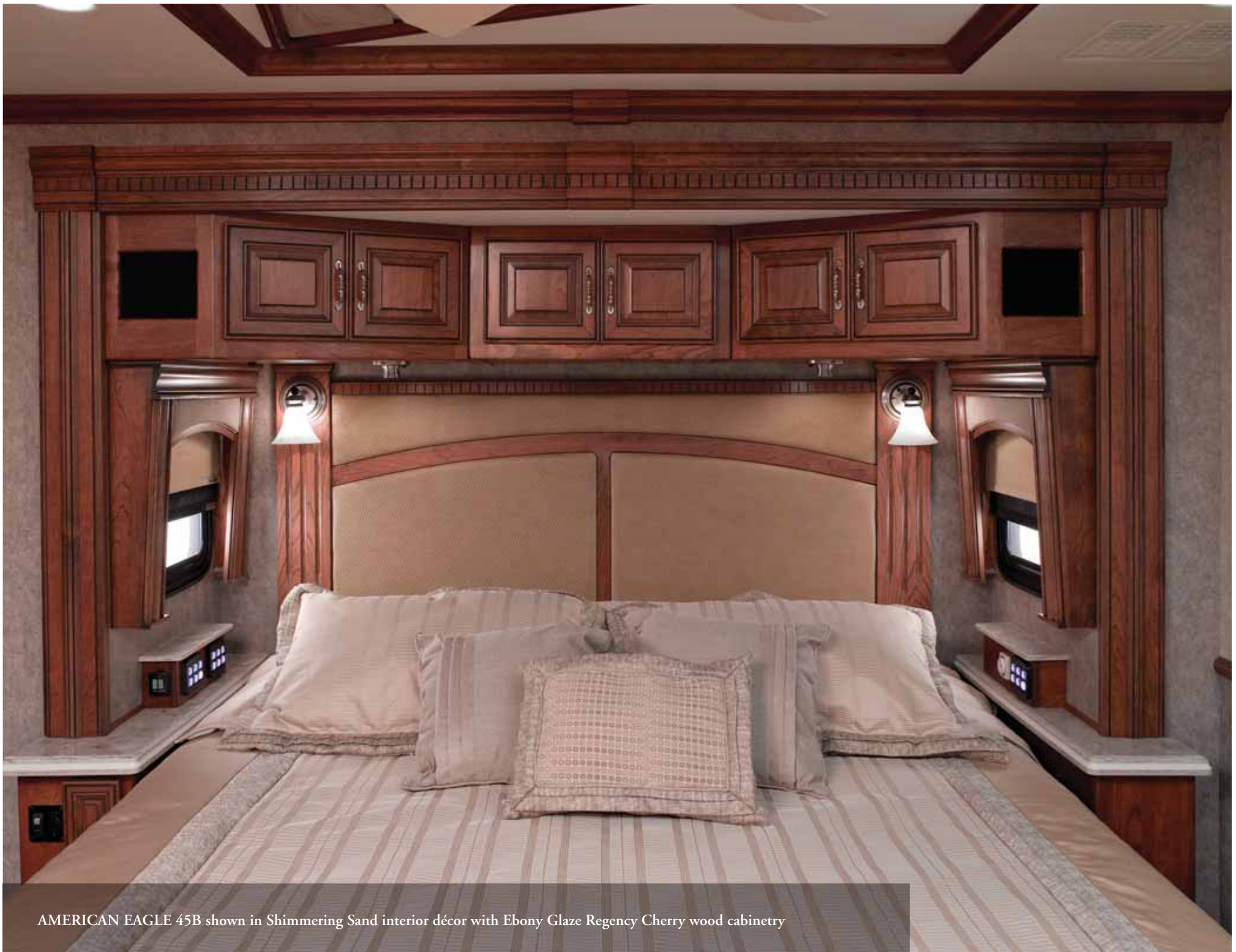

AMERICAN EAGLE 45B shown in Shimmering Sand interior décor with Ebony Glaze Regency Cherry wood cabinetry

EXTERIOR GRAPHICS

VICTORY GRAPHICS



CABERNET GOLD



CAFE BLANC



MOONLIGHT SAND

FLIGHTLINE GRAPHICS



DESERT SUNSET



FRENCH ROAST



MOCHA TRUFFLE

Not all exterior colors or graphics are shown. All colors are available in Flightline and Victory graphics schemes. See your American Coach dealer or visit our website at www.AmericanCoach.com to view all graphic and color choices.

†Interior décors and/or woods may be subject to change. Printed fabric samples are representations of actual fabrics and may be limited due to standard printing technology.

INTERIOR DÉCOR

Even at a distance, American Coach motor homes make quite an impression. Inside and out, we've added handcrafted touches that demand attention and earn admiration. We've fussed over the finest details, from modern conveniences and sleek technology to exceptional fabrics and superior finishes. All you need to add is your own personal style. No matter where your journey takes you, you'll always travel first class†

	BITTERSWEET TWILIGHT	BRONZE FUSION	SHIMMERING SAND	SOLID WOOD CABINETRY
SOFA				
ACCENT				
BEDSPREAD				
COUNTERTOP				
FLOORING				
CARPET				

CHERRY W/SATIN
CABINET GLAZE

REGENCY CHERRY
W/EBONY GLAZE

ALMOND MOCHA GLAZE

FLOOR PLANS

42M

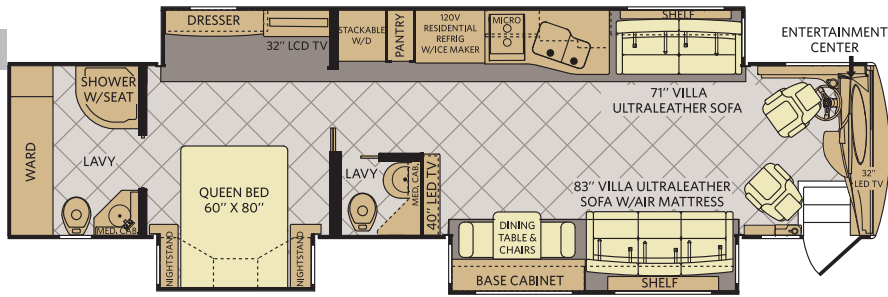

Available options: 107, 113, 124, 125, 126, 127, 129, 161, 197, 205, 828, 852, 853, 854, 855, 856, 881

42P

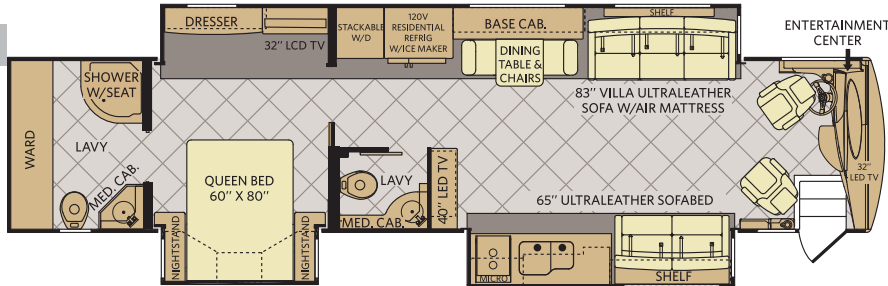

Available options: 107, 113, 124, 125, 126, 127, 129, 161, 205, 828, 852, 853, 854, 855, 856, 881

45B

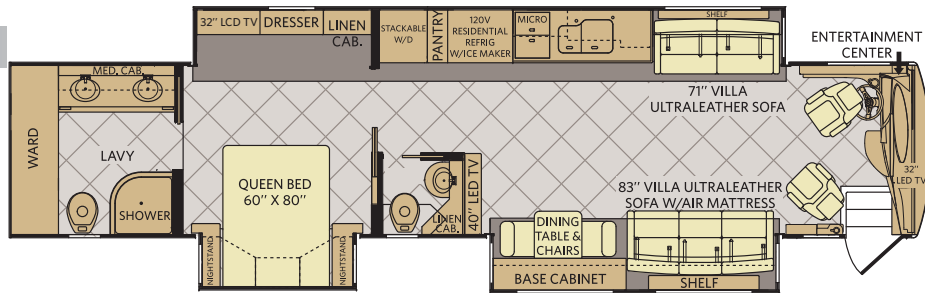

Available options: 107, 113, 124, 125, 126, 127, 129, 161, 205, 828, 852, 853, 854, 855, 856, 881

45T

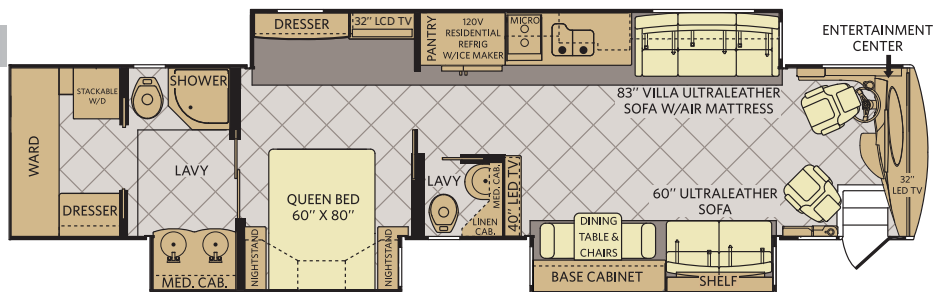

Available options: 107, 124, 125, 126, 127, 129, 161, 191, 828, 852, 853, 854, 855, 856

OPTIONS

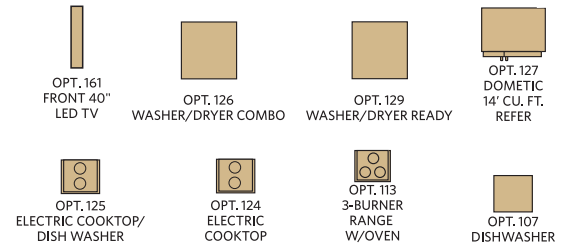
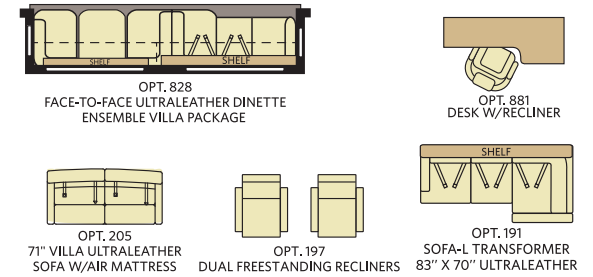
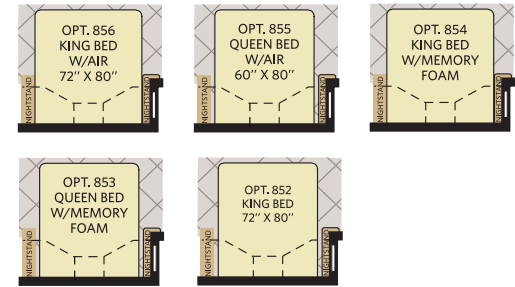

WEIGHTS AND MEASUREMENTS

WEIGHTS	42M/42P	45B/45T	45B/45T	45B/45T
	450HP	450HP	500HP	600HP
GVWR (lbs) ¹	46,600	46,600	48,600	50,600
Front GAWR (lbs) ²	16,600	16,600	16,600	16,600
Rear GAWR (lbs) ²	20,000	20,000	20,000	20,000
Tag Axle GAWR (lbs) ²	10,000	10,000	12,000	14,000
GCWR (lbs) ³	61,600	61,600	63,600	65,600
Hitch Rating Weight (lbs) [†]	15,000	15,000	15,000	15,000
Tongue Weight (lbs) [†]	1,500	1,500	1,500	1,500
Fuel Capacity (gal)	150	150	150	150

DIMENSIONS & CAPACITIES	42M/42P	45B/45T	45B/45T	45B/45T
Wheelbase (inches)	302"	302"	302"	302"
Overall Length ⁴	42' 11.5"	42' 11.5"	44' 11.5"	44' 11.5"
Overall Height (with A/C)	13' .5"	13' .5"	13' .5"	13' .5"
Overall Width (maximum) ^{5,6}	102"	102"	102"	102"
Interior Height (maximum)	84"	84"	84"	84"
Interior Width (maximum)	96"	96"	96"	96"
Fresh Water Holding Tank (gal)	100	100	100	100
Grey Water Holding Tank (gal)	60	60	60	60
Black Water Holding Tank (gal)	40	40	40	40
Appliance Propane Tank (gal) (WC) ⁷	28.2	28.2	28.2	28.2

Liquid Weight Reference: Water (gal) = (8.3 lbs/3.8 kgs) Fuel (gal) = (6.1 lbs/2.8 kgs) Propane (gal) = (4.2 lbs/1.9 kgs)

Metric Conversion: Multiply pounds x 0.453 to obtain kilograms. Multiply gallons x 3.785 to obtain liters.

Multiply liters x 61 to obtain cubic inches.

- GVWR (Gross Vehicle Weight Rating) is the maximum permissible weight of this fully loaded motor home. The GVWR is equal to or greater than the sum of the (UVW) unloaded vehicle weight plus the (OCCC) occupant cargo-carrying capacity*.
- GAWR (Gross Axle Weight Rating) is the maximum permissible loaded weight a specific axle is designed to carry.
- GCWR (Gross Combined Weight Rating) is the value specified by the motor home manufacturer as the maximum allowable loaded weight of this motor home with its towed vehicle. Towing and braking capacities may be different. Refer to American Coach and chassis manufacturer's manuals for complete information.
- Length measured from front bumper to rear bumper (excludes accessories).
- Excludes safety equipment and awnings.
- Motor homes feature a body width over 96" which will restrict your access to certain roads. Before purchasing, you should research any state and/or province road laws which may affect your usage.
- Tank manufacturer's listed water capacity (WC). Actual propane capacity is 80% of water listing as required by the safety code.

† The chassis manufacturer recommends the installation of a supplemental brake control system to activate the brakes on the vehicle or trailer you are towing. Hitch receiver ratings expressed are maximum for the hitch receiver installed and may require the purchase of additional equipment that is dependent on the weight of the towed load. Consult with hitch receiver manufacturer for further information.

* UVW and OCCC are found on the label containing the federal certification tag in each RV.

IMPORTANT — PLEASE READ: Product information, photography and illustrations included in this publication were as accurate as possible at the time of printing. For further product information and changes, please visit our website at www.AmericanCoach.com or contact your local American Coach dealer. Prices, materials, design and specifications are subject to change without notice. All weights, fuel, liquid capacities and dimensions are approximate. American Coach has designed its recreational vehicles to provide a variety of uses for customers. Each vehicle features optimal seating, sleeping, storage and fluid capacities. The user is responsible for selecting the proper combination of loads (i.e., occupants, equipment, fluids, cargo, etc.) to ensure that the vehicle's capacities are not exceeded.

CHASSIS - Liberty® 450	CHASSIS - Liberty® 500	CHASSIS - Liberty® 600
Model: Spartan®	Model: Spartan®	Model: Spartan®
Engine: Cummins® 8.9L ISL w/2-Stage Engine Brake	Engine: Cummins® 11.9L ISX w/3-Stage Engine Brake	Engine: Cummins® 15.0L ISX w/3-Stage Engine Brake
Torque: 1,250 lb-ft @ 1,300 RPM	Torque: 1,645 lb-ft @ 1,200 RPM	Torque: 1,950 lb-ft @ 1,300 RPM
Horsepower: 450HP	Horsepower: 500HP	Horsepower: 600HP
Transmission: Allison® 3000 MH, 6-Speed w/Electronic Shifter	Transmission: Allison® 4000 MH, 6-Speed w/Electronic Shifter	Transmission: Allison® 4000 MH, 6-Speed w/Electronic Shifter
Alternator: 200 Amp Leece-Neville	Alternator: 200 Amp Leece-Neville	Alternator: 200 Amp Leece-Neville
Front Tires: 315/80R 22.5 Michelin® Radial (2)	Front Tires: 315/80R 22.5 Michelin® Radial (2)	Front Tires: 315/80R 22.5 Michelin® Radial (2)
Rear Tires: 295/80R 22.5 Michelin® Radial (6)	Rear Tires: 295/80R 22.5 Michelin® Radial (6)	Rear Tires: 295/80R 22.5 Michelin® Radial (6)

GENERAL AMENITIES

- Outlets (Multiple Locations)
- Decorative Throw Pillows
- Decorative Hardwood Window Treatments
- Accent Rope Lighting
- Decorative Wood-Trimmed Fan-Tastic® Rain Sensor, Power Roof Vents w/ 3-Speed Fan (3)
- Interior MultiPlex "Power Management Plus System"
- TV Cable-Ready
- Premium Hardwood Face-Framed Cabinetry and Moldings
- Premium Hardwood Cabinet Doors
- Lined Cabinet Interior Bottoms and Shelves
- Decorative Ceiling Trim
- Flush Bolt Latch Decorative Hardware on Pocket Doors
- Polished Porcelain Tile Floor w/Décor Accents Throughout

- OPTIONAL
- Custom Interior Request
 - Factory V.I.P. Delivery
 - Canadian Standards Build

DRIVER CONVENIENCE

- XITE Dash AM/FM Stereo; Single CD, MP3, Bluetooth, DVD, iPod Compatible
- Dual Dash Monitors Design
- Touch Screen GPS Navigation
- Sony Color Camera Monitor w/One-Way Audio
- Tire Pressure & Silverleaf Chassis Monitoring
- Premium Hardwood Dash Cabinetry with Top & Storage Drawers
- Villa® 6-Way Power Driver Seat w/Heat, Power Lumbar & Adjustable Arms (Ultraleather)
- Villa 6-Way Power Passenger Seat w/Heat, Power Lumbar, Adjustable Arms & Electric Footrest (Ultraleather)
- Sirius® Satellite Radio (Subscription Req.)
- Cruise Control
- I.C.C. Light Switch
- Smart Wheel w/Leather & Burl Wood Trim w/Manual Tilt, Tip, Telescope
- Top-Mounted Intermittent Windshield Wiper System w/Wet Arm
- Power Sun Shades and Blinds
- Power Driver Window
- One-Piece Windshield Bonded to Steel
- Windshield Washer Bottle, 1.5 Gallon Reservoir
- Driver & Passenger Drink Holder
- Driver & Passenger Map Reading Lights
- Halogen Head Lamps
- SGM Dash Climate Control System
- Adjustable Brake and Throttle Pedals
- Compass and Exterior Temperature Gauge
- Low Profile Automotive Style Dash Instrumentation, Backlit Gauges & Switches
- Tag Axle Dump Switch
- Keyless Entry Door Access w/Key Fob
- Auxiliary Fog Lamps
- Auxiliary Start Switch
- Hadley® Air Horns
- Low-Level Washer Fluid Indicator
- Multiple Auxiliary 12-Volt Dash Receptacles

LIVING ROOM

- Power Step Well Cover
- Entry Step Switch at Entry Wall
- Lighted Step Well Area
- Large Passenger Window
- 12V LED Ceiling Lighting
- Centralized Audio-Electronics
- Day/Night Pleated Shades
- Hardwood Front TV Overhead Cabinetry
- Raised-Panel Cabinet Doors
- Centralized Command Center
- Automatic Generator Start System
- Inverter and Battery Monitor
- Polished Porcelain Tile Floor w/Decorative Insert Tiles
- Central Vacuum System
- OPTIONAL
- Power Shade/Blind Package

GALLEY

- Polished Solid-Surface Galley Top, Range & Sink Covers
- Countertop Decorative Edge Treatment
- Solid-Surface Double-Bowl Galley Sink
- Porcelain Tile and Accent Glass Backsplash
- Recessed 2-Burner Cooktop
- Solid Hardwood Drawer Fronts
- Roller Bearing Drawer Guides Full Extension
- Adjustable Shelves
- Cabinet Storage for Sink and Range Covers
- Task Halogen Lighting
- 12V Fluorescent Lighting
- Kohler High Rise Galley Faucet w/Pullout Sprayer
- Silverware Tray
- Polished Porcelain Tile Floor w/Decorative Insert Tiles

BEDROOM

- Premium Hardwood 6-Panel Bath & Bedroom Doors
- Premium Hardwood Framed Headboard w/Padded Fabric Accent
- Quilted Bedspread
- Queen Innerspring Pillow-Top Mattress (60" x 80")
- Lift-Up Bed w/Under-Bed Storage
- Polished Solid-Surface Counter & Nightstand Tops
- Overhead Cabinet Above the Bed
- Wall Sconce Light Fixtures
- 30" Deep Bedroom Slides
- Day/Night Pleated Shades
- Remote Generator Start Switch
- Cedar-Lined Wardrobe
- Wardrobe Lighting
- Full-Length Rear Wardrobe (Select Models)
- Recessed Bedroom Ceiling Fan
- Key-Actuated Hidden Safe
- Polished Porcelain Tile Floor w/Decorative Insert Tiles
- OPTIONAL
- King Bed with Pillow Top (72" x 80")
- Select Comfort Queen Air Mattress w/2 Remotes
- Select Comfort King Air Mattress w/2 Remotes
- Queen Bed with Memory Foam Mattress
- King Bed with Memory Foam Mattress

BATHROOM

- Polished Solid-Surface Lavy Countertop
- Polished Porcelain Tile w/Decorative Insert Tiles
- Solid-Surface Sink & Residential Kohler Faucet
- Porcelain Tile & Accent Glass Backsplash
- Medicine Cabinet
- LED Floor Lights
- Solid Surface Shower Pan Skylight in Shower
- Residential Hand-Held Shower Head
- Clear Glass Style Decorative Shower Glass Enclosure
- Solid-Surface Shower Surround w/Décor Inlay
- Residential China Bowl Power Flush Toilet w/Hand Sprayer (Select Models/Locations)
- Micro Mini Blind (Bathroom Window)

FURNITURE

- Villa® Ultraleather™ Sofa Bed w/Air Mattress
- Villa Ultraleather Sofa Bed w/Removable Arms
- Solid-Surface Dinette Table, Slide-Out Extension, 2 Decorative Chairs, 2 Folding Chairs
- Decorative Dinette & Folding Guest Chairs Not Available w/Face-to-Face Dinette Options
- Dinette w/Deep Base Cabinet Storage, File Storage & Keyboard Tray Wood & Fabric Dinette Chairs
- OPTIONAL
- Villa Ultraleather Dinette Face-to-Face Wrap-Around Ensemble
- Villa Ultraleather Dual Recliners (Select Models)
- Villa Ultraleather Recliner & Ottoman with Desk (Select Models)
- Villa Ultraleather Expanding L-Sofa (Select Models)

APPLIANCES

- Sony Blu-ray® DVD w/Wi-Fi
- TracVision® R5 Series "In Motion" HDTV Compatible, Domed Digital Satellite System
- Sony 32" LED HDTV (Front TV)
- Sony 40" LED HDTV (Mid-Ship)
- Bose® Lifestyle 18 Home Entertainment System
- OPTIONAL
- Sony 40" LED HDTV (Front TV)
- TracVision R6 Series Satellite System

GALLEY

- GE Advantium® Over the Range Convection Microwave Oven
- Residential Refrigerator w/Icemaker
- OPTIONAL
- Insta-Hot: Hot Water Dispenser
- Dometic® 14 cu. ft., Sidewise Refrigerator, 120V/Propane, Icemaker, Brushed Stainless Finish
- Recessed 3 Burner Range & Oven (Select Models)
- Dishwasher w/Cabinet Wood Front
- Electric Cooktop w/Dishwasher (Deletes LPG)
- Electric Cooktop (Deletes LPG)

BEDROOM

- Sony® 32" LCD HDTV
- Sony Blu-ray® DVD Player

GENERAL

- Stacked Washer/Dryer
- OPTIONAL
- Combination Washer/Dryer (Vented)
- Washer/Dryer Ready w/Shelves

OPTIONAL FEATURES | INTERIOR AMENITIES

HEATING/PLUMBING

- AquaHot® Heating System, 50,000 BTU (House, Water & Engine Pre-Heat)
- Heated Basement
- (3) 15.0M Low-Profile Roof Air Conditioners
- Heat Pump on Rear AC Unit
- Hinged Plumbing & Access Panels (Galley & Bath Areas)
- Propane (LPG) Tank
- Fresh Water Gravity Fill
- Holding Tanks w/Low Point Drain Valves
- Multi-Point Water Pump Switching
- Variable-Speed Water Pump
- Whole Coach Water Filtration System
- Holding Tank San-T-Flush™ System
- Waste Away Sewer Hose Manager

OPTIONAL

- Heated Full Tile Floor
- Waste Management System (Macerator) Deletes Sewer Hose Manager

SAFETY

- Smoke Detector/Alarm
- Carbon Monoxide (CO) Detector
- Fire Extinguisher
- Propane (LP) Leak Detector
- 3 Point Integrated Seat Belts at Driver & Passenger Seats
- Side Docking Lamps (4)
- Momentary Courtesy Lighting at Entry and Passenger Area
- Lighted Exterior Grab Handle w/Logo
- Emergency Egress Window
- Turn Signal Indicators

AMERICAN EAGLE | STANDARD AND OPTIONAL FEATURES | EXTERIOR AMENITIES

GENERAL AMENITIES

- Cameras are Integrated into the Mirrors
- Convenience Light in Utility Compartment
- Diamond Shield Protective Front Mask
- Dual Pure Sine Wave Inverter/Chargers (2,800/2,000 Watt)
- Maintenance-Free (8) Absorbed Glass Mat 6-Volt Batteries (Group GC2)
- Inverter & Battery Monitor
- Surge Guard™ – Electrical System Protection
- Energy Management System (50 Amp)
- Battery Disconnect Switches for House & Chassis
- Hella Docking Lamps (4)
- Sliding Lower Front Cap
- Power Generator Slide
- Utility Light – Front & Rear
- Dual Fuel Fill Doors – Locking
- Fresh Water Hose (25')
- Sensa Tank Level Monitoring System (Interior and Exterior Monitor)
- Spray Wand w/Soap Dispenser & Paper Towel Holder
- Chrome Headlight Bezels
- Power Cord Reel (50 Amp)
- Full-Width Rear Rock Guard w/Stainless Logo Panel
- Mud Flaps - Front & Rear
- Roof-Mounted Engine Air Intake
- Two-Piece Aluminum Rear Ladder
- Integrated Rear Upper Fiberglass Wing Deflector
- Large Rear Engine Access Door w/Lift Assist Struts
- Brushed Chrome Rear Access Grill
- Side-Hinged Luggage Doors Manual Locks (Select Doors)
- Strut-Assisted Luggage Doors (Select Doors)
- Solar Charging Panel (65w)
- Power Luggage Door Locks (Select Doors) w/Remote Key Fob
- Porch Light
- Keyless Entry Touch Pad/Entry Handle Integrated
- “One Key” System (Luggage & Entry Doors)
- Brushed Stainless Kick Plate Under Entry Door
- Power Double Entry Step “Bus Style”
- Electrical Outlets in Luggage Compartments
- Air Inflation Hose w/Fittings
- Chrome, Heated Side-View Mirrors w/Remote Adjustment, Turn Signal Indicators & Side

OPTIONAL

- 2 Exterior Graphic Design Choices – Victory or Flightline Graphic Schemes
- Power Water Hose Reel
- Power Cord Remote (Key Fob)
- Custom Exterior Paint Color Request
- 1st Full Bay 90" Slide Tray
- 1st Full Bay 36" & 54" Slide Tray
- 2nd Full Bay 90" Slide Tray
- 2nd Full Bay 36" & 54" Slide Tray

CONSTRUCTION

- Powder-Coated Heavy-Duty Steel Framing
- Aluminum-Framed Wall Construction
- Interlocking Aluminum Framing Connections; Roof, Sidewall, Floor
- Steel Front Bulkhead
- Vacu-bond® Sidewall, Roof, Floor & Rear Wall
- Dense Bead Foam Insulation Throughout
- 5-Layer Flooring w/3" Bead Foam Insulation
- 6-Layer Roof Bead Foam Insulation
- DuPont® Exterior Automotive Full Body Paint w/Sand and Buff High-Gloss Finish
- Gel Coat Fiberglass Exterior Sidewalls w/No Wood Substrate
- Full Fiberglass Front & Rear Caps
- Fiberglass Front & Rear Quarter Panels
- Fiberglass Molded Front Bumper
- One-Piece Fiberglass Roof w/Radius Corners & Seamless Transition to Caps
- Insulated Aluminum Framed & Paneled Luggage Compartment Doors
- Sound Absorption Material Front, Rear & Engine
- Pebble-Finished Fiberglass Basement Lining
- Heated Water & Holding Tank Compartments
- Central Electrical Panel for 120V/12V AC/DC
- PEX Plumbing System

CHASSIS/ENGINE

- Liberty Chassis
- Independent Front Suspension w/55-Degree Steering Angle
- Group 31 Chassis Batteries (2)
- Air Ride Suspension w/Bilstein® Shocks
- Aluminum Wheels
- Anti-Lock Brake System (ABS)
- Automatic 4-Point Hydraulic Leveling System (Air and Hydraulic)
- Automatic Traction Control
- Chassis Filter Service Center
- Engine Block Heater
- Full Air Brakes w/Automatic Slack Adjusters
- Tire Pressure Check Gauge (Manual)

AWNING/WINDOWS/DOORS

- 30" Avionics Entry Door w/Deadbolt & Pneumatic Air Latches
- Entry Screen Door with Logo Kick Plate
- Powered Entry Door Awning
- Slide-Out Topper Awnings
- Frameless Flush Mount Windows
- (2) Roof-Mounted Girard Power Awnings w/Wind Sensor System (Door Side)
- (2) Girard Window Awnings (Roadside)

APPLIANCES

- Onan® 10.0kW Quiet Diesel Generator, Power Slide-Out
- Power TV Antenna w/Audible “Antenna Up” Warning
- OPTIONAL
- Exterior TV – Sidewall-Mounted (Includes: Sony® 32" LCD HDTV, Sony® AM/FM/CD/DVD)

† The chassis manufacturer recommends the installation of a supplemental brake control system to activate the brakes on the vehicle or trailer you are towing. Hitch receiver ratings expressed are maximum for the hitch receiver installed and may require the purchase of additional equipment that is dependant on the weight of the towed load. Consult with hitch receiver manufacturer for further information.

THE LIBERTY CHASSIS

Technology this groundbreaking requires an expert team. That's why American Coach and Spartan decided to join forces—to create a rugged, modular chassis system for an incomparable driving experience. Since 2004, the American Coach line has been built on the Liberty Chassis, an integration of superior American Coach

framing technology and the Spartan Chassis modular system, providing the strength and structure for a ride unrivaled in the luxury coach industry. So even coupled with a high-performance diesel engine, you'll enjoy the lowest levels of vibration for the smoothest riding coach on the road. Consider it our salute to integrity.

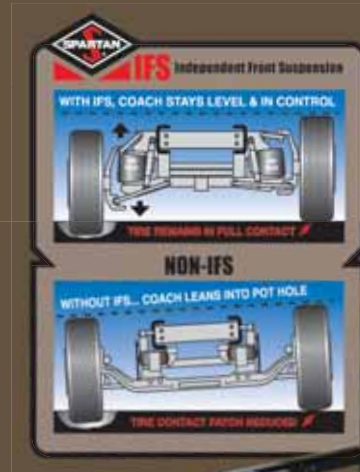

LIBERTY
CHASSIS



American Coach
THE OFFICIAL LUXURY COACH OF THE AMERICAN ROAD

For more information, visit us at www.AmericanCoach.com or call us at 800.854.1344

©2011. Fleetwood RV, Inc. Printed in the USA. Inventory Control Number AE12B1, 9/11. Model Year 2012, First Edition.