



THOR
MOTOR COACH

Siesta

SPRINTER MOTORHOME SPECIFICATIONS





24SA FLOORPLAN / CHERRY WOOD / URBAN STEEL DÉCOR



MILANO BROWN



URBAN STEEL



SIZZLE GREY II



CHERRY

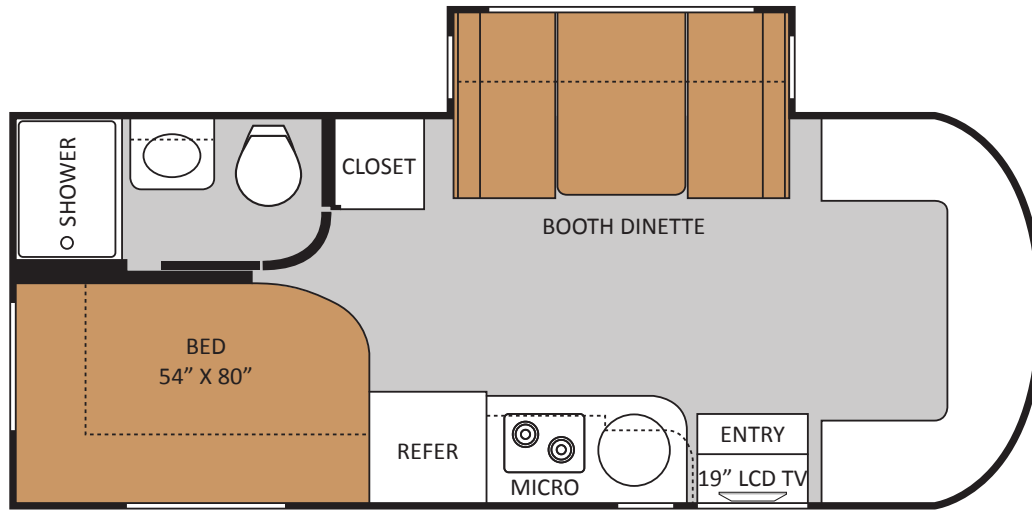

24SA

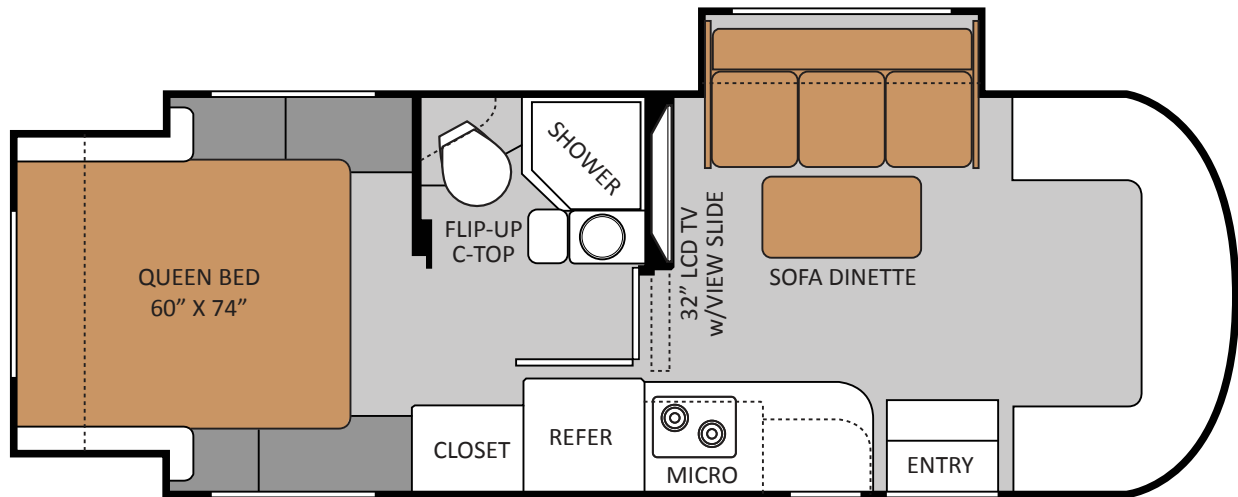

24SR



STANDARD GRAPHICS



AUTUMN MAPLE PARTIAL PAINT



SATIN CREAM FULL BODY PAINT



SILVER STORM FULL BODY PAINT

MODEL	24SA	24SR
Chassis	SPRINTER	SPRINTER
Gross Vehicle Weight Rating (GVWR)	11,030	11,030
Gross Combined Weight Rating (GCWR)	15,250	15,250
Wheel Base	170.3"	170.3"
Exterior Length (without ladder)	24'-6"	24'-10"
Exterior Height (with air conditioning)	10'-10"	10'-10"
Exterior Width (without mirrors)	90"	90"
Interior Height	80"	80"
Awning Size (manual/electric)	14'-6"	14'-6"
Fuel (gallons)	26.4	26.4
LPG (pounds)	68.2	68.2
Fresh Water (gallons)	40	40
Grey Water (gallons)	34	34
Waste Water (gallons)	38	38
Water Heater (gallons)	6	6
Furnace (BTUs)	25,000	25,000
Exterior Storage Capacity (cubic feet)	49.6	39

IMPORTANT - PLEASE READ: Information published within this brochure reflects product design, fabrication, material, components and specifications at the date of printing. If your vehicle was manufactured before this brochure was published this information may not be accurate because vehicles assembled before the brochure was published may not have the same design, fabrication, materials, components and specification as represented in the brochure. If your vehicle was manufactured after this sales brochure was published the representations may not be accurate because, for product improvement reasons, we reserve the unilateral right, at any time, without prior notice, to make changes in product design, material, components and specifications. The date the brochure was published (i.e. "Julian date") is set forth on the last page of the brochure. IF CERTAIN INFORMATION PUBLISHED WITHIN THIS BROCHURE IS SIGNIFICANT TO YOUR PURCHASING DECISION, PLEASE CONSULT WITH YOUR SELLING DEALERSHIP TO CONFIRM THAT THE INFORMATION IS ACCURATE WITH RESPECT TO THE VEHICLE YOU ARE CONSIDERING PURCHASING. Photographs in the brochure may depict optional equipment or may only be available in certain floor plans. We reserve the right to make changes in prices and models and to discontinue models without notice or obligation. Components, appliances and the chassis may have been manufactured in a calendar year before the vehicle's designated model year. All capacities are approximate. The actual length of the vehicle may differ from that indicated in the brochure due to variances in the manufacturing processes and/or installed components. All dry weights are based on standard model features and do not include optional features or equipment. Components, appliances and features may differ to conform to local codes. Due to EPA environmental restrictions, engine power and torque ratings may change during any model year. The Thor Motor Coach logo and its design are registered trademarks. Other products and company names are trademarks and/or registered trademarks of their respective manufacturer. While the color of the motorhome's exterior and the interior fabrics depicted in this brochure are fair and reasonable depictions, the colors depicted may not be exact match of the actual colors because of variances in photo processing and printing. Component part and appliance manufacturers issue limited warranties covering portions of the vehicle not covered under the limited warranty we issue. To learn specific details regarding warranty coverage please consult your selling dealership or review the warranty packet inside the vehicle.

STANDARD FEATURES AND OPTIONS

CONSTRUCTION & EXTERIOR

- Slick fiberglass exterior sidewalls
- One-piece fiberglass front cap
- One-piece fiberglass rear cap (Partial on 24SR)
- Exterior graphics package
- Seamless roto-cast storage compartments
- Side hinged slab luggage doors
- Manual patio awning
- Slideout room awning
- Roof ladder (N/A 24SR)
- Automatic electric entrance step
- Outside shower

CONSTRUCTION & EXTERIOR OPTIONS

- Exterior graphics with partial paint package
- Full-body paint package with Gel-coat sidewalls

AUTOMOTIVE & COCKPIT

- AM/FM Dash radio with oversized buttons, CD player and weather band tuner; iPod and Sirius Satellite ready (iPod & Sirius Satellite ready not available with backup camera)
- Driver and passenger air bags
- Keyless entry
- Heated remote exterior mirrors
- Fiberglass running boards
- Stainless steel wheel liners
- Spare tire
- 3,500 lb. trailer hitch
- Leatherette driver and passenger captain's chairs
- Back-up monitor

INTERIOR

- 80" interior ceiling height
- Electric Euro-skylight
- Residential linoleum (galley, bath and living area)
- Windshield privacy curtain

- 13,500 BTU low-profile air conditioner in front
- Ceiling ducted air conditioning system
- Directional reading lights
- European style curved cabinetry with hidden hinges
- Hardware with nickel finish
- Night shades
- Booth dinette (N/A 24SR)

INTERIOR OPTIONS

- Leatherette hide-a-bed sofa with air mattress and pedestal table (STD 24SR)
- Fabric / Leather U-shape dinette (N/A 24SR)
- Leatherette U-shape dinette (N/A 24SR)
- Fantastic fan

KITCHEN

- Double door refrigerator with stainless steel door inserts
- European 2-burner high-output gas range top with glass cover
- Stainless steel power range hood
- Stainless steel convection microwave
- Large stainless steel single bowl sink with goose neck faucet
- Laminate countertops
- Solid surface lavatory countertop (N/A 24SA)
- Full extension drawer guides

KITCHEN OPTIONS

- Solid surface kitchen countertop

ENTERTAINMENT

- 19" LCD television over the door DVD entertainment system - iPod ready (N/A 24SR)
- 26" LCD Television (Midship) DVD entertainment system - iPod ready (N/A 24SA)
- Television antenna and booster

- Cable television prep
- HD/DSS satellite prep

ENTERTAINMENT OPTIONS

- Front entertainment center with 26" LCD television in cab-over (N/A 24SR)
- 19" LCD television in bedroom - can be removed and mounted to exterior hook-ups (N/A 24SR)

BEDROOM & BATHROOM

- Bedspread and pillow shams
- Directional reading lights
- China bowl toilet
- Power bath vent
- Rectangular shower with glass door (N/A 24SR)
- Neo-angled shower with curtain (N/A 24SA)

SAFETY & CONVENIENCE

- Entry door with deadbolt lock
- Systems control center
- Smoke, LPG, carbon monoxide detectors
- Fire extinguisher

ELECTRICAL & PLUMBING

- Onan 3.6 (3600-kilowatts) LP generator
- 30 amp service with shore line power cord
- Automatic shoreline-to-generator transfer switch
- Battery disconnect switch
- 6-gallon gas/electric water heater
- Water heater bypass system

ELECTRICAL & PLUMBING OPTIONS

- Holding tanks with heat pads
- Onan 3.2 (3200-kilowatts) Diesel generator
- Second Auxiliary Battery



Siesta



SCAN THE QR CODE WITH YOUR SMART PHONE

YOUR LOCAL TMC DEALER:



Go RVing.

P.O. BOX 1486 • ELKHART, IN 46515 • CUSTOMER SERVICE: 877-855-2867 • SALES DEPARTMENT: 800-860-5658 • SIESTA-SPRINTER.COM



COPYRIGHT THOR MOTOR COACH, INC. © 2011 [12/2011]