

www.KeystoneRV-Vizion.com

# VIZION

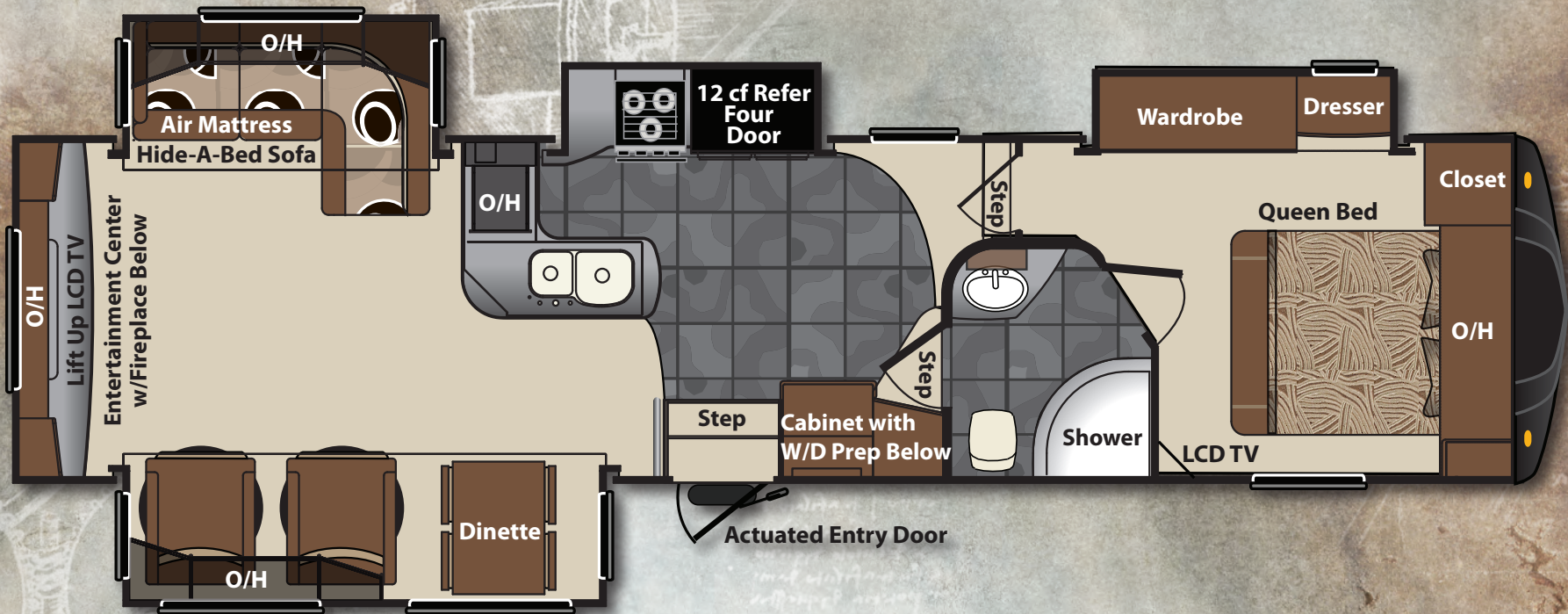

**THE "NEW CONCEPT" FIFTH WHEEL**  
WITH OVER 350 CUBIC FEET OF PASS THRU STORAGE



# STANDARD FEATURES

**SCAN & SEE**

VIEW FEATURES, PHOTOS  
AND MORE! GET YOUR FREE  
APP AT: [HTTP://GETTAG.MOBI](http://GETTAG.MOBI)

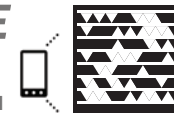

## Living Area

- Raised panel Cherry cabinet doors with spring-loaded hidden hinges
- Mullion-style cabinet doors, where applicable
- Electric fireplace (some models)
- Air-mattress L-shaped sofa
- Euro-recliner chairs (2) (some models)
- 37-inch LCD TV
- Sony® sound system with 600-watt Kicker amp, 6 speakers and sub-woofer
- Solid surface countertop
- Day/Night shades
- 12-volt lighting throughout
- 4-inch recessed puck lights
- Dyson® hand vacuum

## Kitchen

- Solid surface countertop
- 60/40 stainless steel sink
- Full extension ball-bearing drawer guides
- Bottle opener
- 12-cubic foot 4-door refrigerator
- Microwave
- Three burner range with oven
- Free standing dinette with storage in table and in chair seats

## Bathroom

- Solid surface countertop
- Stainless steel vanity sink
- Mirrored medicine cabinet
- One-piece fiberglass shower surround with radius sliding door
- Porcelain foot-flush toilet

## Construction

- Dual-zone thermostat in bedroom and living room
- Norco® electric slides, each slide individually controllable
- 100-amp converter

- Washer/Dryer prep
- Entrance doors with integrated gas-strut
- 15K BTU ducted roof air conditioner
- 12-gallon gas/electric DSI water heater
- 35K BTU furnace
- Four-wheel electric brakes
- Blizzard Package (R-31 roof and floor; R-24 slideroom floors; vented attic; ducted heat to underbelly)

## Exterior Features

- 102-inch wide body
- Slam-latch storage compartment doors (11)
- 7000-pound axles
- 16-inch tires
- 8-lug aluminum rims
- Rear electric stabilizer jacks
- Front electric landing jacks
- LP generator prep
- Hitch Vision
- 30-pound LP bottles (3)
- Sewer hose holder
- Rear ladder
- 50 AMP power
- Opening windows (11)
- Docking lights
- Security lights (2)

## Convenience Center

- Black tank flush
- Exterior shower
- Water heater bypass
- Winterization valve
- Light
- City water hook up
- Cable and satellite hook ups

## Optional Features

- 2nd 15K BTU roof air conditioner
- Dual-pane windows
- Onan® 55kw LP generator
- CSA Certification

## Weights and Measurements

<b>MODEL</b>	<b>3544</b>
<b>SHIPPING WEIGHT</b>	TBD
<b>CARRYING CAPACITY</b>	TBD
<b>HITCH WEIGHT</b>	TBD
<b>EXTERIOR LENGTH</b>	38' 1"
<b>EXTERIOR WIDTH</b>	8'
<b>EXT. HEIGHT - A/C TOP</b>	13' 3"
<b>FRESH WATER (GAL.)</b>	62
<b>WASTE WATER (GAL.)</b>	43
<b>GRAY WATER (GAL.)</b>	86
<b>LPG CAPACITY (LBS.)</b>	90

[www.KeystoneRV-Vizion.com](http://www.KeystoneRV-Vizion.com)

# VIZION



**Keystone RV  
Company**

[www.kestonerv.com](http://www.kestonerv.com)

2642 Hackberry Drive  
PO Box 2000  
Goshen, IN 46527-2000  
(574) 535-2100

Member  
**RVIA**  
RECREATION VEHICLE  
INDUSTRY ASSOCIATION  
**Go RVing**  
Life's A Trip!

Product information is as accurate as possible at the date of publication of this brochure. Features, floor plans, and specifications are subject to change without notice. Please also consult Keystone's web site at [kestonerv.com](http://kestonerv.com) for more current product information and specifications. Tow Vehicle Disclaimer. CAUTION: Owners of Keystone recreational vehicles are solely responsible for the selection and proper use of tow vehicles. All customers should consult with a motor vehicle manufacturer or their dealer concerning the purchase and use of suitable tow vehicles for Keystone products. Keystone disclaims any liability or damages suffered as a result of the selection, operation, use or misuse of a tow vehicle. KEYSTONE'S LIMITED WARRANTY DOES NOT COVER DAMAGE TO THE RECREATIONAL VEHICLE OR THE TOW VEHICLE AS A RESULT OF THE SELECTION, OPERATION, USE OR MISUSE OF THE TOW VEHICLE. 11/2011