

Camping Trailers



COMET SERIES

CENTENNIAL SERIES

- 2012 Camping Trailers**
- ✓ 7-year tent warranty
 - ✓ 5 lifetime warranties
 - ✓ Standard power roof lift
 - ✓ Easy-glide bunks
 - ✓ 1,050-lb. rated bunks

2012 CAMPING TRAILERS

- » FULLY ENCLOSED LIFTER SYSTEM
- » AQUASHIELD AQUALON TENT
- » INDEPENDENT SUSPENSION
- » 16,000-BTU FURNACE
- » ELECTRIC BRAKES
- » 5 LIFETIME WARRANTIES
 - » LIFTER SYSTEM
 - » ROOF
 - » FRAME
 - » FLOOR
 - » BED FRAMES

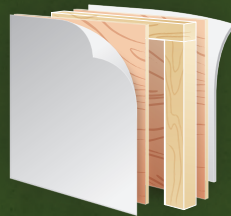
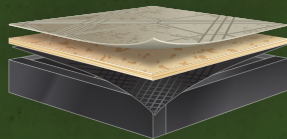

BUILT GREEN

We are one of the few manufacturers that can say we are certified green capable. Our processes and production materials are independently tested in six environmental categories.

A FIRM FOUNDATION

We wrap a seamless 5/8" Structurwood floorboard with Darco underbelly material and double bond it to our steel frame, resulting in one of the strongest floors available.

VACUUM-BONDED WALLS

We combine 1 1/2" thick laminated aluminum sidewalls with wooden frames and backers to create a durable structure designed to handle the toughest conditions.

DURABLE TENT DESIGN

Our patented lifter system is fully enclosed to protect against rust and debris and is backed by a lifetime warranty. Meanwhile our AquaShield tent material, backed by a 7-year warranty, is water repellent and double stitched to protect Starcraft's 1,050-lb. rated bunk ends.



Comet 1019



Comet 1222

DETAILS THAT MAKE A DIFFERENCE



CARRY-OUT STOVE

Starcraft's flexible stainless-steel carry-out stove lets you cook where it's most convenient.



EASY BUNK SETUP

With E-Z Store permanent bunk supports, easy-glide bunk ends and permanently attached poles, tent setup is easier than ever.



INDOOR/OUTDOOR SOUND SYSTEM

Enjoy your music inside or outside thanks to high-output, marine-grade speakers.



ONE-PIECE DOOR

Keep drafts out easily with Starcraft's one-piece door that's also easy to clean and store.



CRANK-DOWN STABILIZER JACKS

Set up in seconds, even in sand or mud, with our crank-down stabilizer jacks and sand pads.

Comet® Series



- » 5 FLEXIBLE FLOORPLANS
- » 1,050-LB. RATED BUNKS
- » SLEEPS UP TO 7 PEOPLE



7-YEAR TENT WARRANTY

Our double-stitched AquaShield Aqualon tents are built to resist mold and won't stretch, shrink or crack. They're also permanently attached to the bunk ends for easy setup and safety.

PATENTED SOFTSHADES

Our patented SoftShades provide easy privacy with no hassle or tangled cords.

DIAMOND PLATING

Starcraft's diamond plating provides protection from road debris where it's needed most.

Simple solutions

With the Starcraft Comet you don't pay for things you don't need. Its simple design delivers everything that will make life easy. With low-maintenance E-Z Lube axles, our AquaShield Aqualon tent material and a patented lifter system, you'll spend more time camping.





Floorplans

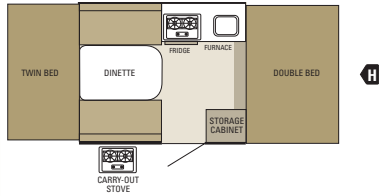

Comet 816

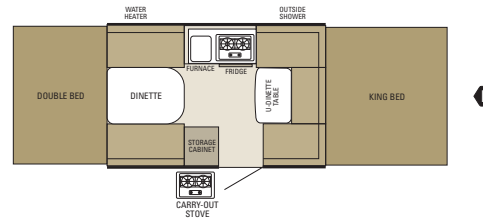

Comet 1019

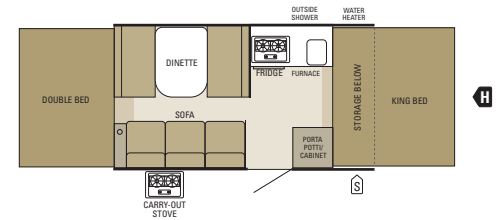

Comet 1020

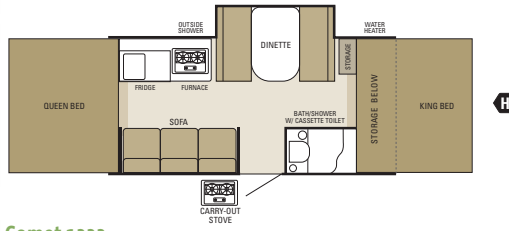

Comet 1222

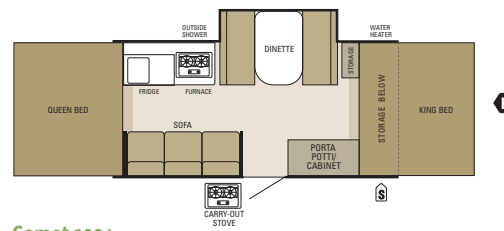

Comet 1224

- OUTSIDE STORAGE
- TRAILER HITCH
- FRIDGE REFRIGERATOR



Comet 1222

Standards and options

STANDARD INTERIOR EQUIPMENT

- 120V G.F.C.I. protected interior receptacle
- 2nd table with pedestal leg (1019)
- Ball bearing drawer guides 50-lb. capacity with full-drawer extension
- Bath/shower (1222)
- Hinged dinette seat bases
- Non-sliding, 4" deep cushions for dinette with reversible EZ-clean vinyl backs
- Real-wood drawers
- Silverware tray
- Sliding pantry in front wall (1020, 1222, 1224)
- SoftShade window shades and valances
- Spice rack
- Stainless-steel carry-out stove
- Stereo with MP3 input jack and 2 speakers
- Tinted vinyl windows with fine-mesh bug screen

STANDARD EXTERIOR EQUIPMENT

- 6-gal. water heater (n/a 816)
- 120V G.F.C.I. protected exterior receptacle
- Aluminum exterior sidewalls
- AquaShield Aqualon water-repellent sectionalized tent with 7-year warranty
- Bunk-end tents permanently attached to bed base
- Crank-down stabilizer jacks with sand pads (4)
- Diamond plating on front and rear walls
- Domed fiberglass roof with no center seam
- Electric brakes
- Entrance door, one-piece construction
- Exterior speakers, high-output marine-grade (2)
- E-Z Lube axles
- E-Z Store bed supports
- Floor constructed of Structurwood and sealed with a Darco underbelly
- Outside shower (n/a 816)
- Patio light with amber lens
- Powder-coated white bunk-end bows

- Power roof lift
- Prep for A/C accommodating all roof-mounted A/C's
- Spare tire and carrier
- Storage compartment in front trunk (select models)
- TorFlex independent torsion axle suspension
- Vinyl spare tire cover

STANDARD HEAT, POWER & ELECTRIC EQUIPMENT

- 12V electrical system with 20-amp 110V converter
- 17-gal. fresh water system with 12V demand pump
- 20-lb. propane bottle
- 16,000-BTU furnace
- Water heater bypass system (n/a 816)

CUSTOMER CONVENIENCE PACKAGE

- 2 cu. ft. 3-way refrigerator
- Awning
- Bunk-end lights/fans (2)
- Water purification system



OUTSIDE SHOWER

The handy outside shower makes it easy to rinse off after a day outdoors (n/a in 816).



For a complete list of standards and options, scan here with your smartphone or visit starcraftcamping.com.

Specifications

Floorplan	Exterior Length	Campsite Length	Travel Height	Unloaded Vehicle Weight (lbs.)	Dry Hitch Weight (lbs.)	Gross Vehicle Weight Rating (lbs.)	Cargo Carrying Capacity (lbs.)	Fresh Water Capacity (gal) (includes water heater)	Gray Waste Water Capacity (gal.)	Black Waste Water Capacity (gal.)
816	11' 9"	16' 2"	57"	1,550	195	2,250	700	17	-	-
1019	14' 2"	20' 10"	56"	1,875	185	2,550	675	23	-	-
1020	16' 2"	20' 10"	60"	2,080	225	2,950	870	23	-	-
1222	18' 2"	23' 4"	61"	2,725	385	3,450	725	23	11	5
1224	18' 2"	23' 4"	61"	2,440	280	3,450	1,010	23	-	-

Unloaded Vehicle Weight (UVW): Sometimes referred to as "Dry Weight," UVW means the typical weight of this trailer as built at the factory. The UVW, as used in product literature and other promotional materials, does not include cargo, fresh water, propane, options or dealer-installed accessories.

Gross Vehicle Weight Rating (GVWR): GVWR means the maximum permissible weight of the trailer, including the UVW plus passengers, personal items, all cargo, fluids, options, and dealer-installed accessories. The GVWR is equal to or greater than the sum of the UVW and the CCC.

Cargo Carrying Capacity (CCC): CCC means the maximum weight of all passengers, personal items, food, fresh water, propane, tools, other cargo and dealer-installed accessories that can be carried by the trailer. CCC is equal to or less than GVWR minus UVW. The addition of options will decrease the CCC.

Hitch Weight (HW): The hitch weight, as used in product literature and other promotional materials, does not include cargo, fresh water, propane gas, options or dealer-installed accessories. The addition of these types of items will either add to or subtract from the stated hitch weight.

It is important for your safety and enjoyment that your tow vehicle be adequately sized and equipped to tow and handle the GVWR of the RV you select. Review weights and rating of your tow vehicle and consult a competent advisor for questions or advice. Whether you are new to RVing or a veteran, get a feel for the performance of your tow vehicle and the RV together before heading out on the roadways. When you tow an RV, you must drive differently than you do when driving a single vehicle. Practice hooking up, driving, backing up and braking in a safe environment or seek out professional instruction. Starcraft affixes a weight label to each RV which lists weight information for that vehicle. See specification chart above.



Comet 1222

Centennial® Series



- » 2 FANTASTIC FLOORPLANS
- » EXPANSIVE KING-SIZED BUNKS
- » HEATED BED MATS
- » SPACE-MAKING SLIDEOUTS



KING-SIZED COMFORT

Spread out and stay warm with a pair of king-sized mattresses with bed heaters.

AQUASHIELD AQUALON TENTS

Our double-stitched AquaShield Aqualon tents, backed by a 7-year warranty, are built to resist mold and won't stretch, shrink or crack.

BOURBON GLAZE CABINERY

Centennial features hand-crafted Bourbon Glaze flat-panel cabinetry.

Spread out

Starcraft Centennial is designed to give you more space. The slideout dinette, a pair of E-Z glide king-sized bunks and innovative storage areas puts the Centennial in the highest class of camping trailers. And with a 16,000-BTU furnace, 3-burner stove and AM/FM stereo with MP3/iPod input, Centennial is as comfortable as it is spacious.





Centennial 3611



Centennial 3611

Floorplans

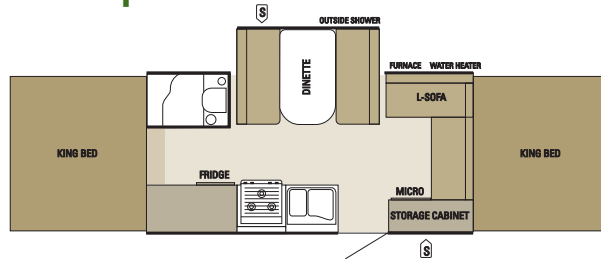

Centennial 3611

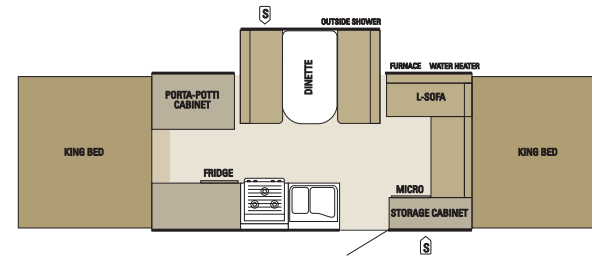

Centennial 3612

- TRAILER HITCH
- OUTSIDE STORAGE
- FRIDGE REFRIGERATOR
- MICRO MICROWAVE

Standards and options

STANDARD INTERIOR EQUIPMENT

- 3-burner stove with recessed stove ring
- 3 cu. ft. 3-way gas/electric refrigerator
- 120V G.F.C.I. protected interior receptacle
- Ball bearing drawer guides 50-lb. capacity with full-drawer extension
- Bath/shower (3612)
- Bed mat heaters (2)
- Bourbon Glaze cabinetry
- Bunk-end fan lights (2)
- Cable TV hookup with RG6 connection
- Carry-out dinette table
- Clothes rod
- Hinged dinette seat bases
- Interior speakers (2)
- Microwave
- Oversized oven
- Privacy curtains for bunk ends
- Real-wood drawers
- Silverware tray
- SoftShade window shades and valances
- Spice rack
- Tinted vinyl windows with fine-mesh bug screen

STANDARD EXTERIOR EQUIPMENT

- 6-gal. water heater
- 120V G.F.C.I. protected exterior receptacle
- AquaShield Aqualon water-repellent sectionalized tent with 7-year warranty
- Bunk-end tents permanently attached to bed base
- Crank-down stabilizer jacks with sand pads (4)
- Diamond plate on front and rear walls

- Domed fiberglass roof with no center seam
- Electric brakes
- Entrance door, one-piece construction
- Exterior speakers, high-output marine-grade (2)
- E-Z Lube axles
- E-Z Store bed supports
- Floor constructed of Structurwood and sealed with a Darco underbelly
- Gelled hi-gloss fiberglass laminated sidewalls
- Outside shower
- Patio light with amber lens
- Powder-coated white bunk-end bows
- Power roof lift
- Prep for A/C accommodating all roof-mounted A/C
- Spare tire and tire carrier
- TorFlex independent torsion-axle suspension
- Vinyl spare tire cover

STANDARD HEAT, POWER & ELECTRIC EQUIPMENT

- 12V electrical system with 30-amp 110V converter
- 17-gal. fresh water system with 12V demand pump
- 16,000-BTU furnace
- Double 20-lb. propane bottles with vinyl cover
- Water heater bypass system

CUSTOMER CONVENIENCE PACKAGE

- Awning
- Polished aluminum rims
- Stereo with MP3 input jack
- Water purification system



EASY-GLIDE BUNK ENDS

The bunk ends are built on steel rails with easy-glide rollers for quick, effortless setup.



ONE-PIECE DOOR STORAGE

Our one-piece door stores easily against the ceiling during travel—keeping it protected and accessible for easy setup.



For a complete list of standards and options, scan here with your smartphone or visit starcraftcamping.com.



POWER ROOF LIFT WITH KEY FOB

What's better than an industry-leading lifter system? One that runs with the click of a button.

Specifications

Floorplan	Exterior Length	Campsite Length	Travel Height	Unloaded Vehicle Weight (lbs.)	Dry Hitch Weight (lbs.)	Gross Vehicle Weight Rating (lbs.)	Cargo Carrying Capacity (lbs.)	Fresh Water Capacity (gal.) (includes water heater)	Gray Waste Water Capacity (gal.)	Black Waste Water Capacity (gal.)
3611	18' 1"	25' 8"	63"	2,945	355	3,850	905	23	7.5	5
3612	17' 8"	25' 8"	63"	2,840	375	3,850	1,010	23	-	-

Unloaded Vehicle Weight (UVW): Sometimes referred to as "Dry Weight," UVW means the typical weight of this trailer as built at the factory. The UVW, as used in product literature and other promotional materials, does not include cargo, fresh water, propane, options or dealer-installed accessories.

Gross Vehicle Weight Rating (GVWR): GVWR means the maximum permissible weight of the trailer, including the UVW plus passengers, personal items, all cargo, fluids, options, and dealer-installed accessories. The GVWR is equal to or greater than the sum of the UVW and the CCC.

Cargo Carrying Capacity (CCC): CCC means the maximum weight of all passengers, personal items, food, fresh water, propane, tools, other cargo and dealer-installed accessories that can be carried by the trailer. CCC is equal to or less than GVWR minus UVW. The addition of options will decrease the CCC.

Hitch Weight (HW): The hitch weight, as used in product literature and other promotional materials, does not include cargo, fresh water, propane gas, options or dealer-installed accessories. The addition of these types of items will either add to or subtract from the stated hitch weight.

It is important for your safety and enjoyment that your tow vehicle be adequately sized and equipped to tow and handle the GVWR of the RV you select. Review weights and rating of your tow vehicle and consult a competent advisor for questions or advice. Whether you are new to RVing or a veteran, get a feel for the performance of your tow vehicle and the RV together before heading out on the roadways. When you tow an RV, you must drive differently than you do when driving a single vehicle. Practice hooking up, driving, backing up and braking in a safe environment or seek out professional instruction. Starcraft affixes a weight label to each RV which lists weight information for that vehicle. See specification chart above.

BUILT ON TRADITION



The Starcraft name has been around for more than 40 years—becoming one of the most dependable names in the camping industry. Today, our strong balance sheet and family-oriented business approach means we'll be around for years to come. And with a full lineup of towables, you can bet our campers will fit your lifestyle and come with everything you need—all at an affordable price.

Warranty

The Starcraft warranty is a manufacturer's limited warranty. Each Starcraft is warranted to the original purchaser for twelve (12) months from the original date of purchase against defects in materials and workmanship. Starcraft's limited warranty is not transferable. For a copy of the limited warranty with full terms and conditions, ask your local Starcraft dealer.

Roadside assistance

Travel worry-free with the complimentary National Motor Club program, which gives you immediate access to dependable roadside assistance with a simple phone call.

Why a Local Starcraft Dealer is Important to You

Establishing a solid relationship with your local Starcraft dealer is a key component in the enjoyment of your new Starcraft. By purchasing from a local dealer, you will have a convenient location for sales, parts and service support.



To learn how Comet and Centennial take comfort and affordability to a whole new level, scan here with your smartphone.

FOLLOW US ON



STARCRAFT

CAMPING | *pure and simple.*



www.starcraftcamping.com | STOP BY OUR HOME ON THE WEB FOR MORE INFORMATION OR TO FIND A DEALER NEAR YOU.

© Starcraft RV • 536 Michigan St., Topeka, IN 46571

www.starcraftcamping.com
See dealer for further information and prices. All information in this brochure is the latest available at the time of publication approval. Starcraft reserves the right to make changes and to discontinue models without notice or obligation. Photos in this brochure may show optional equipment and props for photography purposes. RV's built for sale in Canada may differ to conform to Canadian codes.