

# i-Go

LITE by EVERGREEN



I Go, You Go,  
We all Go Camping in an EverGreen!

### An EverGreen for Everyone.

The concept of the i-Go Lite travel trailers and fifth wheels is to provide economy conscious camping families the opportunity to own a lightweight, quality built EverGreen. The i-Go is crafted with the same aluminum-framed, vacuum-laminated processes and quality control systems as all EverGreen products.

### The Advantages of Owning an i-Go Lite by EverGreen

- **i-Go is lighter weight and easier to tow** because of its narrower, seven-foot six-inch width. With less wind resistance, the i-Go tracks smoothly behind smaller tow vehicles such as half-ton pickups or mid-sized SUVs. The entire i-Go Lite series trailers are less than 30 feet in length and weigh less than 5,000 pounds.
- **Built better, yet more affordable** with a fiberglass reinforced exterior skin, the i-Go still features EverGreen's innovative, lightweight composite inner shell to reduce rot, mold and mildew. Composites also lower off-gassing of VOC's for healthier camping.
- **EverGreen's vacuum laminated composite construction** is bonded onto a fully welded and reinforced aluminum frame. The combination of seamless composite materials and vacuum lamination result in added durability and higher R-values. The i-Go is a true EverGreen at a more affordable price.
- **Deeper, 42-inch slide outs are above the wheel-well to provide** higher ground clearance. Six-inches deeper than the competition, i-Go Lite slides provide the living space of an eight foot wide trailer yet has the towability of a seven and one half foot wide trailer. Slides are driven in all four corners with EverGreen's quality, four point, gear driven system to provide smoother operation and a tighter seal.



## Floorplan Preview!

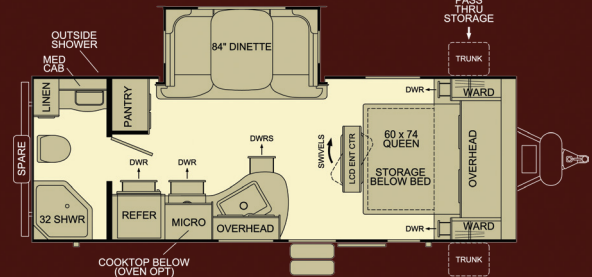

MODEL G220RB

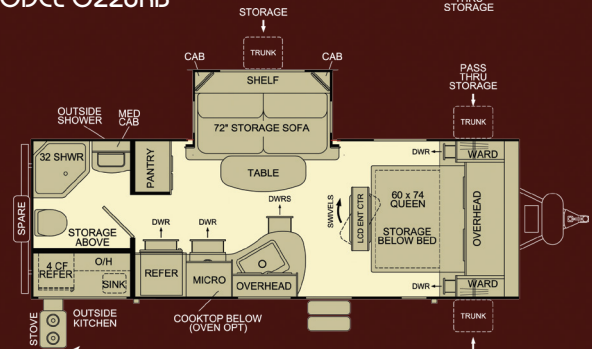

MODEL G236RBK

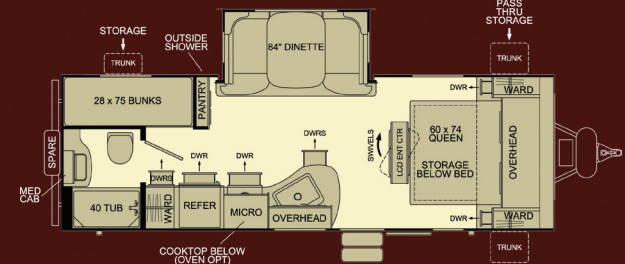

MODEL G239BH

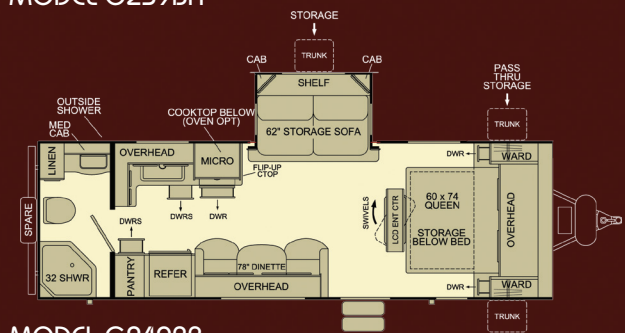

MODEL G249RB



## Standard Features

### Construction

- Steel I-beam frame • vacuum-laminated side walls, roof and floors • Composite inner shell to help prevent rot, mold or mildew • tough fiberglass reinforced exterior • fully welded aluminum framed sidewalls, roof and floor includes window framing • walk-on crowned roof fully laminated with white, reflective TPO material • four, frame-mounted stabilizer jacks • Easy-Flex suspension • protective enclosed underbelly

### Exterior

- Large, dark tinted radius windows • porch light • 14-inch radial, nitro-filled tires with steel rims • outside shower • exterior speakers • awning • radius entry door with large grab handles • large pass-through storage • designer graphics • double entry steps • spare tire and kit with cover • large baggage doors with compression latches

### Utilities

- Six-gallon gas/electric direct spark ignition water heater • power cord with the LED indicator light • two, 20-pound LP tanks with hard cover • exterior LCD TV hook up with bracket, cable hook up • furnace • ducted roof AC • TV antenna and booster • digital tank readout • water pump with winterizing inlet • fire extinguisher, carbon monoxide detector, smoke alarm

### Interior

**Kitchen**— Padded 'no crack' vinyl flooring • large kitchen window with blind • full-size composite sink with cover and gooseneck faucet • skylight with shade • screwed and glued solid wood cabinetry • microwave • three burner cook top • double door refrigerator/freezer

**Living**— Swivel entertainment center with optional 20 inch TV • AM/FM/DVD/CD, with USB/SD port • ceiling speakers

**Bath**— Porcelain foot flush toilet • full tub/or neo-angled shower • skylight over shower/tub • large medicine cabinet and mirror • towel hooks • power exhaust fan • oil rubbed bronze fixtures

**Bedroom**— Queen bed with inner spring mattress • under-bed storage with lift struts • bed spread, headboard • dual wardrobe and drawer storage • two nightstand nooks with power outlets

### Options

- Aluminum wheels • glass shower surround • 15K BTU air conditioner • 20 inch, LCD flat screen TV • power awning • convection microwave • gas oven • Hi-Output fan in bedroom • power tongue jack • solar battery charger • composite 20# LP tank.

[www.GoGoRV.com](http://www.GoGoRV.com)

## The i-Go Lite Difference--from the Inside Out

### Walls

1. Composite inner shell
2. Fully welded aluminum frame
3. High-density, block foam insulation
4. Plywood substrate
5. Glossy fiberglass reinforced exterior

### Roof

6. Composite inner shell
7. Fully welded, walk on, crowned aluminum frame
8. High-density, block foam insulation
9. Plywood substrate
10. Reflective, white TPO roofing

### Floor

11. Enclosed, seamless underbelly
12. Woven plastic floor brace
13. Plywood substrate
14. Fully welded aluminum frame
15. High-density, block foam insulation
16. Seamless composite inner shell
17. Tough, temperature resistant Beau Flor linoleum
18. Steel I-beam frame



EVERGREEN RECREATIONAL VEHICLES [www.GoEverGreenRV.com](http://www.GoEverGreenRV.com)  
 10758 County Road 2 • Middlebury, IN 46540 • Phone: (574) 825-4298 • Fax: (574) 825-4299