

"I WILL GUARANTEE YOU ONE THING... NOBODY BUILDS TOY HAULERS THIS STRONG OR THIS LIGHT!"

Scott Tuttle,
President of LIVIN LITE



Get the Best Value for your Money - Buy the ONE RV that will NOT ROT over time!

ALL Aluminum and composite construction will last for decades!

The VRV Floor Decking is Aluminum Plank Tongue and Groove, Fitted Together and Welded into Place for Unmatched Strength and Durability.



Strong Tubular Aluminum is Welded to Form the Strongest, Lightest Frame Possible.

THE MOST DURABLY CONSTRUCTED TOY HAULERS ON THE MARKET

LIVIN LITE IS PROUD TO FEATURE THESE GREAT PRODUCTS



1.5"x3" Tubular Aluminum Form the Headers and Around the Bunks.



STANDARD FEATURES

- 1. Tubular Aluminum Frame**
Lightweight; Durable; will not rust away like typical steel frames.
- 2. Dexter™ Independent Torsion Suspension**
Provides the smoothest ride, best tracking and less rebound in all terrains - compared to outdated spring leaf suspensions.
- 3. Inter-Locking Alumina-Plank® Floor Deck**
Lightweight; Durable; will not rot away, sag or have soft spots like typical plywood floor decking. Frankly, there's just no comparison to conventional trailers here.
- 4. Tubular Aluminum Sidewall Framing**
1.5" x 1.5" and 1.5" x 3" Strong Tubular Structure; Lightweight; Durable; will not rot away like wood.
- 5. Painted Aluminum Exterior**
Lightweight; Strong; Durable; offers the option of colors vs. competition's white.
- 6. Diamond Plate Aluminum Rockguard and Trim Package (automotive styling)**
Protective; Durable and Adds a Great Look to the Exterior of the Camper.
- 7. Fully Insulated Sidewalls and Roof**
Lightweight, Block Foam Insulation Provides for maximum Insulative Value. Spray On Under Floor Insulation Available As An Option.
- 8. Tubular Aluminum Roof Rafter Framing**
Lightweight; Durable; will not rot away like wood.
- 9. Tubular Aluminum Cabinet Framing**
Lightweight; Durable; water resistant; will not rot away like typical wood studs.
- 10. Aluminum Skinned Cabinetry**
Lightweight; Durable; Clean Look; Designed to stand the test of time - compared with the typical wood paneling.
- 11. Finished Aluminum Cabinet Doors**
Lightweight; Durable; Clean Look; Designed to stand the test of time - compared to typical "presswood" doors.
- 12. Hehr Windows - Featuring Tinted Design and Screens**
- 13. Lightweight Countertops**
Lightweight; Durable; Water Resistant; Designed to stand the test of time - compared with others "presswood" tops.
- 14. 6'-8" Interior Headroom**
No more bending over in your camper! Enjoy the ability to walk around with plenty of head room - afforded by VRV's increased interior spaciousness!
- 15. AZDEL Composite Wallboard - 50% Lighter than Wood; No Formaldehyde; Moisture Resistant; R2 Insulative Value!**
- 16. Diamond Vinyl Interior Wall Board**
Durable; Easy to Clean So You Can Spray The Unit Out With a Hose!
- 17. Heavy Duty, Durable Tip-Out Bunks**
Patent-Pending Design with Comfortable Mattresses. Sets Up Easily in Minutes with Zippered Windows and Screens!
- 18. Upgraded Side Vents**
Sturdy Design Provides Air Flow While in Transit, Easily Opened and Closed.

POPULAR OPTIONS

- Bath Option (Dry Bath Most Models - Wet Bath on 6x14 and 8x26FB)
- LP Package: Refer, Furnace, W/H, Range, Tank (Includes refer cabinet for 2.5 cu. ft. on 6' models, and 5 cu. ft. on 7 & 8.5 models)
- Awning
- 13.5 BTU Air Conditioner
- Fold-Up Furniture (Sofa/Bed or Dinette/Bed)
- HappiJac Sofa/Beds - Go Up and Out of the Way at the Touch of a Button
- Exterior Shower (where available) With Flexible Hose & Sprayer (H&C)



OPTIONS CONT...

- Offroad Package:
Increased Clearance, All-Terrain Tires
- Black Trim Package
- Spare Tire
- Custom Exterior Paint Color
- Electric Appliances (water heater/refer)
- E-Track Flooring (D-Rings Standard)
- Custom Colored Cabinetry
- Helmet Racks or Overhead Cabinets
- Porta Potty for Closet (non-wet bath models)
- Windows with Blinds
- Pull Down Rear Screen
- Screwless Exterior
- Custom Rims
- Custom Designed Interiors

See our website or your nearest VRV dealer for more information and new product updates.
www.LIVINLITE.com

All illustrations and specifications contained in this literature are based on the latest product information at time of publication. Photos may show options which are not included with the purchase price of the vehicle. LIVIN LITE Recreational Vehicles, Inc., reserves the right to make changes in prices, colors, materials, equipment and specifications at anytime without notice or obligation. All units are shipped F.O.B. Wakarusa, Indiana. Consult your local dealer for detailed warranty information.

Your Dealer

15M 7.26.11



1025 E. WATERFORD • WAKARUSA, IN 46573 • PH. 574.862.2228

www.LIVINLITE.com



SUV AND HALF TON TOWABLE TOY HAULERS

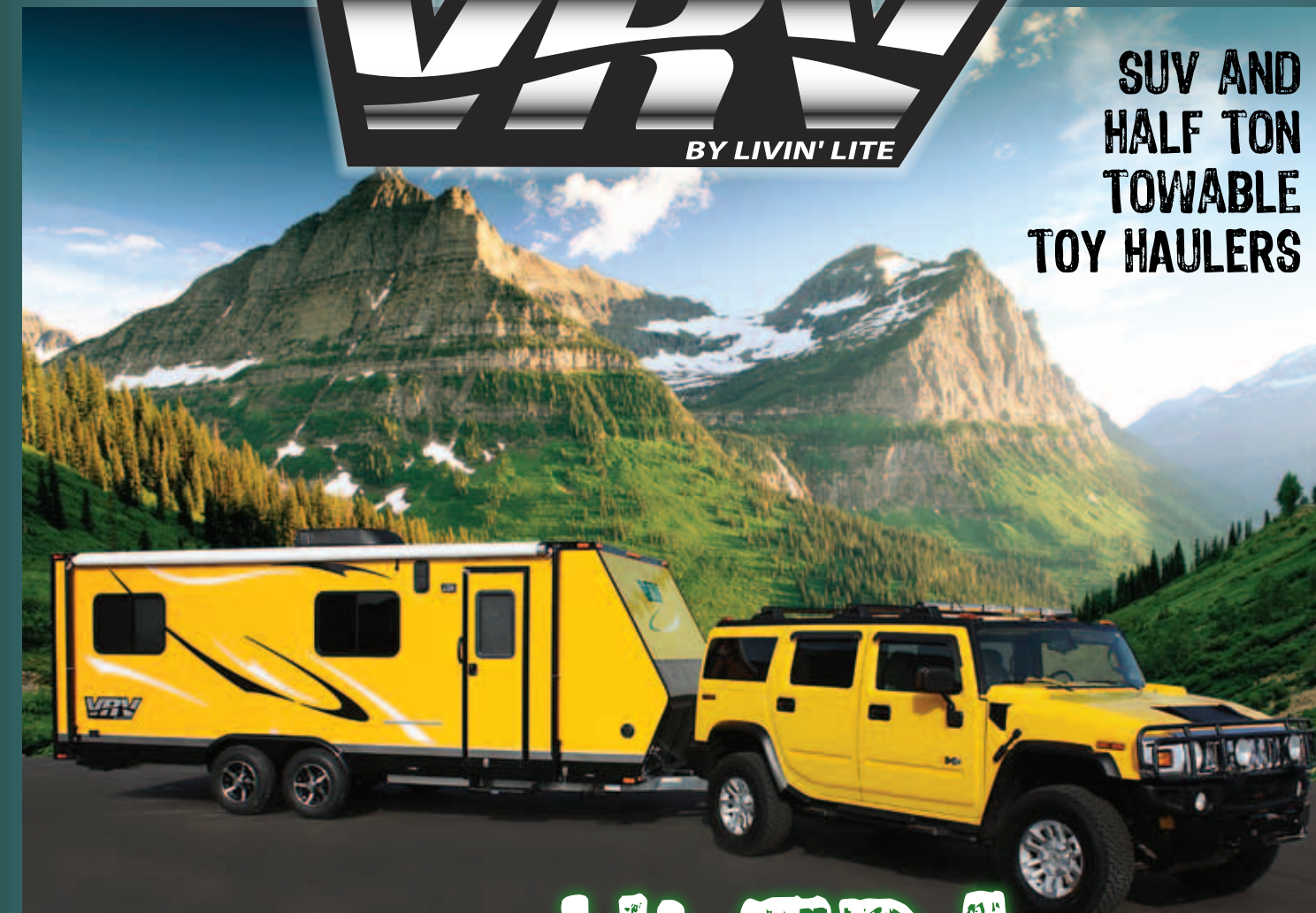

ULTRA LIGHT WEIGHT



ALL-ALUMINUM



VERSATILE RECREATIONAL VEHICLE

Colorful Painted Aluminum Exteriors Make the VRV Stand Out! Match Your Tow Vehicle or Favorite Racing Team Colors.

Now Available with DRY BATHS in most models! You've asked for it, we've responded, and we keep listening to our customers.

Optional Full LP Systems, Including a 3-Way Refrigerator, Furnace, and Water Heater.



Choose From an Array of Cabinetry Colors. Shown Here are the Standard Black and the Optional Champagne Cabinets.



Take your Screamin' Eagle® Out In Style!

Each VRV is UNIQUE - Choose from Tip-Out Bunks, Fold-Up Sofa Beds and Dinettes, or HappiJac Sofa/Bed Systems that Make into Two Beds and Go Up to the Ceiling at the Touch of a Button!

www.LIVINLITE.com



ULTRA LIGHTWEIGHT FLOORPLANS

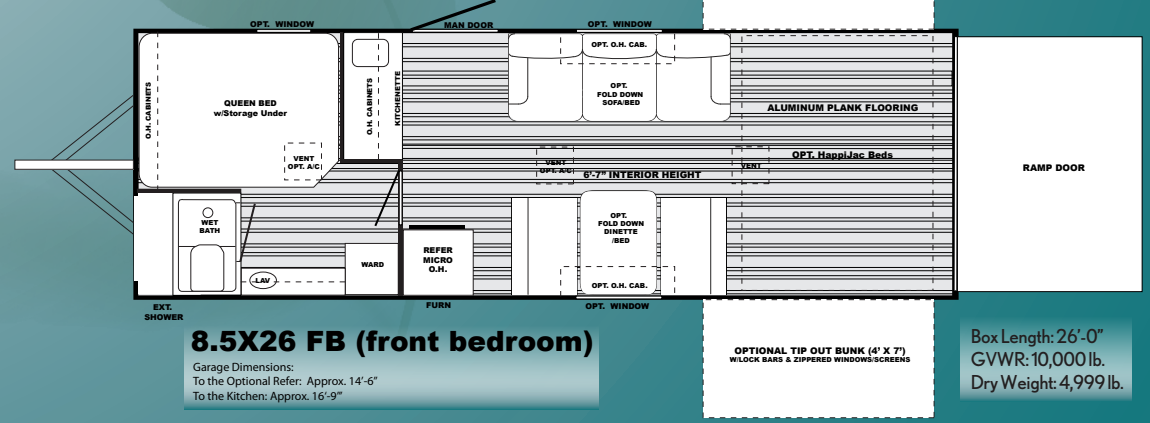
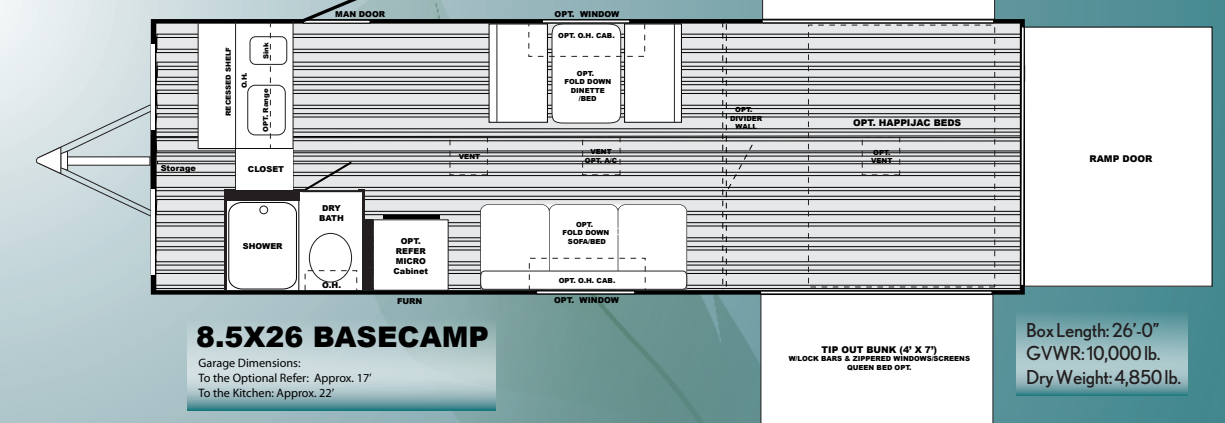
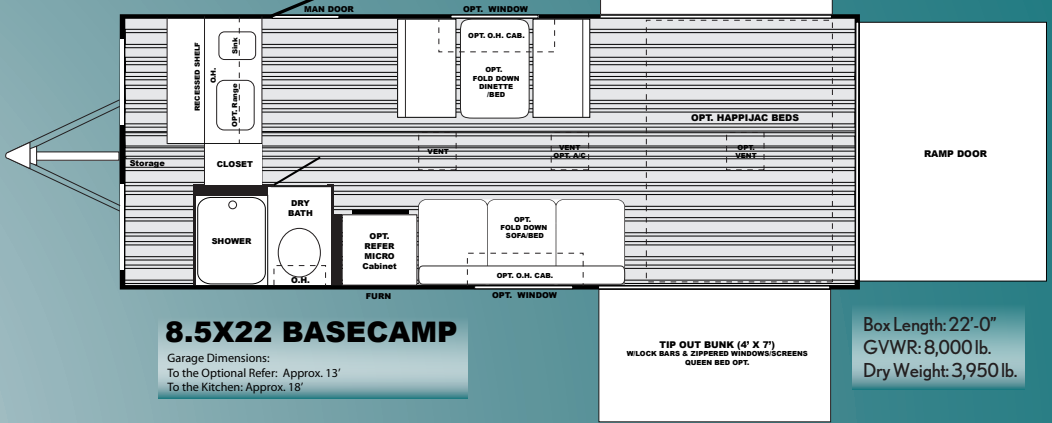
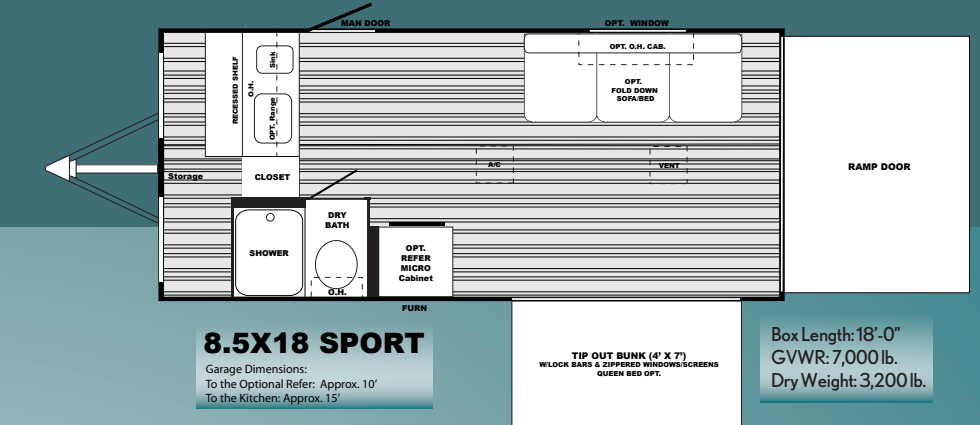
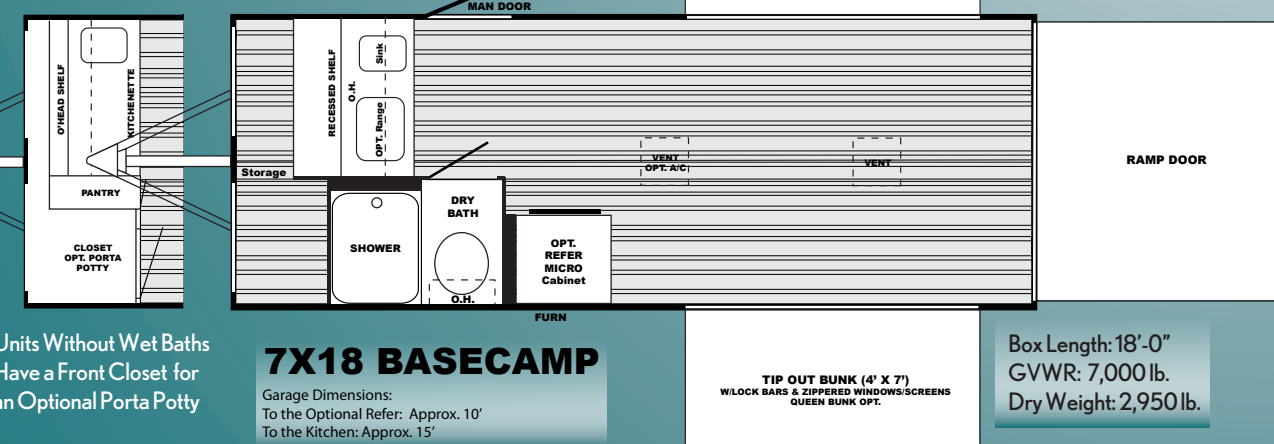
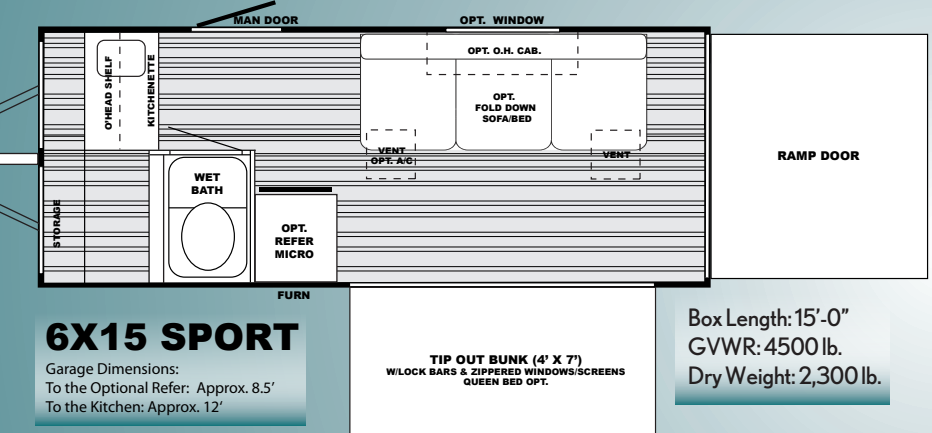
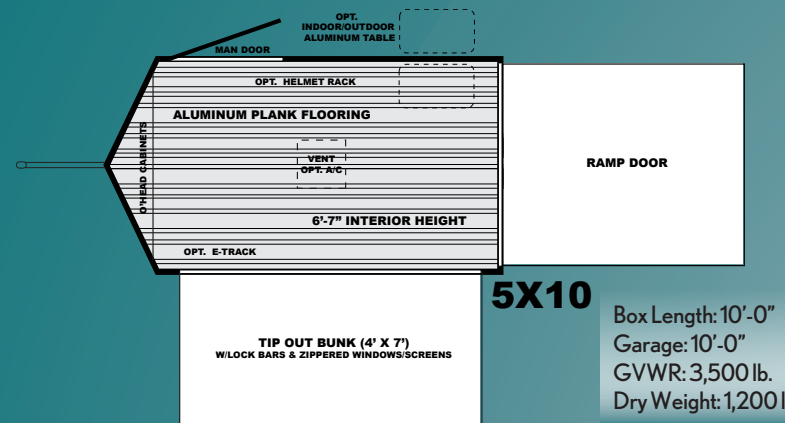

Weights based on standard equipment. Options will add weight. Some weights estimated and based on similar models. Specifications subject to change without notice or obligation to LIVIN LITE RV.