



T O W A B L E S



WINNEBAGO ONE



Leading the way in value and customer satisfaction.



TOWABLES

Winnebago Of Indiana, LLC

201 14th Street | P.O. Box 2001
Middlebury, IN 46540 | (574) 825-5250

Winnebago Dealer

CUSTOMER 1ST VALUE PACKAGE

Memory foam mattress
Double door refrigerator
6 gallon gas/electric water heater
34.0M BTU Hi-capacity furnace
Arctic package
Range cover
Large oven
Tinted safety glass windows
AM/FM/CD/DVD player
Swivel rockers (where applicable)
Outside shower
Super lube axles
Digital TV antenna
Swing-out assist handle
15" radial tires

Stabilizer jacks
Spare tire & carrier
13.5M BTU central air
Microwave
Patio awning
Sink cover
30# LP bottles & cover
Tub surround

OPTIONS

Pull-out lounge table (N/A 32BH)
L-shaped sofa (N/A w/booth dinette)
Hide-a-bed sofa
Recliner ipo swivel rocker
2nd recliner ipo swivel rocker
Freestanding dinette & 4 chairs
32" television
15.0M BTU A/C (13.5M BTU std.)
Raised panel cabinet doors - uppers
Raised panel refrigerator front
Night shades ipo mini blinds
Wardrobe slide-out
15" aluminum wheels
12 volt awning
Slam latch baggage doors

12 volt stabilizer jacks
12 volt tongue jack
Fantastic fan with rain sensor in kitchen/living room
Roof ladder
Canadian electrical breaker configuration
8 cu. ft. refer
Solid surface countertop in kitchen
Designer front fiberglass cap
50 AMP service w/2nd A/C prep
Trail Air Equa Flex suspension
Thermopane windows
CSA
Body paint

FLOOR PLANS

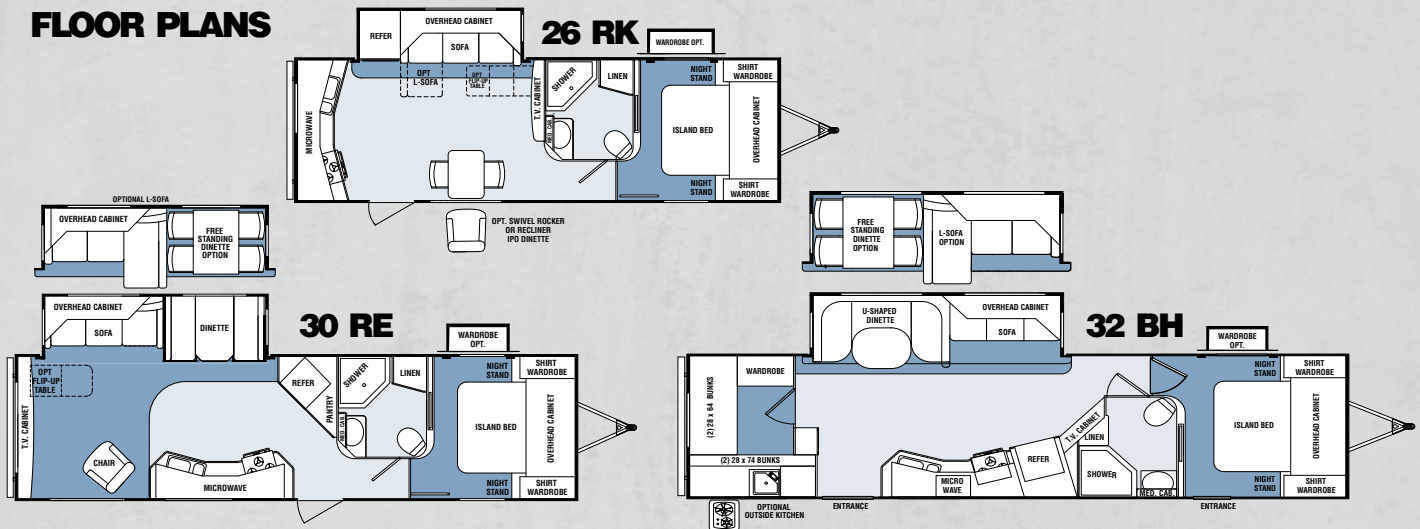

SPECIFICATIONS

	Exterior Length	Ext. Ht. w/ A/C	Exterior Width	Interior Height	Dry Hitch Weight	Dry Gross Weight	GVWR LBS.	Dual 4,400 LBS. AXLES	Tire Size	Hitch Height	Fresh Water	Black Water	Gray Water
26 RK	30'-6"	11'-11"	8'-0"	6'-10"	820 LBS.	6,280 LBS.	7,500	STR. AXLES	ST205/75R14C	21-1/2"	56	33	66
30 RE	34'-6"	11'-11"	8'-0"	6'-10"	780 LBS.	6,820 LBS.	8,800	STR. AXLES	ST225/75R15D	21-1/2"	56	33	66
32 BH	35'-11"	11'	8'-0"	6'-10"	TBD	TBD	8,800	STR. AXLES	ST225/75R15D	21-1/2"	56	33	99

Tow Vehicle Disclaimer. CAUTION: Owners of Winnebago of Indiana, LLC recreational vehicles are solely responsible for the selection and proper use of tow vehicles. All customers should consult with a motor vehicle manufacturer or their dealer concerning the purchase and use of suitable tow vehicles for Winnebago of Indiana, LLC products. Winnebago of Indiana, LLC disclaims any liability or damages suffered as a result of the selection, operation, use or misuse of a tow vehicle. WINNEBAGO OF INDIANA, LLC'S LIMITED WARRANTY DOES NOT COVER DAMAGE TO THE RECREATIONAL VEHICLE OR THE TOW VEHICLE AS A RESULT OF THE SELECTION, OPERATION, USE OR MISUSE OF THE TOW VEHICLE.

All illustrations and specifications contained in this literature are based on the latest product information available at the time of printing. Winnebago of Indiana, LLC reserves the right to make changes to colors, materials, specifications and pricing without notice or obligation. Photography may show optional equipment available at an additional cost. Items used as props in photography are not part of the packages. All liquid capacities and weights are approximate and dimensions are nominal. Winnebago of Indiana, LLC reserves the right to make changes and improvements without incorporating these changes into similar models produced at an earlier date. Consult your local, authorized Winnebago of Indiana, LLC dealer for the latest information and changes. Winnebago of Indiana, LLC continues to be a member in good standing of the RVIA.